

NSL correction
issue 4 - 13-72

WOOD-McSHANE, INC.
MANAGEMENT AND OPERATIONS
TELEPHONE 915 - 943-3092
P. O. BOX 968
MONAHANS, TEXAS 79756
RECEIVED
APR 12 1972
OIL CONSERVATION COMM.
Santa Fe

April 10, 1972

New Mexico Oil Conservation Commission
Secretary-Director
P. O. Box 2088
Santa Fe, New Mexico 87501

Attention: Mr. A. L. Porter, Jr.

Re: Wood, McShane & Thams-692, Ltd.
"M" State No. 60
Langlie Mattix Pool
Lea County, New Mexico

Gentlemen:

Wood, McShane & Thams have received an Administrative Order NSL-529 for the drilling of New Mexico "M" State No. 60. The original Form C-102 showed the location to be 1335 feet from the north line and 10 feet from the east line of Section 30, Unit H, Township 22-S, Range 37-E, Lea County, New Mexico. It was necessary to move the original stake away from a tank at the water plant prior to spudding and the attached Form C-102 is therefore being filed to show the correct location.

It is understood that it will be necessary to obtain another NSL-529 for "M" State No. 60 subsequent to moving the location. Wood, McShane & Thams will appreciate very much another Administrative Order for this well.

Yours very truly,

WOOD-McSHANE, INC., For
Wood, McShane & Thams-692, Ltd.

K. D. Myrick
K. D. Myrick

KDM:vc
Attachment

cc: Mr. Joe Ramey

OIL ☐ MINERALS ☐ REAL ESTATE ☐ CATTLE ☐ FARMING ☐ GAS ☐ WATER ☐

**NEW MEXICO OIL CONSERVATION COMMISSION
WELL LOCATION AND ACREAGE DEDICATION PLAT**

All distances must be from the outer boundaries of the Section.

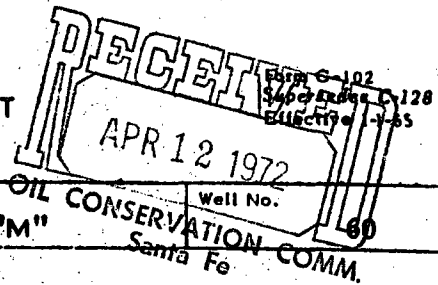

Operator WOOD, McSHANE & THAMS			Lease NEW MEXICO STATE "M"			Well No. 80
Unit Letter H	Section 30	Township 22 SOUTH	Range 37 EAST	County LEA		
Actual Footage Location of Well: 1410 feet from the NORTH line and 90 feet from the EAST line						
Ground Level Elev. 3382'	Producing Formation Queen		Pool Langlie Mattix		Dedicated Acreage: Acres	

1. Outline the acreage dedicated to the subject well by colored pencil or hachure marks on the plat below.
2. If more than one lease is dedicated to the well, outline each and identify the ownership thereof (both as to working interest and royalty).
3. If more than one lease of different ownership is dedicated to the well, have the interests of all owners been consolidated by communitization, unitization, force-pooling, etc?

☐ Yes ☐ No If answer is "yes," type of consolidation _____

If answer is "no," list the owners and tract descriptions which have actually been consolidated. (Use reverse side of this form if necessary.) _____

No allowable will be assigned to the well until all interests have been consolidated (by communitization, unitization, forced-pooling, or otherwise) or until a non-standard unit, eliminating such interests, has been approved by the Commission.

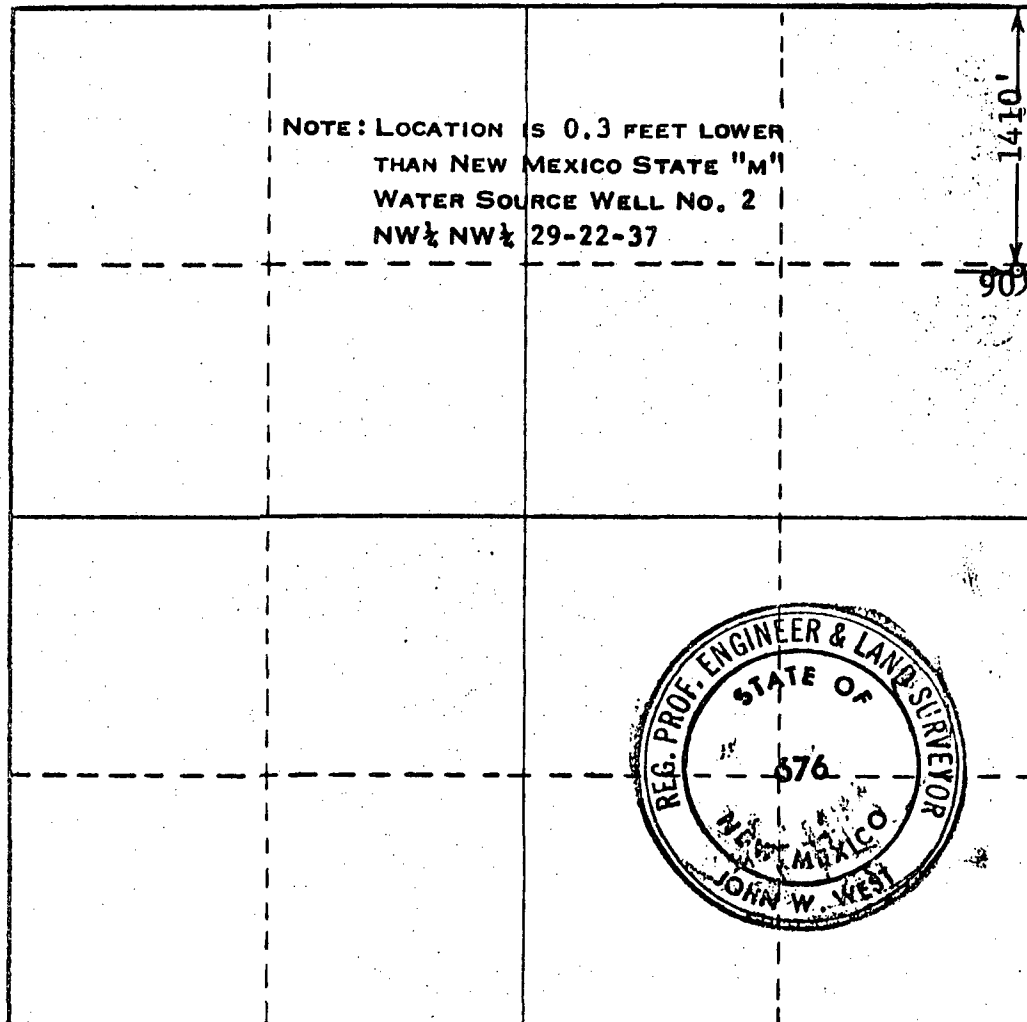

CERTIFICATION

I hereby certify that the information contained herein is true and complete to the best of my knowledge and belief.

K. D. Myrick

Name

K. D. Myrick

Position

Petroleum Engineer

Company

Wood, McShane & Thams

Date

4-10-72

I hereby certify that the well location shown on this plat was plotted from field notes of actual surveys made by me or under my supervision, and that the same is true and correct to the best of my knowledge and belief.

Date Surveyed

NOVEMBER 19, 1971

Registered Professional Engineer and/or Land Surveyor

John W. West

Certificate No.

676

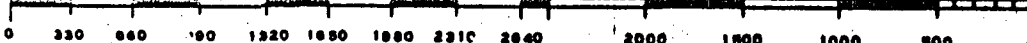

OIL CONSERVATION COMMISSION

P. O. BOX 2088

SANTA FE, NEW MEXICO 87501

April 13, 1972

C
O
P
Y

Wood-McShane, Inc.
P. O. Box 968
Monahans, Texas 79756

Attention: Mr. K. D. Myrick

Re: Administrative Order NSL-529
"M" State Well No. 60

Gentlemen:

Please correct NSL-529 to reflect the following
change in location:

"to be located 1410 feet from the North line and
90 feet from the East line of Section 30."

Very truly yours,

A. L. PORTER, Jr.
Secretary-Director

ALP/GMH/dr

cc: Oil Conservation Commission - Hobbs
Oil & Gas Engineering - Hobbs
State Land Office - Santa Fe