

*NSL's - 557
issue upon receipt of
additional information*

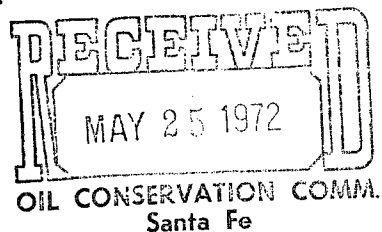

WOOD-McSHANE, INC.
MANAGEMENT AND OPERATIONS
TELEPHONE 915 - 943-3092
P. O. BOX 968
MONAHANS, TEXAS 79756

April 24, 1972

New Mexico Oil Conservation Commission
Secretary-Director
P. O. Box 2088
Santa Fe, New Mexico 87501

Con 4287

Attention: Mr. A. L. Porter, Jr.

Re: Wood, McShane & Thams-692, Ltd.
Application to Drill
"M" State Nos. 62 & 71
Langlie Mattix Pool
Lea County, New Mexico

Gentlemen:

Wood, McShane & Thams request approval to drill New Mexico "M" State Nos. 62 and 71 on unorthodox locations in the Langlie Mattix Pool. Commission Order No. R-3910, dated January 14, 1970, provides for administrative approval of wells to be drilled at orthodox and unorthodox locations within the "M" State Lease Waterflood Project, provided said wells are drilled no closer than 330 feet to the outer boundary of the subject lease nor closer than 10 feet to any quarter-quarter section or subdivision inner boundary.

Forms C-101, Notices of Intention to Drill, have been filed with the District Office and Forms C-102 are attached showing the location of each well.

Wood, McShane & Thams will appreciate very much your prompt approval of these locations.

Yours very truly,

WOOD-McSHANE, INC., For
Wood, McShane & Thams-692, Ltd.

K. D. Myrick

KDM:pb
cc: Mr. Joe Ramey

NEW MEXICO OIL CONSERVATION COMMISSION
WELL LOCATION AND ACREAGE DEDICATION PLAT

RECEIVED
Form C-102
Supersedes C-128
Effective 1-1-65
MAY 25 1972

All distances must be from the outer boundaries of the Section.

Operator WOOD, MCSHANE, THAMS-COLORADO			Lease N.M. STATE M OIL CONSERVATION COMM 62			Well No.		
Unit Letter B	Section 29	Township 22 SOUTH	Range 37 EAST	County LEA	Santa Fe			
Actual Footage Location of Well: 1310 feet from the NORTH line and 2630 feet from the WEST line								
Ground Level Elev. 3360.5'	Producing Formation Queen		Pool Langlie Mattix			Dedicated Acreage: Acres		

1. Outline the acreage dedicated to the subject well by colored pencil or hachure marks on the plat below.
2. If more than one lease is dedicated to the well, outline each and identify the ownership thereof (both as to working interest and royalty).
3. If more than one lease of different ownership is dedicated to the well, have the interests of all owners been consolidated by communitization, unitization, force-pooling, etc?

☐ Yes ☐ No If answer is "yes," type of consolidation _____

If answer is "no," list the owners and tract descriptions which have actually been consolidated. (Use reverse side of this form if necessary.) _____

No allowable will be assigned to the well until all interests have been consolidated (by communitization, unitization, forced-pooling, or otherwise) or until a non-standard unit, eliminating such interests, has been approved by the Commission.

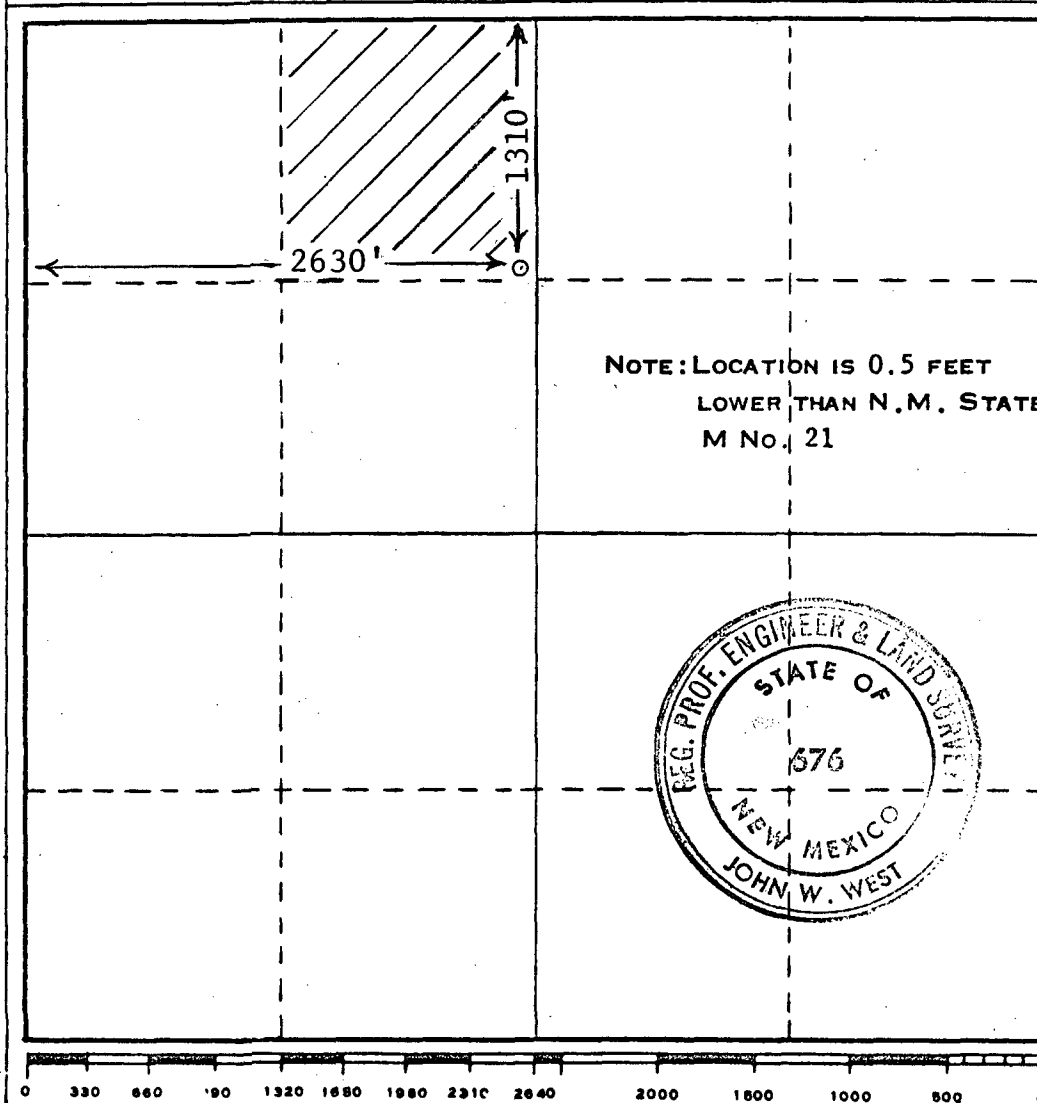

CERTIFICATION

I hereby certify that the information contained herein is true and complete to the best of my knowledge and belief.

K. D. Myrick

Name
K. D. Myrick
Position
Petroleum Engineer
Company
Wood, McShane & Thams
Date
5-24-72

I hereby certify that the well location shown on this plat was plotted from field notes of actual surveys made by me or under my supervision, and that the same is true and correct to the best of my knowledge and belief.

Date Surveyed
APRIL 21, 1970
Registered Professional Engineer and/or Land Surveyor

John W. West
Certificate No. **676**

NEW MEXICO OIL CONSERVATION COMMISSION
WELL LOCATION AND ACREAGE DEDICATION PLAT

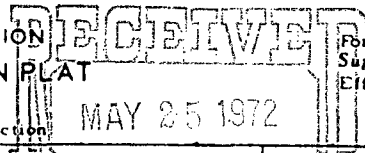

Form C-102
Supersedes C-128
Effective 1-1-65

All distances must be from the outer boundaries of the Section

Operator WOOD, McSHANE & THAMS			Lease "M" STATE CONSERVATION		Well No. COMM. 71
Unit Letter B	Section 29	Township 22 SOUTH	Range 37 EAST	County Santa Fe	
Actual Footage Location of Well: 70 feet from the NORTH line and 2570 feet from the EAST line					
Ground Level Elev. 3369.4	Producing Formation Queen		Pool Langlie Mattix	Dedicated Acreage: Acres	

1. Outline the acreage dedicated to the subject well by colored pencil or hachure marks on the plat below.
2. If more than one lease is dedicated to the well, outline each and identify the ownership thereof (both as to working interest and royalty).
3. If more than one lease of different ownership is dedicated to the well, have the interests of all owners been consolidated by communitization, unitization, force-pooling, etc?

☐ Yes ☐ No If answer is "yes," type of consolidation _____

If answer is "no," list the owners and tract descriptions which have actually been consolidated. (Use reverse side of this form if necessary.) _____

No allowable will be assigned to the well until all interests have been consolidated (by communitization, unitization, forced-pooling, or otherwise) or until a non-standard unit, eliminating such interests, has been approved by the Commission.

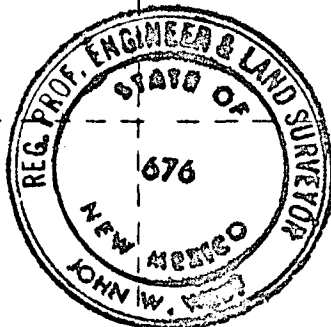
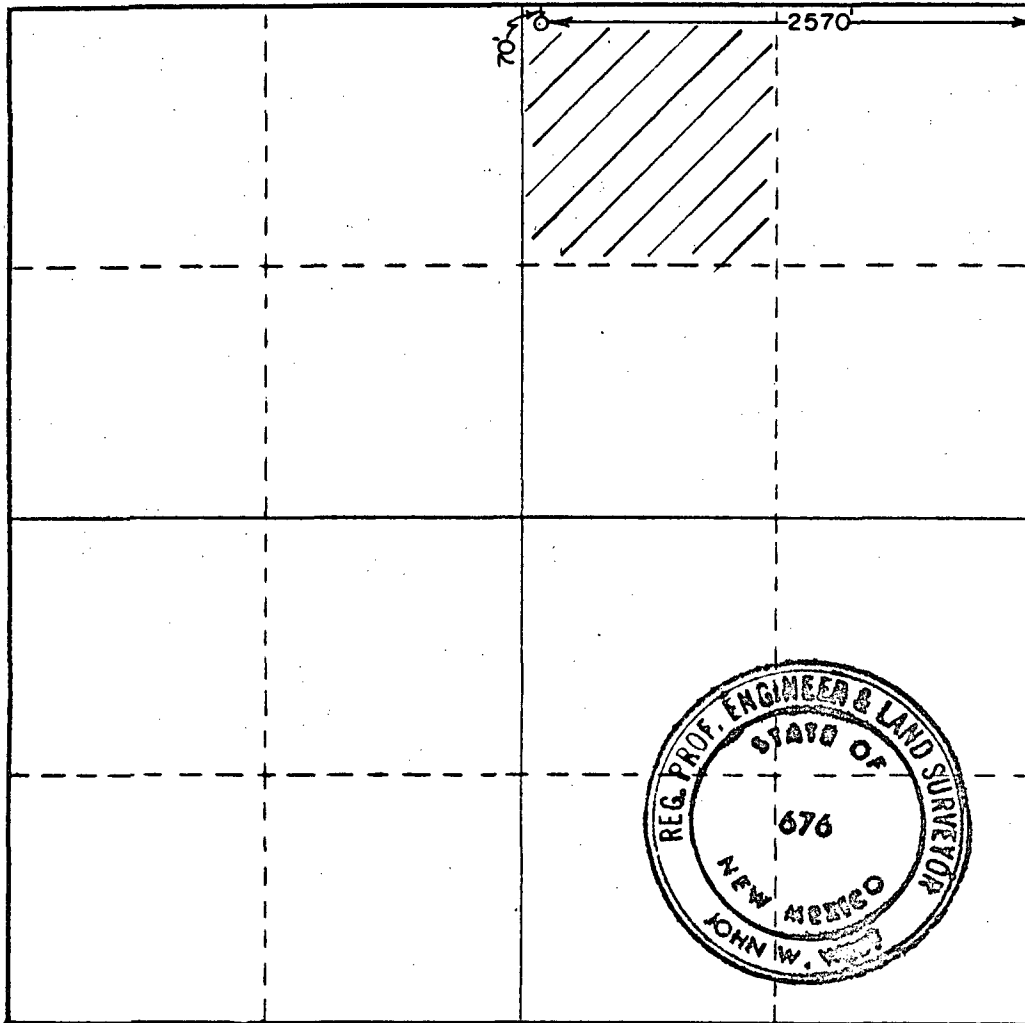

CERTIFICATION

I hereby certify that the information contained herein is true and complete to the best of my knowledge and belief.

K. D. Myrick

Name
K. D. Myrick

Position
Petroleum Engineer

Company
Wood, McShane & Thams

Date
5-24-72

I hereby certify that the well location shown on this plat was plotted from field notes of actual surveys made by me or under my supervision, and that the same is true and correct to the best of my knowledge and belief.

Date Surveyed
SEPTEMBER 10, 1971

Registered Professional Engineer and/or Land Surveyor

John W. West

Certificate No. **676**

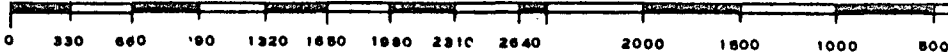

gms
NS
two
564
Wells (Production)
Issue - 6-5-72
Order 2 of Order
No. R-3910

WOOD-McSHANE, INC.

MANAGEMENT AND OPERATIONS

TELEPHONE 915 - 943-3092

P. O. BOX 968

MONAHANS, TEXAS 79756

June 3, 1972

Oil Conservation Commission
P. O. Box 2088
Santa Fe, NM 87501

ATTENTION: Mr. George M. Hatch

Gentlemen:

The following information is submitted in response to your letter dated May 25, 1972.

- (1) Both "M" State Nos. 62 and 71 are scheduled to be producing wells.
- (2) Wood, McShane & Thams "M" State Lease is also in the adjoining Section 20; it was therefore thought unnecessary to notify offset operators. Commission Order No. R-3910 provides for administrative approval of wells to be drilled no closer than 330 feet from the outer boundary of the subject lease nor closer than 10 feet to any quarter-quarter section or subdivision inner boundary.
- (3) A plat is attached showing which wells are on production and injection.

Yours very truly,

WOOD-McSHANE, INC. For
Wood, McShane & Thams

K. D. Myrick

K. D. Myrick

KDM:pb/cs

Enclosure

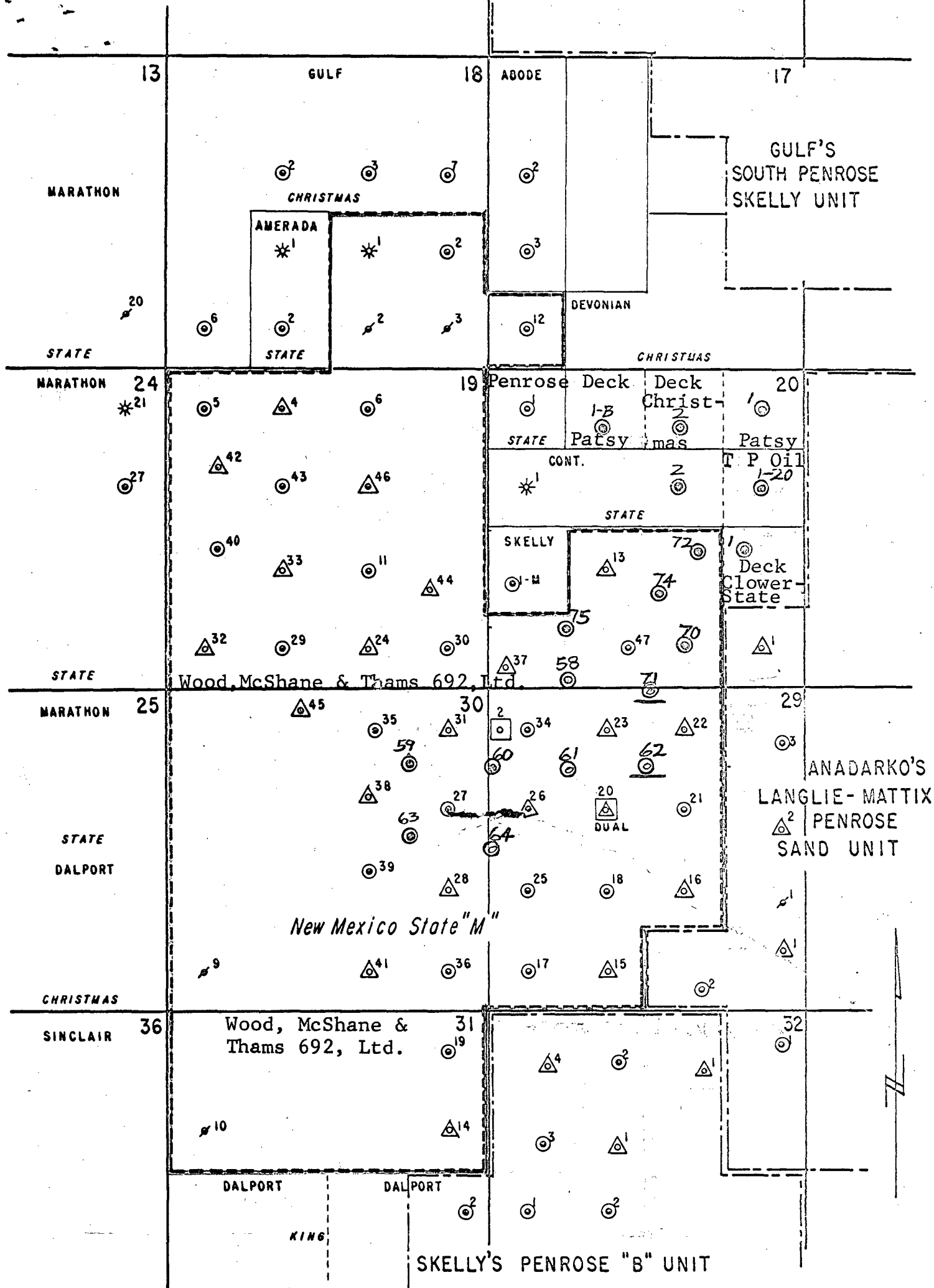

- LEGEND -

- ⊙ Producing Wells
- △ Water Injection Wells
- Water Source Wells
- * Gas Wells
- ↗ P & A Wells
- State "M" Lease
- Unit Lines

QUEEN SAND

FLOOD PATTERN

WOOD, McSHANE & THAMS 692, LTD.

NEW MEXICO STATE "M" LEASE
 LANGLEY MATTIX POOL
 LEA COUNTY, NEW MEXICO

OIL CONSERVATION COMMISSION

P. O. BOX 2088

SANTA FE, NEW MEXICO 87501

May 25, 1972

Wood-McShane, Inc.
P. O. Box 968
Monahans, Texas 79756

Re: Application to drill
"M" State Wells Nos. 62
and 71, Langlie-Mattix
Pool, Lea County, New Mexico

Gentlemen:

In regards to the above-described application, please
send this office the following information:

- (1) Information as to whether the wells are to
be producing wells or injection wells.
- (2) A statement that offset operators to your
Well No. 71 have been notified of your
application.
- (3) A plat showing wells that are presently on
production and injection.

Very truly yours,

GEORGE M. HATCH
Attorney

GMH/dr

C
O
P
Y