

NS ✓
issue upon add. info
receipt of acreage to
be dedicated

TENNECO OIL COMPANY

A Tenneco Company

SUITE 1200 • LINCOLN TOWER BUILDING • DENVER, COLORADO 80203

TENNECO

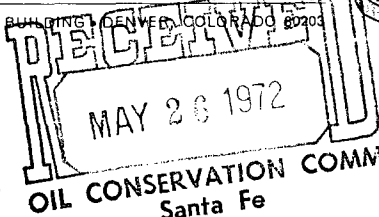

May 23, 1972

Mr. A. L. Porter
Secretary - Director
New Mexico Oil Conservation Commission
P. O. Box 2088
Santa Fe, New Mexico

RE: Exception to Rule 104
Gas Well Spacing: Santa Fe
and Pacific Railroad Well No. 8
Section 24, Township 17 North,
Range 9 West,
Undesignated Dakota Field
McKinley County, New Mexico

Dear Sir:

Tenneco Oil Company, as operator of the captioned well, respectfully submits application for an exception to the well spacing Rule 104. A copy of the location plat for the captioned well is attached. It shows the well to be located 640 feet (instead of 660') from the west side of Section 24, Township 17 North, Range 9 West. The well is now completed in the Dakota "A" Gas Reservoir.

The basis on which Tenneco is making this request is the fact that this well was initially drilled with the Lone Pine Dakota "D" Pool (oil) as its objective. The "D" Zone was unproductive and the well recompleted to the "A" Zone. The current completion meets oil well spacing requirements.

Tenneco Oil Company controls all of the acreage in the immediate area.

Your approval of the application will be appreciated.

Yours very truly,

TENNECO OIL COMPANY

R. A. Williford
District Production Manager

WEB/lj
Attachments

cc: Emery Arnold
NMOCC
Aztec, New Mexico

**NEW MEXICO OIL CONSERVATION COMMISSION
WELL LOCATION AND ACERAGE DEDICATION PLAT**

All distances must be from the outer boundaries of the Section

RECEIVED
MAY 26 1972
OIL CONSERVATION COMM.
Santa Fe

Operator TENNECO OIL COMPANY			Lease SANTA FE PACIFIC RAILROAD			Well No. 8		
Unit Letter D	Section 24	Township 17 North	Range 9 West	County McKinley				
Actual Footage Location of Well: 740 feet from the North line and 640 feet from the West line								
Ground Level Elev. 7096' ungraded			Producing Formation			Pool		Dedicated Acreage: Acres

1. Outline the acreage dedicated to the subject well by colored pencil or hatchure marks on the plat below.
2. If more than one lease is dedicated to the well, outline each and identify the ownership thereof (both as to working interest and royalty),
3. If more than one lease of different ownership is dedicated to the well, have the interests of all owners been consolidated by communitization, unitization, force-pooling, etc?

() Yes () No If answer is "yes," type of consolidation

If answer is "no," list the owners and tract descriptions which have actually consolidated. (Use reverse side of this form if necessary.)

No allowable will be assigned to the well until all interests have been consolidated (by communitization, unitization, forced-pooling, or otherwise) or until a non standard unit, eliminating such interests, has been approved by the Commission.

CERTIFICATION

I hereby certify that the information contained herein is true and complete to the best of my knowledge and belief.

Name _____
Position _____
Company _____
Date _____

I hereby certify that the well location shown on this plat was plotted from field notes of actual surveys made by me or under my supervision, and that the same is true and correct to the best of my knowledge and belief.

18 November 1970
Date Surveyed _____
Robert H. Ernst
Registered Professional Engineer
and/or Land Surveyor

Robert H. Ernst

New Mexico PE&LS 2463

Certificate No. _____

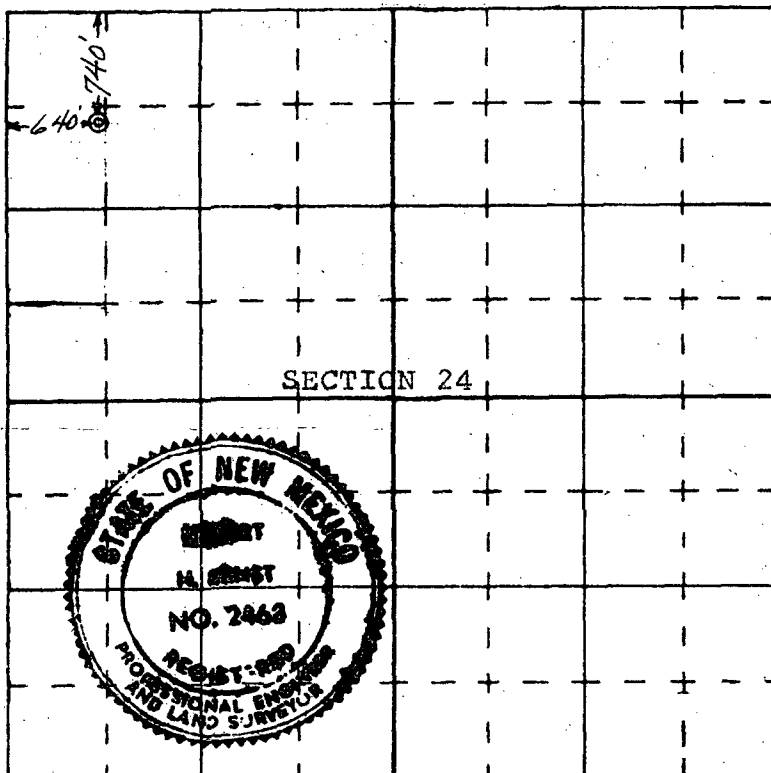

**ERNST ENGINEERING CO.
DURANGO, COLORADO**



OIL CONSERVATION COMMISSION

STATE OF NEW MEXICO

P. O. BOX 2088 - SANTA FE

87501

May 26, 1972

GOVERNOR
BRUCE KING
CHAIRMAN

LAND COMMISSIONER
ALEX J. ARMijo
MEMBER

STATE GEOLOGIST
A. L. PORTER, JR.
SECRETARY - DIRECTOR

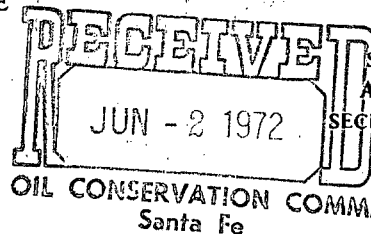

Tenneco Oil Company
Suite 1200
Lincoln Tower Building
Denver, Colorado 80203

Attention: Mr. R. A. Williford

Re: Application for non-standard
gas well location for Santa Fe
Pacific Railroad Well No. 8,
Section 24, Township 17 North,
Range 9 West, Undesignated
Dakota gas pool, McKinley
County, New Mexico.

Gentlemen:

Please send to this office a plat showing
the acreage to be dedicated to the above-described
well.

Yours very truly,

George M. Hatch
GEORGE M. HATCH
Attorney

GMH/dr

5/31/72
Plat attached as per your
request
Tenneco Oil Co.
By G.A. Z...

**NEW MEXICO OIL CONSERVATION COMMISSION
WELL LOCATION AND ACERAGE DEDICATION PLAT**

RECEIVED
JUN - 2 1972
OIL CONSERVATION COMM.
Santa Fe

All distances must be from the outer boundaries of the Section

Operator TENNECO OIL COMPANY			Lease SANTA FE PACIFIC RAILROAD		Well No. 8
Unit Letter D	Section 24	Township 17 North	Range 9 West	County McKinley	
Actual Footage Location of Well: 740 feet from the North line and 640 feet from the West line					
Ground Level Elev. 7096' ungraded	Producing Formation Dakota	Pool Undesignated Dakota	Dedicated Acreage: 160		Acres

1. Outline the acreage dedicated to the subject well by colored pencil or hatchure marks on the plat below.
2. If more than one lease is dedicated to the well, outline each and identify the ownership thereof (both as to working interest and royalty),
3. If more than one lease of different ownership is dedicated to the well, have the interests of all owners been consolidated by communitization, unitization, force-pooling, etc?

() Yes () No If answer is "yes," type of consolidation

If answer is "no," list the owners and tract descriptions which have actually consolidated. (Use reverse side of this form if necessary.)

No allowable will be assigned to the well until all interests have been consolidated (by communitization, unitization, forced-pooling, or otherwise) or until a non standard unit, eliminating such interests, has been approved by the Commission.

CERTIFICATION

I hereby certify that the information contained herein is true and complete to the best of my knowledge and belief.

G. A. Ford
Name **G. A. Ford**

Position
Sr. Production Clerk
Company

Tenneco Oil Company
Date
5/31/72

I hereby certify that the well location shown on this plat was plotted from field notes of actual surveys made by me or under my supervision, and that the same is true and correct to the best of my knowledge and belief.

18 November 1970
Date Surveyed
Robert H. Ernst
Registered Professional Engineer
and/or Land Surveyor

Robert H. Ernst
New Mexico PE&LS 2463
Certificate No.

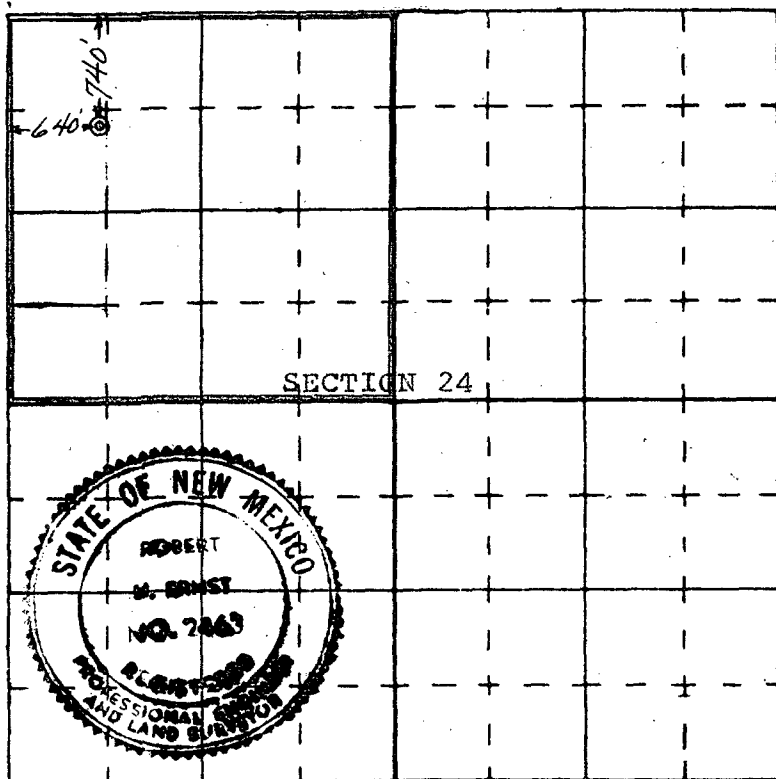

**ERNST ENGINEERING CO.
DURANGO, COLORADO**