



NSL-603

L. P. Thompson
Division Manager
Production Department
Hobbs Division

Blue June 20

Western Hemisphere Petroleum Division
Continental Oil Company
P.O. Box 460
1001 North Turner
Hobbs, New Mexico 88240
(505) 393-4141

A 2403-A

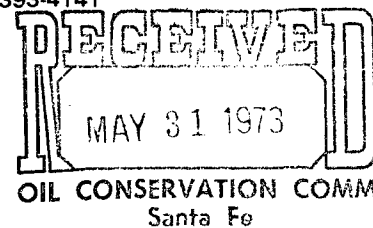

May 29, 1973

New Mexico Oil Conservation Commission (3) ✓
P. O. Box 2088
Santa Fe, New Mexico 87501

Attention Mr. A. L. Porter, Jr.
Secretary-Director

Gentlemen:

Application for Approval of Unorthodox Locations for the MCA Unit

Continental Oil Company, as operator for the MCA Unit, hereby requests approval under the provisions of Order No. R-2403-A to drill the following wells:

MCA Unit - T-17S, R-32E, Lea County, New Mexico

<u>Well No.</u>	<u>Location</u>	<u>Section</u>	<u>Unit Letter</u>
340	1345' FNL & 1345' FEL	21	G
341	100' FSL & 150' FEL	22	P
342	1225' FNL & 1295' FWL	26	D

The wells are being drilled in conjunction with our current in-fill drilling program, and should result in the more efficient recovery of oil in this immediate area. It is respectfully requested that immediate approval of these locations be given.

Yours very truly,

rw
Enc
Copy + enc:
New Mexico Oil Conservation Commission
P. O. Box 1980
Hobbs, New Mexico 88240

United States Geological Survey (2)
P. O. Box 1157
Hobbs, New Mexico 88240

RLA: JJB: JWK:

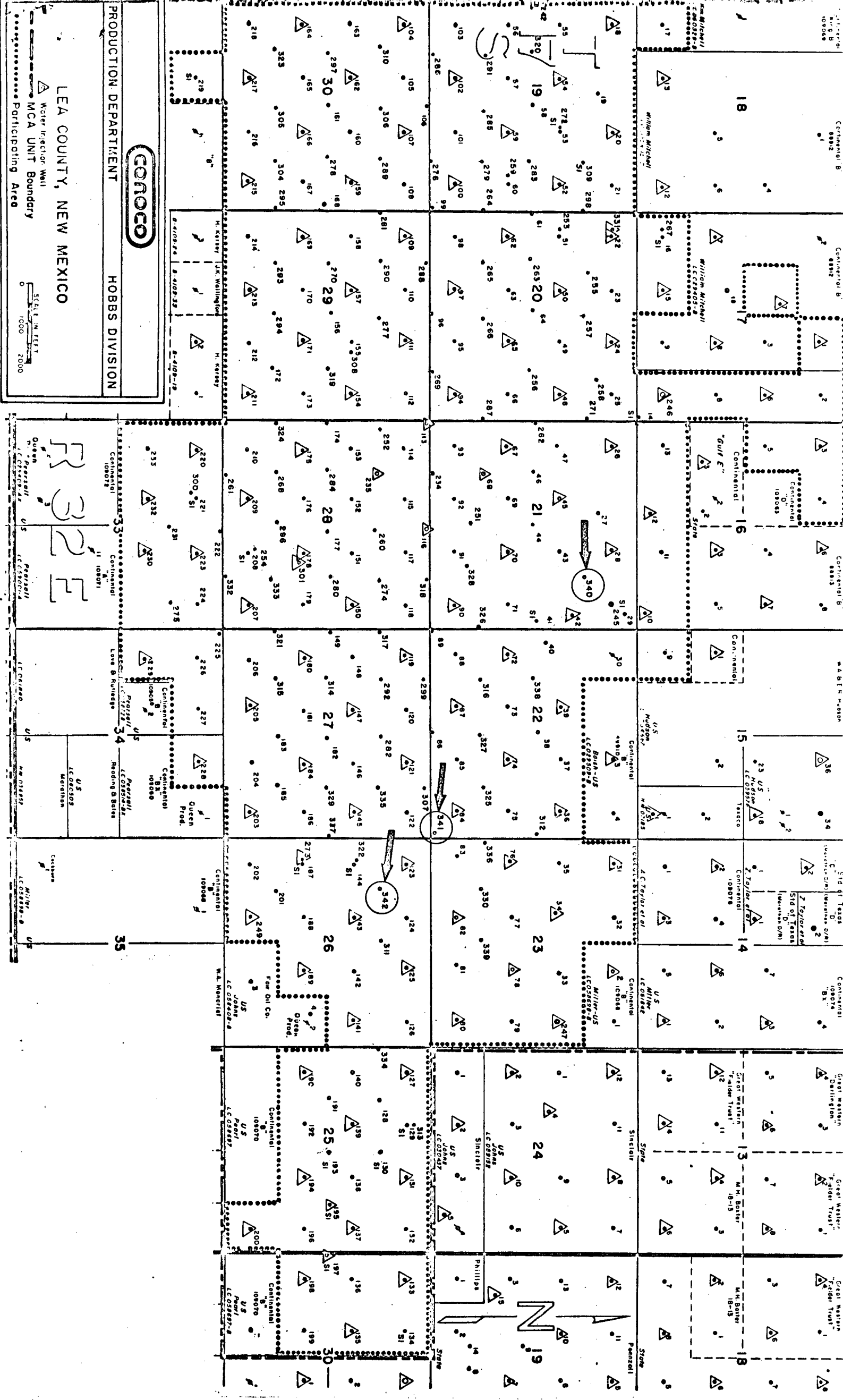

CONOCO

PRODUCTION DEPARTMENT

HOBBS DIVISION

LEA COUNTY, NEW MEXICO

Water Injection Well

MCA UNIT Boundary

Scale in Feet

0 1000 2000

Participating Area

