

*Thunderbird Oil Corporation*

1010 WEST WALL ○ P O. BOX 1097 ○ (915) 682-0524 ○ MIDLAND, TEXAS 79701

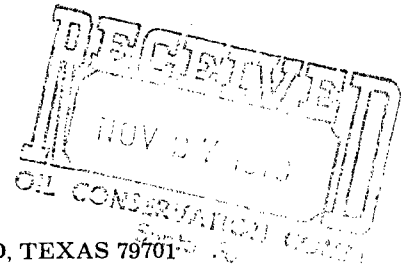

November 26, 1973

*NSL-634*

*10/26/73*

Mr. A. L. Porter, Jr.  
Secretary-Director  
New Mexico Oil Conservation Commission  
P. O. Box 2088  
Santa Fe, New Mexico 87501

Re: Request for Administrative Approval  
Unorthodox Location  
Commission Order No. R-4317

Dear Mr. Porter:

Request for administrative approval for an unorthodox location pursuant to Commission Order No. R-4317 is hereby requested for our No. 2-Y North Caprock Unit, Tract 26, as further described on the accompanying survey plat.

There are no offset lease owners to this tract other than Thunderbird Oil Corporation.

Yours very truly,

Harry F. Schram  
President

HFS/bd  
Enclosures

NO. OF COPIES RECEIVED		
DISTRIBUTION		
SANTA FE		
FILE		
U.S.G.S.		
LAND OFFICE		
OPERATOR		

# NEW MEXICO OIL CONSERVATION COMMISSION

Form C-101  
Revised 1-1-65

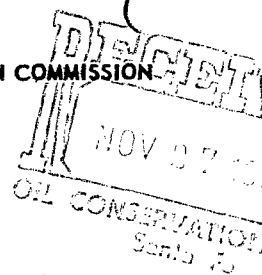

5A. Indicate Type of Lease

STATE ☐ FEE ☒

5. State Oil & Gas Lease No.

## APPLICATION FOR PERMIT TO DRILL, DEEPEN, OR PLUG BACK

1a. Type of Work		7. Unit Agreement Name	
b. Type of Well OIL WELL <input checked="" type="checkbox"/> GAS WELL <input type="checkbox"/> OTHER <input type="checkbox"/> DRILL <input checked="" type="checkbox"/> DEEPEN <input type="checkbox"/> PLUG BACK <input type="checkbox"/>		No. Caprock Queen	
2. Name of Operator		8. Farm or Lease Name	
Thunderbird Oil Corporation		Tract 26	
3. Address of Operator		9. Well No.	
P. O. Box 1097, Midland, Texas 79701		2-Y	
4. Location of Well		10. Field and Pool, or Wildcat	
UNIT LETTER <u>B</u> LOCATED <u>1310</u> FEET FROM THE <u>North</u> LINE AND <u>1330</u> FEET FROM THE <u>East</u> LINE OF SEC. <u>7</u> TWP. <u>13-S</u> RGE. <u>32-E</u> NMPM		Caprock Queen	
		12. County	
		Lea	
		19. Proposed Depth	
		3100'	
		19A. Formation	
		Queen	
		20. Rotary or C.T.	
		Rotary	
21. Elevations (Show whether DF, RT, etc.)		22. Approx. Date Work will start	
21A. Kind & Status Plug. Bond		21B. Drilling Contractor	
Statewide		Capitan Drlg. Co.	
		Dec. 1, 1973	

23.

## PROPOSED CASING AND CEMENT PROGRAM

SIZE OF HOLE	SIZE OF CASING	WEIGHT PER FOOT	SETTING DEPTH	SACKS OF CEMENT	EST. TOP
11"	8-5/8"	24#	300'	150	Circulate
7-7/8"	5-1/2"	14#	3100'	150	2087'

It is proposed to drill the captioned well to 3100' and test the Queen Formation. If commercial production is indicated, we propose to follow the described casing program, perforate and treat the reservoir, and produce the well. Should we plug and abandon this well, plugging shall be done in accordance with New Mexico Oil Commission regulations.

For unorthodox location see NMOCC Order No. R-4317

IN ABOVE SPACE DESCRIBE PROPOSED PROGRAM; IF PROPOSAL IS TO DEEPEN OR PLUG BACK, GIVE DATA ON PRESENT PRODUCTIVE ZONE AND PROPOSED NEW PRODUCTIVE ZONE. GIVE BLOWOUT PREVENTER PROGRAM, IF ANY.

I hereby certify that the information above is true and complete to the best of my knowledge and belief.

Signed Harry J. Schum Title President Date November 20, 1973  
(This space for State Use)

APPROVED BY \_\_\_\_\_ TITLE \_\_\_\_\_ DATE \_\_\_\_\_

CONDITIONS OF APPROVAL, IF ANY:

NEW MEXICO OIL CONSERVATION COMMISSION  
WELL LOCATION AND ACREAGE DEDICATION PLAT

Form C-132  
Supersedes C-128  
Effective 1-1-55

All distances must be from the outer boundaries of the Section

Operator <b>THUNDERBIRD OIL CORPORATION</b>			Lease <b>NORTH CAPROCK UNIT, TRACT 26</b>			Well <b>2-Y</b>
Unit Letter <b>B</b>	Section <b>7</b>	Township <b>13 SOUTH</b>	Range <b>32 EAST</b>	County <b>LEA</b>		

Actual Footage Location of Well:  
**1310** feet from the **NORTH** line and **1330** feet from the **EAST** line  
 Ground Level Elev. \_\_\_\_\_ Producing Formation **Queen** Pool **Caprock Queen** Dedicated Acreage: **40** Acres

1. Outline the acreage dedicated to the subject well by colored pencil or hachure marks on the plat below.
2. If more than one lease is dedicated to the well, outline each and identify the ownership thereof (both as to working interest and royalty).
3. If more than one lease of different ownership is dedicated to the well, have the interests of all owners been consolidated by communitization, unitization, force-pooling, etc?

☒ Yes ☐ No If answer is "yes," type of consolidation Unitized

If answer is "no," list the owners and tract descriptions which have actually been consolidated. (Use reverse side of this form if necessary.) \_\_\_\_\_

No allowable will be assigned to the well until all interests have been consolidated (by communitization, unitization, forced-pooling, or otherwise) or until a non-standard unit, eliminating such interests, has been approved by the Commission.

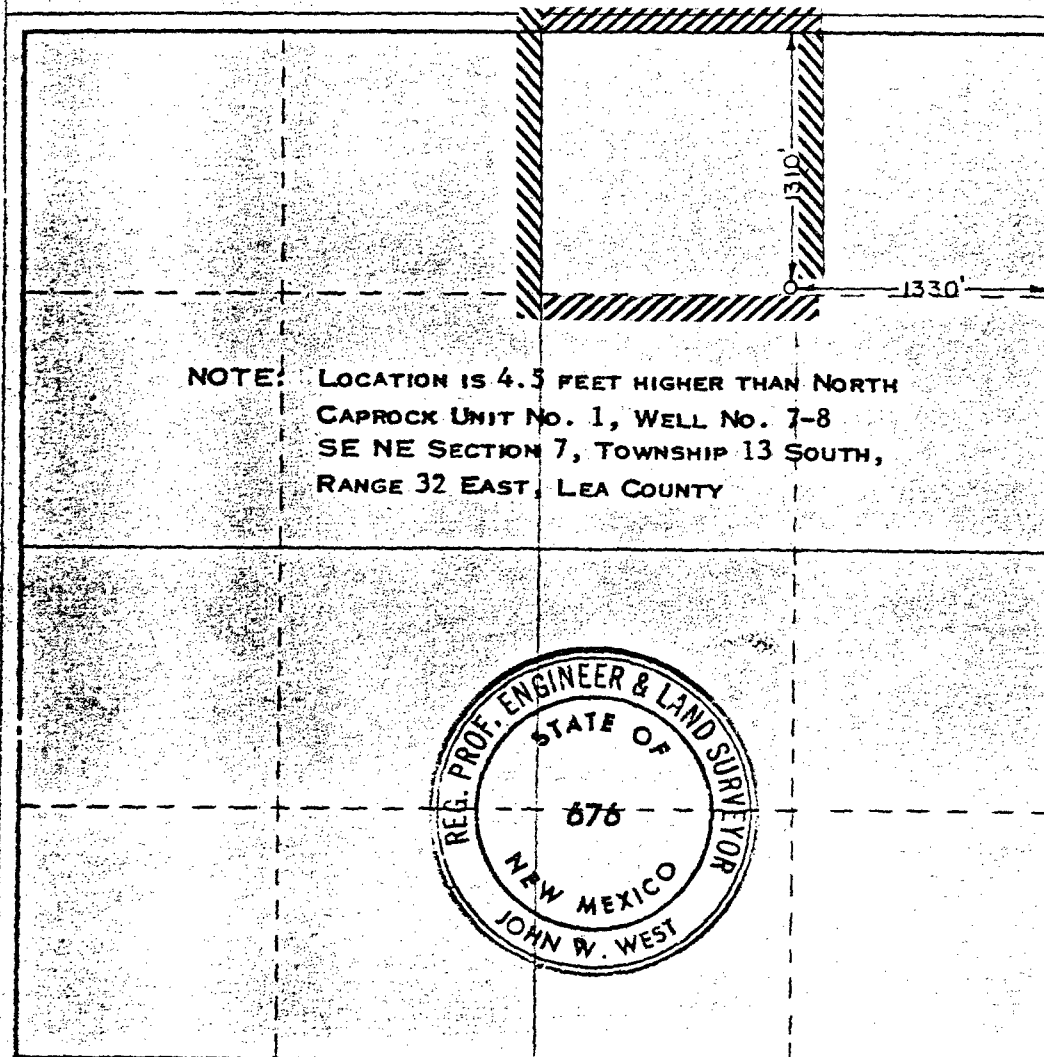

CERTIFICATION

I hereby certify that the information contained herein is true and complete to the best of my knowledge and belief.

Name: Harry F. Schuman  
 Position: President  
 Company: Thunderbird Oil Corp.  
 Date: Nov. 20, 1973

I hereby certify that the well location shown on this plat was plotted from field notes of actual surveys made by me or under my supervision, and that the same is true and correct to the best of my knowledge and belief.

Date Surveyed: OCTOBER 27, 1973  
 Registered Professional Engineer and/or Land Surveyor

John W. West  
 Certificate No. 676

