

8/14/03 DATE IN	9/4/03 SUSPENSE	ENGINEER <del>XXXX</del>	LOGGED IN LSR	SWD TYPE	PLR0322650890 APP NO.
--------------------	--------------------	--------------------------	---------------	-------------	--------------------------

ABOVE THIS LINE FOR DIVISION USE ONLY

## NEW MEXICO OIL CONSERVATION DIVISION

- Engineering Bureau -

1220 South St. Francis Drive, Santa Fe, NM 87505



RECEIVED

AUG 14 2003

## ADMINISTRATIVE APPLICATION CHECKLIST

OIL CONSERVATION  
DIVISION

THIS CHECKLIST IS MANDATORY FOR ALL ADMINISTRATIVE APPLICATIONS FOR EXCEPTIONS TO DIVISION RULES AND REGULATIONS WHICH REQUIRE PROCESSING AT THE DIVISION LEVEL IN SANTA FE

### Application Acronyms:

[NSL-Non-Standard Location] [NSP-Non-Standard Proration Unit] [SD-Simultaneous Dedication]  
[DHC-Downhole Commingling] [CTB-Lease Commingling] [PLC-Pool/Lease Commingling]  
[PC-Pool Commingling] [OLS - Off-Lease Storage] [OLM-Off-Lease Measurement]  
[WFX-Waterflood Expansion] [PMX-Pressure Maintenance Expansion]  
[SWD-Salt Water Disposal] [IPI-Injection Pressure Increase]  
[EOR-Qualified Enhanced Oil Recovery Certification] [PPR-Positive Production Response]

### [1] TYPE OF APPLICATION - Check Those Which Apply for [A]

[A] Location - Spacing Unit - Simultaneous Dedication  
☐ NSL ☐ NSP ☐ SD

Check One Only for [B] or [C]

[B] Commingling - Storage - Measurement  
☐ DHC ☐ CTB ☐ PLC ☐ PC ☐ OLS ☐ OLM

[C] Injection - Disposal - Pressure Increase - Enhanced Oil Recovery  
☐ WFX ☐ PMX ☒ SWD ☐ IPI ☐ EOR ☐ PPR

[D] Other: Specify \_\_\_\_\_

### [2] NOTIFICATION REQUIRED TO: - Check Those Which Apply, or Does Not Apply

- [A] ☐ Working, Royalty or Overriding Royalty Interest Owners
- [B] ☒ Offset Operators, Leaseholders or Surface Owner
- [C] ☒ Application is One Which Requires Published Legal Notice
- [D] ☐ Notification and/or Concurrent Approval by BLM or SLO  
U.S. Bureau of Land Management - Commissioner of Public Lands, State Land Office
- [E] ☒ For all of the above, Proof of Notification or Publication is Attached, and/or,
- [F] ☐ Waivers are Attached

### [3] SUBMIT ACCURATE AND COMPLETE INFORMATION REQUIRED TO PROCESS THE TYPE OF APPLICATION INDICATED ABOVE.

[4] **CERTIFICATION:** I hereby certify that the information submitted with this application for administrative approval is accurate and complete to the best of my knowledge. I also understand that no action will be taken on this application until the required information and notifications are submitted to the Division.

Note: Statement must be completed by an individual with managerial and/or supervisor/ capacity.

James Bruce  
Print or Type Name

Signature

Attorney for Applicant

Title

jamesbruc@aol.com

e-mail Address

Date

8/13/03

**JAMES BRUCE**  
ATTORNEY AT LAW

POST OFFICE BOX 1056  
SANTA FE, NEW MEXICO 87504

369 MONTEZUMA, NO. 213  
SANTA FE, NEW MEXICO 87501

(505) 982-2043 (PHONE)  
(505) 982-2151 (FAX)

jamesbruc@aol.com

August 13, 2003

David Catanach  
Oil Conservation Division  
1220 South St. Francis Drive  
Santa Fe, New Mexico 87505

Re: Amendment of Division Administrative Order No. SWD-452

<u>Well:</u>	Corrall Draw Well No. 2
<u>Location:</u>	1580 feet FSL & 1980 feet FWL of Section 22, Township 25 South, Range 29 East, N.M.P.M., Eddy County, New Mexico

Dear Mr. Catanach

The above order approved injection in the interval from 3180-3333 feet subsurface. Pogo Producing Company requests an amendment of the order to add injection perforations at 4063-4164 feet subsurface. Attached as Exhibits A-C are (a) a copy of Order SWD-432,<sup>1</sup> (b) a current wellbore sketch, and (c) a proposed wellbore sketch. The maximum injection pressure will remain 636 psi.

Attached as Exhibit D is a land plat. The surface owner is the United States. There are no Delaware wells within a half-mile of the injection well, but applicant has notified the offset lessees, EOG Resources, Inc. and Devon Energy Production Company, L.P. (successor to Concho Resources, Inc.). A copy of the notice letter is attached as Exhibit E.

A notice regarding this application is being published. A copy of the notice is attached as Exhibit F. The proof of publication will be filed when received.

---

<sup>1</sup>Applicant is in the process of filing documents changing the well's operator from Bettis, Boyle & Stovall to Pogo Producing Company.

Very truly yours,

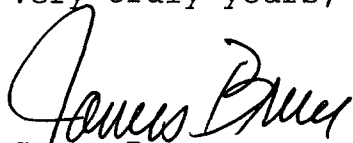
A handwritten signature in cursive script, appearing to read "James Bruce". The signature is written in dark ink and is positioned above the printed name.

James Bruce

Attorney for Pogo Producing Company

BRUCE KING  
GOVERNOR

STATE OF NEW MEXICO

## ENERGY, MINERALS AND NATURAL RESOURCES DEPARTMENT

OIL CONSERVATION DIVISION

POST OFFICE BOX 2088  
STATE LAND OFFICE BUILDING  
SANTA FE, NEW MEXICO 87504  
(505) 827-5800

ADMINISTRATIVE ORDER NO. SWD-452

## APPLICATION OF BETTIS, BOYLE AND STOVALL

ADMINISTRATIVE ORDER  
OF THE OIL CONSERVATION DIVISION

Under the provisions of Rule 701(B), Bettis, Boyle and Stovall made application to the New Mexico Oil Conservation Division on November 6, 1991, for permission to complete for salt water disposal its Corral Draw Well No. 2 located in Unit K of Section 22, Township 25 South, Range 29 East, NMPM, Eddy County, New Mexico.

THE DIVISION DIRECTOR FINDS THAT:

- (1) The application has been duly filed under the provisions of Rule 701(B) of the Division Rules and Regulations.
- (2) Satisfactory information has been provided that all offset operators and surface owners have been duly notified; and
- (3) The applicant has presented satisfactory evidence that all requirements prescribed in Rule 701 will be met.
- (4) No objections have been received within the waiting period prescribed by said rule.

IT IS THEREFORE ORDERED THAT:

- (1) The applicant herein, Bettis, Boyle and Stovall is hereby authorized to complete its Corral Draw Well No. 2 located in Unit K of Section 22, Township 25 South, Range 29 East, NMPM, Eddy County, New Mexico, in such a manner as to permit the injection of salt water for disposal purposes into the Delaware formation at approximately 3180 feet to approximately 3333 feet through 2 3/8 inch plastic lined tubing set in a packer located at approximately 3100 feet.



*Administrative Order No. SWD-452  
Bettis, Boyle and Stovall  
December 13, 1991  
Page 2*

**IT IS FURTHER ORDERED THAT:**

The operator shall take all steps necessary to ensure that the injected water enters only the proposed injection interval and is not permitted to escape to other formations or onto the surface.

Prior to commencing injection operations into the well, the casing shall be pressure tested from the surface to the packer setting depth to assure the integrity of said casing.

The casing-tubing annulus shall be loaded with an inert fluid and equipped with a pressure gauge at the surface or left open to the atmosphere to facilitate detection of leakage in the casing, tubing or packer.

The injection well or system shall be equipped with a pressure limiting device which will limit the wellhead pressure on the injection well to no more than 636 psi.

The Director of the Division may authorize an increase in injection pressure upon a proper showing by the operator of said well that such higher pressure will not result in migration of the injected fluid from the Delaware formation. Such proper showing shall consist of a valid step-rate test run in accordance with and acceptable to this office.

The operator shall notify the supervisor of the Artesia district office of the Division of the date and time of the installation of disposal equipment and of the mechanical integrity test so that the same may be inspected and witnessed.

The operator shall immediately notify the supervisor of the Artesia district office of the Division of the failure of the tubing, casing or packer in said well and shall take such steps as may be timely and necessary to correct such failure or leakage.

*Administrative Order No. SWD-452  
Bettis, Boyle and Stovall  
December 13, 1991  
Page 3*

**PROVIDED FURTHER THAT,** jurisdiction of this cause is hereby retained by the Division for such further order or orders as may be deemed necessary or convenient for the prevention of waste and/or protection of correlative rights; upon failure of the operator to conduct operations in a manner which will ensure the protection of fresh water or in a manner inconsistent with the requirements set forth in this order, the Division may, after notice and hearing, terminate the injection authority granted herein.

The operator shall submit monthly reports of the disposal operations in accordance with Rule 706 and 1120 of the Division Rules and Regulations.

Approved at Santa Fe, New Mexico, on this 13th day of December, 1991.

STATE OF NEW MEXICO  
OIL CONSERVATION DIVISION

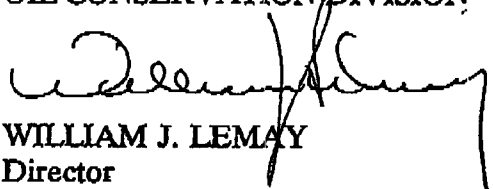
  
WILLIAM J. LEMAY  
Director

SEAL

cc: Oil Conservation Division - Artesia

jc\

**CURRENT**  
**Wellbore Schematic**

30015-21425  
 1580 FSL 1980 FWL

CORRAL DRAW # 002 SWD

Wellbore ID #: 4826

Printed: 8/4/2003

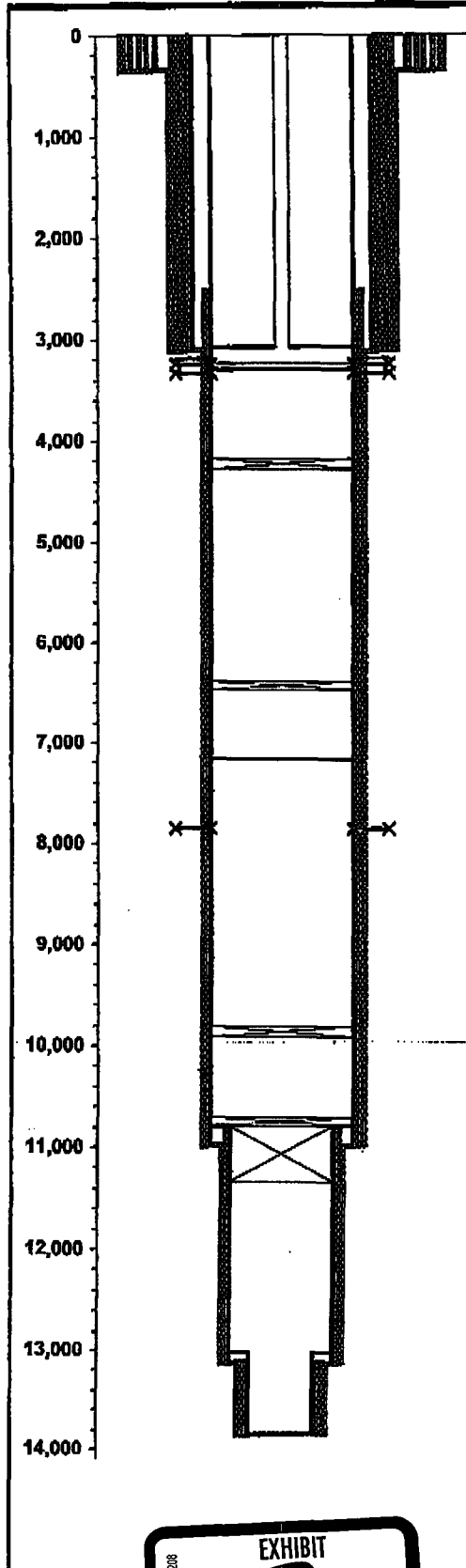

1580' FSL & 1980' FWL	GL Elev:	3,062.00
Sec, Blk, Sur (Lbr, Lge, Sur) or (Sec, Twn, Rng): 22, 25S, 29E	Fill Depth:	
County, State: EDDY, NM	PBTD:	3,220.00
Aux ID (API, etc.):	TD:	13,840.00
KB = 16; DF = : All Depths Cor To: KB	BOP:	

**Hole Size**

Diameter	Top At	Btm At	Date Drilled
17.5000	0.00	350.00	1/1/1975
12.2500	350.00	3,097.00	1/1/1975
8.7500	3,097.00	10,982.00	1/1/1975
6.5000	10,982.00	13,128.00	1/1/1975
4.7500	13,128.00	13,840.00	1/1/1975

**Surface Casing**

Date Ran: 1/1/1975

Description	#	Diameter	Weight	Grade	Length	Top At	Btm At
Casing		13.3750			334.00	16.00	350.00

**Intermediate Casing**

Date Ran: 1/1/1975

Description	#	Diameter	Weight	Grade	Length	Top At	Btm At
Casing		9.6250	36.00		3,081.00	16.00	3,097.00

**Production Casing String 1**

Date Ran: 1/1/1975

Description	#	Diameter	Weight	Grade	Length	Top At	Btm At
Casing		7.6250	33.70		10,966.00	16.00	10,982.00
33.70#, 29.70#, & 28.4#							

**Production Casing String 2**

Date Ran: 1/1/1975

Description	#	Diameter	Weight	Grade	Length	Top At	Btm At
Casing		5.5000	20.00		2,330.00	10,798.00	13,128.00

**Production Casing String 3**

Date Ran: 1/1/1975

Description	#	Diameter	Weight	Grade	Length	Top At	Btm At
Casing		3.5000	9.20		824.00	13,016.00	13,840.00

**Cement**

# Sx	Class	Weight	I D	O D	Top At	Btm At	TOC Per
400			13.375	17.500	0.00	350.00	Est
1800			9.625	12.250	0.00	3,097.00	Est
925			7.625	8.750	7,900.00	10,982.00	Est
400			5.500	6.500	10,782.00	13,128.00	Circ
80			3.500	4.750	13,100.00	13,840.00	Est
925			7.625	8.750	2,500.00	7,850.00	Est

**SQ HOLES @ 7850'****Perforations**

Top	Bottom	Status	Opened	Closed	# / Ft	Ttl #	Open Hole?
3,180.00	3,189.00	A					
3,230.00	3,242.00	PA					
3,313.00	3,333.00	PA					
7,850.00	7,851.00	PA					

**SQ HOLES****Wellbore Plugs and Junk**

Top	Bottom	Type	Diameter	Solid	Date
3,220.00	3,223.00	CIBP	7.625	Yes	1/1/1975
3,275.00	3,300.00	Cmt	7.625	Yes	1/1/1975
3,300.00	3,303.00	CIBP	7.625	Yes	1/1/1975
4,175.00	4,275.00	Cmt	7.625	Yes	1/1/1975
6,380.00	6,480.00	Cmt	7.625	Yes	1/1/1975
7,160.00	7,180.00	Cmt	7.625	Yes	1/1/1975
7,180.00	7,183.00	CIBP	7.625	Yes	1/1/1975
9,800.00	9,803.00	CIBP	7.625	Yes	1/1/1975

Description	#	Diameter	Weight	Grade	Length	Top At	Btm At
Tbg Sect 1		2.3750			3,054.00	16.00	3,070.00
Packer		7.6250			5.00	3,070.00	3,075.00
<b>TENSION PKR</b>							



## PROPOSED

Wellbore Schematic

CORRAL DRAW # 002 SWD

Wellbore ID #: 4826

Printed: 8/4/2003

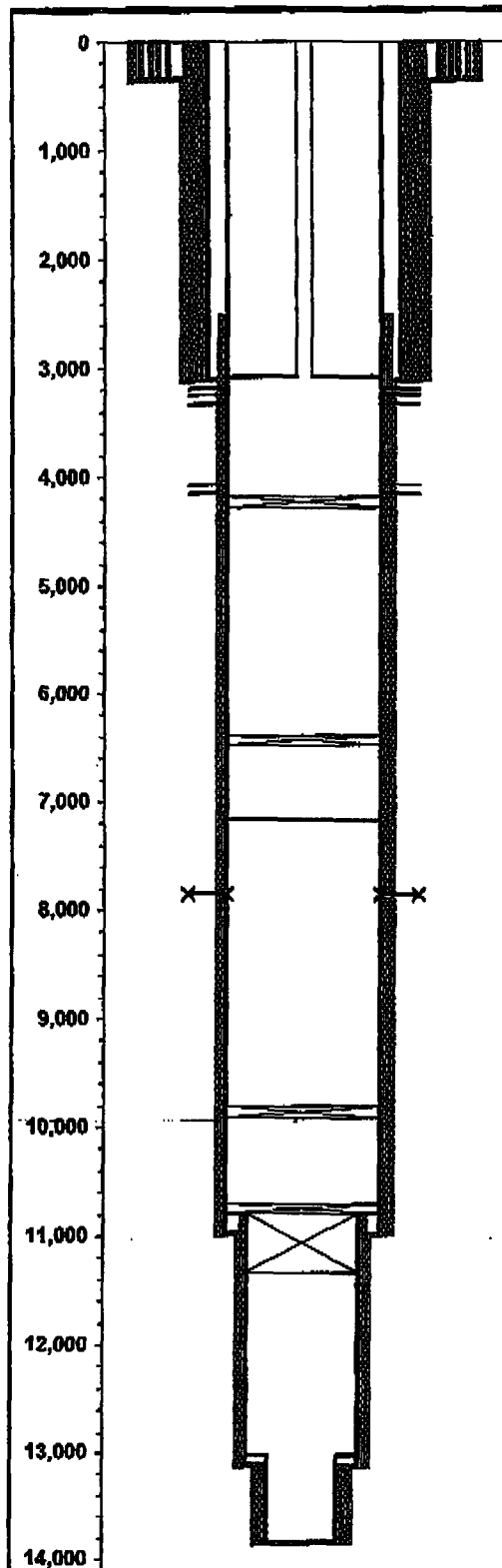

1580' FSL & 1980' FWL	GL Elev:	3,062.00
Sec, Blk, Sur (Lbr, Lge, Sur) or (Sec, Twn, Rng): 22, 25S, 29E	Fill Depth:	
County, State: EDDY, NM	PBTD:	3,220.00
Aux ID (API, etc.):	TD:	13,840.00
KB = 16; DF = ; All Depths Corr To: KB	BOP:	

## Hole Size

Diameter	Top At	Btm At	Date Drilled
17.5000	0.00	350.00	1/1/1975
12.2500	350.00	3,097.00	1/1/1975
8.7500	3,097.00	10,982.00	1/1/1975
6.5000	10,982.00	13,128.00	1/1/1975
4.7500	13,128.00	13,840.00	1/1/1975

## Surface Casing

Date Ran: 1/1/1975

Description	#	Diameter	Weight	Grade	Length	Top At	Btm At
Casing		13.3750			334.00	16.00	350.00

## Intermediate Casing

Date Ran: 1/1/1975

Description	#	Diameter	Weight	Grade	Length	Top At	Btm At
Casing		9.6250	36.00		3,081.00	16.00	3,097.00

## Production Casing String 1

Date Ran: 1/1/1975

Description	#	Diameter	Weight	Grade	Length	Top At	Btm At
Casing		7.6250	33.70		10,966.00	16.00	10,982.00

33.70#, 29.70#, &amp; 26.4#

## Production Casing String 2

Date Ran: 1/1/1975

Description	#	Diameter	Weight	Grade	Length	Top At	Btm At
Casing		6.5000	20.00		2,330.00	10,798.00	13,128.00

## Production Casing String 3

Date Ran: 1/1/1975

Description	#	Diameter	Weight	Grade	Length	Top At	Btm At
Casing		3.5000	9.20		824.00	13,016.00	13,840.00

## Cement

# Sx	Glass	Weight	ID	OD	Top At	Btm At	TOC Per
400			13.375	17.500	0.00	350.00	Est
1800			9.625	12.250	0.00	3,097.00	Est
925			7.625	8.750	7,900.00	10,982.00	Est
400			5.500	6.500	10,782.00	13,128.00	Circ
80			3.500	4.750	13,100.00	13,840.00	Est
925			7.625	8.750	2,500.00	7,850.00	Est

SQ HOLES @ 7850'

## Perforations

Top	Bottom	Status	Opened	Closed	# / Ft	Tft #	Open Hole?
3,180.00	3,189.00	A					
3,230.00	3,242.00	A					
3,313.00	3,333.00	A					
4,068.00	4,132.00	A			2		
4,142.00	4,164.00	A			2		
7,850.00	7,851.00	PA					

SQ HOLES

## Wellbore Plugs and Junk

Top	Bottom	Type	Diameter	Solid	Date
4,175.00	4,275.00	Cmt	7.625	Yes	1/1/1975
6,380.00	6,480.00	Cmt	7.625	Yes	1/1/1975
7,160.00	7,180.00	Cmt	7.625	Yes	1/1/1975
7,180.00	7,183.00	CIBP	7.625	Yes	1/1/1975
9,800.00	9,803.00	CIBP	7.625	Yes	1/1/1975
9,803.00	9,920.00	Cmt	7.625	Yes	1/1/1975

EXHIBIT

C

Description	#	Diameter	Weight	Grade	Length	Top At	Btm At
Tbg Sect 1		2.3750			3,054.00	16.00	3,070.00
<b>PLASTIC COATED</b>							
Packer		7.6250			5.00	3,070.00	3,075.00
<b>TENSION PKR</b>							

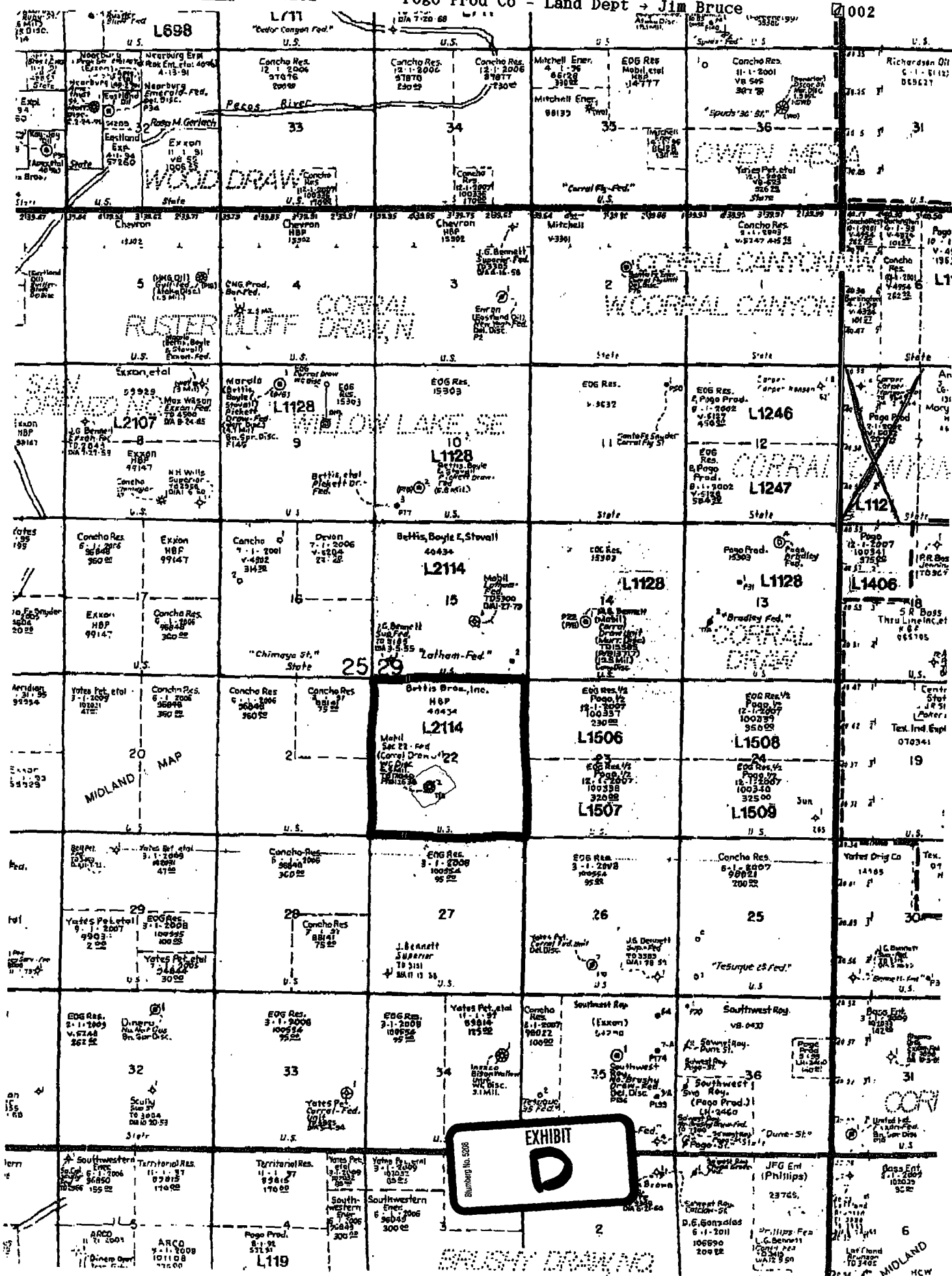

**JAMES BRUCE**  
ATTORNEY AT LAW

POST OFFICE BOX 1056  
SANTA FE, NEW MEXICO 87504

369 MONTEZUMA, NO. 213  
SANTA FE, NEW MEXICO 87501

(505) 982-2043 (PHONE)  
(505) 982-2151 (FAX)

jamesbruc@aol.com

August 13, 2003

**CERTIFIED MAIL - RETURN RECEIPT REQUESTED**

Bureau of Land Management  
2909 West Second Street  
Roswell, New Mexico 88201

EOG Resources, Inc.  
P.O. Box 2267  
Midland, Texas 79702

Devon Energy Production Company, L.P.  
P.O. Box 108838  
Oklahoma City, Oklahoma 73101-8838

Attention: Ken Gray  
Land Department

Ladies and Gentlemen:

Enclosed is a copy of an application to amend Administrative Order No. SWD-432, filed with the New Mexico Oil Conservation Division by Pogo Producing Company, regarding a well in Section 22, Township 25 South, Range 29 East, NMPM, Eddy County, New Mexico. If you object to the application, you must file a written objection with the Division no later than Tuesday, September 2, 2003 (1220 South St. Francis Drive, Santa Fe, New Mexico 87505).

Very truly yours,

  
James Bruce

Attorney for Pogo Producing Company



NOTICE

To whom it may concern: Pogo Producing Company has filed an application with the New Mexico Oil Conservation Division to add perforations to the Corral Draw Well No. 2 saltwater disposal well, located 1580 feet from the south line and 1980 feet from the west line of Section 22, Township 25 South, Range 29 East, NMPM, Eddy County, New Mexico. The well is currently injecting into the Delaware formation in the interval from 3180-3333 feet subsurface, and applicant proposes to add injection perforations in the Delaware formation at 4068-4164 feet subsurface. The maximum injection rate is 600 BWPD, and the maximum injection pressure is 636 psi. Applicant's contact person is Thomas R. Land, Pogo Producing Company, P.O. Box 10340, Midland, Texas 79702, (432) 685-8100. Any interested person must file an objection or request for hearing with the Division within 15 days of publication of this notice. The Division's address is 1220 South St. Francis Drive, Santa Fe, New Mexico 87505.

