

Rec'd
7/28/03
Suspend
7/28/03

DRC

ZPI

PDL 0320948579

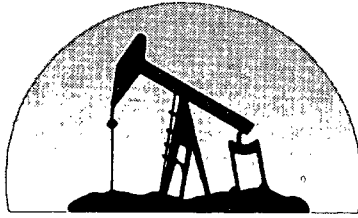

RECEIVED

JUL 28 2003

OIL CONSERVATION
DIVISION

marbob
energy corporation

July 25, 2003

207

New Mexico Oil Conservation Division
1220 S. St. Francis Drive
Santa Fe, NM 87505-4000

Attention: Mr. David Catanach

Re: Injection Pressure Increase Request
Burch Keely Cooperative Waterflood Project
Eddy County

Dear Mr. Catanach:

Marbob Energy respectfully requests a blanket, unit-wide 900 psig maximum surface injection pressure limit for any and all Grayburg/San Andres water injection wells within the Burch Keely Unit boundary. We already have approval for a 900 psi injection pressure limit for the 32 injection wells that were active as of September 14, 1993, per the attached letter signed by Mr. LeMay.

There are currently ten newer water injection wells, averaging 823 psig injection pressure, that are exceeding the average allowable injection pressure of 603 psig (based on 0.2 psi/ft to the top perforation). Field experience shows that injection pressures approaching 900 psig are required in order to inject reasonable water volumes. The ten newer injectors average 120 BHPD (0.083 BPM) each at 823 psig average injection pressure. Step-rate tests run for injection pressure increase requests in the past support the application of the 900 psig pressure limit.

Attached for your information is the letter from Mr. LeMay dated September 14, 1993, and a map of the Burch Keely Unit showing the older wells with 900 psig pressure limits and newer wells with lower pressure

New Mexico Oil Conservation Division
July 25, 2003

Page 2

limits. Some of the past records related to this request are Case No. 2640/Order No. R-2324, Case No. 8418/Order No. R-7900, Order No. WFX-555, Case File 7572, Order No. WFX-682 and Order No. WFX-743. Please call me if you have any questions.

Sincerely,

A handwritten signature in black ink, appearing to read "Brian Collins", written in a cursive style.

Brian Collins

BC/dlw
attachments

xc: Mr. Tim Gum - OCD Artesia
BKU Water Injection File



STATE OF NEW MEXICO
ENERGY, MINERALS AND NATURAL RESOURCES DEPARTMENT

OIL CONSERVATION DIVISION



BRUCE KING
GOVERNOR

ANITA LOCKWOOD
CABINET SECRETARY

September 14, 1993

POST OFFICE BOX 2088
STATE LAND OFFICE BUILDING
SANTA FE, NEW MEXICO 87504
(505) 827-5800

Marbob Energy Corporation
P.O. Box 217
Artesia, NM 88210

RECEIVED

OCT - 4 1993

C. C. D.

Attention: Raye Miller

**RE: Injection Pressure Increase Burch-Keely Cooperative Waterflood Project,
Eddy County, New Mexico**

Dear Mr. Miller:

Reference is made to your request to increase the surface injection pressure on all wells in the above-referenced Burch-Keely Cooperative Waterflood Project. This request is based on step rate tests conducted previously in this project. The results of the tests have been reviewed by my staff and we feel a field-wide increase in injection pressure is justified at this time.

You are therefore authorized to increase the surface injection pressure to a maximum of 900 psi each, on thirty-two authorized injection wells in the subject waterflood project in Eddy County, New Mexico.

The Division Director may rescind this injection pressure increase if it becomes apparent that the injected water is not being confined to the injection zone or is endangering any fresh water aquifers.

Sincerely,

William J. LeMay
Director

WJL/BES/amg

cc: Oil Conservation Division - Artesia
File: WFX-555
Case File 8418
D. Catanach

RBDMS New Mexico 2002

Edit

Inquiry

Switchboard

User Queries

Refresh Data



API Well Number :

OGRID Name :

Property Name : BURCH KEELY

Pool Name :

County :

Well Type : I

Well Status :

Permit :

19

Section

Land

17

Township

Dir.

30

Range

Dir.

Company



Inspections

Well Master

Scheduler

Mech. Int. Tests

Well History

Data Action

Idle Detail

Env. Inspections

Admin Permits

Idle Management

Incidents

Hearing Orders

R

U

G

Pool Master

Compliance

N

I

S

Surf Facilities

Close all
Functions
and Exit
RBDMS

Clear Criteria Fields

Make Group Inspection
or 'Sync' Table from
Displayed Records

Apply Selection Criteria

API WELL #	Well	Well #	CT	S	Cc	Surf	UL	Sec	Tw	N/S	Rng	W/E	Feet	NS	ft	EW	Order No
30-015-04204-00-00	BU	095	I	E	F	J	19	17	S	30	E	2310	S	2310	E	WFX-682	
30-015-04209-00-00	BU	097	I	E	F	I	19	17	S	30	E	2615	S	295	E	CTB-309	
30-015-04210-00-00	BU	104	I	E	F	N	19	17	S	30	E	330	S	650	W	CTB-309	
30-015-04211-00-00	BU	105	I	E	F	4	19	17	S	30	E	660	S	660	W	R-7900	
30-015-04212-00-00	BU	102	I	E	F	O	19	17	S	30	E	990	S	2310	E	CTB-309	
30-015-04213-00-00	BU	100	I	E	F	P	19	17	S	30	E	660	S	660	E	WFX-682	
30-015-20794-00-00	BU	101	I	E	F	O	19	17	S	30	E	330	S	1650	E	CTB-309	
30-015-21366-00-00	BU	098	I	E	F	I	19	17	S	30	E	1650	S	760	E	CTB-309	
30-015-22092-00-00	BU	094	I	E	F	K	19	17	S	30	E	1650	S	2970	E	CTB-309	

RBDMS New Mexico 2002

[Edit](#)
[Inquiry](#)
[Switchboard](#)
[User Queries](#)
[Refresh Data](#)

API Well Number :

OGRID Name :

Property Name : BURCH KEELY

Pool Name :

County :

Well Type : I

Well Status :

Permit :

30 Section

Land

17 Township

Dir.

30 Range

Dir.

Company



Inspections

Well Master

Scheduler

Mech. Int. Tests

Well History

Data Action

Idle Detail

Env. Inspections

Admin Permits

Idle Management

Incidents

Hearing Orders

R

U

N



G

I

S

Pool Master

Surf Facilities

Close all
Functions
and Exit
RBDMS

Clear Criteria Fields

Make Group Inspection
or 'Sync' Table from
Displayed Records



Apply Selection Criteria

API WELL #	Well	Well #	CT	S	Cc	Surf	UL	Sec	Twp	N/S	Rng	W/E	Feet	NS	Ft	EW	Order_No
30-015-04388-00-00	BU	142	I	E	F		1	30	17	S	30	E	660	N	660	W	CTB-309
30-015-04389-00-00	BU	144	I	E	F		C	30	17	S	30	E	660	N	1980	W	R-7900
30-015-04394-00-00	BU	146	I	E	F		B	30	17	S	30	E	660	N	1980	E	CTB-309

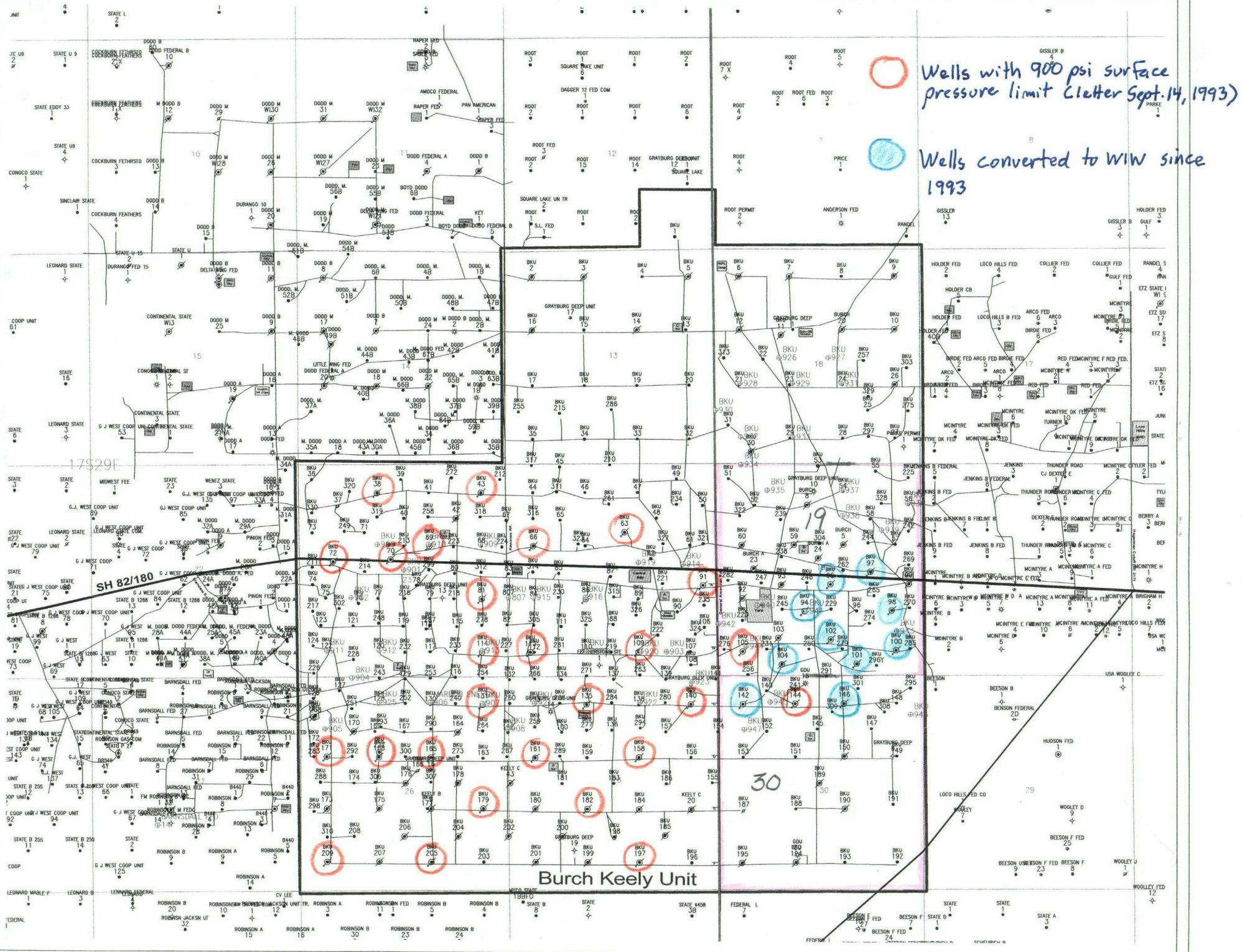

Wells with 900 psi surface pressure limit (letter Sept. 14, 1993)

Wells converted to WIW since 1993

Burch Keely Unit