

TEXAS AMERICAN OIL CORPORATION

300 WEST WALL, SUITE 1012 MIDLAND, TEXAS 79701 915-683-4811

September 16, 1975

Mr. A. L. Porter, Jr.
Secretary-Director
New Mexico Oil Conservation Commission
Post Office Box 2088
Santa Fe, New Mexico 87501

RECEIVED

SEP 17 1975

O. C. C.
ARTESIA, OFFICE

Re: Rule 104-Well Spacing
Etz State, Well No. 26,
1625' FSL & 2630' FWL,
Section 16, T-17-S, R-30-E,
Eddy County, New Mexico
Grayburg Jackson Field

Dear Mr. Porter:

Application to drill the above named unorthodox location, based on topographical conditions, is submitted for your approval.

Waiver of objection from the only offset operator, C. E. Larue and B. N. Muncy, Jr., is attached.

Yours very truly,

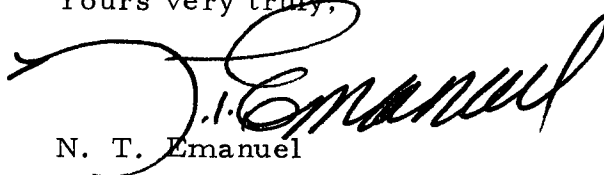
N. T. Emanuel

cc

Attachment

NSL

Approval Recommended
9/18/75 W.A. Gressett

**NEW MEXICO OIL CONSERVATION COMMISSION
WELL LOCATION AND ACREAGE DEDICATION PLAT**

Form C-102
Supersedes C-128
Effective 1-1-65

All distances must be from the outer boundaries of the Section.

Operator TEXAS AMERICAN OIL CORPORATION			Lease Etz-State		Well No. 26
Unit Letter K	Section 16	Township 17 South	Range 30 East	County Eddy	
Actual Footage Location of Well: 1625 feet from the south line and 2630 feet from the west line					
Ground Level Elev. 3674.6	Producing Formation Q-GB	Pool Grayburg Jackson		Dedicated Acreage 40	

1. Outline the acreage dedicated to the subject well by colored pencil or hatchure marks on the plat below.
2. If more than one lease is dedicated to the well, outline each and identify the ownership thereof (both as to working interest and royalty).
3. If more than one lease of different ownership is dedicated to the well, have the interests of all owners been consolidated by communitization, unitization, force-pooling, etc?

☐ Yes ☐ No If answer is "yes" type of consolidation _____

If answer is "no," list the owners and tract descriptions which have actually been consolidated (Use reverse side of this form if necessary.) _____

No allowable will be assigned to the well until all interests have been consolidated (by communitization, unitization, forced-pooling, or otherwise) or until a non-standard unit, eliminating such interests, has been approved by the Commission.

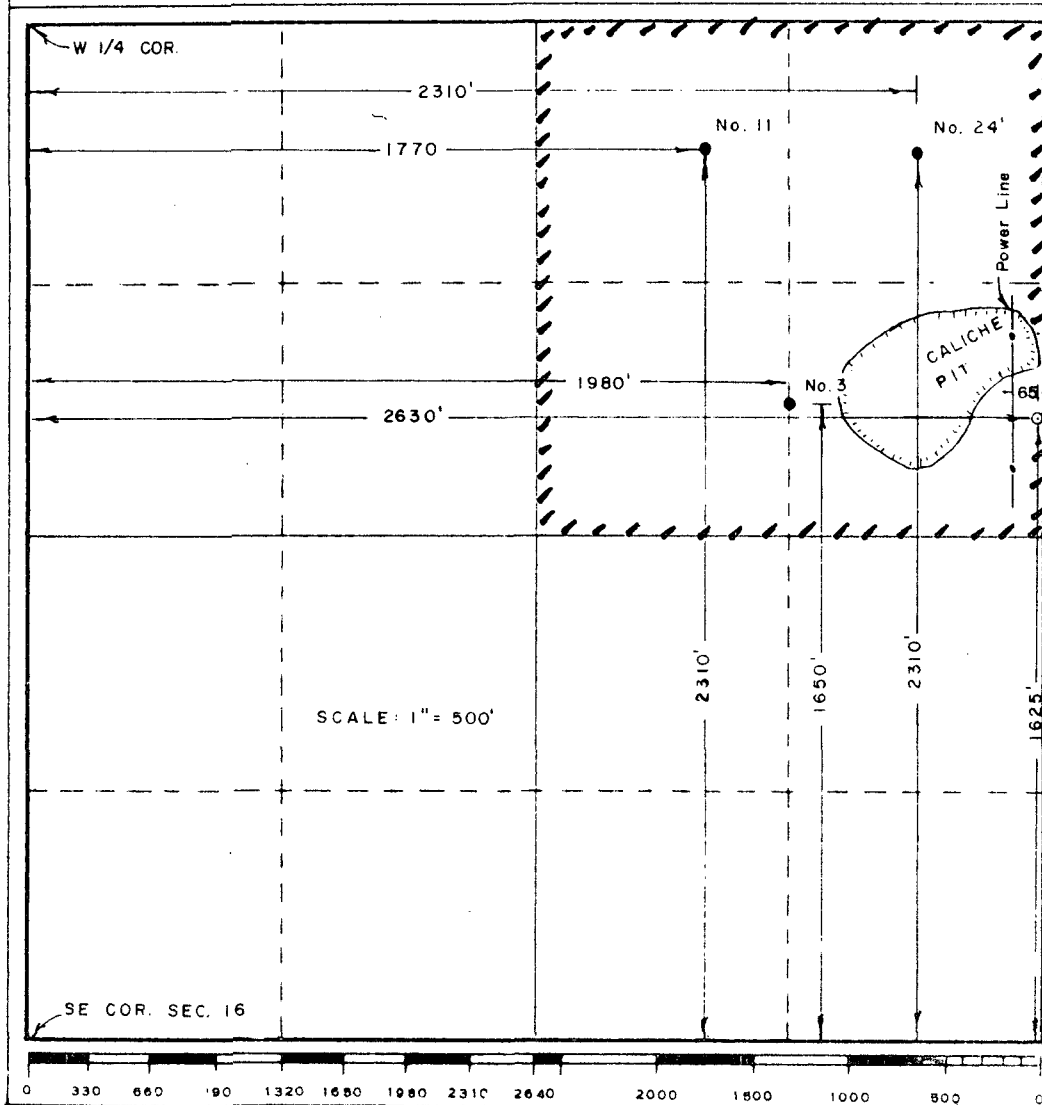

CERTIFICATION

I hereby certify that the information contained herein is true and complete to the best of my knowledge and belief.

[Signature]

 Engineer
 Texas American Oil Corp
 Date **9-17-75**

I hereby certify that the information shown on this plat was plotted from notes of actual surveys made under my supervision and that the same is true and correct to the best of my knowledge and belief.

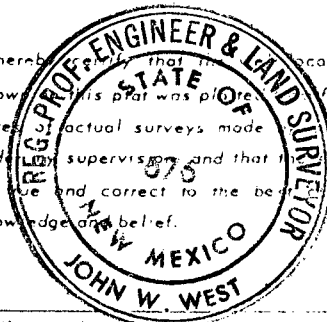

Date Surveyed

Sept. 16, 1975

Registered Professional Engineer and Land Surveyor

SE 1/4 COR

Certification No.

676

WAIVER OF OBJECTION

We have received notice of Texas American Oil Corporation's plans to drill Etz State, Well No. 26, 1625' FSL & 2630' FWL, Section 16, T-17-S, R-30-E, Grayburg Jackson Field, Eddy County, New Mexico.

This well location is unorthodox due to topographical conditions.

C. E. Larue and B. N. Muncy, Jr., an operator of the southwest offset proration unit, has no objection to this well.

C. E. Larue & B. N. Muncy, Jr.
September 17, 1975

Texas American Oil
Corp. Leases.
Outlined in Yellow.

