

**BASS ENTERPRISES PRODUCTION CO.**

Vaughn Building

P. O. BOX 2760

MIDLAND, TEXAS 79701

March 22, 1977

MAR 28 1977

RE: Rule 104 Exception  
Perry R. Bass  
Big Eddy Unit No. 54  
Eddy County, New Mexico  
File: 400-WF

OIL CONSERVATION COMM.

Oil Conservation Commission  
State of New Mexico  
P.O. Box 2088  
Santa Fe, New Mexico 87501

*NSL-837*

*104 F*

ATTN: Mr. J. D. Ramey, Secretary-Director

*See upon receipt*

Gentlemen:

*of approval from Artesia*

Perry R. Bass respectfully requests administrative approval to drill and complete the subject well as an exception to Rule 104 due to topographical conditions. The original location staked 1980' FWL, 1980' FSL, Section 29, T21S, R28E, Eddy County was found to be in the middle of an Indian campground by an archaeological survey conducted in accordance with USGS Notice to Lessees (NTL-6). The survey, conducted through the office of Dr. J. Loring Haskell, Operating Director, Agency of Conservation Archaeology, Eastern New Mexico University, Portales, New Mexico, recommended that the well be moved to the following location so that it will not interfere with the archaeological site (recorded ENM10378):

1980' FWL, 1180' FSL, Section 29, T21S, R28E  
Eddy County, New Mexico

Perry R. Bass owns all offset lease acreage affected by the proposed location with the exception of the NW 1/4 of the NW 1/4 of Section 32 which is open fee land. We are presently attempting to purchase an oil and gas lease for this 40-acre tract.

We are submitting, in triplicate, a completed Application for Permit to Drill, a plat showing offset lease ownership, and a copy of the archaeological survey. Since the well is on federal lands, it is subject to approval by the United States Geological Survey.

Very truly yours,

*J. E. Pullig*

J. E. Pullig  
Division Production Manager

*Will dedicate  
S/2 Sec 29*

JEP:DLS/gp  
Attachments

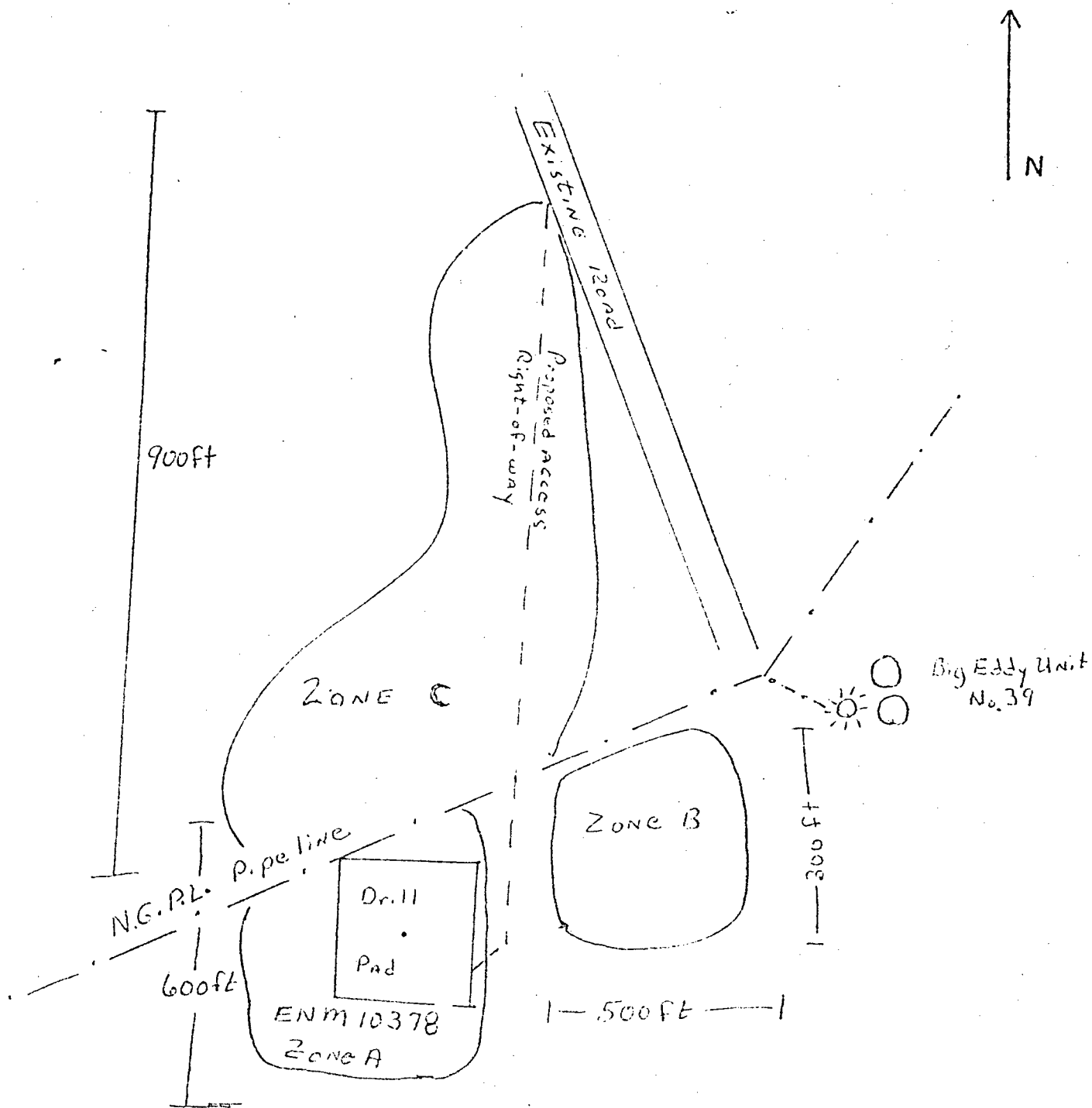

Figure 1

UNITED STATES  
DEPARTMENT OF THE INTERIOR  
GEOLOGICAL SURVEY

SUBMIT IN TRIPLICATE\*

(Other instructions on  
reverse side)Form approved.  
Budget Bureau No. 42-R1425.

MAR 28 1977

## APPLICATION FOR PERMIT TO DRILL, DEEPEN, OR PLUG BACK

## 1a. TYPE OF WORK

DRILL ☒DEEPEN ☐PLUG BACK ☐

## b. TYPE OF WELL

OIL  
WELL ☐GAS  
WELL ☒

OTHER

SINGLE  
ZONE ☒MULTIPLE  
ZONE ☐

## 2. NAME OF OPERATOR

PERRY R. BASS

## 3. ADDRESS OF OPERATOR

P.O. Box 2760 Midland, Texas 79702

## 4. LOCATION OF WELL (Report location clearly and in accordance with any State requirements.)\*

At surface

1180 FSL &amp; 1980 FWL, Sec 29, T21S, R28E

Eddy County, New Mexico

At proposed prod. zone

as above

## 14. DISTANCE IN MILES AND DIRECTION FROM NEAREST TOWN OR POST OFFICE\*

8 miles northeast of Carlsbad, New Mexico

## 15. DISTANCE FROM PROPOSED\*

LOCATION TO NEAREST  
PROPERTY OR LEASE LINE, FT.  
(Also to nearest drlg. unit line, if any)

## 16. NO. OF ACRES IN LEASE

17. NO. OF ACRES ASSIGNED  
TO THIS WELL

320

18. DISTANCE FROM PROPOSED LOCATION\*  
TO NEAREST WELL, DRILLING, COMPLETED,  
OR APPLIED FOR, ON THIS LEASE, FT.

## 19. PROPOSED DEPTH

12,300

## 20. ROTARY OR CABLE TOOLS

rotary

## 21. ELEVATIONS (Show whether DF, RT, GR, etc.)

GL 3177

## 22. APPROX. DATE WORK WILL START\*

May 1, 1977

## 23.

## PROPOSED CASING AND CEMENTING PROGRAM

SIZE OF HOLE	SIZE OF CASING	WEIGHT PER FOOT	SETTING DEPTH	QUANTITY OF CEMENT
20"	16"	55#	40'	Ready mix
15"	11-3/4"	42#	500'	350 sx
11"	8-5/8"	24#	3200'	1650 sx
7-7/8"	5-1/2"	17 & 20#	12300'	550 sx

Drilling procedure, BOPE diagram, anticipated formation tops & surface use plans are attached.

IN ABOVE SPACE DESCRIBE PROPOSED PROGRAM: If proposal is to deepen or plug back, give data on present productive zone and proposed new productive zone. If proposal is to drill or deepen directionally, give pertinent data on subsurface locations and measured and true vertical depths. Give blowout preventer program, if any.

## 24.

SIGNED

*Don T. Schilling*

TITLE

Drilling Engineer

DATE

March 22, 1977

(This space for Federal or State office use)

PERMIT NO.

APPROVAL DATE

APPROVED BY

TITLE

DATE

CONDITIONS OF APPROVAL, IF ANY:

\*See Instructions On Reverse Side

Archaeological Clearance Report  
for  
Bass Enterprises Inc.

by

Eduardo A. Mimiaga

Submitted by

Dr. J. Loring Haskell  
Operations Director and  
Principal Investigator  
Agency of Conservation Archaeology  
Eastern New Mexico University  
Portales, New Mexico 88130

14 March 1977

## INTRODUCTION

An archaeological reconnaissance was recently completed by the Agency of Conservation Archaeology, Eastern New Mexico University, Portales, New Mexico, for Bass Enterprises, Incorporated in Eddy County, New Mexico. The area will be impacted by the construction of an access road and drill pad. This project was completed under Federal Antiquities Permit No. 77-NM-021.

The project was administered by Mr. Collins, representative for Bass Enterprises Incorporated, and by Dr. J. Loring Haskell, Operations Director and Principal Investigator, Agency of Conservation Archaeology, Eastern New Mexico University, Portales, New Mexico.

The reconnaissance was completed by Eduardo A. Mimiaga on 14 March 1977.

## SURVEY TECHNIQUE

The archaeologist accomplished the survey by walking a zigzag pattern the width of the proposed access right-of-way and a series of zigzag parallel transects across the proposed drill pad.

### Big Eddy Unit No. 54

## LOCATION

The proposed access road is 12 ft wide and extends 1500 ft to a proposed 400 ft x 400 ft drill pad located in the E 1/2 of the W 1/2 of Section 29, T21S, R28E, NMPM, Eddy County, New Mexico.

Map Reference: U.S.G.S. 15 minute series, Carlsbad Quadrangle.

## TERRAIN

Local terrain consists of an undulating plain with deep aeolian sand deposition interspersed with shallow blowouts.

## FLORISTICS

The plant community is dominated by Prosopis juliflora, Larrea tridentata, Muhlenbergia porterii, Muhlenbergia torreyi, Bouteloua gracilis, Tridens pulchellus, and Gutierrezia sarothrae.

## CULTURAL RESOURCES

One archaeological site was recorded during this reconnaissance, viz.

ENM 10378.

### ENM 10378

Ownership: Bureau of Land Management

Location: SW 1/4 NE 1/4 SE 1/4, Section 29, T21S, R28E, NMPM, Eddy County,  
New Mexico

Type of Site: Special Activity Zone

### Description:

ENM 10378 is located in a series of shallow blowouts and consists of burned rock, lithics, ground stone, and ceramics. This site has been subdivided into three distinct areas, viz. zones A, B, and C. Zone A is distinguishable by its heavy concentration of artifacts, burned rock, and an area of scattered ashly sand deposits.

Zone C is an area which lacks the artifact density of Zones A and B. This area consists of many isolated hearths with small concentrations of burned rock, ceramics, ground stone, and lithics. A small biface was found in Zone C close to the junction of the proposed access right-of-way and the existing road.

Zone B consists of burned rock concentrations with low artifact density. These low concentrations seldom resemble hearths and appear to be generalized scatters. There is an area approximately 30 to 40 m wide between Zones A and B which contains no artifacts and only an occasional burned rock.

RECOMMENDATIONS

ACA recommends relocation of the proposed drilling pad and access road in order to avoid impacting ENM 10378.

**NEW MEXICO OIL CONSERVATION COMMISSION  
WELL LOCATION AND ACREAGE DEDICATION PLAT**

Form C-102  
Supersedes C-128  
Effective 1-1-65

All distances must be from the outer boundaries of the Section.

Operator <b>PERRY R. BASS</b>			Lease <b>BIG EDDY UNIT</b>			Well No. <b>54</b>		
Unit Letter <b>N</b>	Section <b>29</b>	Township <b>21 South</b>	Range <b>28 East</b>	County <b>Eddy</b>				
Actual Footage Location of Well:								
<b>1180</b>		feet from the <b>South</b>		line and <b>1980</b>		feet from the <b>West</b>		line
Ground Level Elev. <b>3177.2</b>		Producing Formation		Pool			Dedicated Acreage:  Acres	

1. Outline the acreage dedicated to the subject well by colored pencil or hachure marks on the plat below.
2. If more than one lease is dedicated to the well, outline each and identify the ownership thereof (both as to working interest and royalty).
3. If more than one lease of different ownership is dedicated to the well, have the interests of all owners been consolidated by communitization, unitization, force-pooling, etc?

☐ Yes    ☐ No    If answer is "yes," type of consolidation \_\_\_\_\_

If answer is "no," list the owners and tract descriptions which have actually been consolidated. (Use reverse side of this form if necessary.) \_\_\_\_\_

No allowable will be assigned to the well until all interests have been consolidated (by communitization, unitization, forced-pooling, or otherwise) or until a non-standard unit, eliminating such interests, has been approved by the Commission.

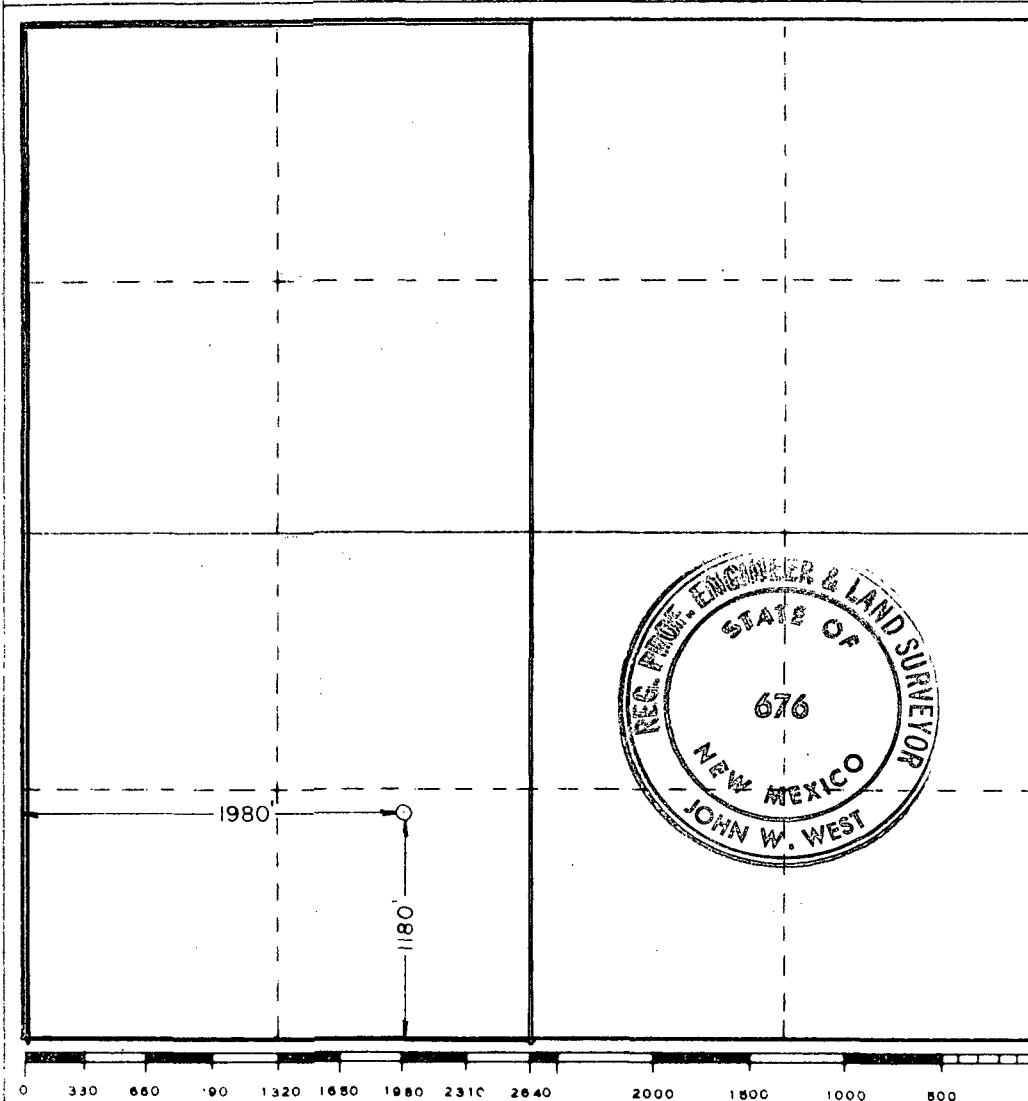

**CERTIFICATION**

I hereby certify that the information contained herein is true and complete to the best of my knowledge and belief.

Name \_\_\_\_\_

Position \_\_\_\_\_

Company \_\_\_\_\_

Date \_\_\_\_\_

I hereby certify that the well location shown on this plat was plotted from field notes of actual surveys made by me or under my supervision, and that the same is true and correct to the best of my knowledge and belief.

Date Surveyed

**March 16, 1977**

Registered Professional Engineer  
and/or Land Surveyor

*John W. West*  
Certificate No. **676**



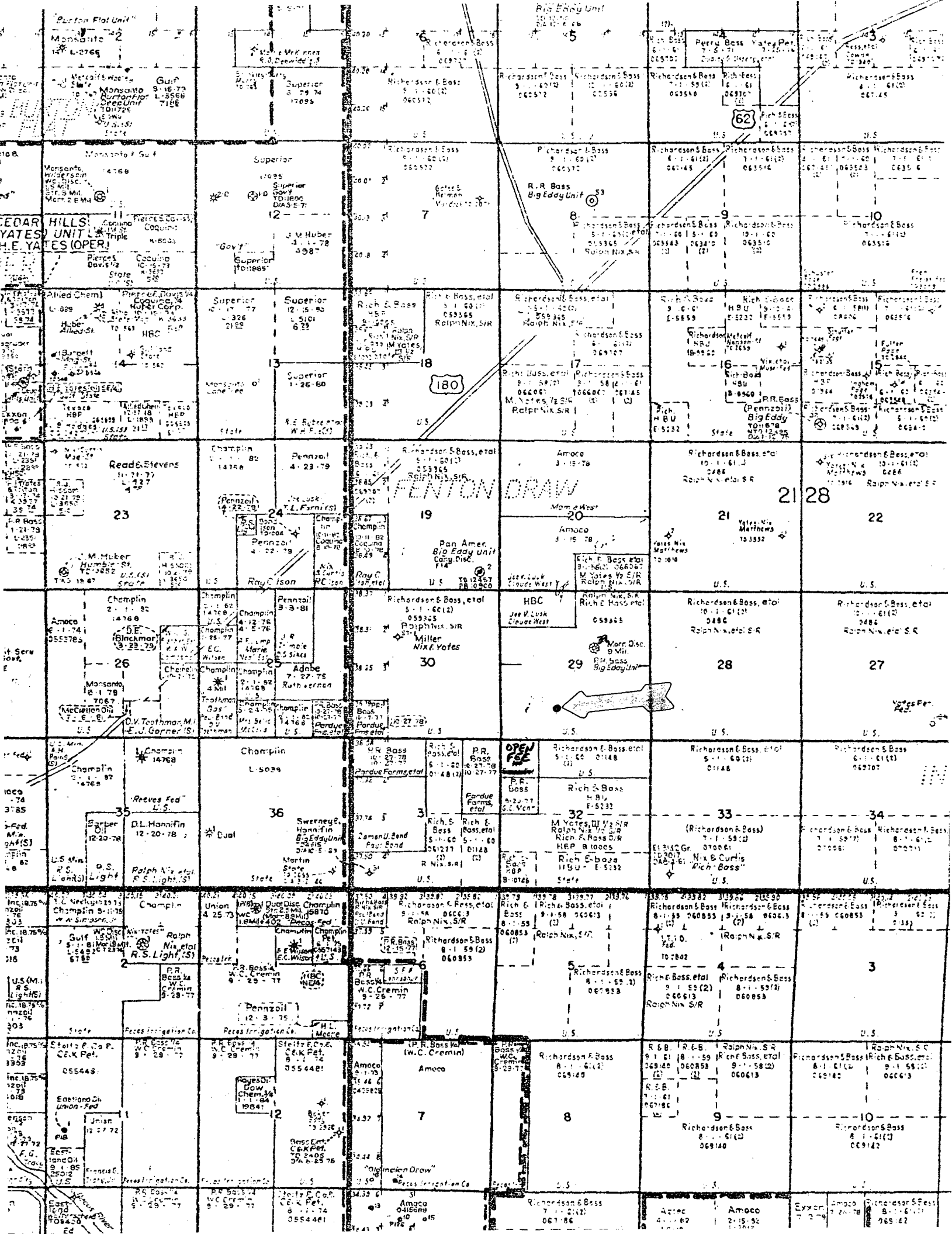

OIL CONSERVATION COMMISSION  
Artesia DISTRICT

OIL CONSERVATION COMMISSION  
BOX 2088  
SANTA FE, NEW MEXICO

DATE 4-20-77

RE: Proposed MC \_\_\_\_\_  
Proposed DHC \_\_\_\_\_  
Proposed NSL X \_\_\_\_\_  
Proposed SWD \_\_\_\_\_  
Proposed WFX \_\_\_\_\_  
Proposed PMX \_\_\_\_\_

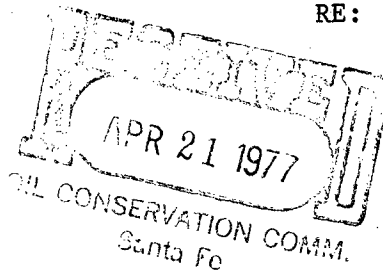

Gentlemen:

I have examined the application dated 3-22-77  
for the Perry R Bass Big Edly Unit # 54 A-29-21-28  
Operator Lease and Well No. Unit, S-T-R

and my recommendations are as follows:

Approval

Yours very truly,

W. A. Gressett