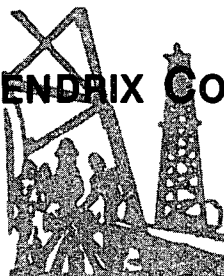

22428795

AMEND NSL

8/30/00

JOHN H. HENDRIX CORPORATION

MAILING ADDRESS
P.O. BOX 3040
MIDLAND, TX 79702-3040

(915) 684-6631
FAX (915) 684-7317
110 N. MARIENFELD, SUITE 400
MIDLAND, TEXAS 79701-4412

August 3, 2000

AUG 10 2000

Ms. Lori Wrotenbery, Director
Oil Conservation Division
New Mexico Department of
Energy, Minerals and Natural Resources
2040 South Pacheco Street
Santa Fe, New Mexico 87505

RE: Application of John H. Hendrix
Corporation for Administrative
Approval of an Unorthodox Oil
Well Recompletion Location for
its Drinkard Estate Well No. 6
at a Point of 1807' from the North
Line and 1542' from the East
Line, Section 25, T22S, R37E,
NMPM, Lea County, New Mexico

Dear Ms. Wrotenbery:

John H. Hendrix Corporation hereby seeks administrative approval of an unorthodox oil well location for its Drinkard Estate Well No. 6 to be recompleted in the Blinbry Oil and Gas Pool at a location 1807 feet from the North line and 1542 feet from the East line of Section 25, Township 22 South, Range 37 East, NMPM, Lea County, New Mexico.

The Drinkard Estate Well No. 6 was spudded May 19, 1977 and drilled at a non-standard well location. A non-standard location was requested due to the location of the Drinkard Estate Well No. 5 being at a standard location and to avoid existing buried pipelines, battery, and road. John H. Hendrix Corporation owns and operates the affected 40 acre tract to the East. All mineral and working interests are the same in both 40 acre tracts. This non-standard location was approved June 6, 1977 under Administrative Order NSL-852. This order was amended May 24, 1990 to cover a South Brunson Drinkard-Abo Pool completion. (Exhibit A)

O.C.D.

-2-

August 3, 2000

The South Brunson Drinkard-Abo Pool will be properly plugged back and said well recompleted in the Blinebry Oil and Gas Pool. Well No. 5 cannot be used because it is temporarily abandoned due to a high pressure water flow.

Exhibit B is a map which shows the well on the Drinkard Estate Lease.

Exhibit C is the original survey plat.

Exhibit D is a current C-102.

Exhibit E lists the offset operator affected by this application. A copy of this application has been sent to the affected party by certified mail - return receipt requested advising them that if they have an objection to this application, it must be filed in writing with the Division's Santa Fe Office within twenty days from the date this notice was sent.

Exhibit F is a plat indicating offset operator.

Exhibit G is a copy of the returned certified mail-return receipt.

Your attention to this application is greatly appreciated.

Yours very truly,

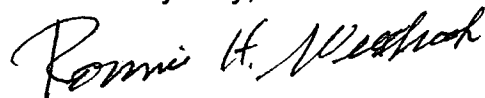

Ronnie H. Westbrook
Vice President

RHW/ah

Enclosures



STATE OF NEW MEXICO
ENERGY, MINERALS AND NATURAL RESOURCES DEPARTMENT
OIL CONSERVATION DIVISION

EXHIBIT A

GARREY CARRUTHERS
GOVERNOR

POST OFFICE BOX 2088
STATE LAND OFFICE BUILDING
SANTA FE, NEW MEXICO 87504
(505) 827-5800

May 24, 1990

**John H. Hendrix Corporation
223 West Wall Street
Suite 525
Midland, TX 79701**

Attention: Ronnie H. Westbrook, Vice-President

Amended Administrative Order NSL-852

Dear Mr. Westbrook:

Reference is made to your application dated April 5, 1990 for a non-standard South Brunson Drinkard Abo oil well location for your Drinkard Estate Well No. 6 which was drilled in May, 1977 and completed in the Wantz Granite Wash Pool at a previously approved non-standard oil well location (Division Administrative Order NSL-852, dated June 6, 1977) 1807 feet from the North line and 1542 feet from the East line (Unit G) of Section 25, Township 22 South, Range 37 East, NMPM, Lea County, New Mexico.

It is my understanding that the Wantz Granite Wash zone will be properly plugged back and said well will be recompleted to the South Brunson Drinkard-Abo Pool, which pursuant to General Rule 104.C.I., is unorthodox also.

By the authority granted me under the provisions of General Rule 104.F.I., the above-described unorthodox oil well location is hereby approved.

Further, the NW/4 NE/4 of said Section 25 shall be dedicated to said well forming a standard 40-acre oil spacing and proration unit for said pool.

Said original Division Order NSL-852, shall be placed in abeyance until further notice.

Sincerely,

**William J. LeMay
Director**

WJL/MES/ag

cc: Oil Conservation Division - Hobbs

**S/2 NE/4 Section 25
T-22-S, R-37-E
Lea County, New Mexico**

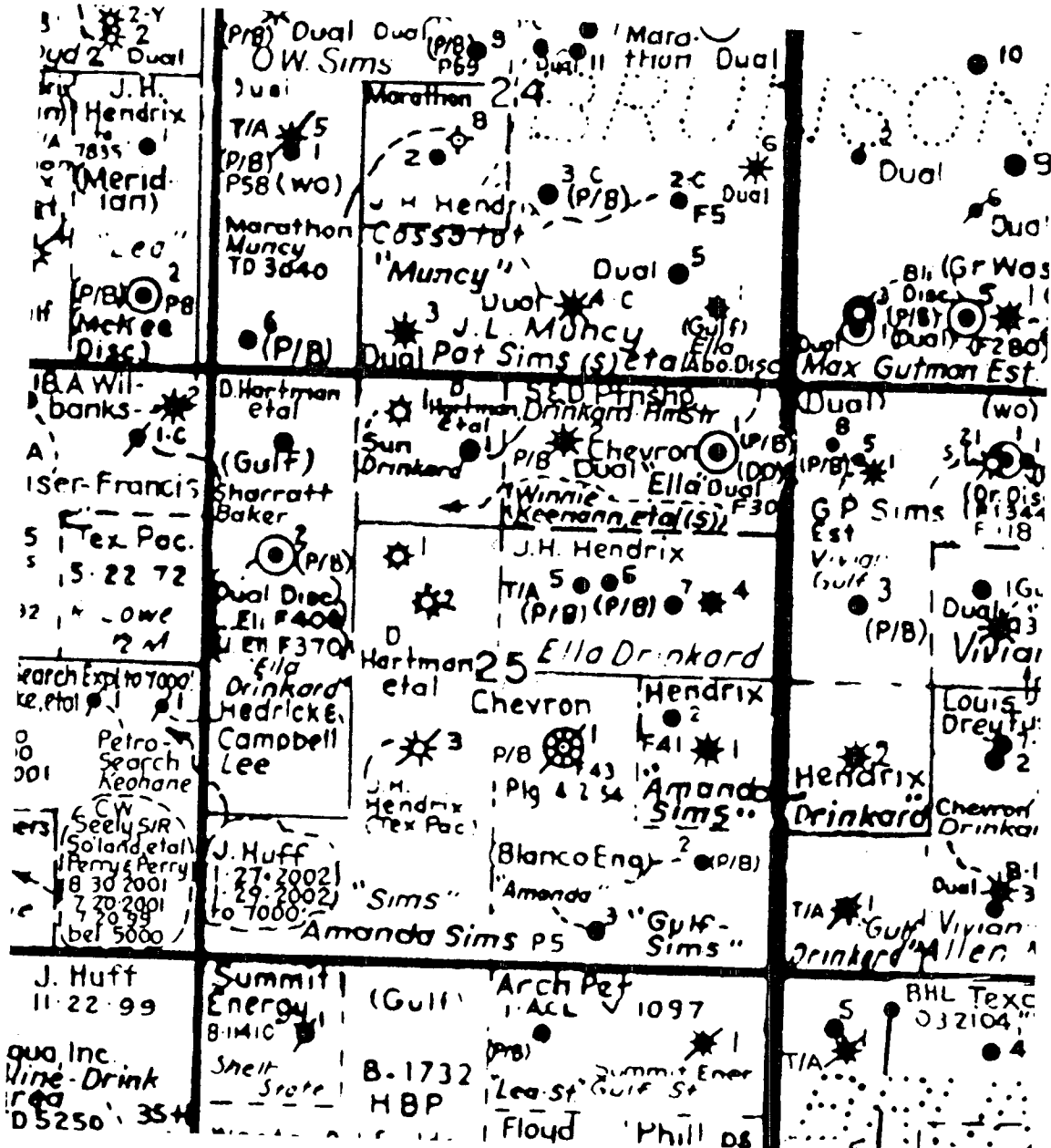

NEW MEXICO OIL CONSERVATION COMMISSION
WELL LOCATION AND ACREAGE DEDICATION PLAT

EXHIBIT C

All distances must be from the outer boundaries of the Section

Operator Summit Energy Inc.			Lease Drinkard Estate		Well No. 6
Unit Letter G	Section 25	Township 22 South	Range 37 East	County Lea	
Actual Footage Location of Well: 1807 feet from the North line and 1542 feet from the East line					
Ground Level Elev. 3316.7	Producing Formation GRANITE WASH		Pool WANTZ GRANITE WASH		Dedicated Acreage 40 Acres

1. Outline the acreage dedicated to the subject well by colored pencil or hatchure marks on the plat below.
2. If more than one lease is dedicated to the well, outline each and identify the ownership thereof (both as to working interest and royalty).
3. If more than one lease of different ownership is dedicated to the well, have the interests of all owners been consolidated by communitization, unitization, force-pooling, etc?

☐ Yes ☐ No If answer is "yes," type of consolidation _____

If answer is "no," list the owners and tract descriptions which have actually been consolidated. (Use reverse side of this form if necessary.) _____

No allowable will be assigned to the well until all interests have been consolidated (by communitization, unitization, forced-pooling, or otherwise) or until a non-standard unit, eliminating such interests, has been approved by the Commission.

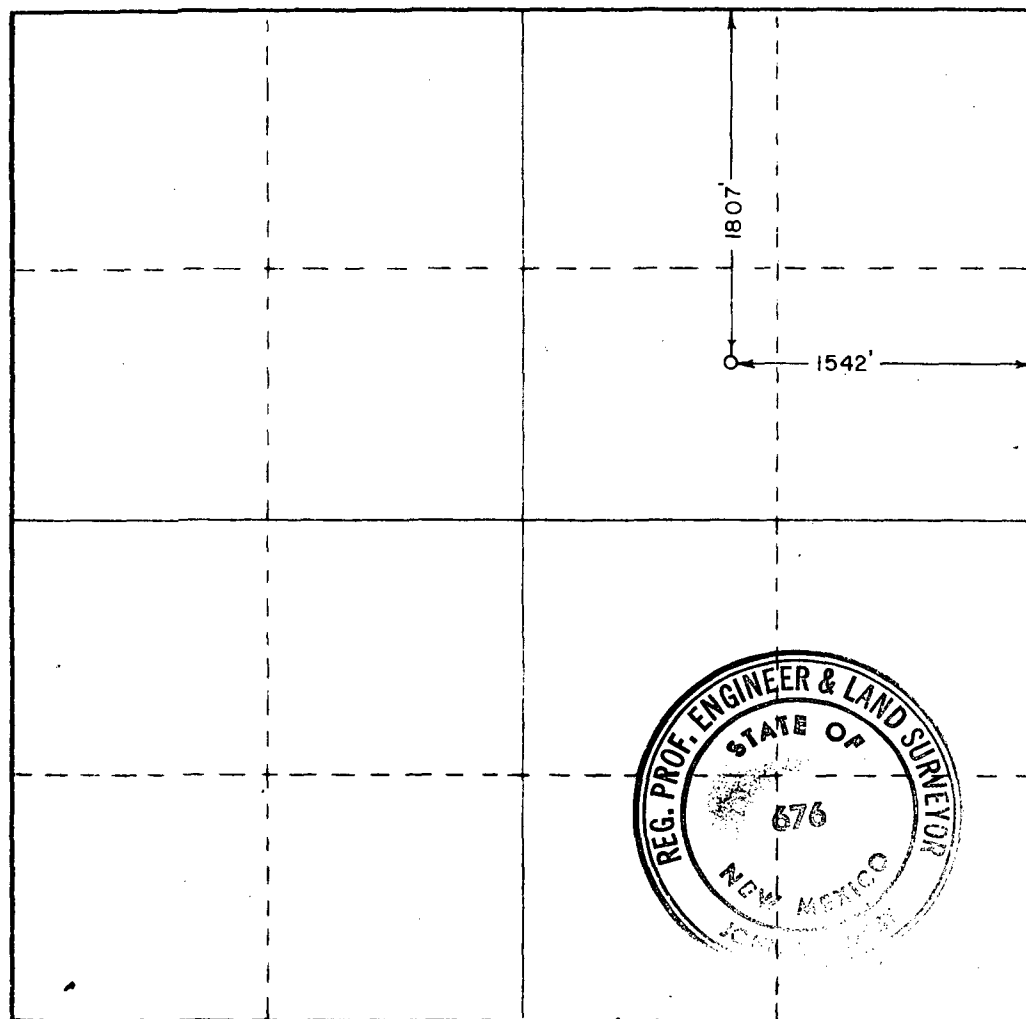

CERTIFICATION

I hereby certify that the information contained herein is true and complete to the best of my knowledge and belief

Name *Paul Switzer*

Position
Vice President-Production

Company
Summit Energy, Inc.

Date
May 16, 1977

I hereby certify that the well location shown on this plat was plotted from field notes of actual surveys made by me or under my supervision, and that the same is true and correct to the best of my knowledge and belief.

Date Surveyed
May 13, 1977

Registered Professional Engineer and/or Land Surveyor

John W. West

Certificate No. **676**

0 330 660 990 1320 1650 1980 2310 2640 2970 3300 3630 3960 4290 4620 4950 5280 5610 5940 6270 6600

EXHIBIT D

District I
PO Box 1980, Hobbs, NM 88241-1980

District II
811 South First, Artesia, NM 88210

District III
1000 Rio Brazos Rd., Aztec, NM 87410

District IV
2040 South Pacheco, Santa Fe, NM 87505

State of New Mexico
Energy, Minerals & Natural Resources Department

OIL CONSERVATION DIVISION
2040 South Pacheco
Santa Fe, NM 87505

Form C-102
Revised October 18, 1994
Instructions on back
Submit to Appropriate District Office
State Lease - 4 Copies
Fee Lease - 3 Copies

☐ AMENDED REPORT

WELL LOCATION AND ACREAGE DEDICATION PLAT

¹ API Number 30-025-25544	² Pool Code 06660	³ Pool Name Blinebry Oil & Gas
⁴ Property Code 005163	⁵ Property Name Drinkard Estate	⁶ Well Number 6
⁷ OGRID No. 012024	⁸ Operator Name John H. Hendrix Corporation	⁹ Elevation 3317

¹⁰Surface Location

UL or lot no. G	Section 25	Township 22S	Range 37E	Lot Idn	Feet from the 1807	North/South line North	Feet from the 1542	East/West Line East	County Lea
--------------------	---------------	-----------------	--------------	---------	-----------------------	---------------------------	-----------------------	------------------------	---------------

¹¹Bottom Hole Location If Different From Surface

UL or lot no.	Section	Township	Range	Lot Idn	Feet from the	North/South line	Feet from the	East/West Line	County
¹² Dedicated Acres 40.00	¹³ Joint or Infill	¹⁴ Consolidation Code	¹⁵ Order No.						

**NO ALLOWABLE WILL BE ASSIGNED TO THIS COMPLETION UNTIL ALL INTERESTS HAVE BEEN CONSOLIDATED
OR A NON-STANDARD UNIT HAS BEEN APPROVED BY THE DIVISION**

¹⁶							¹⁷OPERATOR CERTIFICATION <i>I hereby certify that the information contained herein is true and complete to the best of my knowledge and belief</i>  Signature Ronnie H. Westbrook Printed Name Vice President Title 08-04-00 Date
							¹⁸SURVEYOR CERTIFICATION <i>I hereby certify that the well location shown on this plat was plotted from field notes of actual surveys made by me or under my supervision, and that the same is true and correct to the best of my belief.</i> Date of Survey Signature and Seal of Professional Surveyer: Certificate Number

Diagram details: A vertical line with a downward arrow is labeled '1807'. A horizontal line with a leftward arrow is labeled '1542'. The intersection of these lines is marked with a dot and labeled '#6'.

EXHIBIT E

OFFSET OPERATORS

**S/2 NE/4 Section 25
T-22-S, R-37-E
Lea County, New Mexico**

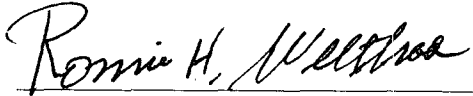
Chevron U.S.A. Production Company
P. O. Box 1150
Midland, TX 79702

EXHIBIT F

DRINKARD ESTATE NO. 6 LEASE

**S/2 NE/4 Section 25
T-22-S, R-37-E
Lea County, New Mexico**

23		24		19	
26	Hendrix	Hendrix	Chevron 25	Chevron 30	
		Hendrix	Hendrix		
			Hendrix	Hendrix	Chevron
			Chevron		
35	36		31		

EXHIBIT G

RETURNED CERTIFIED RECEIPT

SENDER: COMPLETE THIS SECTION		COMPLETE THIS SECTION ON DELIVERY	
<p>■ Complete items 1, 2, and 3. Also complete item 4 if Restricted Delivery is desired.</p> <p>■ Print your name and address on the reverse so that we can return the card to you.</p> <p>■ Attach this card to the back of the mailpiece, or on the front if space permits.</p>		<p>A. Received by (Please Print Clearly) <i>Bob Bell</i> B. Date of Delivery AUG 04 2000</p>	
		<p>C. Signature <i>Bob Bell</i> <input type="checkbox"/> Agent <input type="checkbox"/> Addressee</p>	
<p>1. Article Addressed to:</p> <p>Chevron USA Prod. Co. P. O. Box 1150 Midland, TX 79702</p>		<p>D. Is delivery address different from item 1? <input type="checkbox"/> Yes If YES, enter delivery address below: <input type="checkbox"/> No</p>	
		<p>3. Service Type</p> <p><input checked="" type="checkbox"/> Certified Mail <input type="checkbox"/> Express Mail <input type="checkbox"/> Registered <input type="checkbox"/> Return Receipt for Merchandise <input type="checkbox"/> Insured Mail <input type="checkbox"/> C.O.D.</p>	
<p>2. Article Number (Copy from service label)</p> <p>Z 470 656 234</p>		<p>4. Restricted Delivery? (Extra Fee) <input type="checkbox"/> Yes</p>	

PS Form 3811, July 1999 Domestic Return Receipt 102595-99-M-1789