

MAIL ADDRESS:
P. O. BOX 2188
GRAND JUNCTION, COLORADO
81501

WILLIAM G. WALDECK
ATTORNEY AT LAW
SUITE 900
VALLEY FEDERAL PLAZA
GRAND JUNCTION, COLORADO

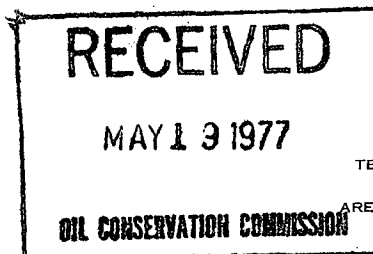

May 16, 1977

New Mexico Oil Conservation Commission
Post Office Box 2088
Santa Fe, New Mexico 87501

Re: Application For Administrative
Approval of Unorthodox Location
For Navajo AA No. 27 Well

Gentlemen:

James P. Woosley and the undersigned, William G. Waldeck (referred to hereinafter as the "Applicants") are the owners of all of the operating and working rights in and under that certain Oil and Gas Lease described as Navajo Tribal Oil and Gas Lease Contract No. 14-20-603-585 effective June 15, 1954, covering the following described lands located in San Juan County, New Mexico:

Township 32 North, Range 17 West:

Section 7:	Fractional
Section 8:	Fractional
Section 17:	All
Section 18:	All
Section 19:	All
Section 20:	All

The North Many Rocks field is situated on the above lease and is operated under the name and style of "Woosley Oil Company."

Efforts have been made by Applicants and their predecessors in interest to water flood the Many Rocks field but such efforts have proved unsuccessful. For this reason, resort, has, of necessity, been had to drilling additional inside wells in order to increase the recovery of oil from the reservoir.

Applicants wish to drill a well in the SE $\frac{1}{4}$ SW $\frac{1}{4}$ of Section 17, Township 32 North, Range 17 West, which will be 2,040 feet East of the West line and 178 feet North of the South line of said Section 17, which well is to be designated as the Navajo "AA" Well No. 27. Applicants own all off-setting acreage to the proposed location and there are no other off-setting operators who would be effected by the location of the well.

NSL-853

104 F

Blue Upon Receipt
of approval from Artec

no offsetting operators

May 16, 1977

Pursuant to Rule 104D of the Rules and Regulations of the Oil Conservation Commission of the State of New Mexico, Applicants respectfully request approval of an unorthodox location for the drilling of a well to be numbered "Navajo AA No. 27." Attached to this Application and made a part thereof is a plat showing the location of the proposed well, a sketch of the terrain in the area of the well which also shows the nearest producer to the proposed location. The reason necessitating the requested unorthodox location is that the topography and terrain is such that it would be economically impractical to drill the subject well at an orthodox location. The well is to be located on a flat mesa which is bounded by steep rocky cliffs to the North, South and East. To the West is situated producing well Navajao AA No. 9 of the Applicants.

Due to the conditions of terrain and topography mentioned above, the Applicants respectfully request that administrative approval of the unorthodox location requested herein be granted. This Application is made in triplicate in accordance with the applicable rules.

Yours very truly,

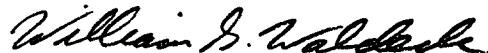

William G. Waldeck

WELL LOCATION AND ACREAGE DEDICATION PLAT

All distances must be from the outer boundaries of the Section.

Operator James P. Wcosley		Lease Navajo "AA"		Well No. 27	
Unit Letter	Section 17	Township 32 N	Range 17 W	County San Juan	
Actual Footage Location of Well: 2040 feet from the West line and 178 feet from the South line.					
Ground Level Elev. 5788.6	Producing Formation Gallup	Pool Rocks, Lower Gallup	North Many Dedicated Acreage: 40 Acres		

1. Outline the acreage dedicated to the subject well by colored pencil or hachure marks on the plat below.
2. If more than one lease is dedicated to the well, outline each and identify the ownership thereof (both as to working interest and royalty),
3. If more than one lease of different ownership is dedicated to the well, have the interests of all owners been consolidated by communitization, unitization, force-pooling, etc.?

() Yes () No If answer is "yes", type of consolidation

If answer is "no," list the owners and tract descriptions which have actually consolidated. (Use reverse side of this form is necessary.)

No allowable will be assigned to the well until all interests have been consolidated (by communitization, unitization, forced-pooling, or otherwise) or until a non standard unit, eliminating such interests, has been approved by the Commission.

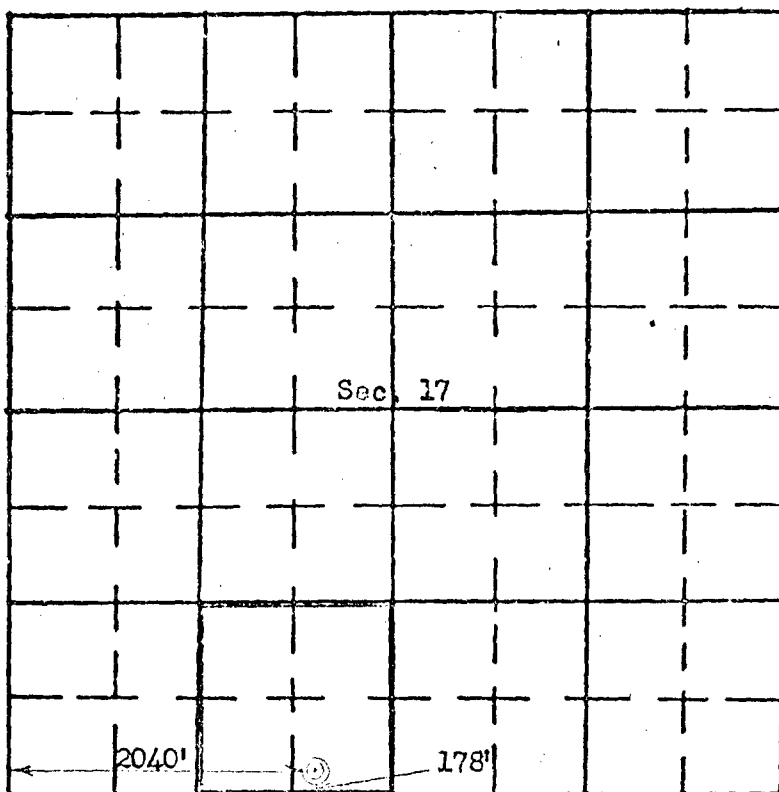

CERTIFICATION

I hereby certify that the information contained herein is true and complete to the best of my knowledge and belief.

Name

Position

Company

Date

I hereby certify that the well location shown on this plat was platted from field notes of actual surveys made by me or under my supervision, and that the same is true and correct to the best of my knowledge and belief.

9-Sept 4, 1974

Date Surveyed

Richard G. Clark

Richard G. Clark, Reg. L.S.
New Mexico # 4452

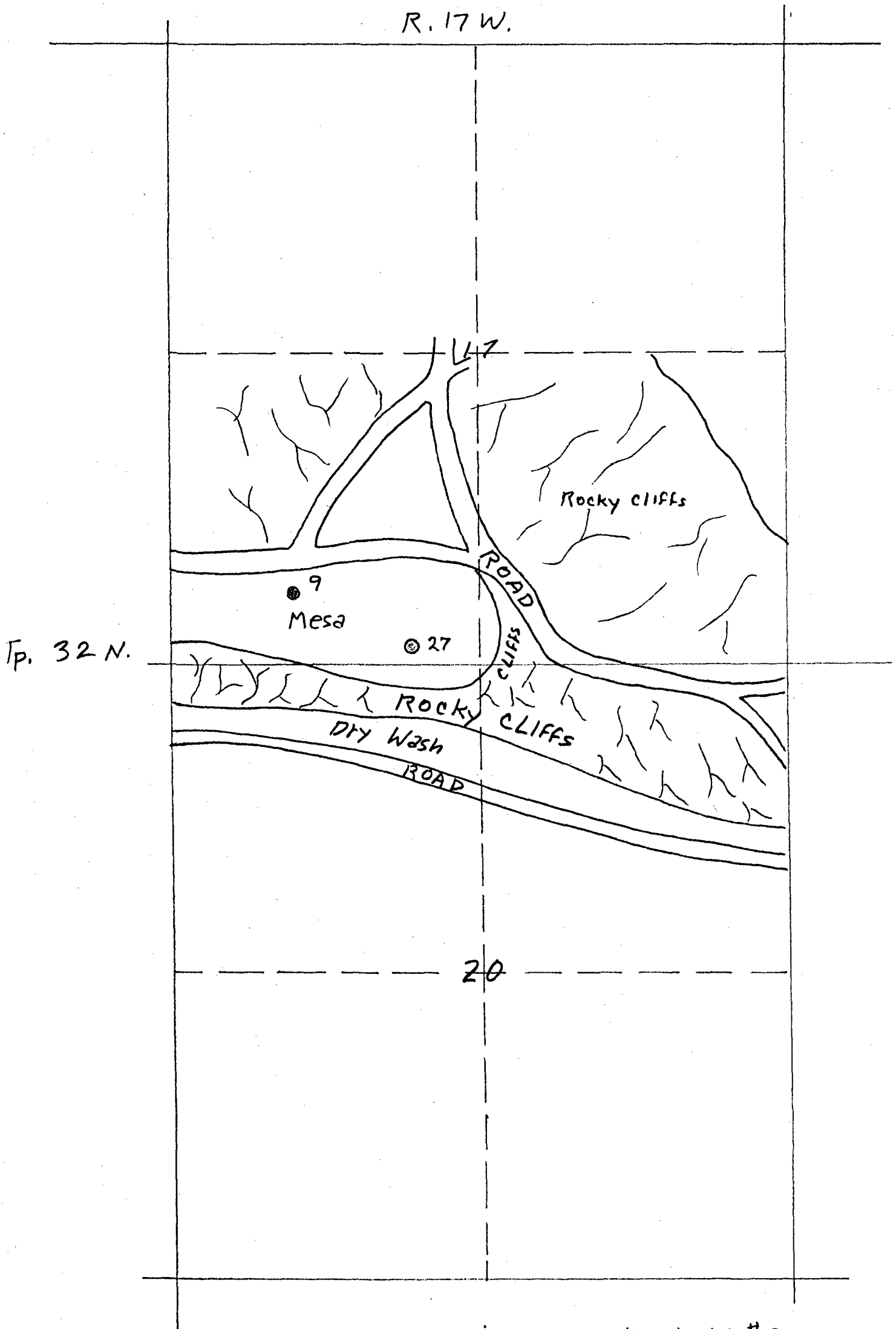

Terrain surrounding Proposed Navajo AA #27

scale: 1" = 1000'

OIL CONSERVATION COMMISSION

Alto DISTRICT

OIL CONSERVATION COMMISSION
BOX 2088
SANTA FE, NEW MEXICO

DATE 5-19-77

RE: Proposed MC _____
Proposed DHC _____
Proposed NSL ☒ _____
Proposed SWD _____
Proposed WFX _____
Proposed PMX _____

Gentlemen:

I have examined the application dated 5-16-77
for the James P. Woosley Navajo AA #27 N-17-32A-17W
Operator Lease and Well No. Unit, S-T-R

and my recommendations are as follows:

Approve
The operator is James P. Woosley

Yours very truly,

AR Kendrick