

# Consolidated Oil & Gas, Inc.

LINCOLN TOWER BUILDING  
1860 LINCOLN STREET  
DENVER, COLORADO 80203  
(303) 255-1751

June 1, 1977

NSL-857

JUN - 2 1977

OIL CONSERVATION COMM.  
Santa Fe

Joe D. Ramey  
Secretary and Director  
Oil Conservation Commission  
P.O. Box 2088  
Santa Fe, New Mexico

104 F  
Done June 22

Dear Mr. Ramey:

This is a request from Consolidated Oil & Gas, Inc. for administration approval for an unorthodox location in the Blanco Mesa Verde Pool. This request is based upon extreme topographical conditions.

The well, "Consolidated Oil & Gas, Inc. Champlin #5A", is to be located 2135 feet from the West line and 1910 feet from the North line of Section 25, Township 27 North, Range 4 West, N.M.P.M. Rio Arriba County, New Mexico. The West half of the section is dedicated to the Mesa Verde formation. The Northwest quarter of Section 25, in which the well is to be located, is comprised of extremely rugged terrain. The only accessible ground for a well location in the NW/4 of Section 25 is outside the legal limits placing the location unorthodox, and is the only alternative to offset the extremely high cost of constructing an orthodox location.

The operator of spacing units offsetting this unit for which the unorthodox location is sought, is El Paso Natural Gas Company and they have been notified by registered mail.

Enclosed are three copies of the certified plats and three copies of plats showing offset operators of the proration unit (W/2 of Section 25, T27N, R4W).

*O.B. Whitenburg*  
O.B. Whitenburg  
Sr. Drilling Engineer

CONSOLIDATED OIL & GAS, INC.

OBW/jb

## NEW MEXICO OIL CONSERVATION COMMISSION

## WELL LOCATION AND ACERAGE DEDICATION PLAT

All distances must be from the outer boundaries of the Section

Operator <b>CONSOLIDATED OIL AND GAS, INC.</b>			Lease <b>CHAMPLIN</b>		Well No. <b>5- A</b>
Unit Letter <b>F</b>	Section <b>25</b>	Township <b>27 NORTH</b>	Range <b>4 WEST</b>	County <b>RIO ARriba</b>	
Actual Footage Location of Well: <b>1910</b> feet from the <b>NORTH</b> line and <b>2135</b> feet from the <b>WEST</b> line					
Ground Level Elev. <b>7327</b>	Producing Formation <b>Mesa Verde</b>		Pool <b>Blanco</b>	Dedicated Acreage: <b>320</b> Acres	

1. Outline the acreage dedicated to the subject well by colored pencil or hachure marks on the plat below.
2. If more than one lease is dedicated to the well, outline each and identify the ownership thereof (both as to working interest and royalty),
3. If more than one lease of different ownership is dedicated to the well, have the interests of all owners been consolidated by communitization, unitization, force-pooling, etc?

( ) Yes ( ) No If answer is "yes," type of consolidation .....

If answer is "no," list the owners and tract descriptions which have actually consolidated. (Use reverse side of this form if necessary.) .....

No allowable will be assigned to the well until all interests have been consolidated (by communitization, unitization, forced-pooling, or otherwise) or until a non standard unit, eliminating such interests, has been approved by the Commission.

## CERTIFICATION

I hereby certify that the information contained herein is true and complete to the best of my knowledge and belief.

Name O.B. Whitenburg  
 Position Sr. Drilling Engineer  
 Company Consolidated Oil & Gas, Inc.  
 Date June 1, 1977

I hereby certify that the well location shown on this plat was plotted from field notes of actual surveys made by me or under my supervision, and that the same is true and correct to the best of my knowledge and belief.

Date Surveyed 9 May 1977  
James P. Leese  
 Registered Professional Engineer  
 and/or Land Surveyor **James P. Leese**

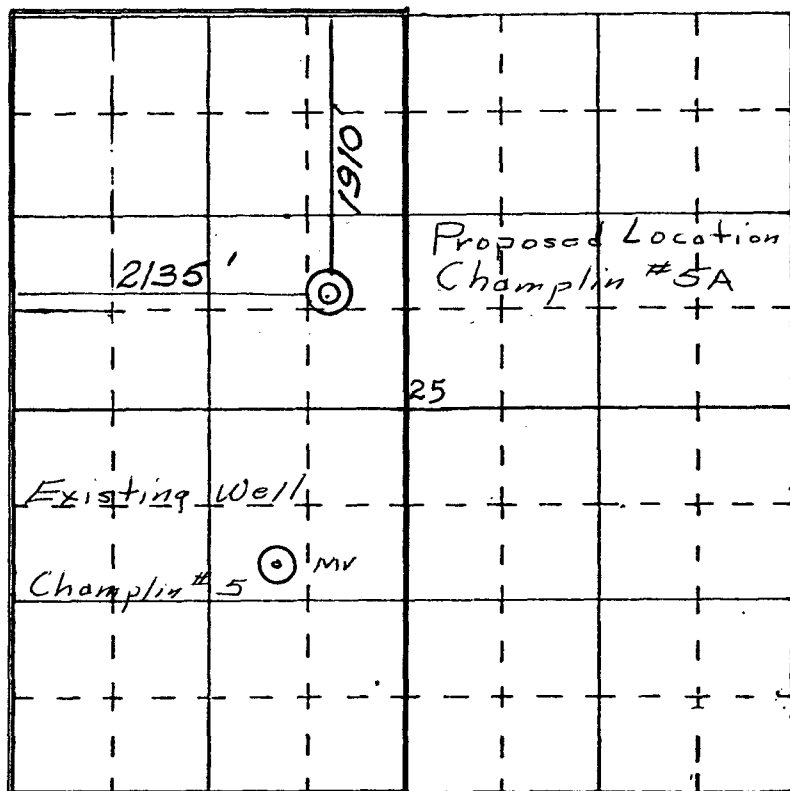

SCALE—4 INCHES EQUALS 1 MILE

SAN JUAN ENGINEERING COMPANY, FARMINGTON, N. M.

Certificate No. 1463

Name: Offset Operators TO  
 Location: Proposed Unorthodox  
 Champlin #5A Location  
 w/2 section 25 Dedicated

Date: June 1, 1977

000-000 → Shut In Pressure  
 000-000 → pressure (psi)  
 000-000 → pressure (kpsi)  
 → Producing Rate

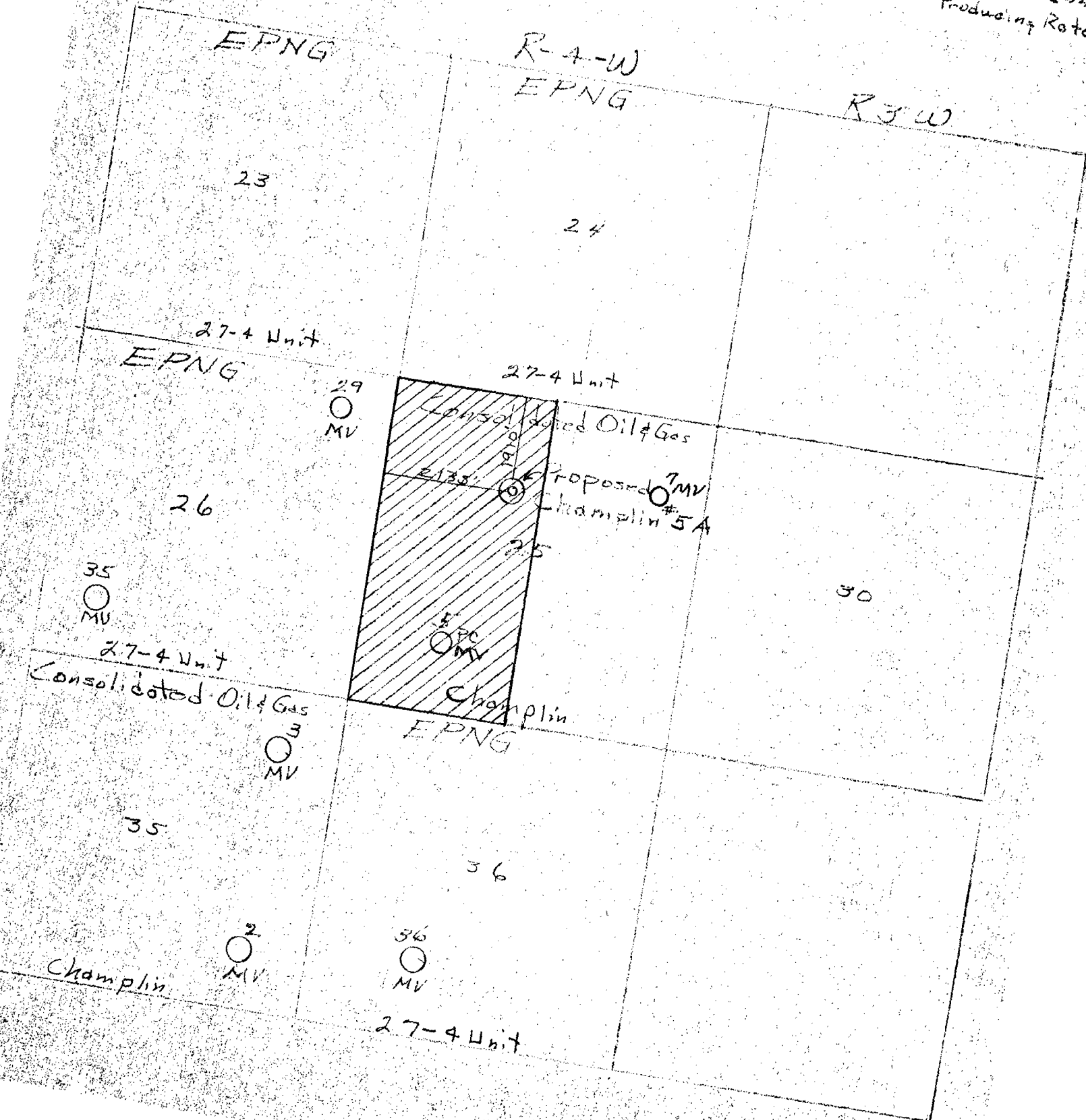

OIL CONSERVATION COMMISSION  
Alameda DISTRICT

OIL CONSERVATION COMMISSION  
BOX 2088  
SANTA FE, NEW MEXICO

DATE 6-2-77

RE: Proposed MC \_\_\_\_\_  
Proposed DHC \_\_\_\_\_  
Proposed NSL ✓ \_\_\_\_\_  
Proposed SWD \_\_\_\_\_  
Proposed WFX \_\_\_\_\_  
Proposed PMX \_\_\_\_\_

*Jim Kapteina*

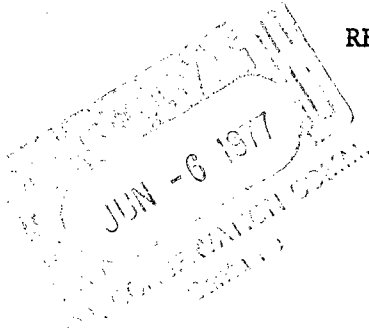

Gentlemen:

I have examined the application dated 6-1-77  
for the Consolidated Oil & Gas Inc. Champlin #5A F.25-27N-4W  
Operator Lease and Well No. Unit, S-T-R

and my recommendations are as follows:

Approve  
\_\_\_\_\_  
\_\_\_\_\_  
\_\_\_\_\_  
\_\_\_\_\_  
\_\_\_\_\_

Yours very truly,

*W. Kendrick*

