

El Paso NATURAL GAS
COMPANY

P. O. BOX 990
FARMINGTON, NEW MEXICO 87401
PHONE 505-325-2841

OCT 24 1977

October 20, 1977

NSL 3 1670
Rn 6
11-13-77

Mr. Joe Ramey
New Mexico Oil Conservation Commission
Post Office Box 2088
Santa Fe, New Mexico 87501

Dear Mr. Ramey:

This is a request for administrative approval for an unorthodox gas well location in the Blanco Mesa Verde pool.

It is intended to locate the El Paso Natural Gas Company's Riddle G #1A at 2050' from the South line and 1390' from the West line of Section 7, T-28-N, R-8-W, San Juan County, New Mexico.

Largo Canyon and Largo Wash cover the southwest corner of this section and this makes it impossible to build an orthodox gas well location.

All operators of proration units offsetting the proposed unorthodox location have been notified of this application by certified mail.

Plats showing the proposed well location and the terrain of Section 7, along with an ownership plat, are attached.

Yours truly,

Don Read

D. R. Read
Division Drilling Engineer

DRR:pb

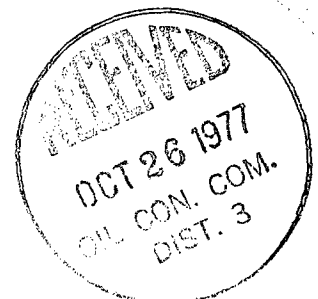

El Paso NATURAL GAS
COMPANY

P. O. BOX 990
FARMINGTON, NEW MEXICO 87401
PHONE: 505-325-2841

October 20, 1977

Aztec Oil & Gas Company
Fred C. Koch
W. H. Gilmore
Tenneco Oil Company
Supron Energy Corporation

Re: Unorthodox Gas Well Location

Gentlemen:

El Paso Natural Gas Company has requested administrative approval for an unorthodox location for a well in the Blanco Mesa Verde pool.

It is intended to locate the El Paso Natural Gas Company's Riddle G #1A at 1390' from the West line and 2050' from the South line of Section 7, T-28-N, R-8-W, San Juan County, New Mexico.

Largo Canyon and Largo Wash cover most of the southwest corner of this section and this makes it impossible to build an orthodox location.

In compliance with New Mexico Oil Conservation Commission rules, we are notifying you, as operators of an offsetting proration unit, of our application for administrative approval for the aforementioned unorthodox gas well location. Enclosed are three copies of this letter. If there is no objection to this location, please sign and return one copy to the New Mexico Oil Conservation Commission, Post Office Box 2088, Santa Fe, New Mexico 87501; one copy to El Paso Natural Gas Company; and keep one copy for your files.

A plat showing the proposed well location and offsetting Mesa Verde lease ownership is attached.

Yours truly,



D. R. Read
Division Drilling Engineer

DRR:pb

Approved: _____

Date: _____

EL PASO NATURAL GAS COMPANY

Well Name Riddle G #1 A, Blanco Mesaverde

Footage----- 2050 FSL, 1390 FWL

APPLICATION FOR NON-STANDARD LOCATION

County San Juan State New Mexico Section 7 Township 28N Range 8W

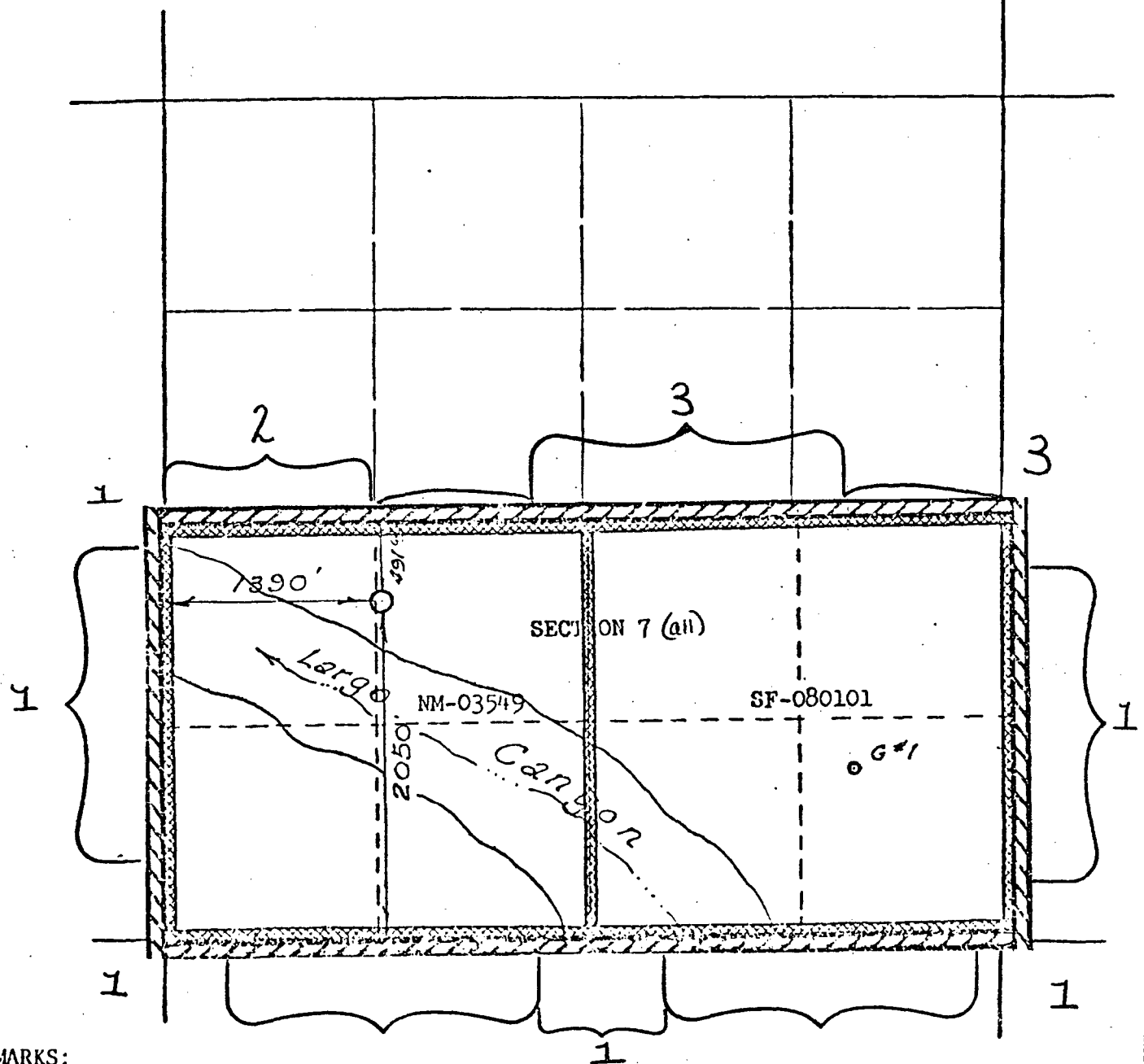

REMARKS:

- (1) El Paso Natural Gas Company
- (2) Aztec Oil & Gas, EPNG, Fred C. Koch, Southern Union, W. H. Gilmore
- (3) Tenneco Oil Company

UNITED STATES
DEPARTMENT OF THE INTERIOR
GEOLOGICAL SURVEY

APPLICATION FOR PERMIT TO DRILL, DEEPEN, OR PLUG BACK

1a. TYPE OF WORK

DRILL ☒DEEPEN ☐PLUG BACK ☐

b. TYPE OF WELL

OIL
WELL ☐GAS
WELL ☒

OTHER

SINGLE
ZONE ☐ XMULTIPLE
ZONE ☐

2. NAME OF OPERATOR

El Paso Natural Gas Company

3. ADDRESS OF OPERATOR

PO Box 990, Farmington, NM 87401

4. LOCATION OF WELL (Report location clearly and in accordance with any State requirements.*)

At surface

2050'S, 1390'W

At proposed prod. zone

14. DISTANCE IN MILES AND DIRECTION FROM NEAREST TOWN OR POST OFFICE*

15. DISTANCE FROM PROPOSED*

LOCATION TO NEAREST
PROPERTY OR LEASE LINE, FT.
(Also to nearest drlg. unit line, if any)

16. NO. OF ACRES IN LEASE

17. NO. OF ACRES ASSIGNED
TO THIS WELL

298.76

18. DISTANCE FROM PROPOSED LOCATION*
TO NEAREST WELL, DRILLING, COMPLETED,
OR APPLIED FOR, ON THIS LEASE, FT.

19. PROPOSED DEPTH

4795'

20. ROTARY OR CABLE TOOLS

Rotary

21. ELEVATIONS (Show whether DF, RT, GR, etc.)

5687'GL

22. APPROX. DATE WORK WILL START*

23. PROPOSED CASING AND CEMENTING PROGRAM

SIZE OF HOLE	SIZE OF CASING	WEIGHT PER FOOT	SETTING DEPTH	QUANTITY OF CEMENT
13 3/4"	9 5/8"	32.3#	200'	224 cu.ft. to circulate
8 3/4"	7"	20.0#	2445'	297 cu.ft. to cover Ojo Alamo
6 1/4"	4 1/2" liner	10.5#	2295-4795'	436 cu.ft. to fill to 2295'

Selectively perforate and sandwater fracture the Mesa Verde formation.

A 3000 psi WP and 6000 psi test double gate preventer equipped with blind and pipe rams will be used for blow out prevention on this well.

This gas is dedicated.

The S/2 of Section 7 is dedicated to this well.

IN ABOVE SPACE DESCRIBE PROPOSED PROGRAM: If proposal is to deepen or plug back, give data on present productive zone and proposed new productive zone. If proposal is to drill or deepen directionally, give pertinent data on subsurface locations and measured and true vertical depths. Give blowout preventer program, if any.

24.

SIGNED

A. G. Lucas

TITLE

Drilling Clerk

DATE

Oct. 20, 1977

(This space for Federal or State office use)

PERMIT NO.

APPROVAL DATE

APPROVED BY

TITLE

DATE

CONDITIONS OF APPROVAL, IF ANY:

NEW MEXICO OIL CONSERVATION COMMISSION
WELL LOCATION AND ACREAGE DEDICATION PLAT

Form C-102
Supersedes C-128
Effective 1-1-65

All distances must be from the outer boundaries of the Section.

Operator EL PASO NATURAL GAS COMPANY			Lease RIDDLE G (NM-03549)		Well No. 1A
Unit Letter K	Section 7	Township 28-N	Range 8-W	County SAN JUAN	
Actual Footage Location of Well: 2050 feet from the SOUTH line and 1390 feet from the WEST line					
Ground Level Elev. 5687	Producing Formation MESA VERDE		Pool BLANCO MESA VERDE		Dedicated Acreage: 298.76 Acres

1. Outline the acreage dedicated to the subject well by colored pencil or hachure marks on the plat below.
2. If more than one lease is dedicated to the well, outline each and identify the ownership thereof (both as to working interest and royalty).
3. If more than one lease of different ownership is dedicated to the well, have the interests of all owners been consolidated by communitization, unitization, force-pooling, etc?

☒ Yes ☐ No If answer is "yes," type of consolidation Communitization

If answer is "no," list the owners and tract descriptions which have actually been consolidated. (Use reverse side of this form if necessary.) _____

No allowable will be assigned to the well until all interests have been consolidated (by communitization, unitization, forced-pooling, or otherwise) or until a non-standard unit, eliminating such interests, has been approved by the Commission.
NOTE: THIS PLAT IS REISSUED. 9-8-77

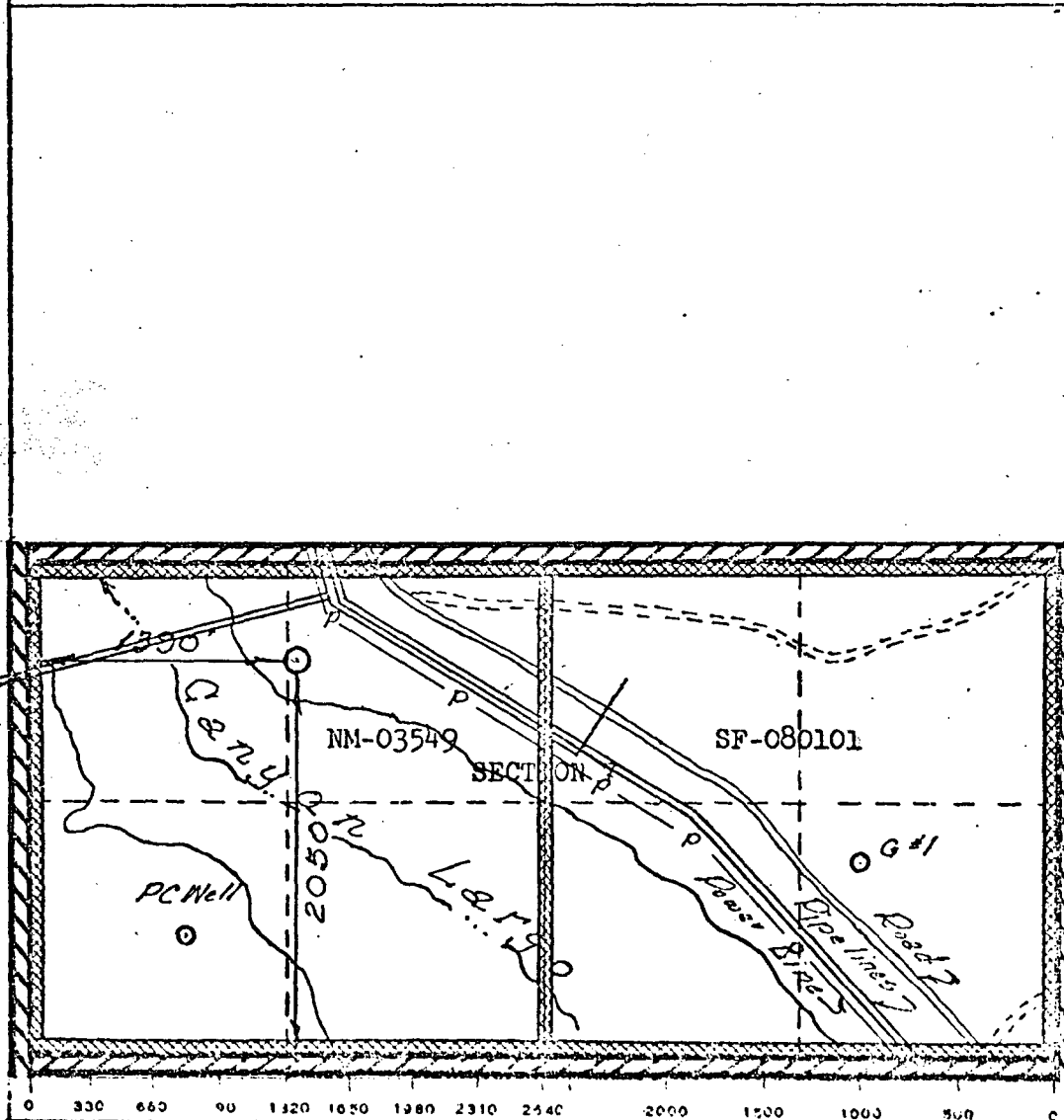

CERTIFICATION

I hereby certify that the information contained herein is true and complete to the best of my knowledge and belief.

Original Signed by
D. G. Briscoe

Name
Drilling Clerk
Position
El Paso Natural Gas Co.
Company
October 20, 1977
Date

I hereby certify that the well location shown on this plat was plotted from field notes of actual surveys made by me or under my supervision, and that the same is true and correct to the best of my knowledge and belief.

Date Surveyed
AUGUST 29, 1977

Registered Professional Engineer
or/Or Land Surveyor

[Signature]
Certificate No. **1760**

UNITED STATES
DEPARTMENT OF THE INTERIOR
GEOLOGICAL SURVEY

APPLICATION FOR PERMIT TO DRILL, DEEPEN, OR PLUG BACK

1a. TYPE OF WORK

DRILL ☒DEEPEN ☐PLUG BACK ☐

b. TYPE OF WELL

OIL
WELL ☐GAS
WELL ☒

OTHER

SINGLE
ZONE ☒ xMULTIPLE
ZONE ☐

2. NAME OF OPERATOR

El Paso Natural Gas Company

3. ADDRESS OF OPERATOR

PO Box 990, Farmington, NM 87401

4. LOCATION OF WELL (Report location clearly and in accordance with any State requirements.)*

At surface

2050'S, 1390'W

At proposed prod. zone

14. DISTANCE IN MILES AND DIRECTION FROM NEAREST TOWN OR POST OFFICE*

15. DISTANCE FROM PROPOSED*

LOCATION TO NEAREST
PROPERTY OR LEASE LINE, FT.
(Also to nearest drlg. unit line, if any)

16. NO. OF ACRES IN LEASE

17. NO. OF ACRES ASSIGNED
TO THIS WELL

298.76

18. DISTANCE FROM PROPOSED LOCATION*
TO NEAREST WELL, DRILLING, COMPLETED,
OR APPLIED FOR, ON THIS LEASE, FT.

19. PROPOSED DEPTH

4795'

20. ROTARY OR CABLE TOOLS

Rotary

21. ELEVATIONS (Show whether DF, RT, GR, etc.)

5687'GL

22. APPROX. DATE WORK WILL START*

23. PROPOSED CASING AND CEMENTING PROGRAM

SIZE OF HOLE	SIZE OF CASING	WEIGHT PER FOOT	SETTING DEPTH	QUANTITY OF CEMENT
13 3/4"	9 5/8"	32.3#	200'	224 cu.ft. to circulate
8 3/4"	7"	20.0#	2445'	297 cu.ft. to cover Ojo Alamo
6 1/4"	4 1/2" liner	10.5#	2295-4795'	436 cu.ft. to fill to 2295'

Selectively perforate and sandwater fracture the Mesa Verde formation.

A 3000 psi WP and 6000 psi test double gate preventer equipped with blind and pipe rams will be used for blow out prevention on this well.

This gas is dedicated.

The S/2 of Section 7 is dedicated to this well.

IN ABOVE SPACE DESCRIBE PROPOSED PROGRAM: If proposal is to deepen or plug back, give data on present productive zone and proposed new productive zone. If proposal is to drill or deepen directionally, give pertinent data on subsurface locations and measured and true vertical depths. Give blowout preventer program, if any.

24.

SIGNED

A. G. Bueco

TITLE

Drilling Clerk

DATE

Oct. 20, 1977

(This space for Federal or State office use)

PERMIT NO.

APPROVAL DATE

APPROVED BY

TITLE

DATE

CONDITIONS OF APPROVAL, IF ANY:

*See Instructions On Reverse Side

Tenneco Oil
A Tenneco Company

Penthouse
720 South Colorado Blvd.
Denver, CO 80222



NOV - 7 1977
Conservation Commission

November 2, 1977

New Mexico Oil Conservation Commission
Post Office Box 2088
Santa Fe, New Mexico 87501

El Paso Natural Gas Company
P. O. Box 990
Farmington, New Mexico 87401

Re: Unorthodox Gas Well Location
Riddle G #1-A
SW/4, Section 7, T28N-R8W
San Juan County, New Mexico

Gentlemen:

Attached is an approved copy of the request by El Paso Natural Gas for an unorthodox location for the captioned Mesaverde Infill Well. Tenneco Oil Company has no objection to the approval of this request by the Commission.

Yours very truly,

TENNECO OIL COMPANY

A handwritten signature in cursive script, reading "D. D. Myers".

D. D. Myers
Division Production Manager

RJG:DDM:v
Attachment

El Paso NATURAL GAS
COMPANY

P. O. BOX 990
FARMINGTON, NEW MEXICO 87401
PHONE: 505-325-2841

October 20, 1977

Aztec Oil & Gas Company
Fred C. Koch
W. H. Gilmore
Tenneco Oil Company
Supron Energy Corporation

Re: Unorthodox Gas Well Location

Gentlemen:

El Paso Natural Gas Company has requested administrative approval for an unorthodox location for a well in the Blanco Mesa Verde pool.

It is intended to locate the El Paso Natural Gas Company's Riddle G #1A at 1390' from the West line and 2050' from the South line of Section 7, T-28-N, R-8-W, San Juan County, New Mexico.

Largo Canyon and Largo Wash cover most of the southwest corner of this section and this makes it impossible to build an orthodox location.

In compliance with New Mexico Oil Conservation Commission rules, we are notifying you, as operators of an offsetting proration unit, of our application for administrative approval for the aforementioned unorthodox gas well location. Enclosed are three copies of this letter. If there is no objection to this location, please sign and return one copy to the New Mexico Oil Conservation Commission, Post Office Box 2088, Santa Fe, New Mexico 87501; one copy to El Paso Natural Gas Company; and keep one copy for your files.

A plat showing the proposed well location and offsetting Mesa Verde lease ownership is attached.

Yours truly,

Don Read

D. R. Read
Division Drilling Engineer

DRR:pb

Approved: Tenneco Oil Co.

Date: 11-3-77

D. D. Myer

W. H GILMORE
800 BLDG. OF THE SOUTHWEST
MIDLAND, TEXAS 79701

October 26, 1977

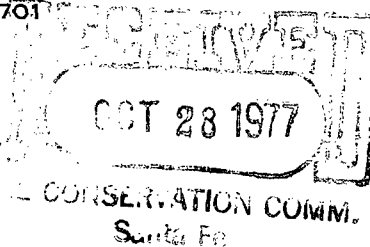

New Mexico Oil Conservation Commission
P. O. Box 2088
Santa Fe, New Mexico 87501

Gentlemen:

I am enclosing herewith a copy of the application for administration approval of an unorthodox gas well location in Section 7, T-28-N, R-8-W, San Juan County, New Mexico filed by El Paso Natural Gas Company.

I have indicated my approval by signing the enclosed copy of this application.

Very truly yours,

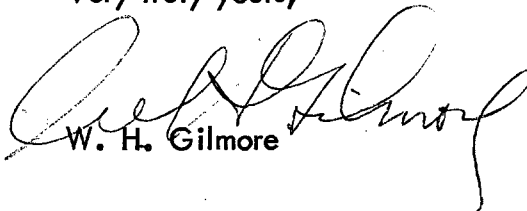
W. H. Gilmore

WHG:tjr
enclosure

cc: El Paso Natural Gas Company
P. O. Box 990
Farmington, New Mexico 87401

El Paso NATURAL GAS
COMPANY

P. O. BOX 990
FARMINGTON, NEW MEXICO 87401

PHONE: 505-325-2841

OCT 28 1977

CONSERVATION COMM.
October 20, 1977

Aztec Oil & Gas Company
Fred C. Koch
W. H. Gilmore
Tenneco Oil Company
Supron Energy Corporation

Re: Unorthodox Gas Well Location

Gentlemen:

El Paso Natural Gas Company has requested administrative approval for an unorthodox location for a well in the Blanco Mesa Verde pool.

It is intended to locate the El Paso Natural Gas Company's Riddle G #1A at 1390' from the West line and 2050' from the South line of Section 7, T-28-N, R-8-W, San Juan County, New Mexico.

Largo Canyon and Largo Wash cover most of the southwest corner of this section and this makes it impossible to build an orthodox location.

In compliance with New Mexico Oil Conservation Commission rules, we are notifying you, as operators of an offsetting proration unit, of our application for administrative approval for the aforementioned unorthodox gas well location. Enclosed are three copies of this letter. If there is no objection to this location, please sign and return one copy to the New Mexico Oil Conservation Commission, Post Office Box 2088, Santa Fe, New Mexico 87501; one copy to El Paso Natural Gas Company; and keep one copy for your files.

A plat showing the proposed well location and offsetting Mesa Verde lease ownership is attached.

Yours truly,

Don Read

D. R. Read
Division Drilling Engineer

DRR:pb

Approved: *W. H. Gilmore*

Date: 10/26/77

REC'D OCT 28 1977

El Paso NATURAL GAS COMPANY OCT 31 1977

P. O. BOX 990
FARMINGTON, NEW MEXICO 87401
PHONE: 505-325-2841

October 20, 1977

Aztec Oil & Gas Company
Fred C. Koch
W. H. Gilmore
Tenneco Oil Company
Supron Energy Corporation

Re: Unorthodox Gas Well Location

Gentlemen:

El Paso Natural Gas Company has requested administrative approval for an unorthodox location for a well in the Blanco Mesa Verde pool.

It is intended to locate the El Paso Natural Gas Company's Riddle G #1A at 1390' from the West line and 2050' from the South line of Section 7, T-28-N, R-8-W, San Juan County, New Mexico.

Largo Canyon and Largo Wash cover most of the southwest corner of this section and this makes it impossible to build an orthodox location.

In compliance with New Mexico Oil Conservation Commission rules, we are notifying you, as operators of an offsetting proration unit, of our application for administrative approval for the aforementioned unorthodox gas well location. Enclosed are three copies of this letter. If there is no objection to this location, please sign and return one copy to the New Mexico Oil Conservation Commission, Post Office Box 2088, Santa Fe, New Mexico 87501; one copy to El Paso Natural Gas Company; and keep one copy for your files.

A plat showing the proposed well location and offsetting Mesa Verde lease ownership is attached.

Yours truly,

Don Read

D. R. Read
Division Drilling Engineer

DRR:pb

Approved: _____

Koch Exploration Co.

J. J. [Signature]

Date: _____

10/28/77

El Paso NATURAL GAS
COMPANY

P. O. BOX 990
FARMINGTON, NEW MEXICO 87401
PHONE: 505-325-2841

NOV - 7 1977 October 20, 1977
Conservation Commission

Aztec Oil & Gas Company
Fred C. Koch
W. H. Gilmore
Tenneco Oil Company
Supron Energy Corporation

Re: Unorthodox Gas Well Location

Gentlemen:

El Paso Natural Gas Company has requested administrative approval for an unorthodox location for a well in the Blanco Mesa Verde pool.

It is intended to locate the El Paso Natural Gas Company's Riddle G #1A at 1390' from the West line and 2050' from the South line of Section 7, T-28-N, R-8-W, San Juan County, New Mexico.

Largo Canyon and Largo Wash cover most of the southwest corner of this section and this makes it impossible to build an orthodox location.

In compliance with New Mexico Oil Conservation Commission rules, we are notifying you, as operators of an offsetting proration unit, of our application for administrative approval for the aforementioned unorthodox gas well location. Enclosed are three copies of this letter. If there is no objection to this location, please sign and return one copy to the New Mexico Oil Conservation Commission, Post Office Box 2088, Santa Fe, New Mexico 87501; one copy to El Paso Natural Gas Company; and keep one copy for your files.

A plat showing the proposed well location and offsetting Mesa Verde lease ownership is attached.

Yours truly,

Don Read

D. R. Read
Division Drilling Engineer

DRR:pb

Approved: SUPRON ENERGY CORPORATION
Haskell Fleetwood
Haskell Fleetwood, Vice President

Date: October 31, 1977

El Paso NATURAL GAS
COMPANY

P.O. BOX 990
FARMINGTON, NEW MEXICO 87401
PHONE: 505-325-2841

OCT 31 1977
OIL CONSERVATION COMMISSION
SANTA FE, N.M.

October 20, 1977

Amoco Production
Tenneco Oil Company
D. J. Simmons
Aztec Oil & Gas Company

Re: Unorthodox Gas Well Location

Gentlemen:

El Paso Natural Gas Company has requested administrative approval for an unorthodox gas well location in the Blanco Mesa Verde pool.

It is intended to locate the El Paso Natural Gas Company's El Paso #1A at 500' from the North line and 1840' from the West line of Section 20, T-29-N, R-9-W, San Juan County, New Mexico.

Largo Canyon and Largo Wash cover most of the northern half of this section, making it impossible to build an orthodox gas well location.

In compliance with New Mexico Oil Conservation Commission, we are notifying you, as operators of an offsetting proration unit, of our application for administrative approval for the aforementioned unorthodox gas well location. Enclosed are three copies of this letter. If there is no objection to this location, please sign and return one copy to New Mexico Oil Conservation Commission, Post Office Box 2088, Santa Fe, New Mexico 87501; one copy to El Paso Natural Gas Company, and keep one copy for your files.

A plat showing the proposed well location and offsetting Mesa Verde ownership is attached.

Yours truly,

Don Read

D. R. Read
Division Drilling Engineer

DRR:pb

Approved: *[Signature]*
District Production Manager
AZTEC OIL & GAS COMPANY

Date: October 28, 1977

EL PASO NATURAL GAS COMPANY

Well Name El Paso #1 A, Blanco Mesaverde

Footage----- 500' FNL, 1840' FWL

APPLICATION FOR NON-STANDARD LOCATION

OCT 31 1977

County San Juan

State New Mexico

Section 20 Township 29N

Range 9W

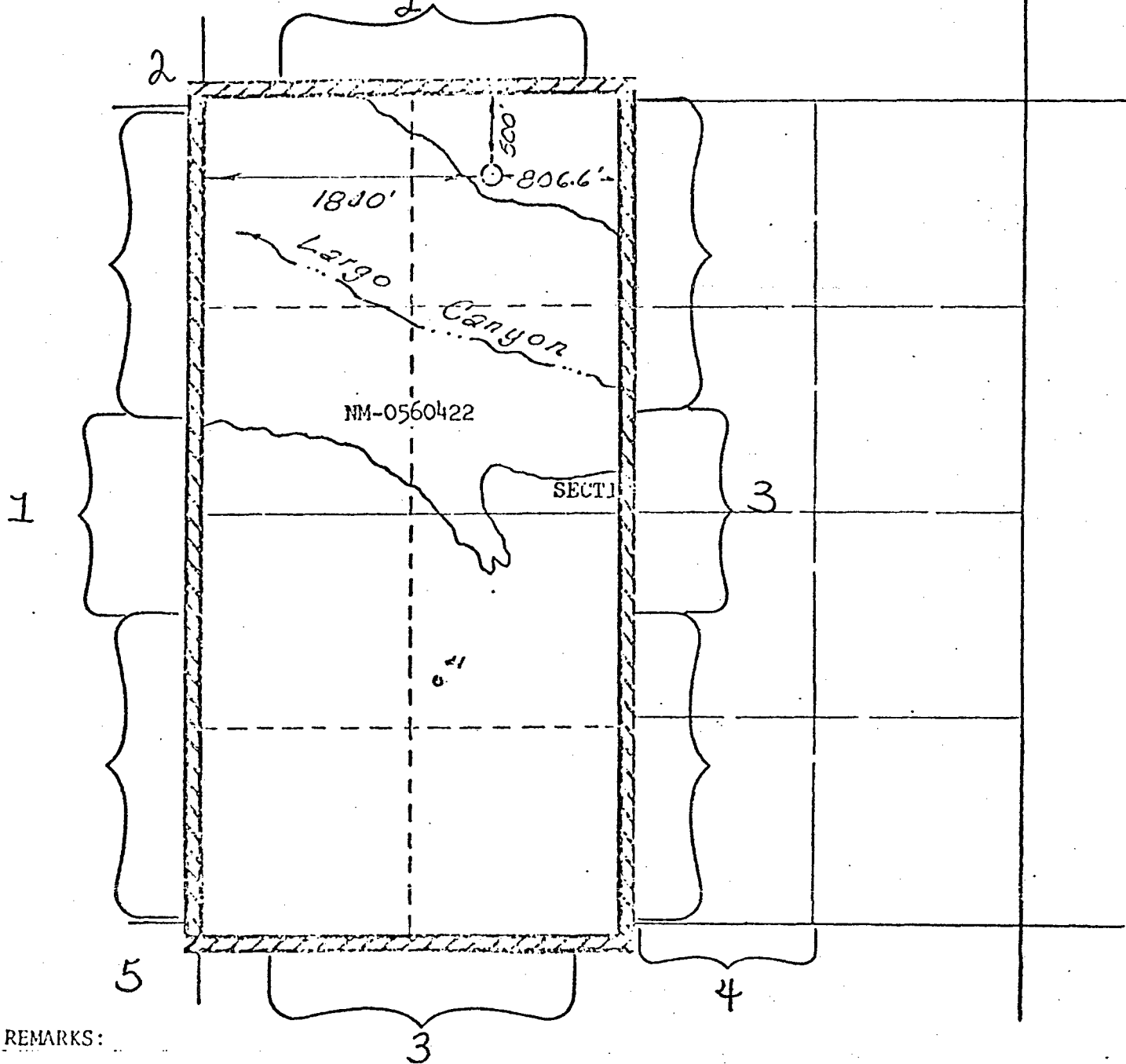

REMARKS:

- (1) El Paso Natural Gas Company
- (2) Amoco
- (3) Tenneco Oil Company
- (4) D. J. Simmons
- (5) Aztec Oil & Gas Company

OIL CONSERVATION COMMISSION
Act DISTRICT

OIL CONSERVATION COMMISSION
BOX 2088
SANTA FE, NEW MEXICO

DATE 10-26-77

RE: Proposed MC _____
Proposed DHC _____
Proposed NSL ✓ _____
Proposed SWD _____
Proposed WFX _____
Proposed PMX _____

7-27-1977

Gentlemen:

I have examined the application dated 10-20-77
for the El Paso Natural Gas Co. Riddle G #1A K-7-28N-8W
Operator Lease and Well No. Unit, S-T-R

and my recommendations are as follows:

Approve

Yours very truly,

AR Kendrick