

NSL-911

**El Paso** NATURAL GAS  
COMPANY

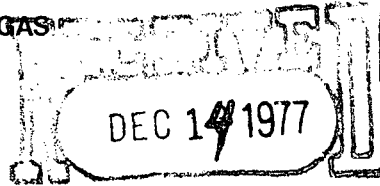

NEW MEXICO OIL CONSERVATION COMM.  
Santa Fe

P. O. BOX 990  
FARMINGTON, NEW MEXICO 87401  
PHONE: 505-325-2841

December 9, 1977

NSL  
Rule 104 F  
January 3, 1978

Mr. Joe Ramey  
New Mexico Oil Conservation Commission  
Post Office Box 2088  
Santa Fe, New Mexico 87501

Dear Mr. Ramey:

This is a request for administrative approval for an unorthodox gas well location in the Blanco Pictured Cliffs pool.

It is intended to locate the El Paso Natural Gas Company Fields #11 at 1440' from the North line and 1270' from the East line of Section 28, T-32-N, R-11-W, San Juan County, New Mexico.

The terrain is extremely rough and there is a high rock ledge to the West of the proposed location. The terrain makes it impossible to build an orthodox location (see attached plat).

All operators of proration units offsetting the proposed unorthodox location have been notified of this application by certified mail.

Plats showing the proposed well location and the terrain of Section 28 along with an ownership plat, are attached.

Yours truly,

D. R. Read  
Division Drilling Engineer

DRR:pb

UNITED STATES  
DEPARTMENT OF THE INTERIOR  
GEOLOGICAL SURVEY

SUBMIT IN TRIPPLICATE

(Other instructions on reverse side)

Form approved.  
Budget Bureau No. 42-R1425.

DEC 1 1977

5. LEASE DESIGNATION AND SERIAL NO.

NM 010989

6. IF INDIAN, ALLOTTEE OR TRIBE NAME

APPLICATION FOR PERMIT TO DRILL, DEEPEN, OR PLUG BACK

1a. TYPE OF WORK

DRILL ☒

DEEPEN ☐

PLUG BACK ☐

7. UNIT AGREEMENT NAME

8. FARM OR LEASE NAME

Fields

9. WELL NO.

11

10. FIELD AND POOL, OR WILDCAT

Blanco Pictured Cliffs

11. SEC., T., R., M., OR BLK.

AND SURVEY OR AREA  
Sec. 28, T-32-N, R-11-W  
NMPM

12. COUNTY OR PARISH

San Juan

13. STATE

NM

b. TYPE OF WELL

OIL WELL ☐

GAS WELL ☒

OTHER

SINGLE ZONE ☒

MULTIPLE ZONE ☐

2. NAME OF OPERATOR

El Paso Natural Gas Company

3. ADDRESS OF OPERATOR

PO Box 990, Farmington, NM 87401

4. LOCATION OF WELL (Report location clearly and in accordance with any State requirements.)\*

At surface

1440'N, 1270'E

At proposed prod. zone

14. DISTANCE IN MILES AND DIRECTION FROM NEAREST TOWN OR POST OFFICE\*

5 3/4 mi. es from Cedar Hill, NM

15. DISTANCE FROM PROPOSED\*

LOCATION TO NEAREST  
PROPERTY OR LEASE LINE, FT.  
(Also to nearest drlg. unit line, if any)

1280'

16. NO. OF ACRES IN LEASE

2480

17. NO. OF ACRES ASSIGNED  
TO THIS WELL

160

18. DISTANCE FROM PROPOSED LOCATION\*  
TO NEAREST WELL, DRILLING, COMPLETED,  
OR APPLIED FOR, ON THIS LEASE, FT.

200

19. PROPOSED DEPTH

3265'

20. ROTARY OR CABLE TOOLS

Rotary

21. ELEVATIONS (Show whether DF, RT, GR, etc.)

6323'GR

22. APPROX. DATE WORK WILL START\*

23.

PROPOSED CASING AND CEMENTING PROGRAM

SIZE OF HOLE	SIZE OF CASING	WEIGHT PER FOOT	SETTING DEPTH	QUANTITY OF CEMENT
12 1/4"	8 5/8"	24.0#	120'	106 cu.ft. to circulate
6 3/4"	2 7/8"	6.4#	3265'	448 cu.ft. to cover Ojo Alam

Selectively perforate and sandwater fracture the Pictured Cliffs formation.

A 3000 psi WP and 6000 psi test double gate preventer equipped with blind and pipe rams will be used for blow out prevention on this well.

This gas is dedicated.

The NE/4 of Section 28 is dedicated to this well.

IN ABOVE SPACE DESCRIBE PROPOSED PROGRAM: If proposal is to deepen or plug back, give data on present productive zone and proposed new productive zone. If proposal is to drill or deepen directionally, give pertinent data on subsurface locations and measured and true vertical depths. Give blowout preventer program, if any.

24.

SIGNED

*D. G. Busio*

TITLE

Drilling Clerk

DATE

December 8, 1977

(This space for Federal or State office use)

PERMIT NO.

APPROVAL DATE

APPROVED BY

TITLE

DATE

CONDITIONS OF APPROVAL, IF ANY:

\*See Instructions On Reverse Side

## NEW MEXICO OIL CONSERVATION COMMISSION

## WELL LOCATION AND ACERAGE DEDICATION PLAT

All distances must be from the outer boundaries of the Section

Operator <b>EL PASO NATURAL GAS COMPANY</b>			Lease <b>FIELDS (NM-010989)</b>		Well No. <b>11</b>
Unit Letter <b>H</b>	Section <b>28</b>	Township <b>32 NORTH</b>	Range <b>11 WEST</b>	County <b>SAN JUAN</b>	
Actual Footage Location of Well: <b>1440</b> feet from the <b>NORTH</b> line and <b>1270</b> feet from the <b>EAST</b> line					
Ground Level Elev. <b>6323</b>	Producing Formation <b>PICTURED CLIFFS</b>		Pool <b>BLANCO PICTURED CLIFFS</b>	Dedicated Acreage: <b>160.00</b> Acres	

- Outline the acreage dedicated to the subject well by colored pencil or hatchure marks on the plat below.
- If more than one lease is dedicated to the well, outline each and identify the ownership thereof (both as to working interest and royalty),
- If more than one lease of different ownership is dedicated to the well, have the interests of all owners been consolidated by communitization, unitization, force-pooling, etc?

( ) Yes ( ) No If answer is "yes," type of consolidation \_\_\_\_\_

If answer is "no," list the owners and tract descriptions which have actually consolidated. (Use reverse side of this form if necessary.) \_\_\_\_\_

No allowable will be assigned to the well until all interests have been consolidated (by communitization, unitization, forced-pooling, or otherwise) or until a non standard unit, eliminating such interests, has been approved by the Commission.

## CERTIFICATION

I hereby certify that the information contained herein is true and complete to the best of my knowledge and belief.

*N. G. Buess*  
Name  
Drilling Clerk  
Position  
El Paso Natural Gas Co.  
Company  
December 8, 1977  
Date

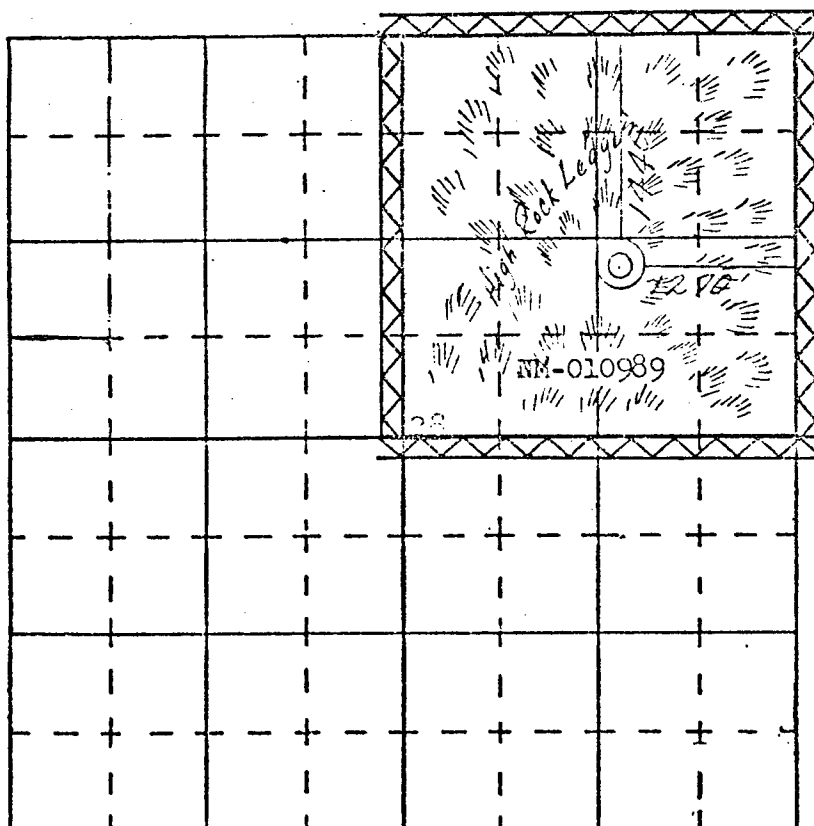

SCALE—4 INCHES EQUALS 1 MILE

SAN JUAN ENGINEERING COMPANY, FARMINGTON, N. M.

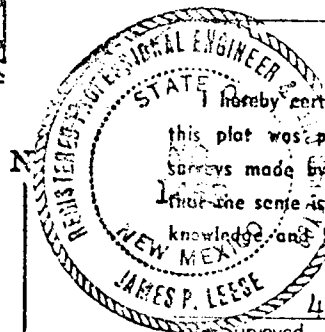

I hereby certify that the well location shown on this plat was plotted from field notes of actual surveys made by me or under my supervision, and that the same is true and correct to the best of my knowledge and belief.

4 November 1977  
Date Surveyed  
*James P. Leese*  
Registered Professional Engineer  
and/or Land Surveyor **James P. Leese**

Certificate No. 1463

# EL PASO NATURAL GAS COMPANY

Well Name Fields #11, Pictured Cliffs

Footage---- 1440' FNL, 1270' FEL

## APPLICATION FOR NON-STANDARD LOCATION

County San Juan

State New Mexico

Section 28

Township 32N

Range 11W

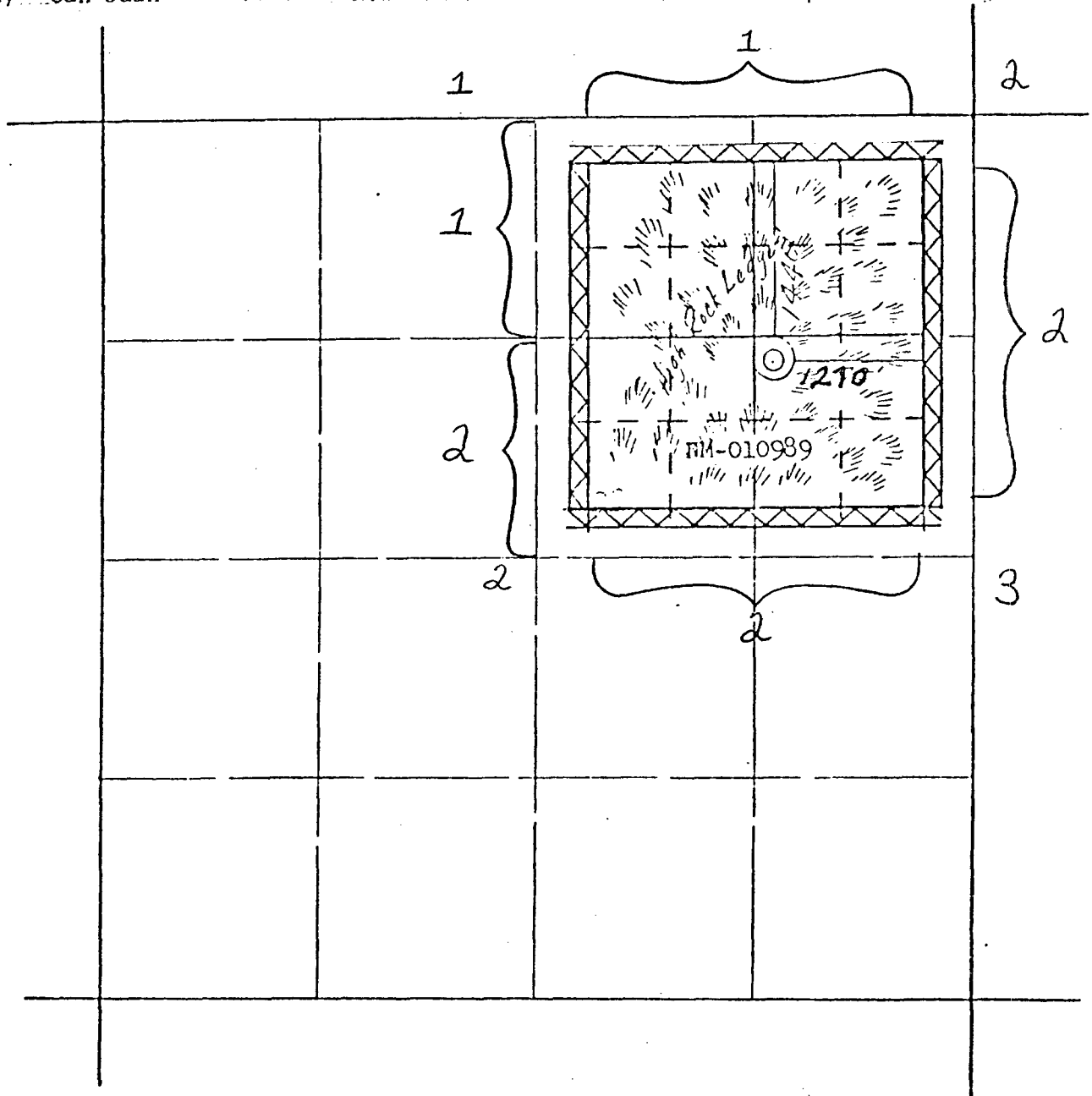

### REMARKS:

- (1) Northwest Pipeline Corporation (Cox Canyon Unit)
- (2) El Paso Natural Gas Company
- (3) Amoco Production Company

**El Paso** NATURAL GAS  
COMPANY

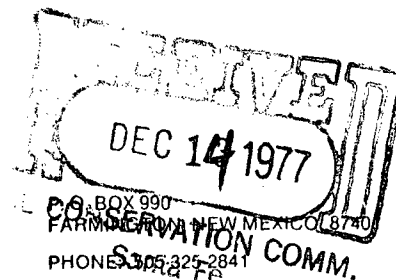

December 9, 1977

Northwest Pipeline Corporation  
Amoco Production Company

Re: Unorthodox Gas Well Location

Gentlemen:

El Paso Natural Gas Company has requested administrative approval for an unorthodox gas well location for a Blanco Pictured Cliffs pool well.

It is intended to locate the El Paso Natural Gas Company Fields #11 well at 1440' from the North line and 1270' from the East line of Section 28, T-32-N, R-11-W, San Juan County, New Mexico.

The terrain is extremely rough and there is a high rock ledge to the West of the proposed location. The terrain makes it impossible to build an orthodox location (see attached plat).

In compliance with New Mexico Oil Conservation Commission rules, we are notifying you, as operator of an offsetting proration unit, of our application for administrative approval for the aforementioned unorthodox gas well location. Enclosed are three copies of this letter. If there is no objection to this location, please sign and return one copy to the New Mexico Oil Conservation Commission, Post Office Box 2088, Santa Fe, New Mexico 87501; one copy to El Paso Natural Gas Company; and keep one copy for your files.

A plat showing the proposed well location and the offsetting Pictured Cliffs lease ownership is attached.

Yours truly,

D. R. Read  
Division Drilling Engineer

DRR:pb  
encs.

Approved: \_\_\_\_\_

Date: \_\_\_\_\_

**El Paso** NATURAL GAS  
COMPANY

P.O. BOX 990  
FARMINGTON, NEW MEXICO 87401  
PHONE: 505-325-2841

DEC 22 1977

December 9, 1977

Northwest Pipeline Corporation  
Amoco Production Company

Re: Unorthodox Gas Well Location

Gentlemen:

El Paso Natural Gas Company has requested administrative approval for an unorthodox gas well location for a Blanco Pictured Cliffs pool well.

It is intended to locate the El Paso Natural Gas Company Fields #11 well at 1440' from the North line and 1270' from the East line of Section 28, T-32-N, R-11-W, San Juan County, New Mexico.

The terrain is extremely rough and there is a high rock ledge to the West of the proposed location. The terrain makes it impossible to build an orthodox location (see attached plat).

In compliance with New Mexico Oil Conservation Commission rules, we are notifying you, as operator of an offsetting proration unit, of our application for administrative approval for the aforementioned unorthodox gas well location. Enclosed are three copies of this letter. If there is no objection to this location, please sign and return one copy to the New Mexico Oil Conservation Commission, Post Office Box 2088, Santa Fe, New Mexico 87501; one copy to El Paso Natural Gas Company; and keep one copy for your files.

A plat showing the proposed well location and the offsetting Pictured Cliffs lease ownership is attached.

Yours truly,

*Don Read*

D. R. Read  
Division Drilling Engineer

DRR:pb  
encs.

Approved:

*RB Giles*  
*Amoco Production Company*  
Date: 12/20/77

**El Paso** NATURAL GAS  
COMPANY

Northwest Pipeline Corporation

DEC 14 1977

Production Department

DEC 22 1977  
P. O. BOX 990  
FARMINGTON, NEW MEXICO 87401  
PHONE: 505-325-2841

December 9, 1977

Northwest Pipeline Corporation  
Amoco Production Company

Re: Unorthodox Gas Well Location

Gentlemen:

El Paso Natural Gas Company has requested administrative approval for an unorthodox gas well location for a Blanco Pictured Cliffs pool well.

It is intended to locate the El Paso Natural Gas Company Fields #11 well at 1440' from the North line and 1270' from the East line of Section 28, T-32-N, R-11-W, San Juan County, New Mexico.

The terrain is extremely rough and there is a high rock ledge to the West of the proposed location. The terrain makes it impossible to build an orthodox location (see attached plat).

In compliance with New Mexico Oil Conservation Commission rules, we are notifying you, as operator of an offsetting proration unit, of our application for administrative approval for the aforementioned unorthodox gas well location. Enclosed are three copies of this letter. If there is no objection to this location, please sign and return one copy to the New Mexico Oil Conservation Commission, Post Office Box 2088, Santa Fe, New Mexico 87501; one copy to El Paso Natural Gas Company; and keep one copy for your files.

A plat showing the proposed well location and the offsetting Pictured Cliffs lease ownership is attached.

Yours truly,



D. R. Read  
Division Drilling Engineer

DRR:pb  
encs.

Approved:

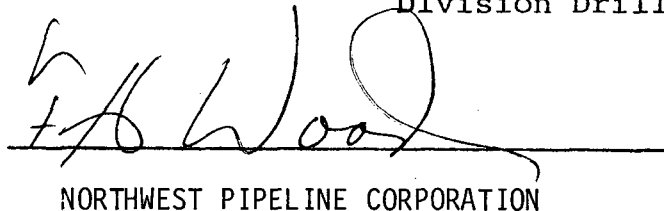
  
NORTHWEST PIPELINE CORPORATION

Date: 12-14-77

OIL CONSERVATION COMMISSION  
Byles DISTRICT

DATE 12-19-77

OIL CONSERVATION COMMISSION  
BOX 2088  
SANTA FE, NEW MEXICO

RE: Proposed MC \_\_\_\_\_  
Proposed DHC \_\_\_\_\_  
Proposed NSL ☒ \_\_\_\_\_  
Proposed SWD \_\_\_\_\_  
Proposed WFX \_\_\_\_\_  
Proposed PMX \_\_\_\_\_

Gentlemen:

I have examined the application dated 12-9-77  
for the El Paso Natural Gas Co Fields #11 H-28-32N-11W  
Operator Lease and Well No. Unit, S-T-R

and my recommendations are as follows:

Approve  
\_\_\_\_\_  
\_\_\_\_\_  
\_\_\_\_\_  
\_\_\_\_\_  
\_\_\_\_\_

Yours very truly,

AR Hendrick