

El Paso NATURAL GAS
COMPANY

P. O. BOX 990
FARMINGTON, NEW MEXICO 87401
PHONE: 505-325-2841

January 13, 1978

Mr. Joe Ramey
New Mexico Oil Conservation Commission
Post Office Box 2088
Santa Fe, New Mexico 87501

NSL-917
NSL
Feb 5, 1978
Rule 104 F

Dear Mr. Ramey:

This is a request for administrative approval for a non-standard gas well location in the Blanco Mesa Verde pool.

It is intended to locate the El Paso Natural Gas Company's San Juan 29-7 Unit #89A at 2020' from the North line and 390' from the West line of Section 7, T-29-N, R-7-W, NMPM, Rio Arriba County, New Mexico.

This location cannot be built at standard footages because of the terrain. Large cliffs and rock outcroppings rise directly to the south and southeast of the proposed location site. Standard footages would place this well on a cliff which rises vertically approximately 400'.

All operators of proration units offsetting the proposed non-standard location have been notified of this application by certified mail.

Plats showing the proposed location and an ownership plat are attached.

Yours truly,

L. A. Aimes

L. A. Aimes
Sr. Drilling Engineer

LAA:pb

UNITED STATES
DEPARTMENT OF THE INTERIOR
GEOLOGICAL SURVEY

APPLICATION FOR PERMIT TO DRILL, DEEPEN, OR PLUG BACK

1a. TYPE OF WORK DRILL <input checked="" type="checkbox"/> DEEPEN <input type="checkbox"/> PLUG BACK <input type="checkbox"/>		5. LEASE DESIGNATION AND SERIAL NO. SF 078943-A 6. IF INDIAN, ALLOTTEE OR TRIBE NAME 7. UNIT AGREEMENT NAME San Juan 29-7 Unit 8. FARM OR LEASE NAME San Juan 29-7 Unit 9. WELL NO. 89A 10. FIELD AND POOL, OR WILDCAT Blanco Mesa Verde 11. SEC., T., R., M., OR BLK. AND SURVEY OR AREA Sec. 7, T-29-N, R-7-W NMPM 12. COUNTY OR PARISH 13. STATE Rio Arriba NM
b. TYPE OF WELL OIL WELL <input type="checkbox"/> GAS WELL <input checked="" type="checkbox"/> OTHER <input type="checkbox"/> SINGLE ZONE <input checked="" type="checkbox"/> MULTIPLE ZONE <input type="checkbox"/>		
2. NAME OF OPERATOR El Paso Natural Gas Company		
3. ADDRESS OF OPERATOR PO Box 990, Farmington, NM 87401		
4. LOCATION OF WELL (Report location clearly and in accordance with any State requirements.)* At surface 2020'N, 390'W At proposed prod. zone		
14. DISTANCE IN MILES AND DIRECTION FROM NEAREST TOWN OR POST OFFICE* 6 miles SE of Abe's Store, NM		
15. DISTANCE FROM PROPOSED* LOCATION TO NEAREST PROPERTY OR LEASE LINE, FT. (Also to nearest drlg. unit line, if any) 390		16. NO. OF ACRES IN LEASE Unit
18. DISTANCE FROM PROPOSED LOCATION* TO NEAREST WELL, DRILLING, COMPLETED, OR APPLIED FOR, ON THIS LEASE, FT. 1400		17. NO. OF ACRES ASSIGNED TO THIS WELL 226.72
19. PROPOSED DEPTH 5730'		20. ROTARY OR CABLE TOOLS Rotary
21. ELEVATIONS (Show whether DF, RT, GR, etc.) 6350'GL		22. APPROX. DATE WORK WILL START*

23. PROPOSED CASING AND CEMENTING PROGRAM				
SIZE OF HOLE	SIZE OF CASING	WEIGHT PER FOOT	SETTING DEPTH	QUANTITY OF CEMENT
13 3/4"	9 5/8"	32.3#	200'	224 cu.ft. to circulate
8 3/4"	7"	20.0#	3450'	304 cu.ft. to cover Ojo Alamo
6 1/4"	4 1/2" liner	10.5#	3300-5730'	431 cu.ft. to fill to 3300'

Selectively perforate and sandwater fracture the Mesa Verde formation.

A 3000 psi WP and 6000 psi test double gate preventer equipped with blind and pipe rams will be used for blow out prevention on this well.

This gas is dedicated.

The W/2 of Section 7 is dedicated to this well.

IN ABOVE SPACE DESCRIBE PROPOSED PROGRAM: If proposal is to deepen or plug back, give data on present productive zone and proposed new productive zone. If proposal is to drill or deepen directionally, give pertinent data on subsurface locations and measured and true vertical depths. Give blowout preventer program, if any.

24. SIGNED A. G. Busco TITLE Drilling Clerk DATE 1-12-78

(This space for Federal or State office use)

PERMIT NO. _____ APPROVAL DATE _____

APPROVED BY _____ TITLE _____ DATE _____

CONDITIONS OF APPROVAL, IF ANY:

NEW MEXICO OIL CONSERVATION COMMISSION
WELL LOCATION AND ACREAGE DEDICATION PLAT

Form C-102
Supersedes C-128
Effective 1-1-65

All distances must be from the outer boundaries of the Section.

Operator EL PASO NATURAL GAS COMPANY			Lease SAN JUAN 29-7 UNIT (SF- 078943-A)		Well No. 89A
Unit Letter E	Section 7	Township 29-N	Range 7-W	County RIO ARriba	
Actual Footage Location of Well: <div style="display: flex; justify-content: space-between;"> 2020 feet from the NORTH line and 390 feet from the WEST line </div>					
Ground Level Elev. 6350	Producing Formation MESA VERDE	Pool BLANCO MESA VERDE	Dedicated Acreage: 226.72 Acres		

1. Outline the acreage dedicated to the subject well by colored pencil or hachure marks on the plat below.
2. If more than one lease is dedicated to the well, outline each and identify the ownership thereof (both as to working interest and royalty).
3. If more than one lease of different ownership is dedicated to the well, have the interests of all owners been consolidated by communitization, unitization, force-pooling, etc?

☒ Yes ☐ No If answer is "yes," type of consolidation — Unitization —

If answer is "no," list the owners and tract descriptions which have actually been consolidated. (Use reverse side of this form if necessary.) _____

No allowable will be assigned to the well until all interests have been consolidated (by communitization, unitization, forced-pooling, or otherwise) or until a non-standard unit, eliminating such interests, has been approved by the Commission.
REISSUED 11/01/77 TO SHOW CORRECT ELEVATION

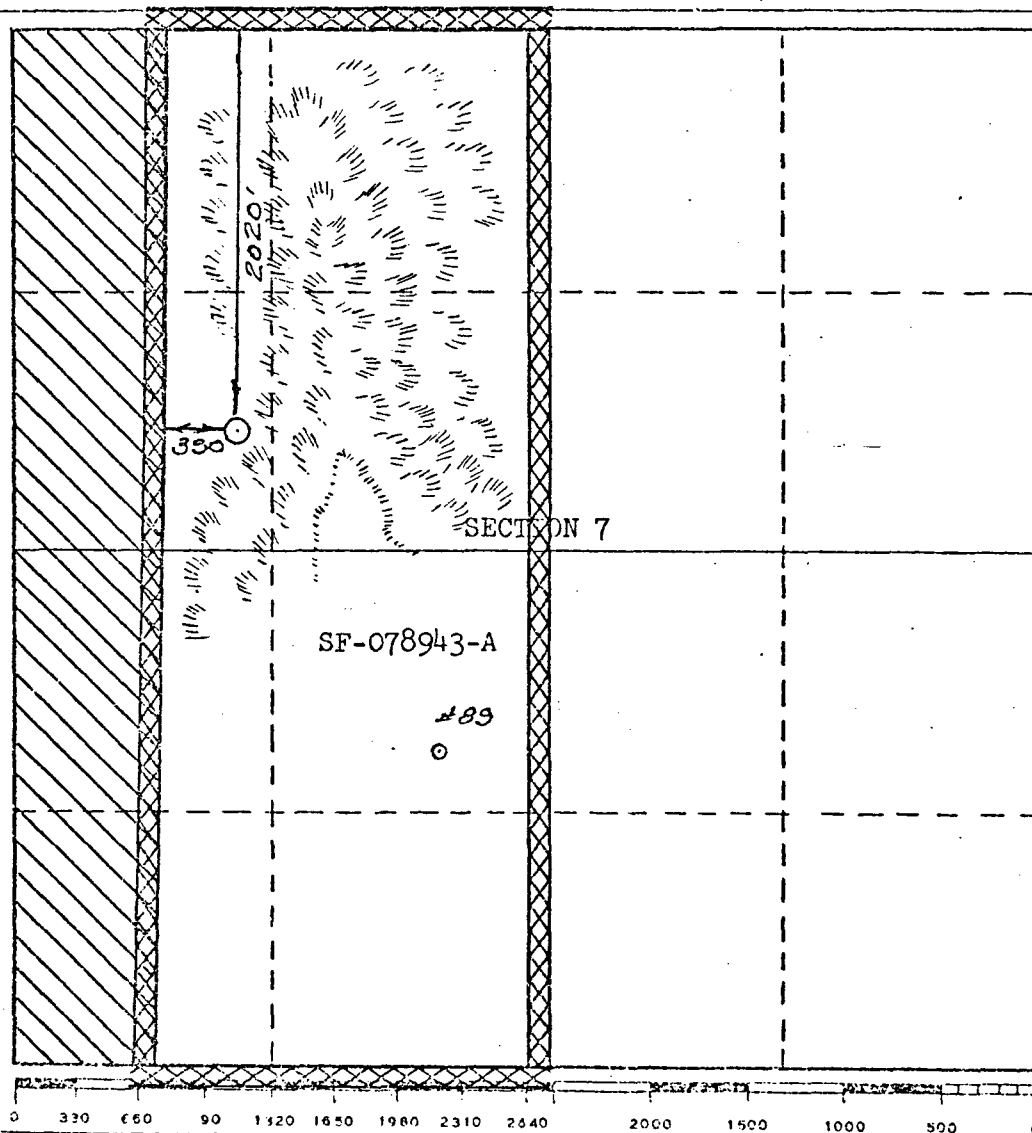

CERTIFICATION

I hereby certify that the information contained herein is true and complete to the best of my knowledge and belief.

D. G. Guice
Name
Drilling Clerk

Position
El Paso Natural Gas

Company
January 12, 1978

Date

I hereby certify that the well location shown on this plat was plotted from field notes of actual surveys made by me or under my supervision, and that the same is true and correct to the best of my knowledge and belief.

Date Surveyed
OCTOBER 12, 1977

Registered Professional Engineer
and/or Land Surveyor

David W. Allen
Certificate No. 1760

EL PASO NATURAL GAS COMPANY

Well Name San Juan 29-7 Unit #89 A

Footage---- 2020' FNL, 390' FWL

APPLICATION FOR NON-STANDARD LOCATION

County Rio Arriba State New Mexico

Section 7 Township 29N Range 7W

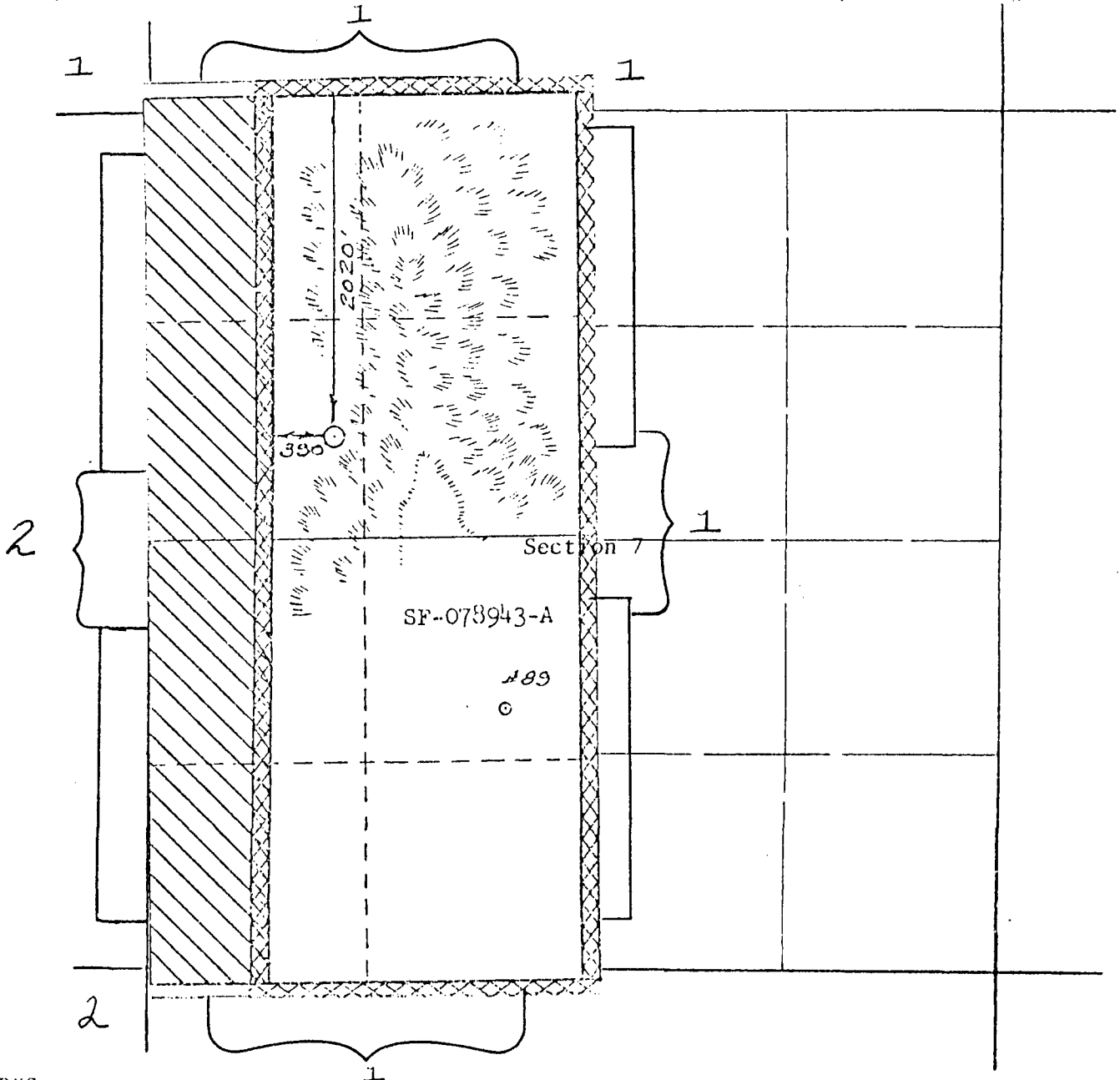

REMARKS:

(1) El Paso Natural Gas Company

(2) Tenneco Oil Company

xc: Mr. C. E. Matthews
Mr. W. D. Dawson
Mr. L. A. Aimes

Tenneco Oil
A Tenneco Company

Suite 1200
Lincoln Tower Building
Denver, Colorado 80203
(303) 292-9920



January 27, 1978

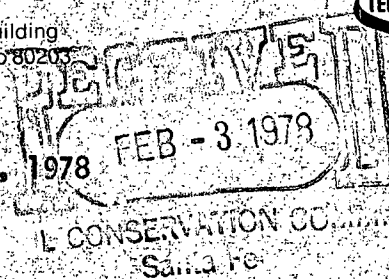

El Paso Natural Gas Company
P. O. Box 990
Farmington, New Mexico 87401

Attention: Mr. L. A. Aimes

New Mexico Oil Conservation Commission
P. O. Box 2088
Santa Fe, New Mexico 87501

Re: San Juan 29-7 Unit #89-A
NW/4 Section 7, T29N-R7W
Rio Arriba County, New Mexico

Gentlemen:

Tenneco Oil Company acknowledges notification by El Paso Natural Gas Company of their request for the granting of a non-standard location for the captioned well. As an offset operator, we have no objection to the approval of this request.

Yours very truly,

TENNECO OIL COMPANY

D. D. Myers
Division Production Manager

RJG:DDM:v

COPY

El Paso NATURAL GAS
COMPANY

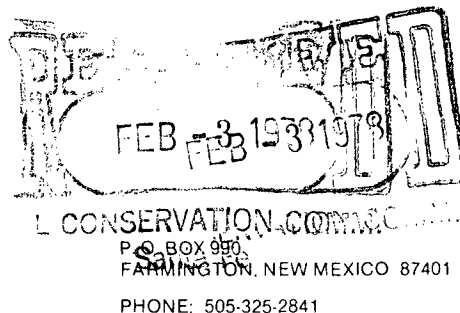

January 13, 1978

Tenneco Oil Company
1200 Lincoln Tower Building
Denver, CO 80295

Gentlemen:

El Paso Natural Gas Company has requested administrative approval for a non-standard gas well location in the Blanco Mesa Verde pool.

It is intended to locate the El Paso Natural Gas Company's San Juan 29-7 Unit #89A at 2020' from the North line and 390' from the West line of Section 7, T-29-N, R-7-W, NMPM, Rio Arriba County, New Mexico.

This location has been changed due to topographical reasons. Large cliffs and rock outcroppings make this well site impossible to build at standard footages.

In compliance with New Mexico Oil Conservation Commission rules, we are notifying you, as operators of an offsetting unit, of our application for administrative approval. Enclosed are three copies of this letter. If there is no objection to this location, please sign and return one copy to the New Mexico Oil Conservation Commission, Post Office Box 2088, Santa Fe, New Mexico 87501; one copy to El Paso Natural Gas Company; and keep one copy for your files.

A plat showing the proposed well location and offsetting Mesa Verde ownership is attached.

Yours truly,

L. A. Aimes
Sr. Drilling Engineer

TOC W.I. _____
TOC Net _____
Date Rec. 1-20-78
Date Out. 1-27-78

LAA:pb

Approved: _____

ORIGINAL
SIGNED BY: D. D. MYERS

Date: _____

1-27-78

OIL CONSERVATION COMMISSION
Antec DISTRICT

JAN 31 1978
OIL CONSERVATION COMMISSION

OIL CONSERVATION COMMISSION
BOX 2088
SANTA FE, NEW MEXICO

DATE 1-27-78

RE: Proposed MC _____
Proposed DHC _____
Proposed NSL ✓ _____
Proposed SWD _____
Proposed WFX _____
Proposed PMX _____

Dick Stamets

Gentlemen:

I have examined the application dated 1-13-78
for the El Paso Natural Gas Co San Juan 29-72 Unit # 89A
Operator Lease and Well No. Unit, S-T-R
E-7-29N-7W
and my recommendations are as follows:

Approve

Yours very truly,

AR Kendrick