

OIL CONSERVATION DIVISION
PO Box 2088
Santa Fe, NM 87504-2088

☐ AMENDED REPORT

'95 APR 21 PM 8 52

I. REQUEST FOR ALLOWABLE AND AUTHORIZATION TO TRANSPORT

Operator name and Address CONOCO INC. 10 Desta Drive Ste 100W MIDLAND, TEXAS 79705		OGRID Number 005073
Reason for Filing Code CH (EFFECTIVE 3-1-95) CO (EFFECTIVE 4-1-95)		
API Number 30 - 0 39-60071	Pool Name BLANCO MESAVERDE	Pool Code 72319
Property Code 10000	Property Name SAN JUAN 28-7 Unit	Well Number 68

II. Surface Location

UL or lot no.	Section	Township	Range	Lot Ida	Feet from the	North/South Line	Feet from the	East/West line	County
B	31	28 N	7 W		990	NORTH	1650	EAST	RIO ARriba

III. Bottom Hole Location

UL or lot no.	Section	Township	Range	Lot Ida	Feet from the	North/South line	Feet from the	East/West line	County
Lee Code F	Producing Method Code P	Gas Connection Date	C-129 Permit Number	C-129 Effective Date	C-129 Expiration Date				

III. Oil and Gas Transporters

Transporter OGRID	Transporter Name and Address	POD	O/G	POD ULSTR Location and Description
014538	MERIDIAN OIL INC. P.O. BOX 4289 FARMINGTON, NM. 87499	94710	0	B 31 28N 7W
007057	EL PASO NATURAL GAS CO. P.O. BOX 4990 FARMINGTON, NM 87499	94730	G	B 31 28N 7W
009018	GIANT REFINERY P.O. BOX 338 BLOOMFIELD, NM 87413	94710	0	B 31 28N 7W EFFECTIVE 4-1-95

IV. Produced Water

POD	POD ULSTR Location and Description
94750	B 31 28N 7W

V. Well Completion Data

Spud Date	Ready Date	TD	PBTD	Perforations
Hole Size	Casing & Tubing Size	Depth Set	Sack Cement	
			FEB 17 1995	
			OIL CON. DIV.	
			DIST. 3	

VI. Well Test Data

Date New Oil	Gas Delivery Date	Test Date	Test Length	Tbg. Pressure	Cag. Pressure
Choke Size	Oil	Water	Gas	AOF	Test Method
I hereby certify that the rules of the Oil Conservation Division have been complied with and that the information given above is true and complete to the best of my knowledge and belief. Signature: <i>Bill R. Keathly</i> Printed name: BILL R. KEATHLY Title: SR. REGULATORY SPEC. Date: 2-25-95			OIL CONSERVATION DIVISION Approved by: <i>378</i> SUPERVISOR DISTRICT #3 Title: Approval Date: FEB 17 1995 Phone: (915) 686-5424		

If this is a change of operator fill in the OGRID number and name of the previous operator 00778

Previous Operator Signature	Printed Name	Title	Date
<i>B. Shaw</i>	Buddy Shaw	Enviro Coordinator	2/15/95

UNITED STATES
DEPARTMENT OF THE INTERIOR
BUREAU OF LAND MANAGEMENT

FORM APPROVED
Budget Bureau No. 1004-0135
Expires: March 31, 1993

SUNDRY NOTICES AND REPORTS ON WELLS

Do not use this form for proposals to drill or to deepen or reentry to a different reservoir.

APPLICATION FOR PERMIT - " for such proposals

5. Lease Designation and Serial No.

SF078500A

6. If Indian, Allottee or Tribe Name

7. If Unit or CA, Agreement Designation

8. Well Name and No.

San Juan 28-7NP 68

9. API Well No.

3003960071

10. Field and Pool, or Exploratory Area

Blanco Mesaverde

11. County or Parish, State

Rio Arriba New Mexico

1. Type of Well

☐ Oil Well ☒ Gas Well ☐ Other

2. Name of Operator

Amoco Production Company

Attention:

Gail M. Jefferson, Rm 1942

3. Address and Telephone No.

P.O. Box 800, Denver, Colorado 80201

(303) 830-6157

4. Location of Well (Footage, Sec., T., R., M., or Survey Description)

990' FNL 1650' FEL Sec. 31 T 28N R 7W Unit B

12. CHECK APPROPRIATE BOX(s) TO INDICATE NATURE OF NOTICE, REPORT, OR OTHER DATA

TYPE OF SUBMISSION

- ☐ Notice of Intent
☒ Subsequent Report
☐ Final Abandonment Notice

TYPE OF ACTION

- ☐ Abandonment
☐ Recompletion
☐ Plugging Back
☐ Casing Repair
☐ Altering Casing
☒ Other Bradenhead Repair
☐ Change of Plans
☐ New Construction
☐ Non-Routine Fracturing
☐ Water Shut-Off
☐ Conversion to Injection
☐ Dispose Water

(Note: Report results of multiple completion on Well Completion or Recompletion Report and Log form.)

13. Describe Proposed or Completed Operations (Clearly state all pertinent details, and give pertinent dates, including estimated date of starting any proposed work. If well is directionally drilled, give subsurface locations and measured and true vertical depths for all markers and zones pertinent to this work.)*

The Bradenhead repair for this well was completed as follows: MIRU 2/9/95. set tbq plug at 4100', blew down tbq. Set pkr 1 joint deep, bradenhead blew down immediately. TOH w/tbg & pkr, set rbp at 2005' and pres test csg to 1000#. Csg held press. Installed new seals to stop communication w/bradenhead TOH w.RBP. TIH w/tbg set at 4769'. 2jts of pitted tbq was replaced. Tested bradenhead 2/16/95 32 runs for a total of 72 bbls recovered, flowed for 30 min, recovered 5 bbls (total load = 88.5 bbls, LTR = 11 1/2 bbls). 2/17/95 BH = 0, Csg = 350 psi, unseat BP and TOH, TIH w/tbg to 4741' n-w/SN on bottom:

RECEIVED
MAR 13 1995
OIL & GAS DIV.
DENVER

14. I hereby certify that the foregoing is true and correct

Signed

Gail M. Jefferson

Title

Business Assistant

Date

03-03-1995

(This space for Federal or State office use)

Approved by

Conditions of approval, if any:

Title

Date

MAR 08 1995

Title 18 U.S.C. Section 1001, makes it a crime for any person knowingly and willfully to make to any department or agency of the United States any false, fictitious or fraudulent statements or representations as to any matter within its jurisdiction.

UNITED STATES
DEPARTMENT OF THE INTERIOR
BUREAU OF LAND MANAGEMENT
CONSERVATION DIVISION
RECEIVED
FEB 10 1995

FORM APPROVED
Budget Bureau No. 1004-0135
Expires: March 31, 1993

SUNDRY NOTICES AND REPORTS ON WELLS

Do not use this form for proposals to drill or to deepen or reentry to a different reservoir.
Use "APPLICATION FOR PERMIT - " for such proposals

5. Lease Designation and Serial No.

52 SF 078500

6. If Indian, Allottee or Tribe Name

7. If Unit or CA, Agreement Designation

8. Well Name and No.

San Juan 28-7 NP 68

9. API Well No.

3003960071

10. Field and Pool, or Exploratory Area

Blanco Mesaverde

11. County or Parish, State

Rio Arriba New Mexico

1. Type of Well
☐ Oil Well ☒ Gas Well ☐ Other

2. Name of Operator

AMOCO PRODUCTION COMPANY

Attention:

Gail Jefferson Room 1942

3. Address and Telephone No.

P.O. Box 800, Denver, Colorado 80201

(303) 830-6157

4. Location of Well (Footage, Sec., T., R., M., or Survey Description)

990' FNL 1650' FEL Sec. 31 T 28N R 7W Unit B

12. CHECK APPROPRIATE BOX(s) TO INDICATE NATURE OF NOTICE, REPORT, OR OTHER DATA

TYPE OF SUBMISSION	TYPE OF ACTION	
<input checked="" type="checkbox"/> Notice of Intent	<input type="checkbox"/> Abandonment	<input type="checkbox"/> Change of Plans
<input type="checkbox"/> Subsequent Report	<input type="checkbox"/> Recompletion	<input type="checkbox"/> New Construction
<input type="checkbox"/> Final Abandonment Notice	<input type="checkbox"/> Plugging Back	<input type="checkbox"/> Non-Routine Fracturing
	<input type="checkbox"/> Casing Repair	<input type="checkbox"/> Water Shut-Off
	<input type="checkbox"/> Altering Casing	<input type="checkbox"/> Conversion to Injection
	<input checked="" type="checkbox"/> Other Bradenhead Repair	<input type="checkbox"/> Dispose Water

(Note: Report results of multiple completion on Well Completion or Recompletion Report and Log form.)

13. Describe Proposed or Completed Operations (Clearly state all pertinent details, and give pertinent dates, including estimated date of starting any proposed work. If well is directionally drilled, give subsurface locations and measured and true vertical depths for all markers and zones pertinent to this work.)*

Amoco proposes to perform a Bradenhead repair per the procedures attached.

RECEIVED
FEB 17 1995
OIL CON. DIV.
DIST. 8

NO. 1004-0135
FEB 10 1995

14. I hereby certify that the foregoing is true and correct

Signed

Gail M. Jefferson

Title

Business Assistant

Date

02-08-1995

(This space for Federal or State office use)

Approved by

Title

Conditions of approval, if any:

APPROVED

FEB 13 1995

Title 18 U.S.C. Section 1001, makes it a crime for any person knowingly and willfully to make to any department or agency of the United States any false, fictitious or fraudulent representations as to any matter within its jurisdiction.



SJOET Well Work Procedure

SJ 28-7 #68

93 FEB 10 11:12:58

Version: #1
Date: February 9, 1995
Budget: DRA
Repair Type: Bradenhead

070 F... ..

Objectives:

1. Test wellhead for seal leak, if no leak found continue with procedure as outlined.
2. Casing will be pressure tested..
3. CBL will be run to determine top of cement
4. Remedial cementing will be performed to insure zonal isolation.
5. Return well to production

Pertinent Information:

Location:	990' FNL, 1650' FEL, S31, T28N, R7W	Horizon:	MV
County:	Rio Arriba	API #:	300-39-60071
State:	New Mexico	Engr:	Kwartin
Lease:	SF-078500	Phone:	H--(303)343-3973
Well Flac:			W-(303)830-5708
			P--(303)553-6332

Economic Information:

APC WI:	0%	MV Prod. Before Repair:	200 MCFD
Conoco WI:	100%	MV Anticipated Prod.:	200 MCFD
Estimated Cost:	\$42,500		
Payout:	6 YEARS		
Max Cost -12 Mo. P.O.	NA		

Note: Economics will be run on all projects that have a payout exceeding ONE year.

***Note:** Economics run based upon 200 MCFD production vs 0 MCFD.

Formation Tops: (Estimated formation tops)

Nacimiento:		Menefee:	4213'
Ojo Alamo:		Point Lookout:	4684'
Kirtland Shale:		Mancos Shale:	4853'
Fruitland:	2049'	Gallup:	
Pictured Cliffs:	2485'	Graneros:	
Lewis Shale:		Dakota:	
Cliff House:	4149'	Morrison:	

Bradenhead Test Information:

Test Date: 7/6/94 Tubing: 331 psi Casing: 335 psi BH: 335 psi

Time	BH	CSG	INT	CSG
5 min	156			
10 min	148			
15 min	137			

Comments: Bradenhead has steady flow of gas.

SJ 28-7 #68

Orig. Comp. 4/57

TD = 4872', PBTD = 4835'

Page 2 of 3

1. Contact Federal or State agency prior to starting repair work.
2. Catch gas and/or water sample off of bradenhead and casing, and have analyzed.
3. Install and/or test anchors.
4. MIRUSU. Check and record tubing, casing and bradenhead pressures.
5. Blow well down, kill well if necessary with 2% KCL.
6. Nipple down well head, nipple up and pressure test BOP's.
7. Trip in the hole and tag PBTD, check for fill, trip and tally out of hole with tubing checking condition of tubing.
8. Trip in the hole with bit and scraper for the intermediate casing and trip in to the top of the liner. Trip out of the hole with bit and scraper. Trip in hole with second bit and scraper and run from the top of the liner to the top of the perforations. A seating nipple and standing valve may be run in order to pressure test the tubing.
9. Trip in the hole with RBP and PKR. Set RBP 50-100 ft. above perforations. Trip out of hole one joint and set PKR and pressure test RBP to 1500 psi. Release PKR, spot sand on RBP and pressure test csg to 1000 psi. If no leak is found, trip out of hole with PKR and skip to step 11.
10. Trip out of hole isolating leak in liner, if any. If a liner leak is found, establish injection rate and check for circulation around liner top. Also, determine if there is a leak above the top of the liner. Trip out of hole with PKR.
11. Determine from well file and history, the interval a CBL needs to be run between the RBP and the surface. If a CBL is needed, run CBL over the interval necessary under 1000 psi and report results to Denver. Different size CBL tools may be required in the liner versus the intermediate casing.
12. If there are no casing leaks, skip to step 14.
13. If there is a leak in the liner and a leak above the top of the liner, trip in hole with a RBP that fits the liner and a PKR that fits the intermediate casing. Set RBP 30-60' below the top of the liner. Release PKR and trip out of hole isolating leak in the intermediate casing.
14. Based on the location of the leak, if any, and the results of the CBL, perforate casing if necessary with 4 JSPF and circulate dye if possible to determine cement volume. Depending on the depth of the hole and circulating pressure, a PKR or a cement retainer may be needed.
15. Mix and pump sufficient cement (class B or equivalent with two hour setting time) to circulate to surface, if circulation to surface is possible. Shut bradenhead valve and attempt to obtain a squeeze pressure and WOC.
16. Trip out of hole. Trip in the hole with bit and scraper and drill out cement and pressure test casing. Re-squeeze leaks if casing fails pressure test.
17. If cement is not circulated to the surface, it may be necessary to run another CBL (and/or temperature survey 8-10 hours after cementing) and repeat steps 14 thru 16.

SJ 28-7 #68
Orig. Comp. 4/57
TD = 4872', PBTD = 4835'
Page 3 of 3

18. Trip in the hole with retrieving head for RBP, circulate sand off of RBP and trip out of hole with plug.
19. If there is a leak in the liner top, trip in hole with a PKR. If there is no leak in the liner top, skip to step 22.
20. Mix and pump sufficient cement (class B or equivalent with two hour setting time) to squeeze liner top. Attempt to obtain a squeeze pressure and WOC.
21. Trip in the hole with bit and scraper and drill out cement and pressure test casing. Re-squeeze leak if liner top fails pressure test.
22. If there is a second RBP in the liner, trip in the hole with a retrieving head, circulate sand off of the RBP and trip out of hole with the plug.
23. If there is a leak in the liner or squeeze work is required based on the CBL, perforate casing, if necessary with 4 JSPF. Trip in hole with a cement retainer and set above the leak or perforations.
24. Mix and pump sufficient cement (class B or equivalent with two hour setting time) and attempt to obtain a squeeze pressure and WOC.
25. Trip in the hole with bit and scraper and drill out cement and pressure test casing. Re-squeeze leaks if casing fails pressure test.
26. Trip in the hole with retrieving head for RBP set in the liner, circulate sand off of RBP with 2% KCL and trip out of hole with plug.
27. Trip in hole with a sawtooth collar and/or bailer and clean out to PBTD and trip out of hole.
28. Trip in the hole with the production string (1/2 mule shoe on bottom and a seating nipple one joint off bottom), land tubing to original depth. Nipple down BOP's, nipple up well head.
29. Swab well in and put well on production.
30. Rig down move off service unit.

If problems are encountered, please contact:

Lara Kwartin

(W) (303) 830-5708
(H) (303) 343-3973

Amoco Production Company

Sheet No _____ or _____
File _____

ENGINEERING CHART

Appn _____

SUBJECT SJ 28-7 #68NP

Date 2-2-95

31-28N-7W

TESTED TO 2112:50

By SGK

Completed 4/57

OTO 11-11-95, TCM

330

330

330

Tested 1-11-95

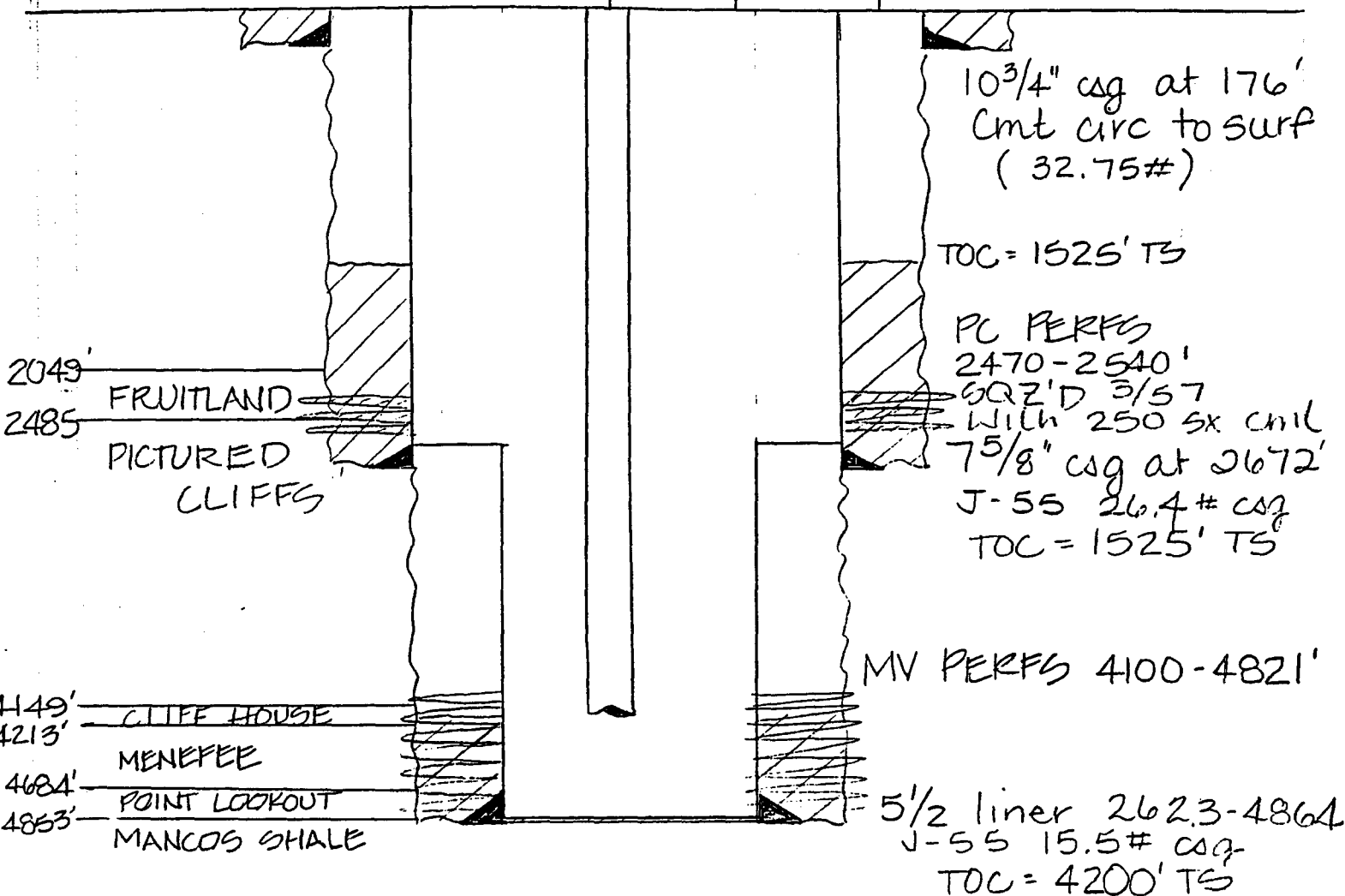

SAN JUAN 28 7 UNIT NP 68

Operator - AMOCO PRODUCTION C

300396007100MV B312807-068 MV

APC_WI - 0.50000000

Fract: 7r0r06

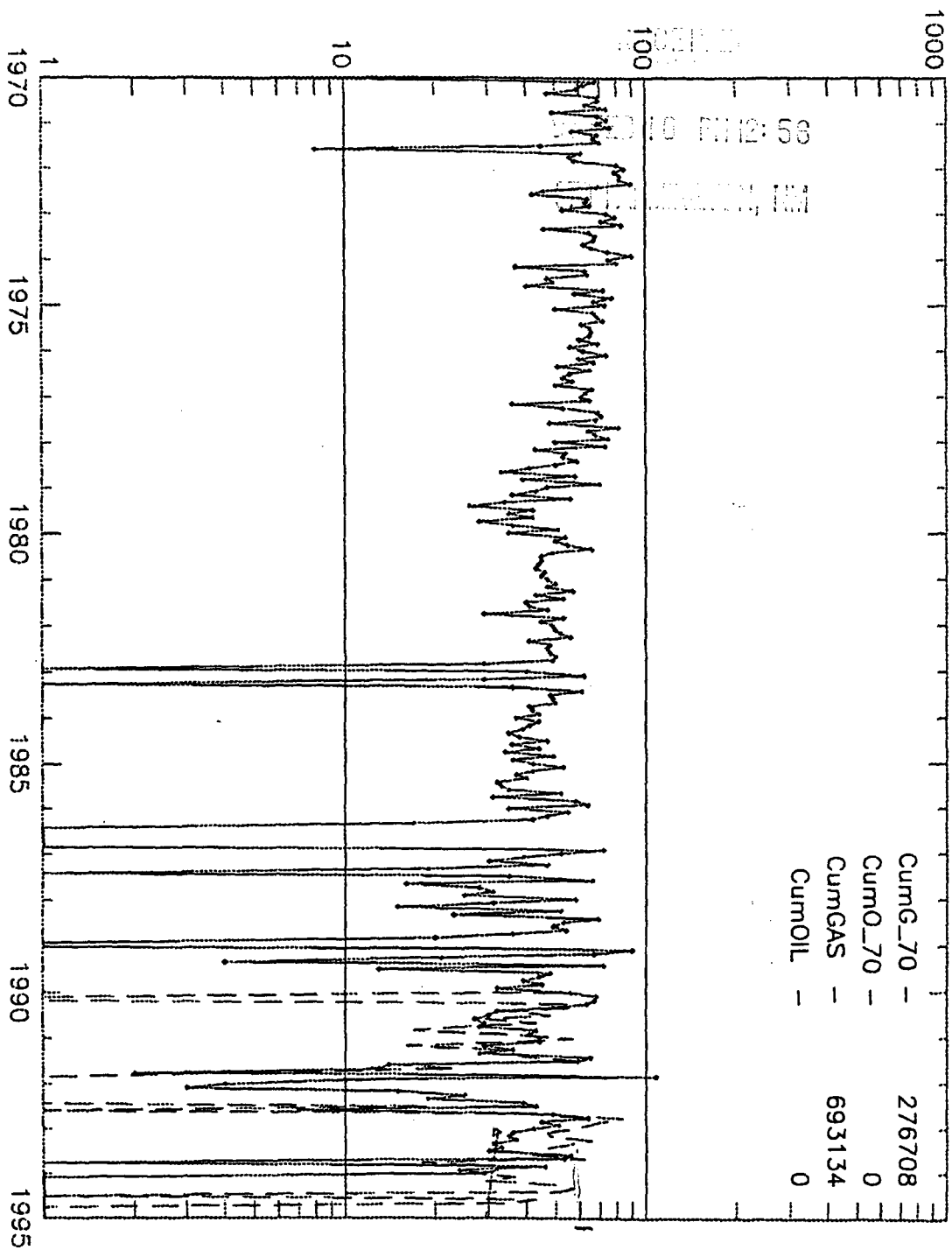

BRADENHEAD TEST REPORT

71798

48

DATE

7-6-94

OPERATOR AMOCO PRODUCTION COMPANY

Wellname: SAN JUAN 28-7 NP

Well No. 068

Formation: MV

Section: B31 TOWNSHIP: 28N

Range: 07W

INITIAL PRESSURE (psi)

Well Status (Circle One) SHUT-IN FLOWING

No. of Casing Strings (Circle One) TWO (Production and Surface) THREE (Intermediate, Production and Surface)

Pressure: Tubing 331 (psi) Intermediate NA (psi) Casing 335 (psi) Bradenhead 335 (psi)

INSTRUCTIONS FOR TESTING WELLS WITH TWO (2) CASING STRINGS:

- A. Open bradenhead to atmosphere.
- B. Record casing pressure every 5 minutes.
- C. Note characteristics of bradenhead flow.
- D. Describe any water flow.

INSTRUCTIONS FOR TESTING WELLS WITH THREE (3) CASING STRINGS:

- A. Open intermediate casing to atmosphere.
- B. Record casing and bradenhead pressure every 5 minutes.
- C. Note characteristics of intermediate flow.
- D. Describe any water flow from the intermediate.
- E. Open bradenhead to the atmosphere.
- F. Record casing and intermediate pressures every 5 minutes.
- G. Note characteristics of bradenhead flow.
- H. Describe any water flow from the bradenhead.

Shut in intermediate valve.

PRESSURE (psi)

Time	Bradenhead	Casing	Intermediate	Casing
5 min	<u>156</u>	<u>328</u>	<u>NA</u>	
10 min	<u>148</u>	<u>321</u>		
15 min	<u>137</u>	<u>315</u>		
20 min	<u>133</u>	<u>309</u>		
25 min	<u>128</u>	<u>305</u>		
30 min	<u>121</u>	<u>302</u>		

FLOW CHARACTERISTICS

Bradenhead Intermediate

DESCRIBE ANY WATER FLOW

Bradenhead Intermediate

Steady Flow

Surges

Down to Nothing

No Flow

Gas

Water

Gas and Water

Clear

Fresh

Salty

Sulfur

Black

Muddy

REMARKS:

Bradenhead has steady flow of gas, it is pulling well casing & tubing BT down while venting gas from bradenhead

DATE: 7-6-94

BY: Lane Farnsworth

(June 1990)

UNITED STATES
DEPARTMENT OF THE INTERIOR
BUREAU OF LAND MANAGEMENT

FORM APPROVED
Budget Bureau No. 1004-0135
Expires: March 31, 1993

SUNDRY NOTICES AND REPORTS ON WELLS
RECEIVED

Do not use this form for proposals to drill or to deepen or reentry to a different reservoir.

Use "APPLICATION FOR PERMIT - " for such proposals.

53 JUN 21 AM 9 53

1. Type of Well
☐ Oil Well ☒ Gas Well ☐ Other

2. Name of Operator
Amoco Production Company Attention E. R. Nicholson

3. Address and Telephone No.
P. O. Box 800, Denver, Colorado 80201 (303) 830-5014

4. Location of Well (Footage, Sec., T., R., M., or Survey Description)

See Below

5. Lease Designation and Serial No.

See Below

6. If Indian, Allottee or Tribe Name

7. If Unit or CA, Agreement Designation

8. Well Name and No.

See Below

9. API Well No.

See Below

10. Field and Pool, or Exploratory Area

See Below

11. County or Parish, State

Rio Arriba, NM

12. CHECK APPROPRIATE BOX(S) TO INDICATE NATURE OF NOTICE, REPORT, OR OTHER DATA

TYPE OF SUBMISSION

TYPE OF ACTION

- ☐ Notice of Intent
☒ Subsequent Report
☐ Final Abandonment Notice

RECEIVED
MAY 1 0 1993
OIL CON. DIV
DIST 2

- ☐ Abandonment
☐ Recompletion
☐ Plugging Back
☐ Casing Repair
☐ Altering Casing
☐ Other

- ☒ Change of Plans
☐ New Construction
☐ Non-Routine Fracturing
☐ Water Shut-Off
☐ Conversion to Injection
☐ Dispose Water

(Note: Report results of multiple completion on Well Completion or Recompletion Report and Log form.)

13. Describe Proposed or Completed Operations (Clearly state all pertinent details, and give pertinent dates, including estimated date of starting any proposed work. If well is directionally drilled, give subsurface locations and measured and true vertical depths for all markers and zones pertinent to this work.)

Per conversation with Ken an Wayne Townsend this date, due to the low priority of the following wells, it is requested that approval be given to cancel the bradenhead procedures at this time.

San Juan 28-7 Unit #33 (SF-079290) - Blanco Mesaverde, 800' FNL, 990' FEL, Sec. 13, T28N-R7W Unit "A", API #30 039 07438
San Juan 28-7 Unit #136 (SF-079289) - Basin Dakota, 1650' FSL, 1650' FEL, Sec. 14, T28N-R7W Unit "J", API #30 039 07408
San Juan 28-7 Unit #218 (SF-079289) - Basin Dakota, 1175' FSL, 1540' FWL, Sec. 12, T28N-R7W, API #30 039 20879
San Juan 28-7 NP #68 (SF-078500-A) - Blanco Mesaverde, 990' FNL, 1650' FEL, Sec. 31, T28N-R7W Unit "B", API #30 039 60071
San Juan 28-7 Unit #21 (SF-078497-A) - Blanco Mesaverde, 1080' FSL, 1650' FWL, Sec. 9, T28N-R7W Unit "N", API #30 039 07449
San Juan 28-7 Unit #241 (SF-078497-A) - Basin Dakota, 1690' FSL, 810' FWL, Sec. 9, T28N-R7W Unit "L", API #30 039 08100
San Juan 28-7 Unit #242E (SF-078497) - Basin Dakota, 900' FSL, 800' FWL, Sec. 7, T28N-R7W Unit "M", API #30 039 22359
San Juan 28-7 Unit #195E (SF-078497) - Basin Dakota, 1050' FNL, 1035' FEL Sec. 16, T28N-R7W, API #30 039 22361
San Juan 28-7 Unit #61 (SF-079289) - Blanco Mesaverde, 1550' FSL, 1650' FWL Sec. 10, T28N-R7W Unit "K", API #30 039 07460

14. I hereby certify that the foregoing is true and correct

Signed

ER Nicholson

Title

By Adm Analyst

Date

4-29-93

(This space for Federal or State office use)

ACCEPTED FOR RECORD

Approved by

Conditions of approval, if any:

AMOCB

MAY 05 1993

Title 18 U.S.C. Section 1001, makes it a crime for any person knowingly and willfully to make to any department or agency of the United States any false, fictitious or fraudulent statements or representations as to any matter within its jurisdiction.

BY

UNITED STATES
DEPARTMENT OF THE INTERIOR
BUREAU OF LAND MANAGEMENT

OIL CONSERVATION DIVISION
RECEIVED

FORM APPROVED
Budget Bureau No. 1004-0135
Expires: March 31, 1993

SUNDRY NOTICES AND REPORTS ON WELLS

Do not use this form for proposals to drill or to deepen or reentry to a different reservoir.
Use "APPLICATION FOR PERMIT—" for such proposals

SUBMIT IN TRIPLICATE

1. Type of Well
☐ Oil Well ☒ Gas Well ☐ Other

2. Name of Operator
Amoco Production Company Attn: John Hampton

3. Address and Telephone No.
P.O. Box 800 Denver, Colorado 80201

4. Location of Well (Footage, Sec., T., R., M., or Survey Description)
990' FNL, 1650' FEL Sec. 31, T28N-R7W: Unit "B"

5. Lease Designation and Serial No.
15 SF-078500-A

6. If Indian, Allottee or Tribe Name

7. If Unit or CA, Agreement Designation

8. Well Name and No.
San Juan 28-7 NP #68

9. API Well No.
30-039-60071

10. Field and Pool, or Exploratory Area
Blanco Mesaverde

11. County or Parish, State
Rio Arriba, NM

12. CHECK APPROPRIATE BOX(S) TO INDICATE NATURE OF NOTICE, REPORT, OR OTHER DATA

TYPE OF SUBMISSION	TYPE OF ACTION	
<input checked="" type="checkbox"/> Notice of Intent	<input type="checkbox"/> Abandonment	<input type="checkbox"/> Change of Plans
<input type="checkbox"/> Subsequent Report	<input type="checkbox"/> Recompletion	<input type="checkbox"/> New Construction
<input type="checkbox"/> Final Abandonment Notice	<input type="checkbox"/> Plugging Back	<input type="checkbox"/> Non-Routine Fracturing
	<input type="checkbox"/> Casing Repair	<input type="checkbox"/> Water Shut-Off
	<input type="checkbox"/> Altering Casing	<input type="checkbox"/> Conversion to Injection
	<input checked="" type="checkbox"/> Other Bradenhead Repair	<input type="checkbox"/> Dispose Water

(Note: Report results of multiple completion on Well Completion or Recompletion Report and Log form.)

13. Describe Proposed or Completed Operations (Clearly state all pertinent details, and give pertinent dates, including estimated date of starting any proposed work. If well is directionally drilled, give subsurface locations and measured and true vertical depths for all markers and zones pertinent to this work.)

Amoco intends to perform the attached workover procedure required to eliminate bradenhead pressure.

In addition, Amoco also requests approval to construct a temporary 15'X15'X 5' blow pit for return fluids. This pit will be reclaimed if utilized, upon completion of this operation.

RECEIVED
MAR 5 1992
OIL CON. DIV
DIST. 3

RECEIVED
MAR 19 1992
AM 10:00

Please contact Cindy Burton (303) 830-5119 if you have any questions.

14. I hereby certify that the foregoing is true and correct

Signed John Hampton

Title Sr. Staff Admin. Supv.

APPROVED

(This space for Federal or State office use)

Approved by
Conditions of approval, if any:

Title

MAR 03 1992

AREA MANAGER

NMOCD

the number of
ca, or regional
e issued by, or may
file.

SAN JUAN 28-7 #68
LOCATION, 31B-T28N-R7W
DUAL, CH PC MV
ORIGINAL COMPLETION 4/57
LAST FILE UPDATE 10/91 BY CSW

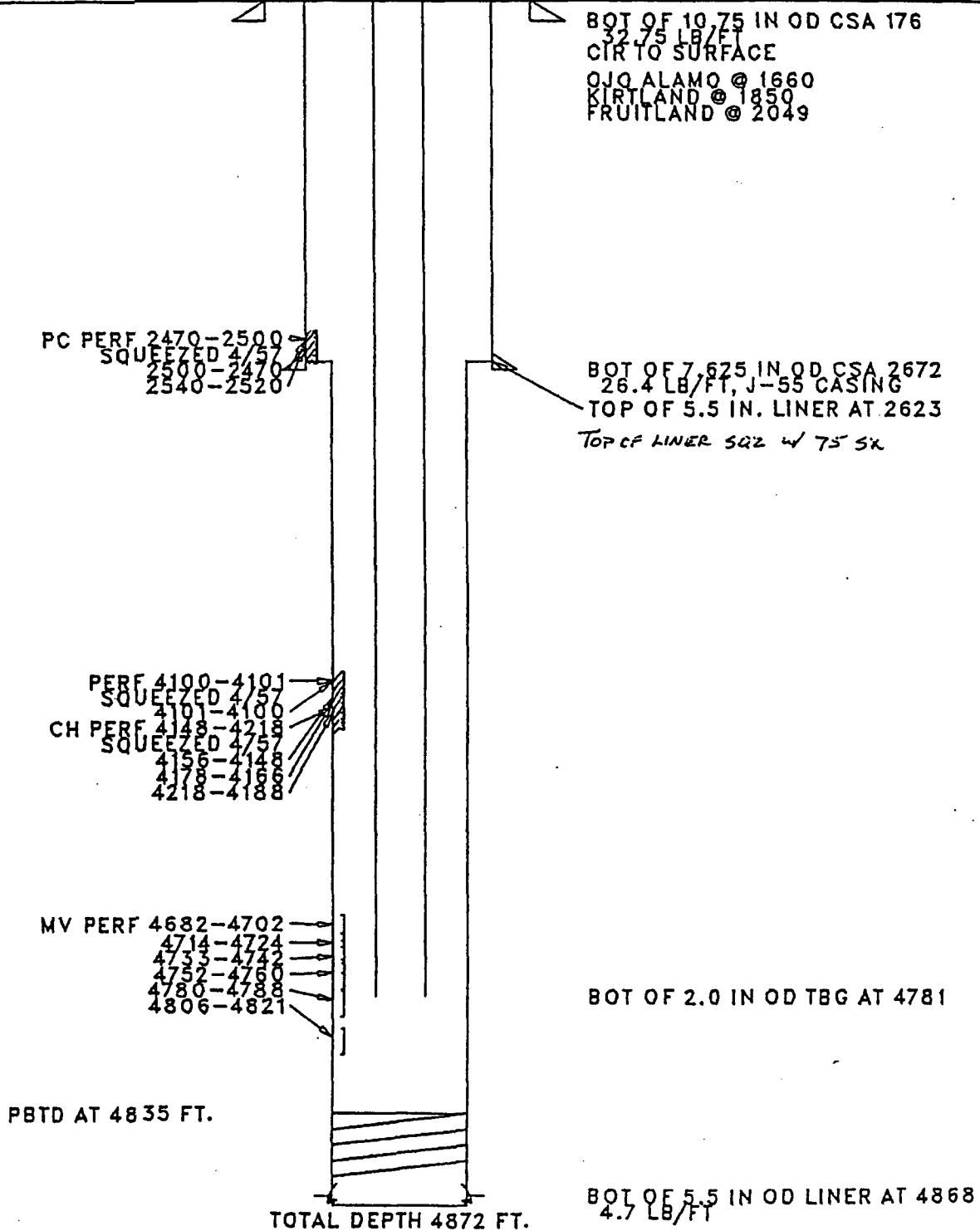

Workover Procedure
San Juan 28-7 #68
Sec.31-T28N-R07W
San Juan County, NM

1. Contact Federal or State agency prior to starting repair work.
2. Catch gas and/or water sample off of bradenhead and casing, and have analyzed.
3. Install and/or test anchors.
4. MIRUSU. Check and record tubing, casing and bradenhead pressures.
5. Blow well down, kill well if necessary with 2% KCL.
6. Nipple down well head, nipple up and pressure test BOP's.
7. Trip in the hole and tag PBTD, check for fill, trip and tally out of hole with tubing checking condition of tubing.
8. Trip in the hole with bit and scraper for the intermediate casing and trip in to the top of the liner. Trip out of the hole with bit and scraper. Trip in hole with second bit and scraper and run from the top of the liner to the top of the perforations. A seating nipple and standing valve may be run in order to pressure test the tubing.
9. Trip in the hole with RBP and PKR. Set RBP 50-100 ft. above perforations. Trip out of hole one joint and set PKR and pressure test RBP to 1500 psi. Release PKR, spot sand on RBP and pressure test csg to 1000 psi. If no leak is found, trip out of hole with PKR and skip to step 11.
10. Trip out of hole isolating leak in liner, if any. If a liner leak is found, establish injection rate and check for circulation around liner top. Also, determine if there is a leak above the top of the liner. Trip out of hole with PKR.
11. Determine from well file and history, the interval a CBL needs to be run between the RBP and the surface. If a CBL is needed, run CBL over the interval necessary under 1000 psi and report results to Denver. Different size CBL tools may be required in the liner versus the intermediate casing.
12. If there are no casing leaks, skip to step 14.

25. Trip in the hole with bit and scraper and drill out cement and pressure test casing. Re-squeeze leaks if casing fails pressure test.
26. Trip in the hole with retrieving head for RBP set in the liner, circulate sand off of RBP with 2% KCL and trip out of hole with plug.
27. Trip in hole with a sawtooth collar and/or bailer and clean out to PBTD and trip out of hole.
28. Trip in the hole with the production string (1/2 mule shoe on bottom and a seating nipple one joint off bottom), land tubing to original depth. Nipple down BOP's, nipple up well head.
29. Swab well in and put well on production.
30. Rig down move off service unit.

13. If there is a leak in the liner and a leak above the top of the liner, trip in hole with a RBP that fits the liner and a PKR that fits the intermediate casing. Set RBP 30-60' below the top of the liner. Release PKR and trip out of hole isolating leak in the intermediate casing.
14. Based on the location of the leak, if any, and the results of the CBL, perforate casing if necessary with 4 JSPF and circulate dye if possible to determine cement volume. Depending on the depth of the hole and circulating pressure, a PKR or a cement retainer may be needed.
15. Mix and pump sufficient cement (class B or equivalent with two hour setting time) to circulate to surface, if circulation to surface is possible. Shut bradenhead valve and attempt to obtain a squeeze pressure and WOC.
16. Trip out of hole. Trip in the hole with bit and scraper and drill out cement and pressure test casing. Re-squeeze leaks if casing fails pressure test.
17. If cement is not circulated to the surface, it may be necessary to run another CBL (and/or temperature survey 8-10 hours after cementing) and repeat steps 14 thru 16.
18. Trip in the hole with retrieving head for RBP, circulate sand off of RBP and trip out of hole with plug.
19. If there is a leak in the liner top, trip in hole with a PKR. If there is no leak in the liner top, skip to step 22.
20. Mix and pump sufficient cement (class B or equivalent with two hour setting time) to squeeze liner top. Attempt to obtain a squeeze pressure and WOC.
21. Trip in the hole with bit and scraper and drill out cement and pressure test casing. Re-squeeze leak if liner top fails pressure test.
22. If there is a second RBP in the liner, trip in the hole with a retrieving head, circulate sand off of the RBP and trip out of hole with the plug.
23. If there is a leak in the liner or squeeze work is required based on the CBL, perforate casing, if necessary with 4 JSPF. Trip in hole with a cement retainer and set above the leak or perforations.
24. Mix and pump sufficient cement (class B or equivalent with two hour setting time) and attempt to obtain a squeeze pressure and WOC.

OIL CONSERVATION DIVISION

P.O. Box 2088
Santa Fe, New Mexico 87504-2088

RECEIVED

REQUEST FOR ALLOWABLE AND AUTHORIZATION
TO TRANSPORT OIL AND NATURAL GAS

JUN 14 1989

Operator Amoco Production Company		Well APT No. 3003960071
Address 1670 Broadway, P. O. Box 800, Denver, Colorado 80201		
Reason(s) for Filing (Check proper box) <input type="checkbox"/> Other (Please explain)		
New Well <input type="checkbox"/>	Change in Transporter of:	
Recompletion <input type="checkbox"/>	Oil <input type="checkbox"/>	Dry Gas <input type="checkbox"/>
Change in Operator <input checked="" type="checkbox"/>	Casinghead Gas <input type="checkbox"/>	Condensate <input type="checkbox"/>
If change of operator give name and address of previous operator Tenneco Oil E & P, 6162 S. Willow, Englewood, Colorado 80155		

OIL CONSERVATION DIV.
SANTA FE

II. DESCRIPTION OF WELL AND LEASE

Lease Name SAN JUAN 28-7 UNIT NP	Well No. 68	Pool Name, Including Formation BLANCO (MESAVERDE)	FEDERAL	Lease No. SF078500A
Location				
Unit Letter B	990	Feet From The FNL	Line and 1650	Feet From The FEL Line
Section 31	Township 28N	Range 7W	NMPM,	RIO ARriba County

III. DESIGNATION OF TRANSPORTER OF OIL AND NATURAL GAS

Name of Authorized Transporter of Oil <input type="checkbox"/> or Condensate <input checked="" type="checkbox"/>	Address (Give address to which approved copy of this form is to be sent) P. O. BOX 1429, BLOOMFIELD, NM 87413
Name of Authorized Transporter of Casinghead Gas <input type="checkbox"/> or Dry Gas <input checked="" type="checkbox"/>	Address (Give address to which approved copy of this form is to be sent) P. O. BOX 1492, EL PASO, TX 79978
If well produces oil or liquids, give location of tanks.	Unit Sec. Twp. Rge. Is gas actually connected? When ?

If this production is commingled with that from any other lease or pool, give commingling order number:

IV. COMPLETION DATA

Designate Type of Completion - (X)	Oil Well	Gas Well	New Well	Workover	Deepen	Plug Back	Same Res'v	Diff Res'v
Date Spudded	Date Compl. Ready to Prod.		Total Depth		P.B.T.D.			
Elevations (DF, RKB, RF, GR, etc.)	Name of Producing Formation		Top Oil/Gas Pay		Tubing Depth			
Perforations					Depth Casing Shoe			

TUBING, CASING AND CEMENTING RECORD

HOLE SIZE	CASING & TUBING SIZE	DEPTH SET	SACKS CEMENT

V. TEST DATA AND REQUEST FOR ALLOWABLE

OIL WELL (Test must be after recovery of total volume of load oil and must be equal to or exceed top allowable for this depth or be for full 24 hours.)

Date First New Oil Run To Tank	Date of Test	Producing Method (Flow, pump, gas lift, etc.)	
Length of Test	Tubing Pressure	Casing Pressure	Choke Size
Actual Prod. During Test	Oil - Bbls.	Water - Bbls.	Gas - MCF

GAS WELL

Actual Prod. Test - MCF/D	Length of Test	Bbls. Condensate/MMCF	Gravity of Condensate
Testing Method (pilot, back pr.)	Tubing Pressure (Shut-in)	Casing Pressure (Shut-in)	Choke Size

VI. OPERATOR CERTIFICATE OF COMPLIANCE

I hereby certify that the rules and regulations of the Oil Conservation Division have been complied with and that the information given above is true and complete to the best of my knowledge and belief.

J. L. Hampton
Signature

J. L. Hampton Sr. Staff Admin. Suprv.
Printed Name Title
January 16, 1989 303-830-5025
Date Telephone No.

OIL CONSERVATION DIVISION

Date Approved **MAY 08 1989**

By *[Signature]*
SUPERVISION DISTRICT # 8

Title

INSTRUCTIONS: This form is to be filed in compliance with Rule 1104

- 1) Request for allowable for newly drilled or deepened well must be accompanied by tabulation of deviation tests taken in accordance with Rule 111.
- 2) All sections of this form must be filled out for allowable on new and recompleted wells.
- 3) Fill out only Sections I, II, III, and VI for changes of operator, well name or number, transporter, or other such changes.
- 4) Separate Form C-104 must be filed for each pool in multiply completed wells.

STATE OF NEW MEXICO
ENERGY AND MINERALS DEPARTMENT

NO. OF COPIES RECEIVED	
DISTRIBUTION	
SANTA FE	
FILE	
U.S.G.S.	
LAND OFFICE	
TRANSPORTER	OIL
	GAS
OPERATOR	
PRORATION OFFICE	

OIL CONSERVATION DIVISION

P.O. BOX 2088
SANTA FE, NEW MEXICO 87501

Form C-104
Revised 10-01-78
Format 06-01-83
Page 1

REQUEST FOR ALLOWABLE
AND
AUTHORIZATION TO TRANSPORT OIL AND NATURAL GAS

I. Operator
Tenneco Oil Company - [REDACTED]
Address
P.O. Box 3249, Englewood, CO 80155
Reason(s) for filling (Check proper box)
☐ New Well ☐ Change in Transporter of:
☐ Recompletion ☐ Oil ☐ Dry Gas
☒ Change in Ownership ☐ Casinghead Gas ☒ Condensate
Other (Please explain)
OCT 02 1985

If change of ownership give name and address of previous owner **El Paso Natural Gas Company, P.O. Box 4990, Farmington, NM 87499**

II. DESCRIPTION OF WELL AND LEASE

Lease Name SJ 28-7 Unit NP	Well No. 68	Pool Name, including Formation Blanco-MV	Kind of Lease State, Federal or Fee USA SF	Lease No. 078500-A
Location Unit Letter B : 990 Feet From The North Line and 1650 Feet From The East Line of Section 31 Township 28N Range 7W NMPM, Rio Arriba County				

III. DESIGNATION OF TRANSPORTER OF OIL AND NATURAL GAS

Name of Authorized Transporter of Oil <input type="checkbox"/> or Condensate <input checked="" type="checkbox"/> Conoco Inc. Surface Transportation	Address (Give address to which approved copy of this form is to be sent) P.O. Box 460, Hobbs, NM 88240	
Name of Authorized Transporter of Casinghead Gas <input type="checkbox"/> or Dry Gas <input checked="" type="checkbox"/> El Paso Natural Gas Company	Address (Give address to which approved copy of this form is to be sent) P.O. Box 4990, Farmington, NM 87499	
If well produces oil or liquids, give location of tanks. Unit B Sec. 31 Twp. 28N Rge. 7W	Is gas actually connected? Yes	When

If this production is commingled with that from any other lease or pool, give commingling order number

NOTE: Complete Parts IV and V on reverse side if necessary.

VI. CERTIFICATE OF COMPLIANCE

I hereby certify that the rules and regulations of the Oil Conservation Division have been complied with and that the information given is true and complete to the best of my knowledge and belief.

[Signature]
(Signature)

Sr. Regulatory Analyst
OCT 1 1985
(Date)

OIL CONSERVATION DIVISION

APPROVED **[Signature]**, 19
BY
TITLE

This form is to be filed in compliance with RULE 1104.
If this is a request for allowable for a newly drilled or deepened well, this form must be accompanied by a tabulation of the deviation tests taken on the well in accordance with RULE 111.
All sections of this form must be filled out completely for allowable on new and recompleted wells.
Fill out only Section I, II, III, and VI for changes of owner, well name and or number, or transporter, or other such change of condition.
Separate Forms C-104 must be filed for each pool in multiply completed wells.

IV. COMPLETION DATA

Designate Type of Completion — (X)		Oil Well	Gas Well	New Well	Workover	Deepen	Plug Back	Same Res.v.	Diff. Res.v
Date Spudded	Date Compl. Ready to Prod.		Total Depth			P.B.T.D.			
Elevations (DF, RKB, RT, GR, etc.)	Name of Producing Formation		Top Oil/Gas Pay			Tubing Depth			
Perforations						Depth Casing Shoe			
TUBING, CASING, AND CEMENTING RECORD									
HOLE SIZE	CASING & TUBING SIZE		DEPTH SET			SACKS CEMENT			

V. TEST DATA AND REQUEST FOR ALLOWABLE OIL WELL

(Test must be after recovery of total volume of load oil and must be equal to or exceed top allowable for this depth or be for full 24 hours)

Date First New Oil Run To Tanks	Date of Test	Producing Method (Flow, pump, gas lift, etc.)	
Length of Test	Tubing Pressure	Casing Pressure	Choke Size
Actual Prod. During Test	Oil - Bbls.	Water - Bbls.	Gas - MCF

GAS WELL

Actual Prod. Test - MCF/D	Length of Test	Bbls. Condensate/MMCF	Gravity of Condensate
Testing Method (pilot, back pr.)	Tubing Pressure (Shut-in)	Casing Pressure (Shut-in)	Choke Size

NO. OF COPIES RECEIVED		5
DISTRIBUTION		
SANTA FE		
FILE		
U.S.G.S.		
LAND OFFICE		
TRANSPORTER	OIL	
	GAS	
OPERATOR		
PRORATION OFFICE		

NEW MEXICO OIL CONSERVATION COMMISSION
REQUEST FOR ALLOWABLE
AND
AUTHORIZATION TO TRANSPORT OIL AND NATURAL GAS

Form C-104
Supersedes Old C-104 and C-11
Effective 1-1-65

MAIN
'65 Nov 8

I. Operator
El Paso Natural Gas Company

Address

Reason(s) for filing (Check proper box)

New Well ☐

Recompletion ☐

Change in Ownership ☐

Change in Transporter of:

Oil ☐

Casinghead Gas ☐

Dry Gas ☐

Condensate ☐

Other (Please explain)

Name Change from
San Juan 28-7 Unit #68

If change of ownership give name
and address of previous owner

II. DESCRIPTION OF WELL AND LEASE

Lease Name San Juan 28-7 Unit NP	Well No. 68	Pool Name, Including Formation Blanco Mesa Verde	Kind of Lease State, Federal or Fee
Location Unit Letter B ; Feet From The Line and Feet From The Line of Section 31 , Township 28-N Range 7-W , NMPM, Rio Arriba County			

III. DESIGNATION OF TRANSPORTER OF OIL AND NATURAL GAS

Name of Authorized Transporter of Oil <input type="checkbox"/> or Condensate <input checked="" type="checkbox"/> El Paso Natural Gas Company	Address (Give address to which approved copy of this form is to be sent)
Name of Authorized Transporter of Casinghead Gas <input type="checkbox"/> or Dry Gas <input checked="" type="checkbox"/> El Paso Natural Gas Company	Address (Give address to which approved copy of this form is to be sent)
If well produces oil or liquids, give location of tanks.	Unit Sec. Twp. Rge. Is gas actually connected? Yes When

If this production is commingled with that from any other lease or pool, give commingling order number:

IV. COMPLETION DATA

Designate Type of Completion - (X)	Oil Well	Gas Well	New Well	Workover	Deepen	Plug Back	Same Res'tv.	Diff. Res'tv.
Date Spudded	Date Compl. Ready to Prod.		Total Depth			P.B.T.D.		
Pool	Name of Producing Formation		Top Oil/Gas Pay			Tubing Depth		
Perforations						Depth Casing Shoe		

TUBING, CASING, AND CEMENTING RECORD

HOLE SIZE	CASING & TUBING SIZE	DEPTH SET	SACKS CEMENT

V. TEST DATA AND REQUEST FOR ALLOWABLE OIL WELL (Test must be after recovery of total volume of load oil and must be equal to or exceed top allowable for this depth or be for full 24 hours)

Date First New Oil Run To Tanks	Date of Test	Producing Method (Flow, pump, gas lift, etc.)	
Length of Test	Tubing Pressure	Casing Pressure	Choke Size
Actual Prod. During Test	Oil - Bbls.	Water - Bbls.	Gas - MCF

GAS WELL

Actual Prod. Test-MCF/D	Length of Test	Bbls. Condensate/MMCF	Gravity of Condensate
Testing Method (pilot, back pr.)	Tubing Pressure	Casing Pressure	Choke Size

VI. CERTIFICATE OF COMPLIANCE

I hereby certify that the rules and regulations of the Oil Conservation Commission have been complied with and that the information given above is true and complete to the best of my knowledge and belief.

Petroleum Engineer

October 12, 1965

(Signature)

(Title)

(Date)

OIL CONSERVATION COMMISSION

APPROVED NOV 1 1965

BY

TITLE Supervisor Dist. # 3

This form is to be filed in compliance with RULE 1104.

If this is a request for allowable for a newly drilled or deepened well, this form must be accompanied by a tabulation of the deviation tests taken on the well in accordance with RULE 111.

All sections of this form must be filled out completely for allowable on new and recompleted wells.

Fill out Sections I, II, III, and VI only for changes of owner, well name or number, or transporter, or other such change of condition.

Separate Forms C-104 must be filed for each pool in multiply completed wells.

State of New Mexico

1952 FEB 10

Recompleçon.

Farmington, New Mexico

January 31, 1962

10 MW 1/4 PCE 1/4

Pool

12-21-61

4659

4659

Mesa Verde

D	C	B	A
E	F	X	H
L	K	J	I
M	N	O	P

Size	Feet	Sal
------	------	-----

10-3/4	176	150
7-5/8	2672	250
	2623	
	to	
5-1/2	4060	300
2	4781	

El Paso Natural Gas Company

Remarks An intermitter was installed. Turned back on production 12-21-61.

I hereby certify that the information given above is true and complete to the best of my knowledge.

Approved _____ 82.

El Paso Natural Gas Company

- ~~JOHN F. B. JONES~~

JOHN TILLERSON
Production Engineer

NO. 10-108-1000-122-007-001-00

Supervisor Dist. 4 3

OIL CONSERVATION COMMISSION

BOX 697

120 EAST CHACO

AZTEC, NEW MEXICO

MAIN OFFICE OCC

1957 OCT 10 AM 8:18

R.G.

NOTICE OF GAS CONNECTION

DATE September 23, 1957

THIS IS TO NOTIFY THE OIL CONSERVATION COMMISSION THAT CONNECTION FOR THE PURCHASE OF GAS FROM

THE El Paso Natural Gas Company
OPERATOR

San Juan 28-7 No. 68 B 31-28-7
LEASE WELL UNIT S-T-R

Blanco, Mesa Verde El Paso Natural Gas Company
POOL NAME OF PURCHASER

WAS MADE ON September 17, 1957 , FIRST DELIVERY September 17, 1957
DATE DATE

AOF - 923. Choke - 896
INITIAL POTENTIAL

El Paso Natural Gas Company
PURCHASER

L. L. Killenau
REPRESENTATIVE

Assistant
Chief Dispatcher
TITLE

CC: TO OPERATOR
OIL CONSERVATION COMMISSION - SANTA FE
F. N. WOODRUFF - EL PASO
B. D. ADAMS
Three States Natural Gas
FILE

U. S. LAND OFFICE Santa Fe
SERIAL NUMBER 078500-4
LEASE OR PERMIT TO PROSPECT _____

UNITED STATES
DEPARTMENT OF THE INTERIOR
GEOLOGICAL SURVEY

14-00-001-459

LOG OF OIL OR GAS WELL

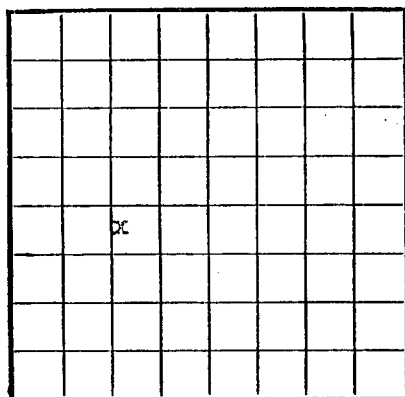

LOCATE WELL CORRECTLY

Company El Paso Natural Gas Company Address Box 997, Farmington, New Mexico
Lessor or Tract San Juan 28-7 Unit Field Blanco State New Mexico
Well No. 60 Sec. 31 T28N R. 7W Meridian N.M.P.M. County Rio Arriba
Location 990 ft. N of N Line and 1650 ft. E of E Line of Section 31 Elevation 5903'
(Derrick floor relative to sea level)

The information given herewith is a complete and correct record of the well and all work done thereon so far as can be determined from all available records.

Signed _____

Date May 22, 1957 Title Petroleum Engineer

The summary on this page is for the condition of the well at above date.

Commenced drilling 1-19, 1957 Finished drilling 1-31, 1957

OIL OR GAS SANDS OR ZONES

(Denote gas by G)

No. 1, from 2485 to 2608 (G) No. 4, from 4634 to 4853 (G)
No. 2, from 4149 to 4213 (G) No. 5, from _____ to _____
No. 3, from 4213 to 4684 (G) No. 6, from _____ to _____

IMPORTANT WATER SANDS

No. 1, from _____ to _____ No. 3, from _____ to _____
No. 2, from _____ to _____ No. 4, from _____ to _____

CASING RECORD

Size casing	Weight per foot	Threads per inch	Make	Amount	Kind of shoe	Cut and pulled from	Perforated		Purpose
							From—	To—	
10-3/4"	32.75	F.E.	S.W.	160'	Howco				surface
7-5/8"	26.40	8 Rd.	J-55	245'	Baker				Intermediate
5-1/2"	15.50	8 Rd.	J-55	2245'	Baker				Prod. Liner
2"	4.7	8 Rd.	J-55	478'					Prod. Lbg.

MUDDING AND CEMENTING RECORD

Size casing	Where set	Number sacks of cement	Method used	Mud gravity	Amount of mud used
10-3/4"	175'	150	circulated		
7-5/8"	2672'	350	single stage		
5-1/2"	2523-4861	375	single stage		

PLUGS AND ADAPTERS

Heaving plug—Material _____ Length _____ Depth set _____

PLUGS AND ADAPTERS

Heaving plug—Material _____ Length _____ Depth set _____

Adapters—Material _____ Size _____

SHOOTING RECORD

[illegible]

TOOLS USED

TOOLS USED

Rotary tools were used from 0 feet to 280 feet, and from 280 feet to 400 feet. Gas Drilled

Cable tools were used from _____ feet to _____ feet, and from _____ feet to _____ feet.

DATES

4-2, 19-57 Put to producing _____, 19-_____

The production for the first 24 hours was ----- barrels of fluid of which -----% was oil; -----% emulsion; -----% water; and -----% sediment. Gravity, °Bé. -----

If gas well, cu. ft. per 24 hours ----- Gallons gasoline per 1,000 cu. ft. of gas -----

Rock pressure, lbs. per sq. in. ----- 912-----

-912

EMPLOYEES

_____, Driller _____, Driller

_____, Driller _____, Driller

FORMATION RECORD

FROM-	TO-	TOTAL FEET	FORMATION
0	1660	1660	Tan to gry cr-grn ss interbedded w/gry sh.
1660	1850	190	Ojo Alamo ss. White cr-grn s.
1850	2049	199	Kirtland form. Gry sh interbedded w, tight gry fine-grn ss.
2049	2485	436	Fruitland form. Gry carb sh, scattered coals, coals and gry, tight, fine-grn ss.
2485	2608	123	Pictured Cliffs form. Gry, fine-grn, tight, varicolored soft ss.
2608	4149	1541	Lewis formation. Gry to white dense sh w/silty to shaly ss breaks.
4149	4213	64	Cliff House ss. Gry, fine-grn dense sil ss.
4213	4684	471	Menefee form. Gry, fine-grn s, carb sh & coal.
4684	4853	169	Point Lookout form. Gry, very fine sil ss w/frequent sh breaks.
4853	4872	19	Mancos formation. Gry carb sh.

(OVER)

16-43094-1

FORMATION RECORD—Continued[illegible]

LEONARD - JO - JOSEPH - JOSEPH

LOEWY, LEON RECORD

UNIQUE

Dyfford.

DEPOSE.

INDEX.

EMPLOYEES

Rock blemish, pp. 61, 62, 63, 64, 65, 66, 67, 68, 69, 70, 71, 72, 73, 74, 75, 76, 77, 78, 79, 80, 81, 82, 83, 84, 85, 86, 87, 88, 89, 90, 91, 92, 93, 94, 95, 96, 97, 98, 99, 100, 101, 102, 103, 104, 105, 106, 107, 108, 109, 110, 111, 112, 113, 114, 115, 116, 117, 118, 119, 120, 121, 122, 123, 124, 125, 126, 127, 128, 129, 130, 131, 132, 133, 134, 135, 136, 137, 138, 139, 140, 141, 142, 143, 144, 145, 146, 147, 148, 149, 150, 151, 152, 153, 154, 155, 156, 157, 158, 159, 160, 161, 162, 163, 164, 165, 166, 167, 168, 169, 170, 171, 172, 173, 174, 175, 176, 177, 178, 179, 180, 181, 182, 183, 184, 185, 186, 187, 188, 189, 190, 191, 192, 193, 194, 195, 196, 197, 198, 199, 200, 201, 202, 203, 204, 205, 206, 207, 208, 209, 210, 211, 212, 213, 214, 215, 216, 217, 218, 219, 220, 221, 222, 223, 224, 225, 226, 227, 228, 229, 230, 231, 232, 233, 234, 235, 236, 237, 238, 239, 240, 241, 242, 243, 244, 245, 246, 247, 248, 249, 250, 251, 252, 253, 254, 255, 256, 257, 258, 259, 260, 261, 262, 263, 264, 265, 266, 267, 268, 269, 270, 271, 272, 273, 274, 275, 276, 277, 278, 279, 280, 281, 282, 283, 284, 285, 286, 287, 288, 289, 290, 291, 292, 293, 294, 295, 296, 297, 298, 299, 300, 301, 302, 303, 304, 305, 306, 307, 308, 309, 310, 311, 312, 313, 314, 315, 316, 317, 318, 319, 320, 321, 322, 323, 324, 325, 326, 327, 328, 329, 330, 331, 332, 333, 334, 335, 336, 337, 338, 339, 340, 341, 342, 343, 344, 345, 346, 347, 348, 349, 350, 351, 352, 353, 354, 355, 356, 357, 358, 359, 360, 361, 362, 363, 364, 365, 366, 367, 368, 369, 370, 371, 372, 373, 374, 375, 376, 377, 378, 379, 380, 381, 382, 383, 384, 385, 386, 387, 388, 389, 390, 391, 392, 393, 394, 395, 396, 397, 398, 399, 400, 401, 402, 403, 404, 405, 406, 407, 408, 409, 410, 411, 412, 413, 414, 415, 416, 417, 418, 419, 420, 421, 422, 423, 424, 425, 426, 427, 428, 429, 430, 431, 432, 433, 434, 435, 436, 437, 438, 439, 440, 441, 442, 443, 444, 445, 446, 447, 448, 449, 450, 451, 452, 453, 454, 455, 456, 457, 458, 459, 460, 461, 462, 463, 464, 465, 466, 467, 468, 469, 470, 471, 472, 473, 474, 475, 476, 477, 478, 479, 480, 481, 482, 483, 484, 485, 486, 487, 488, 489, 490, 491, 492, 493, 494, 495, 496, 497, 498, 499, 500, 501, 502, 503, 504, 505, 506, 507, 508, 509, 510, 511, 512, 513, 514, 515, 516, 517, 518, 519, 520, 521, 522, 523, 524, 525, 526, 527, 528, 529, 530, 531, 532, 533, 534, 535, 536, 537, 538, 539, 540, 541, 542, 543, 544, 545, 546, 547, 548, 549, 550, 551, 552, 553, 554, 555, 556, 557, 558, 559, 560, 561, 562, 563, 564, 565, 566, 567, 568, 569, 570, 571, 572, 573, 574, 575, 576, 577, 578, 579, 580, 581, 582, 583, 584, 585, 586, 587, 588, 589, 590, 591, 592, 593, 594, 595, 596, 597, 598, 599, 600, 601, 602, 603, 604, 605, 606, 607, 608, 609, 610, 611, 612, 613, 614, 615, 616, 617, 618, 619, 620, 621, 622, 623, 624, 625, 626, 627, 628, 629, 630, 631, 632, 633, 634, 635, 636, 637, 638, 639, 640, 641, 642, 643, 644, 645, 646, 647, 648, 649, 650, 651, 652, 653, 654, 655, 656, 657, 658, 659, 660, 661, 662, 663, 664, 665, 666, 667, 668, 669, 670, 671, 672, 673, 674, 675, 676, 677, 678, 679, 680, 681, 682, 683, 684, 685, 686, 687, 688, 689, 690, 691, 692, 693, 694, 695, 696, 697, 698, 699, 700, 701, 702, 703, 704, 705, 706, 707, 708, 709, 710, 711, 712, 713, 714, 715, 716, 717, 718, 719, 720, 721, 722, 723, 724, 725, 726, 727, 728, 729, 730, 731, 732, 733, 734, 735, 736, 737, 738, 739, 740, 741, 742, 743, 744, 745, 746, 747, 748, 749, 750, 751, 752, 753, 754, 755, 756, 757, 758, 759, 760, 761, 762, 763, 764, 765, 766, 767, 768, 769, 770, 771, 772, 773, 774, 775, 776, 777, 778, 779, 780, 781, 782, 783, 784, 785, 786, 787, 788, 789, 790, 791, 792, 793, 794, 795, 796, 797, 798, 799, 800, 801, 802, 803, 804, 805, 806, 807, 808, 809, 810, 811, 812, 813, 814, 815, 816, 817, 818, 819, 820, 821, 822, 823, 824, 825, 826, 827, 828, 829, 830, 831, 832, 833, 834, 835, 836, 837, 838, 839, 840, 841, 842, 843, 844, 845, 846, 847, 848, 849, 850, 851, 852, 853, 854, 855, 856, 857, 858, 859, 860, 861, 862, 863, 864, 865, 866, 867, 868, 869, 870, 871, 872, 873, 874, 875, 876, 877, 878, 879, 880, 881, 882, 883, 884, 885,

U. S. 2000

Chassis Requiring bet. 1'000 cu. ft. of gas

EXPIRATION: --- NO AUGUST 8 1964 ---

✓ 20 September

CULTURAL REPORT

The blockage of the first 34 hours was

... parts of land of which ... 26 ...

Due to blocking,

FILES

GETTING INTO THE MIDDLE FROM

1660 40

1668' and 1600'

- 668 -

... 10:58

REPORT OF THE ALLEGED HUMAN

1000

notion, and from

1668 10

$$\frac{1}{2} \frac{d}{dt} \int_{\mathbb{R}^n} |\nabla u|^2 dx = \int_{\mathbb{R}^n} u \Delta u dx$$

TOOLS USED

Two benches along	side	Yilmaz	Lower yellow	Lower Hissig	9412
-------------------	------	--------	--------------	--------------	------

SHOOTING RECORD

Aqubfela—Mueg. 1881

2154

ԴՅՈՒՄՆԵ ԵՐԱՆ՝ ԱՄՏՐԵԼՈՒ

101289

Deber ser

ETHICS AND ADAPTERS

[illegible]

16-43004-2 U. S. GOVERNMENT PRINTING OFFICE

2-6-57. Core 4839'. Perf. w/2 DJ/ft. Int. 4639-74; 4682-4702; 4714-24; 4733-42;
4752-60; 4780-88; 4806-21. Water frac F.I. w/50,000 gal. sand. 49,000 gal. water.
Flush 9000 gal. I.R. 60.5 BIM. B.D. 2400, avg. tr. pr. 1000, max. pr. 1200%.

2-6-57. B.P. at 4600', Perf. w/2 ft. Int. 4146-56; 4166-76; 4186-212. Water
frac C.H. w/50,000 gal. water. 50,000 gal. sand. Flush w/9000 gal. IR 52.5 BIM.
B.D. 2800, avg. tr. pr. 1800, max. pr. 1800%.

2-6-57. BE. at 4000', Perf. w/2 DJ/ft. Int. 2470-2500; 2520-2540. Water
frac P.C. w/41,946 gal. water 40,000 gal. sand. Flush w/6000 gal. water. I.R. 69.7
BIM. B.D. 3000, avg. tr. pr. 1000%, max. pr. 1200%.

OUT ON ONE SIDE OF ROAD

The summary on this page is for the condition of the well as shown above.
 Date _____
 Signed _____
 so far as can be determined from all available records.
 The information given hereafter is a complete and correct record of the well and all work done thereon.
 Location _____ of _____ type and _____ of _____ Elevation _____
 Well No. _____ Sec. _____ T. _____ R. _____ S. _____
 Section of Township _____ Range _____ State _____
 Company _____ Address _____

GOOGLE MEET CORRECTION

[illegible]

TOC OF OIT OK GVS MERT

GEOLOGICAL SURVEY
 DEPARTMENT OF THE INTERIOR
 UNITED STATES

1. PROVIDE THE FOLLOWING TO THE BUREAU:
 a. ALL INFORMATION RELATIVE TO THE SUBJECT
 b. ALL INFORMATION RELATIVE TO THE SOURCE
 c. ALL INFORMATION RELATIVE TO THE MATTER
 d. ALL INFORMATION RELATIVE TO THE MATTER
 e. ALL INFORMATION RELATIVE TO THE MATTER
 f. ALL INFORMATION RELATIVE TO THE MATTER
 g. ALL INFORMATION RELATIVE TO THE MATTER
 h. ALL INFORMATION RELATIVE TO THE MATTER
 i. ALL INFORMATION RELATIVE TO THE MATTER
 j. ALL INFORMATION RELATIVE TO THE MATTER
 k. ALL INFORMATION RELATIVE TO THE MATTER
 l. ALL INFORMATION RELATIVE TO THE MATTER
 m. ALL INFORMATION RELATIVE TO THE MATTER
 n. ALL INFORMATION RELATIVE TO THE MATTER
 o. ALL INFORMATION RELATIVE TO THE MATTER
 p. ALL INFORMATION RELATIVE TO THE MATTER
 q. ALL INFORMATION RELATIVE TO THE MATTER
 r. ALL INFORMATION RELATIVE TO THE MATTER
 s. ALL INFORMATION RELATIVE TO THE MATTER
 t. ALL INFORMATION RELATIVE TO THE MATTER
 u. ALL INFORMATION RELATIVE TO THE MATTER
 v. ALL INFORMATION RELATIVE TO THE MATTER
 w. ALL INFORMATION RELATIVE TO THE MATTER
 x. ALL INFORMATION RELATIVE TO THE MATTER
 y. ALL INFORMATION RELATIVE TO THE MATTER
 z. ALL INFORMATION RELATIVE TO THE MATTER

Form C-110
Revised 7/1/55

157 CERTIFICATE OF COMPLIANCE AND AUTHORIZATION
TO TRANSPORT OIL AND NATURAL GAS.

Farmington, New Mexico

NEW MEXICO OIL CONSERVATION COMMISSION
Santa Fe, New Mexico

(Form C-104)
(Revised 7/1/52)

REQUEST FOR (OIL) - (GAS) ALLOWABLE

New Well
~~Recompletion~~

This form shall be submitted by the operator before an initial allowable will be assigned to any completed Oil or Gas well. Form C-104 is to be submitted in QUADRUPLICATE to the same District Office to which Form C-101 was sent. The allowable will be assigned effective 7:00 A.M. on date of completion or recompletion, provided this form is filed during calendar month of completion or recompletion. The completion date shall be that date in the case of an oil well when oil is delivered into the stock tanks. Gas must be reported on 15.025 psia at 60° Fahrenheit.

Farmington, New Mexico May 14, 1957
(Place) (Date)

WE ARE HEREBY REQUESTING AN ALLOWABLE FOR A WELL KNOWN AS:

El Paso Natural Gas Co. San Juan 28-7 Unit, Well No. 68, in NW 1/4 NE 1/4,
(Company or Operator) (Lease)
B, Sec. 31, T. 28N, R. 7W, NMPM, Blanco Pool
Unit Letter
Rio Arriba County. Date Spudded 1-19-57, Date Completed 4-2-57

Please indicate location:

D	C	B	A
E	F	X	H
L	K	J	I
M	N	O	P

Elevation 5973 Total Depth 4872', P.B.

Top oil/gas pay 4659' (Perf.) Name of Prod. Form M.V.
2470-2500; 2520-40 squeezed w/475 sks cmt., 4100-01; 4148-56; 4166-
Casing Perforations: 4188-4218 sq. w/100 sks cmt. 4659-74; 4682-or
4702; 4714-24; 4733-42; 4752-60; 4780-88; 4806-21'.
Depth to Casing shoe of Prod. String

Natural Prod. Test BOPD

based on bbls. Oil in Hrs. Mins.

Test after acid or shot BOPD

Based on bbls. Oil in Hrs. Mins.

Gas Well Potential Ch. Volume = 896 MCF/D; A.B.F. = 923 MCF/D

Size choke in inches 3/4"

Date first oil run to tanks or gas to Transmission system: w/o Pipeline

Transporter taking Oil or Gas: El Paso Natural Gas Company

Remarks:

I hereby certify that the information given above is true and complete to the best of my knowledge.

Approved MAY 21 1957, 19

El Paso Natural Gas Company
(Company or Operator)

OIL CONSERVATION COMMISSION

By: Emory C. Curren

Title Supervisor

By: J. C. Johnston
(Signature)

Title: Box 997, Farmington, New Mexico
Send Communications regarding well to:

Name: E. J. Coel

Address: Box 997, Farmington, New Mexico

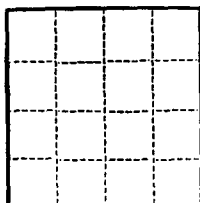
Form 9-331a
(Feb. 1951)

(SUBMIT IN TRIPLICATE)

UNITED STATES
DEPARTMENT OF THE INTERIOR
GEOLOGICAL SURVEY

Land Office Santa Fe
Lease No. 078500-A
Unit San Juan 28-7 Unit
14-08-001-459

SUNDRY NOTICES AND REPORTS ON WELLS

NOTICE OF INTENTION TO DRILL.....	SUBSEQUENT REPORT OF WATER SHUT-OFF.....	<input checked="" type="checkbox"/>
NOTICE OF INTENTION TO CHANGE PLANS.....	SUBSEQUENT REPORT OF SHOOTING OR ACIDIZING.....	
NOTICE OF INTENTION TO TEST WATER SHUT-OFF.....	SUBSEQUENT REPORT OF ALTERING CASING.....	
NOTICE OF INTENTION TO RE-DRILL OR REPAIR WELL.....	SUBSEQUENT REPORT OF RE-DRILLING OR REPAIR.....	
NOTICE OF INTENTION TO SHOOT OR ACIDIZE.....	SUBSEQUENT REPORT OF ABANDONMENT.....	
NOTICE OF INTENTION TO PULL OR ALTER CASING.....	SUPPLEMENTARY WELL HISTORY.....	
NOTICE OF INTENTION TO ABANDON WELL.....		

(INDICATE ABOVE BY CHECK MARK NATURE OF REPORT, NOTICE, OR OTHER DATA)

April 29, 1957

Well No. 68 is located 990 ft. from N line and 1650 ft. from E line of sec. 31NE Section 31
(¼ Sec. and Sec. No.)28N
(Twp.)7W
(Range)N.M.P.M.
(Meridian)Blanco
(Field)Rio Arriba
(County or Subdivision)New Mexico
(State or Territory)The elevation of the derrick floor above sea level is 5263 ft.

DETAILS OF WORK

(State names of and expected depths to objective sands; show sizes, weights, and lengths of proposed casings; indicate mudding jobs, cementing points, and all other important proposed work)

2-1-57. Total Depth 4872'.

Ran 99 joints 5-1/2", 15.50#, J-55 liner (2245') set from 2623' to 4068' with 150 sacks regular cement, 150 sacks Pozmix, 2% Gel, 1/8% Floccle/sk.

Held 1000# for 30 minutes.

Top of cement by temperature survey at 4200'.

I understand that this plan of work must receive approval in writing by the Geological Survey before operations may be commenced.

Company El Paso Natural Gas CompanyAddress Box 997Farmington, New MexicoBy W. W. 5045Title Petroleum Engineer

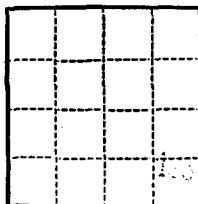

(SUBMIT IN TRIPLICATE)

UNITED STATES

DEPARTMENT OF THE INTERIOR
GEOLOGICAL SURVEY

Land Office **Santa Fe**
Lease No. **078500-A**
Unit **San Juan 28-7 Unit**
14-08-001-459

SUNDRY NOTICES AND REPORTS ON WELLS

NOTICE OF INTENTION TO DRILL	SUBSEQUENT REPORT OF WATER SHUT-OFF	
NOTICE OF INTENTION TO CHANGE PLANS	SUBSEQUENT REPORT OF SHOOTING OR ACIDIZING	
NOTICE OF INTENTION TO TEST WATER SHUT-OFF	SUBSEQUENT REPORT OF ALTERING CASING	
NOTICE OF INTENTION TO RE-DRILL OR REPAIR WELL	SUBSEQUENT REPORT OF RE-DRILLING OR REPAIR	
NOTICE OF INTENTION TO SHOOT OR ACIDIZE	SUBSEQUENT REPORT OF ABANDONMENT	
NOTICE OF INTENTION TO PULL OR ALTER CASING	SUPPLEMENTARY WELL HISTORY	
NOTICE OF INTENTION TO ABANDON WELL	Water Fracture	X

(INDICATE ABOVE BY CHECK MARK NATURE OF REPORT, NOTICE, OR OTHER DATA)

February 8, 1957

Well No. 68 is located 990 ft. from [N] line and 1650 ft. from [E] line of sec. 31
~~rock~~
NE Section 31 28N 7W BMFM
($\frac{1}{4}$ Sec. and Sec. No.) (Twp.) (Range) (Meridian)
Blanco **Rio Arriba** **New Mexico**
(Field) (County or Subdivision) (State or Territory)

The elevation of the derrick floor above sea level is 5983 ft.

DETAILS OF WORK

(State names of and expected depths to objective sands; show sizes, weights, and lengths of proposed casings; indicate mudding jobs, cementing points, and all other important proposed work)

2-6-57 T.D. Cleaned out 4835'. Water fractured Point Lookout perf. int. 4659-74, 4682-4702, 4714-24, 4733-42, 4752-60, 4780-28, 4806-21 w/49,000 gals. water & 60,000 sand. BDP 2400#, max. pr. 1200#, avg. tr. pr. 1000#. I.R. 60.5 BPM. Flush 9000 gals.

2-6-57 Temp. Bridge Plug 3 4600'. Water fractured Cliff House perf. int. 4148-56, 4166-76, 4188-4218 w/50,080 gals. water & 60,000# sand. BDP 2800#, max. pr. 1800#, avg. tr. pr. 1800#. I.R. 52.5 BPM. Flush 9000 gals.

2-6-57 Temp. B.P. 3 4000'. Water fractured Pictured Cliffs perf. int. 2470-2500, 2520-2540 with 41,946 gals. water & 40,000# sand. BDP 3000#, max. pr. 1200#, avg. tr. pr. 1000#. I.R. 69.7 BPM. Flush 6000 gals.

I understand that this plan of work must receive approval in writing by the Geological Survey before operations may be commenced.

Company El Paso Natural Gas Company

Address Box 997

Farmington, New Mexico

By _____
Title Petroleum Engineer

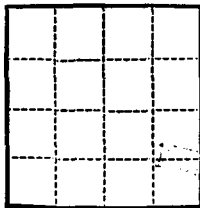

(SUBMIT IN TRIPLICATE)

UNITED STATES

DEPARTMENT OF THE INTERIOR
GEOLOGICAL SURVEY

Land Office Santa Fe
Lease No. 078500-A
Unit San Juan 28-7 Unit
14-08-001-459

SUNDRY NOTICES AND REPORTS ON WELLS

NOTICE OF INTENTION TO DRILL	SUBSEQUENT REPORT OF WATER SHUT-OFF	<input checked="" type="checkbox"/>
NOTICE OF INTENTION TO CHANGE PLANS	SUBSEQUENT REPORT OF SHOOTING OR ACIDIZING	
NOTICE OF INTENTION TO TEST WATER SHUT-OFF	SUBSEQUENT REPORT OF ALTERING CASING	
NOTICE OF INTENTION TO RE-DRILL OR REPAIR WELL	SUBSEQUENT REPORT OF RE-DRILLING OR REPAIR	
NOTICE OF INTENTION TO SHOOT OR ACIDIZE	SUBSEQUENT REPORT OF ABANDONMENT	
NOTICE OF INTENTION TO PULL OR ALTER CASING	SUPPLEMENTARY WELL HISTORY	
NOTICE OF INTENTION TO ABANDON WELL		

(INDICATE ABOVE BY CHECK MARK NATURE OF REPORT, NOTICE, OR OTHER DATA)

February 8, 1957

Well No. 68 is located 990 ft. from [N] line and 1650 ft. from [E] line of sec. 31
NE section 31 28N 7W 101M
(1/4 Sec. and Sec. No.) (Twp.) (Range) (Meridian)
Bianco Rio Arriba New Mexico
(Field) (County or Subdivision) (State or Territory)

The elevation of the derrick floor above sea level is 5983 ft.

DETAILS OF WORK

(State names of and expected depths to objective sands; show sizes, weights, and lengths of proposed casings; indicate mudding jobs, cementing points, and all other important proposed work)

On 1-25-57, Total Depth 2672'.
Ran 89 joints 7 5/8", J-55, 26.4#, casing (2660') set at 2672' with 100 sacks regular cement, 100 sacks Pennix, 50# Floccale and 4# Gel, 1/4# Floccale/sk. followed with 50 sacks Heat cement.
Held 1000# 30 minutes.
Top of cement by temperature survey at 1525'.

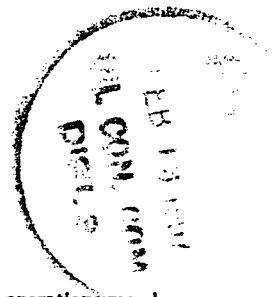

I understand that this plan of work must receive approval in writing by the Geological Survey before operations may be commenced.

Company El Paso Natural Gas Company

Address Box 997
Farmington, New Mexico

By A. G. WALSH, JR. E.S. OBERLY
Title Petroleum Engineer

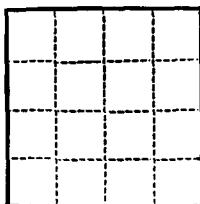

(SUBMIT IN TRIPLICATE)

UNITED STATES
DEPARTMENT OF THE INTERIOR
GEOLOGICAL SURVEY

Land Office **Santa Fe**
Lease No. **076500-A**
Unit **San Juan 28-7 Unit**
14-08-001-459

SUNDRY NOTICES AND REPORTS ON WELLS

NOTICE OF INTENTION TO DRILL	SUBSEQUENT REPORT OF WATER SHUT-OFF	<input checked="" type="checkbox"/>
NOTICE OF INTENTION TO CHANGE PLANS	SUBSEQUENT REPORT OF SHOOTING OR ACIDIZING	
NOTICE OF INTENTION TO TEST WATER SHUT-OFF	SUBSEQUENT REPORT OF ALTERING CASING	
NOTICE OF INTENTION TO RE-DRILL OR REPAIR WELL	SUBSEQUENT REPORT OF RE-DRILLING OR REPAIR	
NOTICE OF INTENTION TO SHOOT OR ACIDIZE	SUBSEQUENT REPORT OF ABANDONMENT	
NOTICE OF INTENTION TO PULL OR ALTER CASING	SUPPLEMENTARY WELL HISTORY	
NOTICE OF INTENTION TO ABANDON WELL		

(INDICATE ABOVE BY CHECK MARK NATURE OF REPORT, NOTICE, OR OTHER DATA)

February 8, 1957

Well No. **68** is located **990** ft. from **[N]** line and **1650** ft. from **[E]** line of sec. **31**

NE Section 31 **26N** **7W** **14N**
(1/4 Sec. and Sec. No.) (Twp.) (Range) (Meridian)
Blanco **Rio Arriba** **New Mexico**
(Field) (County or Subdivision) (State or Territory)

The elevation of the derrick floor above sea level is **5983** ft.

DETAILS OF WORK

(State names of and expected depths to objective sands; show sizes, weights, and lengths of proposed casings; indicate mudding jobs, cementing points, and all other important proposed work)

2-1-57, Total Depth **4872'**.
Ran 99 joints 5 1/2", 15.50#, J-55 liner (2623') set at 4000' with 150 sacks regular cement, 150 sacks Pozmix, 2% Gel, 1/8" Floccale/sk.
Held 1000# for 30 minutes.
Top of cement by temperature survey at 4200'.

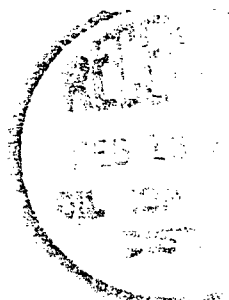

I understand that this plan of work must receive approval in writing by the Geological Survey before operations may be commenced.

Company **El Paso Natural Gas Company**
Address **Box 997**
Farmington, New Mexico
By _____
Title **Petroleum Engineer**

ORIGINAL SIGNED E.S. OREPLY

NEW MEXICO
OIL CONSERVATION COMMISSION

Form C-128

Well Location and/or Gas Proration Plat

Date January 25, 1957

Operator El Paso Natural Gas Company

Lease San Juan 28-7 Unit

Well No. 68 (FM) Section 31 Township 28N Range 7W NMPM

Located 990 Feet From North Line, 1650 Feet From East Line,

Rio Arriba County, New Mexico. G. L. Elevation 5973'

Name of Producing Formation Pictured Cliffs Pool So. Blanco Ext. Dedicated Acreage 160

(Note: All distances must be from outer boundaries of Section)

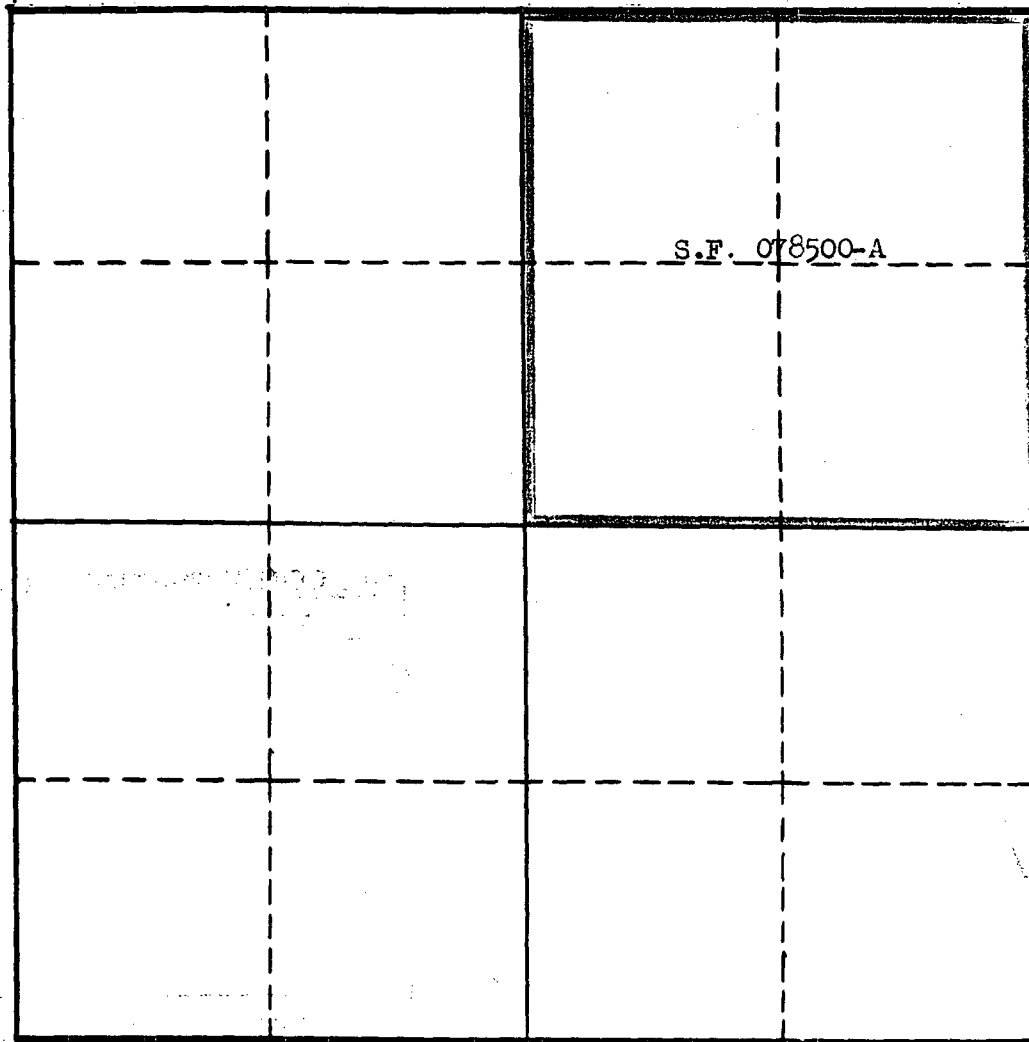

SCALE: 1" = 1000'

1. Is this Well a Dual Comp.? Yes ☒ No ☐.
2. If the answer to Question 1 is yes, are there any other dually completed wells within the dedicated acreage? Yes ☐ No ☒.

This is to certify that the above plat was prepared from field notes of actual surveys made by me or under my supervision and that the same are true and correct to the best of my knowledge and belief.

Name W. F. Dought
Position Petroleum Engineer
Representing El Paso Natural Gas Co.
Address Box 997, Farmington, N.M.

Date Surveyed _____
Registered Professional Engineer and/or
Land Surveyor

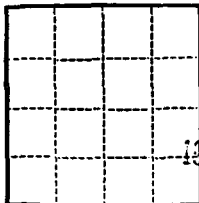

(SUBMIT IN TRIPLICATE)

MAIN OFFICE 000

UNITED STATES
DEPARTMENT OF THE INTERIOR
GEOLOGICAL SURVEY

1957 FEB 4 AM 8:43

Land Office Santa Fe
Lease No. 070500-1
Unit San Juan 20-7 Unit
14-08-001-459

SUNDRY NOTICES AND REPORTS ON WELLS

NOTICE OF INTENTION TO DRILL.....	SUBSEQUENT REPORT OF WATER SHUT-OFF.....	<input checked="" type="checkbox"/>
NOTICE OF INTENTION TO CHANGE PLANS.....	SUBSEQUENT REPORT OF SHOOTING OR ACIDIZING.....	<input type="checkbox"/>
NOTICE OF INTENTION TO TEST WATER SHUT-OFF.....	SUBSEQUENT REPORT OF ALTERING CASING.....	<input type="checkbox"/>
NOTICE OF INTENTION TO RE-DRILL OR REPAIR WELL.....	SUBSEQUENT REPORT OF RE-DRILLING OR REPAIR.....	<input type="checkbox"/>
NOTICE OF INTENTION TO SHOOT OR ACIDIZE.....	SUBSEQUENT REPORT OF ABANDONMENT.....	<input type="checkbox"/>
NOTICE OF INTENTION TO PULL OR ALTER CASING.....	SUPPLEMENTARY WELL HISTORY.....	<input type="checkbox"/>
NOTICE OF INTENTION TO ABANDON WELL.....		<input type="checkbox"/>

(INDICATE ABOVE BY CHECK MARK NATURE OF REPORT, NOTICE, OR OTHER DATA)

January 26, 1957

Well No. 68 (FM) is located 990 ft. from N line and 1650 ft. from E line of sec. 31
NE section 31 22N 7W RMH
(1/4 Sec. and Sec. No.) (Twp.) (Range) (Meridian)
Blanco Rio Arriba New Mexico
(Field) (County or Subdivision) (State or Territory)

The elevation of the derrick floor above sea level is 5983 ft.

DETAILS OF WORK

(State names of and expected depths to objective sands; show sizes, weights, and lengths of proposed casings; indicate mudding jobs, cementing points, and all other important proposed work)

Spud date 1-19-57.

On 1-20-57. Total Depth 176'.

Run 4 joints 10 1/4", 32.75#, Araco spiral weld casing (160') set at 176' with 150 sacks regular cement circulated to surface.

Held 500/ 30 minutes.

I understand that this plan of work must receive approval in writing by the Geological Survey before operations may be commenced.

Company El Paso Natural Gas Company

Address Box 997

Farmington, New Mexico

By W. F. Court

Title Natural Gas Engineer

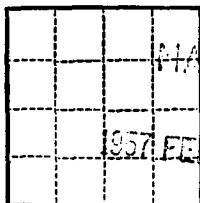

(SUBMIT IN TRIPLICATE)

UNITED STATES
DEPARTMENT OF THE INTERIOR
GEOLOGICAL SURVEY

Land Office Santa Fe
Lease No. 070500-A
Unit San Juan 28-7 Unit
14-08-001-459

SUNDRY NOTICES AND REPORTS ON WELLS

NOTICE OF INTENTION TO DRILL	<input checked="" type="checkbox"/>	SUBSEQUENT REPORT OF WATER SHUT-OFF	
NOTICE OF INTENTION TO CHANGE PLANS		SUBSEQUENT REPORT OF SHOOTING OR ACIDIZING	
NOTICE OF INTENTION TO TEST WATER SHUT-OFF		SUBSEQUENT REPORT OF ALTERING CASING	
NOTICE OF INTENTION TO RE-DRILL OR REPAIR WELL		SUBSEQUENT REPORT OF RE-DRILLING OR REPAIR	
NOTICE OF INTENTION TO SHOOT OR ACIDIZE		SUBSEQUENT REPORT OF ABANDONMENT	
NOTICE OF INTENTION TO PULL OR ALTER CASING		SUPPLEMENTARY WELL HISTORY	
NOTICE OF INTENTION TO ABANDON WELL			

(INDICATE ABOVE BY CHECK MARK NATURE OF REPORT, NOTICE, OR OTHER DATA)

January 25, 1957

Well No. 68 (PH) is located 990 ft. from N line and 1650 ft. from E line of sec. 31
NE Section 31 28N 7W MMM
(1/4 Sec. and Sec. No.) (Twp.) (Range) (Meridian)
Blanco & So. Blanco Art. Rio Arriba New Mexico
(Field) (County or Subdivision) (State or Territory)

The elevation of the derrick floor above sea level is 5983 ft.

DETAILS OF WORK

(State names of and expected depths to objective sands; show sizes, weights, and lengths of proposed casings; indicate mudding jobs, cementing points, and all other important proposed work)

It is intended to dual complete this well in the Pictured Cliffs and Mesa Verde formations. The NE 1/4 of Section 31 is dedicated to the Pictured Cliffs formation. The E 1/2 of Section 31 is dedicated to the Mesa Verde formation.

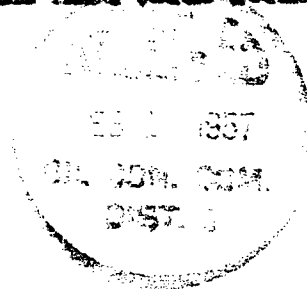

I understand that this plan of work must receive approval in writing by the Geological Survey before operations may be commenced.

Company El Paso Natural Gas Company

Address Box 997

Farmington, New Mexico

By W. F. Court

Title Petroleum Eng near

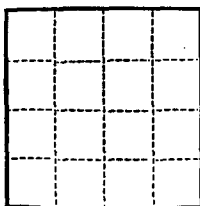

(SUBMIT IN TRIPLICATE)
MAIN OFFICE UNITED STATES
DEPARTMENT OF THE INTERIOR
GEOLOGICAL SURVEY
JAN 18 1957
3:56

Land Office **Santa Fe**
076500-A
Lease No. _____
Unit **San Juan 28-7 Unit**
14-08-001-459

SUNDRY NOTICES AND REPORTS ON WELLS

NOTICE OF INTENTION TO DRILL	<input checked="" type="checkbox"/>	SUBSEQUENT REPORT OF WATER SHUT-OFF	
NOTICE OF INTENTION TO CHANGE PLANS		SUBSEQUENT REPORT OF SHOOTING OR ACIDIZING	
NOTICE OF INTENTION TO TEST WATER SHUT-OFF		SUBSEQUENT REPORT OF ALTERING CASING	
NOTICE OF INTENTION TO RE-DRILL OR REPAIR WELL		SUBSEQUENT REPORT OF RE-DRILLING OR REPAIR	
NOTICE OF INTENTION TO SHOOT OR ACIDIZE		SUBSEQUENT REPORT OF ABANDONMENT	
NOTICE OF INTENTION TO PULL OR ALTER CASING		SUPPLEMENTARY WELL HISTORY	
NOTICE OF INTENTION TO ABANDON WELL			

(INDICATE ABOVE BY CHECK MARK NATURE OF REPORT, NOTICE, OR OTHER DATA)

January 18, 1957

Well No. **66** is located **990** ft. from **(N)** line and **1650** ft. from **(E)** line of sec. **31**
NE Section 31 **28N** **T6** **104W**
($\frac{1}{4}$ Sec. and Sec. No.) (Twp.) (Range) (Meridian)
Blanco **Rio Arriba** **New Mexico**
(Field) (County or Subdivision) (State or Territory)

The elevation of the derrick floor above sea level is **5983** ft.

DETAILS OF WORK

(State names of and expected depths to objective sands; show sizes, weights, and lengths of proposed casings; indicate mudding jobs, cementing points, and all other important proposed work)

It is intended to drill a well with rotary tools thru the Mesa Verde formation. Mud circulation will be used thru the Pictured Cliffs and set intermediate casing. Gas circulation will be used thru the Mesa Verde and production casing will be set. Possible productive intervals will be perforated and fractured. Estimated T.D. 4872'.

Casing Program:

10 3/4" at 170' with 125 sacks cement circulated to the surface.
7 5/8" at 2672' with 250 sacks cement.
5 1/2" at 4872' with 150 sacks cement.

The E/2 of Section 31 is dedicated to this well.
E/2 of 076500-A.

I understand that this plan of work must receive approval in writing by the Geological Survey before operations may be commenced.

Company **El Paso Natural Gas Company**

Address **Box 997**

Farmington, New Mexico

By **Signed DWELL N. WALSH**

Title **Petroleum Engineer**

NEW MEXICO
OIL CONSERVATION COMMISSION

Form 7-128

WELL LOCATION AND/OR GAS PRORATION PLAT

DATE JANUARY 17, 1957

OWNER EL PASO NATURAL GAS COMPANY WELL SAN JUAN 28-7 UNIT SF 078500-A

WELL NO. 68 SECTION 31 T. 28-N R. 7-W NMDN

LOCATED 990 FEET FROM NORTH LINE 1650 FEET FROM EAST LINE

RIO ARriba COUNTY, NEW MEXICO WELL ELEVATION 5973

NAME OF PROPERTY OWNERS MESA VERDE BLANCO TOTAL ACRES 315 ACRES
(1917 PLAT)

Note: All distances must be from outer boundaries of section.

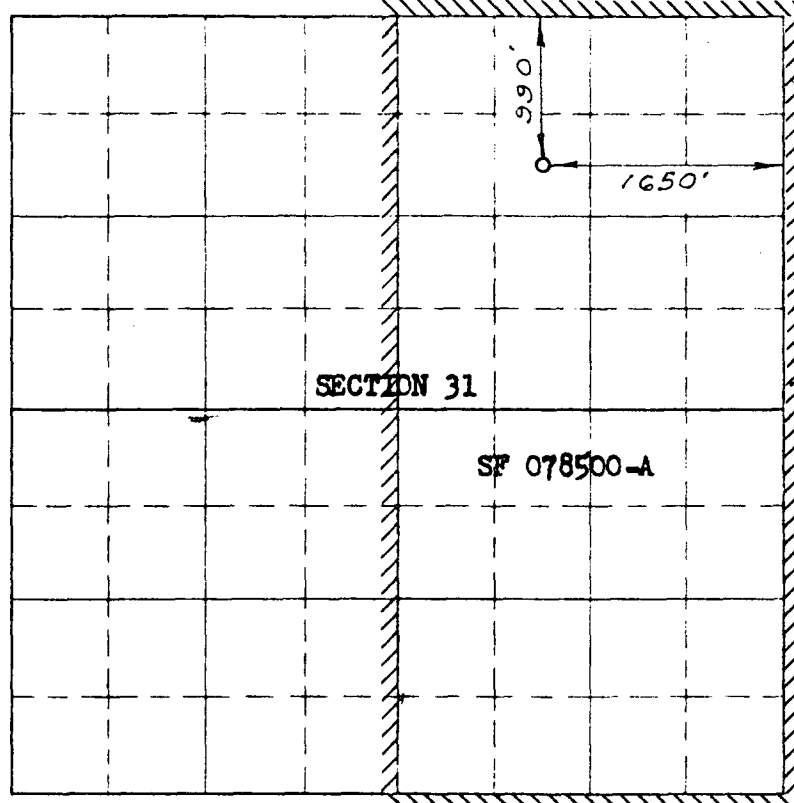

Scale 1 inch equals 1 mile

RECEIVED
JAN 18 1957

NOTE

This section of
form is to be used
for gas wells only

This is to certify that the above plat was prepared from
field notes of actual surveys made by me or under my
supervision and that the same are true and correct to the
best of my knowledge and belief.

Date Surveyed DECEMBER 26, 1956

E. O. Walker
Registered Professional Engineer and/or Land Surveyor

1. Is this well a Dual Comp.
Yes _____ No X
2. If the answer to Question 1
is yes, are there any other dually
completed wells within the
dedicated acreage.
Yes _____ No _____

Name Original Signed EWELL N. WALSH

Position Petroleum Engineer

Representing El Paso Natural Gas Co.

Address Box 997, Farmington, N.M.

(Seal)

Farmington, New Mexico

BEFORE THE OIL CONSERVATION COMMISSION
OF THE STATE OF NEW MEXICO

IN THE MATTER OF THE HEARING
CALLED BY THE OIL CONSERVATION
COMMISSION OF NEW MEXICO FOR
THE PURPOSE OF CONSIDERING:

CASE No. 3272
Order No. R-2948

APPLICATION OF EL PASO NATURAL GAS
COMPANY FOR NON-STANDARD GAS PRORA-
TION UNITS, BASIN-DAKOTA GAS POOL,
RIO ARriba COUNTY, NEW MEXICO.

ORDER OF THE COMMISSION

BY THE COMMISSION:

This cause came on for hearing at 9 o'clock a.m. on June 30, 1965, at Santa Fe, New Mexico, before Examiner Daniel S. Nutter.

NOW, on this 16th day of August, 1965, the Commission, a quorum being present, having considered the testimony, the record, and the recommendations of the Examiner, and being fully advised in the premises,

FINDS:

(1) That due public notice having been given as required by law, the Commission has jurisdiction of this cause and the subject matter thereof.

(2) That the applicant, El Paso Natural Gas Company, seeks approval of 51 non-standard gas proration units in the Basin-Dakota Gas Pool, Rio Arriba County, New Mexico, in the following area:

TOWNSHIP 28 NORTH, RANGE 5 WEST, NMPM
Sections 7 through 13, 24 and 25, and
33 through 36

TOWNSHIP 28 NORTH, RANGE 6 WEST, NMPM
Sections 7 through 12, 18 and 19, and
30 through 34

TOWNSHIP 28 NORTH, RANGE 7 WEST, NMPM
Sections 7 through 12, 18 and 19, and
30 through 36

(3) That a standard gas proration unit in the Basin-Dakota Gas Pool consists of 320 acres, and that each of the proposed non-standard units exceeds 320 acres.

(4) That non-standard units are necessary in the subject area due to variations in legal subdivisions of the U. S. Public Land Survey.

(5) That the non-standard units created in the subject area should approximate 320 acres, insofar as is practicable, in order to afford to the owner of each property in the Basin-Dakota Gas Pool the opportunity to produce his just and equitable share of the gas in the pool, and otherwise prevent waste and protect correlative rights.

(6) That non-standard gas proration units approximating 320 acres, insofar as is practicable, should be created in the subject area, and that the subject application should otherwise be denied.

IT IS THEREFORE ORDERED:

(1) That the following-described non-standard gas proration units in the Basin-Dakota Gas Pool are hereby approved:

RIO ARRIBA COUNTY, NEW MEXICO

TOWNSHIP 28 NORTH, RANGE 5 WEST, NMPM

Unit	Acres	Description
1	322.96	Section 7: Lots 1, 2, 3, and 4 and S/2 S/2 Section 8: SW/4 SW/4
2	313.42	Section 8: Lots 1, 2, 3, and 4, SE/4 SW/4, and S/2 SE/4 Section 9: Lot 4 and SW/4 SW/4
3	322.35	Section 9: Lots 1, 2, and 3, SE/4 SW/4, and S/2 SE/4 Section 10: Lot 4 and S/2 SW/4
4	321.61	Section 10: Lots 1, 2, and 3 and S/2 SE/4 Section 11: Lot 4, S/2 SW/4, and SW/4 SE/4

-3-

CASE No. 3272

Order No. R-2948

TOWNSHIP 28 NORTH, RANGE 5 WEST, NMPM (CONT.)

Unit	Acres	Description
5	310.19	Section 11: Lots 1, 2, and 3 and SE/4 SE/4 Section 12: Lots 3 and 4, S/2 SW/4, and SW/4 SE/4
6	342.30	Section 12: Lots 1, 2, and 5 Section 13: Lots 1 and 2, W/2 NE/4, and NW/4 SE/4
7	327.36	Section 13: Lots 3 and 4 and SW/4 SE/4 Section 24: Lots 1 and 2 and W/2 NE/4
8	329.09	Section 24: Lots 3 and 4 and W/2 SE/4 Section 25: Lots 1 and 2 and NW/4 NE/4
9	316.76	Section 25: Lots 3 and 4, SW/4 NE/4 and W/2 SE/4 Section 36: Lot 1 and NW/4 NE/4
10	330.74	Section 36: Lots 2, 3, 5, 6, 7, and 8 and NW/4 SE/4
11	345.39	Section 36: Lot 4, NE/4 NW/4, S/2 NW/4, SW/4 NE/4, and N/2 SW/4 Section 35: Lot 1
12	330.92	Section 36: NW/4 NW/4 Section 35: Lot 2, NE/4, and N/2 SE/4
13	345.82	Section 35: Lots 3 and 4, NE/4 NW/4, S/2 NW/4, and N/2 SW/4 Section 34: Lot 1
14	326.42	Section 35: NW/4 NW/4 Section 34: Lot 2, NE/4, and N/2 SE/4
15	329.70	Section 34: W/2
16	325.46	Section 33: E/2

-4-

CASE No. 3272

Order No. R-2948

TOWNSHIP 28 NORTH, RANGE 6 WEST, NMPM

Unit	Acres	Description
1	353.10	Section 12: Lots 1, 2, 3, and 4 and S/2 S/2 Section 11: Lot 1 and SE/4 SE/4
2	353.83	Section 11: Lots 2, 3, and 4, S/2 SW/4, and SW/4 SE/4 Section 10: Lots 1 and 2 and S/2 SE/4
3	354.79	Section 10: Lots 3 and 4 and S/2 SW/4 Section 9: Lots 1, 2, and 3, SE/4 SW/4, and S/2 SE/4
4	356.16	Section 9: Lot 4 and SW/4 SW/4 Section 8: Lots 1, 2, 3, and 4 and S/2 S/2
5	326.18	Section 7: Lots 1, 2, 3, 4, and 5, SE/4 SW/4, and S/2 SE/4 Section 18: Lot 1 and NE/4 NW/4
6	328.37	Section 18: Lots 2, 3, and 4, SE/4 NW/4, and E/2 SW/4 Section 19: Lots 1 and 2 and E/2 NW/4
7	328.77	Section 19: Lots 3 and 4 and E/2 SW/4 Section 30: Lots 1, 2, and 3, E/2 NW/4, and NE/4 SW/4
8	334.79	Section 30: Lot 4 and SE/4 SW/4 Section 31: Lots 1, 2, 3, 4, and 5, E/2 NW/4, and NE/4 SW/4
9	326.29	Section 31: E/2
10	325.23	Section 32: W/2
11	325.04	Section 32: E/2
12	325.59	Section 33: W/2
13	325.02	Section 33: E/2
14	324.69	Section 34: W/2
15	324.63	Section 34: E/2

-5-

CASE No. 3272

Order No. R-2948

TOWNSHIP 28 NORTH, RANGE 7 WEST, NMPM

Unit	Acres	Description
1	321.22	Section 12: Lots 1, 2, 3, and 4 and S/2 S/2 Section 11: Lot 1
2	333.76	Section 11: Lots 2, 3, and 4 and S/2 S/2 Section 10: Lot 1 and SE/4 SE/4
3	331.55	Section 10: Lots 2, 3, and 4, S/2 SW/4, and SW/4 SE/4 Section 9: Lots 1 and 2 and SE/4 SE/4
4	338.02	Section 9: Lots 3 and 4, S/2 SW/4, and SW/4 SE/4 Section 8: Lots 1, 2, and 3 and SE/4 SE/4
5	313.00	Section 8: Lot 4, S/2 SW/4, and SW/4 SE/4 Section 7: Lot 1, SE/4 SW/4, and S/2 SE/4
6	331.11	Section 7: Lots 2, 3, 4, and 5 Section 18: Lots 1, 2, and 3 and E/2 NW/4
7	345.30	Section 18: Lot 4 and E/2 SW/4 Section 19: Lots 1, 2, and 3, E/2 NW/4, and NE/4 SW/4
8	342.17	Section 19: Lot 4 and SE/4 SW/4 Section 30: Lots 1, 2, 3, and 4, E/2 NW/4, and NE/4 SW/4
9	316.50	Section 30: SE/4 SW/4 Section 31: Lot 1, E/2 NW/4, and NE/4
10	339.73	Section 31: Lots 2, 3, 4, 5, 6, and 7, NE/4 SW/4, and N/2 SW/4
11	315.36	Section 32: W/2
12	315.68	Section 32: E/2
13	316.00	Section 33: W/2
14	316.32	Section 33: E/2

-6-

CASE No. 3272

Order No. R-2948

TOWNSHIP 28 NORTH, RANGE 7 WEST, NMPM (CONT.)

Unit	Acres	Description
15	318.40	Section 34: W/2
16	324.70	Section 35: W/2
17	327.70	Section 35: E/2
18	328.82	Section 36: W/2
19	328.06	Section 36: E/2

(2) That the subject application is otherwise hereby denied.

(3) That jurisdiction of this cause is retained for the entry of such further orders as the Commission may deem necessary.

DONE at Santa Fe, New Mexico, on the day and year hereinabove designated.

STATE OF NEW MEXICO
OIL CONSERVATION COMMISSION

JACK M. CAMPBELL, Chairman

GUYTON B. HAYS, Member

S E A L

A. L. PORTER, JR., Member & Secretary

esr/

BEFORE THE OIL CONSERVATION COMMISSION
OF THE STATE OF NEW MEXICO

IN THE MATTER OF THE HEARING
CALLED BY THE OIL CONSERVATION
COMMISSION OF NEW MEXICO FOR
THE PURPOSE OF CONSIDERING:

CASE No. 4042
Order No. R-2948-A

APPLICATION OF EL PASO NATURAL GAS
COMPANY FOR AN AMENDMENT TO ORDER
NO. R-2948, RIO ARriba COUNTY, NEW
MEXICO.

ORDER OF THE COMMISSION

BY THE COMMISSION:

This cause came on for hearing at 9 a.m. on February 5, 1969,
at Santa Fe, New Mexico, before Examiner Daniel S. Nutter.

NOW, on this 11th day of February, 1969, the Commission, a
quorum being present, having considered the testimony, the record,
and the recommendations of the Examiner, and being fully advised
in the premises,

FINDS:

(1) That due public notice having been given as required by
law, the Commission has jurisdiction of this cause and the subject
matter thereof.

(2) That by Order No. R-2948, dated August 16, 1965, the
Commission approved several non-standard gas proration units in
the Basin-Dakota Gas Pool, Rio Arriba County, New Mexico, among
them the following:

TOWNSHIP 28 NORTH, RANGE 6 WEST, NMPM

Unit	Acres	Description
12	325.59	Section 33: W/2
13	325.02	Section 33: E/2

-2-

CASE No. 4042

Order No. R-2948-A

TOWNSHIP 28 NORTH, RANGE 7 WEST, NMPM

Unit	Acres	Description
16	324.70	Section 35: W/2
17	327.70	Section 35: E/2

(3) That the applicant, El Paso Natural Gas Company, now seeks amendment of Order No. R-2948 to change the acreage dedication comprising the above-described non-standard gas proration units to comprise the following acreage:

TOWNSHIP 28 NORTH, RANGE 6 WEST, NMPM

Unit	Acres	Description
12	320	Section 33: N/2
13	330.71	Section 33: S/2

TOWNSHIP 28 NORTH, RANGE 7 WEST, NMPM

Unit	Acres	Description
16	320	Section 35: N/2
17	332.40	Section 35: S/2

(4) That the N/2 of said Section 33 has been admitted to the participating area for the Dakota formation of the San Juan 28-6 Unit.

(5) That the S/2 of said Section 35 has been admitted to the participating area for the Dakota formation of the San Juan 28-7 Unit.

(6) That each participating area should coincide with a proration unit.

(7) That approval of the subject application will allow each of the aforesaid participating areas to coincide with a proration unit and will afford the applicant the opportunity

-3-

CASE No. 4042

Order No. R-2948-A

to produce its just and equitable share of the gas in the Basin-Dakota Gas Pool and will otherwise prevent waste and protect correlative rights.

IT IS THEREFORE ORDERED:

(1) That Order No. R-2948, dated August 16, 1965, is hereby amended by deleting therefrom the following-described non-standard gas proration units in the Basin-Dakota Gas Pool, Rio Arriba County, New Mexico:

TOWNSHIP 28 NORTH, RANGE 6 WEST, NMPM

Unit	Acres	Description
12	325.59	Section 33: W/2
13	325.02	Section 33: E/2

TOWNSHIP 28 NORTH, RANGE 7 WEST, NMPM

Unit	Acres	Description
16	324.70	Section 35: W/2
17	327.70	Section 35: E/2

and substituting in lieu thereof the following-described gas proration units:

TOWNSHIP 28 NORTH, RANGE 6 WEST, NMPM

Unit	Acres	Description
12	320	Section 33: N/2
13	330.71	Section 33: S/2

TOWNSHIP 28 NORTH, RANGE 7 WEST, NMPM

Unit	Acres	Description
16	320	Section 35: N/2
17	332.40	Section 35: S/2

-4-

CASE No. 4042

Order No. R-2948-A

(2) That jurisdiction of this cause is retained for the entry of such further orders as the Commission may deem necessary.

DONE at Santa Fe, New Mexico, on the day and year hereinabove designated.

STATE OF NEW MEXICO
OIL CONSERVATION COMMISSION

DAVID F. CARGO, Chairman

ALEX J. ARMIJO, Member

A. L. PORTER, Jr., Member & Secretary

S E A L

esr/

District I
PO Box 1980, Hobbs, NM 88241-1980
District II
PO Drawer DD, Artesia, NM 88211-0719
District III
1000 Rio Brazos Rd., Aztec, NM 87410
District IV
PO Box 2088, Santa Fe, NM 87504-2088

State of New Mexico
Energy, Minerals & Natural Resources Department

OIL CONSERVATION DIVISION
PO Box 2088
Santa Fe, NM 87504-2088

Form C-104

Revised February 10, 1994

Instructions on back

Submit to Appropriate District Office

5 Copies

☐ AMENDED REPORT

I. REQUEST FOR ALLOWABLE AND AUTHORIZATION TO TRANSPORT

Operator name and Address CONOCO INC. 10 Desta Drive Ste 100W MIDLAND, TEXAS 79705		OGRID Number 005073	
		Reason for Filing Code CH (EFFECTIVE 3-1-95) CO (EFFECTIVE 4-1-95)	
API Number 30-0 39-21652	Pool Name BASIN DAKOTA	Pool Code 71599	
Property Code 16608	Property Name SAN JUAN 28-7 <i>Unit</i>	Well Number 251	

II. Surface Location

UL or lot no. G	Section 31	Township 28 N	Range 7 W	Lot Ida	Feet from the 2025	North/South Line NORTH	Feet from the 1325	East/West line EAST	County RIO ARRIBA
--------------------	---------------	------------------	--------------	---------	-----------------------	---------------------------	-----------------------	------------------------	----------------------

Bottom Hole Location

UL or lot no.	Section	Township	Range	Lot Ida	Feet from the	North/South line	Feet from the	East/West line	County
F	P								
Lee Code	Producing Method Code	Gas Connection Date	C-129 Permit Number	C-129 Effective Date	C-129 Expiration Date				

III. Oil and Gas Transporters

Transporter OGRID	Transporter Name and Address	POD	O/G	POD ULSTR Location and Description
014538	MERIDIAN OIL INC. P.O. BOX 4289 FARMINGTON, NM. 87499	115210	0	G 31 28N 7W
007057	EL PASO NATURAL GAS CO. P.O. BOX 4990 FARMINGTON, NM 87499	115230	G	G 31 28N 7W
009018	GIANT REFINERY P.O. BOX 338 BLOOMFIELD, NM 87413	115210	0	G 31 28N 7W EFFECTIVE 4-1-95

IV. Produced Water

POD 115250	POD ULSTR Location and Description G 31 28N 7W
---------------	---

V. Well Completion Data

Spud Date	Ready Date	TD	PBTD	Perforations
Hole Size	Casing & Tubing Size	Depth Set	Sack Cement	
			RECEIVED FEB 17 1995 OIL CON. DIV. DIST. 3	

VI. Well Test Data

Date New Oil	Gas Delivery Date	Test Date	Test Length	Tbg. Pressure	Csg. Pressure
Choke Size	Oil	Water	Gas	AOF	Test Method
I hereby certify that the rules of the Oil Conservation Division have been complied with and that the information given above is true and complete to the best of my knowledge and belief. Signature: <i>Bill R. Keathly</i> Printed name: BILL R. KEATHLY Title: SR. REGULATORY SPEC. Date: 2-25-95			OIL CONSERVATION DIVISION Approved by: <i>37.8</i> SUPERVISOR DISTRICT #3 Approval Date: FEB 17 1995 Phone: (915) 686-5424		
If this is a change of operator fill in the OGRID number and name of the previous operator 00778					
Previous Operator Signature <i>Buddy Shaw</i>		Printed Name Buddy Shaw		Title Enviro Coordinator	Date 2/15/95

**NEW MEXICO OIL CONSERVATION COMMISSION
WELL LOCATION AND ACREAGE DEDICATION PLAT**

Form C-102
Supersedes C-128
Effective 1-1-55

All distances must be from the outer boundaries of the Section.

1313 1978

Operator El Paso Natural Gas Company			Lease San Juan 28-7 Unit (SF-078500-A)		Well No. 251
Unit Letter G	Section 31	Township 28N	Range 7W	County Rio Arriba	
Actual Footage Location of Well: <div style="display: flex; justify-content: space-between;"> 2025 feet from the North line and 1325 feet from the East line </div>					
Ground Level Elev. 6072	Producing Formation Dakota	Pool Basin Dakota		Dedicated Acreage 316.50 Acres	

1. Outline the acreage dedicated to the subject well by colored pencil or hatchure marks on the plat below.
2. If more than one lease is dedicated to the well, outline each and identify the ownership thereof (both as to working interest and royalty).
3. If more than one lease of different ownership is dedicated to the well, have the interests of all owners been consolidated by communitization, unitization, force-pooling, etc?

☒ Yes ☐ No If answer is "yes," type of consolidation Unitization

If answer is "no," list the owners and tract descriptions which have actually been consolidated. (Use reverse side of this form if necessary.) _____

No allowable will be assigned to the well until all interests have been consolidated (by communitization, unitization, forced-pooling, or otherwise) or until a non-standard unit, eliminating such interests, has been approved by the Commission.

DEDICATION PER N. M. O.C.C. ORDER #R-2948 AUGUST 6, 1965

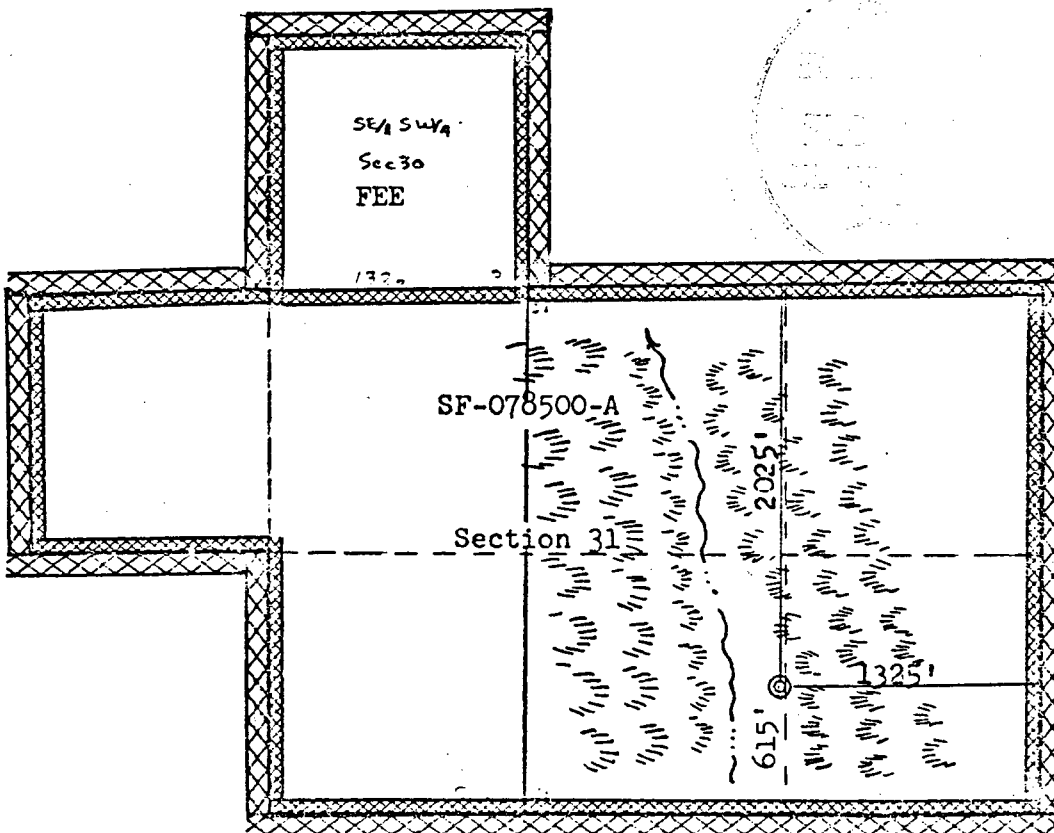

Scale: 1" = 1,000'

CERTIFICATION

I hereby certify that the information contained herein is true and complete to the best of my knowledge and belief.

D. G. Duane

Name
Drilling Clerk

Position
El Paso Natural Gas Co.

Company
January 31, 1978

Date

I hereby certify that the well location shown on this plat was plotted from field notes of actual surveys made by me or under my supervision, and that the same is true and correct to the best of my knowledge and belief.

Date Surveyed
November 30, 1977

Registered Professional Engineer and Land Surveyor

Fred B. Kerr Jr.
Fred B. Kerr Jr.

Certificate No.
3950

OIL CONSERVATION DIVISION

DISTRICT II
P.O. Drawer DD, Artesia, NM 88210

P.O. Box 2088

Santa Fe, New Mexico 87504-2088

DISTRICT III
1000 Rio Brazos Rd., Aztec, NM 87410

REQUEST FOR ALLOWABLE AND AUTHORIZATION
TO TRANSPORT OIL AND NATURAL GAS

Operator AMOCO PRODUCTION COMPANY		Well API No. 300392165200
Address P.O. BOX 800, DENVER, COLORADO 80201		
Reason(s) for Filing (Check proper box) <input type="checkbox"/> Other (Please explain)		
New Well <input type="checkbox"/>	Change in Transporter of:	
Recompletion <input type="checkbox"/>	Oil <input checked="" type="checkbox"/> Dry Gas <input type="checkbox"/>	
Change in Operator <input type="checkbox"/>	Casinghead Gas <input type="checkbox"/> Condensate <input type="checkbox"/>	
If change of operator give name and address of previous operator		

II. DESCRIPTION OF WELL AND LEASE

Lease Name SAN JUAN 28 7 UNIT	Well No. 251	Pool Name, Including Formation BASIN DAKOTA (PRORATED GAS)	Kind of Lease State, Federal or Fee	Lease No.
Location Unit Letter <u>G</u> : <u>2025</u> Feet From The <u>FNL</u> Line and <u>1325</u> Feet From The <u>FEL</u> Line Section <u>31</u> Township <u>28N</u> Range <u>7W</u> , NMPM, <u>RIO ARRIBA</u> County				

III. DESIGNATION OF TRANSPORTER OF OIL AND NATURAL GAS

Name of Authorized Transporter of Oil <input type="checkbox"/> or Condensate <input type="checkbox"/> MERIDIAN OIL INC.	Address (Give address to which approved copy of this form is to be sent) 3535 EAST 30TH STREET, FARMINGTON, NM 87401					
Name of Authorized Transporter of Casinghead Gas <input type="checkbox"/> or Dry Gas <input type="checkbox"/> EL PASO NATURAL GAS COMPANY	Address (Give address to which approved copy of this form is to be sent) P.O. BOX 1492, EL PASO, TX 79978					
If well produces oil or liquids, give location of tanks.	Unit	Sec.	Twp.	Rge.	Is gas actually connected?	When?

If this production is commingled with that from any other lease or pool, give commingling order number:

IV. COMPLETION DATA

Designate Type of Completion - (X)	Oil Well	Gas Well	New Well	Workover	Deepen	Plug Back	Same Res'v	Diff Res'v
Date Spudded	Date Compl. Ready to Prod.		Total Depth		P.B.T.D.			
Elevations (DF, RKB, RT, GR, etc.)	Name of Producing Formation		Top Oil/Gas Pay		Tubing Depth			
Perforations					Depth Casing Shoe			
TUBING, CASING AND CEMENTING RECORD								
HOLE SIZE	CASING & TUBING SIZE		DEPTH SET		SACKS CEMENT			
RECEIVED AUG 23 1990 OIL CON. DIV.								

V. TEST DATA AND REQUEST FOR ALLOWABLE

OIL WELL (Test must be after recovery of total volume of load oil and must be equal to or exceed top allowable for this depth or be for full 24 hours.)			
Date First New Oil Run To Tank	Date of Test	Producing Method (Flow, pump, gas lift, etc.)	
Length of Test	Tubing Pressure	Casing Pressure	Choke Size
Actual Prod. During Test	Oil - Bbls.	Water - Bbls.	Gas- MCF

GAS WELL

Actual Prod. Test - MCF/D	Length of Test	Bbls. Condensate/MMCF	Gravity of Condensate
Testing Method (pilot, back pr.)	Tubing Pressure (Shut-in)	Casing Pressure (Shut-in)	Choke Size

VI. OPERATOR CERTIFICATE OF COMPLIANCE

I hereby certify that the rules and regulations of the Oil Conservation Division have been complied with and that the information given above is true and complete to the best of my knowledge and belief.

D. W. Whaley
Signature
Doug W. Whaley, Staff Admin. Supervisor
Printed Name
Title
Date July 5, 1990 Telephone No. 303-830-4280

OIL CONSERVATION DIVISION

AUG 23 1990

Date Approved

By Bill D. Sherry

SUPERVISOR DISTRICT #3

Title

INSTRUCTIONS: This form is to be filed in compliance with Rule 1104

- 1) Request for allowable for newly drilled or deepened well must be accompanied by tabulation of deviation tests taken in accordance with Rule 111.
- 2) All sections of this form must be filled out for allowable on new and recompleted wells.
- 3) Fill out only Sections I, II, III, and VI for changes of operator, well name or number, transporter, or other such changes.
- 4) Separate Form C-104 must be filed for each pool in multiply completed wells.

DISTRICT II
P.O. Drawer DD, Artesia, NM 88210

DISTRICT III
1000 Rio Brazos Rd., Aztec, NM 87410

OIL CONSERVATION DIVISION

P.O. Box 2088
Santa Fe, New Mexico 87504-2088

REQUEST FOR ALLOWABLE AND AUTHORIZATION TO TRANSPORT OIL AND NATURAL GAS

RECEIVED

JUN 14 1989

OIL CONSERVATION DIV.
SANTA FE

I. Operator
Amoco Production Company
Well APN No. 3003921652
Address
1670 Broadway, P. O. Box 800, Denver, Colorado 80201
Reason(s) for Filing (Check proper box) ☐ Other (Please explain)
New Well ☐ Change in Transporter of:
Recompletion ☐ Oil ☐ Dry Gas ☐
Change in Operator ☒ Casinghead Gas ☐ Condensate ☐
If change of operator give name and address of previous operator
Tenneco Oil E & P, 6162 S. Willow, Englewood, Colorado 80155

II. DESCRIPTION OF WELL AND LEASE

Lease Name SAN JUAN 28-7 UNIT	Well No. 251	Pool Name, Including Formation BASIN (DAKOTA)	FEDERAL	Lease No. SF078040
Location Unit Letter G : 2025 Feet From The FNL Line and 1325 Feet From The FEL Line Section 31 Township 28N Range 7W, NMPM, RIO ARRIBA County				

III. DESIGNATION OF TRANSPORTER OF OIL AND NATURAL GAS

Name of Authorized Transporter of Oil CONOCO	<input type="checkbox"/> or Condensate <input checked="" type="checkbox"/>	Address (Give address to which approved copy of this form is to be sent) P. O. BOX 1429, BLOOMFIELD, NM 87413				
Name of Authorized Transporter of Casinghead Gas EL PASO NATURAL GAS COMPANY	<input type="checkbox"/> or Dry Gas <input checked="" type="checkbox"/>	Address (Give address to which approved copy of this form is to be sent) P. O. BOX 1492, EL PASO, TX 79978				
If well produces oil or liquids, give location of tanks.	Unit	Sec.	Twp.	Rge.	Is gas actually connected?	When?

If this production is commingled with that from any other lease or pool, give commingling order number:

IV. COMPLETION DATA

Designate Type of Completion - (X)	Oil Well	Gas Well	New Well	Workover	Deepen	Plug Back	Same Res'v	Diff Res'v
Date Spudded	Date Compl. Ready to Prod.		Total Depth			P.B.T.D.		
Elevations (DF, RKB, RT, GR, etc.)	Name of Producing Formation		Top Oil/Gas Pay			Tubing Depth		
Perforations						Depth Casing Shoe		
TUBING, CASING AND CEMENTING RECORD								
HOLE SIZE	CASING & TUBING SIZE		DEPTH SET		SACKS CEMENT			

V. TEST DATA AND REQUEST FOR ALLOWABLE

OIL WELL (Test must be after recovery of total volume of load oil and must be equal to or exceed top allowable for this depth or be for full 24 hours.)

Date First New Oil Run To Tank	Date of Test	Producing Method (Flow, pump, gas lift, etc.)	
Length of Test	Tubing Pressure	Casing Pressure	Choke Size
Actual Prod. During Test	Oil - Bbls.	Water - Bbls.	Gas - MCF

GAS WELL

Actual Prod. Test - MCF/D	Length of Test	Bbls. Condensate/MMCF	Gravity of Condensate
Testing Method (pilot, back pr.)	Tubing Pressure (Shut-in)	Casing Pressure (Shut-in)	Choke Size

VI. OPERATOR CERTIFICATE OF COMPLIANCE

I hereby certify that the rules and regulations of the Oil Conservation Division have been complied with and that the information given above is true and complete to the best of my knowledge and belief.

J. L. Hampton
Signature

J. L. Hampton Sr. Staff Admin. Suprv.
Printed Name Title
January 16, 1989 303-830-5025
Date Telephone No.

OIL CONSERVATION DIVISION

Date Approved MAY 08 1989

By *Bill J. Shum*
SUPERVISION DISTRICT # 3

Title

INSTRUCTIONS: This form is to be filed in compliance with Rule 1104

- 1) Request for allowable for newly drilled or deepened well must be accompanied by tabulation of deviation tests taken in accordance with Rule 111.
- 2) All sections of this form must be filled out for allowable on new and recompleted wells.
- 3) Fill out only Sections I, II, III, and VI for changes of operator, well name or number, transporter, or other such changes.
- 4) Separate Form C-104 must be filed for each pool in multiply completed wells.

STATE OF NEW MEXICO
ENERGY AND MINERALS DEPARTMENT

NO. OF COPIES RECEIVED	
DISTRIBUTION	
SANTA FE	
FILE	
U.S.G.S.	
LAND OFFICE	
TRANSPORTER	OIL
	GAS
OPERATOR	
PRORATION OFFICE	

OIL CONSERVATION DIVISION

P.O. BOX 2088
SANTA FE, NEW MEXICO 87501

REQUEST FOR ALLOWABLE
AND
AUTHORIZATION TO TRANSPORT OIL AND NATURAL GAS

Form C-104
Revised 10-01-78
Format 06-01-83
Page 1

Operator Tenneco Oil Company -	
Address P.O. Box 3249, Englewood, CO 80155	
Reason(s) for filing (Check proper box)	Other (Please explain)
<input type="checkbox"/> New Well <input type="checkbox"/> Recompletion <input checked="" type="checkbox"/> Change in Ownership	Change in Transporter of: <input type="checkbox"/> Oil <input type="checkbox"/> Casinghead Gas <input type="checkbox"/> Dry Gas <input checked="" type="checkbox"/> Condensate

If change of ownership give name and address of previous owner **El Paso Natural Gas Company, P.O. Box 4990, Farmington, NM 87499**

II. DESCRIPTION OF WELL AND LEASE

Lease Name SJ 28-7 Unit	Well No. 251	Pool Name, including Formation Basin Dakota	Kind of Lease State, Federal or Fee USA SF	Lease No. 078500-A
Location Unit Letter G : 2025 Feet From The North Line and 1325 Feet From The East Line of Section 31 Township 28N Range 7W , NMPM, Rio Arriba County				

III. DESIGNATION OF TRANSPORTER OF OIL AND NATURAL GAS

Name of Authorized Transporter of Oil <input type="checkbox"/> or Condensate <input checked="" type="checkbox"/> Conoco Inc. Surface Transportation	Address (Give address to which approved copy of this form is to be sent) P.O. Box 460, Hobbs, NM 88240	
Name of Authorized Transporter of Casinghead Gas <input type="checkbox"/> or Dry Gas <input checked="" type="checkbox"/> El Paso Natural Gas Company	Address (Give address to which approved copy of this form is to be sent) P.O. Box 4990, Farmington, NM 87499	
If well produces oil or liquids, give location of tanks.	Unit G	Sec. 31
	Twp. 28N	Rge. 7W
	Is gas actually connected? Yes	

If this production is commingled with that from any other lease or pool, give commingling order number

NOTE: Complete Parts IV and V on reverse side if necessary.

VI. CERTIFICATE OF COMPLIANCE

I hereby certify that the rules and regulations of the Oil Conservation Division have been complied with and that the information given is true and complete to the best of my knowledge and belief.

Scott McKinney
(Signature)

Sr. Regulatory Analyst

OCT 1 1985
(Date)

OIL CONSERVATION DIVISION
APPROVED *Frank J. [Signature]*, 19
BY
TITLE **SUPERVISOR DISTRICT 3**

This form is to be filed in compliance with RULE 1104.

If this is a request for allowable for a newly drilled or deepened well, this form must be accompanied by a tabulation of the deviation tests taken on the well in accordance with RULE 111.

All sections of this form must be filled out completely for allowable on new and recompleted wells.

Fill out only Section I, II, III, and VI for changes of owner, well name and or number, or transporter, or other such change of condition.

Separate Forms C-104 must be filed for each pool in multiply completed wells.

IV. COMPLETION DATA

Designate Type of Completion — (X)		Oil Well	Gas Well	New Well	Workover	Deepen	Plug Back	Same Res.v.	Diff. Res.v
Date Spudded	Date Compl. Ready to Prod.		Total Depth			P.B.T.D.			
Elevations (DF, RKB, RT, GR, etc.)	Name of Producing Formation		Top Oil/Gas Pay			Tubing Depth			
Perforations						Depth Casing Shoe			
TUBING, CASING, AND CEMENTING RECORD									
HOLE SIZE	CASING & TUBING SIZE			DEPTH SET			SACKS CEMENT		

V. TEST DATA AND REQUEST FOR ALLOWABLE OIL WELL

(Test must be after recovery of total volume of load oil and must be equal to or exceed top allowable for this depth or be for full 24 hours)

Date First New Oil Run To Tanks	Date of Test	Producing Method (Flow, pump, gas lift, etc.)	
Length of Test	Tubing Pressure	Casing Pressure	Choke Size
Actual Prod. During Test	Oil - Bbls.	Water - Bbls.	Gas - MCF

GAS WELL

Actual Prod. Test - MCF/D	Length of Test	Bbls. Condensate/MMCF	Gravity of Condensate
Testing Method (pilot, back pr.)	Tubing Pressure (Shut-in)	Casing Pressure (Shut-in)	Choke Size

EL PASO NATURAL GAS COMPANY
POST OFFICE BOX 990
FARMINGTON, NEW MEXICO

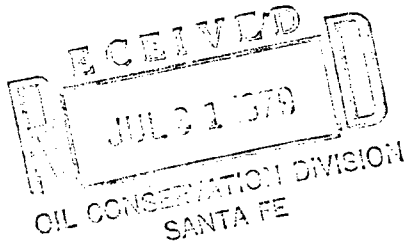

NOTICE OF GAS CONNECTION

DATE July 24, 1979

THIS IS TO NOTIFY THE OIL CONSERVATION COMMISSION THAT CONNECTION FOR PURCHASE OF

GAS FROM El Paso Natural Gas Company San Juan 28-7 Unit #251
Operator Well Name

90-574-01 20856 G 31-28-7
Meter Code Site Code Well Unit S-T-R

Basin Dakota El Paso Natural Gas Company
Pool Name of Purchaser

WAS MADE ON July 20, 1979 FIRST DELIVERY July 21, 1979
Date Date

AOF -

CHOKE -

El Paso Natural Gas Company
Purchaser

[Signature]
Representative

Chief Dispatcher
Title

cc: Operator
Oil Conservation Commission - 2
Proration - El Paso

File

NEW MEXICO OIL CONSERVATION COMMISSION
REQUEST FOR ALLOWABLE
AND
AUTHORIZATION TO TRANSPORT OIL AND NATURAL GAS

Form C-104
Supersedes Old C-104 and C-11
Effective 1-1-65

API 30-039-21652

I.

DISTRIBUTION			
SANTA FE			
FILE			
U.S.G.S.			
LAND OFFICE			
TRANSPORTER	OIL		
	GAS		
OPERATOR			
PRORATION OFFICE			

Operator
El Paso Natural Gas Company
Address
P.O. Box 289, Farmington, N.M. 87401
Reason(s) for filing (Check proper box)
New Well ☒ Change in Transporter of:
Recompletion ☐ Oil ☐ Dry Gas ☐
Change in Ownership ☐ Casinghead Gas ☐ Condensate ☐
Other (Please explain)
RECEIVED
JUN 20 1979
OIL CONSERVATION DIVISION
SANTA FE
If change of ownership give name and address of previous owner

II. DESCRIPTION OF WELL AND LEASE

Lease Name San Juan 28-7 Unit	Well No. 251	Pool Name, Including Formation Basin Dakota	Kind of Lease State, Federal or Fee	Lease No. SE 078500A
Location Unit Letter G ; 2025 Feet From The North Line and 1325 Feet From The East Line of Section 31 Township 28-N Range 7-W, NMPM, Rio Arriba County				

III. DESIGNATION OF TRANSPORTER OF OIL AND NATURAL GAS

Name of Authorized Transporter of Oil <input type="checkbox"/> or Condensate <input checked="" type="checkbox"/> El Paso Natural Gas Company	Address (Give address to which approved copy of this form is to be sent) P.O. Box 289, Farmington, N.M. 87401	
Name of Authorized Transporter of Casinghead Gas <input type="checkbox"/> or Dry Gas <input checked="" type="checkbox"/> El Paso Natural Gas Company	Address (Give address to which approved copy of this form is to be sent) P.O. Box 289, Farmington, N.M. 87401	
If well produces oil or liquids, give location of tanks.	Unit G	Sec. 31
	Twp. 28-N	Rge. 7-W
	Is gas actually connected? When	

If this production is commingled with that from any other lease or pool, give commingling order number:

IV. COMPLETION DATA

Designate Type of Completion - (X)	Oil Well	Gas Well	New Well	Workover	Deepen	Plug Back	Same Res'tv.	Diff. Res'tv.
		X	X					
Date Spudded 1-4-79	Date Compl. Ready to Prod. 5-15-79	Total Depth 7075'	P.B.T.D. 7056'					
Elevations (DF, RKB, RT, GR, etc.) 6072' G.L.	Name of Producing Formation Basin Dakota	Top Gas/Gas Pay 6824'	Tubing Depth 7016'					
Perforations 6824, 6828, 6832, 6836, 6910, 6945, 6950, 6955, 6986, 7002	Depth Casing Shoe 7075'							
TUBING, CASING, AND CEMENTING RECORD								
HOLE SIZE	CASING & TUBING SIZE	DEPTH SET	SACKS CEMENT					
13 3/4"	9 5/8"	216'	224 cf					
8 3/4"	7"	2923'	312 cf					
6 1/4"	4 1/2"	7075'	640 cf					
	1 1/2"	7016'	tubing					

V. TEST DATA AND REQUEST FOR ALLOWABLE OIL WELL

(Test must be after recovery of total volume of load oil and must be equal to or exceed top allowable for this depth or be for full 24 hours)

Date First New Oil Run To Tanks	Date of Test	Producing Method (Flow, pump, gas lift, etc.)	
Length of Test	Tubing Pressure	Casing Pressure	Choke Size
Actual Prod. During Test	Oil-Bbls.	Water-Bbls.	Gas-MCF

GAS WELL

Actual Prod. Test-MCF/D	Length of Test	Bbls. Condensate/MMCF	Gravity of Condensate
Testing Method (pilot, back pr.)	Tubing Pressure (shut-in) 2318	Casing Pressure (shut-in) 2335	Choke Size

VI. CERTIFICATE OF COMPLIANCE

I hereby certify that the rules and regulations of the Oil Conservation Commission have been complied with and that the information given above is true and complete to the best of my knowledge and belief.

Al. P. Drisco
(Signature)

Drilling Clerk

(Title)

June 19, 1979

(Date)

OIL CONSERVATION COMMISSION

APPROVED JUN 20 1979
BY AR. Dendrick
SUPERVISOR DISTRICT #3
TITLE

This form is to be filed in compliance with RULE 1104.

If this is a request for allowable for a newly drilled or deepened well, this form must be accompanied by a tabulation of the deviation tests taken on the well in accordance with RULE 111.

All sections of this form must be filled out completely for allowable on new and recompleted wells.

Fill out only Sections I, II, III, and VI for changes of owner, well name or number, or transporter, or other such change of condition.

Separate Forms C-104 must be filed for each pool in multiple

UNITED STATES
DEPARTMENT OF THE INTERIOR
GEOLOGICAL SURVEY

SUBMIT IN DUPLICATE*

(See other in-
structions on
reverse side)Form approved.
Budget Bureau No. 42-R355.5.

WELL COMPLETION OR RECOMPLETION REPORT AND LOG *

1a. TYPE OF WELL: OIL WELL <input type="checkbox"/> GAS WELL <input checked="" type="checkbox"/> DRY <input type="checkbox"/> Other <input type="checkbox"/>		5. LEASE DESIGNATION AND SERIAL NO. SF 078500 A	
b. TYPE OF COMPLETION: NEW WELL <input checked="" type="checkbox"/> WORK OVER <input type="checkbox"/> DEEP-EN <input type="checkbox"/> PLUG BACK <input type="checkbox"/> DIFF. RESVR. <input type="checkbox"/> Other <input type="checkbox"/>		6. IF INDIAN, ALLOTTEE OR TRIBE NAME	
2. NAME OF OPERATOR El Paso Natural Gas Company		7. UNIT AGREEMENT NAME S.J. 28-7 Unit	
3. ADDRESS OF OPERATOR P.O. Box 289, Farmington, New Mexico 87401		8. FARM OR LEASE NAME S.J. 28-7 Unit	
4. LOCATION OF WELL (Report location clearly and in accordance with any State requirements)* At surface 2025' N, 1325' E At top prod. interval reported below At total depth		9. WELL NO. 251	
14. PERMIT NO.		10. FIELD AND POOL, OR WILDCAT Basin Dakota	
DATE ISSUED		11. SEC. T. R. M., OR BLOCK AND SURVEY OR AREA Sec 31, T-28-N, R-7-W, N.M.P.M.	
15. DATE SPUDDED 1-4-79		12. COUNTY OR PARISH Rio Arriba	
16. DATE T.D. REACHED 1-11-79		13. STATE New Mexico	
17. DATE COMPL. (Ready to prod.) 5-15-79		18. ELEVATIONS (DF, REB, RT, GR, ETC.)* 6072' G.L.	
19. ELEV. CASINGHEAD		20. TOTAL DEPTH, MD & TVD 7075'	
21. PLUG, BACK T.D., MD & TVD 7056'		22. IF MULTIPLE COMPL., HOW MANY*	
23. INTERVALS DRILLED BY 10-7075'		24. PRODUCING INTERVAL(S), OF THIS COMPLETION—TOP, BOTTOM, NAME, MD & TVD 6824-7002' (Dakota)	
25. WAS DIRECTIONAL SURVEY MADE No		26. TYPE ELECTRIC AND OTHER LOGS RUN CDL, GR-Ind., Corr., Temp. Survey	
27. WAS WELL CORED No		28. CASING RECORD (Report in accordance with Division)	
CASING SIZE		WEIGHT, LB./FT.	
DEPTH SET (MD)		HOLE SIZE	
CEMENTING RECORD		AMOUNT PULLED	
9 5/8"		36#	
216'		13 3/4"	
224 cu. ft.		7"	
20#		2923'	
8 3/4"		312 cu. ft.	
4 1/2"		10.5 & 11.6#	
7075'		6 1/4"	
640 cu. ft.		29. LINER RECORD	
30. TUBING RECORD		31. PERFORATION RECORD (Interval, size and number)	
SIZE		TOP (MD)	
DEPTH SET (MD)		BOTTOM (MD)	
PACKER SET (MD)		SACKS CEMENT*	
SCREEN (MD)		5-15-79	
1 1/2"		7016'	
32. ACID, SHOT, FRACTURE, CEMENT SQUEEZE, ETC.		33.* PRODUCTION	
DEPTH INTERVAL (MD)		DATE FIRST PRODUCTION	
AMOUNT AND KIND OF MATERIAL USED		PRODUCTION METHOD (Flowing, gas lift, pumping, etc. and type of pump)	
6824-7002'		After Frac Gauge-394 MCF/Day	
26,500# sand & 67,960 gal. wtr.		WELL STATUS (Producing or shut-in) Shut-in	
34. DISPOSITION OF GAS (Sold, used for fuel, vented, etc.)		DATE OF TEST	
TEST WITNESSED BY N. Waggoner		HOURS TESTED	
CHOKE SIZE		PROD'N. FOR TEST PERIOD	
OIL—BBL.		GAS—MCF.	
WATER—BBL.		OIL GRAVITY-API (CORR.)	
SI 2435		FLOW. TUBING PRESS.	
CASING PRESSURE		CALCULATED 24-HOUR RATE	
OIL—BBL.		GAS—MCF.	
WATER—BBL.		OIL GRAVITY-API (CORR.)	
SI 2435		35. LIST OF ATTACHMENTS	
36. I hereby certify that the foregoing and attached information is complete and correct as determined from all available records.		SIGNED <i>D. G. Brisco</i>	
TITLE Drilling Clerk		DATE 7-6-79	

*(See Instructions and Spaces for Additional Data on Reverse Side)

UNITED STATES
DEPARTMENT OF THE INTERIOR
GEOLOGICAL SURVEYForm Approved
Budget Bureau No. 42-R1424

SUNDRY NOTICES AND REPORTS ON WELLS

(Do not use this form for proposals to drill or to deepen or plug back to a different reservoir. Use Form 9-331-C for such proposals.)

1. oil ☐ well gas ☒ well other ☐

2. NAME OF OPERATOR
El Paso Natural Gas Company

3. ADDRESS OF OPERATOR
P.O. Box 289, Farmington, New Mexico 87401

4. LOCATION OF WELL (REPORT LOCATION CLEARLY. See space 17 below.)
AT SURFACE: 2025'N, 1325'E
AT TOP PROD. INTERVAL:
AT TOTAL DEPTH:

16. CHECK APPROPRIATE BOX TO INDICATE NATURE OF NOTICE, REPORT, OR OTHER DATA

REQUEST FOR APPROVAL TO:

TEST WATER SHUT-OFF ☐
FRACTURE TREAT ☐
SHOOT OR ACIDIZE ☐
REPAIR WELL ☐
PULL OR ALTER CASING ☐
MULTIPLE COMPLETE ☐
CHANGE ZONES ☐
ABANDON* ☐
(other) ☐

SUBSEQUENT REPORT OF:

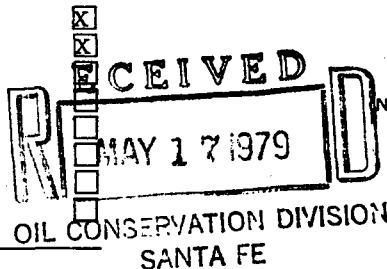

5. LEASE
SF 078500A

6. IF INDIAN, ALLOTTEE OR TRIBE NAME

7. UNIT AGREEMENT NAME
San Juan 28-7 Unit

8. FARM OR LEASE NAME
San Juan 28-7 Unit

9. WELL NO.
251

10. FIELD OR WILDCAT NAME
Basin Dakota

11. SEC., T., R., M., OR BLK. AND SURVEY OR AREA
Sec. 31, T-28-N, R-7-W
N.M.P.M.

12. COUNTY OR PARISH
Rio Arriba

13. STATE
New Mexico

14. API NO.

15. ELEVATIONS (SHOW DF, KDB, AND WD)
6072' GL

NOTE: Report results of multiple completion or zone change on Form 9-330.

17. DESCRIBE PROPOSED OR COMPLETED OPERATIONS (Clearly state all pertinent details, and give pertinent dates, including estimated date of starting any proposed work. If well is directionally drilled, give subsurface locations and measured and true vertical depths for all markers and zones pertinent to this work.)*

1-07-79: TD 2923'. Ran 72 jts. 7", 20#, K-55 intermediate casing, 2911' set at 2923'. Cemented w/312 cu. ft. cement. WOC 12 hours; held 1200#/30 minutes. Top of cement at 1450'.

1-12-79: TD 7075'. Ran 215 jts. 4 1/2", 10.5# & 11.6#, K-55 production casing, 7065' set at 7075'. Float collar set at 7056'. Cemented w/640 cu. ft. cement. WOC 18 hours. Top of cement at 2500'.

5-05-79: PBDT 7056'. Tested casing to 4000#, OK. Perfed Dak 6824, 6828, 6832, 6836, 6910, 6945, 6950, 6955, 6986, 7002' w/1 SPZ. Fraced w/79,500# 20/40 sand, 26,500# 10/20 sand and 67,960 gal. gelled water. Flushed w/4578 gal. water.

Subsurface Safety Valve: Manu. and Type _____

18. I hereby certify that the foregoing is true and correct

SIGNED N. G. Buss TITLE Drilling Clerk DATE May 7, 1979

(This space for Federal or State office use)

APPROVED BY _____ TITLE _____ DATE _____
CONDITIONS OF APPROVAL, IF ANY:

UNITED STATES
DEPARTMENT OF THE INTERIOR
GEOLOGICAL SURVEY

SUNDRY NOTICES AND REPORTS ON WELLS

(Do not use this form for proposals to drill or to deepen or plug back to a different reservoir. Use Form 9-331-C for such proposals.)

1. oil ☐ gas ☒ other ☐
2. NAME OF OPERATOR
EL PASO NATURAL GAS CO.
3. ADDRESS OF OPERATOR
BOX 289, FARMINGTON, NEW MEXICO
4. LOCATION OF WELL (REPORT LOCATION CLEARLY. See space 17 below.)
AT SURFACE: 2025'N, 1325'E
AT TOP PROD. INTERVAL:
AT TOTAL DEPTH:
16. CHECK APPROPRIATE BOX TO INDICATE NATURE OF NOTICE, REPORT, OR OTHER DATA

REQUEST FOR APPROVAL TO: SUBSEQUENT REPORT OF:
TEST WATER SHUT-OFF ☐ ☒
FRACTURE TREAT ☐ ☐
SHOOT OR ACIDIZE ☐ ☐
REPAIR WELL ☐ ☐
PULL OR ALTER CASING ☐ ☐
MULTIPLE COMPLETE ☐ ☐
CHANGE ZONES ☐ ☐
ABANDON* ☐ ☐
(other) ☐ ☐

5. LEASE
SF 078500A
6. IF INDIAN, ALLOTTEE OR TRIBE NAME
7. UNIT AGREEMENT NAME
San Juan 28-7 Unit
8. FARM OR LEASE NAME
San Juan 28-7 Unit
9. WELL NO.
251
10. FIELD OR WILDCAT NAME
Basin Dakota
11. SEC., T., R., M. OR BLK. AND SURVEY OR AREA
Sec. 31, T-28-N, R-7-W
NMPM
12. COUNTY OR PARISH
Rio Arriba
13. STATE
New Mexico
14. API NO.
15. ELEVATIONS (SHOW DF, KDB, AND WD)
6072' GL

(NOTE: Report results of multiple completion or zone change on Form 9-330.)

17. DESCRIBE PROPOSED OR COMPLETED OPERATIONS (Clearly state all pertinent details, and give pertinent dates, including estimated date of starting any proposed work. If well is directionally drilled, give subsurface locations and measured and true vertical depths for all markers and zones pertinent to this work.)*

1/4/79: Spudded well. Drilled surface hole.

1/5/79: Ran 5 joints 9 5/8", 36# K-55 surface casing, 202' set at 216'. Cemented with 224 cu. ft. cement. Circulated to surface, WOC 12 hours; held 600#/30 minutes.

Subsurface Safety Valve: Manu. and Type

18. I hereby certify that the foregoing is true and correct

SIGNED D. P. Buico TITLE Drilling Clerk DATE 1/9/79

(This space for Federal or State office use)

APPROVED BY _____ TITLE _____ DATE _____
CONDITIONS OF APPROVAL, IF ANY:

*See Instructions on Reverse Side

U. S. GEOLOGICAL SURVEY
BURANGO, COLO.

UNITED STATES
DEPARTMENT OF THE INTERIOR
GEOLOGICAL SURVEY

30-039-21652

5. LEASE DESIGNATION AND SERIAL NO.

SF 078500A

6. IF INDIAN, ALLOTTEE OR TRIBE NAME

7. UNIT AGREEMENT NAME

San Juan 28-7 Unit

8. FARM OR LEASE NAME

San Juan 28-7 Unit

9. WELL NO.

251

10. FIELD AND POOL, OR WILDCAT

Basin Dakota

11. SEC., T., R., M., OR BLK.
AND SURVEY OR AREASec. 31, T-28-N, R-7-W
NMPM

12. COUNTY OR PARISH

13. STATE

Rio Arriba

NM

APPLICATION FOR PERMIT TO DRILL, DEEPEN, OR PLUG BACK

1a. TYPE OF WORK

DRILL ☒DEEPEN ☐PLUG BACK ☐

b. TYPE OF WELL

OIL
WELL ☐GAS
WELL ☒

OTHER

SINGLE
ZONE ☒MULTIPLE
ZONE ☐

2. NAME OF OPERATOR

El Paso Natural Gas Company

3. ADDRESS OF OPERATOR

PO Box 990, Farmington, NM 87401

4. LOCATION OF WELL (Report location clearly and in accordance with any State requirements.)*

At surface

2025'N, 1325' E

At proposed prod. zone

14. DISTANCE IN MILES AND DIRECTION FROM NEAREST TOWN OR POST OFFICE*

21 miles SE of Blanco, NM

15. DISTANCE FROM PROPOSED*

LOCATION TO NEAREST

PROPERTY OR LEASE LINE, FT.
(Also to nearest drlg. unit line, if any)

615

16. NO. OF ACRES IN LEASE

Unit

17. NO. OF ACRES ASSIGNED
TO THIS WELL

316.50

18. DISTANCE FROM PROPOSED LOCATION*
TO NEAREST WELL, DRILLING, COMPLETED,
OR APPLIED FOR, ON THIS LEASE, FT.

310

19. PROPOSED DEPTH

7060'

20. ROTARY OR CABLE TOOLS

Rotary

21. ELEVATIONS (Show whether DF, RT, GR, etc.)

6072'GR

22. APPROX. DATE WORK WILL START*

23.

PROPOSED CASING AND CEMENTING PROGRAM

SIZE OF HOLE	SIZE OF CASING	WEIGHT PER FOOT	SETTING DEPTH	QUANTITY OF CEMENT
13 3/4"	9 5/8"	32.3#	200'	224 cu.ft. to circulate
8 3/4"	7"	20.0#	2920'	271 cu.ft. to cover Ojo Ala.
6 1/4"	4 1/2" liner	11.6#-10.5#	7060'	637 cu.ft. to fill to 2920'

Selectively perforate and sandwater fracture the Dakota formation.

A 3000 psi WP and 6000 psi test double gate preventer equipped with
blind and pipe rams will be used for blow out prevention on this well.

This gas is dedicated.

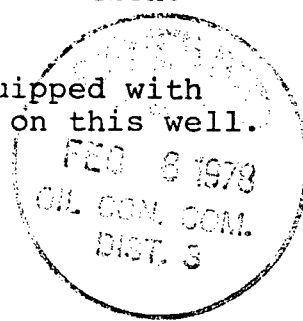
The SE/4 SW/4 of Section 30 and Lot 1, E/2 NW/4 and NE/4 of Section 31
is dedicated to this well.

IN ABOVE SPACE DESCRIBE PROPOSED PROGRAM: If proposal is to deepen or plug back, give data on present productive zone and proposed new productive zone. If proposal is to drill or deepen directionally, give pertinent data on subsurface locations and measured and true vertical depths. Give blowout preventer program, if any.

24.

SIGNED

W. G. Bruce

TITLE

Drilling Clerk

DATE

1-31-78

(This space for Federal or State office use)

PERMIT NO.

APPROVAL DATE

RECEIVED

APPROVED BY

TITLE

FEB 2 1978

CONDITIONS OF APPROVAL, IF ANY:

akaf

*See Instructions On Reverse Side

U. S. GEOLOGICAL SURVEY
DURANGO, COLO.

NW 1/4 R-2948 Hall C-100 for US

Typical B.O.P. Installation for Dakota Well

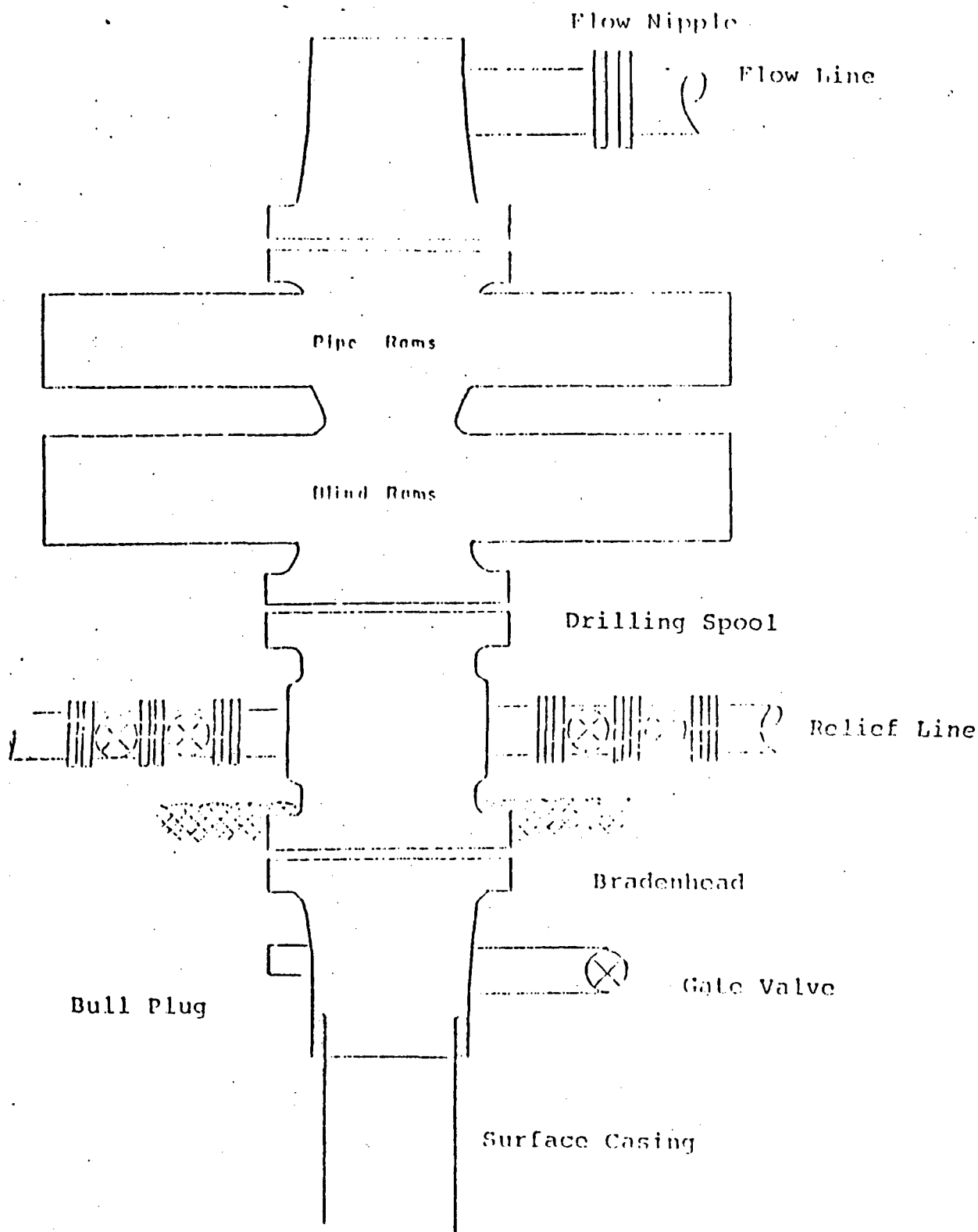

Series 900 Double Gate BOP, rated
at 3000 psi Working Pressure

When gas drilling operations begin a Shaffer type
50 or equivalent rotating head is installed on top of
the flow nipple and the flow line is converted into
a blowie line.