



V. E. Staley
Area Superintendent

August 8, 1978

Amoco Production Company

P.O. Drawer A
Levelland, Texas 79336

NSL-979
Rule 104F
Sept 3, 1978
Pennsylvania
Formation
NH dedicated

AUG 14 1978

File: VES-WF-1527

Re: Unorthodox Location
Williams Gas Com Well No. 1
Undesignated Morrow
Eddy County, New Mexico

State of New Mexico
Department of Energy and Minerals
Oil Conservation Division
P. O. Box 2088
Santa Fe, NM 87501

Attention: Mr. Joe D. Ramey, Secretary-Director

Dear Mr. Ramey:

Amoco Production Company respectfully requests administrative approval for an unorthodox location for our Williams Gas Com Well No. 1, located 560 feet FNL and 1980 feet FWL, Unit C, Section 21, T 19 S, R 24 E, Eddy County, New Mexico. Approval is requested based upon topographical conditions.

The orthodox drillsite, located 660 feet FNL and 1980 feet FWL, would have placed the well in a concrete canal used for irrigation by Carlsbad Irrigation Company. A house, corrals, and a barn prevented the movement of the well east, and the only location available is the unorthodox location at 560 feet FNL and 1980 feet FWL. The deposition trend of the reef discouraged us from moving the well to the south.

In support of our request, we have attached the following:

1. Topographic map showing the wellsite and the existing topographical conditions.
2. Plat showing the well location and all offset operators.
3. A list of names and addresses of all offset operators.

location
correction
phone dialed by
Ray Cor. Caught
by Delta
25-23 S - 28 E

State of New Mexico
Oil Conservation Division
Santa Fe, NM 87501

-2-

File: VES-WF-1527

4. A copy of a letter from Amoco to all offset operators.
5. Proof that the letter has been sent by Certified Mail to all offset operators.

We respectfully request that the Division give administrative approval for this unorthodox location due to topographical conditions.

Yours very truly,

A handwritten signature in black ink, consisting of a stylized 'S' shape with a horizontal line extending to the left.

Attachments

RWC:jla

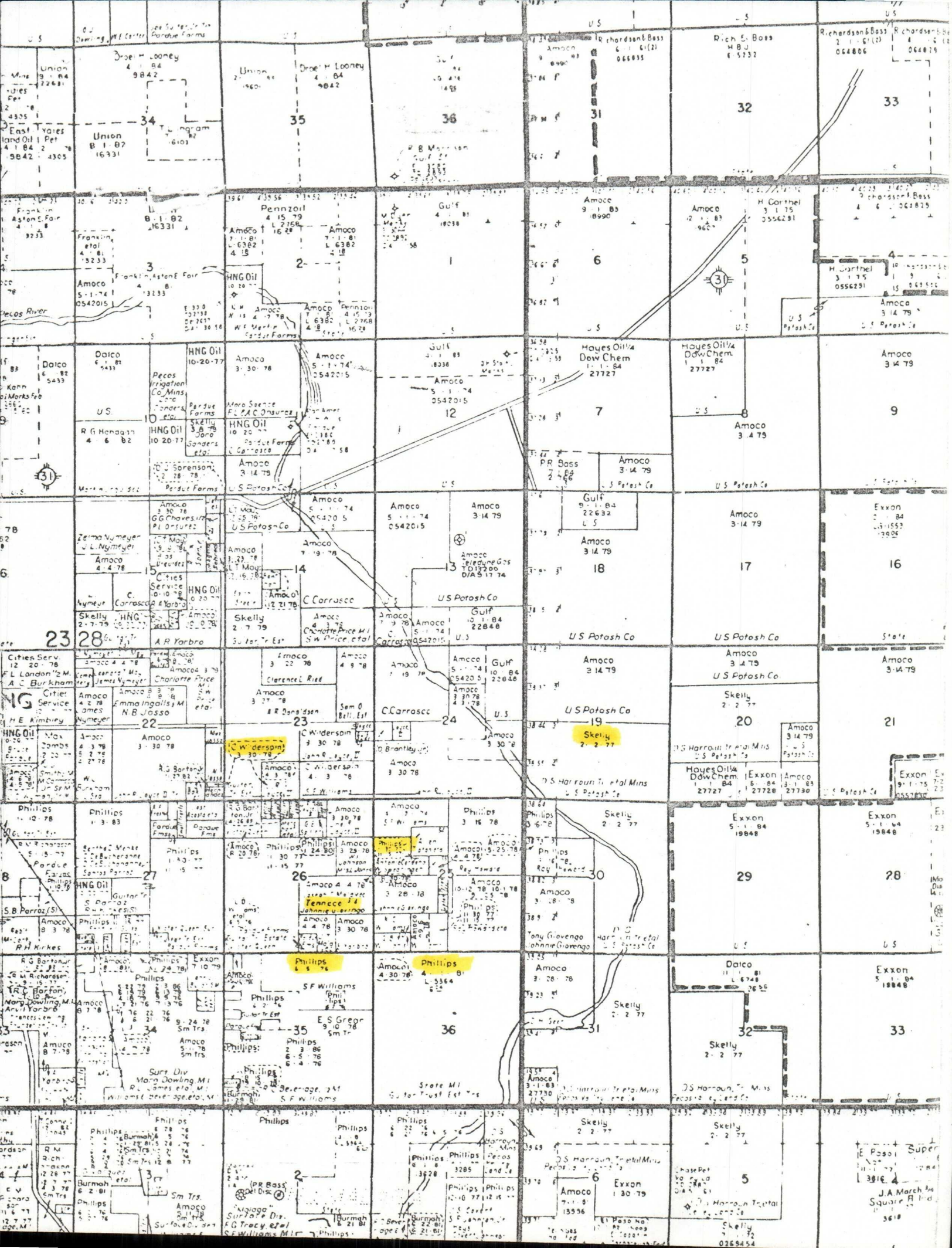

OFFSET OPERATORS TO
AMOCO PRODUCTION COMPANY'S
WILLIAMS GAS COM WELL NO. 1

Delta Drilling Company
P. O. Box 2012
Tyler, TX 75701

Getty Oil Company
P. O. Box 249
Hobbs, NM 88240

Phillips Petroleum Company
P. O. Box 2130
Hobbs, NM 88240

Tenneco Oil Company
Penthouse
720 South Colorado Blvd.
Denver, CO 80222



Amoco Production Company

P.O. Drawer A
Levelland, Texas 79336

V. E. Staley
Area Superintendent

August 8, 1978

File: VES-WF-1526

Re: Request for Administrative Approval
Of Unorthodox Location
Williams Gas Com Well No. 1
Undesignated Morrow
Eddy County, New Mexico

~~OFFSET OPERATORS~~ TO AMOCO PRODUCTION COMPANY'S
~~WILLIAMS GAS COM WELL NO. 1~~

Gentlemen:

Amoco Production Company respectfully requests your approval of an unorthodox location for our Williams Gas Com Well No. 1, located 560 feet FNL and 1980 feet FWL, Unit C, Section 21, T-19-S, R-24-E, Eddy County, New Mexico.

The original orthodox drillsite, located 660 feet FNL and 1980 feet FWL, would have placed the well in a concrete canal used for irrigation by Carlsbad Irrigation Company. A house, corrals, and a barn prevented the movement of the well east, and the only location available is the unorthodox location at 560 feet FNL and 1980' FWL. We are asking for New Mexico Oil Conservation Division approval based on topographical conditions.

Please indicate your approval of our application by signing two of the enclosed copies and sending one to the New Mexico Oil Conservation Division and one to us. Envelopes, which have been addressed and stamped, are attached for your convenience.

Yours very truly,

APPROVED FOR: _____

BY: _____

DATE: _____

Attachments

RWC:jla

cc - State of New Mexico
Department of Energy and Minerals
Oil Conservation Division
P. O. Box 2088
Santa Fe, NM 87501

No. 188063

RECEIPT FOR CERTIFIED MAIL—30¢ (plus postage)

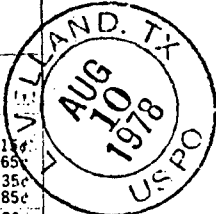
| | | |
|---|--|---|
| SENT TO Delta Drilling Company | | POSTMARK OR DATE |
| STREET AND NO. P. O. Box 2012 | |  |
| P.O., STATE AND ZIP CODE Tyler, TX 75701 | | |
| OPTIONAL SERVICES FOR ADDITIONAL FEES | | |
| RETURN | 1. Shows to whom and date delivered | 15¢ |
| RECEIPT | With delivery to addressee only | 65¢ |
| SERVICES | 2. Shows to whom, date and where delivered | 35¢ |
| | With delivery to addressee only | 85¢ |
| DELIVER TO ADDRESSEE ONLY | | 50¢ |
| SPECIAL DELIVERY (2 pounds or less) | | 45¢ |

POD Form 3800 July 1969 NO INSURANCE COVERAGE PROVIDED—NOT FOR INTERNATIONAL MAIL (See other side)
* GPO : 1969 O—358-312

No. 188064

RECEIPT FOR CERTIFIED MAIL—30¢ (plus postage)

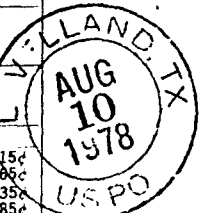
| | | |
|---|--|---|
| SENT TO Getty Oil Company | | POSTMARK OR DATE |
| STREET AND NO. P. O. Box 249 | |  |
| P.O., STATE AND ZIP CODE Hobbs, NM 88240 | | |
| OPTIONAL SERVICES FOR ADDITIONAL FEES | | |
| RETURN | 1. Shows to whom and date delivered | 15¢ |
| RECEIPT | With delivery to addressee only | 65¢ |
| SERVICES | 2. Shows to whom, date and where delivered | 35¢ |
| | With delivery to addressee only | 85¢ |
| DELIVER TO ADDRESSEE ONLY | | 50¢ |
| SPECIAL DELIVERY (2 pounds or less) | | 45¢ |

POD Form 3800 July 1969 NO INSURANCE COVERAGE PROVIDED—NOT FOR INTERNATIONAL MAIL (See other side)
* GPO : 1969 O—358-312

No. 188065

RECEIPT FOR CERTIFIED MAIL—30¢ (plus postage)

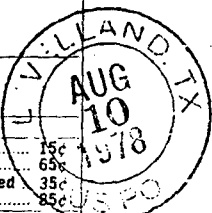
| | | |
|---|--|---|
| SENT TO Phillips Petroleum Company | | POSTMARK OR DATE |
| STREET AND NO. P. O. Box 2130 | |  |
| P.O., STATE AND ZIP CODE Hobbs, NM 88240 | | |
| OPTIONAL SERVICES FOR ADDITIONAL FEES | | |
| RETURN | 1. Shows to whom and date delivered | 15¢ |
| RECEIPT | With delivery to addressee only | 65¢ |
| SERVICES | 2. Shows to whom, date and where delivered | 35¢ |
| | With delivery to addressee only | 85¢ |
| DELIVER TO ADDRESSEE ONLY | | 50¢ |
| SPECIAL DELIVERY (2 pounds or less) | | 45¢ |

POD Form 3800 July 1969 NO INSURANCE COVERAGE PROVIDED—NOT FOR INTERNATIONAL MAIL (See other side)
* GPO : 1969 O—358-312

No. 188066

RECEIPT FOR CERTIFIED MAIL—30¢ (plus postage)

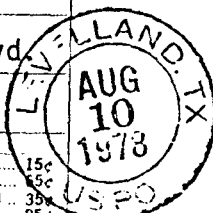
| | | |
|---|--|---|
| SENT TO Tenneco Oil Company | | POSTMARK OR DATE |
| STREET AND NO. Penthouse, 720 S. Colorado Blvd | |  |
| P.O., STATE AND ZIP CODE Denver, CO 80222 | | |
| OPTIONAL SERVICES FOR ADDITIONAL FEES | | |
| RETURN | 1. Shows to whom and date delivered | 15¢ |
| RECEIPT | With delivery to addressee only | 65¢ |
| SERVICES | 2. Shows to whom, date and where delivered | 35¢ |
| | With delivery to addressee only | 85¢ |
| DELIVER TO ADDRESSEE ONLY | | 50¢ |
| SPECIAL DELIVERY (2 pounds or less) | | 45¢ |

POD Form 3800 July 1969 NO INSURANCE COVERAGE PROVIDED—NOT FOR INTERNATIONAL MAIL (See other side)
* GPO : 1969 O—358-312



Amoco Production Company

P.O. Drawer A
Levelland, Texas 79336

V. E. Staley
Area Superintendent

August 8, 1978

AUG 28 1978

File: VES-WF-1526

Re: Request for Administrative Approval
Of Unorthodox Location
Williams Gas Com Well No. 1
Undesignated Morrow
Eddy County, New Mexico

OFFSET OPERATORS TO AMOCO PRODUCTION COMPANY'S
WILLIAMS GAS COM WELL NO. 1

Gentlemen:

Amoco Production Company respectfully requests your approval of an unorthodox location for our Williams Gas Com Well No. 1, located 560 feet FNL and 1980 feet FWL, Unit C, Section ~~21, T-19-S, R-24-E~~, Eddy County, New Mexico.

25, T23S, R-28E

The original orthodox drillsite, located 660 feet FNL and 1980 feet FWL, would have placed the well in a concrete canal used for irrigation by Carlsbad Irrigation Company. A house, corrals, and a barn prevented the movement of the well east, and the only location available is the unorthodox location at 560 feet FNL and 1980' FWL. We are asking for New Mexico Oil Conservation Division approval based on topographical conditions.

Please indicate your approval of our application by signing two of the enclosed copies and sending one to the New Mexico Oil Conservation Division and one to us. Envelopes, which have been addressed and stamped, are attached for your convenience.

Yours very truly,

APPROVED FOR: *Jennison Oil Company*

BY: *22 Parish*

DATE: *8-25-78*

Attachments

RWC:jla

cc - State of New Mexico
Department of Energy and Minerals
Oil Conservation Division
P. O. Box 2088
Santa Fe, NM 87501



V. E. Staley
Area Superintendent

August 8, 1978

NSL 979

Amoco Production Company

P.O. Drawer A
Levelland, Texas 79336

SEP 5 1978

File: VES-WF-1526

Re: Request for Administrative Approval
Of Unorthodox Location
Williams Gas Com Well No. 1
Undesignated Morrow
Eddy County, New Mexico

OFFSET OPERATORS TO AMOCO PRODUCTION COMPANY'S
WILLIAMS GAS COM WELL NO. 1

Gentlemen:

Amoco Production Company respectfully requests your approval of an unorthodox location for our Williams Gas Com Well No. 1, located 560 feet FNL and 1980 feet FWL, Unit C, Section 21, T-19-S, R-24-E, Eddy County, New Mexico.

The original orthodox drillsite, located 660 feet FNL and 1980 feet FWL, would have placed the well in a concrete canal used for irrigation by Carlsbad Irrigation Company. A house, corrals, and a barn prevented the movement of the well east, and the only location available is the unorthodox location at 560 feet FNL and 1980' FWL. We are asking for New Mexico Oil Conservation Division approval based on topographical conditions.

Please indicate your approval of our application by signing two of the enclosed copies and sending one to the New Mexico Oil Conservation Division and one to us. Envelopes, which have been addressed and stamped, are attached for your convenience.

Yours very truly,

APPROVED FOR: GETTY OIL COMPANY

BY: Audra B. Cary
Audra B. Cary

DATE: 9-1-78

Attachments

RWC:jla

cc - State of New Mexico
Department of Energy and Minerals
Oil Conservation Division
P. O. Box 2088
Santa Fe, NM 87501



Amoco Production Company

P.O. Drawer A
Levelland, Texas 79336

V. E. Staley
Area Superintendent

August 8, 1978

File: VES-WF-1526

Re: Request for Administrative Approval
Of Unorthodox Location
Williams Gas Com Well No. 1
Undesignated Morrow
Eddy County, New Mexico

OFFSET OPERATORS TO AMOCO PRODUCTION COMPANY'S
WILLIAMS GAS COM WELL NO. 1

Gentlemen:

Amoco Production Company respectfully requests your approval of an unorthodox location for our Williams Gas Com Well No. 1, located 560 feet FNL and 1980 feet FWL, Unit C, Section ~~21~~₂₅, T-~~19~~₂₃S, R-~~24~~₂₅-E, Eddy County, New Mexico.

The original orthodox drillsite, located 660 feet FNL and 1980 feet FWL, would have placed the well in a concrete canal used for irrigation by Carlsbad Irrigation Company. A house, corrals, and a barn prevented the movement of the well east, and the only location available is the unorthodox location at 560 feet FNL and 1980' FWL. We are asking for New Mexico Oil Conservation Division approval based on topographical conditions.

Please indicate your approval of our application by signing two of the enclosed copies and sending one to the New Mexico Oil Conservation Division and one to us. Envelopes, which have been addressed and stamped, are attached for your convenience.

Yours very truly,

APPROVED FOR:

Delta Drilling Company

BY:

Robert H. Northrup

DATE:

8-18-78

Attachments

RWC:jla

cc - State of New Mexico
Department of Energy and Minerals
Oil Conservation Division
P. O. Box 2088
Santa Fe, NM 87501



Amoco Production Company

P.O. Drawer A
Levelland, Texas 79336

V. E. Staley
Area Superintendent

August 8, 1978

File: VES-WF-1526

Re: Request for Administrative Approval
Of Unorthodox Location
Williams Gas Com Well No. 1
Undesignated Morrow
Eddy County, New Mexico

OFFSET OPERATORS TO AMOCO PRODUCTION COMPANY'S
WILLIAMS GAS COM WELL NO. 1

Gentlemen:

Amoco Production Company respectfully requests your approval of an unorthodox location for our Williams Gas Com Well No. 1, located 560 feet FNL and 1980 feet FWL, Unit C, ~~Section 21, T-19-S, R-24-E~~, Eddy County, New Mexico. Section 25, T-23-S, R-28-E,

The original orthodox drillsite, located 660 feet FNL and 1980 feet FWL, would have placed the well in a concrete canal used for irrigation by Carlsbad Irrigation Company. A house, corrals, and a barn prevented the movement of the well east, and the only location available is the unorthodox location at 560 feet FNL and 1980' FWL. We are asking for New Mexico Oil Conservation Division approval based on topographical conditions.

Please indicate your approval of our application by signing two of the enclosed copies and sending one to the New Mexico Oil Conservation Division and one to us. Envelopes, which have been addressed and stamped, are attached for your convenience.

Yours very truly,

APPROVED FOR:

BY:

DATE:

8/16/78

RECEIVED

AUG 21 1978

Attachments

RWC:jla

Oil Conservation Commission

cc - State of New Mexico
Department of Energy and Minerals
Oil Conservation Division
P. O. Box 2088
Santa Fe, NM 87501