

Mobil Oil Corporation

NINE GREENWAY PLAZA-SUITE 2700
HOUSTON, TEXAS 77046

February 8, 1979

New Mexico Energy & Minerals Department (3)
Oil Conservation Division
State Land Office Building
P. O. Box 2088
Santa Fe, New Mexico 87501

NSL -1015
Rule 104 F
3-12-79

7.01
UNORTHODOX LOCATION
MOBIL OIL CORPORATION'S
NAVAJO WELL #6
UNDESIGNATED MISSISSIPPIAN POOL
SAN JUAN COUNTY, NEW MEXICO

Gentlemen:

Mobil Oil Corporation respectfully requests that permission be granted to drill the subject well at an unorthodox location due to terrain. An attempt was made to stake this well at a standard location (790 feet from the north line and 1850 feet from the east line of the section); however, rugged terrain to the south prevents a drill site in that direction without a large amount of additional dirt work.

Proposed well #6 has been staked as follows:

660 feet from the north line
1980 feet from the east line of
Sec. 3, T26N, R18W,
San Juan County, New Mexico

Mobil requests that authority to drill this well be granted administratively under the provisions of Statewide Rule 104F.

In support of this request, the following items are submitted:

1. Form 9-331C - "Application to Drill"
2. Form C-102 - "Well Location and Acreage Dedication Plat"
3. Topography plat showing the terrain in the vicinity of this well.

FEB 14 1979

New Mexico Energy & Minerals Department
Oil Conservation Division
Page 2
February 8, 1979

A copy of this letter and attachments are being sent to each offset operator by certified mail as their notice of this application and request for their waiver of objection. These offset operators are:

Consolidated Oil & Gas, Inc.
1300 Lincoln Tower Building
1860 Lincoln Street
Denver, Colorado 80203

Saguaro Oil Company
Box 51
Farmington, New Mexico 87401

Yours very truly,



J. A. Morris
Regulatory Engineering Supervisor

ADBond/cbb

Attachments

cc: Consolidated Oil & Gas, Inc.
Saguaro Oil Company
USGS- Farmington

UNITED STATES
DEPARTMENT OF THE INTERIOR
GEOLOGICAL SURVEY

APPLICATION FOR PERMIT TO DRILL, DEEPEN, OR PLUG BACK

1a. TYPE OF WORK

DRILL ☒DEEPEN ☐PLUG BACK ☐

b. TYPE OF WELL

OIL
WELL ☒GAS
WELL ☒

OTHER

SINGLE
ZONE ☒MULTIPLE
ZONE ☐

2. NAME OF OPERATOR

Mobil Oil Corporation

3. ADDRESS OF OPERATOR

Nine Greenway Plaza, Suite 2700; Houston, Texas 77046

4. LOCATION OF WELL (Report location clearly and in accordance with any State requirements.)*

At surface

1980' FEL & 660' FNL, Sec. 3, T26N, R18W

At proposed prod. zone

Same as surface

14. DISTANCE IN MILES AND DIRECTION FROM NEAREST TOWN OR POST OFFICE*

15. DISTANCE FROM PROPOSED*

LOCATION TO NEAREST
PROPERTY OR LEASE LINE, FT.
(Also to nearest drlg. unit line, if any)

660'

16. NO. OF ACRES IN LEASE

1440

17. NO. OF ACRES ASSIGNED
TO THIS WELL

160

18. DISTANCE FROM PROPOSED LOCATION*
TO NEAREST WELL, DRILLING, COMPLETED,
OR APPLIED FOR, ON THIS LEASE, FT.

6404'

19. PROPOSED DEPTH

7000'

20. ROTARY OR CABLE TOOLS

Rotary

21. ELEVATIONS (Show whether DF, RT, GR, etc.)

Ground - 5624'

22. APPROX. DATE WORK WILL START*

As soon as possible

23.

PROPOSED CASING AND CEMENTING PROGRAM

SIZE OF HOLE	SIZE OF CASING	WEIGHT PER FOOT	SETTING DEPTH	QUANTITY OF CEMENT
17 1/2"	13 3/8"	48# H-40	0-100'	1) Circulate to surface
12 1/4"	8 5/8"	24# K-55	0-1600'	2) Circulate to surface
7 7/8"	5 1/2"	14# K-55	0-5400'	3) Circulate to 1575'
		15.5# K-55	5400-7000'	

1) Class H Neat with 2% CaCl₂2) Class B with 8% gel & 2% CaCl₂ Tail in with 100 sx. Class B Neat w/2% CaCl₂

3) Class H with 7% salt sx.

Blowout Preventer and Mud Programs Attached

IN ABOVE SPACE DESCRIBE PROPOSED PROGRAM: If proposal is to deepen or plug back, give data on present productive zone and proposed new productive zone. If proposal is to drill or deepen directionally, give pertinent data on subsurface locations and measured and true vertical depths. Give blowout preventer program, if any.

24.

SIGNED

A. D. Bond

A. D. Bond

TITLE

Regulatory

Engineering Coordinator II

DATE

2-7-79

(This space for Federal or State office use)

PERMIT NO.

APPROVAL DATE

APPROVED BY

TITLE

DATE

CONDITIONS OF APPROVAL, IF ANY:

NEW MEXICO OIL CONSERVATION COMMISSION
WELL LOCATION AND ACREAGE DEDICATION PLAT

Form C-102
Supersedes C-128
Effective 1-1-65

All distances must be from the outer boundaries of the Section.

Operator Mobil Oil Corporation		Lease Navajo		Well No. 6	
Unit Letter B	Section 3	Township 26N	Range 18W	County San Juan	
Actual Footage Location of Well: 660' feet from the North line and 1980' feet from the East line					
Ground Level Elev. 5624'	Producing Formation Mississippian		Pool Undesignated		Dedicated Acreage: 160 Acres

1. Outline the acreage dedicated to the subject well by colored pencil or hachure marks on the plat below.
2. If more than one lease is dedicated to the well, outline each and identify the ownership thereof (both as to working interest and royalty).
3. If more than one lease of different ownership is dedicated to the well, have the interests of all owners been consolidated by communitization, unitization, force-pooling, etc?

☐ Yes ☐ No If answer is "yes," type of consolidation _____

If answer is "no," list the owners and tract descriptions which have actually been consolidated. (Use reverse side of this form if necessary.) _____

No allowable will be assigned to the well until all interests have been consolidated (by communitization, unitization, forced-pooling, or otherwise) or until a non-standard unit, eliminating such interests, has been approved by the Commission.
East - 5288'

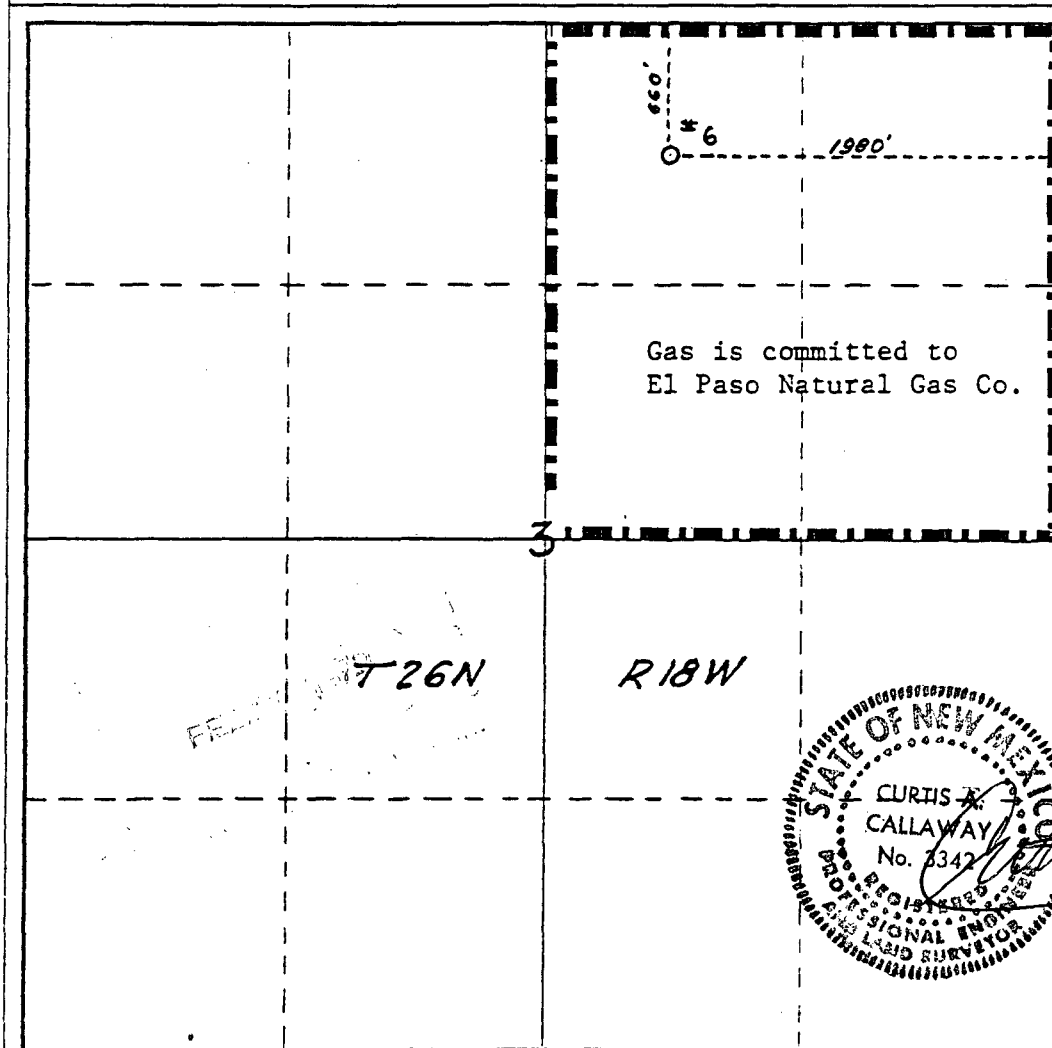

CERTIFICATION

I hereby certify that the information contained herein is true and complete to the best of my knowledge and belief.

A. D. Bond
Name
A. D. Bond
Position Regulatory Engineering Coordinator II
Company Mobil Oil Corporation
Date February 7, 1979

I hereby certify that the well location shown on this plat was plotted from field notes of actual surveys made by me or under my supervision, and that the same is true and correct to the best of my knowledge and belief.

Curtis A. Callaway
Date Surveyed
January 30, 1979
Registered Professional Engineer and/or Land Surveyor

Curtis A. Callaway

Certificate No.

3342

0 330 660 990 1320 1650 1980 2310 2640 2970 3300 3630 3960 4290 4620 4950 5280 5610 5940 6270 6600

ENGINEERS CALCULATION SHEET

FOR _____

JOB OR AUTH. No. _____

LOCATION NAVAJO #6, 660' FNL & 1980' FEL,
SEC. 3, T-26N, R-18W, SAN JUAN CO., N. MEX.

PAGE _____

SUBJECT USE OF ALTERNATE LOCATION DUE
TO TERRAIN PROBLEMS

DATE 2-9-79

BY RMH



SEC. 3, T-26N, R-18W
 SAN JUAN CO., N. MEX.

NAVAJO #6

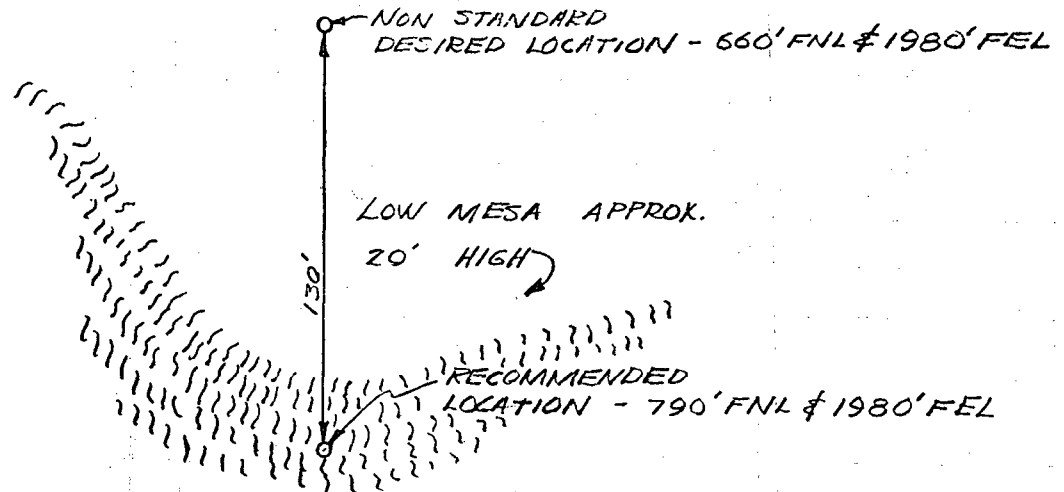

33

34

35



Saguaro Oil Company



Consolidated Oil
& Gas, Inc.

Mobil

660'

6

1980'

T 26 N

R 18 W

3

Navajo

4



Gulf Coast
Prod. Co.

9

10

11

Reserve _____ Permit Depth 7000'

Special Instructions _____

THE STATE OF TEXAS
COUNTY OF HARRIS

I hereby certify that this plat truly represents conditions as they actually exist on this lease; that said plat which is drawn to the scale indicated hereon, is to the best of my knowledge true and correct; that it accurately shows said lease with all wells on same; that number and locations of said wells are as indicated hereon; and that this plat correctly reflects all pertinent and required data.

AD Bond

Mobil Oil Corporation

Houston E&P Division

LEASE Navajo

WELL NO. 6 DATE 2-20 19 79

DIVISION Houston LEASE NO. NM-III

TOTAL ACRES IN LEASE 1440 ACRES COVERED BY PLAT _____

DESCRIPTION Sec. 3, S/2 Sec. 4, S/2 & NW/4 Sec. 9
& SE/4 Sec. 10. (Check lease report for interest in
the formation other than Penn "D")

San Juan County, New Mexico

DRAWN JBK

SCALE 1"=1000'

DATE 11-23-77

FILE NO. 92

FIELD Tocito Dome

Penn "D"

33

34

35



Saguaro Oil Company



Consolidated Oil
& Gas, Inc.

Mobil

660'

6

1980'

T 26 N

R 18 W

3

Navajo

4



Gulf Coast
Prod. Co.

9

10

11

Reserve _____ Permit Depth 7000'

Special Instructions _____

THE STATE OF TEXAS
COUNTY OF HARRIS

I hereby certify that this plat truly represents conditions as they actually exist on this lease; that said plat which is drawn to the scale indicated hereon, is to the best of my knowledge true and correct; that it accurately shows said lease with all wells on same; that number and locations of said wells are as indicated hereon; and that this plat correctly reflects all pertinent and required data.

As Bond

Mobil Oil Corporation

Houston E&P Division

LEASE Navajo

WELL NO. 6 DATE 2-20 19 79

DIVISION Houston LEASE NO. NM-III

TOTAL ACRES IN LEASE 1440 ACRES COVERED BY PLAT _____

DESCRIPTION Sec. 3, S/2 Sec. 4, S/2 & NW/4 Sec. 9

& SE/4 Sec. 10. (Check lease report for interest in the formation other than Penn "D")

San Juan County, New Mexico

DRAWN JBK

DATE 11-23-77

FIELD Tocito Dome

SCALE 1"=1000'

FILE NO. 92

Penn "D"



STATE OF NEW MEXICO
ENERGY AND MINERALS DEPARTMENT
OIL CONSERVATION DIVISION

February 26, 1979

JERRY APODACA
GOVERNOR

NICK FRANKLIN
SECRETARY

POST OFFICE BOX 2088
STATE LAND OFFICE BUILDING
SANTA FE, NEW MEXICO 87501
(505) 827-2434

Mobil Oil Corporation
Nine Greenway Plaza, Suite 2700
Houston, Texas 77046

Attention: J. A. Morris

Re: Application for Non-Standard
Location: Navajo Well No. 6,
Sec. 3, T-26-N, R-18-W
San Juan County, New Mexico

We may not process the subject application for non-standard location until the required information or plats checked below (is) (are) submitted.

- * ☒ A plat must be submitted clearly showing the ownership of the offsetting leases.
- ☐ A statement must be submitted that offset owners have been notified of the application by certified mail.
- ☐ A plat must be submitted fully identifying the topography necessitating the non-standard location.
- ☐ Other:

* *Plat with offset
info. attached
up bond*

Very truly yours,

R. L. STAMETS

Technical Support Chief

3-1-79

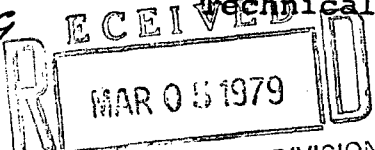

OIL CONSERVATION DIVISION
SANTA FE

RLS/dr

RECEIVED REGULATORY ENGINEERING			
MAR 1 1979			
ADB		TJO	
LSH		WBS	
JAM		HFW	