

12. April. 07 DATE IN	SUSPENSE	W. Sones ENGINEER	12. April. 07 LOGGED IN	DAC TYPE	PCLP0710236519 APP NO.
--------------------------	----------	----------------------	----------------------------	-------------	---------------------------

ABOVE THIS LINE FOR DIVISION USE ONLY

**NEW MEXICO OIL CONSERVATION DIVISION**  
- Engineering Bureau -  
1220 South St. Francis Drive, Santa Fe, NM 87505



**ADMINISTRATIVE APPLICATION CHECKLIST**

THIS CHECKLIST IS MANDATORY FOR ALL ADMINISTRATIVE APPLICATIONS FOR EXCEPTIONS TO DIVISION RULES AND REGULATIONS WHICH REQUIRE PROCESSING AT THE DIVISION LEVEL IN SANTA FE

**Application Acronyms:**

[NSL-Non-Standard Location] [NSP-Non-Standard Proration Unit] [SD-Simultaneous Dedication]  
[DHC-Downhole Commingling] [CTB-Lease Commingling] [PLC-Pool/Lease Commingling]  
[PC-Pool Commingling] [OLS - Off-Lease Storage] [OLM-Off-Lease Measurement]  
[WFX-Waterflood Expansion] [PMX-Pressure Maintenance Expansion]  
[SWD-Salt Water Disposal] [IPI-Injection Pressure Increase]  
[EOR-Qualified Enhanced Oil Recovery Certification] [PPR-Positive Production Response]

[1] **TYPE OF APPLICATION** - Check Those Which Apply for [A]

[A] Location - Spacing Unit - Simultaneous Dedication  
☐ NSL ☐ NSP ☐ SD

Check One Only for [B] or [C]

[B] Commingling - Storage - Measurement  
☒ DHC ☐ CTB ☐ PLC ☐ PC ☐ OLS ☐ OLM

[C] Injection - Disposal - Pressure Increase - Enhanced Oil Recovery  
☐ WFX ☐ PMX ☐ SWD ☐ IPI ☐ EOR ☐ PPR

[D] Other: Specify \_\_\_\_\_

[2] **NOTIFICATION REQUIRED TO:** - Check Those Which Apply, or Does Not Apply

[A] ☐ Working, Royalty or Overriding Royalty Interest Owners  
[B] ☐ Offset Operators, Leaseholders or Surface Owner  
[C] ☐ Application is One Which Requires Published Legal Notice  
[D] ☐ Notification and/or Concurrent Approval by BLM or SLO  
U.S. Bureau of Land Management - Commissioner of Public Lands, State Land Office  
[E] ☐ For all of the above, Proof of Notification or Publication is Attached, and/or,  
[F] ☐ Waivers are Attached

2007 APR 12 AM 9 35

[3] **SUBMIT ACCURATE AND COMPLETE INFORMATION REQUIRED TO PROCESS THE TYPE OF APPLICATION INDICATED ABOVE.**

[4] **CERTIFICATION:** I hereby certify that the information submitted with this application for administrative approval is **accurate and complete** to the best of my knowledge. I also understand that **no action** will be taken on this application until the required information and notifications are submitted to the Division.

**Note:** Statement must be completed by an individual with managerial and/or supervisory capacity.

Charles E. Kendrix  
Print or Type Name

Charles E. Kendrix  
Signature

Regulatory Compliance Rep  
Title

4/11/07  
Date

cekendrix@marathonoil.com  
e-mail Address

District I  
1625 N. French Drive, Hobbs, NM 88240

District II  
1301 W. Grand Avenue, Artesia, NM 88210

District III  
1000 Rio Brazos Road, Aztec, NM 87410

District IV  
1220 S. St. Francis Dr., Santa Fe, NM 87505

State of New Mexico  
Energy, Minerals and Natural Resources Department

Form C-107A  
Revised June 10, 2003

Oil Conservation Division  
1220 South St. Francis Dr.  
Santa Fe, New Mexico 87505

APPLICATION TYPE  
☒ Single Well  
☐ Establish Pre-Approved Pools  
EXISTING WELLBORE  
☒ Yes ☐ No

APPLICATION FOR DOWNHOLE COMMINGLING

Marathon Oil Company P.O. Box 3487 Houston Tx 77253-3487  
Operator Address  
Mark Owen 9 L-35-215-37E Lea  
Lease Well No. Unit Letter-Section-Township-Range County  
OGRID No. 14021 Property Code 6454 API No. 30-025-29468 Lease Type: ☐ Federal ☐ State ☒ Fee

DATA ELEMENT	UPPER ZONE	INTERMEDIATE ZONE	LOWER ZONE
Pool Name	Penrose Skelly Grayburg	Blinchry <sup>(H)</sup> <del>oil</del>	Wantz Abo
Pool Code	50350	06660	62700
Top and Bottom of Pay Section (Perforated or Open-Hole Interval)	3683' - 3800'	5458' - 5861'	6657' - 6967'
Method of Production (Flowing or Artificial Lift)	Pumping	Pumping	Pumping
Bottomhole Pressure (Note: Pressure data will not be required if the bottom perforation in the lower zone is within 150% of the depth of the top perforation in the upper zone)	492 psi	550 psi	550 psi
Oil Gravity or Gas BTU (Degree API or Gas BTU)	36.0	38.2	40.0
Producing, Shut-In or New Zone	Producing	Shut In	Shut In
Date and Oil/Gas/Water Rates of Last Production. (Note: For new zones with no production history, applicant shall be required to attach production estimates and supporting data.)	Date: 4/10/67 Rates: Oil Gas W 2.59 24 .20	Date: 8/11/04 Rates: Oil Gas Water 4.63 52.27 1.67	Date: 8/11/04 Rates: Oil Gas Water 1.38 12.27 .50
Fixed Allocation Percentage (Note: If allocation is based upon something other than current or past production, supporting data or explanation will be required.)	Oil Gas % %	Oil Gas 5 % 52 %	Oil Gas % %

ADDITIONAL DATA

Are all working, royalty and overriding royalty interests identical in all commingled zones? Yes ☒ No ☐  
If not, have all working, royalty and overriding royalty interest owners been notified by certified mail? N/A Yes ☐ No ☐  
Are all produced fluids from all commingled zones compatible with each other? Yes ☒ No ☐  
Will commingling decrease the value of production? Yes ☐ No ☒  
If this well is on, or communitized with, state or federal lands, has either the Commissioner of Public Lands  
or the United States Bureau of Land Management been notified in writing of this application? N/A Yes ☐ No ☐  
NMOCD Reference Case No. applicable to this well: \_\_\_\_\_

Attachments:

- C-102 for each zone to be commingled showing its spacing unit and acreage dedication.
- Production curve for each zone for at least one year. (If not available, attach explanation.)
- For zones with no production history, estimated production rates and supporting data.
- Data to support allocation method or formula.
- Notification list of working, royalty and overriding royalty interests for uncommon interest cases.
- Any additional statements, data or documents required to support commingling.

PRE-APPROVED POOLS

If application is to establish Pre-Approved Pools, the following additional information will be required:

- List of other orders approving downhole commingling within the proposed Pre-Approved Pools
- List of all operators within the proposed Pre-Approved Pools
- Proof that all operators within the proposed Pre-Approved Pools were provided notice of this application.
- Bottomhole pressure data.

I hereby certify that the information above is true and complete to the best of my knowledge and belief.

SIGNATURE Charles E. Kendrick, TITLE Res Compliance Rep DATE 4/11/07

TYPE OR PRINT NAME Charles E. Kendrick TELEPHONE NO. ( 713 ) 296-2096

E-MAIL ADDRESS cekendrix@marathonoil.com

District I  
1625 N. French Dr., Hobbs, NM 88240  
District II  
1301 W. Grand Avenue, Artesia, NM 88210  
District III  
1000 Rio Brazos Rd., Aztec, NM 87410  
District IV  
1220 S. St. Francis Dr., Santa Fe, NM 87505

State of New Mexico  
Energy, Minerals & Natural Resources

OIL CONSERVATION DIVISION  
1220 South St. Francis Dr.  
Santa Fe, NM 87505

Form C-102  
Revised June 10, 2003

Submit to Appropriate District Office  
State Lease - 4 Copies  
Fee Lease - 3 Copies

☐ AMENDED REPORT

WELL LOCATION AND ACREAGE DEDICATION PLAT

<sup>1</sup> API Number <b>30-025-29468</b>	<sup>2</sup> Pool Code <b>50350</b>	<sup>3</sup> Pool Name <b>Penrose Shelly Grayburg</b>
<sup>4</sup> Property Code <b>006454</b>	<sup>5</sup> Property Name <b>Mark Owen</b>	<sup>6</sup> Well Number <b>9</b>
<sup>7</sup> OGRID No. <b>14021</b>	<sup>8</sup> Operator Name <b>Marathon Oil Company</b>	<sup>9</sup> Elevation <b>3383'</b>

<sup>10</sup> Surface Location

UL or lot no. <b>L</b>	Section <b>35</b>	Township <b>21-S</b>	Range <b>37-E</b>	Lot. Idn	Feet from the <b>1830'</b>	North/South line <b>South</b>	Feet from the <b>660'</b>	East/West line <b>West</b>	County <b>Los</b>
---------------------------	----------------------	-------------------------	----------------------	----------	-------------------------------	----------------------------------	------------------------------	-------------------------------	----------------------

<sup>11</sup> Bottom Hole Location If Different From Surface

UL or lot no.	Section	Township	Range	Lot. Idn	Feet from the	North/South line	Feet from the	East/West line	County
<sup>12</sup> Dedicated Acres <b>40</b>	<sup>13</sup> Joint or Infill <b>N</b>	<sup>14</sup> Consolidation Code	<sup>15</sup> Order No.						

NO ALLOWABLE WILL BE ASSIGNED TO THIS COMPLETION UNTIL ALL INTERESTS HAVE BEEN CONSOLIDATED OR A NON-STANDARD UNIT HAS BEEN APPROVED BY THE DIVISION

<sup>16</sup> 	<sup>17</sup> OPERATOR CERTIFICATION I hereby certify that the information contained herein is true and complete to the best of my knowledge and belief.  Signature <b>Charles E. Kendrick</b> Printed Name <b>Engineering Technician</b> <b>cekendrix@marathonoil.com</b> Title and E-mail Address <b>07/28/2004</b> Date			
	<sup>18</sup> SURVEYOR CERTIFICATION I hereby certify that the well location shown on this plat was plotted from field notes of actual surveys made by me or under my supervision, and that the same is true and correct to the best of my belief.  Date of Survey Signature and Seal of Professional Surveyor:  Certificate Number			

**NEW MEXICO OIL CONSERVATION COMMISSION  
WELL LOCATION AND ACREAGE DEDICATION PLAT**

Form C-102  
Supersedes C-128  
Effective 1-1-65

All distances must be from the outer boundaries of the Section

Lessor <b>MARATHON OIL COMPANY</b>			Lease <b>MARK OWEN</b>			Well No. <b>9</b>
Tract Letter <b>L</b>	Section <b>35</b>	Township <b>11 SOUTH</b>	Range <b>37 EAST</b>	County <b>LEA</b>		
Actual Footage Location of Well: <b>1830</b> feet from the <b>SOUTH</b> line and <b>660</b> feet from the <b>WEST</b> line						
Ground Level Elev. <b>2582.4'</b>	Producing Formation <b>Abo</b>		Pool <b>Wantz Abo</b>		Dedicated Acreage: <b>40</b> Acres	

1. Outline the acreage dedicated to the subject well by colored pencil or hatchure marks on the plat below.
2. If more than one lease is dedicated to the well, outline each and identify the ownership thereof (both as to working interest and royalty).
3. If more than one lease of different ownership is dedicated to the well, have the interests of all owners been consolidated by communitization, unitization, force-pooling, etc?

☐ Yes    ☐ No    If answer is "yes," type of consolidation \_\_\_\_\_

If answer is "no," list the owners and tract descriptions which have actually been consolidated. (Use reverse side of this form if necessary.) \_\_\_\_\_

No allowable will be assigned to the well until all interests have been consolidated (by communitization, unitization, forced-pooling, or otherwise) or until a non-standard unit, eliminating such interests, has been approved by the Commission.

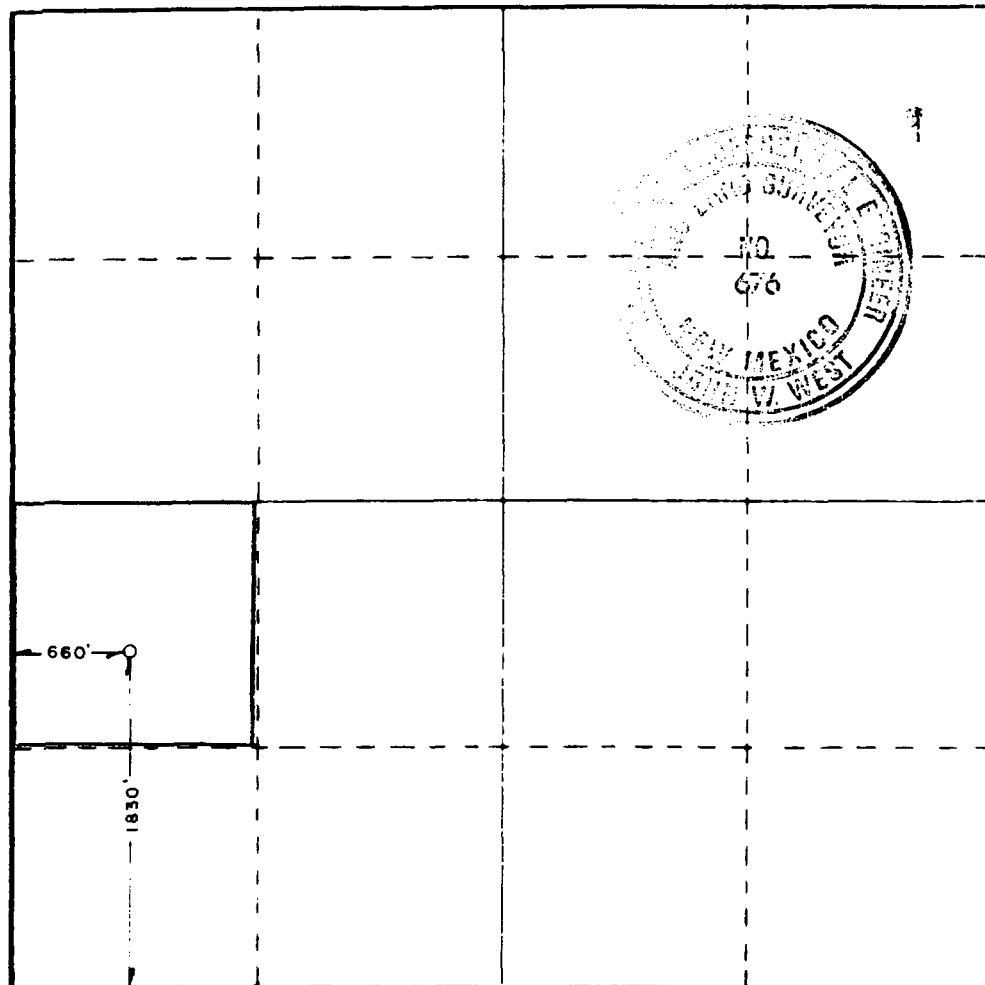

**CERTIFICATION**

I hereby certify that the information contained herein is true and complete to the best of my knowledge and belief.

*Thomas F. Zapatka*

Name  
**Thomas F. Zapatka**

Position  
**Production Engineer**

Company  
**Marathon Oil Company**

Date  
**October 21, 1985**

I hereby certify that the well location shown on this plat was plotted from field notes of actual surveys made by me or under my supervision, and that the same is true and correct to the best of my knowledge and belief.

Date Surveyed  
**OCTOBER 1, 1985**

Registered Professional Engineer and/or Land Surveyor

*Ronald J. Eidson*

Certificate No. **JOHN W. WEST, 676**  
**RONALD J. EIDSON, 3239**

District I  
PO Box 1980, Hobbs, NM 88241-1980  
District II  
811 S. 1st Street, Artesia, NM 88210-2834  
District III  
1000 Rio Brazos Rd., Aztec, NM 87410  
District IV  
PO Box 2088, Santa Fe, NM 87504-2088

State of New Mexico  
Department of Energy, Minerals & Natural Resources

OIL CONSERVATION DIVISION  
P.O. Box 2088  
Santa Fe, NM 87504-2088

Form C-102  
Revised February 10, 1994  
Instructions on back  
Submit to Appropriate District Office  
State Lease - 4 Copies  
Fee Lease - 3 Copies

☐ AMENDED REPORT

WELL LOCATION AND ACREAGE DEDICATION PLAT

<sup>1</sup> API Number 30-025-29468		<sup>2</sup> Pool Code 6660		<sup>3</sup> Pool Name B11nebry Oil & Gas (Oil)	
<sup>4</sup> Property Code 6454		<sup>5</sup> Property Name Mark Owen			<sup>6</sup> Well Number 9
<sup>7</sup> OGRID No. 014021		<sup>8</sup> Operator Name Marathon Oil Company			<sup>9</sup> Elevation GL 3383'

<sup>10</sup> Surface Location									
UL or lot no.	Section	Township	Range	Lot. Idn	Feet from the	North/South Line	Feet from the	East/West line	County
L	36	21-S	37-E		1830'	South	660'	West	Lea

<sup>11</sup> Bottom Hole Location If Different From Surface									
UL or lot no.	Section	Township	Range	Lot. Idn	Feet from the	North/South Line	Feet from the	East/West line	County
<sup>12</sup> Dedicated Acres 40		<sup>13</sup> Joint or Infill		<sup>14</sup> Consolidation Code		<sup>15</sup> Order No.			

NO ALLOWABLE WILL BE ASSIGNED TO THIS COMPLETION UNTIL ALL INTERESTS HAVE BEEN CONSOLIDATED  
OR A NON-STANDARD UNIT HAS BEEN APPROVED BY THE DIVISION

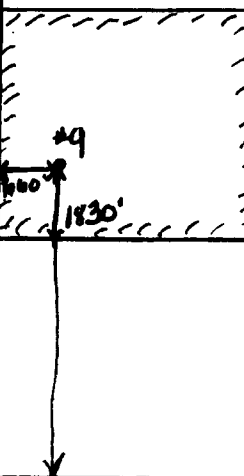
					<p><sup>17</sup> OPERATOR CERTIFICATION</p> <p>I hereby certify that the information contained herein is true and complete to the best of my knowledge and belief.</p> <p><i>Kelly Cook</i> Signature Kelly Cook Printed Name</p> <p>Title May 7, 1997 Date</p> <p><sup>18</sup> SURVEYOR CERTIFICATION</p> <p>I hereby certify that the well location shown on this plat was plotted from field notes of actual surveys made by me or under my supervision, and that the same is true and correct to the best of my belief.</p> <p>Date of Survey</p> <p>Signature and Seal of Professional Surveyor:</p> <p>Certificate Number</p>

MARK OWEN NO 9 (1/A)  
Mark Owen No 9 Downhole Commingled Blinebry & Wantz Abo Pools

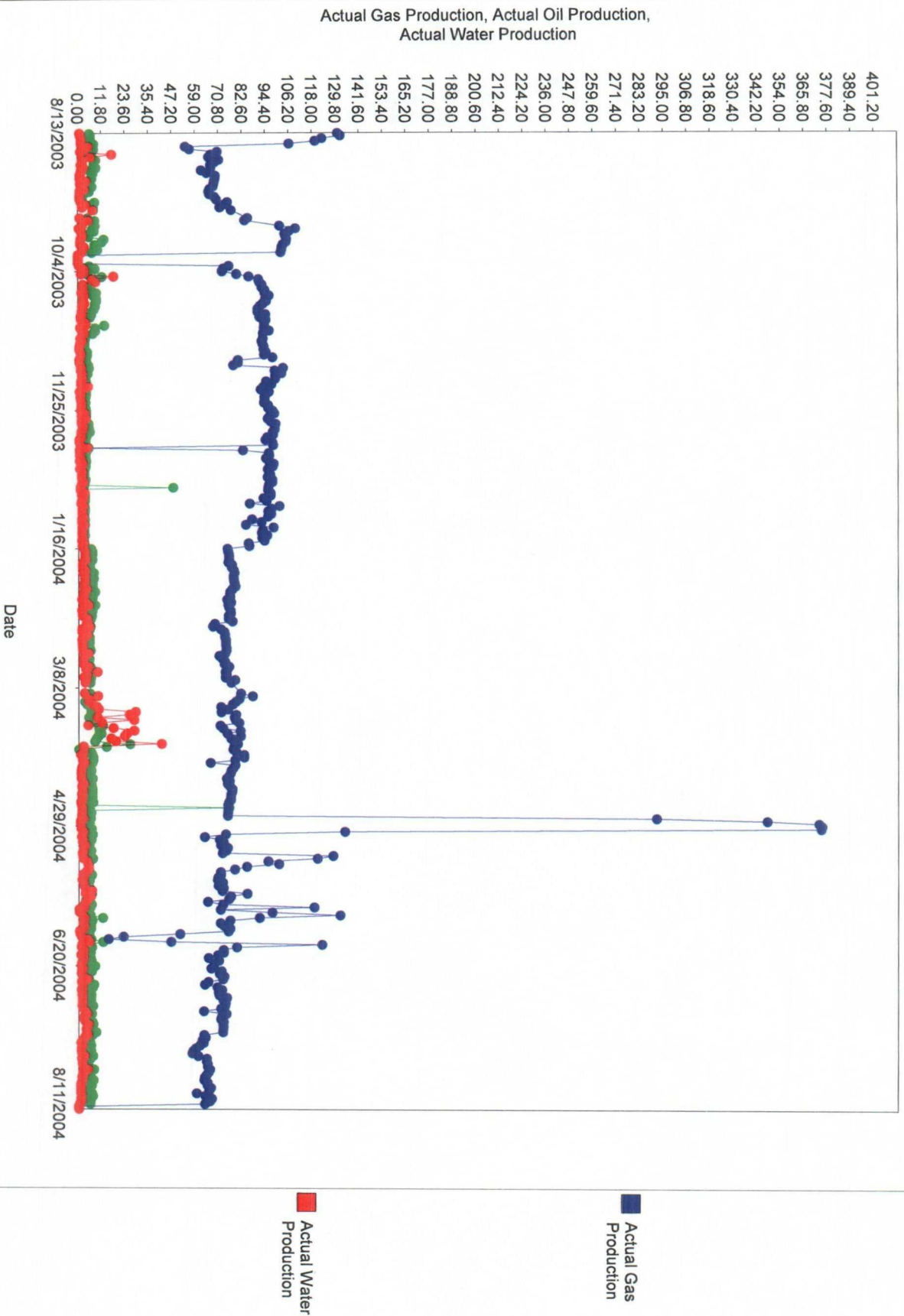

MARK OWEN NO 9 Penrose Skelly Grayburg

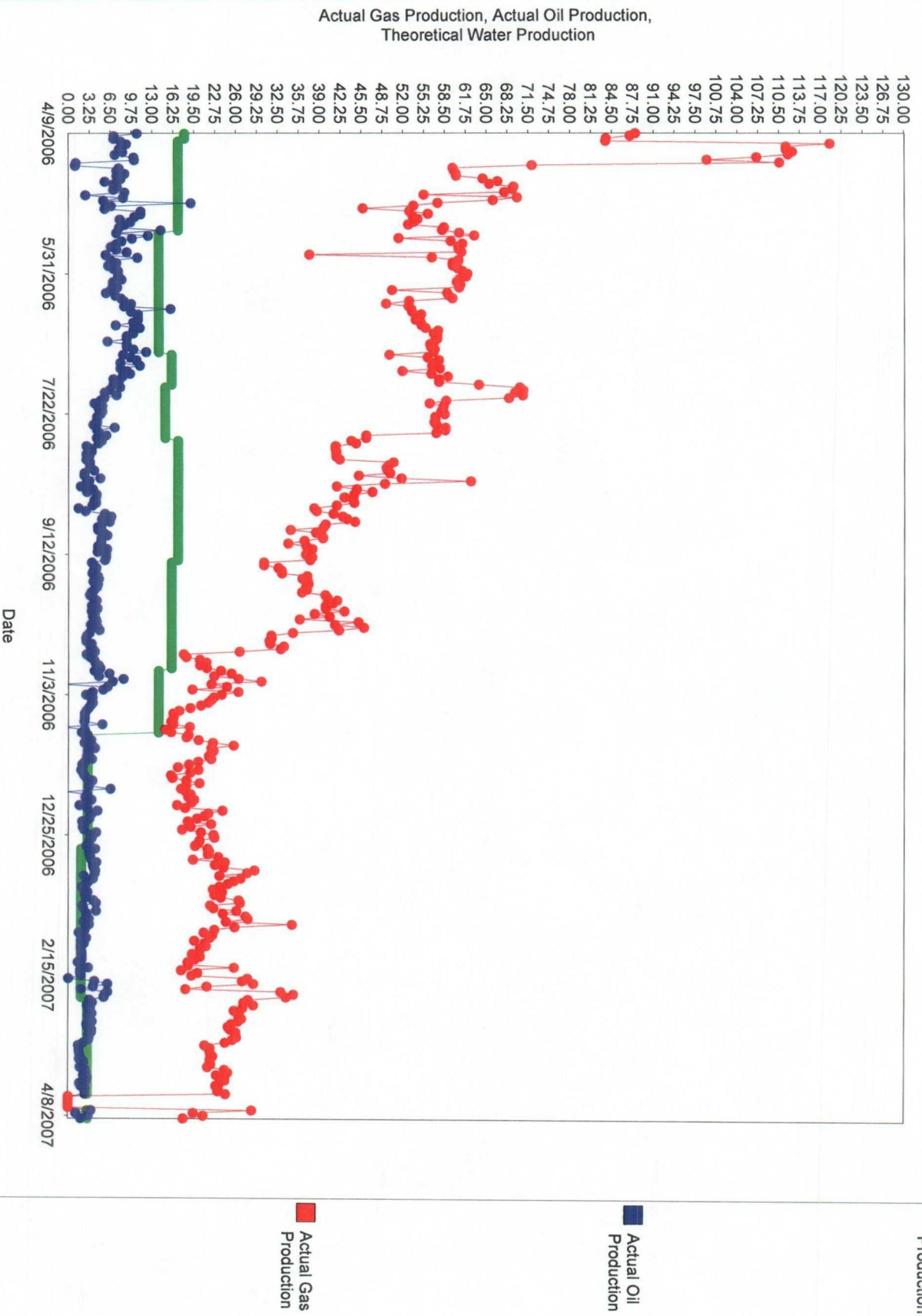

**Mark Owen No. 9**  
**Downhole Commingle**  
**Grayburg, Blinebry, and Abo Formations**

The Wantz Abo and Blinebry formation were downhole commingled from 09/27/1997 through 08/13/2004, therefore the production graph for these formations shows the combined totals.

The commingling of the sour Grayburg oil with the Blinebry and Abo oil will decrease the value of the oil from those two pools. However the depleted condition of the Blinebry and Abo pools makes them uneconomical to produce alone. The minimal production gained since the re-completion to the Grayburg in September 2004 is also not enough to make the well economically viable as a single zone producer. It is Marathon's contention that the combining the three pools will allow Marathon to produce all the reservoirs to a point that will not be economically possible without downhole commingling, and will prevent the premature plugging of this well.

The proposed allocation percentages for the downhole commingled well bore were derived by using average daily production for the last thirty days of production. Average daily production for the downhole commingled Blinebry / Wantz Abo production was broken out based on previously approved percentages. Allocation calculations for each pool are as follows:

	Oil	Gas	Water
Grayburg	2.59	24.00	0.20
Blinebry	4.63	52.27	1.67
Wantz Abo	<u>1.38</u>	<u>12.27</u>	<u>.50</u>
Totals	8.60	88.54	2.37

Percentages	Oil	Gas	Water
Grayburg	$2.59/8.60=0.301$ (30%)	$24.00/88.54=.27$ (27%)	$0.20/2.37=.0844$ (8%)
Blinebry	$4.63/8.60=.5383$ (54%)	$52.27/88.54=.59$ (59%)	$1.67/2.37=.7046$ (71%)
Wantz Abo	$1.38/8.60=.1604$ (16%)	$12.27/88.54=.1386$ (14%)	$.50/2.37=.2109$ (21%)



Production -- Detail

Friday, March 02, 2007 Through Saturday, March 31, 2007

Select By : Completions

Pressure Base : None  
Units : A.P.I.  
Rounded (y/n) : No

Sort By : None selected in Report Options.

Page No : 1  
Report Number : R\_016  
Print Date : 4/11/200 2:15:15 PM

Completion	Date	Oil Production	Water Production	Gas Production	Chk./S.P.M.	Tubing Pres.	Casing Pres.	Dn. Hrs.	Lift	Injection	Inj. Pres.
MARK OWEN NO 9 (3)	3/2/2007	3.12		0.00	0.00	0.00	0.00	0.0	0.00	0.00	0.00
	3/3/2007	3.43		0.15	0.00	0.00	0.00	0.0	0.00	0.00	0.00
	3/4/2007	3.72		0.11	0.00	0.00	0.00	0.0	0.00	0.00	0.00
	3/5/2007	2.86		0.06	0.00	0.00	0.00	0.0	0.00	0.00	0.00
	3/6/2007	2.98		0.00	0.00	0.00	0.00	0.0	0.00	0.00	0.00
	3/7/2007	3.65		0.03	0.00	0.00	0.00	0.0	0.00	0.00	0.00
	3/8/2007	3.60		0.06	0.00	0.00	0.00	0.0	0.00	0.00	0.00
	3/9/2007	3.17		0.04	0.00	0.00	0.00	0.0	0.00	0.00	0.00
	3/10/2007	3.24		0.02	0.00	0.00	0.00	0.0	0.00	0.00	0.00
	3/11/2007	3.15		0.03	0.00	0.00	0.00	0.0	0.00	0.00	0.00
	3/12/2007	2.40		0.03	0.00	0.00	0.00	0.0	0.00	0.00	0.00
	3/13/2007	1.59		0.07	0.00	0.00	0.00	0.0	0.00	0.00	0.00
	3/14/2007	1.73		0.02	0.00	0.00	0.00	0.0	0.00	0.00	0.00
	3/15/2007	1.73		0.03	0.00	0.00	0.00	0.0	0.00	0.00	0.00
	3/16/2007	1.80		0.05	0.00	0.00	0.00	0.0	0.00	0.00	0.00
	3/17/2007	1.87		0.36	0.00	0.00	0.00	0.0	0.00	0.00	0.00
	3/18/2007	1.73		0.48	0.00	0.00	0.00	0.0	0.00	0.00	0.00
	3/19/2007	2.50		0.34	0.00	0.00	0.00	0.0	0.00	0.00	0.00
	3/20/2007	2.09		0.29	0.00	0.00	0.00	0.0	0.00	0.00	0.00
	3/21/2007	1.88		0.32	0.00	0.00	0.00	0.0	0.00	0.00	0.00
3/22/2007	2.69		0.40	0.00	0.00	0.00	0.0	0.00	0.00	0.00	
3/23/2007	2.79		0.15	0.00	0.00	0.00	0.0	0.00	0.00	0.00	
3/24/2007	2.39		0.05	0.00	0.00	0.00	0.0	0.00	0.00	0.00	
3/25/2007	2.99		0.02	0.00	0.00	0.00	0.0	0.00	0.00	0.00	
3/26/2007	2.88		0.50	0.00	0.00	0.00	0.0	0.00	0.00	0.00	
3/27/2007	1.80		0.20	0.00	0.00	0.00	0.0	0.00	0.00	0.00	
3/28/2007	2.00		0.40	0.00	0.00	0.00	0.0	0.00	0.00	0.00	
3/29/2007	2.66		0.16	0.00	0.00	0.00	0.0	0.00	0.00	0.00	
3/30/2007	2.65		0.17	0.00	0.00	0.00	0.0	0.00	0.00	0.00	
3/31/2007	2.65		0.17	0.00	0.00	0.00	0.0	0.00	0.00	0.00	
Totals-- MARK OWEN NO 9 (3)		77.72	4.68	720.26				0.0		0.00	
		<u>30</u>	<u>430</u>	<u>30</u>							
		= 2.59 = 0.2 = 24 mcf									
Report Totals		77.72	4.68	720.26				0.0		0.00	

Monday, July 12, 2004 Through Wednesday, August 11, 2004

# Production -- Detail

Select By : Completions

Sort By : None selected in Report Options.

Pressure Base : None  
Units : A.P.I.  
Rounded (y/n) : No

Page No : 1  
Report Number : R\_016  
Print Date : 3/12/200 1:59:17 PM

Completion	Date	Oil Production	Water Production	Gas Production	Chk./S.P.M.	Tubing Pres.	Casing Pres.	Dn. Hrs.	Lift	Injection	Inj. Pres.
MARK OWEN NO 9 (I/A)  Downhole Commingled  Wauferz Abo + Blinckey	7/12/2004	7.24	4.87	72.76	0.00	0.00	0.00	0.0	0.00	0.00	0.00
	7/13/2004	6.31	4.43	72.80	0.00	0.00	0.00	0.0	0.00	0.00	0.00
	7/14/2004	6.62	3.80	72.77	0.00	0.00	0.00	0.0	0.00	0.00	0.00
	7/15/2004	8.66	4.06	72.60	0.00	0.00	0.00	0.0	0.00	0.00	0.00
	7/16/2004	6.89	4.47	63.04	0.00	0.00	0.00	0.0	0.00	0.00	0.00
	7/17/2004	4.75	2.98	63.82	0.00	0.00	0.00	0.0	0.00	0.00	0.00
	7/18/2004	5.10	1.99	62.18	0.00	0.00	0.00	0.0	0.00	0.00	0.00
	7/19/2004	5.69	1.12	62.84	0.00	0.00	0.00	0.0	0.00	0.00	0.00
	7/20/2004	6.16	1.86	61.01	0.00	0.00	0.00	0.0	0.00	0.00	0.00
	7/21/2004	5.69	1.37	58.96	0.00	0.00	0.00	0.0	0.00	0.00	0.00
	7/22/2004	6.16	1.24	57.70	0.00	0.00	0.00	0.0	0.00	0.00	0.00
	7/23/2004	5.69	1.49	57.10	0.00	0.00	0.00	0.0	0.00	0.00	0.00
	7/24/2004	7.11	2.86	60.11	0.00	0.00	0.00	0.0	0.00	0.00	0.00
	7/25/2004	5.69	1.49	64.43	0.00	0.00	0.00	0.0	0.00	0.00	0.00
	7/26/2004	4.74	1.86	64.43	0.00	0.00	0.00	0.0	0.00	0.00	0.00
	7/27/2004	4.27	1.86	64.97	0.00	0.00	0.00	0.0	0.00	0.00	0.00
	7/28/2004	5.17	2.24	64.97	0.00	0.00	0.00	0.0	0.00	0.00	0.00
	7/29/2004	7.59	4.60	66.09	0.00	0.00	0.00	0.0	0.00	0.00	0.00
	7/30/2004	6.16	2.11	65.40	0.00	0.00	0.00	0.0	0.00	0.00	0.00
	7/31/2004	5.22	2.48	64.45	0.00	0.00	0.00	0.0	0.00	0.00	0.00
Totals-- 07/2004		120.90	53.17	1,292.43	0.00	0.00	0.00	0.0	0.00	0.00	0.00
Totals-- 08/2004 Totals-- MARK OWEN NO 9 (I/A)	8/1/2004	3.79	1.63	63.42	0.00	0.00	0.00	0.0	0.00	0.00	0.00
	8/2/2004	7.36	1.87	63.21	0.00	0.00	0.00	0.0	0.00	0.00	0.00
	8/3/2004	5.98	1.43	64.86	0.00	0.00	0.00	0.0	0.00	0.00	0.00
	8/4/2004	6.44	1.07	64.78	0.00	0.00	0.00	0.0	0.00	0.00	0.00
	8/5/2004	5.69	1.13	66.52	0.00	0.00	0.00	0.0	0.00	0.00	0.00
	8/6/2004	4.74	1.13	65.66	0.00	0.00	0.00	0.0	0.00	0.00	0.00
	8/7/2004	6.64	1.13	59.33	0.00	0.00	0.00	0.0	0.00	0.00	0.00
	8/8/2004	7.11	1.60	63.76	0.00	0.00	0.00	0.0	0.00	0.00	0.00
	8/9/2004	6.16	1.13	67.01	0.00	0.00	0.00	0.0	0.00	0.00	0.00
	8/10/2004	5.69	1.41	66.10	0.00	0.00	0.00	0.0	0.00	0.00	0.00
	8/11/2004	65.51	14.08	708.23	0.00	0.00	0.00	0.0	0.00	0.00	0.00
	Totals-- 08/2004	186.41	67.25	2,000.66	0.00	0.00	0.00	0.0	0.00	0.00	0.00
Report Totals		186.41	67.25	2,000.66	0.0	0.0	0.0	0.0	0.00	0.00	0.00

Blinckey

4.63

1.67

52.27

Wauferz Abo

1.38

0.50

12.27