

El Paso NATURAL GAS
COMPANY

NSL- 1088

P. O. BOX 990
FARMINGTON, NEW MEXICO 87401
PHONE: 505-325-2841

September 20, 1979

NSL-1088
Rule 3B/620
10-21-79

Mr. Joe Ramey
New Mexico Oil Conservation Division
Post Office Box 2088
Santa Fe, NM 87501

Dear Mr. Ramey:

This is a request for administrative approval for an unorthodox gas well location in the Blanco Mesa Verde pool.

It is intended to locate the El Paso Natural Gas Company's San Juan 30-6 Unit #91A at 835' from the South line and 580' from the East line of Section 28, T-30-N, R-7-W, Rio Arriba County, New Mexico.

Extremely rough terrain with cliffs and steep ledges in the southeast corner of this section make it impossible to build an orthodox gas well location.

All operators of proration units offsetting the proposed unorthodox location have been notified of this application by certified mail.

Plats showing the proposed well location and the terrain of Section 28, along with an ownership plat, are attached.

Sincerely,

L. A. Aimes

L. A. Aimes
Project Drilling Engineer

LAA:pb

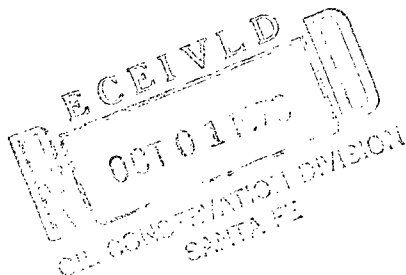

El Paso NATURAL GAS
COMPANY

P. O. BOX 990
FARMINGTON, NEW MEXICO 87401
PHONE: 505-325-2841

RECEIVED
OCT 0 1979
OIL CONSERVATION DIVISION
SANTA FE

September 20, 1979

RECEIVED
OCT 2 1979
BLACKWOOD & NICHOLS CO., LTD.

Blackwood Nichols
Post Office Box 1237
Durango, Colorado 81301

Re: Unorthodox Gas Well Location

Gentlemen:

El Paso Natural Gas Company has requested administrative approval for an unorthodox location for a well in the Blanco Mesa Verde pool.

It is intended to locate the El Paso Natural Gas Company's San Juan 30-6 Unit #91A at 835' from the South line and 580' from the East line of Section 28, T-30-N, R-7-W, Rio Arriba County, New Mexico.

Extremely rough terrain with cliffs and steep ledges in the southeast corner of this section makes it impossible to build an orthodox gas well location.

In compliance with New Mexico Oil Conservation Division rules, we are notifying you, as operator of an offsetting proration unit, of our application for administrative approval for the aforementioned unorthodox gas well location. Enclosed are three copies of this letter. If there is no objection to this location, please sign and return one copy to the New Mexico Oil Conservation Division, Post Office Box 2088, Santa Fe, New Mexico 87501; one copy to El Paso Natural Gas Company; and keep one copy for your files.

A plat showing the proposed well location and offsetting Mesa Verde lease ownership is attached.

Sincerely,

L. A. Aimes

L. A. Aimes
Project Drilling Engineer

LAA:pb

Approved: Blackwood & Nichols Co., Ltd.
De Lasso
District Manager

Date: 10-2-79



P. O. BOX 990
FARMINGTON, NEW MEXICO 87401
PHONE: 505-325-2841

September 20, 1979

Blackwood Nichols
Post Office Box 1237
Durango, Colorado 81301

Re: Unorthodox Gas Well Location

Gentlemen:

El Paso Natural Gas Company has requested administrative approval for an unorthodox location for a well in the Blanco Mesa Verde pool.

It is intended to locate the El Paso Natural Gas Company's San Juan 30-6 Unit #91A at 835' from the South line and 580' from the East line of Section 28, T-30-N, R-7-W, Rio Arriba County, New Mexico.

Extremely rough terrain with cliffs and steep ledges in the southeast corner of this section makes it impossible to build an orthodox gas well location.

In compliance with New Mexico Oil Conservation Division rules, we are notifying you, as operator of an offsetting proration unit, of our application for administrative approval for the aforementioned unorthodox gas well location. Enclosed are three copies of this letter. If there is no objection to this location, please sign and return one copy to the New Mexico Oil Conservation Division, Post Office Box 2088, Santa Fe, New Mexico 87501; one copy to El Paso Natural Gas Company; and keep one copy for your files.

A plat showing the proposed well location and offsetting Mesa Verde lease ownership is attached.

Sincerely,

A handwritten signature in cursive script that reads "L. A. Aimes".

L. A. Aimes
Project Drilling Engineer

LAA:pb

Approved: _____

Date: _____

El Paso NATURAL GAS
COMPANY

P. O. BOX 990
FARMINGTON, NEW MEXICO 87401
PHONE: 505-325-2841

September 20, 1979

Blackwood Nichols
Post Office Box 1237
Durango, Colorado 81301

Re: Unorthodox Gas Well Location

Gentlemen:

El Paso Natural Gas Company has requested administrative approval for an unorthodox location for a well in the Blanco Mesa Verde pool.

It is intended to locate the El Paso Natural Gas Company's San Juan 30-6 Unit #91A at 835' from the South line and 580' from the East line of Section 28, T-30-N, R-7-W, Rio Arriba County, New Mexico.

Extremely rough terrain with cliffs and steep ledges in the southeast corner of this section makes it impossible to build an orthodox gas well location.

In compliance with New Mexico Oil Conservation Division rules, we are notifying you, as operator of an offsetting proration unit, of our application for administrative approval for the aforementioned unorthodox gas well location. Enclosed are three copies of this letter. If there is no objection to this location, please sign and return one copy to the New Mexico Oil Conservation Division, Post Office Box 2088, Santa Fe, New Mexico 87501; one copy to El Paso Natural Gas Company; and keep one copy for your files.

A plat showing the proposed well location and offsetting Mesa Verde lease ownership is attached.

Sincerely,

L. A. Aimes

L. A. Aimes
Project Drilling Engineer

LAA:pb

Approved: _____

Date: _____

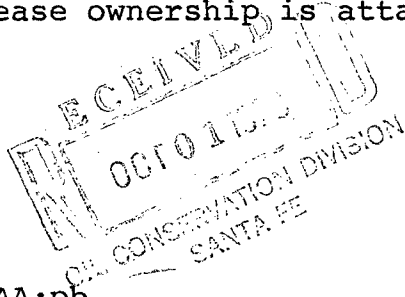

1980

All distances must be from the outer boundaries of the Section.

Operator EL PASO NATURAL GAS COMPANY			Lease SAN JUAN 30-6 UNIT (NM-02151)		Well No. 91A
Unit Letter P	Section 28	Township 30N	Range 7W	County Rio Arriba	
Actual Footage Location of Well: 835 feet from the South line and 580 feet from the East line					
Ground Level Elev. 6890	Producing Formation Mesa Verde		Pool Blanco Mesa Verde	Dedicated Acreage: 320.00 Acres	

1. Outline the acreage dedicated to the subject well by colored pencil or hachure marks on the plat below.
2. If more than one lease is dedicated to the well, outline each and identify the ownership thereof (both as to working interest and royalty).
3. If more than one lease of different ownership is dedicated to the well, have the interests of all owners been consolidated by communitization, unitization, force-pooling, etc?

☒ Yes ☐ No If answer is "yes," type of consolidation Unitization

If answer is "no," list the owners and tract descriptions which have actually been consolidated. (Use reverse side of this form if necessary.)

No allowable will be assigned to the well until all interests have been consolidated (by communitization, unitization, forced-pooling, or otherwise) or until a non-standard unit, eliminating such interests, has been approved by the Commission.

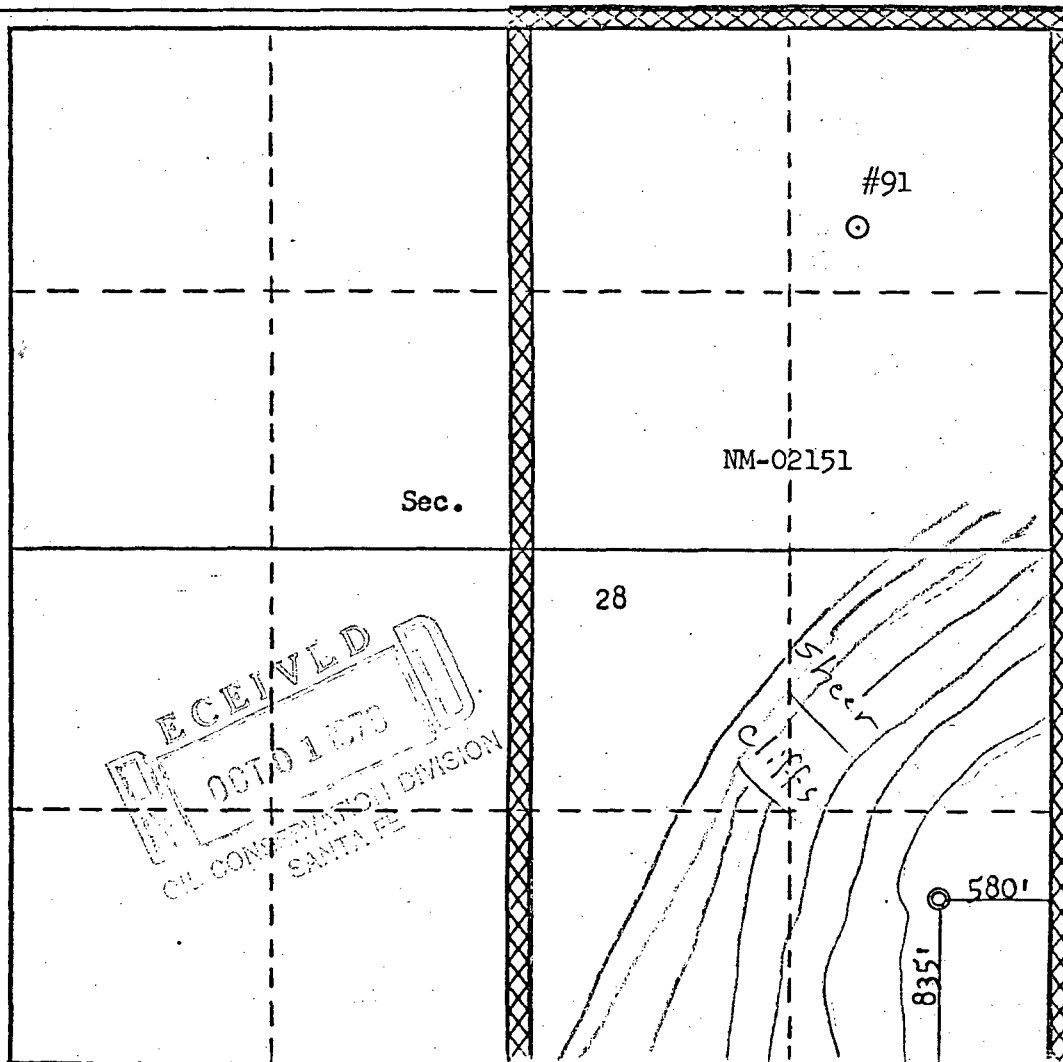

CERTIFICATION

I hereby certify that the information contained herein is true and complete to the best of my knowledge and belief.

A. G. Bruce

Name **Drilling Clerk**

Position **El Paso Natural Gas Co.**

Company **September 20, 1979**

Date

I hereby certify that the well location shown on this plat was plotted from field notes of actual surveys made by me or under my supervision, and that the same is true and correct to the best of my knowledge and belief.

Date Surveyed

July 27, 1979

Registered Professional Engineer and/or Land Surveyor

Fred B. Kerr Jr.
Fred B. Kerr Jr.

Certificate No.

2050

EL PASO NATURAL GAS COMPANY

Well Name San Juan 30-6 Unit #91 A , BLANCO MESAVERDE

Footage---- 835' FSL, 580' FEL

APPLICATION FOR NON-STANDARD LOCATION

County Rio Arriba State New Mexico Section 28 Township 30N Range 7W

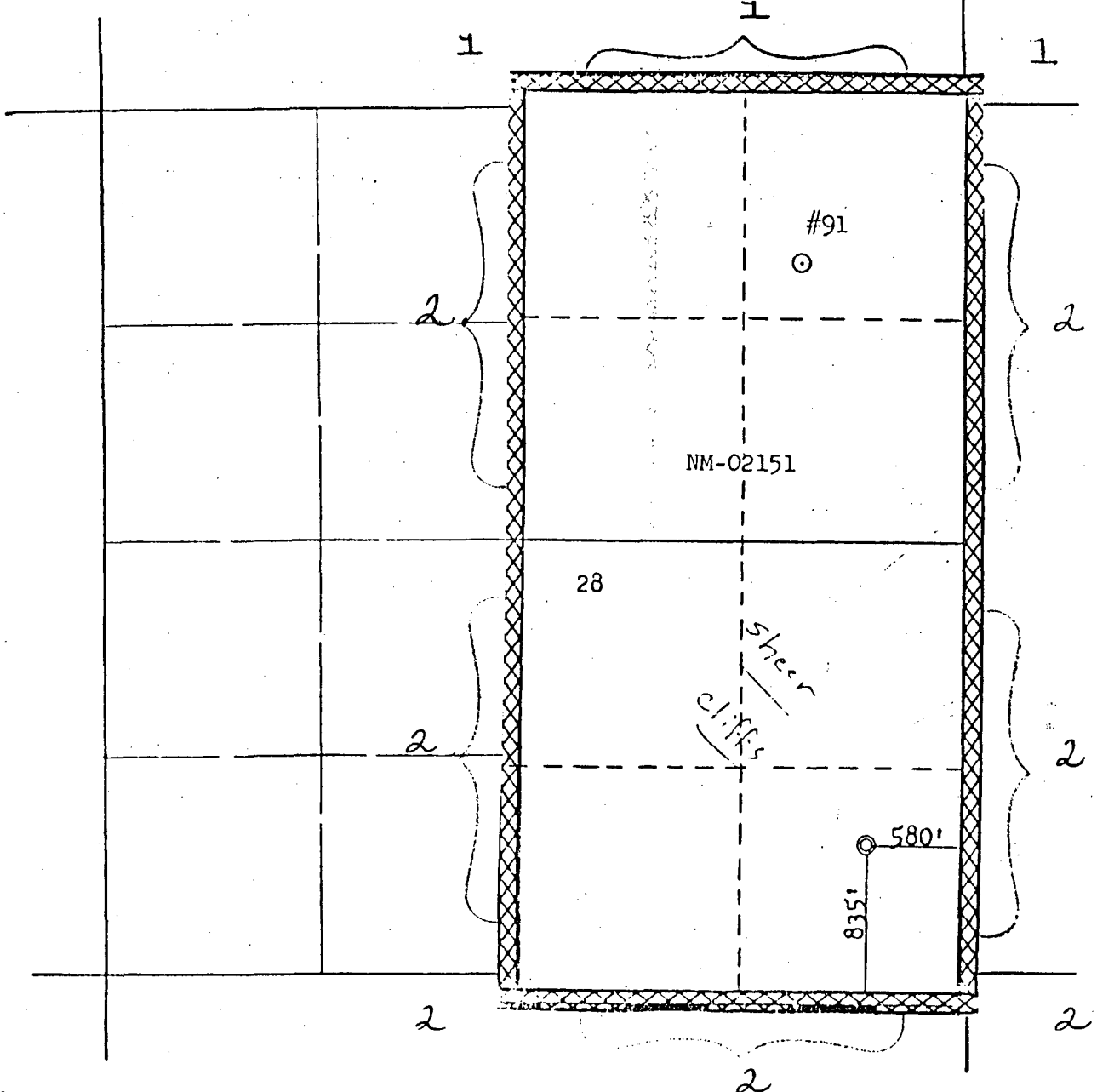

REMARKS:

- (1) BLACKWOOD & NICHOLS-OPERATOR
- (2) EL PASO NATURAL GAS COMPANY-OPERATOR

RECEIVED
OCT 01 1973
CONSERVATION DIVISION
SANTA FE

(ld)