



Getty Oil Company | Three Park Central, Suite 700, 1515 Arapahoe St., Denver, CO 80202 • 303/623-4200

W. J. Newman, District Production Manager  
Denver Exploration and Production District

August 17, 1979

NSL - 1069  
Rule 3 R1620V  
9-9-79

RE: ADMINISTRATIVE APPROVAL  
UNORTHODOX LOCATION

Energy and Minerals Department  
Oil Conservation Division  
P.O. Box 2088  
Santa Fe, New Mexico 87501

Attention: Mr. Joe D. Ramey  
Oil Director

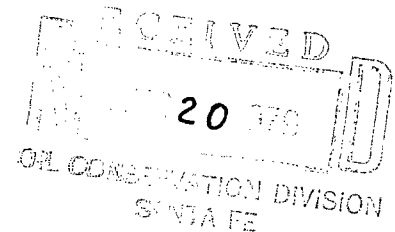

Gentlemen:

We request administrative approval to drill our proposed Mexico Federal "K" No. 1E Basin Dakota well at a location 1190 feet from the south line and 2020 feet from the west line of the "short" Section 8, T28N, R10W, San Juan County, New Mexico. An orthodox location would be 1190 feet from the south and 2120 feet from the west line.

This unorthodox location is required due to the topography. An unnamed wash runs directly through the orthodox drilling location and the wash is butted up next to a bluff.

All offset operators have been notified by certified mail of this application.

We have asked Mr. Al Kendrick of your Aztec office to forward a copy of the surveyor plat. Attached is a plat showing offset ownership.

Very truly yours,

W. J. Newman

GEB:clm  
attachs.

cc: Mr. Al Kendrick, Supervisor  
1000 Rio Brazos Road  
Aztec, New Mexico 87410

MAILING LIST  
Unorthodox Location  
Mexico Federal "K" No. 1E

Amoco Production Company  
Mr. M.S. Kraemer  
Security Life Bldg.  
Denver, CO 80202

Amoco Production Company  
Mr. L.O. Speer, Jr.  
501 Airport Road  
Farmington, NM 87401

Crown Central Petroleum Corp.  
Mr. Jim Chalcraft  
Box 1096  
Morton, Wyoming 82522

Southland Royalty Co.  
410 17th Street, Ste. 1000  
Denver, CO 80202

Supron Energy Corp.  
Box 808  
Farmington, New Mexico 87401

Texaco  
Box 2100  
Denver, CO 80201

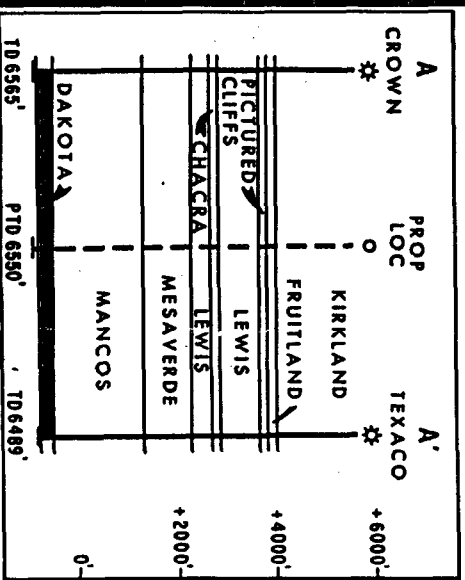
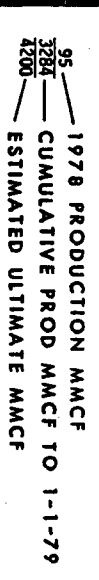
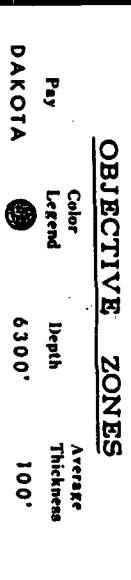
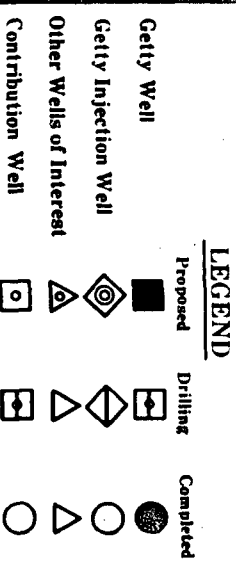
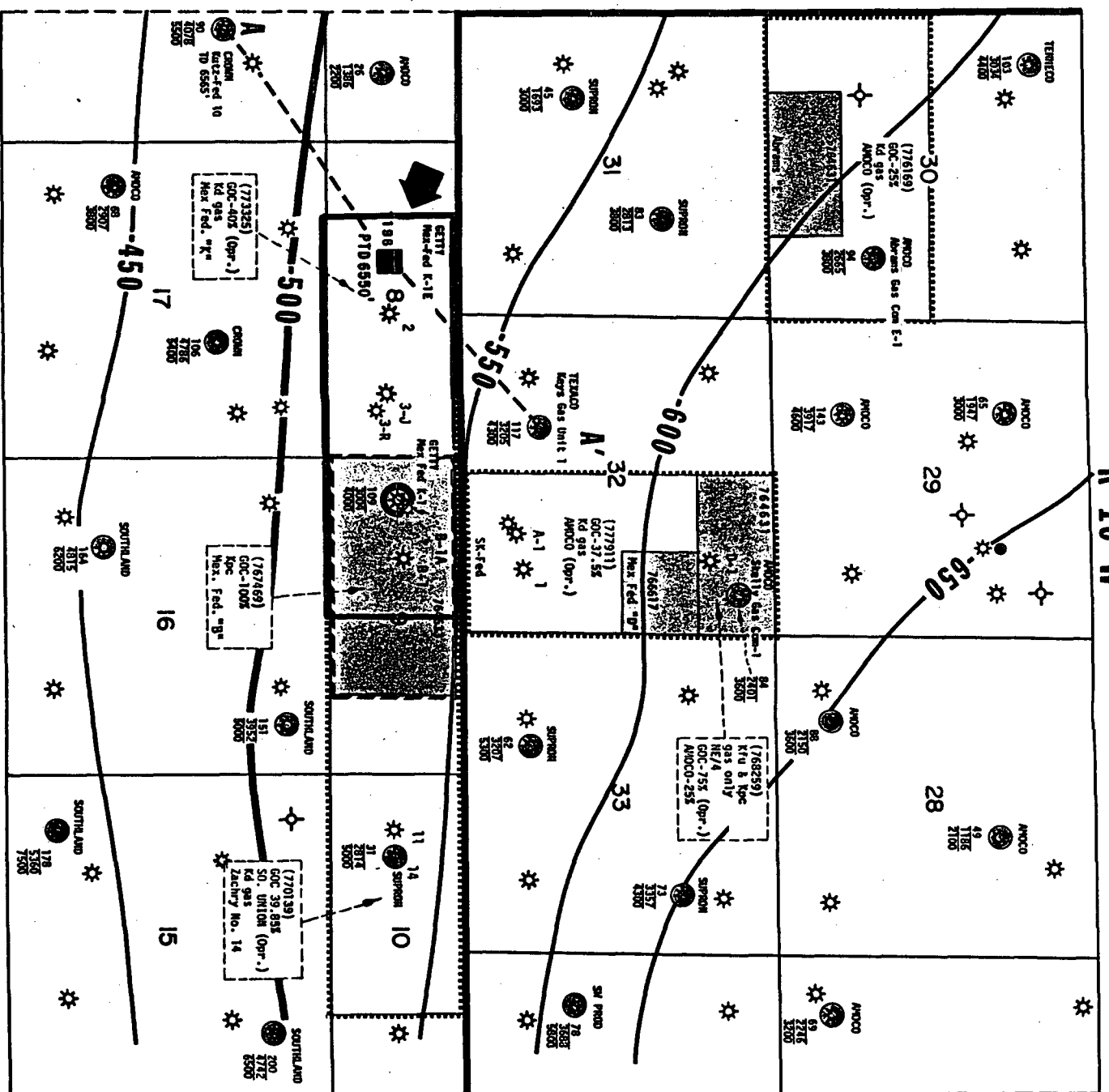

1196  
STRUCTURE 1/DAKOTA C.I. 50' JEV

GETTY OIL COMPANY  
**BASIN DAKOTA FIELD**  
(MEX FED "K")  
SAN JUAN COUNTY, NEW MEXICO  
DENVER DISTRICT

SCALE 1" = 2000'  
DATE MAY 1979



NEW MEXICO OIL CONSERVATION COMMISSION  
WELL LOCATION AND ACREAGE DEDICATION PLAT

Form C-102  
Supersedes C-128  
Effective 1-1-65

All distances must be from the outer boundaries of the Section.

Operator <b>GETTY OIL COMPANY</b>			Lease <b>MEXICO-FEDERAL "K"</b>		Well No. <b>1-E</b>
Unit Letter <b>0</b>	Section <b>8</b>	Township <b>28N</b>	Range <b>10W</b>	County <b>San Juan</b>	
Actual Footage Location of Well: <b>1190</b> feet from the <b>South</b> line and <b>2020</b> feet from the <b>West</b> line					
Ground Level Elev: <b>5713</b>	Producing Formation <b>Dakota</b>		Pool <b>Basin Dakota</b>		Dedicated Acreage:  Acres

1. Outline the acreage dedicated to the subject well by colored pencil or hatchure marks on the plat below.
2. If more than one lease is dedicated to the well, outline each and identify the ownership thereof (both as to working interest and royalty).
3. If more than one lease of different ownership is dedicated to the well, have the interests of all owners been consolidated by communitization, unitization, force-pooling, etc?

☐ Yes ☐ No If answer is "yes," type of consolidation \_\_\_\_\_

If answer is "no," list the owners and tract descriptions which have actually been consolidated. (Use reverse side of this form if necessary.) \_\_\_\_\_

No allowable will be assigned to the well until all interests have been consolidated (by communitization, unitization, forced-pooling, or otherwise) or until a non-standard unit, eliminating such interests, has been approved by the Commission.

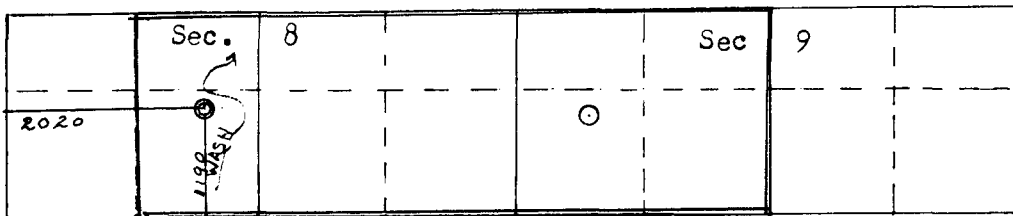

Location moved by Company Representative

Scale 1" = 2000'

RECEIVED  
AUG 6 1979  
OIL CONSERVATION DIVISION  
SANTA FE

CERTIFICATION

I hereby certify that the information contained herein is true and complete to the best of my knowledge and belief.

**PAUL D BERHOSI**

Name  
**Paul D Berhosi**  
Position  
**Field Technician IV**  
Company  
**Getty Oil Co**  
Date  
**August 18 1979**

I hereby certify that the well location shown on this plat was plotted from field notes of actual surveys made by me or under my supervision, and that the same is true and correct to the best of my knowledge and belief.

Date Surveyed  
**August 17, 1979**  
Registered Professional Engineer and  
Land Surveyor  
**Frederick B. Kerr Jr.**  
Certificate No. **2950**



*Waiver*



PETROLEUM PRODUCTS

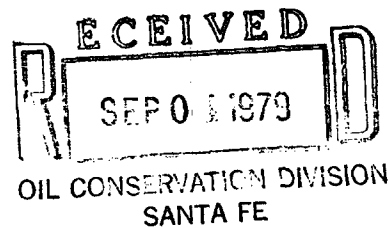

PRODUCING DEPARTMENT  
WEST UNITED STATES  
DENVER DIVISION

August 24, 1979

TEXACO INC.  
P. O. BOX 2100  
DENVER, COLORADO 80201

ADMINISTRATIVE APPROVAL  
UNORTHODOX LOCATION  
GETTY OIL COMPANY  
SEC. 8, T28N, R10W  
SAN JUAN COUNTY, NEW MEXICO  
6.02-1

Mr. Joe D. Ramey  
Oil Conservation Division  
Energy and Minerals Department  
P. O. Box 2088  
Santa Fe, New Mexico 87501

Dear Mr. Ramey:

~~Getty Oil Company's~~ letter application dated August 17, 1979 requested administrative approval to move the location for a Basin Dakota well 100 feet west of the orthodox location because of topographic problems. More specifically, Getty requested approval of a location 1190 feet from the south line and 2020 feet from the west line of the fractional Section 8, Township 28 North, Range 10 West, San Juan County, New Mexico.

Texaco Inc. owns an offset lease, so Getty notified us of their request for approval of an unorthodox location. Texaco has reviewed Getty's application and finds no reason to object. Texaco, therefore, waives objection and urges your approval.

Very truly yours,

J. C. WHITE  
ASSISTANT DIVISION MANAGER

LEA:hn

CC: Mr. A. R. Kendrick  
Oil Conservation Division  
Energy and Minerals Department  
1000 Rio Brazos Road  
Aztec, New Mexico 87410

Mr. W. J. Newman  
Getty Oil Company  
Three Park Central, Suite 700  
1515 Arapahoe Street  
Denver, Colorado 80202

OIL CONSERVATION COMMISSION  
Alameda DISTRICT

OIL CONSERVATION COMMISSION  
BOX 2088  
SANTA FE, NEW MEXICO

DATE 8-20-79

RE: Proposed MC \_\_\_\_\_  
Proposed DHC \_\_\_\_\_  
Proposed NSL ✓ \_\_\_\_\_  
Proposed SWD \_\_\_\_\_  
Proposed WFX \_\_\_\_\_  
Proposed PMX \_\_\_\_\_

Gentlemen:

I have examined the application dated 8-17-79  
for the Getty Oil Co. Mexico-Del Norte # 1E N-8-28N-10W  
Operator Lease and Well No. Unit, S-T-R

and my recommendations are as follows:

Approve  
\_\_\_\_\_  
\_\_\_\_\_  
\_\_\_\_\_  
\_\_\_\_\_  
\_\_\_\_\_

Yours very truly,

AK Kendrick

