

dugan production corp.

October 17, 1979

Joe D. Ramey
Division Director
New Mexico Oil Conservation Division
Box 2088
Santa Fe, New Mexico 87501

NSV-1097
Rule 104 F
11-7-79

Re: Application for Administrative
Approval of Unorthodox Location
Pittam Pond #1 Well
T-29-N, R-15-W, N.M.P.M.
Section 1: 1235' FNL - 1215' FEL
San Juan County, New Mexico

Dear Mr. Ramey:

Enclosed are the following items regarding the Application for Administrative Approval of the Unorthodox Location of the Pittam Pond #1 Well which will be located in the NE/4 of Section 1, Township 29 North, Range 15 West, N.M.P.M., San Juan County, New Mexico.

1. Three copies of the Application for Administrative Approval of the Unorthodox Location for the Pittam Pond #1 Well.
2. Three copies of a plat showing the ownership of all leases offsetting the NE/4 of Section 1, Township 29 North, Range 15 West, N.M.P.M. This plat also shows all of the wells completed on these leases.

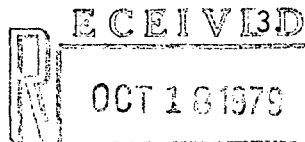

Three copies of an aerial photo showing the proposed location of the well within El Paso Natural Gas Company's San Juan River Plant.

OIL CONSERVATION DIVISION
SANTA FE

Joe D. Ramey
October 17, 1979
Page Two

4. Three copies of a map showing the restricted area for drilling within El Paso Natural Gas Company's San Juan River Plant.
5. Three copies of a Certificate of Mailing stating that all operators of leases offsetting the dedicated acreage for this well have been notified of the Application by Certified Mail, and the Supervisor of the District III Office of the New Mexico Oil Conservation Division and the U.S. Geological Survey have been notified of the Application by regular mail.

If you need further information or assistance, please advise.

Sincerely,

Richard T. C. Tully

Richard T. C. Tully
Attorney for Applicant

RTCT:eb

Enclosures

cc: Al Kendrick
Supervisor, District III Office
New Mexico Oil Conservation Division
1000 Rio Brazos Road
Aztec, N.M. 87410

Jim Sims
District Engineer
U.S. Geological Survey
Box 959
Farmington, N.M. 87401

R. E. Pittam
Staff Landman
Mountain Fuel Supply Company
Box 11368
Salt Lake City, Ut. 84139

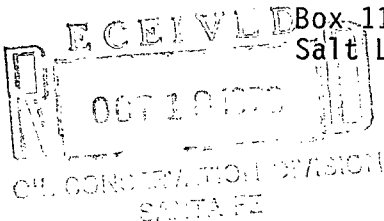

Joe D. Ramey
October 17, 1979
Page Three

David M. Poage
Senior Landman
El Paso Natural Gas Company
Box 990
Farmington, N.M. 87401

Roy Scharrock
Southern Union Exploration Company
1800 First International Building
Dallas, Tx. 75270

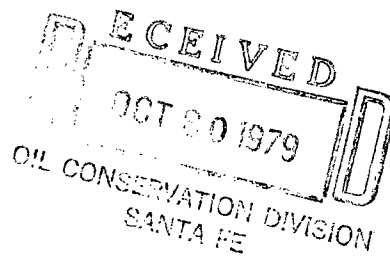

MOUNTAIN FUEL SUPPLY COMPANY

180 EAST FIRST SOUTH • P. O. BOX 11368 • SALT LAKE CITY, UTAH 84139 • PHONE (801) 534-5555

October 26, 1979

Mr. Joe D. Ramey
Division Director
New Mexico Oil Conservation Division
P. O. Box 2088
Santa Fe, NM 87501

Dear Mr. Ramey:

Attached is a copy of this company's consent to the Unorthodox Location for the Pittam Pond No. 1 Well located in the NE $\frac{1}{4}$ of Section 1, Township 29 North, Range 15 West, San Juan County, New Mexico.

Very truly yours,

R. E. Pittam
Staff Landman

REP:vw
Encl.

cc w/encl: Dugan Production Company
P. O. Box 234
Farmington, NM 87401

WAIVER OF OBJECTION AND CONSENT
TO THE UNORTHODOX LOCATION OF
THE PITTAM POND #1 WELL

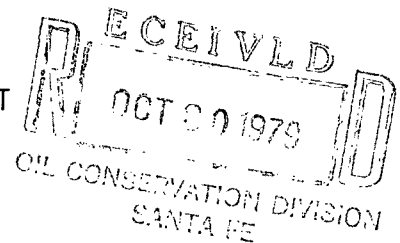

The undersigned, as an operator of a lease offsetting the NE/4 of Section 1, Township 29 North, Range 15 West, N.M.P.M., San Juan County, New Mexico, does hereby acknowledge receipt of the Application for Administrative Approval of Unorthodox Location for the Pittam Pond #1 Well.

The undersigned states that it waives any objection it may have to this unorthodox location, and voluntarily consents to the location of the Pittam Pond #1 Well as stated in the above mentioned Application.

Dated this 25th day of October, 1979.

MOUNTAIN FUEL SUPPLY COMPANY

Company Name

By:

B. Mueller

Title: Chairman and President

Address: P. O. Box 11368

Salt Lake City, UT 84139

Send one executed copy to Joe D. Ramey, Division Director, New Mexico Oil Conservation Division, P.O. Box 2088, Santa Fe, New Mexico 87501, and return one executed copy to the Applicant. The remaining copy is for your files.

APPLICATION FOR ADMINISTRATIVE APPROVAL
OF UNORTHODOX LOCATION

Applicant:	Dugan Production Corp. P.O. Box 208 Farmington, New Mexico 87401
Lease:	Pittam Pond Lease USA NM 10758
Lease Date:	December 1, 1969
Lease Term:	Ten Years
Lands Described in Lease Dedicated to the Well:	<u>Township 29 North, Range 15 West, N.M.P.M.</u> Section 1: NE/4 Containing 160 acres, more or less San Juan County, New Mexico
Name of Well:	Pittam Pond #1 Well
Proposed Unorthodox Location:	<u>Township 29 North, Range 15 West, N.M.P.M.</u> Section 1: 1235' FNL - 1215' FEL (Unit Letter A) San Juan County, New Mexico
Reason for Unorthodox Location:	Topographical conditions based on the restricted locations available for drilling wells in El Paso Natural Gas Company's San Juan River Plant.
New Mexico Oil Conservation Division Rule Authorizing Application:	Rule 104(D)(II)(F)

Offsetting Leases and Operators:

A. USA NM 10758 (Same Lease)

Township 29 North, Range 15 West, N.M.P.M.
Section 1: NW/4, S/2

San Juan County, New Mexico

Mountain Fuel Supply Company
Box 11368
Salt Lake City, Utah 84139

ATTN: R.E. Pittam, Staff Landman

Dugan Production Corp.
Box 208
Farmington, New Mexico 87401

B. State of New Mexico E-3150-1

Township 30 North, Range 15 West, N.M.P.M.
Section 36: S/2

San Juan County, New Mexico

El Paso Natural Gas Company
Box 990
Farmington, New Mexico 87401

ATTN: David M. Poage,
Senior Landman

C. USA NM 4465 (Mayre Lease)

Township 30 North, Range 14 West, N.M.P.M.
Section 31: SW/4

San Juan County, New Mexico

Dugan Production Corp.
Box 208
Farmington, New Mexico 87401

D. Unleased

Township 29 North, Range 14 West, N.M.P.M.
Section 6: E/2 SW/4

San Juan County, New Mexico

E. USA NM 36479

Township 29 North, Range 14 West, N.M.P.M.
Section 6: W/2 SW/4, NW/4

San Juan County, New Mexico

Southern Union Exploration Company
1800 First International Building
Dallas, Texas 75270

ATTN: Roy Scharrock

OME 24" LINE
LINE



36

PROD. LINE

54-E 5273E

RES ROCK

TWS-30-N

TWS-29-N

BARRIER FENCE LINE
WITH LINE

W.O. 630 VALVE #0

800+30E DWG. STR-1-11

500+44E MP#0 End of
Line + Begin Plant Piping

P. 866+088
31°56' E

1335'
North

S. 67°32' W. 26365'

Restricted Area
for Drilling

N. 41+088
W. 2+847
Camp Site Coordinates

N. 45+033
W. 15+000

1315'
East

10" 6" Reducer

DETAILS ON DWG. LAR-ANLP-5

546+918

End Blanco-Fruitland Line

N. 36+10

Office

N. 0°01'E

P. 544+108

134137E

END AT DITCH

90°00'E

100' 16" O.D.
375 W.T.
Grade A

1483E 16" O.D. 250" W.T.
A.O.S.

S. 53°45' W.

N. 0+757

S. 64°15' E 65' BR. END 16" O.D. 250" W.T. P.D.C.

535+921

END 16" O.D. 375 W.T. P.D.C.

535+907 10" O.D.E

APPLICATION FOR UNORTHODOX LOCATION

PITTAM POND #1 Well



Proposed Location

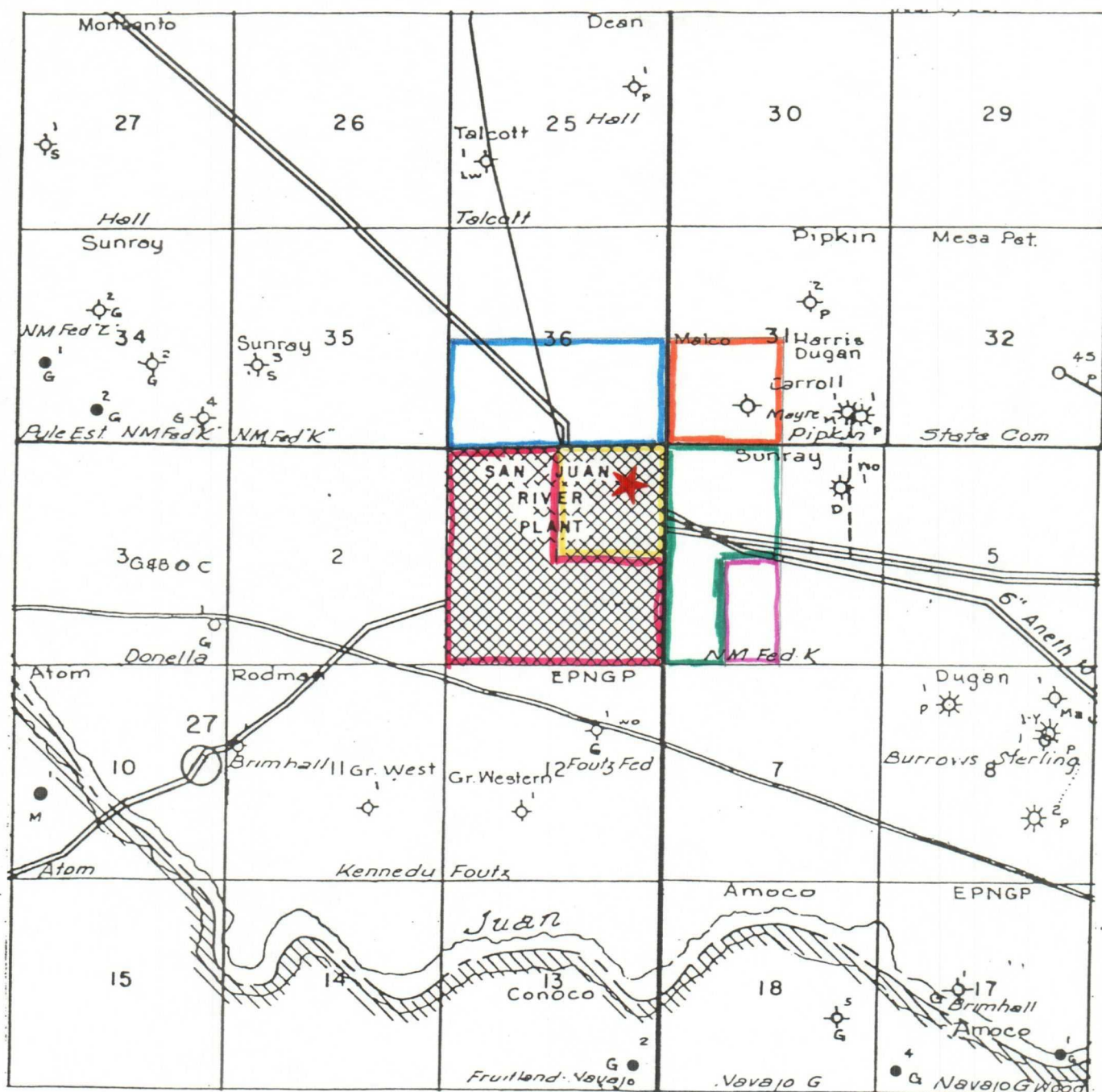

T-29-N, R-14-W T-29-N, R-15-W
T-30-N, R-14-W T-30-N, R-15-W

APPLICATION FOR UNORTHODOX LOCATION
PITAM POND #1 WELL
T-29-N, R-15-W, N.M.P.M.
Section 1: 1235' FNL - 1215' FEL (Unit Letter A)
San Juan County, New Mexico

Offsetting Leases and Operators

- | | |
|---|--|
| USA NM 10758
Mountain Fuel Supply Company,
Dugan Production Corp. | Unleased |
| State of New Mexico E-3150-1
El Paso Natural Gas Company | USA NM 36479
Southern Union Exploration Co. |
| USA NM 4465 (Mayre Lease)
Dugan Production Corp. | |

- ★ Well Location
■ Dedicated Acreage

CERTIFICATE OF MAILING

I certify that I mailed a copy of the Application for Unorthodox Location of the Pittam Pond #1 Well by certified mail to all operators of leases offsetting the dedicated acreage for the Pittam Pond #1 Well, and to the Supervisor of the District III Office of the New Mexico Oil Conservation Division and to the U.S. Geological Survey by regular mail on this 17th day of October, 1979.

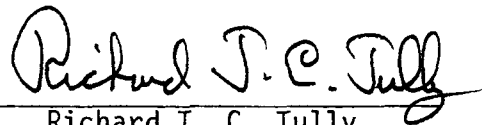

Richard T. C. Tully
Attorney for Applicant

WAIVER OF OBJECTION AND CONSENT
TO THE UNORTHODOX LOCATION OF
THE PITTAM POND #1 WELL

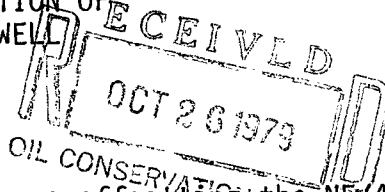

The undersigned, as an operator of a lease offsetting the NE 1/4 of Section 1, Township 29 North, Range 15 West, N.M.P.M., San Juan County, New Mexico, does hereby acknowledge receipt of the Application for Administrative Approval of Unorthodox Location for the Pittam Pond #1 Well.

The undersigned states that it waives any objection it may have to this unorthodox location, and voluntarily consents to the location of the Pittam Pond #1 Well as stated in the above mentioned Application.

Dated this 25th day of October, 1979.

EL PASO NATURAL GAS COMPANY

Company Name

By:

John A. Ahlman

Title: Regional Land Manager

Address: P. O. Box 289

Farmington, NM 87401

Send one executed copy to Joe D. Ramey, Division Director, New Mexico Oil Conservation Division, P.O. Box 2088, Santa Fe, New Mexico 87501, and return one executed copy to the Applicant. The remaining copy is for your files.

WAIVER OF OBJECTION AND CONSENT
TO THE UNORTHODOX LOCATION OF
THE PITTAM POND #1 WELL

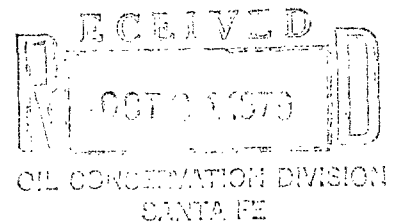

The undersigned, as an operator of a lease offsetting the NE/4 of Section 1, Township 29 North, Range 15 West, N.M.P.M., San Juan County, New Mexico, does hereby acknowledge receipt of the Application for Administrative Approval of Unorthodox Location for the Pittam Pond #1 Well.

The undersigned states that it waives any objection it may have to this unorthodox location, and voluntarily consents to the location of the Pittam Pond #1 Well as stated in the above mentioned Application.

Dated this 22nd day of October, 1979.

Southern Union Exploration Company
Company Name

By: Roy G. Sharrock
Roy G. Sharrock

Title: Vice President/Chief Geologist

Address: 1800 First International Bldg.

Dallas, Texas 75270

Send one executed copy to Joe D. Ramey, Division Director, New Mexico Oil Conservation Division, P.O. Box 2088, Santa Fe, New Mexico 87501, and return one executed copy to the Applicant. The remaining copy is for your files.

OIL CONSERVATION COMMISSION
AZTEC DISTRICT

OIL CONSERVATION COMMISSION
BOX 2088
SANTA FE, NEW MEXICO

DATE 10-19-79

RE: Proposed MC _____
Proposed DHC _____
Proposed NSL XXX _____
Proposed SWD _____
Proposed WFX _____
Proposed PMX _____

R. L. STAMET RECEIVED
OCT 25 1979

Gentlemen:

OIL CONSERVATION DIVISION
SANTA FE

I have examined the application dated 10-17-79
for the DUGAN PROD. CORP. PITMAN POND #1, A-1-29N-15W
Operator Lease and Well No. Unit, S-T-R

and my recommendations are as follows:

Approve for a Twin Mounds-
Pictured Cliffs well.

Yours very truly,

AR Hendrick