



PHILLIPS PETROLEUM COMPANY

ODESSA, TEXAS 79762
4001 PENBROOK

NATURAL RESOURCES GROUP
Exploration and Production

November 17, 1979

Unorthodox Locations--

East Vacuum Grayburg-San Andres Unit,
Vacuum Grayburg-San Andres Pool,
Lea County, New Mexico

The New Mexico Department of
Energy and Minerals
Oil Conservation Division--3
P. O. Box 2088
Santa Fe, New Mexico 87501

Attention: Mr. Joe D. Ramey
Division Director

Gentlemen:

We respectfully request administrative approval of the unorthodox locations of the below listed wells. Administrative action is provided by Order Number R-5897, Section 4, Rule 8. All contiguous proration units are within the interior of the subject unit or the location of the well is greater than 330 feet from the outer unit boundary. Therefore, waiver of the waiting period and immediate action is requested. Individual well proration plats and a unit plat are attached.

Tract 2642--Well No. 001

1310' from the East and 2630' from the North,
Section 26, Township 17-S, Range 35-E, Lea County,
New Mexico.

Tract 2622--Well No. 002

1330' from the East and 1430' from the North,
Section 26, Township 17-S, Range 35-E, Lea County,
New Mexico.

Tract 2819--Well No. 004

1330' from the East and 1330' from the North,
Section 28, Township 17-S, Range 35-E, Lea County,
New Mexico.

Tract 2271--Well No. 003

1330' from the East and 10' from the South,
Section 22, Township 17-S, Range 35-E, Lea County,
New Mexico.

Tract 2864--Well No. 002

1360' from the West and 10' from the North,
Section 28, Township 17-S, Range 35-E, Lea County,
New Mexico.

Tract 2150--Well No. 001

1310' from the East and 10' from the South,
Section 21, Township 17-S, Range 35-E, Lea County,
New Mexico.

*NSLS - 1108
Rule 8 R-5897
as per previous
format
Immediate*

[Handwritten signature]

The New Mexico Department of Energy and Minerals
Oil Conservation Division
November 17, 1979
Page: 2

<u>Tract 2230--Well No. 003</u>	1310' from the West and 1310' from the South, Section 22, Township 17-S, Range 35-E, Lea County, New Mexico.
<u>Tract 2980--Well No. 002</u>	1330' from the West and 1330' from the North, Section 29, Township 17-S, Range 35-E, Lea County, New Mexico.
<u>Tract 2923--Well No. 001</u>	1410' from the East and 1330' from the North, Section 29, Township 17-S, Range 35-E, Lea County, New Mexico.
<u>Tract 2944--Well No. 001</u>	1330' from the East and 10' from the North, Section 29, Township 17-S, Range 35-E, Lea County, New Mexico.
<u>Tract 2923--Well No. 002</u>	1330' from the West and 60' from the North, Section 29, Township 17-S, Range 35-E, Lea County, New Mexico.
<u>Tract 2059--Well No. 003</u>	1330' from the West and 2630' from the North, Section 20, Township 17-S, Range 35-E, Lea County, New Mexico.
<u>Tract 1910--Well No. 003</u>	1330' from the East and 2630' from the South, Section 19, Township 17-S, Range 35-E, Lea County, New Mexico.

Your early consideration and advice will be appreciated.

Very truly yours,

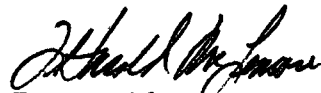

T. Harold McIemore
Area Regulations and
Proration Analyst

JN:skm
Attachments

cc: Oil Conservation Division
Hobbs, New Mexico (w/attachments)

**NEW MEXICO OIL CONSERVATION COMMISSION
WELL LOCATION AND ACREAGE DEDICATION PLAT**

Form C-102
Supersedes C-128
Effective 1-1-65

All distances must be from the outer boundaries of the Section.

Operator PHILLIPS PETROLEUM COMPANY			Lease EVGSA Unit 2642		Well No. 001
Unit Letter H	Section 26	Township 17 South	Range 35 East	County Lea	
Actual Footage Location of Well: 1310 feet from the east line and 2630 feet from the north line					
Ground Level Elev. 3910.4	Producing Formation Grayburg/San Andres		Pool Vacuum Gb/San Andres		Dedicated Acreage: 40 Acres

1. Outline the acreage dedicated to the subject well by colored pencil or hachure marks on the plat below.
2. If more than one lease is dedicated to the well, outline each and identify the ownership thereof (both as to working interest and royalty).
3. If more than one lease of different ownership is dedicated to the well, have the interests of all owners been consolidated by communitization, unitization, force-pooling, etc?

☐ Yes ☐ No If answer is "yes," type of consolidation _____

If answer is "no," list the owners and tract descriptions which have actually been consolidated. (Use reverse side of this form if necessary.) _____

No allowable will be assigned to the well until all interests have been consolidated (by communitization, unitization, forced-pooling, or otherwise) or until a non-standard unit, eliminating such interests, has been approved by the Commission.

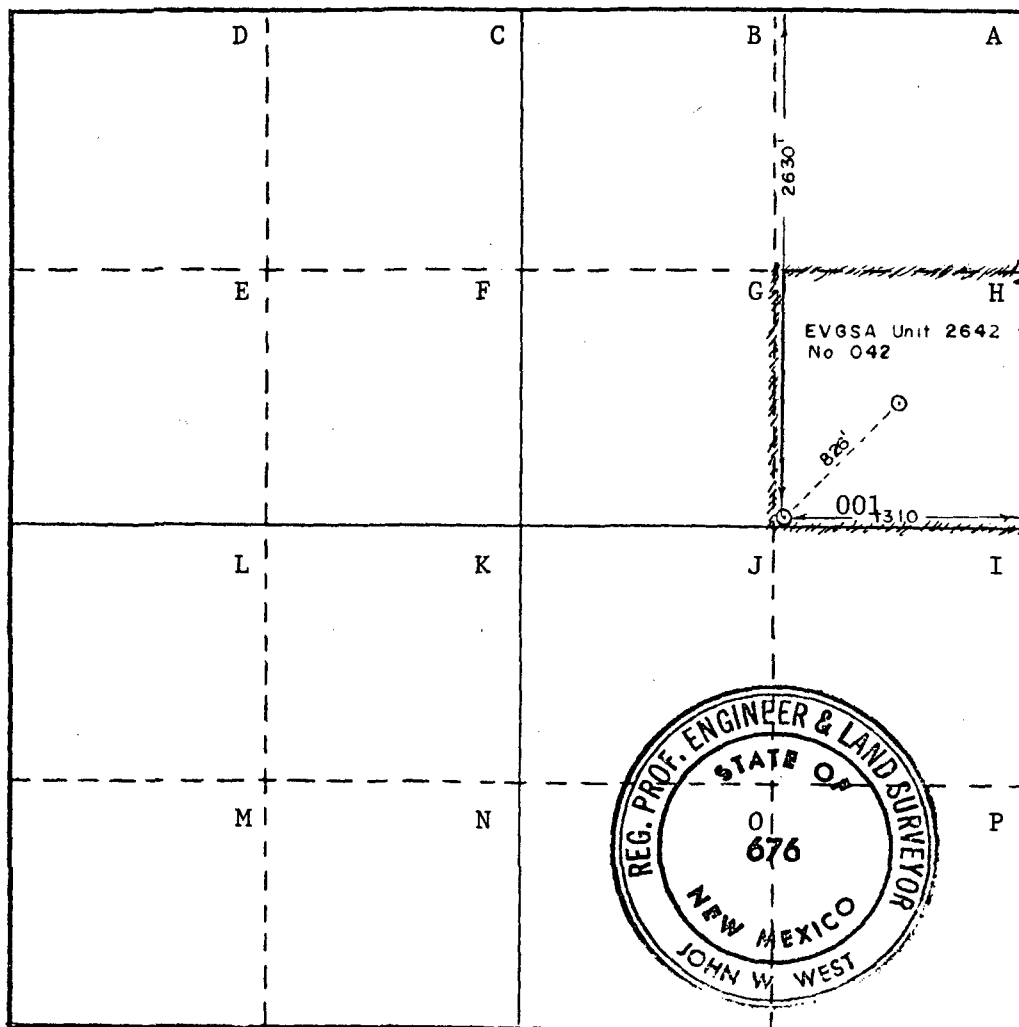

CERTIFICATION

I hereby certify that the information contained herein is true and complete to the best of my knowledge and belief.

Name

W. J. Mueller

Position

Senior Engineering Specialist

Company

Phillips Petroleum Company

Date

November 16, 1979

I hereby certify that the well location shown on this plat was plotted from field notes of actual surveys made by me or under my supervision, and that the same is true and correct to the best of my knowledge and belief.

Date Surveyed

Oct. 10, 1979

Registered Professional Engineer and/or Land Surveyor

John W. West

Certificate No. **JOHN W. WEST 676**
PATRICK A. ROMERO 6665
Ronald J. Eldson 3239

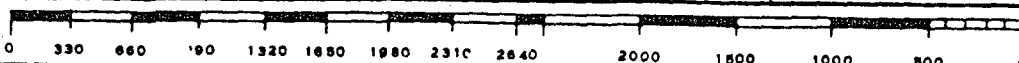

**NEW MEXICO OIL CONSERVATION COMMISSION
WELL LOCATION AND ACREAGE DEDICATION PLAT**

Form C-102
Supersedes C-128
Effective 1-1-65

All distances must be from the outer boundaries of the Section.

Operator PHILLIPS PETROLEUM COMPANY			Lease EVGSA Unit 2622		Well No. 002
Unit Letter G	Section 26	Township 17 South	Range 35 East	County Lea	
Actual Footage Location of Well: 1330 feet from the east line and 1430 feet from the north line					
Ground Level Elev. 3905.1	Producing Formation Grayburg/San Andres		Pool Vacuum Gb/San Andres		Dedicated Acreage: 40 Acres

1. Outline the acreage dedicated to the subject well by colored pencil or hatchure marks on the plat below.
2. If more than one lease is dedicated to the well, outline each and identify the ownership thereof (both as to working interest and royalty).
3. If more than one lease of different ownership is dedicated to the well, have the interests of all owners been consolidated by communitization, unitization, force-pooling, etc?

☐ Yes ☐ No If answer is "yes," type of consolidation _____

If answer is "no," list the owners and tract descriptions which have actually been consolidated. (Use reverse side of this form if necessary.) _____

No allowable will be assigned to the well until all interests have been consolidated (by communitization, unitization, forced-pooling, or otherwise) or until a non-standard unit, eliminating such interests, has been approved by the Commission.

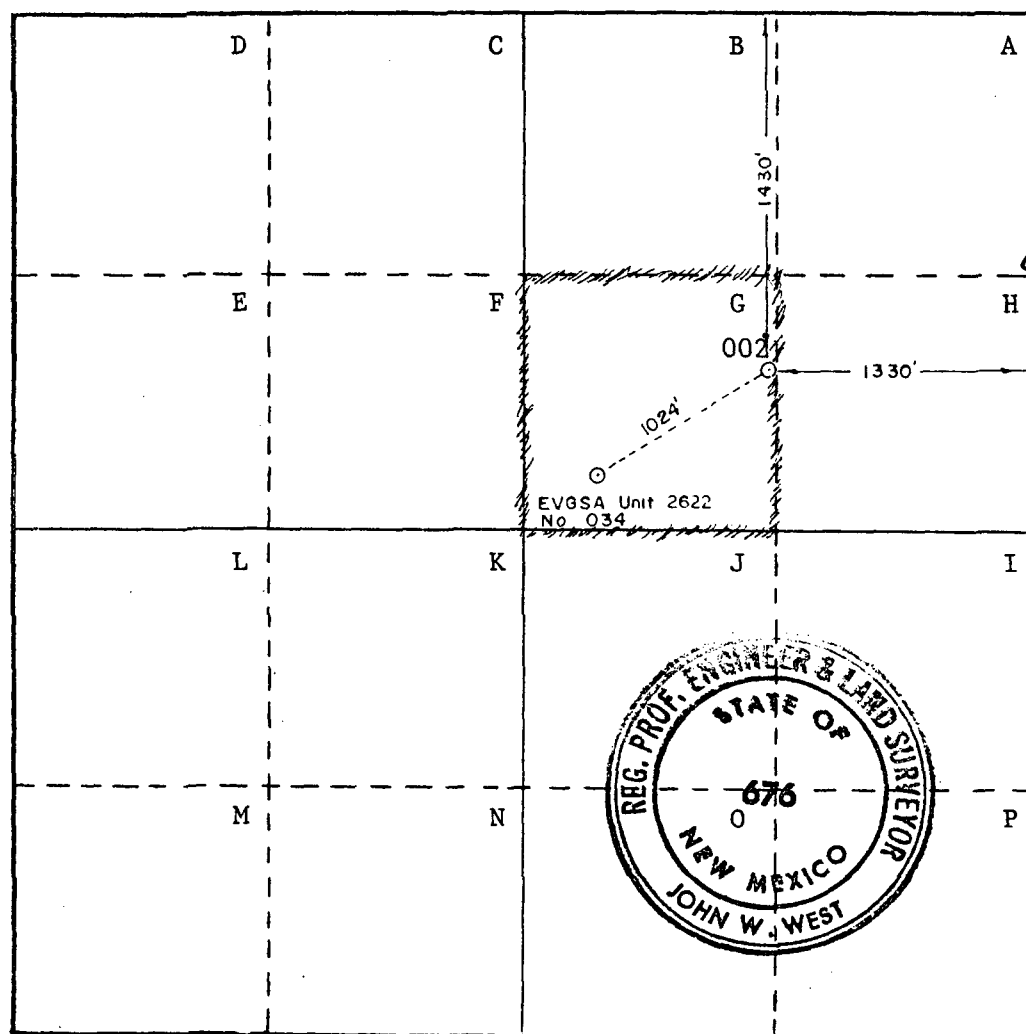

CERTIFICATION

I hereby certify that the information contained herein is true and complete to the best of my knowledge and belief.

Name

W. J. Mueller

Position

Senior Engineering Specialist

Company

Phillips Petroleum Company

Date

November 16, 1979

I hereby certify that the well location shown on this plat was plotted from field notes of actual surveys made by me or under my supervision, and that the same is true and correct to the best of my knowledge and belief.

Date Surveyed

Oct. 10, 1979

Registered Professional Engineer and/or Land Surveyor

Certificate No.

**JOHN W. WEST 676
PATRICK A. ROMERO 6883
Ronald J. Eidson 3239**



**NEW MEXICO OIL CONSERVATION COMMISSION
WELL LOCATION AND ACREAGE DEDICATION PLAT**

Form C-102
Supersedes C-128
Effective 1-1-65

All distances must be from the outer boundaries of the Section.

Operator PHILLIPS PETROLEUM COMPANY			Lease EVGSA Unit 2819		Well No. 004
Unit Letter G	Section 28	Township 17 South	Range 35 East	County Lea	
Actual Footage Location of Well: 1330 feet from the east line and 1330 feet from the north line					
Ground Level Elev. 3950.1	Producing Formation Grayburg/San Andres		Pool Vacuum Gb/San Andres		Dedicated Acreage: 40 Acres

- (Unprepared)
- Outline the acreage dedicated to the subject well by colored pencil or hachure marks on the plat below.
 - If more than one lease is dedicated to the well, outline each and identify the ownership thereof (both as to working interest and royalty).
 - If more than one lease of different ownership is dedicated to the well, have the interests of all owners been consolidated by communitization, unitization, force-pooling, etc?

☐ Yes ☐ No If answer is "yes," type of consolidation _____

If answer is "no," list the owners and tract descriptions which have actually been consolidated. (Use reverse side of this form if necessary.) _____

No allowable will be assigned to the well until all interests have been consolidated (by communitization, unitization, forced-pooling, or otherwise) or until a non-standard unit, eliminating such interests, has been approved by the Commission.

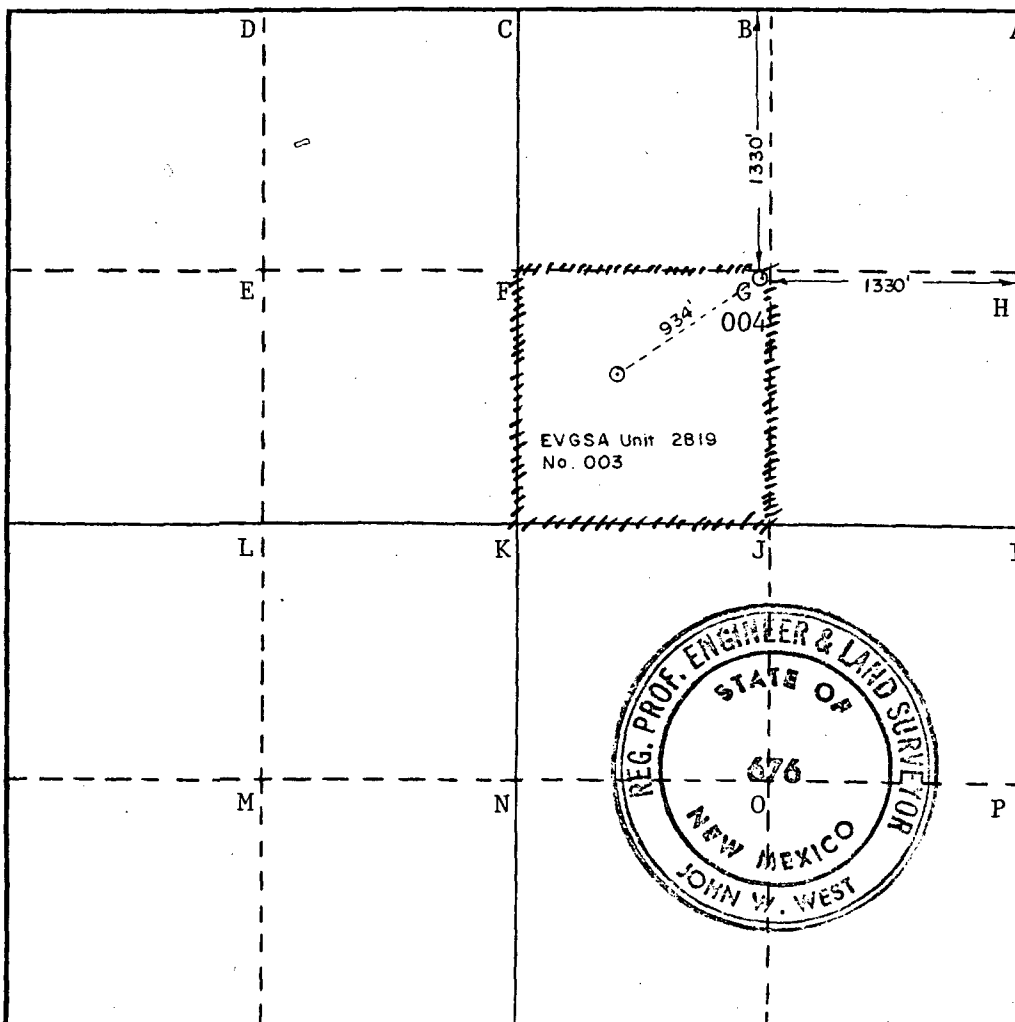

CERTIFICATION

I hereby certify that the information contained herein is true and complete to the best of my knowledge and belief.

Name *W. J. Mueller*
Position
Senior Engrg. Specialist
Company
Phillips Petroleum Company

Date
November 16, 1979

I hereby certify that the well location shown on this plat was plotted from field notes of actual surveys made by me or under my supervision, and that the same is true and correct to the best of my knowledge and belief.

Date Surveyed
Oct. 15, 1979

Registered Professional Engineer and/or Land Surveyor

John W. West
Certificate No. **JOHN W. WEST 676**
PATRICK A. ROMERO 6465
Ronald J. Eidson 3239

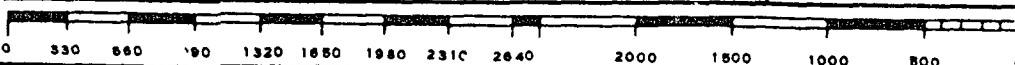

**NEW MEXICO OIL CONSERVATION COMMISSION
WELL LOCATION AND ACREAGE DEDICATION PLAT**

Form C-102
Supersedes C-128
Effective 1-1-65

All distances must be from the outer boundaries of the Section.

Operator PHILLIPS PETROLEUM COMPANY			Lease EVGSA Unit 2271		Well No. 003
Unit Letter 0	Section 22	Township 17 South	Range 35 East	County Lea	
Actual Footage Location of Well: 1330 feet from the east line and 10 feet from the south line					
Ground Level Elev. 3935.4	Producing Formation Grayburg/San Andres		Pool Vacuum Grayburg/San Andres		Dedicated Acreage: 40 Acres

(Unprepared)

1. Outline the acreage dedicated to the subject well by colored pencil or hachure marks on the plat below.
2. If more than one lease is dedicated to the well, outline each and identify the ownership thereof (both as to working interest and royalty).
3. If more than one lease of different ownership is dedicated to the well, have the interests of all owners been consolidated by communitization, unitization, force-pooling, etc?

☐ Yes ☐ No If answer is "yes," type of consolidation _____

If answer is "no," list the owners and tract descriptions which have actually been consolidated. (Use reverse side of this form if necessary.) _____

No allowable will be assigned to the well until all interests have been consolidated (by communitization, unitization, forced-pooling, or otherwise) or until a non-standard unit, eliminating such interests, has been approved by the Commission.

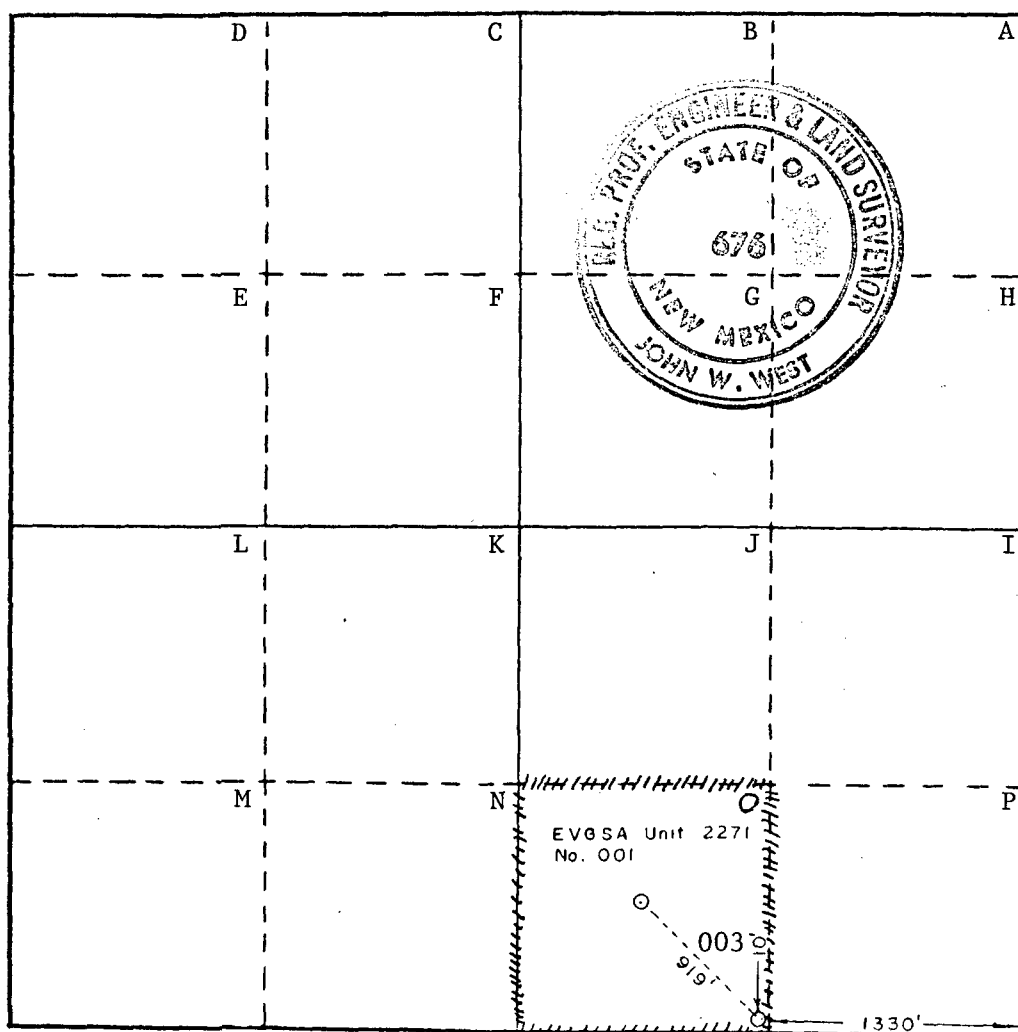

CERTIFICATION

I hereby certify that the information contained herein is true and complete to the best of my knowledge and belief.

Name
W. J. Mueller
Position
Senior Engineering Specialist
Company
Phillips Petroleum Company
Date
November 16, 1979

I hereby certify that the well location shown on this plat was plotted from field notes of actual surveys made by me or under my supervision, and that the same is true and correct to the best of my knowledge and belief.

Date Surveyed
Oct. 22, 1979
Registered Professional Engineer and/or Land Surveyor

Certificate No. **JOHN W. WEST 676**
PATRICK A. ROMERO 6862
Ronald J. Eidson 3239

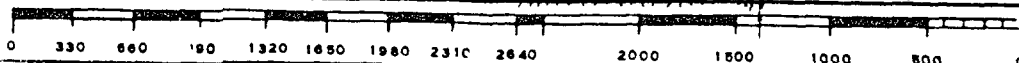

**NEW MEXICO OIL CONSERVATION COMMISSION
WELL LOCATION AND ACREAGE DEDICATION PLAT**

Form C-102
Supersedes C-128
Effective 1-1-65

All distances must be from the outer boundaries of the Section.

Operator PHILLIPS PETROLEUM COMPANY			Lease EVGSA Unit 2864		Well No. 002
Unit Letter C	Section 28	Township 17 South	Range 35 East	County Lea	
Actual Footage Location of Well: 1360 feet from the west line and 10 feet from the north line					
Ground Level Elev. 3966.3	Producing Formation Grayburg/San Andres	Pool Vacuum Gb/San Andres		Dedicated Acreage: 40 Acres	

1. Outline the acreage dedicated to the subject well by colored pencil or hachure marks on the plat below.
2. If more than one lease is dedicated to the well, outline each and identify the ownership thereof (both as to working interest and royalty).
3. If more than one lease of different ownership is dedicated to the well, have the interests of all owners been consolidated by communitization, unitization, force-pooling, etc?

☐ Yes ☐ No If answer is "yes," type of consolidation _____

If answer is "no," list the owners and tract descriptions which have actually been consolidated. (Use reverse side of this form if necessary.) _____

No allowable will be assigned to the well until all interests have been consolidated (by communitization, unitization, forced-pooling, or otherwise) or until a non-standard unit, eliminating such interests, has been approved by the Commission.

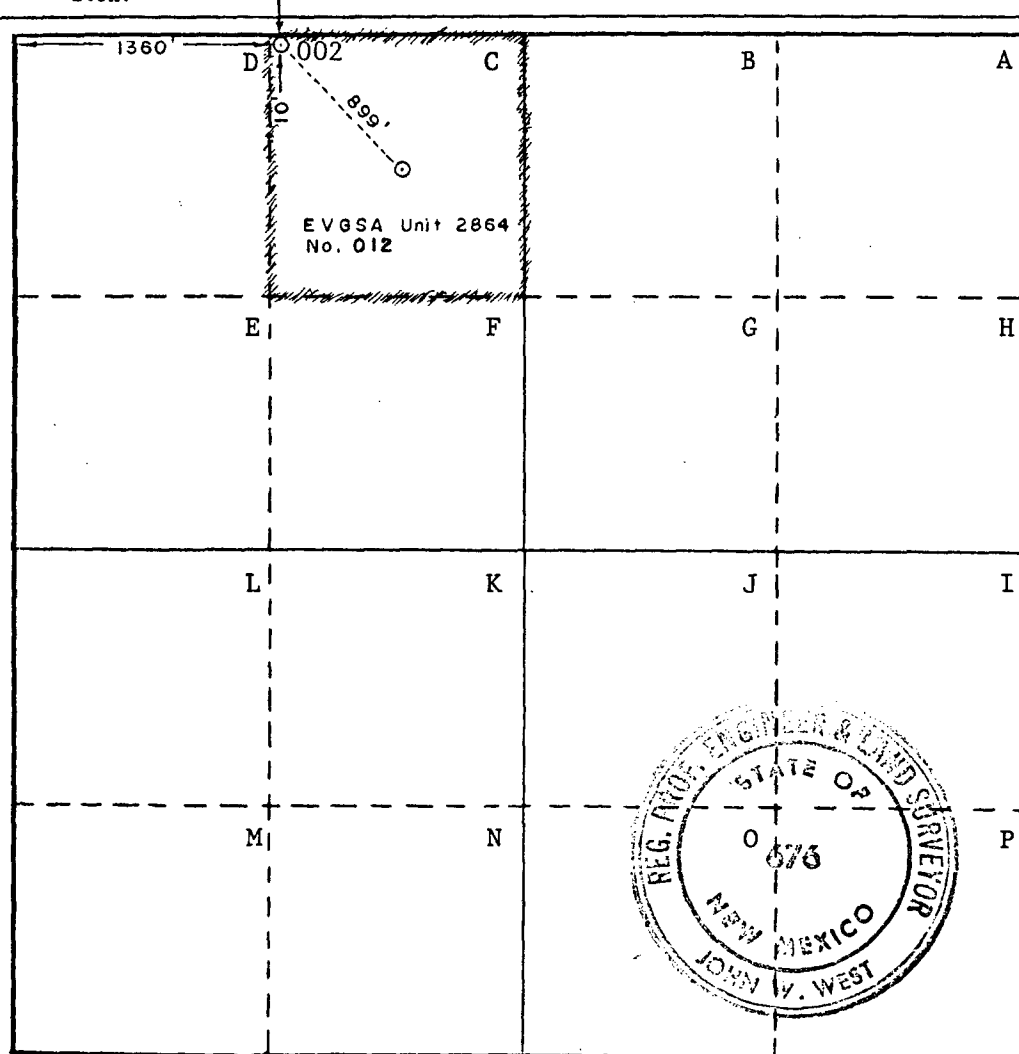

CERTIFICATION

I hereby certify that the information contained herein is true and complete to the best of my knowledge and belief.

Name

W. J. Mueller

Position

Senior Engrg. Specialist

Company

Phillips Petroleum Company

Date

November 16, 1979

I hereby certify that the well location shown on this plat was plotted from field notes of actual surveys made by me or under my supervision, and that the same is true and correct to the best of my knowledge and belief.

Date Surveyed

Oct. 11, 1979

Registered Professional Engineer and/or Land Surveyor

Certificate No. **JOHN W. WEST 676**
PATRICK A. ROMERO 6653
Ronald J. Eidson 3239

0 500 1000 1500 2000 2500 3000 3500 4000 4500 5000

**NEW MEXICO OIL CONSERVATION COMMISSION
WELL LOCATION AND ACREAGE DEDICATION PLAT**

Form C-102
Supersedes C-128
Effective 1-1-65

All distances must be from the outer boundaries of the Section.

Operator PHILLIPS PETROLEUM COMPANY			Lease EVGSA Unit 2150		Well No. 001
Unit Letter P	Section 21	Township 17 South	Range 35 East	County Lea	
Actual Footage Location of Well: 1310 feet from the east line and 10 feet from the south line					
Ground Level Elev. 3953.0	Producing Formation Grayburg/San Andres	Pool Vacuum Grayburg/San Andres		Dedicated Acreage: 40 Acres	

- (Unprepared)
1. Outline the acreage dedicated to the subject well by colored pencil or hachure marks on the plat below.
 2. If more than one lease is dedicated to the well, outline each and identify the ownership thereof (both as to working interest and royalty).
 3. If more than one lease of different ownership is dedicated to the well, have the interests of all owners been consolidated by communitization, unitization, force-pooling, etc?

☐ Yes ☐ No If answer is "yes," type of consolidation _____

If answer is "no," list the owners and tract descriptions which have actually been consolidated. (Use reverse side of this form if necessary.) _____

No allowable will be assigned to the well until all interests have been consolidated (by communitization, unitization, forced-pooling, or otherwise) or until a non-standard unit, eliminating such interests, has been approved by the Commission.

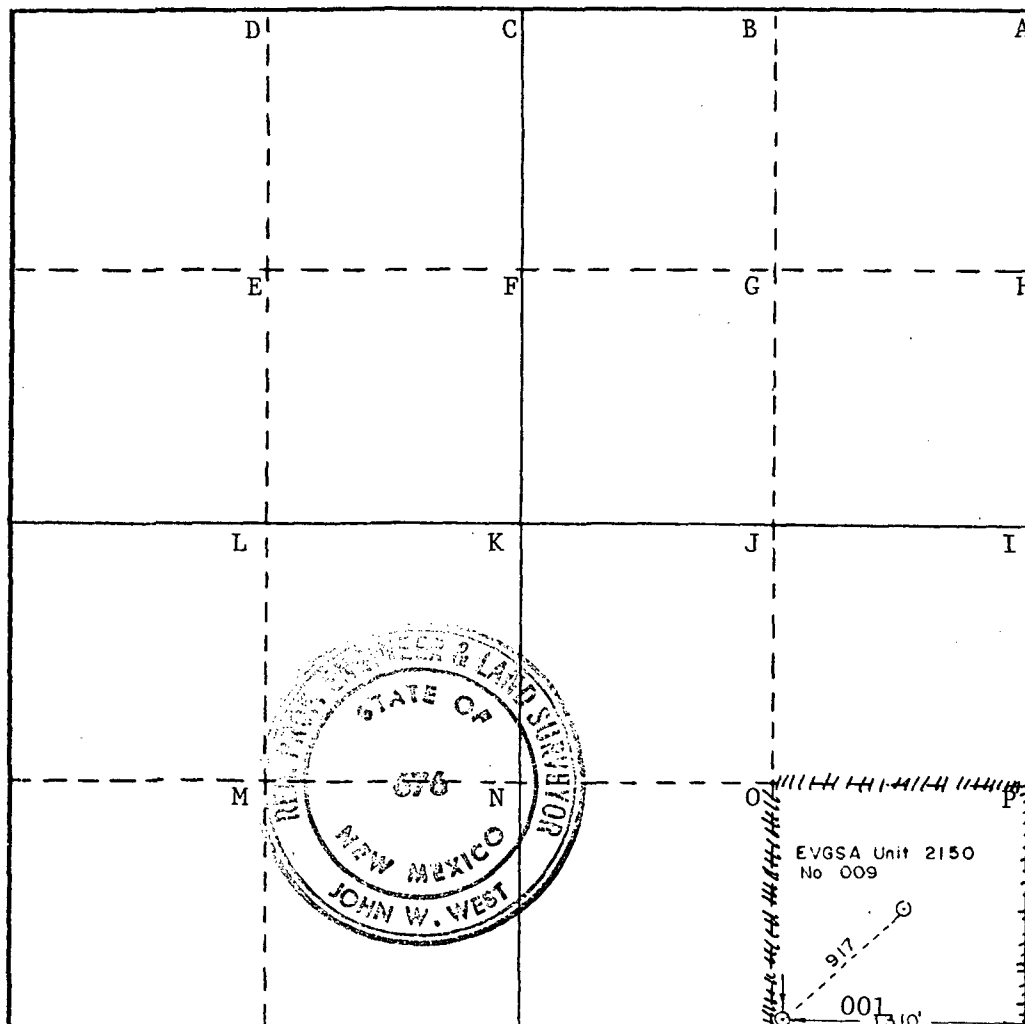

CERTIFICATION

I hereby certify that the information contained herein is true and complete to the best of my knowledge and belief.

[Signature]
Name

W. J. Mueller

Position

Senior Engineering Specialist

Company

Phillips Petroleum Company

Date

November 16, 1979

I hereby certify that the well location shown on this plat was plotted from field notes of actual surveys made by me or under my supervision, and that the same is true and correct to the best of my knowledge and belief.

Date Surveyed

Oct. 22, 1979

Registered Professional Engineer and/or Land Surveyor

[Signature]

Certificate No. **JOHN W. WEST 676**
PATRICK A. ROMERO 6883
Ronald J. Eidson 3233

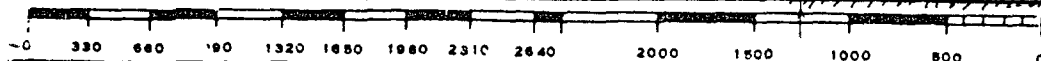

**NEW MEXICO OIL CONSERVATION COMMISSION
WELL LOCATION AND ACREAGE DEDICATION PLAT**

Form C-102
Supersedes C-128
Effective 1-1-65

All distances must be from the outer boundaries of the Section.

Operator PHILLIPS PETROLEUM COMPANY			Lease EVGSA Unit 2230		Well No. 003
Unit Letter M	Section 22	Township 17 South	Range 35 East	County Lea	
Actual Footage Location of Well: 1310 feet from the west line and 1310 feet from the south line					
Ground Level Elev. 3947.0	Producing Formation Grayburg/San Andres		Pool Vacuum Gb/San Andres		Dedicated Acreage: 40 Acres

- (Unprepared)
1. Outline the acreage dedicated to the subject well by colored pencil or hachure marks on the plat below.
 2. If more than one lease is dedicated to the well, outline each and identify the ownership thereof (both as to working interest and royalty).
 3. If more than one lease of different ownership is dedicated to the well, have the interests of all owners been consolidated by communitization, unitization, force-pooling, etc?

☐ Yes ☐ No If answer is "yes," type of consolidation _____

If answer is "no," list the owners and tract descriptions which have actually been consolidated. (Use reverse side of this form if necessary.) _____

No allowable will be assigned to the well until all interests have been consolidated (by communitization, unitization, forced-pooling, or otherwise) or until a non-standard unit, eliminating such interests, has been approved by the Commission.

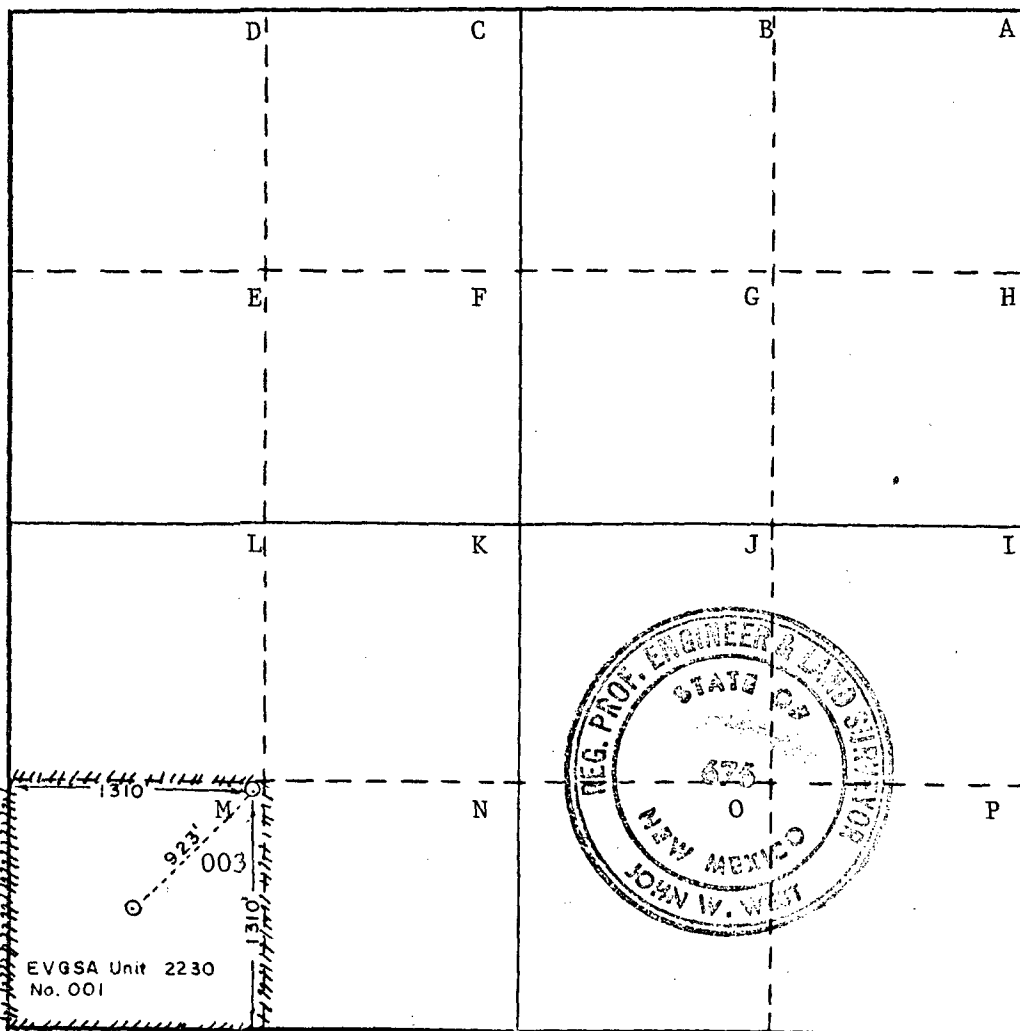

CERTIFICATION

I hereby certify that the information contained herein is true and complete to the best of my knowledge and belief.

[Signature]
Name

W. J. Mueller

Position

Senior Engineering Specialist

Company

Phillips Petroleum Company

Date

November 16, 1979

I hereby certify that the well location shown on this plat was plotted from field notes of actual surveys made by me or under my supervision, and that the same is true and correct to the best of my knowledge and belief.

Date Surveyed

Oct. 17, 1979

Registered Professional Engineer and/or Land Surveyor

[Signature]

Certificate No. **JOHN W. WEST 678**
PATRICK A. ROMERO 6663
Ronald J. Eidson 3239

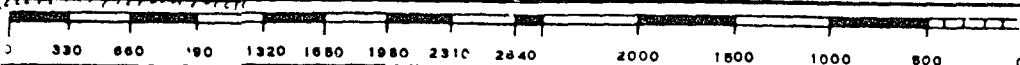

**NEW MEXICO OIL CONSERVATION COMMISSION
WELL LOCATION AND ACREAGE DEDICATION PLAT**

Form C-102
Supersedes C-128
Effective 1-1-65

All distances must be from the outer boundaries of the Section.

Operator PHILLIPS PETROLEUM COMPANY			Lease EVGSA Unit 2980		Well No. 002
Unit Letter F	Section 29	Township 17 South	Range 35 East	County Lea	
Actual Footage Location of Well: 1330 feet from the west line and 1330 feet from the north line					
Ground Level Elev. 3968.6	Producing Formation Grayburg/San Andres		Pool Vacuum Grayburg/San Andres	Dedicated Acreage: 40 Acres	

1. Outline the acreage dedicated to the subject well by colored pencil or hachure marks on the plat below.
2. If more than one lease is dedicated to the well, outline each and identify the ownership thereof (both as to working interest and royalty).
3. If more than one lease of different ownership is dedicated to the well, have the interests of all owners been consolidated by communitization, unitization, force-pooling, etc?

☐ Yes ☐ No If answer is "yes," type of consolidation _____

If answer is "no," list the owners and tract descriptions which have actually been consolidated. (Use reverse side of this form if necessary.) _____

No allowable will be assigned to the well until all interests have been consolidated (by communitization, unitization, forced-pooling, or otherwise) or until a non-standard unit, eliminating such interests, has been approved by the Commission.

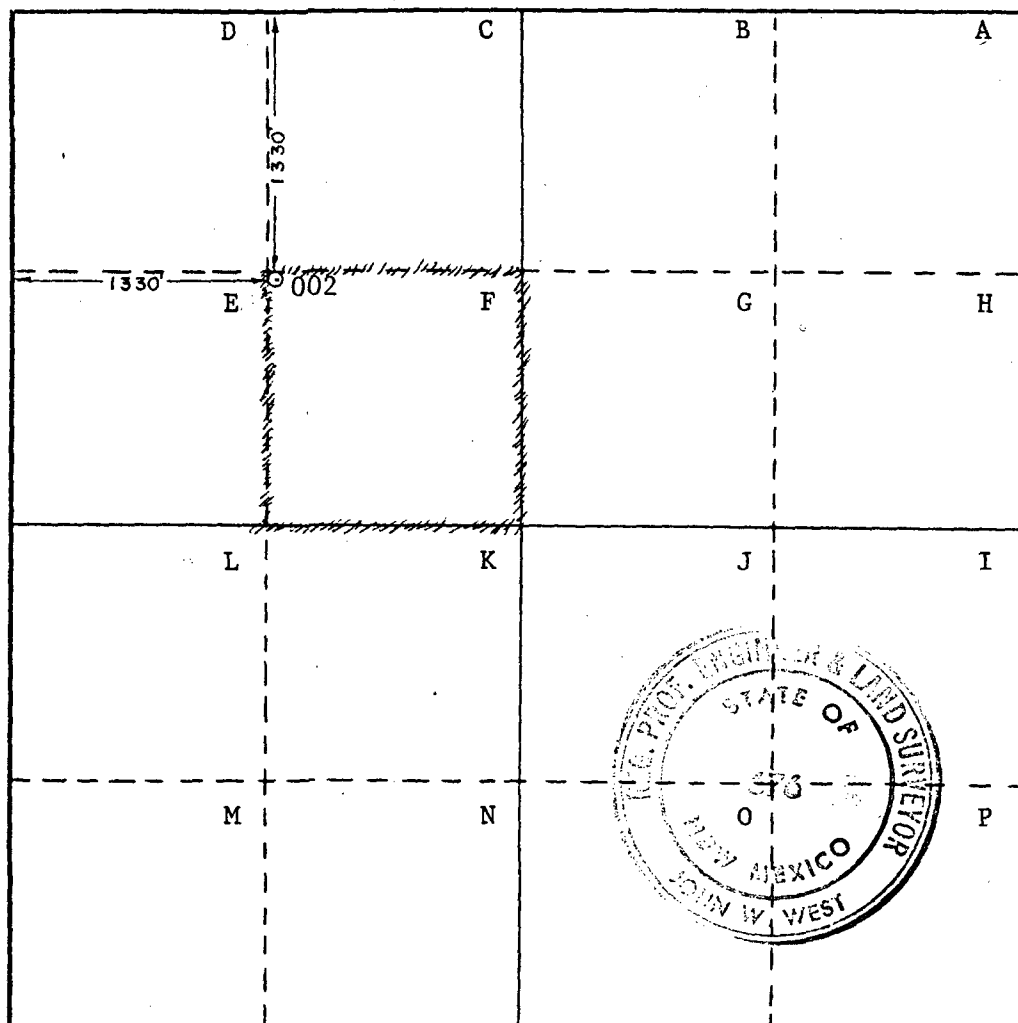

CERTIFICATION

I hereby certify that the information contained herein is true and complete to the best of my knowledge and belief.

[Signature]
Name

W. J. Mueller

Position

Senior Engineering Specialist

Company

Phillips Petroleum Company

Date

November 16, 1979

I hereby certify that the well location shown on this plat was plotted from field notes of actual surveys made by me or under my supervision, and that the same is true and correct to the best of my knowledge and belief.

Date Surveyed

Oct. 11, 1979

Registered Professional Engineer and/or Land Surveyor

[Signature]

Certificate No. **JOHN W. WEST 676**
PATRICK A. ROMERO 6663
Ronald J. Eidson 3239

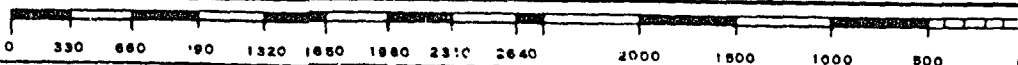

**NEW MEXICO OIL CONSERVATION COMMISSION
WELL LOCATION AND ACREAGE DEDICATION PLAT**

Form C-102
Supersedes C-128
Effective 1-1-65

All distances must be from the outer boundaries of the Section.

Operator PHILLIPS PETROLEUM COMPANY			Lease EVGSA Unit 2923		Well No. 001
Unit Letter G	Section 29	Township 17 South	Range 35 East	County Lea	
Actual Footage Location of Well: 1410 feet from the east line and 1330 feet from the north line					
Ground Level Elev. 3963.6	Producing Formation Grayburg/San Andres		Pool Vacuum Gb/San Andres		Dedicated Acreage: 40 Acres

- (Unprepared)
- Outline the acreage dedicated to the subject well by colored pencil or hachure marks on the plat below.
 - If more than one lease is dedicated to the well, outline each and identify the ownership thereof (both as to working interest and royalty).
 - If more than one lease of different ownership is dedicated to the well, have the interests of all owners been consolidated by communitization, unitization, force-pooling, etc?

☐ Yes ☐ No If answer is "yes," type of consolidation _____

If answer is "no," list the owners and tract descriptions which have actually been consolidated. (Use reverse side of this form if necessary.) _____

No allowable will be assigned to the well until all interests have been consolidated (by communitization, unitization, forced-pooling, or otherwise) or until a non-standard unit, eliminating such interests, has been approved by the Commission.

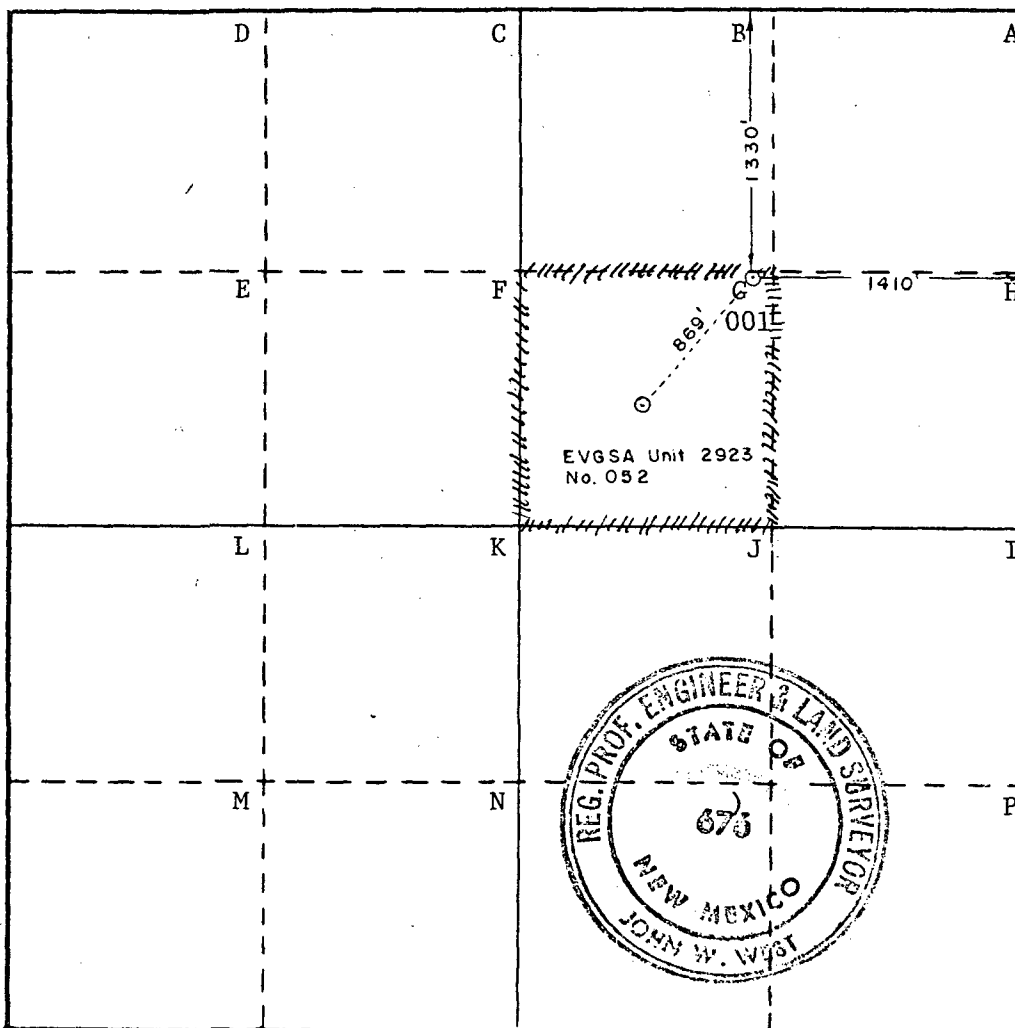

CERTIFICATION

I hereby certify that the information contained herein is true and complete to the best of my knowledge and belief.

Name W. J. Mueller
 Position Senior Engineering Specialist
 Company Phillips Petroleum Company
 Date November 16, 1979

I hereby certify that the well location shown on this plat was plotted from field notes of actual surveys made by me or under my supervision, and that the same is true and correct to the best of my knowledge and belief.

Date Surveyed Oct. 11, 1979
 Registered Professional Engineer and/or Land Surveyor

Certificate No. JOHN W. WEST 673
PATRICK A. ROMERO 6848
Ronald J. Eidson 3239

**NEW MEXICO OIL CONSERVATION COMMISSION
WELL LOCATION AND ACREAGE DEDICATION PLAT**

Form C-102
Supersedes C-128
Effective 1-1-65

All distances must be from the outer boundaries of the Section.

Operator PHILLIPS PETROLEUM COMPANY			Lease EVGSA Unit 2944		Well No. 001
Unit Letter B	Section 29	Township 17 South	Range 35 East	County Lea	
Actual Footage Location of Well: 1330 feet from the east line and 10 feet from the north line					
Ground Level Elev. 3963.4	Producing Formation Grayburg/San Andres		Pool Vacuum Grayburg/San Andres	Dedicated Acreage: 40 Acres	

1. Outline ^(Unprepared) the acreage dedicated to the subject well by colored pencil or hatchure marks on the plat below.
2. If more than one lease is dedicated to the well, outline each and identify the ownership thereof (both as to working interest and royalty).
3. If more than one lease of different ownership is dedicated to the well, have the interests of all owners been consolidated by communitization, unitization, force-pooling, etc?

☐ Yes ☐ No If answer is "yes," type of consolidation _____

If answer is "no," list the owners and tract descriptions which have actually been consolidated. (Use reverse side of this form if necessary.) _____

No allowable will be assigned to the well until all interests have been consolidated (by communitization, unitization, forced-pooling, or otherwise) or until a non-standard unit, eliminating such interests, has been approved by the Commission.

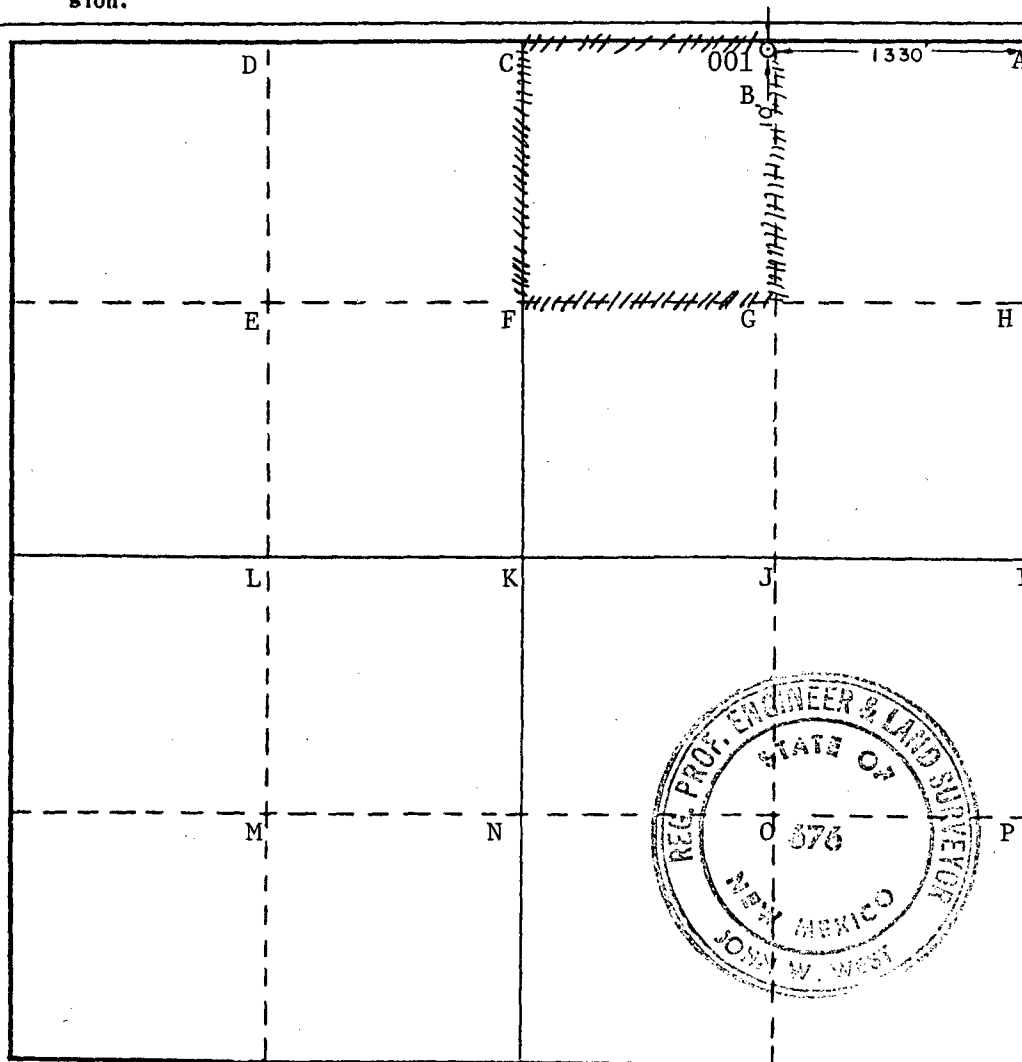

CERTIFICATION

I hereby certify that the information contained herein is true and complete to the best of my knowledge and belief.

[Signature]
Name

W. J. Mueller

Position

Senior Engineering Specialist

Company

Phillips Petroleum Company

Date

November 16, 1979

I hereby certify that the well location shown on this plat was plotted from field notes of actual surveys made by me or under my supervision, and that the same is true and correct to the best of my knowledge and belief.

Date Surveyed

Oct. 11, 1979

Registered Professional Engineer and/or Land Surveyor

[Signature]

Certificate No. **JOHN W. WEST 676**
PATRICK A. ROMERO 6863
Ronald J. Eidson 3239

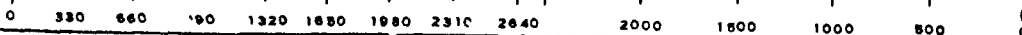

**NEW MEXICO OIL CONSERVATION COMMISSION
WELL LOCATION AND ACREAGE DEDICATION PLAT**

Form C-102
Supersedes C-128
Effective 1-1-65

All distances must be from the outer boundaries of the Section.

Operator PHILLIPS PETROLEUM COMPANY			Lease EVGSA Unit-2923		Well No. 002
Unit Letter C	Section 29	Township 17 South	Range 35 East	County Lea	
Actual Footage Location of Well: 1330 feet from the west line and 60 feet from the north line					
Ground Level Elev. 3970.7	Producing Formation Grayburg/San Andres		Pool Vacuum Grayburg/San Andres	Dedicated Acreage: 40 Acres	

- (Unprepared)
1. Outline the acreage dedicated to the subject well by colored pencil or hachure marks on the plat below.
 2. If more than one lease is dedicated to the well, outline each and identify the ownership thereof (both as to working interest and royalty).
 3. If more than one lease of different ownership is dedicated to the well, have the interests of all owners been consolidated by communitization, unitization, force-pooling, etc?

☐ Yes ☐ No If answer is "yes," type of consolidation _____

If answer is "no," list the owners and tract descriptions which have actually been consolidated. (Use reverse side of this form if necessary.) _____

No allowable will be assigned to the well until all interests have been consolidated (by communitization, unitization, forced-pooling, or otherwise) or until a non-standard unit, eliminating such interests, has been approved by the Commission.

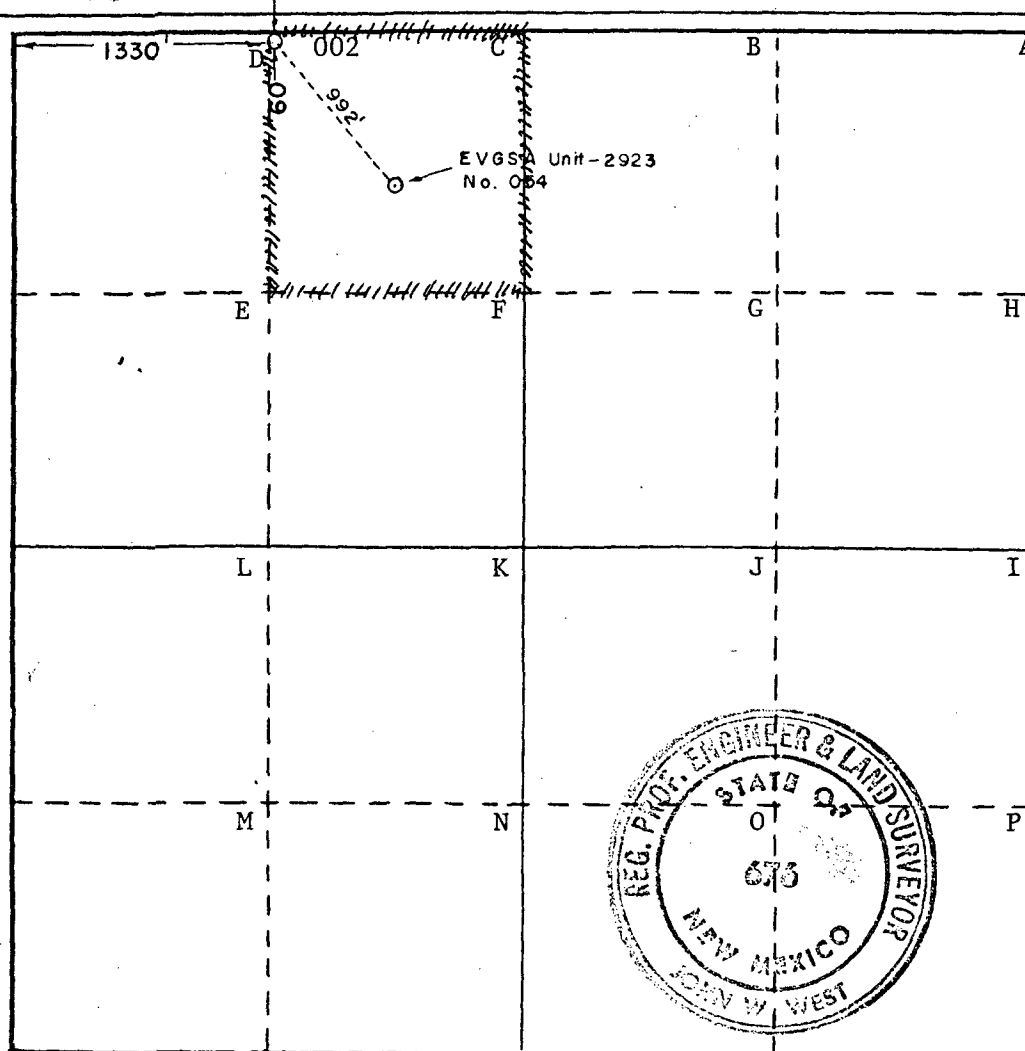

CERTIFICATION

I hereby certify that the information contained herein is true and complete to the best of my knowledge and belief.

[Signature]
Name

W. J. Mueller

Position

Senior Engrg. Specialist

Company

Phillips Petroleum Company

Date

November 16, 1979

I hereby certify that the well location shown on this plat was plotted from field notes of actual surveys made by me or under my supervision, and that the same is true and correct to the best of my knowledge and belief.

Date Surveyed

Oct. 10, 1979

Registered Professional Engineer and/or Land Surveyor

[Signature]

Certificate No. **JOHN W. WEST 673**
PATRICK A. ROMERO 6863
Ronald J. Eidson 3239

**NEW MEXICO OIL CONSERVATION COMMISSION
WELL LOCATION AND ACREAGE DEDICATION PLAT**

Form C-102
Supersedes C-128
Effective 1-1-65

All distances must be from the outer boundaries of the Section.

Operator PHILLIPS PETROLEUM COMPANY			Lease EVGSA Unit 2059		Well No. 003
Unit Letter F	Section 20	Township 17 South	Range 35 East	County Lea	
Actual Footage Location of Well: 1330 feet from the west line and 2630 feet from the north line					
Ground Level Elev. 3975.5	Producing Formation Grayburg/San Andres		Pool Vacuum Gb/San Andres		Dedicated Acreage: 40 Acres

1. Outline the acreage dedicated to the subject well by colored pencil or hachure marks on the plat below.
2. If more than one lease is dedicated to the well, outline each and identify the ownership thereof (both as to working interest and royalty).
3. If more than one lease of different ownership is dedicated to the well, have the interests of all owners been consolidated by communitization, unitization, force-pooling, etc?

☐ Yes ☐ No If answer is "yes," type of consolidation _____

If answer is "no," list the owners and tract descriptions which have actually been consolidated. (Use reverse side of this form if necessary.) _____

No allowable will be assigned to the well until all interests have been consolidated (by communitization, unitization, forced-pooling, or otherwise) or until a non-standard unit, eliminating such interests, has been approved by the Commission.

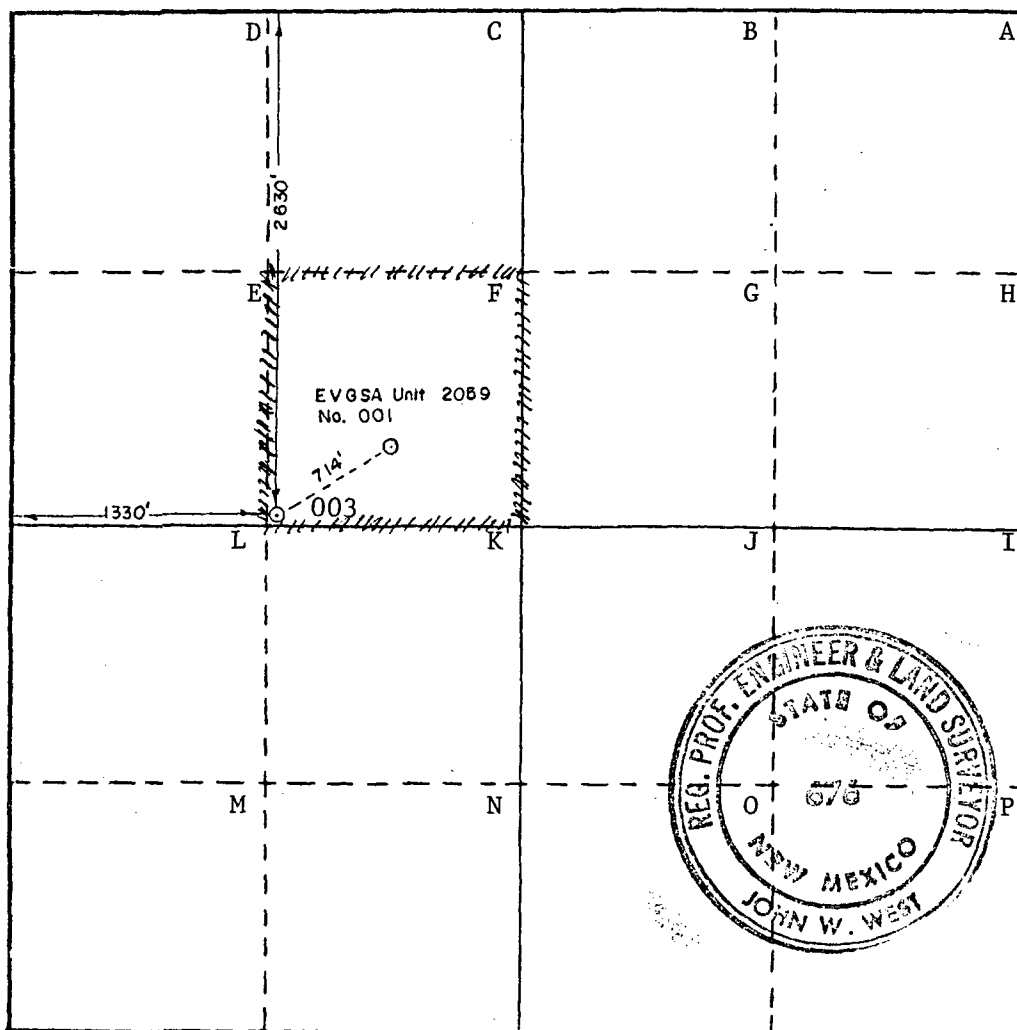

CERTIFICATION

I hereby certify that the information contained herein is true and complete to the best of my knowledge and belief.

[Signature]
Name

W. J. Mueller

Position

Senior Engineering Specialist

Company

Phillips Petroleum Company

Date

November 16, 1979

I hereby certify that the well location shown on this plat was plotted from field notes of actual surveys made by me or under my supervision, and that the same is true and correct to the best of my knowledge and belief.

Date Surveyed

Oct. 22, 1979

Registered Professional Engineer and/or Land Surveyor

[Signature]

Certificate No. **JOHN W. WEST 676**
PATRICK A. ROMERO 6668
Ronald J. Eldson 3239

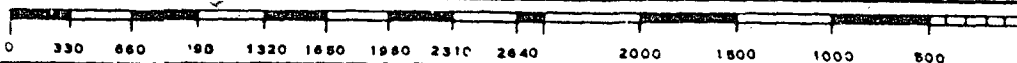

**NEW MEXICO OIL CONSERVATION COMMISSION
WELL LOCATION AND ACREAGE DEDICATION PLAT**

Form C-102
Supersedes C-128
Effective 1-1-65

All distances must be from the outer boundaries of the Section.

Operator PHILLIPS PETROLEUM COMPANY			Lease EVGSA Unit 1910		Well No. 003
Unit Letter J	Section 19	Township 17 South	Range 35 East	County Lea	
Actual Footage Location of Well: <div style="display: flex; justify-content: space-between;"> 1330 feet from the east line and 2630 feet from the south line </div>					
Ground Level Elev. 3983.6	Producing Formation Grayburg/San Andres	Pool Vacuum Gb/San Andres	Dedicated Acreage: 40 Acres		

- (Unprepared)
- Outline the acreage dedicated to the subject well by colored pencil or hachure marks on the plat below.
 - If more than one lease is dedicated to the well, outline each and identify the ownership thereof (both as to working interest and royalty).
 - If more than one lease of different ownership is dedicated to the well, have the interests of all owners been consolidated by communitization, unitization, force-pooling, etc?

☐ Yes ☐ No If answer is "yes," type of consolidation _____

If answer is "no," list the owners and tract descriptions which have actually been consolidated. (Use reverse side of this form if necessary.) _____

No allowable will be assigned to the well until all interests have been consolidated (by communitization, unitization, forced-pooling, or otherwise) or until a non-standard unit, eliminating such interests, has been approved by the Commission.

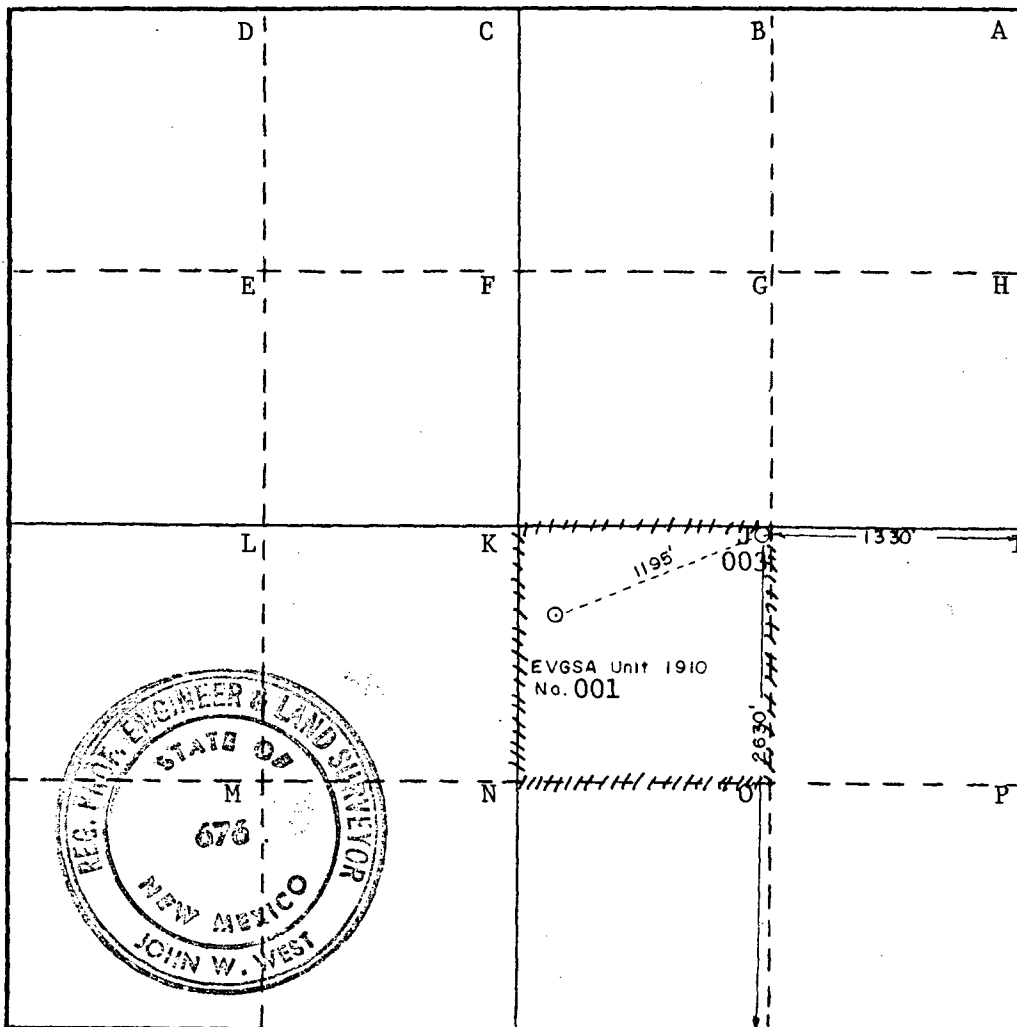

CERTIFICATION

I hereby certify that the information contained herein is true and complete to the best of my knowledge and belief.

Name

W. J. Mueller

Position

Senior Engineering Specialist

Company

Phillips Petroleum Company

Date

November 16, 1979

I hereby certify that the well location shown on this plat was plotted from field notes of actual surveys made by me or under my supervision, and that the same is true and correct to the best of my knowledge and belief.

Date Surveyed

Oct. 22, 1979

Registered Professional Engineer and/or Land Surveyor

John W. West

Certificate No. **JOHN W. WEST 676**
PATRICK A. ROMERO 6868
Ronald J. Eidson 3239

0 330 660 990 1320 1650 1980 2310 2640 2970 3300 3630 3960 4290 4620 4950 5280 5610 5940 6270 6600

R-34-E

R-35-E

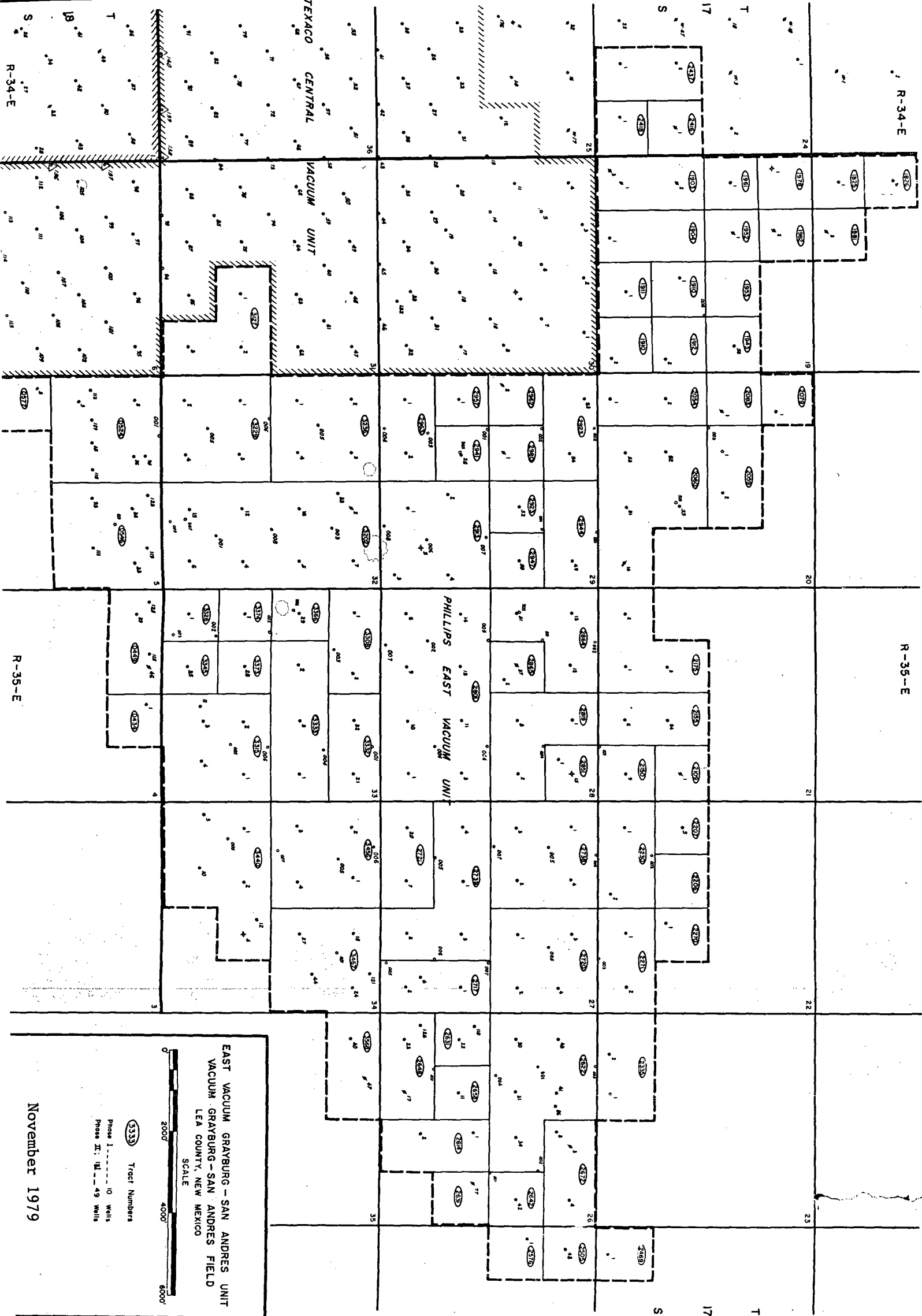

R-34-E

R-35-E

November 1979