

HICKS ENCO, INC.

2313 SANTIAGO PHONE: (505) 325-3950
FARMINGTON, NEW MEXICO 87401

October 11, 1979

NSL - 1118
2 Wells
Immediate
Rule 104 F

New Mexico Oil Conservation Commission
P. O. Box 2088
Santa Fe, New Mexico 87501

RE: Horseshoe Gallup Pool / San Juan
Pressure Maintenance County
Project No.2

Dear Sir:

We request permission to drill two injection wells on the referenced unit to test the feasibility of changing the injection pattern from 80 acre to 40 acre. Also, we must have approval to drill on or near boundaries and legal sub-divisions in order to accomplish our goal. The enclosed copy of a letter from the U.S.G.S. indicates their approval of this pilot test.

This field was drilled on 40 acre spacing and water flooded with 80 acre five spot patterns. We feel this program by-passed economical recoverable oil.

The attached map shows the original 80 acre pattern outlined in blue. The proposed 40 acre pattern is outlined in red. The injection wells would be at the corners of the red squares.

We wish to drill two wells to test our theory. They are Navajo "F" 147, located 5' from North line and 2545' from West line, Section 9 - T31N-R17W and Navajo "F" 148 located 1200' from North line and 1410' from East line, Section 9 - T31N - R13W. They are the red corners with red circles.

2540

- 17-W

We intend to complete these wells initially as producers. After testing to determine oil - water ratios they will be converted to water injection.

The closest offset operator is 2545' West of our Navajo "F" 147. We don't feel notification of offset operators is necessary at this time.

The attached schematic drawing shows the method we will use to complete these proposed injection wells.

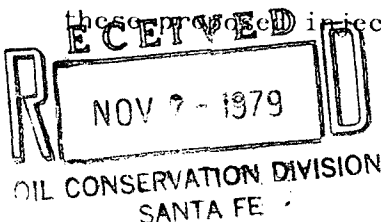

We wish to drill these wells before winter. Your early consideration of this proposal will be appreciated.

Sincerely,

J. D. Hicks
PRESIDENT

JDH/11

Encl.

cc: Al Kendrick

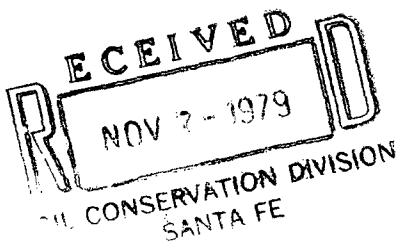

HICKS ENCO, INC.

2313 SANTIAGO PHONE (505) 325-3950
FARMINGTON, NEW MEXICO 87401

November 6, 1979

New Mexico Oil Conservation Commission
P. O. Box 2088
Santa Fe, New Mexico 87501

Gentlemen:

Enclosed is a copy of our letter dated October 11, 1979. Please note the location of the Navajo "F" 148 is 1200' from North line and 1410' from East line - Section 9 - T31N - R17W instead of R13W as stated in our letter.

I am sorry for any inconvenience this may have caused you.

Sincerely,

Laura Ledbetter

11

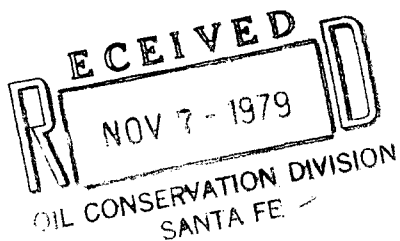



STATE OF NEW MEXICO
ENERGY AND MINERALS DEPARTMENT
OIL CONSERVATION DIVISION

BRUCE KING
GOVERNOR

LARRY KEHOE
SECRETARY

November 26, 1979

POST OFFICE BOX 2088
STATE LAND OFFICE BUILDING
SANTA FE, NEW MEXICO 87501
(505) 827-2434

Hicks Enco, Inc.
2313 Santiago
Farmington, New Mexico 87401

Re: Application for Non-Standard
Location: Navajo F Wells Nos. 147
and 148, Sec. 9, T-31-N, R-17-W,
San Juan County

We may not process the subject application for non-standard location until the required information or plats checked below (is) (are) submitted.

- whowing the project and
- ☒ A plat must be submitted ~~/clearly showing~~ the ownership of the offsetting leases. We could not locate the plat that was reportedly attached to the application.
- ☐ A statement must be submitted that offset owners have been notified of the application by certified mail.
- ☐ A plat must be submitted fully identifying the topography necessitating the non-standard location.
- ☒ Other: Well No. 147 is too close to the quarter-quarter section lines. Wells closer than 10 feet may not be approved.

Very truly yours,

R. L. STAMETS
Technical Support Chief

RLS/dr

HICKS ENCO, INC.

2313 SANTIAGO PHONE: (505) 325-3750
FARMINGTON, NEW MEXICO 87401

November 18, 1979

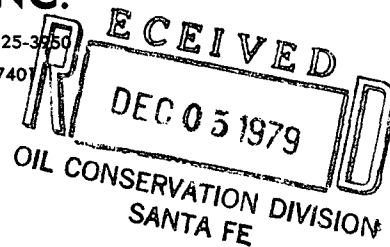

State of New Mexico
Energy and Minerals Department
P. O. Box 2088
Santa Fe, New Mexico 87501

ATTENTION: Mr. R. L. Stamets, Technical Support Chief

RE: Application for non-standard
location: Navajo F Wells #147
& 148, Sec. 9 - T31N - R17W
San Juan County, New Mexico

Dear Sir:

In accordance with your letter of November 26, 1979, we are enclosing the plat you requested.

Also, Well # "F" 147 will be moved from 5' South of North line to 10' South of North line and 2540' East of West line.

If you have other questions, please advise.

Sincerely,

J. D. Hicks
PRESIDENT

JDH:11

Enc.

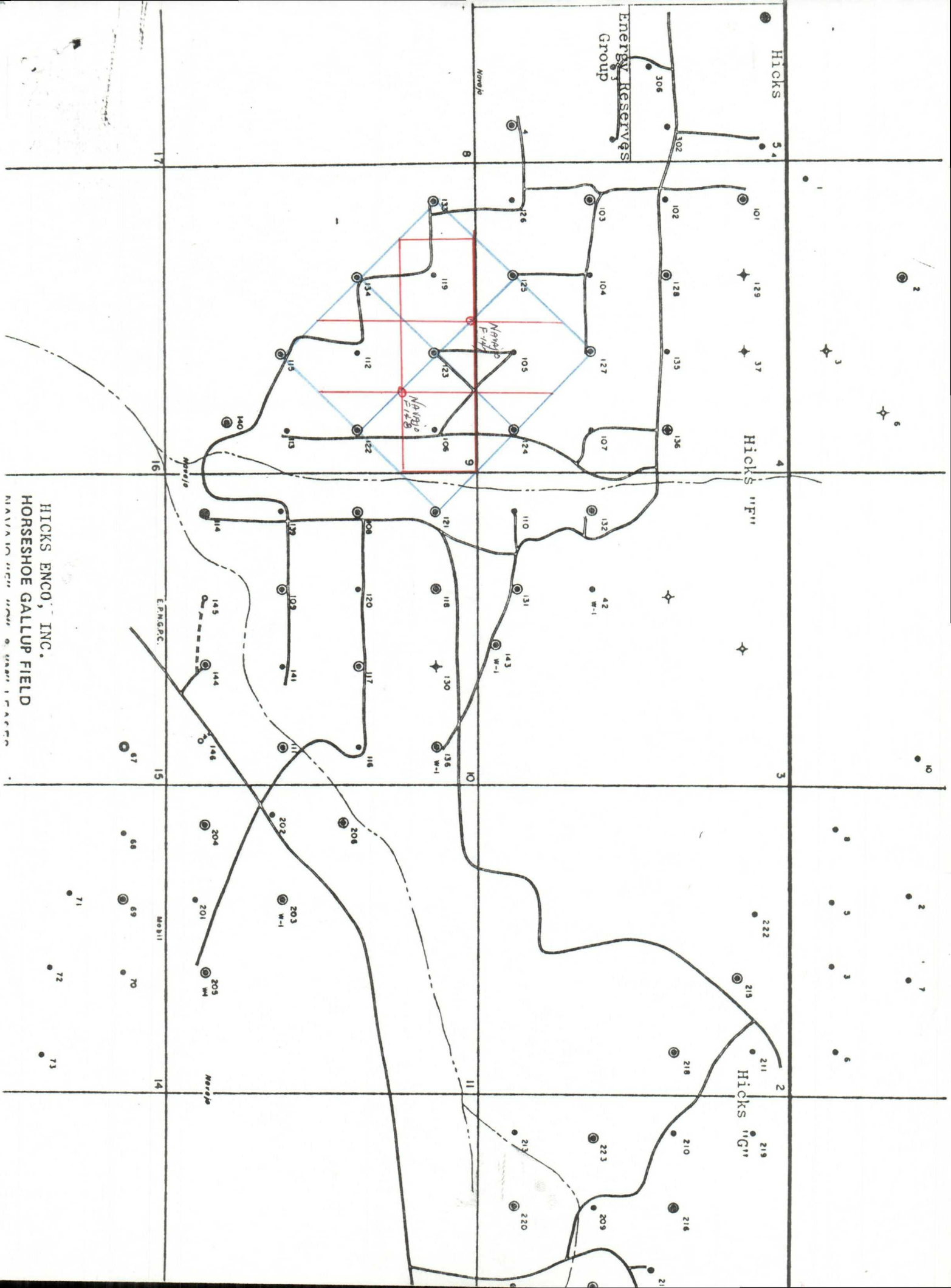

Energy Reserves Group

Hicks

Hicks "F"

Hicks "G"

HICKS ENCO, INC.
HORSESHOE GALLUP FIELD

E.P.M.G.P.C.

Mobil

Horseshoe