

November 27 1979

NSL-1123  
Rule 3 R 1670-V  
12-23-79

Mr. Joe Ramey  
New Mexico Oil Conservation Division  
Post Office Box 2088  
Santa Fe, New Mexico 87501

Dear Mr. Ramey:

This is a request for administrative approval for an unorthodox gas well location in the Basin Dakota pool.

It is intended to locate the El Paso Natural Gas Company's Klein #28 at 2170' from the South line and 1840' from the West line of Section 33, T-26-N, R-6-W, Rio Arriba County, New Mexico.

Extremely rough terrain with cliffs and ledges, an existing pipeline, and the location of an Indian ruin in the southwest corner of this section make the building of an orthodox gas well location impossible.

All operators of proration units offsetting the proposed unorthodox location have been notified of this application by certified mail.

Plats showing the proposed well location and the terrain of Section 33, along with an ownership plat, are attached.

Sincerely,

*L. A. Aimes*

L. A. Aimes  
Project Drilling Engineer

LAA:pb

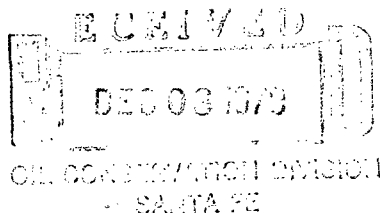

OIL CONSERVATION COMMISSION  
Carter DISTRICT

OIL CONSERVATION COMMISSION  
BOX 2088  
SANTA FE, NEW MEXICO

DATE 11-30-79

RE: Proposed MC \_\_\_\_\_  
Proposed DHC \_\_\_\_\_  
Proposed NSL ✓ \_\_\_\_\_  
Proposed SWD \_\_\_\_\_  
Proposed WFX \_\_\_\_\_  
Proposed PMX \_\_\_\_\_

Gentlemen:

I have examined the application dated 11-27-79  
for the El Paso Natural Gas Co. Klein #28 K-33-26N-6W  
Operator Lease and Well No. Unit, S-T-R

and my recommendations are as follows:

Approve  
\_\_\_\_\_  
\_\_\_\_\_  
\_\_\_\_\_  
\_\_\_\_\_  
\_\_\_\_\_

Yours very truly,

Bill Kendrick

RECEIVED  
DEC 21 1979  
OIL CONSERVATION COMMISSION  
SANTA FE

EL PASO NATURAL GAS COMPANY

Well Name Klein #28 , BASIN DAKOTA

Footage---- 2170' FSL, 1840' FWL

## APPLICATION FOR NON-STANDARD LOCATION

County Rio Arriba State New Mexico Section 33 Township 26N Range 6W

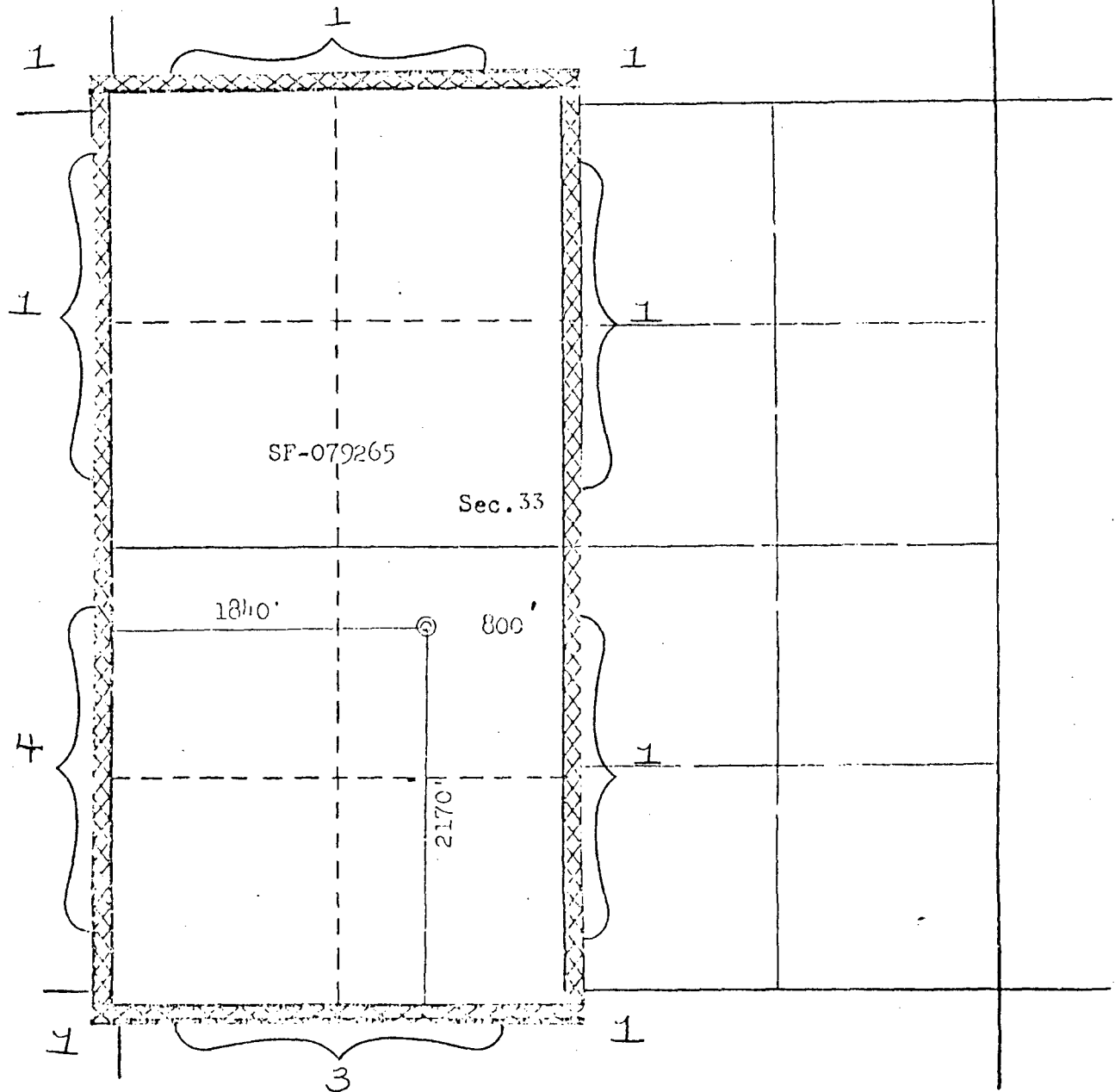

## REMARKS:

- (1) El Paso Natural Gas Company
- (2) Getty Oil Company
- (3) El Paso Natural Gas Company-Canyon Largo Unit
- (4) Merrion & Bayless

Q

## OIL CONSERVATION DIVISION

STATE OF NEW MEXICO  
ENERGY AND MINERALS DEPARTMENTP. O. BOX 2088  
SANTA FE, NEW MEXICO 87501Form C-107  
Revised 10-1-78

All distances must be from the outer boundaries of the Section.

Operator <b>EL PASO NATURAL GAS COMPANY</b>			Lease <b>KLEIN (SF-079265)</b>		Well No. <b>28</b>
Unit Letter <b>K</b>	Section <b>33</b>	Township <b>26N</b>	Range <b>6W</b>	County <b>Rio Arriba</b>	
Actual Footage Location of Well: <b>2170</b> feet from the <b>South</b> line and <b>1840</b> feet from the <b>West</b> line					
Ground Level Elev. <b>6743</b>	Producing Formation <b>DAKOTA</b>		Pool <b>BASIN DAKOTA</b>		Dedicated Acreage: <b>320.00</b> Acres

1. Outline the acreage dedicated to the subject well by colored pencil or hachure marks on the plat below.
2. If more than one lease is dedicated to the well, outline each and identify the ownership thereof (both as to working interest and royalty).
3. If more than one lease of different ownership is dedicated to the well, have the interests of all owners been consolidated by communitization, unitization, force-pooling, etc?

☐ Yes ☐ No If answer is "yes," type of consolidation \_\_\_\_\_

If answer is "no," list the owners and tract descriptions which have actually been consolidated. (Use reverse side of this form if necessary.) \_\_\_\_\_

No allowable will be assigned to the well until all interests have been consolidated (by communitization, unitization, forced-pooling, or otherwise) or until a non-standard unit, eliminating such interests, has been approved by the Commission.

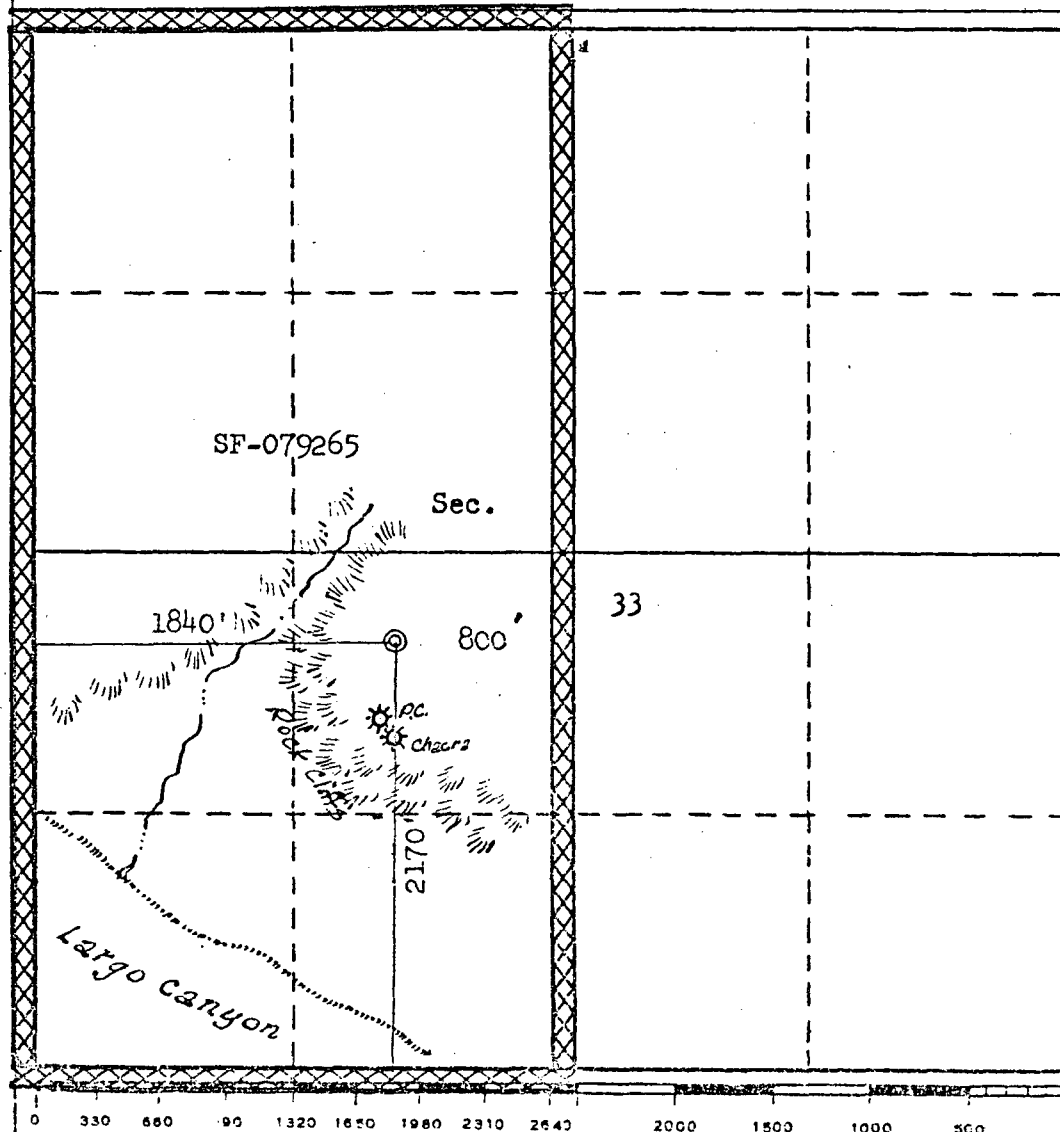

## CERTIFICATION

I hereby certify that the information contained herein is true and complete to the best of my knowledge and belief.

*A. G. Busco*

Name **Drilling Clerk**

Position **El Paso Natural Gas Co.**

Company **November 15, 1979**

Date

I hereby certify that the well location shown on this plat was plotted from field notes of actual surveys made by me or under my supervision, and that the same is true and correct to the best of my knowledge and belief.

Date Surveyed **July 2, 1979**

Registered Professional Engineer and/or Land Surveyor

*Fred B. Kerr Jr.*  
**Fred B. Kerr Jr.**

Certificate No.

**3950**

File HSH-1123

**El Paso** NATURAL GAS  
COMPANY

P. O. BOX 990  
FARMINGTON, NEW MEXICO 87401  
PHONE: 505-325-2841

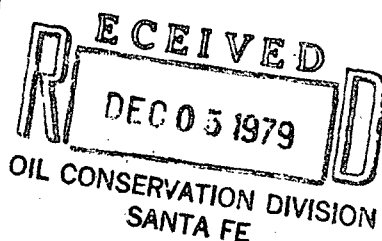

November 27, 1979

Getty Oil Company  
Merrion & Bayless

Re: Unorthodox Gas Well Location

Gentlemen:

El Paso Natural Gas Company has requested administrative approval for an unorthodox location in the Basin Dakota pool.

It is intended to locate the El Paso Natural Gas Company's Klein #28 at 2170' from the South line and 1840' from the West line of Section 33, T-26-N, R-6-W, Rio Arriba County, New Mexico.

Extremely rough terrain with cliffs and ledges, an existing pipeline, and an Indian ruin in the southwest corner of this section make the building of an orthodox gas well location impossible.

In compliance with New Mexico Oil Conservation Division rules, we are notifying you, as operators of an offsetting proration unit, of our application for administrative approval for the aforementioned unorthodox gas well location. Enclosed are three copies of this letter. If there is no objection to this location, please sign and return one copy to the New Mexico Oil Conservation Division, Post Office Box 2088, Santa Fe, New Mexico 87501; one copy to El Paso Natural Gas Company; and keep one copy for your files.

A plat showing the proposed well location and offsetting Dakota lease ownership is attached.

Yours truly,

*L. A. Aimes*

L. A. Aimes  
Project Drilling Engineer

LAA:pb

Approved:

*Merrion & Bayless*  
*by Gregory Merrion*

Date: Dec 3, 1979