

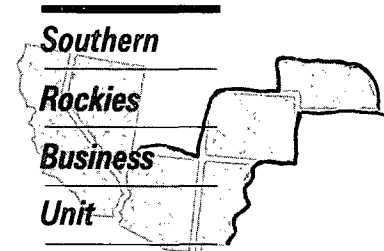

March 20, 1995

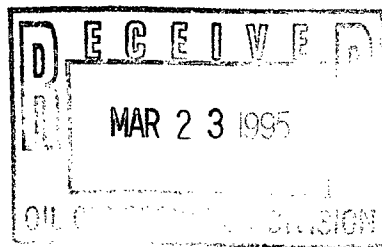

Mr. William J. LeMay, Director  
New Mexico Oil Conservation Division  
2040 S. Pacheco Street  
P.O. Box 6429  
Santa Fe, NM 87505

*Suzanne Rute*  
4-12-95

**Application For Unorthodox Location**  
**Armenta Gas Com C Well #1-E**  
**435' FNL & 1590' FWL, Section 27-T29N-R10W**  
**Blanco Mesaverde Pool**  
**San Juan County, New Mexico**

Amoco Production Company hereby requests administrative approval for an unorthodox well location for the Armenta Gas Com C Well #1-E well in the Blanco Mesaverde Pool. Amoco has recently recompleted this well from the Basin Dakota to the Blanco Mesaverde. The spacing unit for this well is the N/2 Section 27. This well was originally approved at an unorthodox location in the Basin Dakota under Order NSL-1114. Similar approval is requested for the recompleted well in order to produce from the Blanco Mesaverde.

A copy of this application will be submitted to the offset operators by certified mail with a request that they furnish your Santa Fe office with a Waiver of Objection, and return one copy to this office. Attached are plats showing the location of the well, offset operators, and all wells drilled in the area.

Pamela W. Staley

**Attachments**

cc: Frank Chavez, Supervisor  
NMOCD District III  
1000 Rio Brazos Road  
Aztec, NM 87410

**WAIVER**

\_\_\_\_\_ hereby waives objection to Amoco's application for an unorthodox well location for the Armenta Gas Com C Well #1-E well described above.

By: \_\_\_\_\_

Date: \_\_\_\_\_

APPLICATION FOR APPROVAL OF UNORTHODOX LOCATION UNDER RULE 104-F  
ARMENTA GAS COM C WELL #1-E  
SECTION 27-T29N-R10W  
435' FNL & 1590' FWL

ATTACHMENTS:

- 9-SECTION PLAT SHOWING LOCATION OF ALL WELLS AND OFFSET OPERATORS
- FORM C-102 FOR ORIGINAL BASIN DAKOTA WELL
- FORM C-102 FOR BLANCO MESAVERDE WELL
- LIST OF ALL OFFSET OPERATORS AND THEIR ADDRESSES

13,336,884.16 FT. N  
36° 43' 7" N

13,336,884.16 FT. N  
36° 43' 7" N

991,987.79 FT. E  
107° 53' 55" W

107° 50' 38" W  
1,008,012.21 FT. E

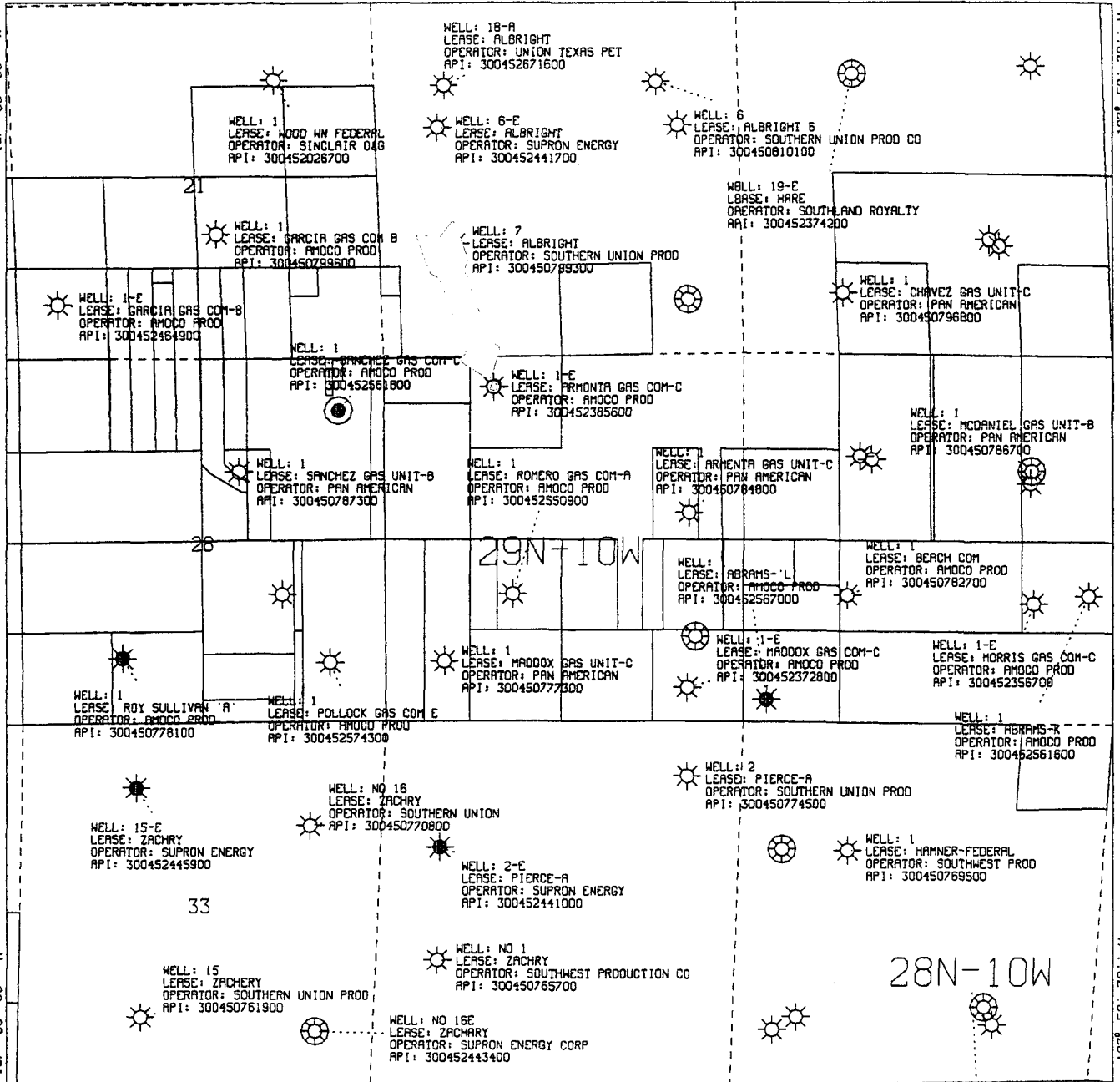

All geological and geophysical data, including the interpretation thereof, appearing on this map is the private and confidential property of Amoco Production Company. The publication or reproduction thereof without the written permission of said Company is strictly prohibited.

POLYCONIC CENTRAL MERIDIAN - 107° 52' 17" W LONG  
SPHEROID - 6

# AMOCO PRODUCTION COMPANY PLAT MAP

Armenta Gas Com C 1E  
dk and mv offsets

SCALE 1 IN. = 2,000 FT. FEB 22, 1995

HORIZONTAL DATUM NAD27

## OIL CONSERVATION DIVISION

STATE OF NEW MEXICO  
ENERGY AND MINERALS DEPARTMENT

P. O. BOX 2088

SANTA FE, NEW MEXICO 87501

Form C-107  
Revised 10-1-78

All distances must be from the outer boundaries of the Section.

|   |                                      |                        |                                     |                           |  |
|---|--------------------------------------|------------------------|-------------------------------------|---------------------------|--|
| Operator<br><b>AMOCO PRODUCTION COMPANY</b>   |                                      |                        | Lease<br><b>ARMENTA GAS COM "C"</b> |                           | Well No.<br><b>1-E</b>                 |
| Unit Letter<br><b>C</b>   | Section<br><b>27</b>                 | Township<br><b>29N</b> | Range<br><b>10W</b>                 | County<br><b>San Juan</b> |  |
| Actual Footage Location of Well:<br><b>435</b> feet from the <b>North</b> line and <b>1590</b> feet from the <b>West</b> line |                                      |                        |                                     |                           |  |
| Ground Level Elev.<br><b>5506</b>   | Producing Formation<br><b>Dakota</b> |                        | Pool<br><b>Basin Dakota</b>         |                           | Dedicated Acreage:<br><b>320</b> Acres |

1. Outline the acreage dedicated to the subject well by colored pencil or hatchure marks on the plat below.
2. If more than one lease is dedicated to the well, outline each and identify the ownership thereof (both as to working interest and royalty).
3. If more than one lease of different ownership is dedicated to the well, have the interests of all owners been consolidated by communitization, unitization, force-pooling, etc?

☒ Yes ☐ No If answer is "yes," type of consolidation Communitization

If answer is "no," list the owners and tract descriptions which have actually been consolidated. (Use reverse side of this form if necessary.)

No allowable will be assigned to the well until all interests have been consolidated (by communitization, unitization, forced-pooling, or otherwise) or until a non-standard unit, eliminating such interests, has been approved by the Commission.

## CERTIFICATION

I hereby certify that the information contained herein is true and complete to the best of my knowledge and belief.

*B. E. Fackrell*

Name

B. E. FACKRELL

Position

DISTRICT ENGINEER

Company

AMOCO PRODUCTION COMPANY

Date

SEPTEMBER 28, 1979

I hereby certify that the well location shown on this plat was plotted from field notes of actual surveys made by me or under my supervision, and that the same is true and correct to the best of my knowledge and belief.

Date Surveyed

September 14, 1979

Registered Professional Engineer and/or Land Surveyor

Fred B. Kerr, Jr.

Certificate No. 3950 B. KERR, JR.

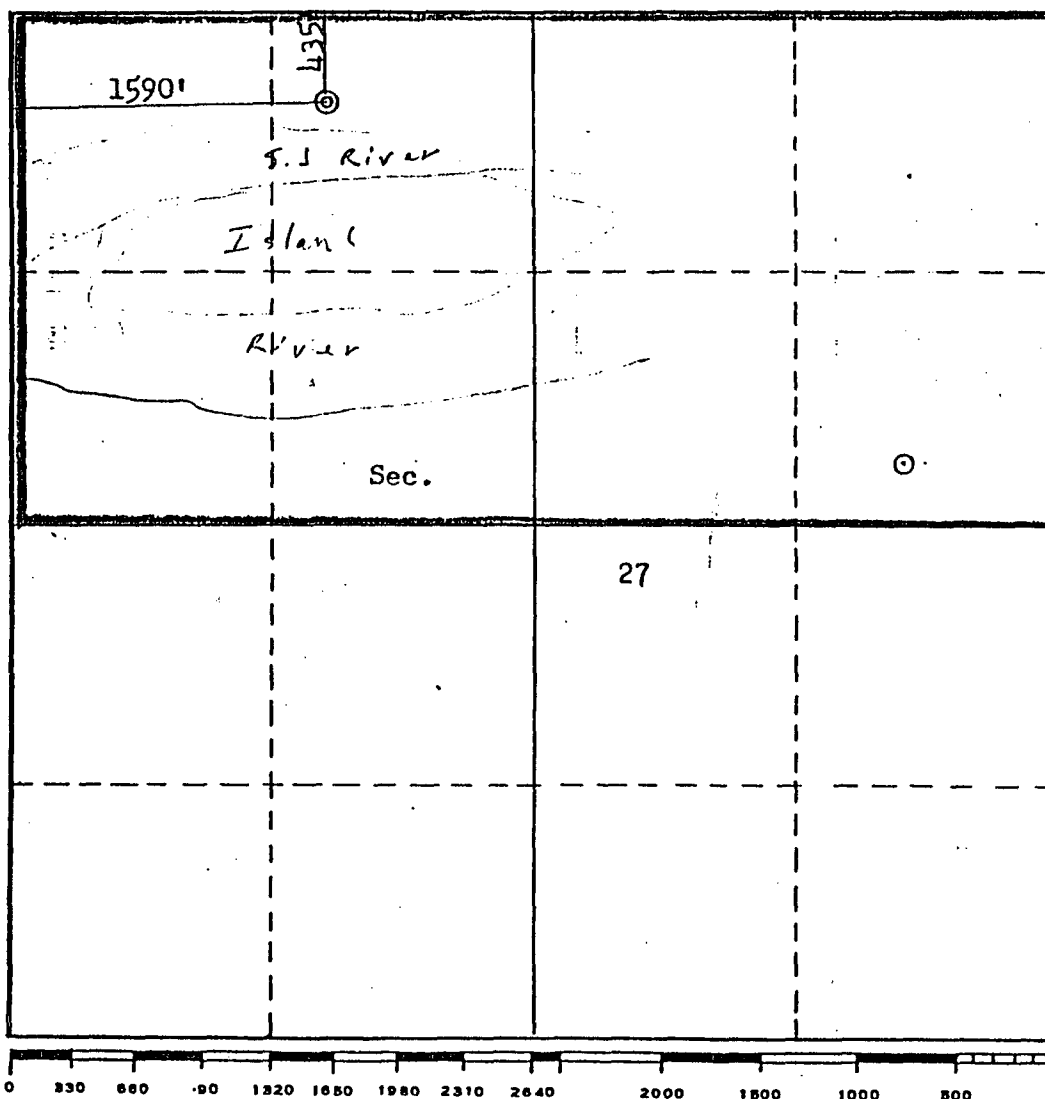

## **Mike Stogner**

---

**From:** Ernie Busch  
**To:** Mike Stogner  
**Subject:** AMOCO (NSL)  
**Date:** Tue, Mar 28, 1995 9:46AM  
**Priority:** High

ARMENTA GAS COM C #1E  
435' FNL; 1590' FWL  
C-27-29N-10W  
RECOMMEND: APPROVAL

District I  
PO Box 1980, Hobbs, NM 88241-1980  
District II  
811 South First, Armenta, NM 88210  
District III  
1000 Rio Brazos Rd., Aztec, NM 87410  
District IV  
2040 South Pacheco, Santa Fe, NM 87505

State of New Mexico  
Energy, Minerals & Natural Resources Department

OIL CONSERVATION DIVISION  
2040 South Pacheco  
Santa Fe, NM 87505

Form C-102  
Revised October 18, 1994  
Instructions on back  
Submit to Appropriate District Office  
State Lease - 4 Copies  
Fee Lease - 3 Copies

☐ AMENDED REPORT

WELL LOCATION AND ACREAGE DEDICATION PLAT

|                            |  |   |  |                                 |                     |  |
|----------------------------|--|---|--|---------------------------------|---------------------|--|
| 1 APT Number<br>3004523856 |  | 2 Pool Code<br>000274                       |  | 3 Pool Name<br>Blanco Mesaverde |                     |  |
| 4 Property Code<br>72319   |  | 5 Property Name<br>Armenta Gas Com C        |  |                                 | 6 Well Number<br>1E |  |
| 7 OGRID No.<br>000778      |  | 8 Operator Name<br>Amoco Production Company |  |                                 | 9 Elevation         |  |

10 Surface Location

|                    |               |                 |              |         |                      |                           |                       |                        |                    |
|--------------------|---------------|-----------------|--------------|---------|----------------------|---------------------------|-----------------------|------------------------|--------------------|
| UL or lot no.<br>c | Section<br>27 | Township<br>29N | Range<br>10W | Lot Idn | Feet from the<br>435 | North/South line<br>North | Feet from the<br>1590 | East/West line<br>West | County<br>San Juan |
|--------------------|---------------|-----------------|--------------|---------|----------------------|---------------------------|-----------------------|------------------------|--------------------|

11 Bottom Hole Location If Different From Surface

|               |         |          |       |         |               |                  |               |                |        |
|---------------|---------|----------|-------|---------|---------------|------------------|---------------|----------------|--------|
| UL or lot no. | Section | Township | Range | Lot Idn | Feet from the | North/South line | Feet from the | East/West line | County |
|---------------|---------|----------|-------|---------|---------------|------------------|---------------|----------------|--------|

|                              |                         |                       |              |
|------------------------------|-------------------------|-----------------------|--------------|
| 12 Dedicated Acres<br>320.00 | 13 Joint or Infill<br>N | 14 Consolidation Code | 15 Order No. |
|------------------------------|-------------------------|-----------------------|--------------|

NO ALLOWABLE WILL BE ASSIGNED TO THIS COMPLETION UNTIL ALL INTERESTS HAVE BEEN CONSOLIDATED  
OR A NON-STANDARD UNIT HAS BEEN APPROVED BY THE DIVISION

|  |  |  |  |   |  |  |  |
|--|--|--|--|---|--|--|--|
| 16<br>1590'  |  |  |  | 17 OPERATOR CERTIFICATION<br>I hereby certify that the information contained herein is true and complete to the best of my knowledge and belief<br><br>Signature <u>Gail M. Jefferson</u><br>Printed Name <u>Gail M. Jefferson</u><br>Title <u>Business Assistant</u><br>Date <u>03-17-1995</u> |  |  |  |
| 18 SURVEYOR CERTIFICATION<br>I hereby certify that the well location shown on this plat was plotted from field notes of actual surveys made by me or under my supervision, and that the same is true and correct to the best of my belief.<br><br>September 13, 1979<br>Date of Survey<br>Signature and Seal of Professional Surveyer:<br><br>3950<br>Certificate Number |  |  |  |   |  |  |  |

OFFSET OPERATORS ADDRESS LIST FOR  
ARMENTA GAS COM C 1E

Meridian Oil Inc.  
P. O. Box 51810  
Midland, Texas 79710-1810

Conoco Inc.  
10 Desta Drive West  
Midland, Texas 79705-4515

Southland Royalty Co.  
P. O. Box 910497  
Dallas, Texas 75391-0497

Southwest Productions Inc.  
812 Gold SW  
Albuquerque, New Mexico 87102

Arco Oil and Gas Company  
P. O. Box 910355  
Dallas, Texas 75391-0355