

Mobil Oil Corporation

NINE GREENWAY PLAZA-SUITE 2700
HOUSTON, TEXAS 77046

December 19, 1979

New Mexico Energy & Minerals Department (3)
Oil Conservation Division
State Land Office Building
P. O. Box 2088
Santa Fe, New Mexico 87501

NSL-1137
Rule 2(c)
1-16-80
R5353

7.01
UNORTHODOX LOCATION
MOBIL OIL CORPORATION'S
LINDRITH B UNIT, WELL #3
CHACON-DAKOTA ASSOCIATED POOL
RIO ARriba COUNTY, NEW MEXICO

790 S 1065W
21-24N-32W

Gentlemen:

Mobil Oil Corporation respectfully requests permission to drill the subject well at an unorthodox location because of a stock tank in the vicinity of a regular location. To clear this stock tank, it is necessary to move 275' east to an alternate drill site. This new location is only 252' from an inner subdivision line which is less than the 330' as required in Rule 2 (b) of Order No. R-5353.

Proposed well #3 will be located as follows:

790' from the South line
1065' from the West line
Sec. 21, T24N - R3W
Rio Arriba, New Mexico

In support of this request, the following items are submitted:

1. Federal Form 9-331C - Application to Drill
2. Form C-102 - "Well Location and Acreage Dedication Plat
3. Plat showing offset lease owners
4. Topography plat showing the stock tank

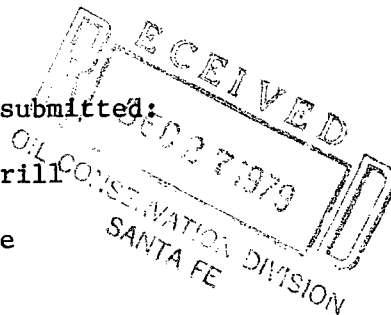

Mobil

New Mexico Energy & Minerals Dept. -2-

December 19, 1979

Mobil Oil Corporation respectfully requests that this unorthodox well location be approved administratively as provided for in Rule 2 (c) of Order No. R-5353.

A copy of this letter and attachments are being send to each offset operator by certified mail as their notice of this application and request for their waiver of objection. These offset operators are:

El Paso Natural Gas Company
P. O. Box 990
Farmington, New Mexico 87401

Mr. Curtis J. Little
103 N. Main
Aztec, New Mexico 87410

Yours very truly,

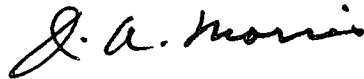

J. A. Morris
Regulatory Engineering
Supervisor

ADBond/cbb

Attachments

cc: District Supv. - Aztec
USGS - Durango
Offset Operators

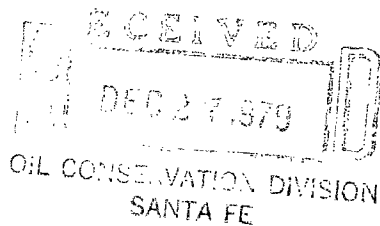

UNITED STATES
DEPARTMENT OF THE INTERIOR
GEOLOGICAL SURVEY

APPLICATION FOR PERMIT TO DRILL, DEEPEN, OR PLUG BACK

1a. TYPE OF WORK

DRILL ☒DEEPEN ☐PLUG BACK ☐

b. TYPE OF WELL

OIL
WELL ☒GAS
WELL ☐

OTHER

SINGLE
ZONE ☒MULTIPLE
ZONE ☐

2. NAME OF OPERATOR

Mobil Oil Corporation

3. ADDRESS OF OPERATOR

Nine Greenway Plaza, Suite 2700; Houston, Texas 77046

4. LOCATION OF WELL (Report location clearly and in accordance with any State requirements.)*

At surface

790' FSL and 1065' FWL, Sec. 21, T24N, R3W

At proposed prod. zone

Same as surface

14. DISTANCE IN MILES AND DIRECTION FROM NEAREST TOWN OR POST OFFICE*

50 miles Southeast of Farmington

10. DISTANCE FROM PROPOSED*

LOCATION TO NEAREST
PROPERTY OR LEASE LINE, FT.
(Also to nearest drlg. unit line, if any)

1065'

18. DISTANCE FROM PROPOSED LOCATION*

TO NEAREST WELL, DRILLING, COMPLETED,
OR APPLIED FOR, ON THIS LEASE, FT.

1603' South

16. NO. OF ACRES IN LEASE

26,365.43

19. PROPOSED DEPTH

8200'

17. NO. OF ACRES ASSIGNED
TO THIS WELL

160

20. ROTARY OR CABLE TOOLS

Rotary

21. ELEVATIONS (Show whether DF, RT, GR, etc.)

6927' - Ground

22. APPROX. DATE WORK WILL START*

February 1, 1980

23.

PROPOSED CASING AND CEMENTING PROGRAM

SIZE OF HOLE	SIZE OF CASING	WEIGHT PER FOOT	SETTING DEPTH	QUANTITY OF CEMENT
17-1/2"	13-3/8"	48# H-40	0- 300'	1. Circulate to Surface
12-1/2"	8-5/8"	24# K-55	0-2500'	2. Circulate to Surface
	8-5/8"	32# H-40	2500-3900'	
7-7/8"	5-1/2"	15.5# K-55	0-7500'	3. Circulate to Surface
	5-1/2"	17# K-55	7500-8200'	

Cementing Program

1) Class A with 2% CaCl₂

(2) Class A with 6% gel tailed in with Neat cement

3) Class H

Mud Program

Depth	Type of Mud	Weight	Viscosity	pH	Water Loss
0-300'	Spud Mud	10.0#	---	---	---
300-8100'	Fresh Water Gel	9.0#	40	---	---

Blowout Preventer Program

See Attachment

IN ABOVE SPACE DESCRIBE PROPOSED PROGRAM: If proposal is to deepen or plug back, give data on present productive zone and proposed new productive zone. If proposal is to drill or deepen directionally, give pertinent data on subsurface locations and measured and true vertical depths. Give blowout preventer program, if any.

24.

SIGNED

A. D. Bond

RECEIVED

Regulatory Engineering

DATE 12/11/79

(This space for Federal or State office use)

Coordinator II

PERMIT NO.

APPROVAL DATE

OIL CONSERVATION DIVISION

SANTA FE

TITLE

APPROVED BY

DATE

CONDITIONS OF APPROVAL, IF ANY:

**NEW MEXICO OIL CONSERVATION COMMISSION
WELL LOCATION AND ACREAGE DEDICATION PLAT**

Form C-102
Supersedes C-128
Effective 1-1-65

All distances must be from the outer boundaries of the Section.

Operator Mobil Oil Corporation			Lease Lindrith B Unit		Well No. 3
Unit Letter M	Section 21	Township 24N	Range 3W	County Rio Arriba	
Actual Footage Location of Well:					
790 feet from the South line and		1065 feet from the West line			
Ground Level Elev. 6927'	Producing Formation Dakota	Pool Chacon-Dakota Associated		Dedicated Acreage: 160 Acres	

1. Outline the acreage dedicated to the subject well by colored pencil or hachure marks on the plat below.
2. If more than one lease is dedicated to the well, outline each and identify the ownership thereof (both as to working interest and royalty).
3. If more than one lease of different ownership is dedicated to the well, have the interests of all owners been consolidated by communitization, unitization, force-pooling, etc?

☒ Yes ☐ No If answer is "yes," type of consolidation **Unitization**

If answer is "no," list the owners and tract descriptions which have actually been consolidated. (Use reverse side of this form if necessary.) _____

No allowable will be assigned to the well until all interests have been consolidated (by communitization, unitization, forced-pooling, or otherwise) or until a non-standard unit, eliminating such interests, has been approved by the Commission.

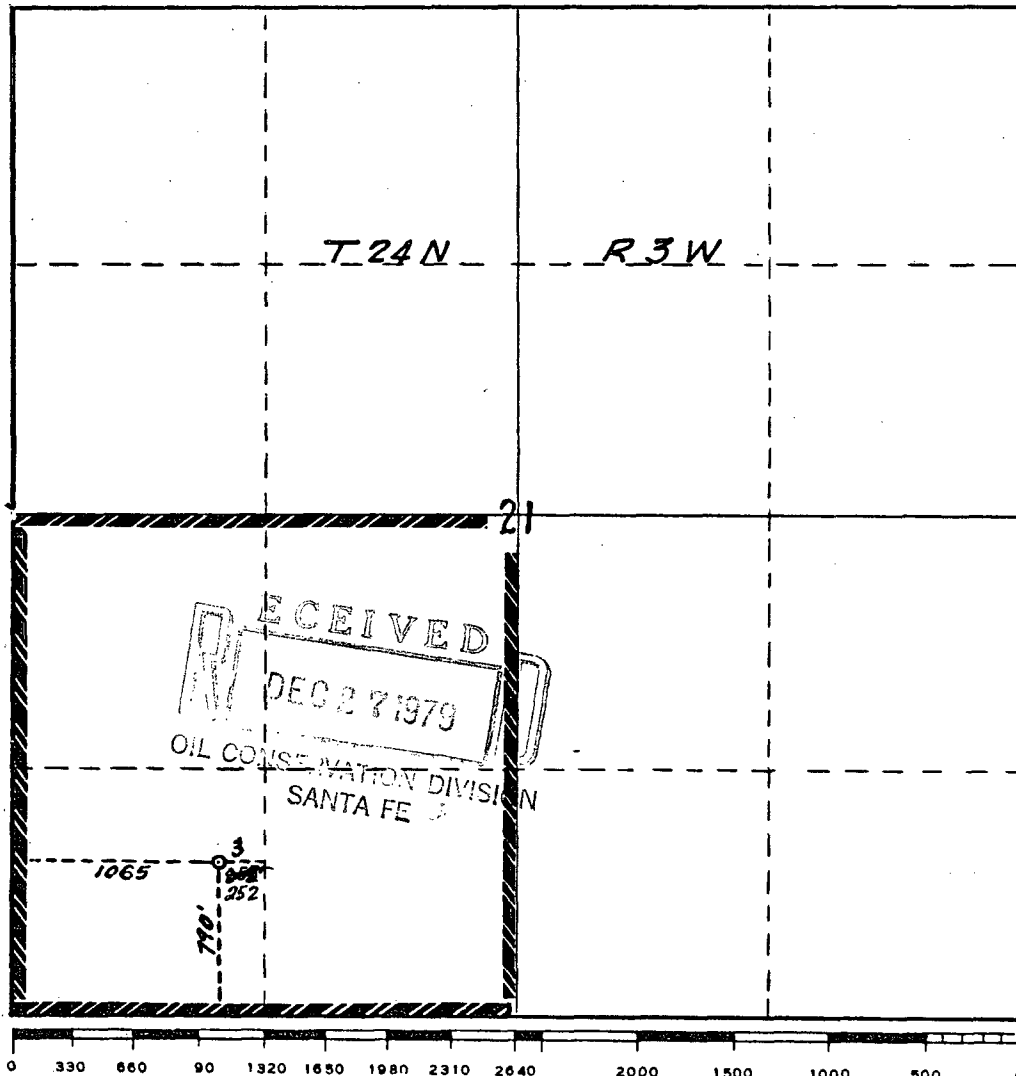

CERTIFICATION

I hereby certify that the information contained herein is true and complete to the best of my knowledge and belief.

A. D. Bond
Name
A. D. Bond
Position **Regulatory Engineering Coordinator II**
Company **Mobil Oil Corporation**
Date **December 11, 1979**

I hereby certify that the well location shown on this plat was plotted from field notes of actual surveys made by me or under my supervision, and that the same is true and correct to the best of my knowledge and belief.

Date Surveyed
November 14, 1979
Registered Professional Engineer and/or Land Surveyor

H. A. Carson, Jr.

Certificate No.

5063

THIS DRAWING AND ALL INFORMATION THEREON IS THE PROPERTY OF MOBIL OIL CORPORATION AND SHALL NOT BE COPIED OR USED EXCEPT FOR THE PURPOSE FOR WHICH

IT IS EXPRESSLY FURNISHED. THE DRAWING AND ANY COPIES THEREOF (PARTIAL OR COMPLETE) SHALL BE RETURNED TO THE OWNER ON DEMAND.

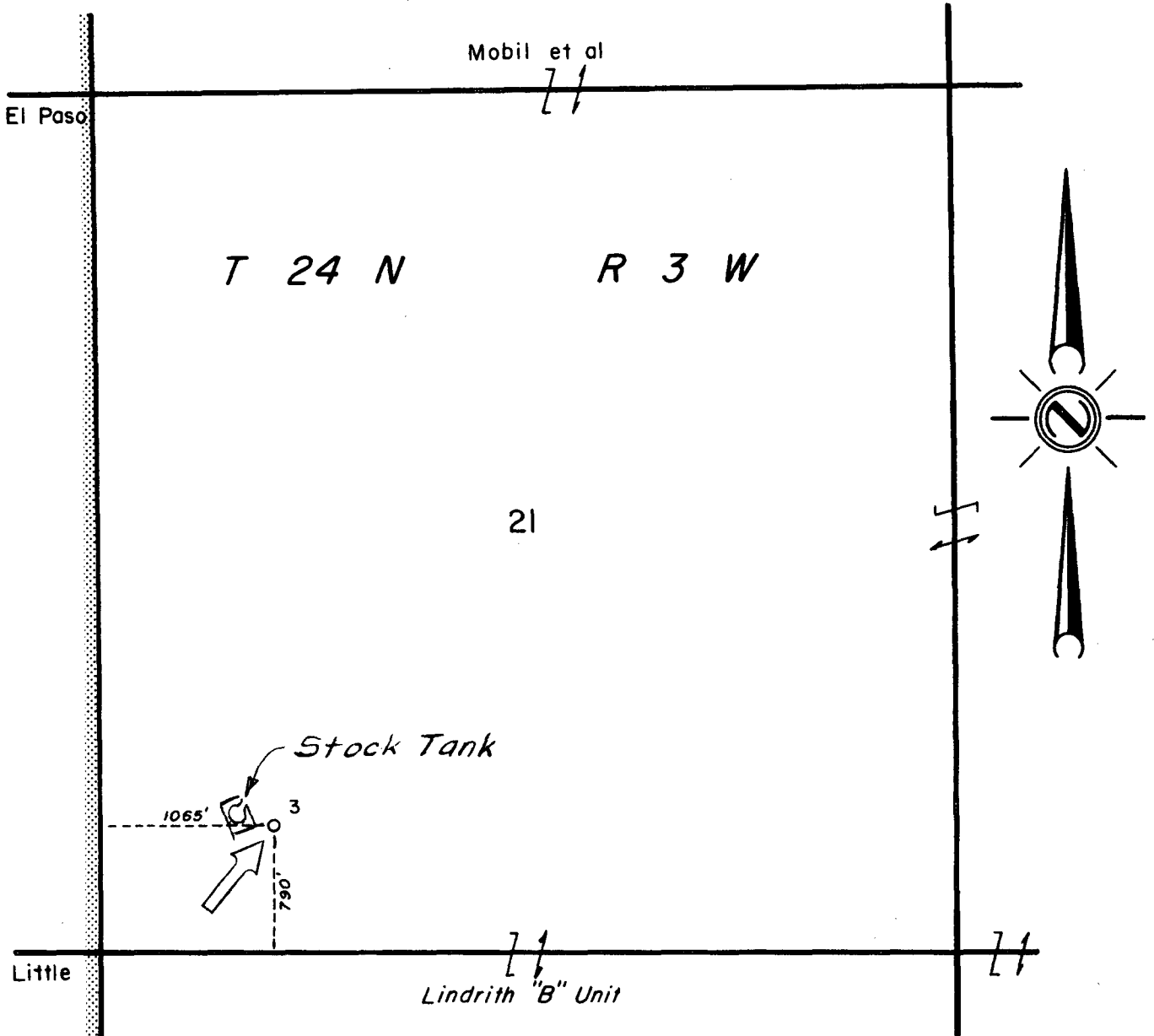

RECEIVED
DEC 27 1979
OIL CONSERVATION DIVISION
SANTA FE

Reserve _____ Permit Depth _____

Special Instructions _____

THE STATE OF TEXAS
COUNTY OF HARRIS

I hereby certify that this plat truly represents conditions as they actually exist on this lease; that said plat which is drawn to the scale indicated hereon, is to the best of my knowledge true and correct; that it accurately shows said lease with all wells on same; that number and locations of said wells are as indicated hereon; and that this plat correctly reflects all pertinent and required data.

as Bond

Mobil Oil Corporation
Houston E&P Division

LEASE Lindrith "B" Unit
WELL NO. 3 DATE 12/19 19 79
DIVISION Houston LEASE NO. _____
TOTAL ACRES IN LEASE 26,365.43 ACRES COVERED BY PLAT _____
DESCRIPTION Section 21, T24N, R3W of 26,365.43
acre unit, 50 mi. SE of Farmington

Rio Arriba County, New Mexico

DRAWN WEK
SCALE 1" = 1000'

DATE 12-17-79
FILE NO. _____

FIELD Chacon - Dakota
Associated

THIS DRAWING AND ALL INFORMATION THEREON
IS THE PROPERTY OF MOBIL OIL CORPORATION AND
SHALL NOT BE COPIED OR USED EXCEPT FOR THE

PURPOSE FOR WHICH IT IS EXPRESSLY FURNISHED.
THE DRAWING AND ANY COPIES THEREON (PARTIAL
OR COMPLETE) SHALL BE RETURNED TO THE OWNER
ON DEMAND.

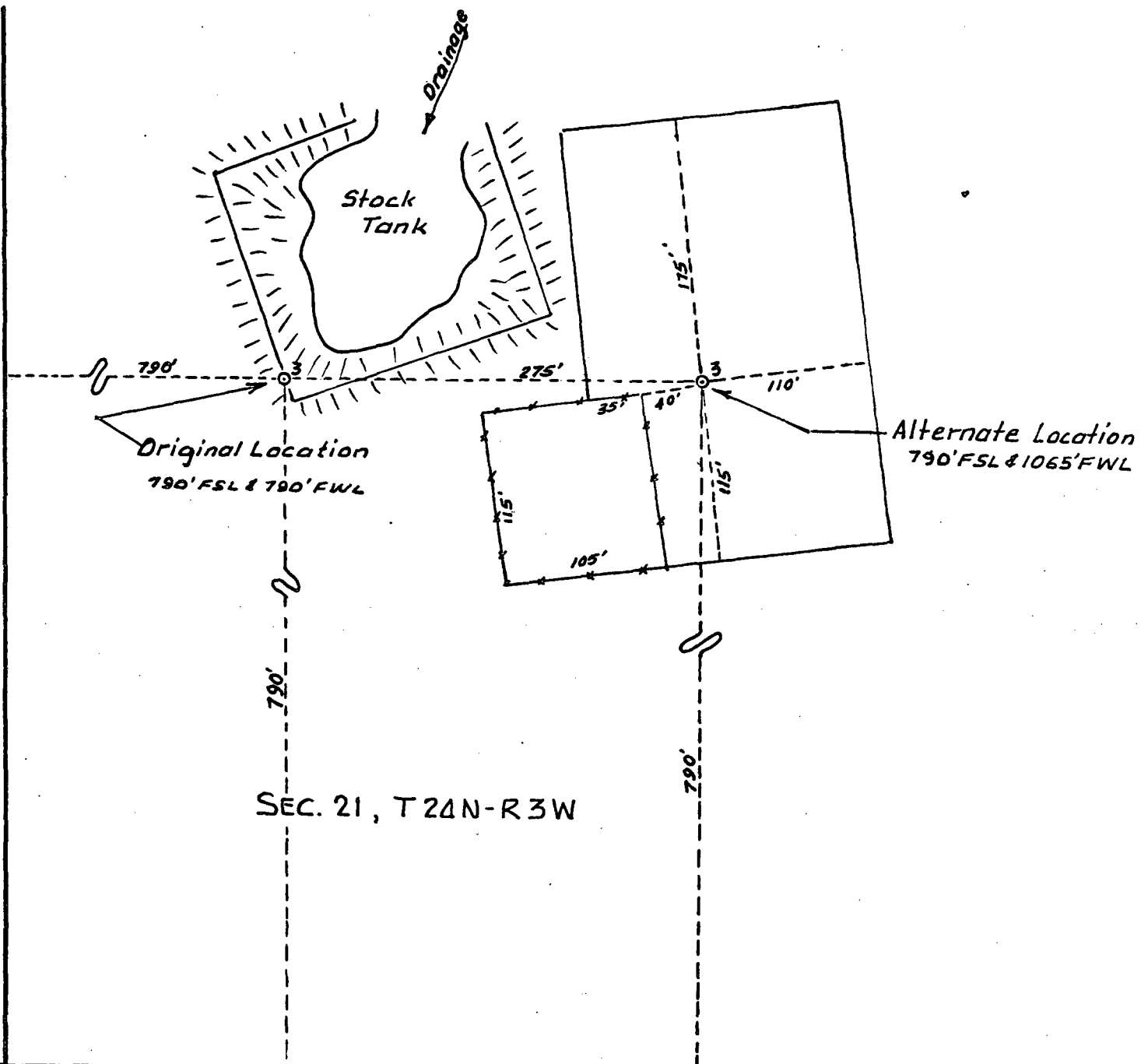

NO.	DATE	BY
Topography Plat Lindrith B Unit, Well #3 Chacon-Dakota Associated Pool Rio Arriba County, New Mexico		
Mobil Oil Corporation Houston E & P Division		
DRAWN		DWG. NO.
CHECKED	SCALE 1"=100'	A
	DATE 12-18-79	

OIL CONSERVATION COMMISSION

Cuyler DISTRICT

OIL CONSERVATION COMMISSION
BOX 2088
SANTA FE, NEW MEXICO

DATE 12-27-79

RE: Proposed MC _____
Proposed DHC _____
Proposed NSL ✓ _____
Proposed SWD _____
Proposed WFX _____
Proposed PMX _____

Gentlemen:

I have examined the application dated 12-14-79
for the Mobil Oil Corp. Lindroth B Unit #3
Operator Lease and Well No. Unit, S-T-R

and my recommendations are as follows:

M-21-24N-3W

Approve

Yours very truly,

AK Ryndick

RECEIVED
DEC 31 1979
OIL CONSERVATION COMMISSION
SANTA FE

Mobil Producing Texas & New Mexico Inc.

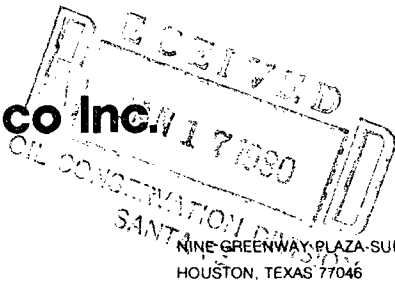

January 11, 1980

New Mexico Energy & Minerals Department
Oil Conservation Division
State Land Office Building
P. O. Box 2088
Santa Fe, New Mexico

7.01
UNORTHODOX LOCATION
MOBIL PRODUCING TX. & N.M. INC.
LINDRITH B UNIT, WELL #3
CHACON-DAKOTA ASSOCIATED POOL
RIO ARriba COUNTY, NEW MEXICO

Gentlemen:

Reference is made to our letter dated December 19, 1979, concerning the subject well. In this letter, we stated that El Paso and Curtis J. Little were offset operators to the proration unit being assigned to this well. We have since learned that the offset operators to this proration unit in the Chacon-Dakota Associated Field are:

Atlantic Richfield (ARCO)
Liberty Life Building
1860 Lincoln
Denver, Colorado 80203

Odessa Natural Corporation
Box 3908
Odessa, Texas 79760

By certified mail, Mobil is notifying these offset operators of our application and requesting their waiver of objection.

A copy of a corrected certified ownership plat is enclosed.

Yours very truly,

J. A. Morris
Regulatory Engineering
Supervisor

ADBond/cbb
Attachment

cc: District Supv. - Aztec
U.S.G.S. - Durango
Atlantic Richfield
Odessa Natural Corporation

THIS DRAWING AND ALL INFORMATION THEREON IS THE
PROPERTY OF MOBIL OIL CORPORATION AND SHALL NOT
BE COPIED OR USED EXCEPT FOR THE PURPOSE FOR WHICH

IT IS EXPRESSLY FURNISHED. THE DRAWING AND ANY
COPIES THEREOF (PARTIAL OR COMPLETE) SHALL BE
RETURNED TO THE OWNER ON DEMAND.

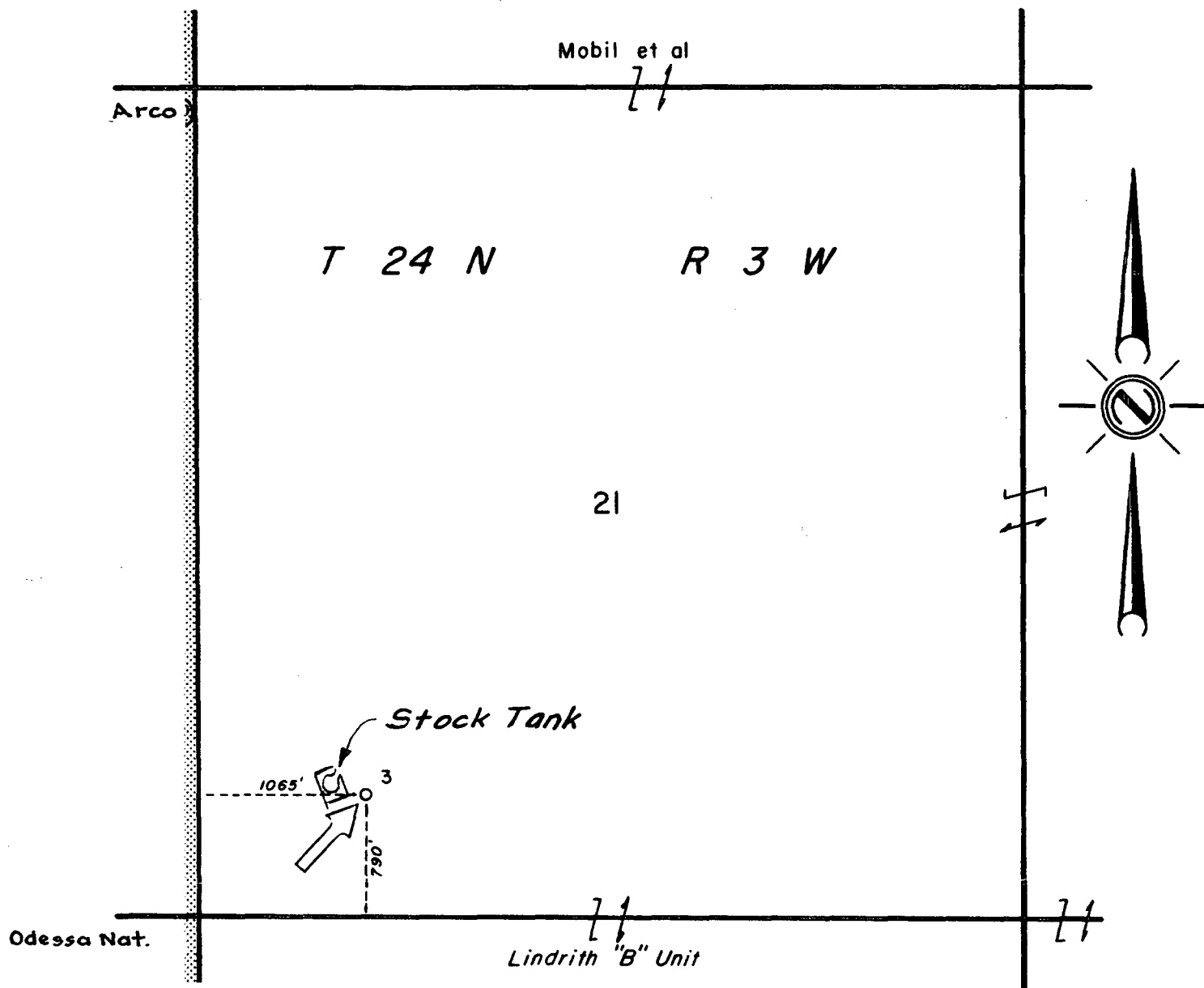

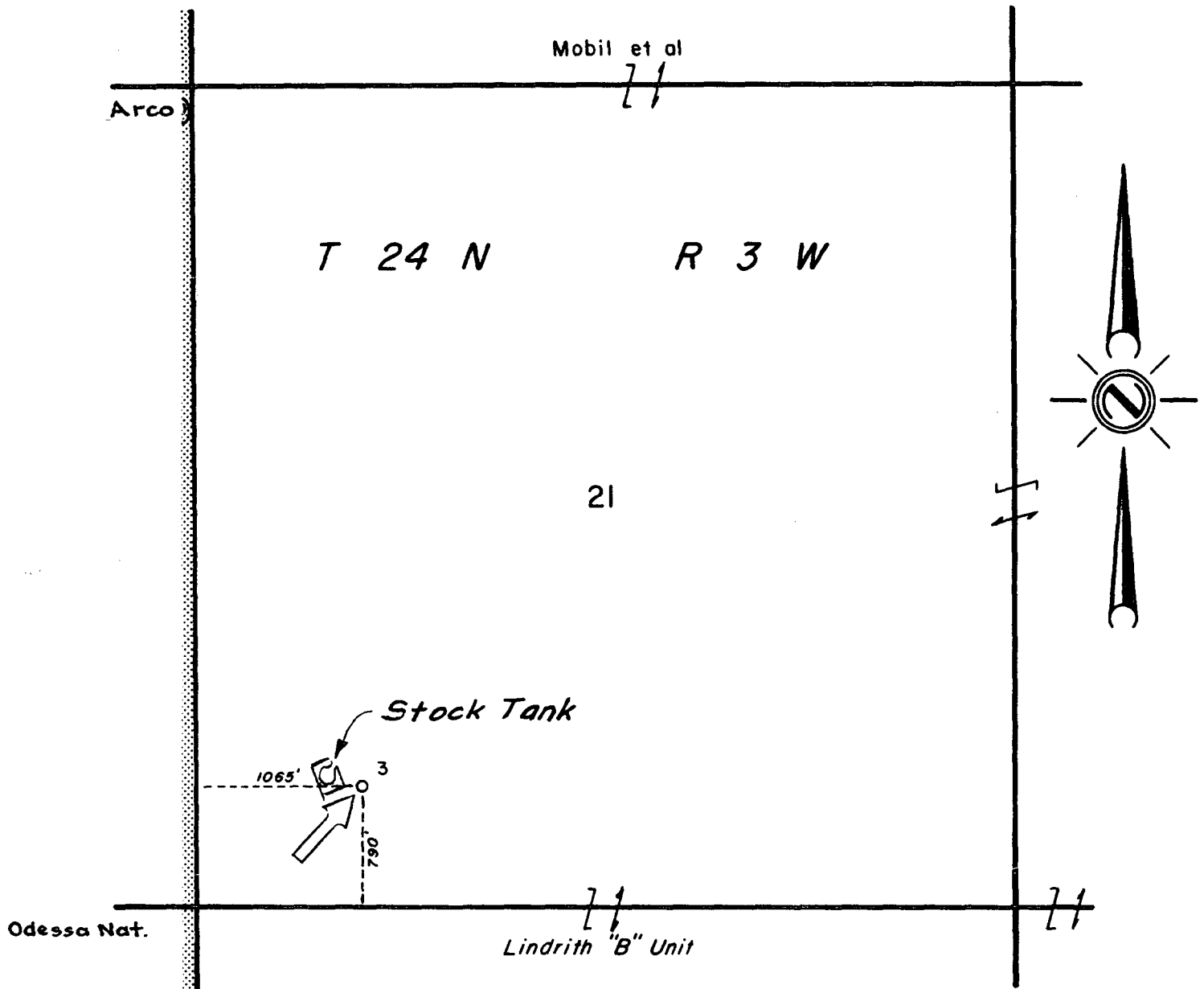

Reserve _____ Permit Depth _____

Special Instructions _____

THE STATE OF TEXAS
COUNTY OF HARRIS

I hereby certify that this plat truly represents conditions as they actually exist on this lease; that said plat which is drawn to the scale indicated hereon, is to the best of my knowledge true and correct; that it accurately shows said lease with all wells on same; that number and locations of said wells are as indicated hereon; and that this plat correctly reflects all pertinent and required data.

Mobil Oil Corporation
Houston E&P Division

LEASE Lindrith "B" Unit
WELL NO. 3 DATE 12/11 19 79
DIVISION Houston LEASE NO. _____
TOTAL ACRES IN LEASE 26,365.43 ACRES COVERED BY PLAT _____
DESCRIPTION Section 21, T24N, R3W of 26,365.43
acre unit, 50 mi. SE of Farmington

Rio Arriba County, New Mexico

DRAWN WEK DATE 12-17-79 FIELD Chacon - Dakota
SCALE 1" = 1000' FILE NO. _____ Associated

W A I V E R

New Mexico Energy & Minerals Department
Oil Conservation Division
State Land Office Building
P. O. Box 2088
Santa Fe, New Mexico 87501

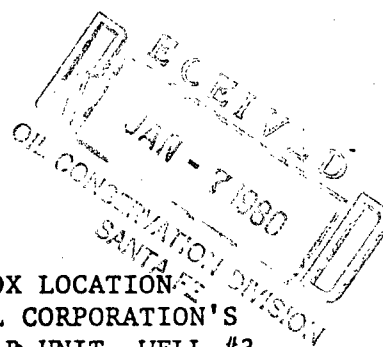

7.01
UNORTHODOX LOCATION
MOBIL OIL CORPORATION'S
LINDRITH B UNIT, WELL #3
CHACON-DAKOTA ASSOCIATED POOL
RIO ARRIBA COUNTY, NEW MEXICO

Gentlemen:

We have received a copy of Mobil Oil Corporation's application to drill the subject well at an unorthodox location. Please be informed that we, as an offset operator to Mobil's proposed well, waive objection to their application as set forth in their letter dated December 19, 1979.

Yours very truly,

COMPANY _____

REPRESENTATIVE _____

SIGNATURE Carl J. Little

TITLE _____

DATE 1-3-80