



*One waiver in  
supra*

May 1, 1980

*NSC-1193  
Rule 3 R-1670  
5-25-80*

Joe D. Ramey, Director (3)  
Department of Energy and Minerals  
Oil Conservation Division  
P. O. Box 2088  
Santa Fe, NM 87501

File: HAS-94-986.511

Dear Mr. Ramey:

Application for Right to Produce  
Basin Dakota Gas From Bergin Gas Com No. 1-E  
at an Unorthodox Well Location in  
NW/4 of Section 21-T29N-R11W  
San Juan County, New Mexico

By this verified application <sup>Pro!</sup> submitted in triplicate, Amoco  
Production Company requests approval to produce gas from  
the Basin Dakota formation in Bergin Gas Com No. 1-E, a  
Basin Dakota infill well, at the unorthodox location of  
1,835' FNL and 1,965' FWL of Section 21-T29N-R11W.

A Form C-102 and a location map showing the unorthodox well  
site in relation to the surrounding housing area are enclosed.  
The reason for this unorthodox location is that the well  
is located within the Village of Bloomfield and was staked  
in its present location to avoid three irrigated garden  
spots which lie just west and within the boundaries of the  
standard location. This well site is an exception because  
the permissible location for a Basin Dakota infill well  
must be at least 790' from the outer boundary line of the  
undrilled quarter section of the 320-acre proration unit,  
and be at least 130' from any quarter quarter section line  
or subdivision inner boundary.

A plat is also enclosed which shows offset wells and operators.  
By the attached Verification and Affidavit that is a part of  
this application, all affected offset operators of Basin  
Dakota wells are being notified by certified mail of this

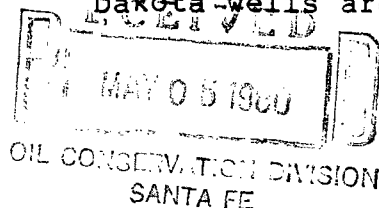

Joe D. Ramey, Director  
May 1, 1980  
Page Two

unorthodox location request. In this instance, Union Texas Petroleum, Southland Royalty Company, and Supron Energy Corporation (Southern Union) are affected offset operators. If there is no objection to this unorthodox location request, we ask that each of these three offset operators so signify on three (3) copies of this letter in the space provided below, sending one copy to you at the NMOCC, one copy to me, and retaining the third copy for their own files. In the absence of an objection from any of the affected offset operators within twenty (20) days, and provided you have no objection to this application, we shall appreciate receiving your administrative approval. Of course, if there is an objection, please set the matter for hearing.

Respectfully submitted,

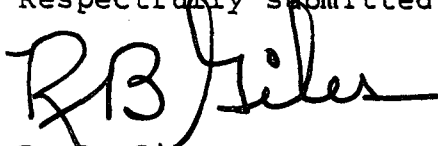

R. B. Giles

RBG/mlm

Enclosures

cc:  
Frank Chaves, Supervisor District III  
New Mexico Oil Conservation Commission  
1000 Rio Brazos Road  
Aztec, NM 87410

P. T. McGrath  
United States Geological Survey  
P. O. Box 965  
Farmington, NM 87401

The undersigned has no objection to Amoco's request for an unorthodox well location for its Bergin Gas Com No. 1-E to be located 1,835' FNL and 1,965' FWL of Section 21-T29N-R11W, San Juan County, New Mexico.

By: \_\_\_\_\_  
Representing: \_\_\_\_\_  
Dated: \_\_\_\_\_

SB547

VERIFICATION AND AFFIDAVIT

STATE OF COLORADO            )  
                                  : ss.  
COUNTY OF DENVER            )

R. B. Giles, of lawful age, being first duly sworn on his oath, deposes and says:

That he is employed in an engineering capacity by Amoco Production Company in its Denver, Colorado, office; that he has been qualified as an expert engineering witness by the New Mexico Oil Conservation Division and his qualifications have been made of record; that he has testified numerous times before the New Mexico Oil Conservation Division on well spacing matters; that Amoco's application for approval of the right to produce Basin Dakota gas from Bergin Gas Com No. 1-E at a location 1,835' FNL and 1,965' FWL of Section 21-T29N-R11W, as an unorthodox location in San Juan County, New Mexico, was prepared under his direction and supervision; that the matters and things therein set forth are true and correct to the best of his knowledge and beliefs; and that a copy thereof was sent by certified mail from Applicant's Denver, Colorado, office on May 1, 1980, to the following affected offset operators, at the addresses shown herein, to wit:

P. M. Cordell, Jr.  
Union Texas Petroleum  
P. O. Box 2120  
Houston, TX 77001

Kenneth E. Roddy  
Supron Energy Corporation  
P. O. Box 808  
Farmington, NM 87401

Southland Royalty Company  
1010 Denver Club Building  
410 - 17th Street  
Denver, CO 80202

and to the best of his information, knowledge and belief, the operators above named are the only operators to whom notice of such application is required to be given in accordance with Rule 104 of the Rules and Regulations of the New Mexico Oil Conservation Division.

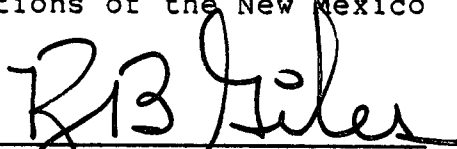
  
R. B. GILES

Subscribed and sworn to before me this 1st day of May, 1980.

  
Notary Public

My Commission expires:

8-15-80

All distances must be from the outer boundaries of the Section.

Operator <b>AMOCO PRODUCTION COMPANY</b>			Lease <b>BERGIN GAS COM</b>		Well No. <b>1-E</b>
Unit Letter <b>F</b>	Section <b>21</b>	Township <b>29N</b>	Range <b>11W</b>	County <b>San Juan</b>	
Actual Postage Location of Well: <b>1835</b> feet from the <b>North</b> line and <b>1965</b> feet from the <b>West</b> line					
Ground Level Elev. <b>5453</b>	Producing Formation <b>Dakota</b>		Pool <b>Basin Dakota</b>		Dedicated Acreage: <b>320</b> Acres

1. Outline the acreage dedicated to the subject well by colored pencil or hachure marks on the plat below.
2. If more than one lease is dedicated to the well, outline each and identify the ownership thereof (both as to working interest and royalty).
3. If more than one lease of different ownership is dedicated to the well, have the interests of all owners been consolidated by communitization, unitization, force-pooling, etc?

☐ Yes ☐ No If answer is "yes," type of consolidation \_\_\_\_\_

If answer is "no," list the owners and tract descriptions which have actually been consolidated. (Use reverse side of this form if necessary.) \_\_\_\_\_

No allowable will be assigned to the well until all interests have been consolidated (by communitization, unitization, forced-pooling, or otherwise) or until a non-standard unit, eliminating such interests, has been approved by the Commission.

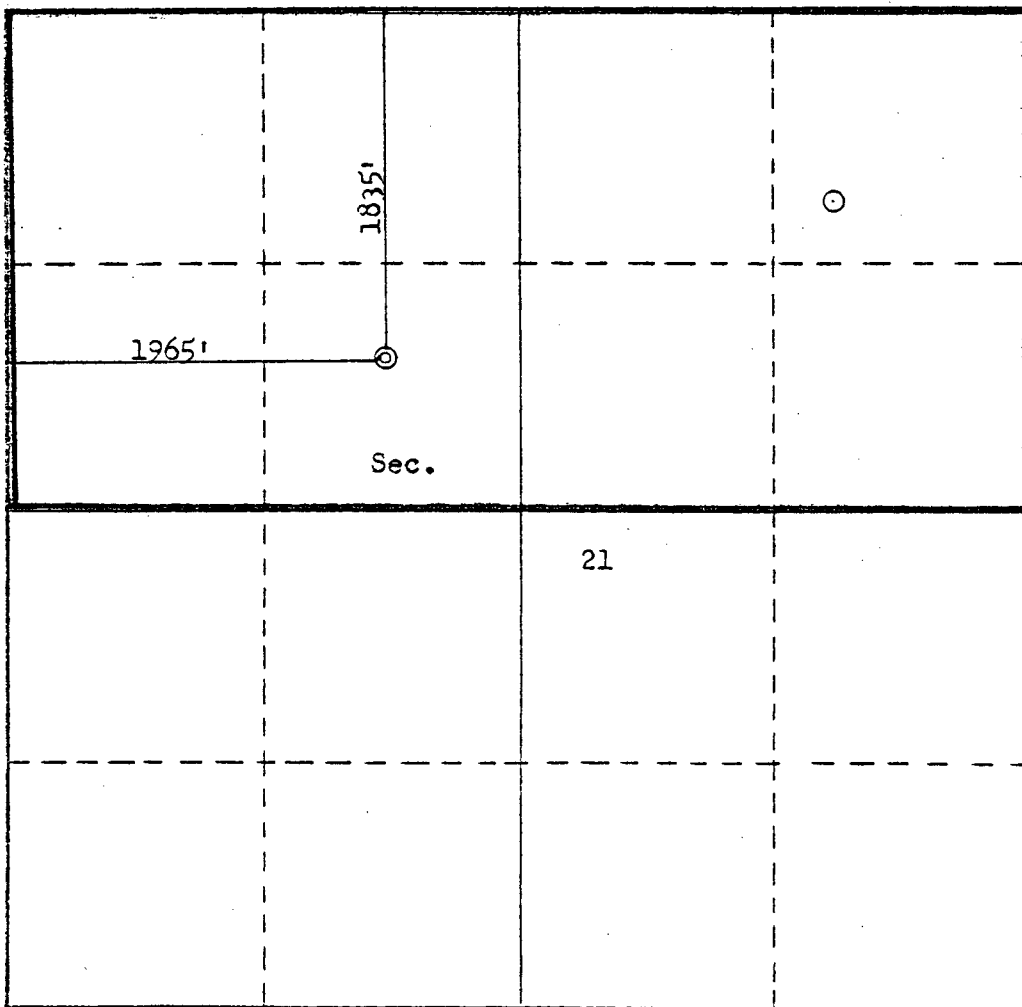

CERTIFICATION

I hereby certify that the information contained herein is true and complete to the best of my knowledge and belief.

*B. E. Fackrell*

Name

**B. E. Fackrell**

Position

**District Engineer**

Company

**AMOCO PRODUCTION CO.**

Date

**August 27, 1979**

I hereby certify that the well location shown on this plat was plotted from field notes of actual surveys made by me or under my supervision, and that the same is true and correct to the best of my knowledge and belief.

Date Surveyed

**August 27, 1979**

Registered Professional Engineer and/or Land Surveyor

*Francis K. Kern Jr.*

Certified No. **3950**

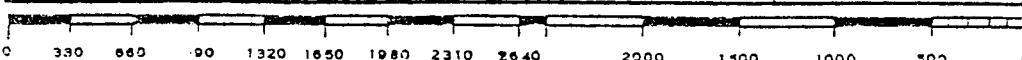

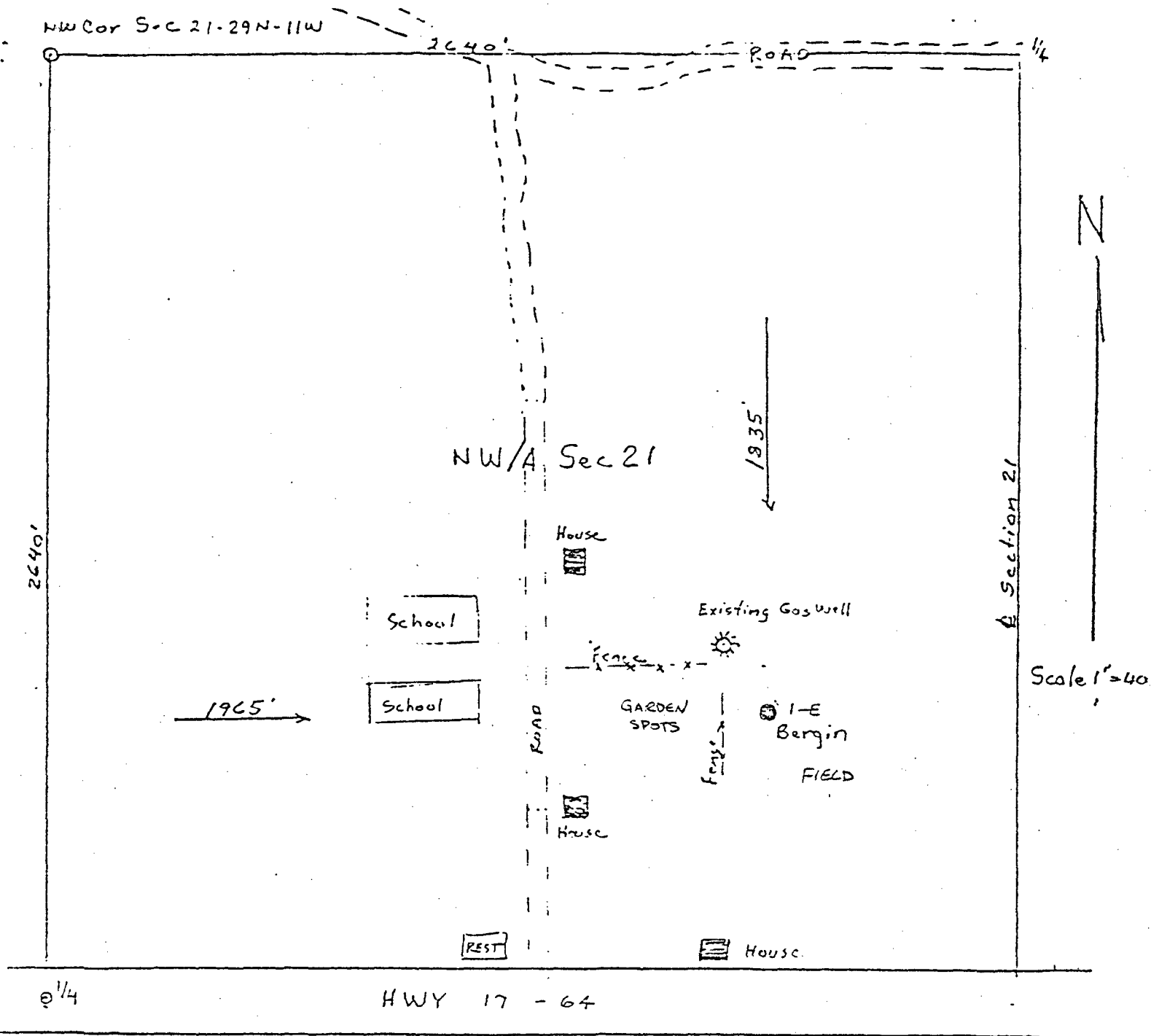

Location map to show the relationship of the AMOCO PRODUCTION CO. #1-E BERGIN GAS COM to the surrounding housing area

Well location is 1835' FNL 1965' FNL Sec 21-T29N-R11W  
San Juan County, New Mexico

# BERGIN GAS COM #1E



EXISTING DAKOTA WELLS • UNOTHOX LOCATION •

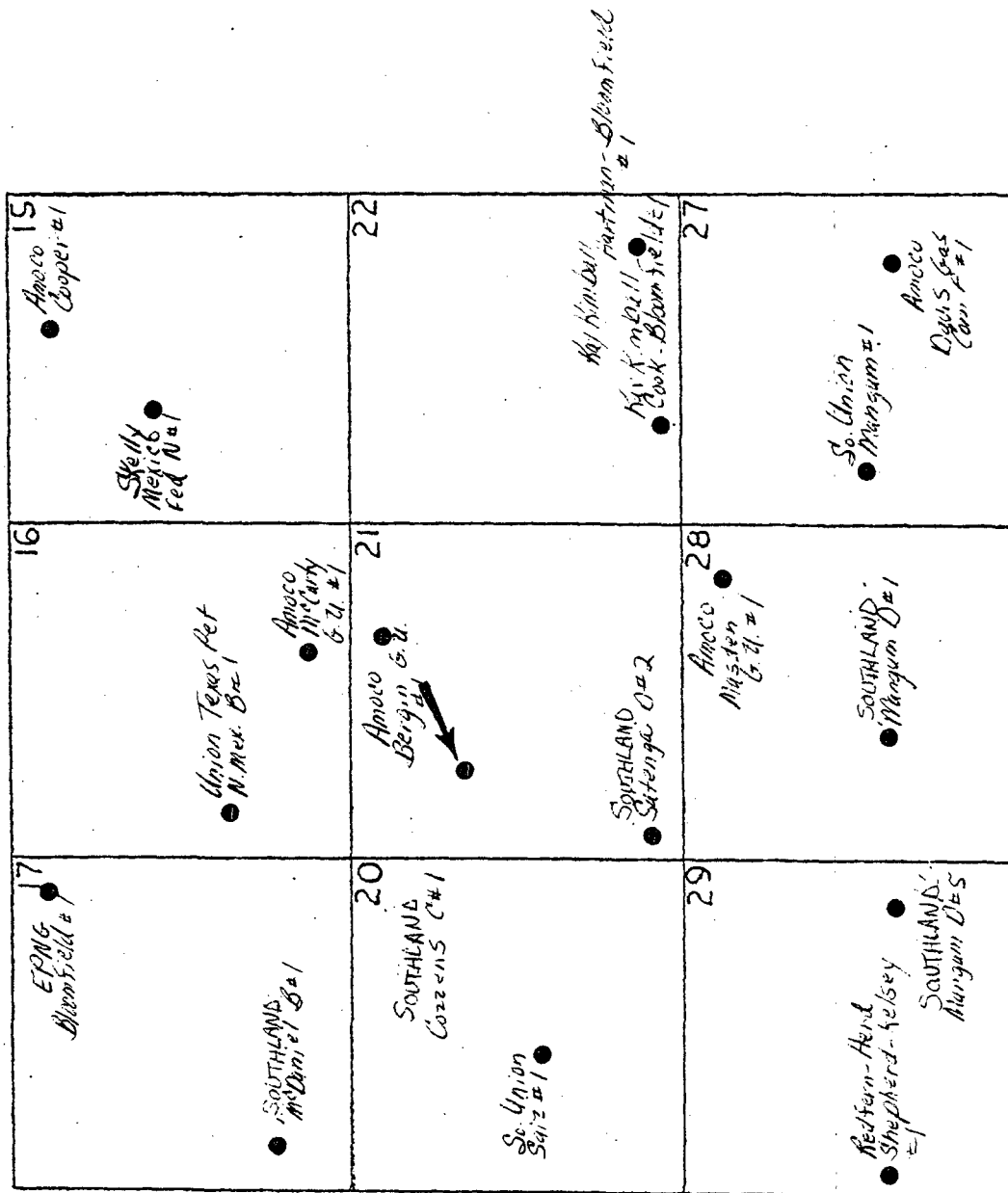

Joe D. Ramey, Director  
May 1, 1980  
Page Two

unorthodox location request. In this instance, Union Texas Petroleum, Southland Royalty Company, and Supron Energy Corporation (Southern Union) are affected offset operators. If there is no objection to this unorthodox location request, we ask that each of these three offset operators so signify on three (3) copies of this letter in the space provided below, sending one copy to you at the NMOCC, one copy to me, and retaining the third copy for their own files. In the absence of an objection from any of the affected offset operators within twenty (20) days, and provided you have no objection to this application, we shall appreciate receiving your administrative approval. Of course, if there is an objection, please set the matter for hearing.

Respectfully submitted,

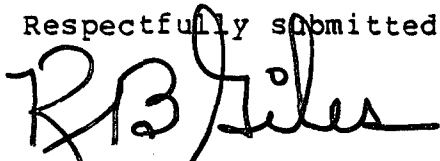

R. B. Giles

RBG/mlm

Enclosures

cc:  
Frank Chaves, Supervisor District III  
New Mexico Oil Conservation Commission  
1000 Rio Brazos Road  
Aztec, NM 87410

P. T. McGrath  
United States Geological Survey  
P. O. Box 965  
Farmington, NM 87401

The undersigned has no objection to Amoco's request for an unorthodox well location for its Bergin Gas Com No. 1-E to be located 1,835' FNL and 1,965' FWL of Section 21-T29N-R11W, San Juan County, New Mexico.

By:

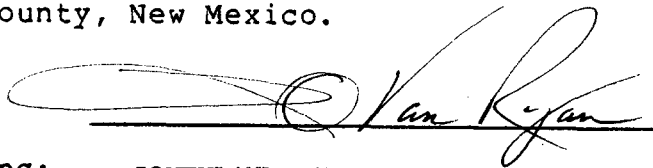

Representing: SOUTHLAND ROYALTY COMPANY

Dated: MAY 19, 1980

SB547

Joe D. Ramey, Director  
May 1, 1980  
Page Two

unorthodox location request. In this instance, Union Texas Petroleum, Southland Royalty Company, and Supron Energy Corporation (Southern Union) are affected offset operators. If there is no objection to this unorthodox location request, we ask that each of these three offset operators so signify on three (3) copies of this letter in the space provided below, sending one copy to you at the NMOCC, one copy to me, and retaining the third copy for their own files. In the absence of an objection from any of the affected offset operators within twenty (20) days, and provided you have no objection to this application, we shall appreciate receiving your administrative approval. Of course, if there is an objection, please set the matter for hearing.

Respectfully submitted,

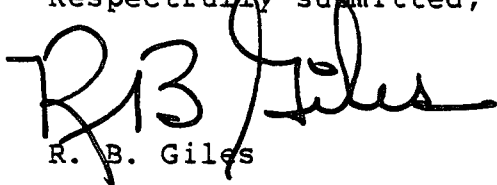
  
R. B. Giles

RBG/mlm

Enclosures

cc:  
Frank Chaves, Supervisor District III  
New Mexico Oil Conservation Commission  
1000 Rio Brazos Road  
Aztec, NM 87410

P. T. McGrath  
United States Geological Survey  
P. O. Box 965  
Farmington, NM 87401

The undersigned has no objection to Amoco's request for an unorthodox well location for its Bergin Gas Com No. 1-E to be located 1,835' FNL and 1,965' FWL of Section 21-T29N-R11W, San Juan County, New Mexico.

By:

Representing:

Dated:

  
UNION TEXAS PETROLEUM CORPORATION

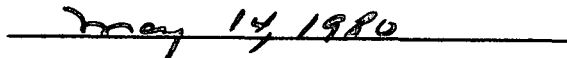

SB547



Joe D. Ramey, Director  
May 1, 1980  
Page Two

unorthodox location request. In this instance, Union Texas Petroleum, Southland Royalty Company, and Supron Energy Corporation (Southern Union) are affected offset operators. If there is no objection to this unorthodox location request, we ask that each of these three offset operators so signify on three (3) copies of this letter in the space provided below, sending one copy to you at the NMOCC, one copy to me, and retaining the third copy for their own files. In the absence of an objection from any of the affected offset operators within twenty (20) days, and provided you have no objection to this application, we shall appreciate receiving your administrative approval. Of course, if there is an objection, please set the matter for hearing.

Respectfully submitted,

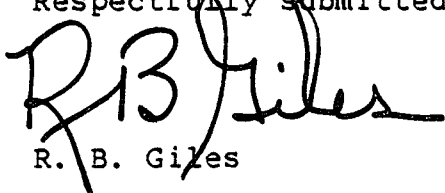
  
R. B. Giles

RBG/mlm

Enclosures

cc:  
Frank Chaves, Supervisor District III  
New Mexico Oil Conservation Commission  
1000 Rio Brazos Road  
Aztec, NM 87410

P. T. McGrath  
United States Geological Survey  
P. O. Box 965  
Farmington, NM 87401

The undersigned has no objection to Amoco's request for an unorthodox well location for its Bergin Gas Com No. 1-E to be located 1,835' FNL and 1,965' FWL of Section 21-T29N-R11W, San Juan County, New Mexico.

By:

SUPRON ENERGY CORPORATION

Representing:

  
Haskell Fleetwood, Vice President

Dated:

5/7/80

SB547

OIL CONSERVATION COMMISSION  
Albuquerque DISTRICT

OIL CONSERVATION COMMISSION  
BOX 2088  
SANTA FE, NEW MEXICO

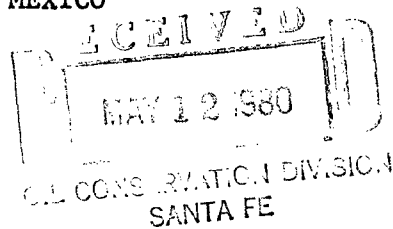

DATE May 8, 1980

RE: Proposed MC \_\_\_\_\_  
Proposed DHC \_\_\_\_\_  
Proposed NSL 2 \_\_\_\_\_  
Proposed SWD \_\_\_\_\_  
Proposed WFX \_\_\_\_\_  
Proposed PMX \_\_\_\_\_

Gentlemen:

I have examined the application dated May 5, 1980  
for the Alamosa Prod. Co. Bergin Gas Com #1E F-21-29N-11W  
Operator Lease and Well No. Unit, S-T-R

and my recommendations are as follows:

Approve.  
\_\_\_\_\_  
\_\_\_\_\_  
\_\_\_\_\_  
\_\_\_\_\_  
\_\_\_\_\_

Yours very truly,

Frank J. Davey