

14 May 07 DATE IN	DHC 3891 RESPONSE	W. Jones ENGINEER	14 May 07 LOGGED	PCLP0713440195 TYPE
----------------------	-------------------------	----------------------	---------------------	------------------------

ABOVE THIS LINE FOR DIVISION USE ONLY

NEW MEXICO OIL CONSERVATION DIVISION
- Engineering Bureau -

ADMINISTRATIVE APPLICATION COVERSHEET

THIS COVERSHEET IS MANDATORY FOR ALL ADMINISTRATIVE APPLICATIONS FOR EXCEPTIONS TO DIVISION RULES AND REGULATIONS

Application Acronyms:

[NSP-Non-Standard Proration Unit] [NSL-Non-Standard Location]
[DD-Directional Drilling] [SD-Simultaneous Dedication]
[DHC-Downhole Commingling] [CTB-Lease Commingling] [PLC-Pool/Lease Commingling]
[PC-Pool Commingling] [OLS - Off-Lease Storage] [OLM-Off-Lease Measurement]
[WFX-Waterflood Expansion] [PMX-Pressure Maintenance Expansion]
[SWD-Salt Water Disposal] [IPI-Injection Pressure Increase]
[EOR-Qualified Enhanced Oil Recovery Certification] [PPR-Positive Production Response]

[1] **TYPE OF APPLICATION** - Check Those Which Apply for [A]

[A] Location - Spacing Unit - Directional Drilling
NSL NSP DD SD

Check One Only for [B] and [C]

[B] Commingling - Storage - Measurement
☒ DHC CTB PLC PC OLS OLM

[C] Injection - Disposal - Pressure Increase - Enhanced Oil Recovery
WFX PMX SWD IPI EOR PPR

[2] **NOTIFICATION REQUIRED TO:** - Check Those Which Apply, or ☒ Does Not Apply

- [A] Working, Royalty or Overriding Royalty Interest Owners
- [B] Offset Operators, Leaseholders or Surface Owner
- [C] Application is One Which Requires Published Legal Notice
- [D] Notification and/or Concurrent Approval by BLM or SLO
U.S. Bureau of Land Management - Commissioner of Public Lands, State Land Office
- [E] For all of the above, Proof of Notification or Publication is Attached, and/or,
- [F] Waivers are Attached

[3] **INFORMATION / DATA SUBMITTED IS COMPLETE** - Statement of Understanding

I hereby certify that I, or personnel under my supervision, have read and complied with all applicable Rules and Regulations of the Oil Conservation Division. Further, I assert that the attached application for administrative approval is accurate and complete to the best of my knowledge and where applicable, verify that all interest (WI, RI, ORRI) is common. I understand that any omission of data, information or notification is cause to have the application package returned with no action taken.

Note: Statement must be completed by an individual with supervisory capacity.

Richard Jenkins		Petro. Engineer	5/7/2007
Print or Type Name	Signature	Title	Date

2007 MAY 14 AM 10 22



Richard A. Jenkins
Petroleum Engineer
New Mexico Team

Permian Business Unit
Chevron U.S.A. Inc.
15 Smith Road
Midland, TX 79705
Tel 432-631-3281
Fax 432-687-7871
rjdg@chevron.com

May 5, 2007

State of New Mexico
Oil Conservation Division
1220 South St. Francis Drive
Santa Fe, New Mexico 87504

Request to DHC the S.J. Sarkey 26 #2 (30-025-06792)

Attention: Oil and Gas Regulatory Department

Chevron U.S.A. Inc. respectfully requests administrative approval for an amendment to Downhole Commingle the Penrose Skelly Grayburg (50350) and the Blinbry Oil & Gas (06660) in the S.J. Sarkey 26 #2, API number is 30-025-06792. The #2 is located in the Penrose Skelly Pool, 660' FNL & 660' FWL, Unit D, Section 26, Township 21 South, Range 37 East, NMPM, Lea County, New Mexico.

The S.J. Sarkey 26 #2 was producing from the Blinbry formation, making 6BOPD, 1 BWPD, and 112 MCFGPD, prior to plugging back to the Penrose Skelly Grayburg. Chevron proposes to downhole commingle and produce both zones in the S.J. Sarkey 26 #2 by drilling the cast iron bridge plug, installing additional tubing, and then returning the well to production.

The proposed allocation percentages were calculated using production information from the S.J. Sarkey 26 #2. Attached in support of this request is a well test report, a proposed well schematic diagram for the #2, C107, a C102 form for each pool, and a lease plat.

Chevron is the operator, with 100% working interest in the lease, and the Royalty Interest Owners are the same on each well.

If you require additional information or have any questions, please contact me by telephone at 432-687-7120, or by email at rjdg@chevron.com.

Sincerely,

A handwritten signature in black ink that reads "Richard A. Jenkins". The signature is stylized with a large, sweeping "R" and "J".

Richard A Jenkins
Petroleum Engineer

Enclosure

cc: Denise Pinkerton

District I
1625 N. French Drive, Hobbs, NM 88240
District II
1301 W. Grand Avenue, Artesia, NM 88210
District III
1000 Rio Brazos Road, Aztec, NM 87410
Pools
District IV
1220 S. St. Francis Dr., Santa Fe, NM 87505

State of New Mexico
Energy, Minerals and Natural Resources Department

Form C-107A
Revised June 10, 2003

Oil Conservation Division
1220 South St. Francis Dr.
Santa Fe, New Mexico 87505

APPLICATION TYPE
X Single Well
___ Establish Pre-Approved

EXISTING WELLBORE
X Yes ___ No

APPLICATION FOR DOWNHOLE COMMINGLING

DHC-3891

Chevron Corporation 15 Smith Road, Midland TX 79705
Operator Address

S.J. Sarkey-26 #2 D-26-21S-37E Lea
Lease Well No. Unit Letter-Section-Township-Range County

OGRID No. 4323 Property Code 30030 API No. 30-025-06792 Lease Type: ___ Federal ___ State _X_ Fee

DATA ELEMENT	UPPER ZONE	INTERMEDIATE ZONE	LOWER ZONE
Pool Name	Penrose Skelly; Grayburg	-	Blinbry Oil & Gas
Pool Code	50350	-	06660
Top and Bottom of Pay Section (Perforated or Open-Hole Interval)	3674'-3876'	-	5519'-5822'
Method of Production (Flowing or Artificial Lift)	Artificial Lift	-	Zone Isolated, will be Artificial Lift, pending OCD approval.
Bottomhole Pressure (Note: Pressure data will not be required if the bottom perforation in the lower zone is within 150% of the depth of the top perforation in the upper zone)	NA	-	NA
Oil Gravity or Gas BTU (Degree API or Gas BTU)	NA	-	NA
Producing, Shut-In or New Zone	Producing	-	Shut-In
Date and Oil/Gas/Water Rates of Last Production. (Note: For new zones with no production history, applicant shall be required to attach production estimates and supporting data.)	Date: 4/8/2007 Oil Gas 11 BOPD 27 MCFPD	-	Date: 11/17/2006 Oil Gas 6 BOPD 112 MCFPD
Fixed Allocation Percentage (Note: If allocation is based upon something other than current or past production, supporting data or explanation will be required.)	Oil Gas 65% 20%	-	Oil Gas 35% 80%

ADDITIONAL DATA

Are all working, royalty and overriding royalty interests identical in all commingled zones? Yes X No ___
If not, have all working, royalty and overriding royalty interest owners been notified by certified mail? Yes ___ No ___
Are all produced fluids from all commingled zones compatible with each other? Yes X No ___
Will commingling decrease the value of production? Yes ___ No X
If this well is on, or communitized with, state or federal lands, has either the Commissioner of Public Lands
or the United States Bureau of Land Management been notified in writing of this application? Yes ___ No ___

NMOCD Reference Case No. applicable to this well: _____

Attachments:

- C-102 for each zone to be commingled showing its spacing unit and acreage dedication.
- Production curve for each zone for at least one year. (If not available, attach explanation.)
- For zones with no production history, estimated production rates and supporting data.
- Data to support allocation method or formula.
- Notification list of working, royalty and overriding royalty interests for uncommon interest cases.
- Any additional statements, data or documents required to support commingling.

PRE-APPROVED POOLS

If application is to establish Pre-Approved Pools, the following additional information will be required:

- List of other orders approving downhole commingling within the proposed Pre-Approved Pools
- List of all operators within the proposed Pre-Approved Pools
- Proof that all operators within the proposed Pre-Approved Pools were provided notice of this application.
- Bottomhole pressure data.

I hereby certify that the information above is true and complete to the best of my knowledge and belief.

SIGNATURE Richard A Jenkins TITLE Petroleum Engineer DATE 5/7/07

TYPE OR PRINT NAME Richard A Jenkins TELEPHONE NO. (432) 687-7120

E-MAIL ADDRESS rjdg@chevron.com

REQUEST FOR EXCEPTION TO RULE 303-A
FOR WELLS LOCATED IN PRE-APPROVED POOLS OR AREAS

Operator

Chevron U.S.A., Inc.
P. O. Box 1150
Midland, TX 79702

Lease Name and Well Number

S.J. Sarkey 26 #2
660' FNL & 660' FWL, Unit Letter D
Section 26, T21S, R37E
Lea County, New Mexico

Division Order

Pre-approved pools or area established by Division Order No. R-11363

Pools To Be Commingled In S.J. Sarkey 26 #2

(50350) Penrose Skelly; Grayburg
(06660) Blinebry Oil and Gas

Perforated Intervals

Penrose Skelly; Grayburg (3674'-3876')
Blinebry Oil and Gas (5519'-5822')

Location Plat

Attached

Well Test Report & Production Plots

Attached.

Product Characteristics And Value

Previous commingling of these zones by Chevron and other operators in the area have shown that the produced fluids are compatible and commingling will not cause formation damage or producing problems. Also, the price received by Chevron for products from these zones is very similar, so value will not be adversely affected.

Production Allocation

<u>Pool</u>	<u>BOPD</u>	<u>BWPD</u>	<u>MCFPD</u>	<u>Remarks</u>
Grayburg	11	121	27	S.J. Sarkey 26 #2 Well Test Report 4/8/2007
Blinebry	6	1	112	S.J. Sarkey 26 #2 Well Test Report 11/17/2006
Totals	17	122	139	

<u>Allocated %</u>	<u>Oil %</u>	<u>Water %</u>	<u>Gas %</u>	<u>Remarks</u>
Grayburg	64.71	99.18	19.42	Calculated using above production volumes
Blinebry	35.29	0.82	80.58	Calculated using above production volumes
Totals	100.00	100.00	100.00	

Ownership

Ownership of all zones is identical so correlative rights will not be compromised.

State / Federal Land Notification

Submit 3 Copies To Appropriate District Office
District I
1625 N. French Dr., Hobbs, NM 88240
District II
1301 W. Grand Ave., Artesia, NM 88210
District III
1000 Rio Brazos Rd., Aztec, NM 87410
District IV
1220 S. St. Francis Dr., Santa Fe, NM 87505

State of New Mexico
Energy, Minerals and Natural Resources

Form C-103
May 27, 2004

OIL CONSERVATION DIVISION
1220 South St. Francis Dr.
Santa Fe, NM 87505

WELL API NO. 30-025-06792
5. Indicate Type of Lease STATE <input type="checkbox"/> FEE <input checked="" type="checkbox"/>
6. State Oil & Gas Lease No.
7. Lease Name or Unit Agreement Name S.J. Sarkey 26
8. Well Number 2
9. OGRID Number 4323
10. Pool name or Wildcat Blinebry/Grayburg
11. Elevation (Show whether DR, RKB, RT, GR, etc.) 3395'

SUNDRY NOTICES AND REPORTS ON WELLS
(DO NOT USE THIS FORM FOR PROPOSALS TO DRILL OR TO DEEPEN OR PLUG BACK TO A DIFFERENT RESERVOIR. USE "APPLICATION FOR PERMIT" (FORM C-101) FOR SUCH PROPOSALS.)

1. Type of Well: ☒ Oil Well ☐ Gas Well ☐ Other

2. Name of Operator
Chevron U.S.A. Inc.

3. Address of Operator
15 Smith Road Midland, TX 79705

4. Well Location
Unit Letter **D** : **660** feet from the **North** line and **660** feet from the **West** line
Section **26** Township **21S** Range **37E** NMPM County **LEA**

Pit or Below-grade Tank Application ☐ or Closure ☐

Pit type _____ Depth to Groundwater _____ Distance from nearest fresh water well _____ Distance from nearest surface water _____

Pit Liner Thickness: _____ mil Below-Grade Tank: Volume _____ bbls; Construction Material _____

12. Check Appropriate Box to Indicate Nature of Notice, Report or Other Data

NOTICE OF INTENTION TO:	SUBSEQUENT REPORT OF:
PERFORM REMEDIAL WORK <input type="checkbox"/>	REMEDIAL WORK <input type="checkbox"/>
TEMPORARILY ABANDON <input type="checkbox"/>	COMMENCE DRILLING OPNS. <input type="checkbox"/>
PULL OR ALTER CASING <input type="checkbox"/>	CASING/CEMENT JOB <input type="checkbox"/>
OTHER: DHC Penrose Skelly; Grayburg\Blinebry Oil & Gas <input checked="" type="checkbox"/>	OTHER: <input type="checkbox"/>

13. Describe proposed or completed operations. (Clearly state all pertinent details, and give pertinent dates, including estimated date of starting any proposed work). SEE RULE 1103. For Multiple Completions: Attach wellbore diagram of proposed completion or recompletion.

IT IS PROPOSED TO DOWNHOLE COMMINGLE POOLS, PENROSE SKELLY GRAYBURG (PERFS 3674'-3876'), AND BLINEBRY OIL & GAS (5519'-5822') IN THE CAPTIONED WELL. PRODUCTION WILL BE ALLOCATED BACK TO THE TWO POOLS BASED ON THE PERCENTAGES SHOWN IN THE ATTACHED SUPPORT DATA.

I hereby certify that the information above is true and complete to the best of my knowledge and belief. I further certify that any pit or below-grade tank has been/will be constructed or closed according to NMOCD guidelines ☐, a general permit ☐ or an (attached) alternative OCD-approved plan ☐.

SIGNATURE  TITLE PETR. ENGINEER DATE 05/1/2007

Type or print name _____ E-mail address: _____ Telephone No. _____
For State Use Only

APPROVED BY: _____ TITLE _____ DATE _____
Conditions of Approval (if any): _____

District I
1625 N. French Dr., Hobbs, NM 88240

District II
811 South First, Artesia, NM 88210

District III
1000 Rio Brazos Rd., Aztec, NM 87410

District IV
2040 South Pacheco, Santa Fe, NM 87505

State of New Mexico
Energy, Minerals & Natural Resources Department

Form C-102
Revised March 17, 1999

OIL CONSERVATION DIVISION

2040 South Pacheco
Santa Fe, NM 87505

Submit to Appropriate District Office
State Lease - 4 Copies
Fee Lease - 3 Copies

☐ AMENDED REPORT

WELL LOCATION AND ACREAGE DEDICATION PLAT

¹ API Number 30-025-06792		² Pool Code 50350		³ Pool Name Penrose Skelly Grayburg	
⁴ Property Code 30030		⁵ Property Name Sarkey, S.J. -26-			⁶ Well Number 2
⁷ OGRID No. 4323		⁸ Operator Name Chevron U.S.A., Inc.			⁹ Elevation 3395'

¹⁰ Surface Location

UL or Lot No.	Section	Township	Range	Lot Idn	Feet from the	North/South line	Feet from the	East/West line	County
D	26	21S	37E		660	North	660	West	Lea

¹¹ Bottom Hole Location If Different From Surface

UL or Lot No.	Section	Township	Range	Lot Idn	Feet from the	North/South line	Feet from the	East/West line	County
¹² Dedicated Acres 40		¹³ Joint or Infill	¹⁴ Consolidation Code		¹⁵ Order No.				

NO ALLOWABLE WILL BE ASSIGNED TO THIS COMPLETION UNTIL ALL INTERESTS HAVE BEEN CONSOLIDATED OR A NON-STANDARD UNIT HAS BEEN APPROVED BY THE DIVISION

<div><div>16</div><div>660'</div><div>#2</div><div>660'</div><div>40-acre proration</div></div>				<div><div>17</div><div>OPERATOR CERTIFICATION</div><div>I hereby certify that the information contained herein is true and complete to the best of my knowledge and belief.</div><div><div>Signature</div><div>Richard A. Jenkins</div></div><div><div>Printed Name</div><div>Petr. Engineer</div></div><div><div>Title</div><div>5/7/2007</div></div></div>			
<div>26</div>				<div><div>18</div><div>SURVEYOR CERTIFICATION</div><div>I hereby certify that the well location shown on this plat was plotted from field notes of actual surveys made by me or under my supervision, and that the same is true and correct to the best of my belief.</div><div>Signature and Seal of Professional Surveyor:</div><div>Certificate Number</div></div>			

District I
1625 N. French Dr., Hobbs, NM 88240

District II
811 South First, Artesia, NM 88210

District III
1000 Rio Brazos Rd., Aztec, NM 87410

District IV
2040 South Pacheco, Santa Fe, NM 87505

State of New Mexico
Energy, Minerals & Natural Resources Department

Form C-102
Revised March 17, 1999

OIL CONSERVATION DIVISION
2040 South Pacheco
Santa Fe, NM 87505

Submit to Appropriate District Office
State Lease - 4 Copies
Fee Lease - 3 Copies

☐ AMENDED REPORT

WELL LOCATION AND ACREAGE DEDICATION PLAT

¹ API Number 30-025-06792		² Pool Code 06660		³ Pool Name Blinebry Oil & Gas (Oil)	
⁴ Property Code 30030		⁵ Property Name Sarkey, S.J. -26-			⁶ Well Number 2
⁷ OGRID No. 4323		⁸ Operator Name Chevron U.S.A., Inc.			⁹ Elevation 3395'

¹⁰ Surface Location

UL or Lot No.	Section	Township	Range	Lot Idn	Feet from the	North/South line	Feet from the	East/West line	County
D	26	21S	37E		660	North	660	West	Lea

¹¹ Bottom Hole Location If Different From Surface

UL or Lot No.	Section	Township	Range	Lot Idn	Feet from the	North/South line	Feet from the	East/West line	County
¹² Dedicated Acres 40		¹³ Joint or Infill	¹⁴ Consolidation Code	¹⁵ Order No.					

NO ALLOWABLE WILL BE ASSIGNED TO THIS COMPLETION UNTIL ALL INTERESTS HAVE BEEN CONSOLIDATED OR A NON-STANDARD UNIT HAS BEEN APPROVED BY THE DIVISION

<div><div>16</div><div>660'</div><div>#2</div><div>660'</div><div>40-acre proration unit</div></div>				<div><div>17</div><div>OPERATOR CERTIFICATION</div><div>I hereby certify that the information contained herein is true and complete to the best of my knowledge and belief.</div><div><div>Signature</div><div></div><div>Richard A. Jenkins</div><div>Printed Name</div><div>Petr. Engineer</div><div>Title</div><div>5/7/2007</div></div></div>			
<div><div>26</div></div>				<div><div>18</div><div>SURVEYOR CERTIFICATION</div><div>I hereby certify that the well location shown on this plat was plotted from field notes of actual surveys made by me or under my supervision, and that the same is true and correct to the best of my belief.</div><div>Signature and Seal of Professional Surveyor:</div><div></div><div>Certificate Number</div></div>			

Well: S.J. Sarkey 26 #2

Reservoir: Grayburg

Location:
660' FNL & 660' FWL
Section: 26
Township: 21S
Range: 37E
County: Lea, NM.

Elevations:
GL: 3395'
DF:
KB: 8'

Squeeze perfs @ 3650' (8 holes) -
385 sks, returns to surfac but no
cmt - 12/14/06

Cmt Retainer @ 3985'

Squeeze perfs @ 4010 (8 holes) -
150 sks, not circulated 12/12/06

CIBP @ 5450' w/ cmt on top

CIBP @ 6310' w/ 35' cmt

Baker Model D @ 6320'

CIBP @ 6520' w/ 15' cmt

COTD: 3985'
PBSD: 3985'
TD: 6603'

Updated: 3/16/2007

Current

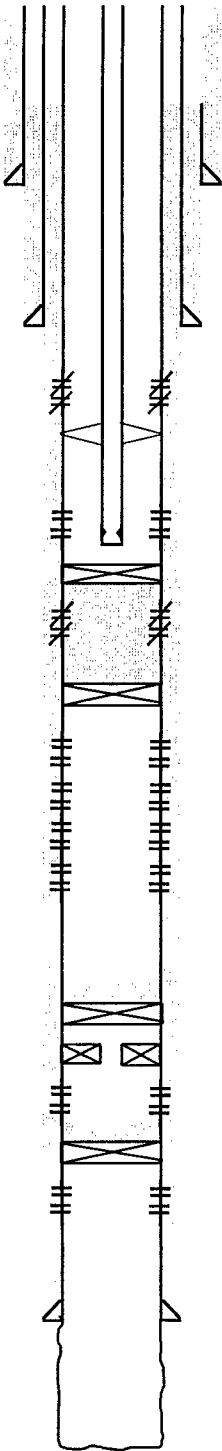

Well ID Info:
Refno: FA7889
API No: 30-025-06792
L5/L6: UCU466800
Spud Date:
Compl. Date:

Surface Csg: 13-3/8" 36#
Set: @ 290' w/ 300 sks
Hole Size: 17-1/4"
Circ: Yes
TOC By: Cir by Calc

Interm Csg: 8-5/8" 32#
Set: @ 2799' w/ 1400 sks
Hole Size: 11"
Circ: ?
TOC By: Cir by Calc

TAC @ 3577'

Perfs	Status
3674'-3876'	Graybug - Open

Perfs	Status	
5519'-5529'	Blinebry - Below CIBP	2 SPF
5532'-5551'	Blinebry - Below CIBP	
5554'-5558'	Blinebry - Below CIBP	
5742'-5749'	Blinebry - Below CIBP	1, 3/8" Jet Shot
5766'-5771'	Blinebry - Below CIBP	
5782'-5789'	Blinebry - Below CIBP	
5807'-5814'	Blinebry - Below CIBP	
5822'	Blinebry - Below CIBP	

Perfs	Status
6416'-6480'	Drinkard - Below CIBP

Perfs	Status
6532'-6554'	Drinkard - Below CIBP

Prod Csg: 5-1/2" 17#
Set: @ 6559' w/ 500 sks
Hole Size: 7-7/8"
Circ: See notes above
TOC By:

Open Hole: 4-3/4", 6559'-6603'

By: rjdg

This wellbore diagram is based on the most recent information regarding wellbore configuration and equipment that could be found in the Midland Office well files and computer databases as of the update date below. Verify what is in the hole with the well file in the Eureka Field Office. Discuss with WED Engineer, WO Rep, OS, ALS, & FS prior to rigging up on well regarding any hazards or unknown issues pertaining to the well.

Well: S.J. Sarkey 26 #2

Reservoir: Grayburg/Blinebry

Location:
660' FNL & 660' FWL
Section: 26
Township: 21S
Range: 37E
County: Lea, NM.

Elevations:
GL: 3395'
DF:
KB: 8'

Squeeze perfs @ 3650' (8 holes) -
385 sks, returns to surfac but no
cmt - 12/14/06

Squeeze perfs @ 4010 (8 holes) -
150 sks, not circulated 12/12/06

CIBP @ 6310' w/ 35' cmt

Baker Model D @ 6320'

CIBP @ 6520' w/ 15' cmt

COTD: 3985'
PBSD: 3985'
TD: 6603'

Updated: 3/16/2007

Proposed

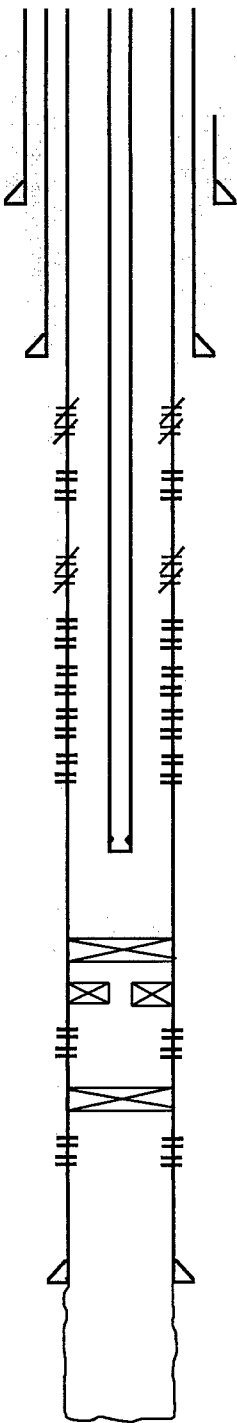

Well ID Info:
Refno: FA7889
API No: 30-025-06792
LS/L6:
Spud Date:
Compl. Date:

Surface Csg: 13-3/8" 36#
Set: @ 290' w/ 300 sks
Hole Size: 17-1/4"
Circ: Yes
TOC By: Cir by Calc

Interm Csg: 8-5/8" 32#
Set: @ 2799' w/ 1400 sks
Hole Size: 11"
Circ: ?
TOC By: Cir by Calc

Perfs	Status
3674'-3876'	Graybug - Open

Perfs	Status	
5519'-5529'	Blinebry - Open	2 SPF
5532'-5551'	Blinebry - Open	
5554'-5558'	Blinebry - Open	
5742'-5749'	Blinebry - Open	1, 3/8" Jet Shot
5766'-5771'	Blinebry - Open	
5782'-5789'	Blinebry - Open	
5807'-5814'	Blinebry - Open	
5822'	Blinebry - Open	

Perfs	Status
6416'-6480'	Drinkard - Below CIBP

Perfs	Status
6532'-6554'	Drinkard - Below CIBP

Prod Csg: 5-1/2" 17#
Set: @ 6559' w/ 500 sks
Hole Size: 7-7/8"
Circ: See notes above
TOC By:

Open Hole: 4-3/4", 6559'-6603'

By: rjdg

This wellbore diagram is based on the most recent information regarding wellbore configuration and equipment that could be found in the Midland Office well files and computer databases as of the update date below. Verify what is in the hole with the well file in the Eunice Field Office. Discuss w/ WED Engineer, WO Rep OS, ALS & FS prior to rigging up on well regarding any hazards or unknown issues pertaining to the well.

WELL TEST REPORT

Lease: SARKEYS, S. J.
Well: 2

Field: BLINEBRY OIL & GAS
Field Code: U46
Unique Code: UCU466800
Wellbore: 427884

Reservoir: BLINEBRY
Resv Code: 0000004532
Battery: SJ SARKEY 26
API No: 300250679200

Test Date	BOPD	BWPD	MCFPD	Tbg PSI	GOR	% Oil	Comp No.	Status	Remarks	Fluid Level	Fld Lvl Date	BTFPD
4/8/07	11	121	27		2482	8.3	03	PR		3401	4/8/07	132
4/7/07	11	130	28		2571	7.8	03	PR		3028	2/25/07	141
3/5/07	12	135	36		3007	8.2	03	PR		3375	2/8/07	147
3/1/07	13	120	47		3600	9.8	03	PR		3375	2/8/07	133
2/23/07	18	127	44		2438	12.4	03	PR		3375	2/8/07	145
2/14/07	24	145	50		2072	14.2	03	PR		3375	2/8/07	169
2/13/07	21	200	44		2090	9.5	03	PR		3375	2/8/07	221
2/12/07	19	160	48		2515	10.6	03	PR		3375	2/8/07	179
2/11/07	20	220	52		2584	8.3	03	PR	Grayburg Production	3375	2/8/07	240
2/10/07	28	240	61		2194	10.4	03	PR		3675	2/8/07	268
2/9/07	27	222	37		1372	10.8	03	PR		3675	2/8/07	249
2/8/07	52	320	39		750	14.0	03	PR		3063	2/7/07	372
2/7/07	20	254	32		1609	7.3	03	PR		3063	2/7/07	274
2/6/07	0	220	17		#DIV/0!	0.0	03	PR				220
2/5/07	22	228	4		177	8.8	03	PR				250
2/4/07	5	244	30		6046	2.0	03	PR				249
2/3/07	38	431	47		1232	8.1	03	PR				469
2/2/07	40	344	98		2438	10.4	03	PR				384
11/17/06	6	1	112	35	18667	88.2	01	PR		5864	6/14/06	7
10/14/06	5	0	84	35	16800	100.0	01	PR		5864	6/14/06	5
7/7/06	6	1	113	35	18833	92.3	01	PR		5864	6/14/06	7
6/9/06	5	1	100	35	20000	90.9	01	PR		5864	6/14/06	6
5/11/06	6	0	98	35	16333	93.8	01	PR		5864	3/14/06	6
4/11/06	8	1	124	35	16533	93.8	01	PR		5864	3/14/06	8
3/26/06	9	0	128	35	14222	100.0	01	PR		5864	3/14/06	9
2/21/06	7	0	125	35	17857	100.0	01	PR	Blinebry Production	5864	12/14/05	7
1/12/06	7	1	120	35	17143	93.3	01	PR		5864	12/14/05	8
12/12/05	6	1	120	35	20000	85.7	01	PR		5864	12/14/05	7
11/8/05	5	1	109	35	21800	83.3	01	PR		5864	10/14/05	6
10/14/05	6	2	129	35	23455	73.3	01	PR		5864	10/14/05	8
9/14/05	5	2	130	35	26000	71.4	01	PR		5864	8/28/05	7
8/5/05	5	1	127	35	25400	83.3	01	PR		5864	8/28/05	6
7/15/05	6	1	122	35	20333	85.7	01	PR		5653	7/27/05	7
6/8/05	5	1	121	35	24200	90.9	01	PR		5653	3/27/05	6

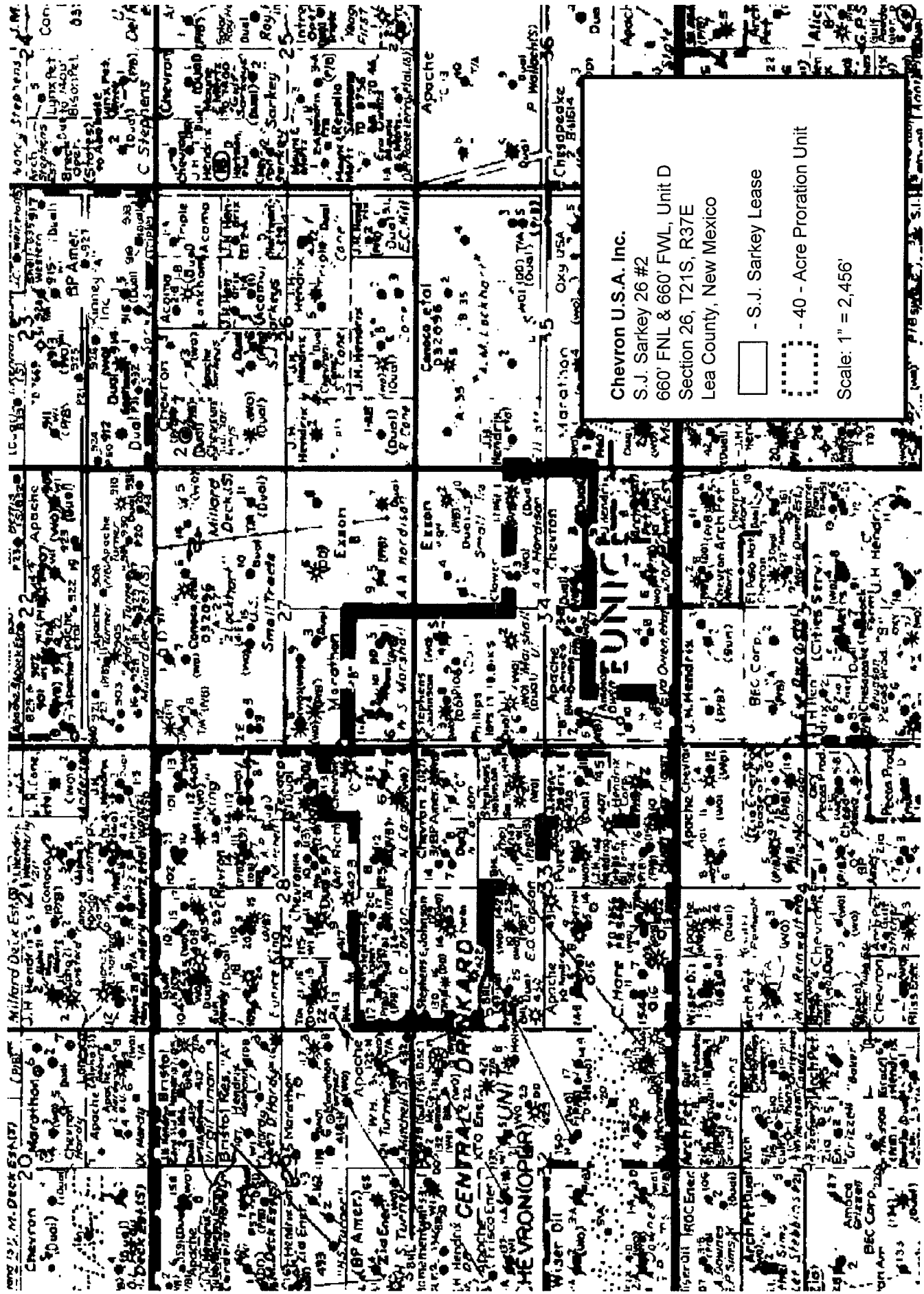

Chevron U.S.A. Inc.

S.J. Sarkey 26 #2

660' FNL & 660' FWL, Unit D

Section 26, T21S, R37E

Lea County, New Mexico

— S.J. Sarkey Lease

- - - 40 - Acre Proration Unit

Scale: 1" = 2,456'