



dugan production corp.

NSL - 1210

June 3, 1980

NSL - 1210
Rule 3 R-1670
See page 3 for details
6-25-80

Joe D. Ramey
Division Director
New Mexico Oil Conservation Division
Box 2088
Santa Fe, NM 87501

Re: Application for Administrative
Approval of Unorthodox Location
for the Lively #18E Well

Dear Mr. Ramey:

Basin Dakota
Grass

Enclosed please find three copies of the Application for Administrative Approval of the Unorthodox Location for the Lively #18E Well, which application includes a plat showing the ownership of all leases offsetting this spacing unit for which the unorthodox location is sought, and all wells completed thereon, and a plat showing the existent topographical conditions of the well location. Also enclosed are copies of the dedicated acreage plat.

Copies of this application are being submitted to all offset operators by certified mail with a request that they furnish your office with a waiver of objection.

Please advise if you need further information.

Sincerely,

Sherman E. Dugan
Agent for Applicant

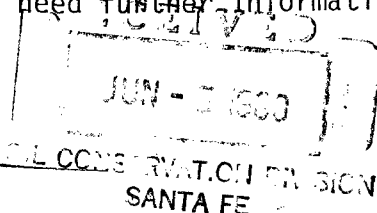

pb

Enclosures

xc: Frank Chavez
New Mexico Oil Conservation Division
1000 Rio Brazos Rd.
Aztec, NM 87410

James Sims
U. S. Geological Survey
P.O. Box 959
Farmington, NM 87401

K. G. Ranum
Depco, Inc.
1000 Petroleum Bldg.
110 16th St.
Denver, CO 80202

D. N. Canfield
Landman
El Paso Natural Gas Co.
Box 1492
El Paso, TX 79978

Tom Burdette
District Land Manager
Atlantic Richfield Co.
555 17th St.
Box 5300
Denver, CO 80202

Bill Curtis
Vice President, Land
Supron Energy Corp.
Bldg 5 Fifth Floor
10300 N. Central Expressway
Dallas, TX 75231

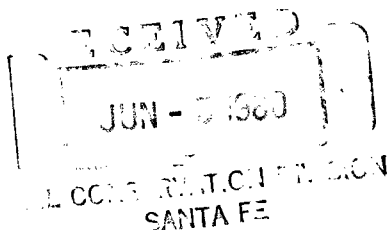

APPLICATION FOR ADMINISTRATIVE APPROVAL
OF UNORTHODOX LOCATION

Applicant: Lively Exploration Co.
1010 First City National Bank Bldg.
Houston, TX 77002

Name of Well: Lively #18E

Land Dedicated to Well: Township 26 North Range 8 West, NMPM
Section 1: W/2

Proposed Unorthodox Location: Township 26 North Range 8 West, NMPM
Section 1 : 410' FNL - 750' FWL
Unit Letter: D
San Juan County, New Mexico

Reason for Unorthodox Location: Topographic conditions identified by
the Bureau of Land Management.
Standard location would place well on
tip of ridge.

Offsetting Leases and Operators: See Exhibit "A" hereto and
incorporated herein by reference.

Existent Topographic Conditions: See Exhibit "B" hereto and
incorporated herein by reference.

New Mexico Oil Conservation
Division Rule Authorizing
Application: Rule 104-F

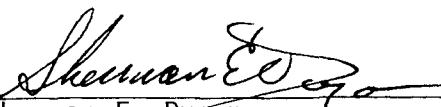
By: 
Sherman E. Dugan
Agent for Applicant

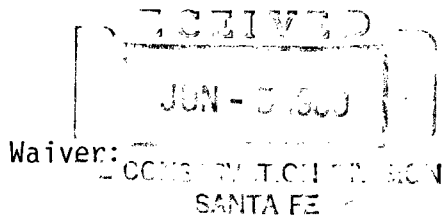

Waiver: _____
OIL CONSERVATION DIVISION
SANTA FE

_____ hereby acknowledges receipt of the Application for
Administrative Approval of Unorthodox Location filed by Lively Exploration Company
herein and hereby waives objection to the Lively #18E Well as proposed herein.

By: _____

Date: _____

NEW MEXICO OIL CONSERVATION COMMISSION
WELL LOCATION AND ACREAGE DEDICATION LAT

Form C-102
Supersedes C-128
Effective 1-1-65

All distances must be from the outer boundaries of the Section.

Operator Lively Exploration Company			Lease Lively			Well No. 118E
Unit Letter D	Section 1	Township 26 North	Range 8 West	County San Juan		
Actual Footage Location of Well: 410 feet from the North line and 750 feet from the West line						
Ground Level Elev. 6220	Producing Formation Dakota		Pool Basin		Dedicated Acreage: 320 Acres	

1. Outline the acreage dedicated to the subject well by colored pencil or hatchure marks on the plat below.
2. If more than one lease is dedicated to the well, outline each and identify the ownership thereof (both as to working interest and royalty).
3. If more than one lease of different ownership is dedicated to the well, have the interests of all owners been consolidated by communitization, unitization, force-pooling, etc?

☐ Yes ☐ No If answer is "yes," type of consolidation _____

If answer is "no," list the owners and tract descriptions which have actually been consolidated. (Use reverse side of this form if necessary.) _____

No allowable will be assigned to the well until all interests have been consolidated (by communitization, unitization, forced-pooling, or otherwise) or until a non-standard unit, eliminating such interests, has been approved by the Commission.

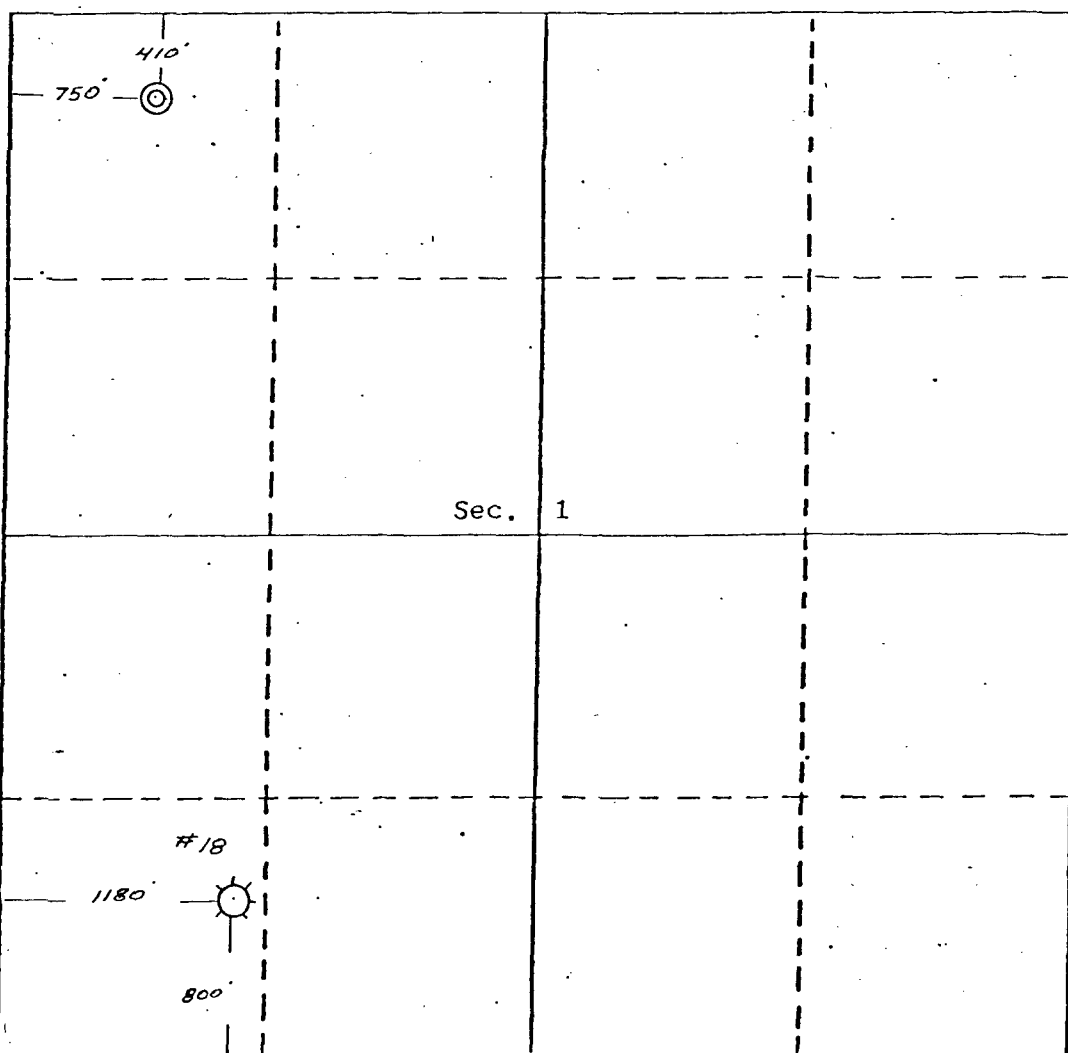

CERTIFICATION

I hereby certify that the information contained herein is true and complete to the best of my knowledge and belief.

Sherman E. Dugan

Name

Sherman E. Dugan

Position

Agent for Applicant

Company

Lively Exploration Co.

Date

6-3-80

I hereby certify that the well location shown on this plat was plotted from field notes of actual surveys made by me or under my supervision, and that the same is true and correct to the best of my knowledge and belief.

Date Surveyed

March 28, 1980

Registered Professional Engineer and/or Land Surveyor

Edgar L. Risenhoover

Certificate No. 5979

Edgar L. Risenhoover, L.S.

0 330 660 990 1320 1650 1980 2310 2640 2970 3300 3630 3960 4290 4620 4950 5280 5610 5940 6270 6600

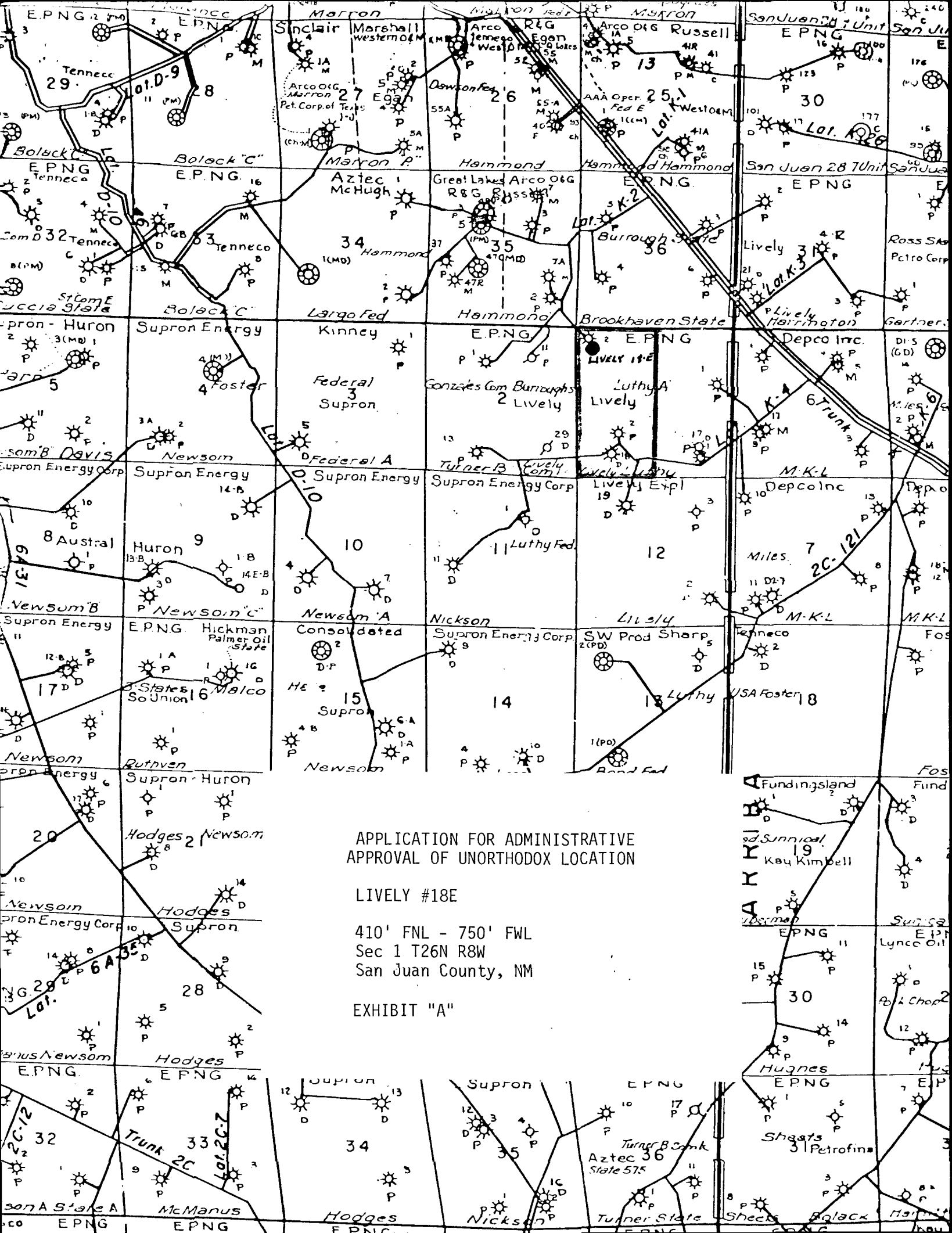

APPLICATION FOR ADMINISTRATIVE
APPROVAL OF UNORTHODOX LOCATION

LIVELY #18E

410' FNL - 750' FWL
Sec 1 T26N R8W
San Juan County, NM

EXHIBIT "A"

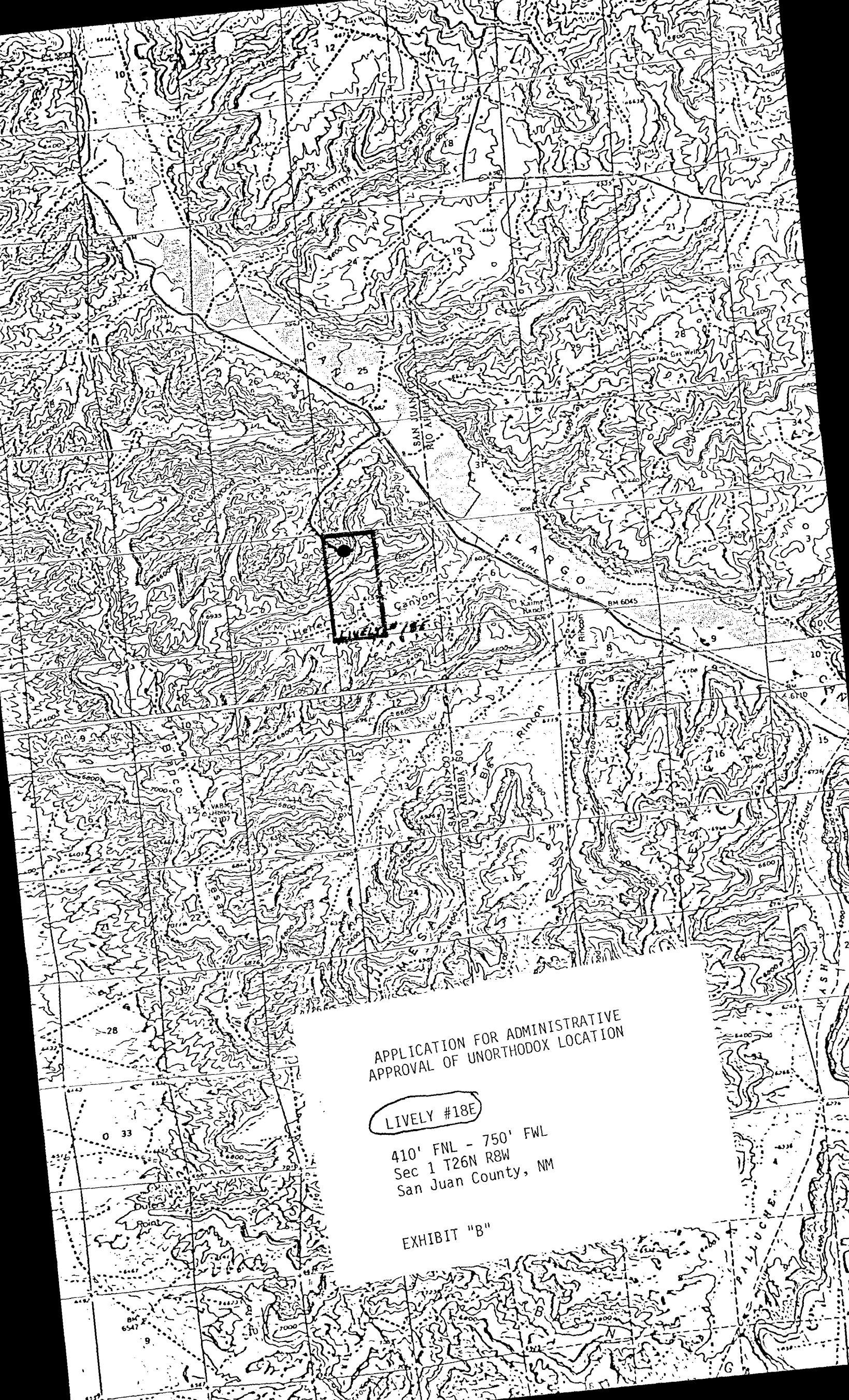

APPLICATION FOR ADMINISTRATIVE
APPROVAL OF UNORTHODOX LOCATION

LIVELY #18E

410' FNL - 750' FWL
Sec 1 T26N R8W
San Juan County, NM

EXHIBIT "B"

NEW MEXICO OIL CONSERVATION COMMISSION
WE LOCATION AND ACREAGE DEDICATION PLAT

Form C-102
Supersedes C-120
Effective 1-1-65

All distances must be from the outer boundaries of the Section.

Operator Lively Exploration Company		Lease			
Unit Letter N	Section 12	Township 26 North	Range 8 West	County San Juan	
Actual Footage Location of Well: 310 feet from the South line and 2390 feet from the West line					
Ground Level Elev. 6325	Producing Formation Dakota		Pool Basin	Dedicated Acreage: 320 Acres	

1. Outline the acreage dedicated to the subject well by colored pencil or hatchure marks on the plat below.
2. If more than one lease is dedicated to the well, outline each and identify the ownership thereof (both as to working interest and royalty).
3. If more than one lease of different ownership is dedicated to the well, have the interests of all owners been consolidated by communitization, unitization, force-pooling, etc?

☐ Yes ☐ No If answer is "yes," type of consolidation _____

If answer is "no," list the owners and tract descriptions which have actually been consolidated. (Use reverse side of this form if necessary.) _____

No allowable will be assigned to the well until all interests have been consolidated (by communitization, unitization, forced-pooling, or otherwise) or until a non-standard unit, eliminating such interests, has been approved by the Commission.

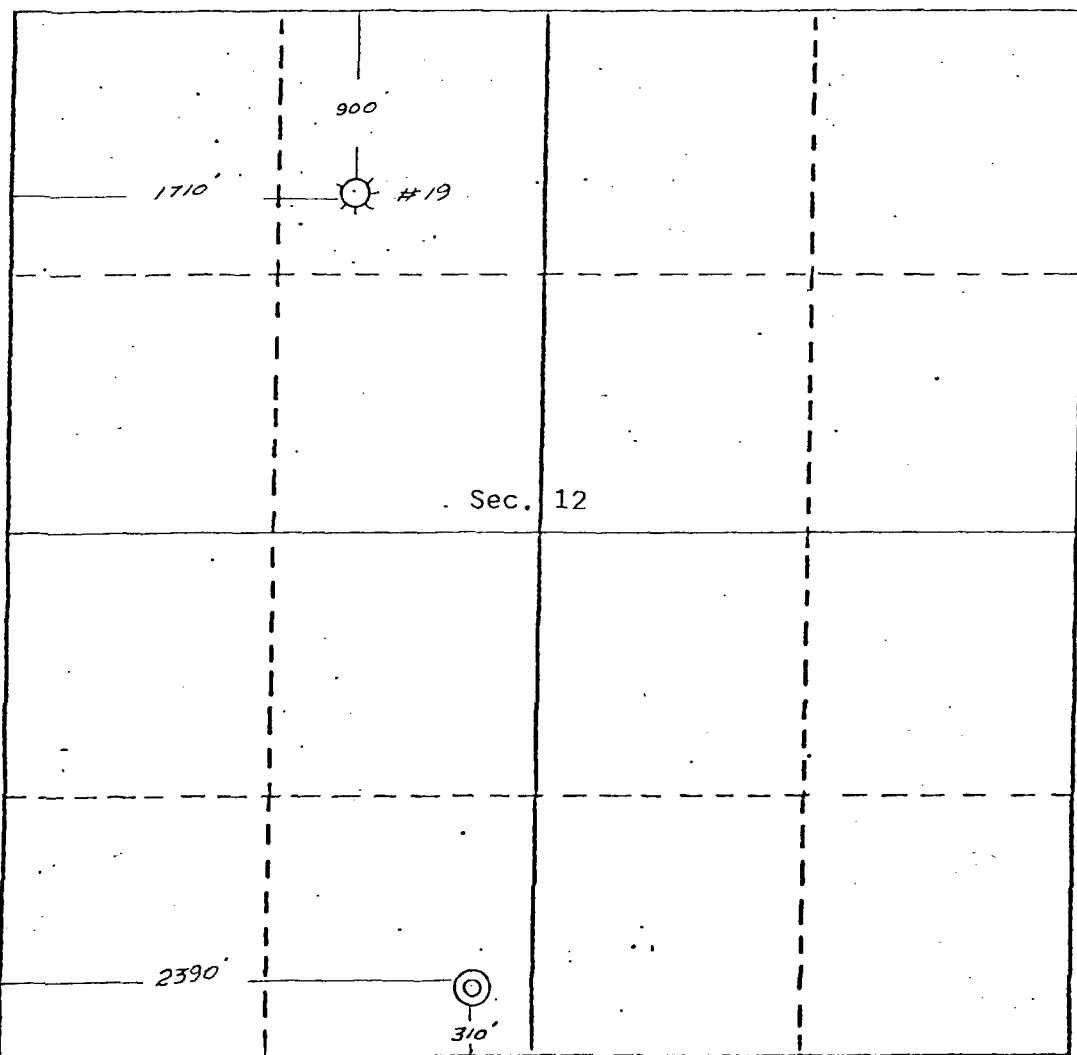

CERTIFICATION

I hereby certify that the information contained herein is true and complete to the best of my knowledge and belief.

Sherman E. Dugan
Name Sherman E. Dugan

Position Agent for Applicant

Company Lively Exploration Co.

Date 6-3-80

Edgar L. Risenhoover
I hereby certify that the well location shown on this plat was plotted from field notes of actual surveys made by me or under my supervision, and that the same are true and correct to the best of my knowledge and belief.

Date Surveyed April 3, 1980

Registered Professional Engineer and/or Land Surveyor

Edgar L. Risenhoover
Certificate No. 5919
Edgar L. Risenhoover, L.S.

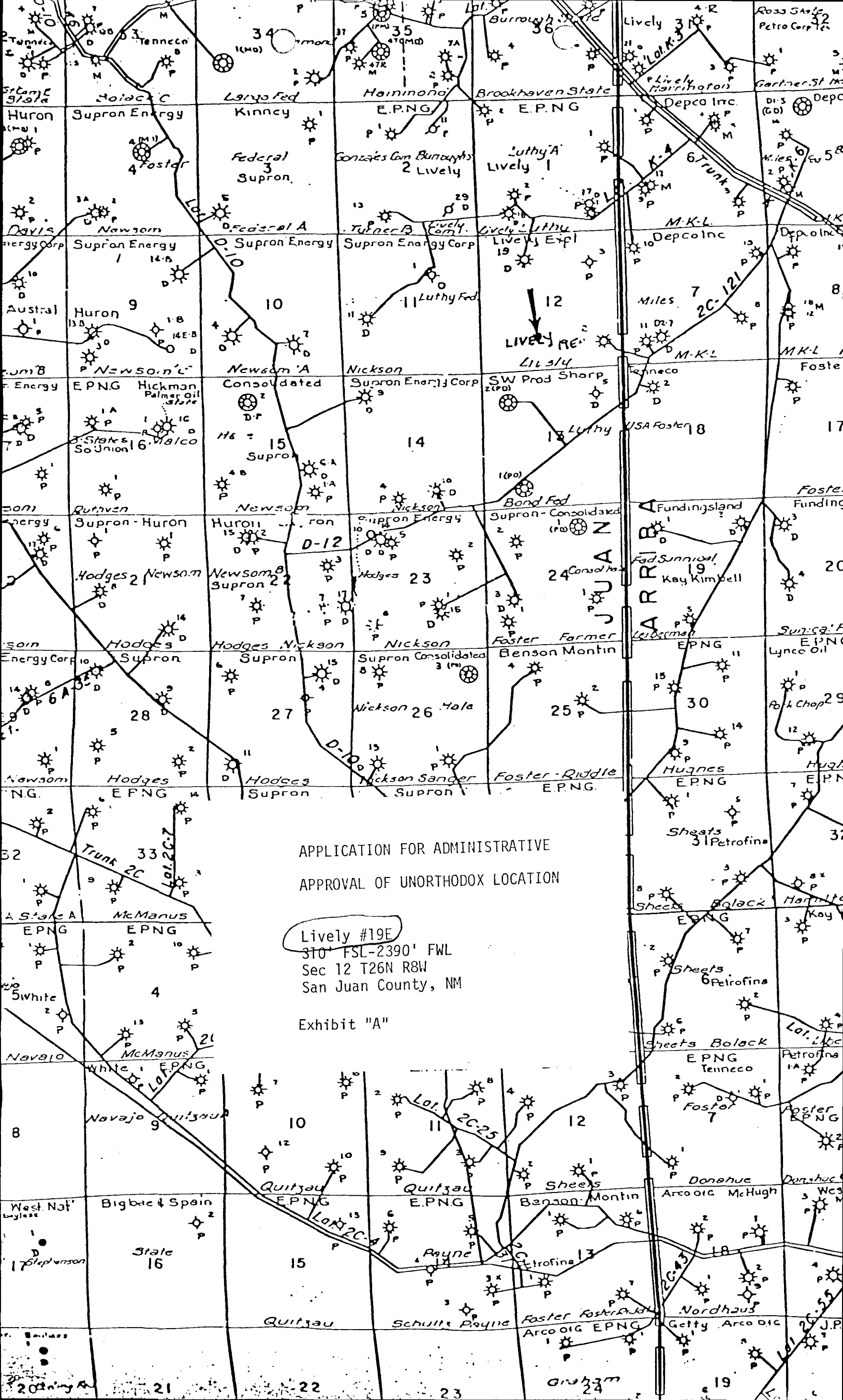

APPLICATION FOR ADMINISTRATIVE
APPROVAL OF UNORTHODOX LOCATION

Lively #19E
310' FSL-2390' FWL
Sec 12 T26N R8W
San Juan County, NM

Exhibit "A"

NEW MEXICO OIL CONSERVATION COMMISSION
WELL LOCATION AND ACREAGE DEDICATION PLAT

Form C-102
Supersedes C-128
Effective 1-1-65

All distances must be from the outer boundaries of the Section.

Operator Jerome P. McHugh		Lease Jicarilla		Well No. 32-8E	
Unit Letter I	Section 32	Township 26 North	Range 4 West	County Rio Arriba	
Actual Footage Location of Well: 2170 feet from the South line and 920 feet from the East line					
Ground Level Elev. 6778	Producing Formation Dakota		Pool Basin		Dedicated Acreage: 320 Acres

1. Outline the acreage dedicated to the subject well by colored pencil or hachure marks on the plat below.
2. If more than one lease is dedicated to the well, outline each and identify the ownership thereof (both as to working interest and royalty).
3. If more than one lease of different ownership is dedicated to the well, have the interests of all owners been consolidated by communitization, unitization, force-pooling, etc?

☐ Yes ☐ No If answer is "yes," type of consolidation _____

If answer is "no," list the owners and tract descriptions which have actually been consolidated. (Use reverse side of this form if necessary.) _____

No allowable will be assigned to the well until all interests have been consolidated (by communitization, unitization, forced-pooling, or otherwise) or until a non-standard unit, eliminating such interests, has been approved by the Commission.

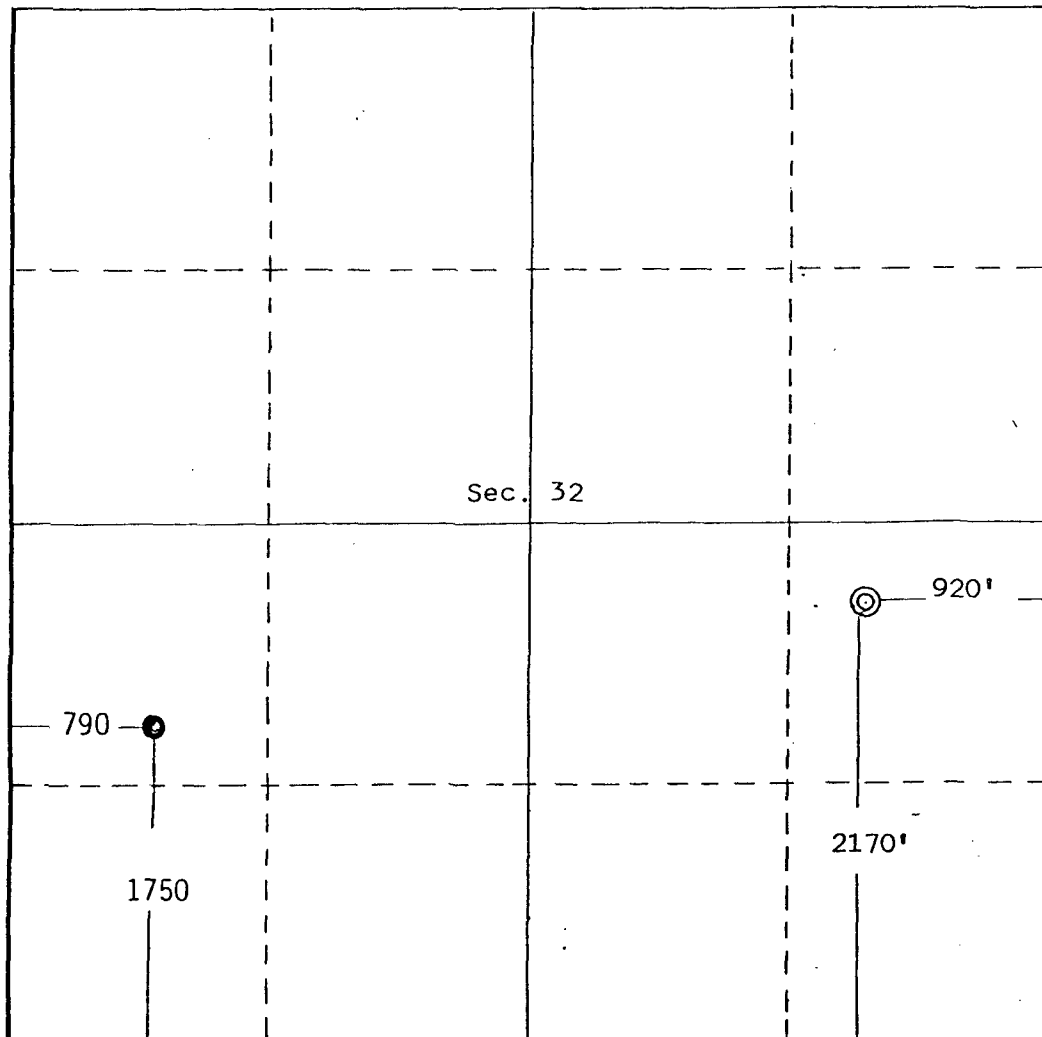

CERTIFICATION

I hereby certify that the information contained herein is true and complete to the best of my knowledge and belief.

Sherman E. Dugan
Name
Sherman E. Dugan

Position
Agent

Company
Jerome P. McHugh

Date
6-3-80

I hereby certify that the well location shown on this plat was plotted from field notes of actual surveys made by me or under my supervision, and that the same is true and correct to the best of my knowledge and belief.

Date Surveyed
March 22, 1980

Registered Professional Engineer and/or Land Surveyor

Edgar L. Risenhoover
Certificate No. **5979**

Edgar L. Risenhoover, L.S.

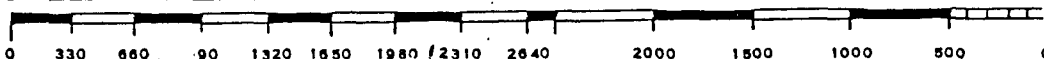

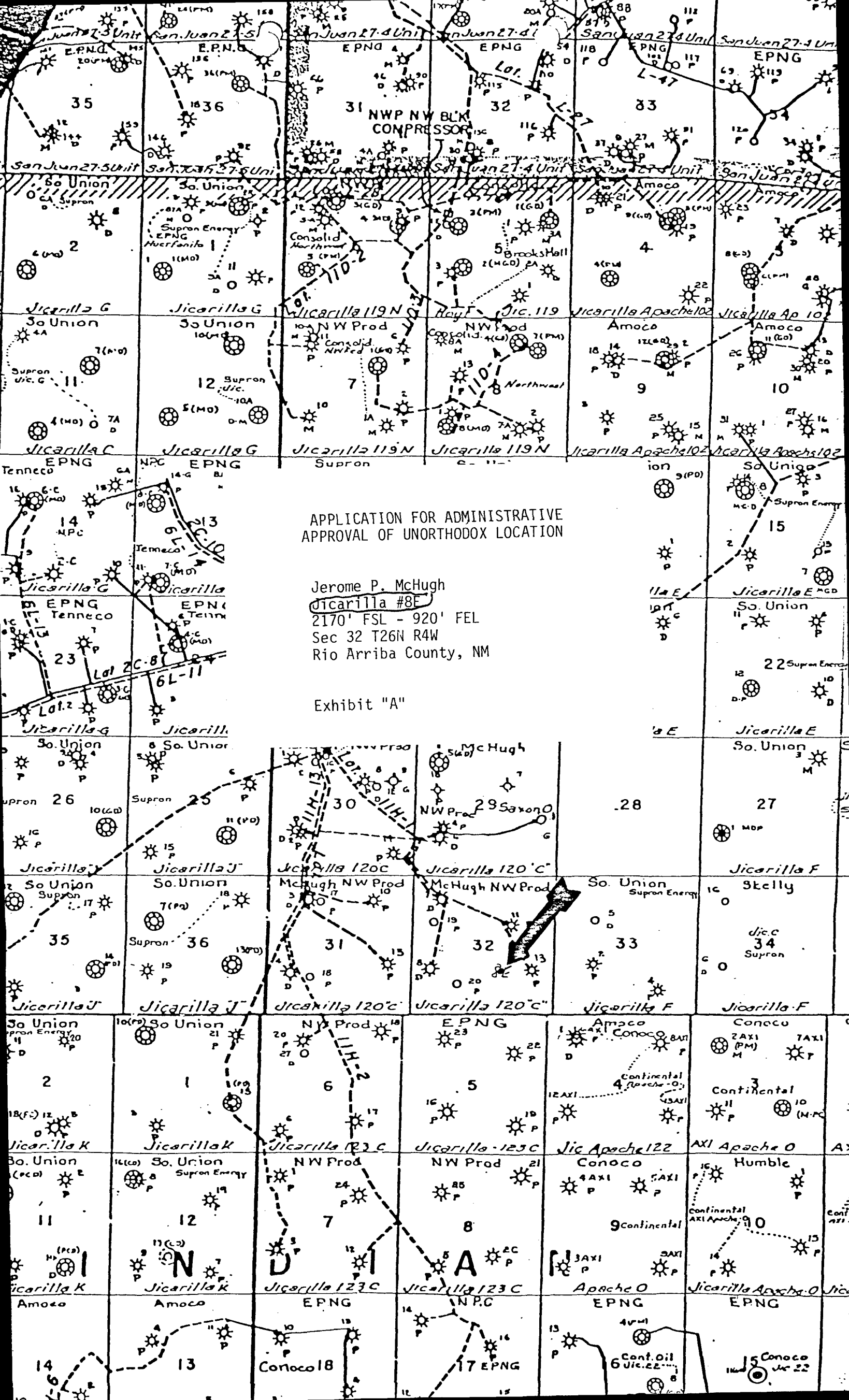

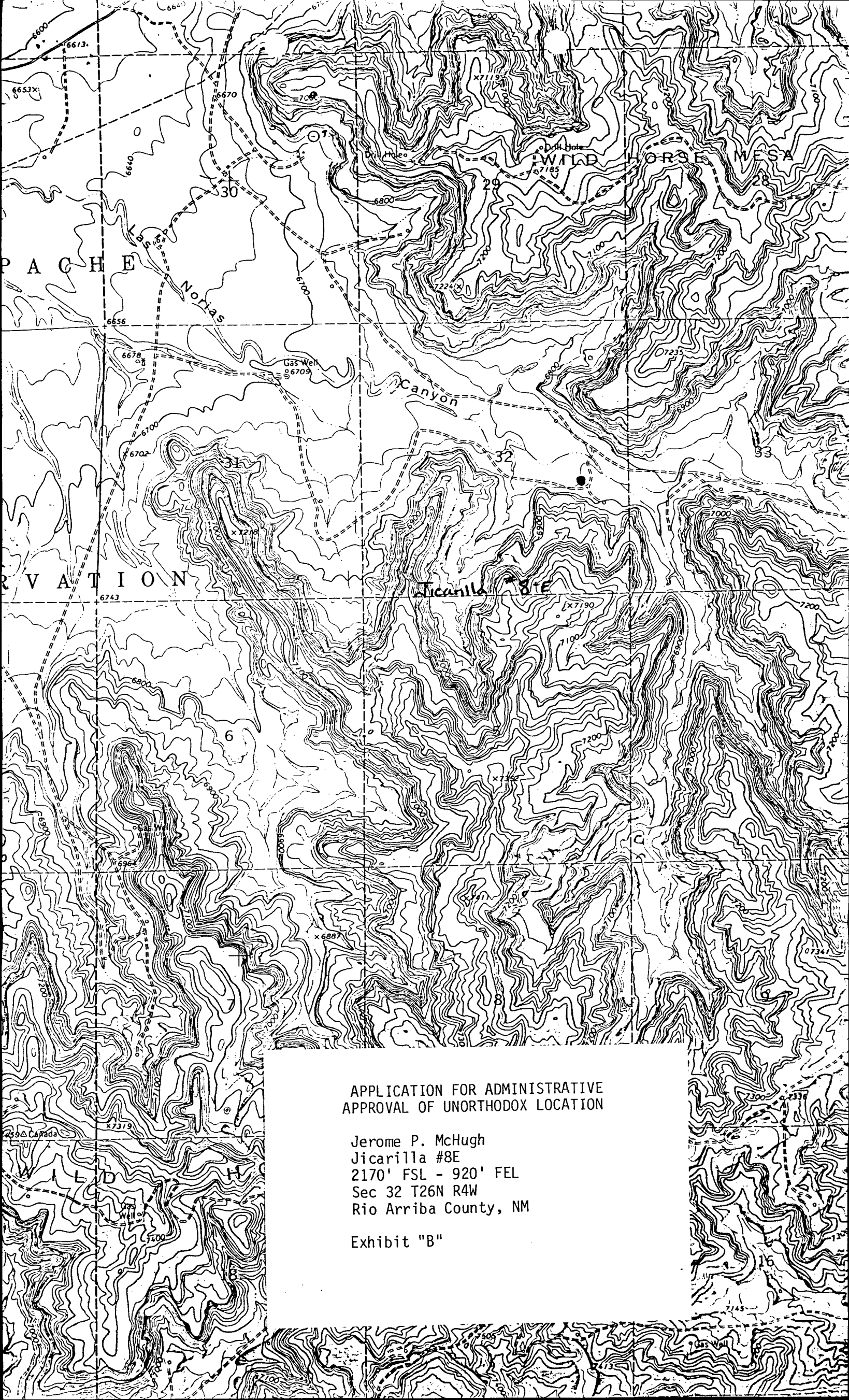

APPLICATION FOR ADMINISTRATIVE
APPROVAL OF UNORTHODOX LOCATION

Jerome P. McHugh
Jicarilla #8E
2170' FSL - 920' FEL
Sec 32 T26N R4W
Rio Arriba County, NM

Exhibit "B"

File HSH-1210

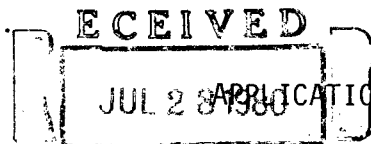

APPLICATION FOR ADMINISTRATIVE APPROVAL
OIL CONSERVATION DIVISION OF UNORTHODOX LOCATION
SANTA FE

Waiver

Applicant: Lively Exploration Co.
1010 First City National Bank Bldg.
Houston, TX 77002

Name of Well: Lively #18E

Land Dedicated to Well: Township 26 North Range 8 West, NMPM
Section 1: W/2

Proposed Unorthodox Location: Township 26 North Range 8 West, NMPM
Section 1 : 410' FNL - 750' FWL
Unit Letter: D
San Juan County, New Mexico

Reason for Unorthodox Location: Topographic conditions identified by
the Bureau of Land Management.
Standard location would place well on
tip of ridge.

Offsetting Leases and Operators: See Exhibit "A" hereto and
incorporated herein by reference.

Existent Topographic Conditions: See Exhibit "B" hereto and
incorporated herein by reference.

New Mexico Oil Conservation
Division Rule Authorizing
Application: Rule 104-F

By: Sherman E. Dugan
Sherman E. Dugan
Agent for Applicant

Waiver:

Atlantic Richfield Co. hereby acknowledges receipt of the Application for
Administrative Approval of Unorthodox Location filed by Lively Exploration Company
herein and hereby waives objection to the Lively #18E Well as proposed herein.

By: W. A. Walther, Jr.
W. A. Walther, Jr., Operations Mgr.
Date: July 22, 1980

OIL CONSERVATION COMMISSION
Albuquerque DISTRICT

OIL CONSERVATION COMMISSION
BOX 2088
SANTA FE, NEW MEXICO

DATE June 11, 1980

RE: Proposed MC _____
Proposed DHC _____
Proposed NSL X _____
Proposed SWD _____
Proposed WFX _____
Proposed PMX _____

RECEIVED
JUN 15 1980
OIL CONSERVATION COMMISSION
SANTA FE, NEW MEXICO

Gentlemen:

I have examined the application dated June 4, 1980
for the Lively Expl. Co. Lively #15E D-1-26N-SW
Operator Lease and Well No. Unit, S-T-R

and my recommendations are as follows:

Agree

Yours very truly,

Frank S. Long