

DATE IN 11/16/00	SUSPENSE 12/6/00	ENGINEER MS	LOGGED MV	TYPE NSL
------------------	------------------	-------------	-----------	----------

AMEND

ABOVE THIS LINE FOR DIVISION USE ONLY

NEW MEXICO OIL CONSERVATION DIVISION
- Engineering Bureau -

32247891

ADMINISTRATIVE APPLICATION COVERSHEET

THIS COVERSHEET IS MANDATORY FOR ALL ADMINISTRATIVE APPLICATIONS FOR EXCEPTIONS TO DIVISION RULES AND REGULATIONS

Application Acronyms:

[NSP-Non-Standard Proration Unit] [NSL-Non-Standard Location]
[DD-Directional Drilling] [SD-Simultaneous Dedication]
[DHC-Downhole Commingling] [CTB-Lease Commingling] [PLC-Pool/Lease Commingling]
[PC-Pool Commingling] [OLS - Off-Lease Storage] [OLM-Off-Lease Measurement]
[WFX-Waterflood Expansion] [PMX-Pressure Maintenance Expansion]
[SWD-Salt Water Disposal] [IPI-Injection Pressure Increase]
[EOR-Qualified Enhanced Oil Recovery Certification] [PPR-Positive Production Response]

[1] TYPE OF APPLICATION - Check Those Which Apply for [A]

[A] Location - Spacing Unit - Directional Drilling

☒ NSL ☐ NSP ☐ DD ☐ SD

NOV 16 2000

Check One Only for [B] and [C]

[B] Commingling - Storage - Measurement

DHC CTB PLC PC OLS OLM

[C] Injection - Disposal - Pressure Increase - Enhanced Oil Recovery

WFX PMX SWD IPI EOR PPR

[2] NOTIFICATION REQUIRED TO: - Check Those Which Apply, or Does Not Apply

[A] ☒ Working, Royalty or Overriding Royalty Interest Owners

[B] ☒ Offset Operators, Leaseholders or Surface Owner

[C] Application is One Which Requires Published Legal Notice

[D] Notification and/or Concurrent Approval by BLM or SLO

U.S. Bureau of Land Management - Commissioner of Public Lands, State Land Office

[E] For all of the above, Proof of Notification or Publication is Attached, and/or,

[F] Waivers are Attached

[3] INFORMATION / DATA SUBMITTED IS COMPLETE - Statement of Understanding

I hereby certify that I, or personnel under my supervision, have read and complied with all applicable Rules and Regulations of the Oil Conservation Division. Further, I assert that the attached application for administrative approval is accurate and complete to the best of my knowledge and where applicable, verify that all interest (WI, RI, ORRI) is common. I understand that any omission of data, information or notification is cause to have the application package returned with no action taken.

Note: Statement must be completed by an individual with supervisory capacity.

Peggy Cole

Regulatory/Compliance Administrator

Print or Type Name

Signature

Title

Date

BURLINGTON RESOURCES

SAN JUAN DIVISION

November 15, 2000

Federal Express

Mr. Michael Stogner
New Mexico Oil Conservation Division
2040 South Pacheco Street
Santa Fe, New Mexico 87505

Re: Lively #18E
410'FNL, 750'FWL Section 1, T-26-N, R-8-W, San Juan County
API #30-045-24581

Dear Mr. Stogner:

This is a request for administrative approval for a non-standard gas well location in the Otero Chacra and Blanco Mesaverde pools.

Burlington Resources intends to recomplete the Lively #18E Basin Dakota well, add the Otero Chacra and Blanco Mesaverde pools, and downhole commingle the three under Order DHC-2795. Order NSL-1210 was issued for the Basin Dakota.

Production from the Otero Chacra is included in a 160 acre gas spacing unit comprising of the northwest quarter (NW/4) of Section 1. Production from the Blanco Mesaverde is included in a 321.5 acre gas spacing unit comprising of the west half (W/2) of Section 1. Production from the Basin Dakota is included in a 321.5 acre gas spacing unit comprising of the west half (W/2) of Section 1 and is to be dedicated to the Lively #18 (30-045-21326) located at 800'FSL, 1800'FWL in Section 1.

1. C-102 plat showing location of the well;
2. Plat showing offset owners/operators;
3. Copy of Well Completion Log for original completion;
4. Affidavit of notification of offset owners/operators.

A copy of this application is being submitted to all offset owners/operators by certified mail with a request that they furnish your Santa Fe office with a Waiver of Objection, and return one copy to this office.

Sincerely yours,



Peggy Cole
Regulatory Supervisor

WAIVER

_____ hereby waives objection to Burlington Resource's application for non-standard location for the Lively #18E as proposed above.

By: _____ Date: _____

Xc: NMOCD – Aztec District Office
Bureau of Land Management - Farmington

District I
PO Box 1980, Hobbs, NM 88241-1980
District II
PO Drawer DD, Artesia, NM 88211-0719
District III
1000 Rio Brazos Rd., Aztec, NM 87410
District IV
PO Box 2088, Santa Fe, NM 87504-2088

State of New Mexico
Energy, Minerals & Natural Resources Department

OIL CONSERVATION DIVISION
PO Box 2088
Santa Fe, NM 87504-2088

Form C-102
Revised February 21, 1994
Instructions on back
Submit to Appropriate District Office
State Lease - 4 Copies
Fee Lease - 3 Copies

☐ AMENDED REPORT

WELL LOCATION AND ACREAGE DEDICATION PLAT

¹ API Number 30-045-24581	² Pool Code 71599 82329/72319/	³ Pool Name Basin Dakota Otero Chacra/Blanco Mesaverde/
⁴ Property Code 18182	⁵ Property Name Lively	⁶ Well Number 18E
⁷ OGRID No. 14538	⁸ Operator Name Burlington Resources Oil & Gas Company	⁹ Elevation 6220' GR

¹⁰ Surface Location

UL or lot no.	Section	Township	Range	Lot Idn	Feet from the	North/South line	Feet from the	East/West line	County
D	1	26N	8W		410'	North	750'	West	SJ

¹¹ Bottom Hole Location If Different From Surface

UL or lot no.	Section	Township	Range	Lot Idn	Feet from the	North/South line	Feet from the	East/West line	County

¹² Dedicated Acres Cha-160 MV/DK-W/321.50	¹³ Joint or Infill	¹⁴ Consolidation Code	¹⁵ Order No.
--	-------------------------------	----------------------------------	-------------------------

NO ALLOWABLE WILL BE ASSIGNED TO THIS COMPLETION UNTIL ALL INTERESTS HAVE BEEN CONSOLIDATED
OR A NON-STANDARD UNIT HAS BEEN APPROVED BY THE DIVISION

<div>16</div> <div>750</div> <div>410</div>				<div>17 OPERATOR CERTIFICATION</div> <p>I hereby certify that the information contained herein is true and complete to the best of my knowledge and belief</p> <div>Signature Peggy Cole Printed Name Regulatory Administrator Title</div> <div>Date</div>
				<div>18 SURVEYOR CERTIFICATION</div> <p>I hereby certify that the well location shown on this plat was plotted from field notes of actual surveys made by me or under my supervision, and that the same is true and correct to the best of my belief.</p> <div>Date of Survey</div> <div>Signature and Seal of Professional Surveyer:</div> <div>Certificate Number</div>

BURLINGTON RESOURCES OIL AND GAS COMPANY

Lively #18E

Section 1, T-26-N, R-8-W

OFFSET OPERATOR/OWNER PLAT

Nonstandard Location

Chacra Formation Well

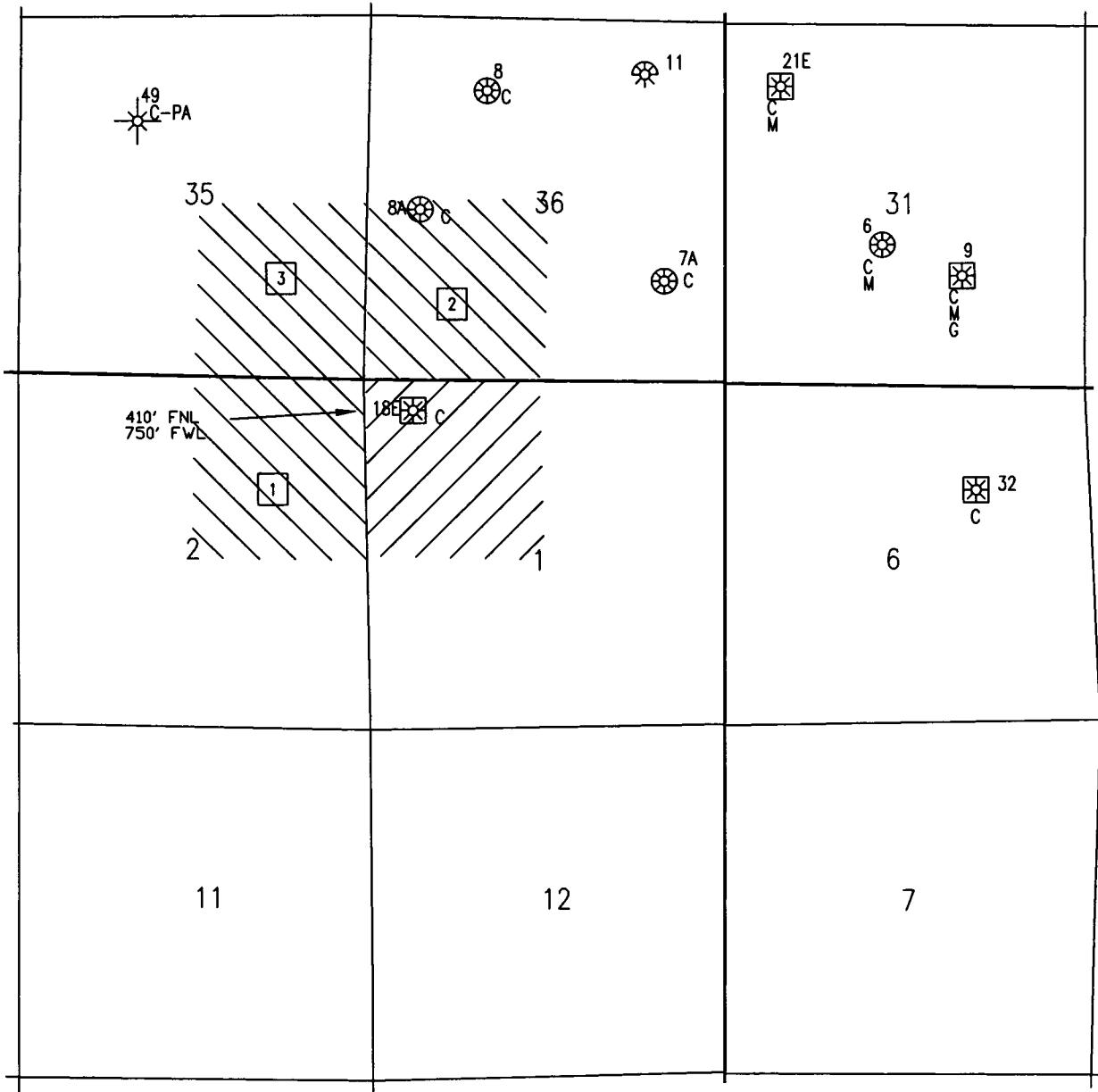

[1] Burlington Resources - Working Interest Owner

[2] Burlington Resources - Operator

See attached list for Working Interest Owners

[3] Conoco, Inc - Working Interest Owner

Attention: Eva Rodriguez

PO Box 2197

Houston, Texas 77252

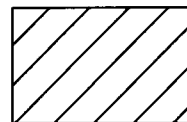

Proposed Well



Offset Operator

**Working Interest Owners for the SW/4, Sec. 36, T-27-N, R-8-W
Otero Chacra**

Burlington Resources - Operator

Energen Resources, Inc.
Attention: Richard Cochran
2198 Bloomfield Highway
Farmington, New Mexico 87401

William C. Briggs
% Nationsbank
PO Box 2546
Fort Worth, Texas 76113-2546

Frank A. Cronican and
Harriet B. Cronican Trust
% Nationsbank
PO Box 2546
Fort Worth, Texas 76113-2546

Fred C. Luthy, Jr.
% Nationsbank NA
Trust Minerals
PO Box 2546
Fort Worth, Texas 76113-2546

Cheryl Potenzian
PO Box 36600, Station D
Albuquerque, New Mexico 87176

Marcia Berger
% Nationsbank NA
Trust Minerals
PO Box 2546
Fort Worth, Texas 76113-2546

WWR Enterprises
% Nationsbank
PO Box 2546
Fort Worth, Texas 76113-2546

Herbert R. Briggs
% Nationsbank
PO Box 2546
Fort Worth, Texas 76113-2546

Cyrene L. Inman
% Nationsbank NA
Trust Minerals
PO Box 2546
Fort Worth, Texas 76113-2546

Carolyn Nielsen Sedberry
% Nationsbank NA
Trust Minerals
PO Box 2546
Fort Worth, Texas 76113-2546

BURLINGTON RESOURCES OIL AND GAS COMPANY

Lively #18E

Section 1, T-26-N, R-8-W

OFFSET OPERATOR/OWNER PLAT

Nonstandard Location

Mesaverde Formation Well

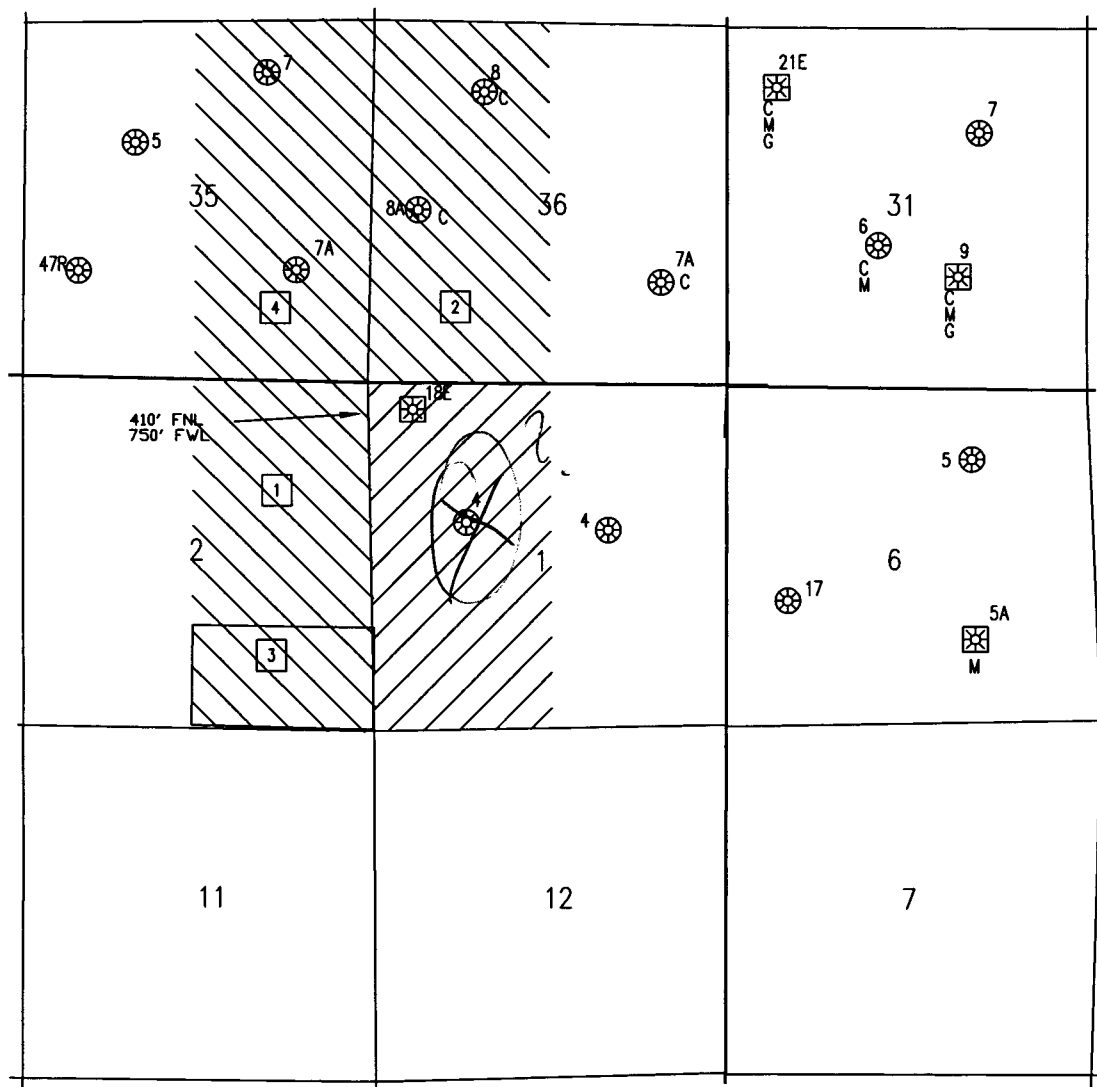

1 Burlington Resources - Working Interest Owner

2 Burlington Resources - Operator

See attached list for Working Interest Owners

3 Curtis J. Little Estate - Working Interest Owner

PO Box 1258

Farmington, New Mexico 87499

4 Conoco, Inc - Operator

Attention: Eva Rodriguez

PO Box 2197

Houston, Texas 77252

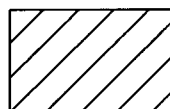

Proposed Well



Offset Operator

**Working Interest Owners for the W/2 Section 36, T-27-N, R-8-W
Blanco Mesaverde**

Burlington Resources - Operator

Energen Resources, Inc.
Attention: Richard Cochran
2198 Bloomfield Highway
Farmington, New Mexico 87401

William C. Briggs
% Nationsbank
PO Box 2546
Fort Worth, Texas 76113-2546

Frank A. Cronican and
Harriet B. Cronican Trust
% Nationsbank
PO Box 2546
Fort Worth, Texas 76113-2546

Fred C. Luthy, Jr.
% Nationsbank NA
Trust Minerals
PO Box 2546
Fort Worth, Texas 76113-2546

Cheryl Potenzian
PO Box 36600, Station D
Albuquerque, New Mexico 87176

Marcia Berger
% Nationsbank NA
Trust Minerals
PO Box 2546
Fort Worth, Texas 76113-2546

WWR Enterprises
% Nationsbank
PO Box 2546
Fort Worth, Texas 76113-2546

Herbert R. Briggs
% Nationsbank
PO Box 2546
Fort Worth, Texas 76113-2546

Cyrene L. Inman
% Nationsbank NA
Trust Minerals
PO Box 2546
Fort Worth, Texas 76113-2546

Carolyn Nielsen Sedberry
% Nationsbank NA
Trust Minerals
PO Box 2546
Fort Worth, Texas 76113-2546

Merchant Resources #1
% St. Johns Operatiog #1 LP
PO Box 27
Houston, Texas 77001-0027

UNITED STATES
DEPARTMENT OF THE INTERIOR
GEOLOGICAL SURVEY

SUBMIT IN DUPLICATE*

(See instructions on
reverse side)Form approved.
Budget Bureau No. 42-R355.5.

WELL COMPLETION OR RECOMPLETION REPORT

1a. TYPE OF WELL:		OIL WELL <input type="checkbox"/>	GAS WELL <input checked="" type="checkbox"/>	DRY <input type="checkbox"/>	Other										
b. TYPE OF COMPLETION:		NEW WELL <input checked="" type="checkbox"/>	WORK OVER <input type="checkbox"/>	DEEP-EN <input type="checkbox"/>	PLUG BACK <input type="checkbox"/>	DIFF. RESVR. <input type="checkbox"/>	Other								
2. NAME OF OPERATOR LIVELY EXPLORATION COMPANY															
3. ADDRESS OF OPERATOR c/o Walsh Engr. & Prod. Corp. P. O. Box 254 Farmington, N.M. 87401															
4. LOCATION OF WELL (Report location clearly and in accordance with any State requirements)* At surface 410' FNL, 750' FWL At top prod. interval reported below Same At total depth Same															
14. PERMIT NO. DATE ISSUED															
12. COUNTY OR PARISH San Juan															
13. STATE N.M.															
15. DATE SPUDDED 1/21/81		16. DATE T.D. REACHED 2/2/81		17. DATE COMPL. (Ready to prod.) 3/14/81		18. ELEVATIONS (DF, REB, BT, OR, ETC.)* 6232' DF, 6233' KB		19. ELEV. CASINGHEAD 6220' GL							
20. TOTAL DEPTH, MD & TVD 6890'		21. PLUG, BACK T.D., MD & TVD 6847'		22. IF MULTIPLE COMPL., HOW MANY*		23. INTERVALS DRILLED BY ROTARY TOOLS CABLE TOOLS		24. PRODUCING INTERVAL(S), OF THIS COMPLETION—TOP, BOTTOM, NAME (MD AND TVD)* 6654'-6754' Dakota							
25. WAS DIRECTIONAL SURVEY MADE NO															
26. TYPE ELECTRIC AND OTHER LOGS RUN ISF, CNL-FDC															
27. WAS WELL CORED NO															
28. CASING RECORD (Report all strings set in well)															
CASINO SIZE		WEIGHT, LB./FT.		DEPTH SET (MD)		HOLE SIZE		CEMENTING RECORD		AMOUNT PULLED					
8-5/8"		24.0		341'		12-1/4"		250 sacks		NONE					
4-1/2"		10.50&11.60		6891'		7-7/8"		1580 sacks		NONE					
29. LINER RECORD								30. TUBING RECORD							
SIZE		TOP (MD)		BOTTOM (MD)		SACKS CEMENT*		SCREEN (MD)		SIZE		DEPTH SET (MD)		PACKER SET (MD)	
NONE										2-3/8"		6705'			
31. PERFORATION RECORD (Interval, size and number) 6654'-6663' 6722'-6726' 6740' 6748' 6752'-6754' 6759'-6768' 1 shot per foot								32. ACID, SHOT, FRACTURE, CEMENT SQUEEZE, ETC. DEPTH INTERVAL (MD) 6654'-6768' AMOUNT AND KIND OF MATERIAL USED 80,000 gallons water 80,000 lbs. sand							
33. PRODUCTION								34. DISPOSITION OF GAS (Sold, used for fuel, vented, etc.) VENTED							
DATE FIRST PRODUCTION W.O.P.		PRODUCTION METHOD (Flowing, gas lift, pumping—size and type of pump) Flowing						WELL STATUS (Producing or shut-in) Shut In							
DATE OF TEST 4/6/81		HOURS TESTED 3 hrs.		CHOKE SIZE Pitot Tube		PROD'N. FOR TEST PERIOD		OIL—EBL.		GAS—MCF.		WATER—EBL.		GAS-OIL RATIO	
FLOW, TUBING PRESS. 700 psig		CASING PRESSURE 930 psig		CALCULATED 24-HOUR RATE		OIL—EBL.		GAS—MCF. CAOF-2,158		WATER—EBL.		OIL GRAVITY-API (CORR.)			
35. LIST OF ATTACHMENTS FOR: LIVELY EXPLORATION COMPANY								36. I hereby certify that the foregoing and attached information is complete and correct as determined from all available records							
ORIGINAL SIGNED BY Ewell N. Walsh, P.E.								President, Walsh Engr. & Prod. Corp.				DATE APR 12 1981 4/8/81			
SIGNED Ewell N. Walsh, P.E.								TITLE & Prod. Corp.				BY RFB			

*(See Instructions and Spaces for Additional Data on Reverse Side)

NM000

Re: Lively #18E
410'FNL, 750'FWL Section 1, T-26-N, R-8-W, San Juan County
API #30-045-24581

Conoco Inc
Att: Eva Rodriguez
PO Box 2197
Houston, TX 77252

Curtis J. Little Estate
PO Box 1258
Farmington, NM 87499

And attached lists

I hereby certify that the following offset owners/operators have been notified by certified mail of our application for administrative approval for non-standard well location of the above well.

Peggy Cole
Regulatory Supervisor