

Walsh

ENGINEERING & PRODUCTION CORP.

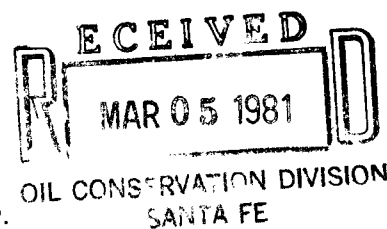

PETROLEUM ENGINEERING
RESERVOIR STUDIES
EVALUATIONS
GEOLOGICAL STUDIES
LEASE MANAGEMENT
CONTRACT PUMPING
DRILLING SUPERVISION
WORKOVER SUPERVISION

March 2, 1981

EWELL N. WALSH, P.E.
President

Mr. Joe D. Ramey, Director
Energy & Minerals Department
NM Oil Conservation Division
P. O. Box 2088
Santa Fe, New Mexico 87501

RE: Lively No. 20-E
Unit B, Section 12-T26N-R8W
San Juan County, New Mexico
Lease No. SF-078622

Dear Mr. Ramey:

Due to terrain problems the above-referred-to location has been changed as follows:

FROM: 510'FNL, 1850'FEL
TO: 480'FNL, 1980'FEL

The original unorthodox or non-standard location was approved by Administrative Order NSL-1211.

The information concerning ownership of offsetting leases and plat identifying the topography necessitating the non-standard location was submitted with the original application. Due to the small change in location footage, this information is not being submitted with this request for approval of change of location.

Enclosed is a copy of the Sundry Notice to U.S.G.S. requesting approval in the change in location footage.

Copies of this request for approval of change of location are being submitted to all offset operators by certified mail with a request that they furnish your office with a copy of a waiver of objection.

Very truly yours,

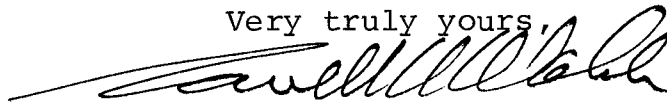
Ewell N. Walsh, P.E.
President

ENW:rr

cc: N.M. Oil Conservation Division, Aztec, N.M. w/encl.
USGS, Farmington wo/encl.
Lively Exploration Company w/encl.
Offsetting Operators (5) wo/encl.

UNITED STATES
DEPARTMENT OF THE INTERIOR
GEOLOGICAL SURVEYSUBMIT IN TRIPPLICATE*
(Other instructions on re-
verse side)Form approved.
Budget Bureau No. 42-R1424.
5. LEASE DESIGNATION AND SERIAL NO.SUNDRY NOTICES AND REPORTS ON WELLS
RECEIVED
MAR 05 1981(Do not use this form for proposals to drill or to deepen or plug back to a different reservoir.
Use "APPLICATION FOR PERMIT—" for such proposals.)

1. OIL WELL <input type="checkbox"/> GAS WELL <input checked="" type="checkbox"/> OTHER		OIL CONSERVATION DIVISION SANTA FE		UNIT AGREEMENT NAME	
2. NAME OF OPERATOR LIVELY EXPLORATION COMPANY		8. FARM OR LEASE NAME Lively		9. WELL NO. 20-E	
3. ADDRESS OF OPERATOR c/o Walsh Engr. & Prod. Corp. P. O. Box 254 Farmington, N.M. 87401		10. FIELD AND POOL, OR WILDCAT Basin Dakota		11. SEC., T., R., M., OR BLK. AND SURVEY OR AREA Sec. 12-T26N-R8W N.M.P.M.	
4. LOCATION OF WELL (Report location clearly and in accordance with any State requirements.* See also space 17 below.) At surface 480'FNL, 1980'FEL		12. COUNTY OR PARISH San Juan		13. STATE N.M.	
14. PERMIT NO.		15. ELEVATIONS (Show whether DF, RT, GR, etc.) 6172'GL			

16. Check Appropriate Box To Indicate Nature of Notice, Report, or Other Data

NOTICE OF INTENTION TO:

TEST WATER SHUT-OFF <input type="checkbox"/>	PULL OR ALTER CASING <input type="checkbox"/>
FRACTURE TREAT <input type="checkbox"/>	MULTIPLE COMPLETE <input type="checkbox"/>
SHOOT OR ACIDIZE <input type="checkbox"/>	ABANDON* <input type="checkbox"/>
REPAIR WELL <input type="checkbox"/>	CHANGE PLANS <input type="checkbox"/>
(Other) Change in location Footage <input checked="" type="checkbox"/>	

SUBSEQUENT REPORT OF:

WATER SHUT-OFF <input type="checkbox"/>	REPAIRING WELL <input type="checkbox"/>
FRACTURE TREATMENT <input type="checkbox"/>	ALTERING CASING <input type="checkbox"/>
SHOOTING OR ACIDIZING <input type="checkbox"/>	ABANDONMENT* <input type="checkbox"/>
(Other) <input type="checkbox"/>	

(NOTE: Report results of multiple completion on Well Completion or Recompletion Report and Log form.)

17. DESCRIBE PROPOSED OR COMPLETED OPERATIONS (Clearly state all pertinent details, and give pertinent dates, including estimated date of starting any proposed work. If well is directionally drilled, give subsurface locations and measured and true vertical depths for all markers and zones pertinent to this work.)*

The location footages are changed as follows:

FROM: 510'FNL, 1850'FEL
TO: 480'FNL, 1980'FEL

The change was made due to topographical conditions and to decrease the environmental impact.

The original Application for Permit to Drill was approved July 1980.

FOR: LIVELY EXPLORATION COMPANY

18. I hereby certify that the foregoing is true and correct

SIGNED

Ewell N. Walsh, P.E.

TITLE

President, Walsh Engr.
& Prod. Corp.

DATE

3/2/81

(This space for Federal or State office use)

APPROVED BY

TITLE

DATE

CONDITIONS OF APPROVAL, IF ANY:

*See Instructions on Reverse Side

All distances must be from the outer boundaries of the Section.

Operator Lively Exploration Company			Lease Lively			Well No. 20-E
Unit Letter B	Section 12	Township 25 North	Range 8 West	County San Juan		
Actual Footage Location of Well: 480 feet from the North line and 1980 feet from the East line						
Ground Level Elev. 5172	Producing Formation Dakota		Pool Basin Dakota		Dedicated Acreage: 320 Acres	

1. Outline the acreage dedicated to the subject well by colored pencil or hatchure marks on the plat below.
2. If more than one lease is dedicated to the well, outline each and identify the ownership thereof (both as to working interest and royalty).
3. If more than one lease of different ownership is dedicated to the well, have the interests of all owners been consolidated by communitization, unitization, force-pooling, etc?

☐ Yes ☐ No If answer is "yes," type of consolidation _____

If answer is "no," list the owners and tract descriptions which have actually been consolidated. (Use reverse side of this form if necessary.) _____

No allowable will be assigned to the well until all interests have been consolidated (by communitization, unitization, forced-pooling, or otherwise) or until a non-standard unit, eliminating such interests, has been approved by the Division

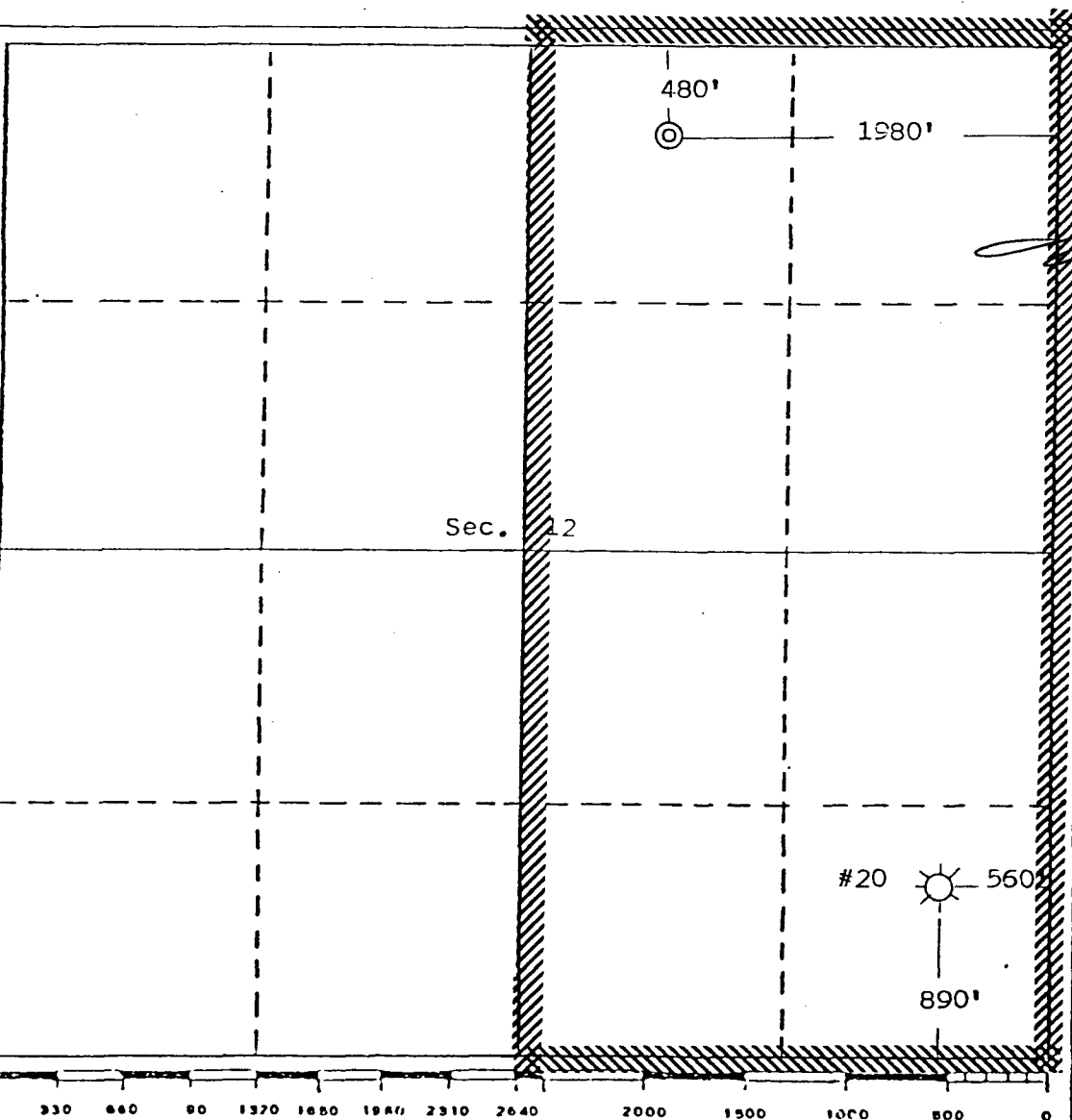

CERTIFICATION

I hereby certify that the information contained herein is true and complete to the best of my knowledge and belief.

FOR: LIVELY EXPLORATION CO.

Name
Ewell N. Walsh, P.E.Position
PresidentCompany
Walsh Engineering & Prod. CorDate
3/2/81

I hereby certify that the location shown on this plat was located from field notes of actual survey made by me or under my supervision, and that the same is true and correct to the best of my knowledge and belief.

Date Surveyed
January 8, 1981Registered Professional Engineer
and/or Land SurveyorEdgar L. Risenhoover
Certificate No. 5272

Edgar L. Risenhoover, L.S.

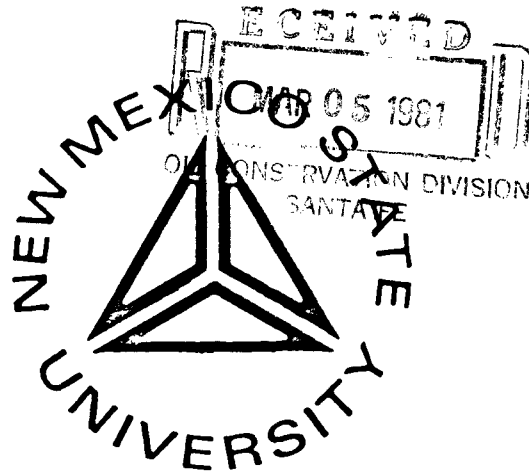

An Archaeological Clearance Survey of
Three Proposed Alternate Well Locations
Conducted for Walsh Engineering & Production Co.

L. Jean Hooton

Lively #17E - Alternate #1
Lively #17E - Alternate #2
Lively #20E - Alternate

Report 81-SJC-018
of the
Cultural Resource Management Program
San Juan Campus
New Mexico State University

22 January 1981

Proposed Well: LIVELY EXPLORATION / LIVELY #20E - ALTERNATE

Land Status: Bureau of Land Management.

Location: The proposed well location is in the center of the NW $\frac{1}{4}$ of the NE $\frac{1}{4}$ of Section 12, Township 26 North, Range 8 West, N.M.P.M., San Juan County, New Mexico. The well will be 480 feet from the north line and 1980 feet from the east line of Section 12. (Figure 1)

U.T.M.: Center - 13; 2,64,280 mE; 40,43,150 mN.

Access: Same as original.

Area Surveyed: 2.07 acres.

Terrain: Low ridge in canyon bottom with northerly drainage and alluvial surface deposits.

Soil: Sandy and sandy clay loam.

Vegetation: Piñon, juniper, sagebrush, narrowleaf yucca, prickly pear cactus, brome, ricegrass, grama.

Cultural Resources: Site SJC-676 was found about 120 feet north of the well stake. The perimeter of the site was flagged with yellow ribbon.

Recommendations: Archaeological clearance is recommended with the stipulation that the site be avoided and that no disturbance of the site will occur as a result of the proposed construction and drilling activities.



STATE OF NEW MEXICO
ENERGY AND MINERALS DEPARTMENT
OIL CONSERVATION DIVISION

June 25, 1980

BRUCE KING
GOVERNOR

LARRY KEHOE
SECRETARY

POST OFFICE BOX 2088
STATE LAND OFFICE BUILDING
SANTA FE, NEW MEXICO 87501
(505) 827-2434

Dugan Production Corporation
P. O. Box 208
Farmington, New Mexico 87401

Attention: Mr. Sherman E. Dugan

Administrative Order NSL-1211

Gentlemen:

Reference is made to your application on behalf of Lively Exploration Co. for approval of a non-standard location for their Lively Well No. 20E to be located 510 feet from the North line and 1850 feet from the East line of Section 12, Township 26 North, Range 8 West, NMPM, Basin-Dakota Gas Pool, San Juan County, New Mexico.

By authority granted me under the provisions of Rule 3 of Order No. R-1670, the above-described unorthodox location is hereby approved.

Sincerely,

JOE D. RAMEY,
Director

JDR/RLS/dr

cc: Oil Conservation Division - Aztec
Oil & Gas Engineering Committee - Hobbs
U. S. Geological Survey - Farmington

NSL-1211

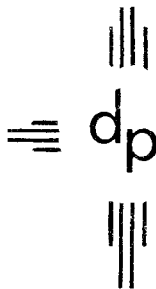

dugan production corp.

NSL-1211
Rul. 3 R 1670
see page 3 for details
6-25-80

June 3, 1980

Joe D. Ramey
Division Director
New Mexico Oil Conservation Division
Box 2088
Santa Fe, NM 87501

Re: Application for Administrative
Approval of Unorthodox Location
for the Lively #20E Well

Dear Mr. Ramey:

Enclosed please find three copies of the Application for Administrative Approval of the Unorthodox Location for the Lively #20E well, which application includes a plat showing the ownership of all leases offsetting this spacing unit for which the unorthodox location is sought, and all wells completed thereon, and a plat showing the existent topographical conditions of the well location. Also enclosed are copies of the dedicated acreage plat.

Copies of this application are being submitted to all offset operators by certified mail with a request that they furnish your office with a waiver of objection.

Please advise if you need further information.

Sincerely,

Sherman E. Dugan
Agent for Applicant

pb

Enclosures

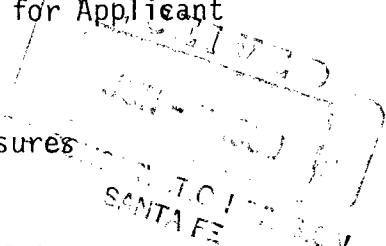

xc: Frank Chavez
New Mexico Oil Conservation Division
1000 Rio Brazos Rd.
Aztec, NM 87410

James Sims
U. S. Geological Survey
P.O. Box 959
Farmington, NM 87401

K. G. Ranum
Depco, Inc.
1000 Petroleum Bldg.
110 16th St.
Denver, CO 80202

D. N. Canfield
Landman
El Paso Natural Gas Co.
Box 1492
El Paso, TX 79978

Southwest Production
P.O. Box 400
Aztec, NM 87410

Bill Curtis
Vice President, Land
Supron Energy Corp.
Bldg. 5 Fifth Floor
10300 N. Central Expressway
Dallas, TX 75231

J. F. Gavlick
Division Landman
Tenneco Oil Company
Penthouse
720 South Colorado Blvd.
Denver, CO 80222

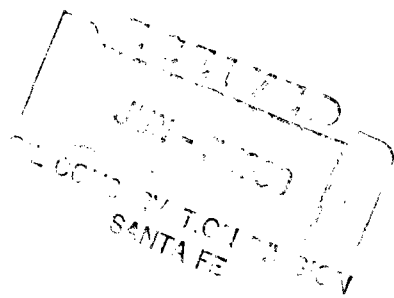

APPLICATION FOR ADMINISTRATIVE APPROVAL
OF UNORTHODOX LOCATION

*Basin Dakota
Gas Pool*

Applicant:

Lively Exploration Co.
1010 First City National Bank Bldg.
Houston, TX 77002

Name of Well:

Lively #20E

Land Dedicated to Well:

Township 26 North, Range 8 West, NMPM
Section 12: E/2

Containing 320 acres more or less

Proposed Unorthodox Location:

Township 26 North, Range 8 West, NMPM
Section 12: 510' FNL - 1850' FEL
Unit Letter B
San Juan County, New Mexico

Reason for Unorthodox Location:

Topographical conditions identified
by the Bureau of Land Management.
Standard location would place well
on tip of ridge.

Offsetting Leases and Operators:

See Exhibit "A" hereto and incorporated
herein by reference.

Existent Topographical Conditions:

See Exhibit "B" hereto and incorporated
herein by reference.

New Mexico Oil Conservation Division
Rule Authorizing Application:

Rule 104-F

By:

Sherman E. Dugan
Sherman E. Dugan
Agent for Applicant

Waiver: *cc: [unclear]*

*RECEIVED
JUL - 2003
SANTA FE*

_____ hereby acknowledges receipt of the Application
for Administrative Approval of Unorthodox Location filed by Lively Exploration
Company herein and hereby waives objection to Lively Exploration Company's
Application for Administrative Approval of Unorthodox Location for their
Lively #20E Well as proposed herein.

By: _____

Date: _____

NEW MEXICO OIL CONSERVATION COMMISSION
WELL LOCATION AND ACREAGE DEDICATION PLAT

Form C-102
Supersedes C-12
Effective 1-1-65

All distances must be from the outer boundaries of the Section.

Operator Lively Exploration Company			Lease		Well No. 20E
Unit Letter 8	Section 12	Township 26 North	Range 8 West	County San Juan	
Actual Footage Location of Well: 510 feet from the North line and 1850 feet from the East line					
Ground Level Elev. 6165	Producing Formation Dakota	Pool Basin		Dedicated Acreage: 320 Acres	

1. Outline the acreage dedicated to the subject well by colored pencil or hatchure marks on the plat below.
2. If more than one lease is dedicated to the well, outline each and identify the ownership thereof (both as to working interest and royalty).
3. If more than one lease of different ownership is dedicated to the well, have the interests of all owners been consolidated by communitization, unitization, force-pooling, etc?

☐ Yes ☐ No If answer is "yes," type of consolidation _____

If answer is "no," list the owners and tract descriptions which have actually been consolidated. (Use reverse side of this form if necessary.) _____

No allowable will be assigned to the well until all interests have been consolidated (by communitization, unitization, forced-pooling, or otherwise) or until a non-standard unit, eliminating such interests, has been approved by the Commission.

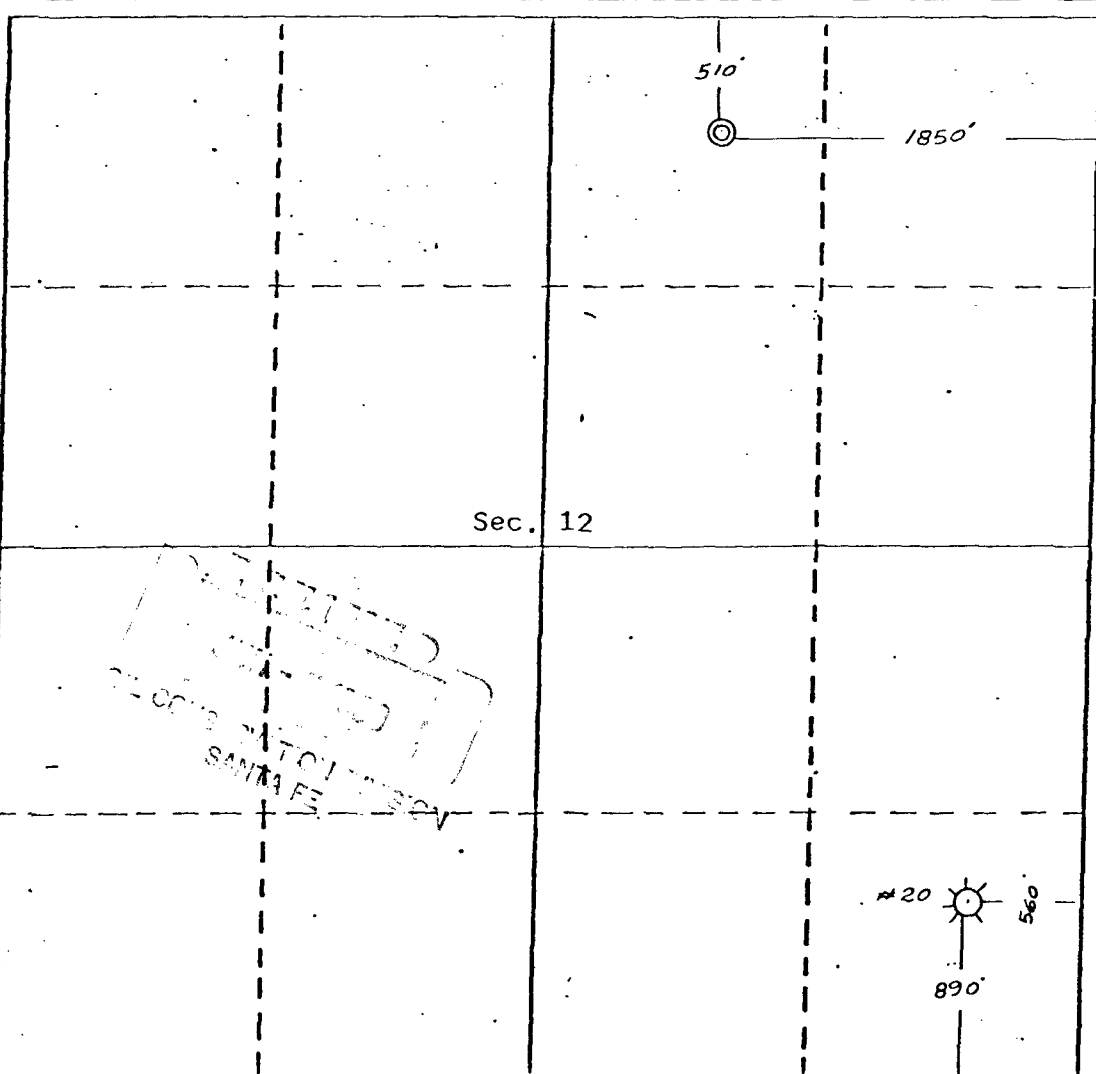

CERTIFICATION

I hereby certify that the information contained herein is true and complete to the best of my knowledge and belief.

Sherman E. Dugan
Name

Sherman E. Dugan
Position

Agent for Applicant
Company

Lively Exploration Co.
Date

6-3-80

I hereby certify that the well location shown on this plat was plotted from field notes of actual surveys made by me or under my supervision, and that the same is true and correct to the best of my knowledge and belief.

Date Surveyed
April 3, 1980

Registered Professional Engineer and/or Land Surveyor

Edgar L. Risenhoover
Certificate No. 5979

Edgar L. Risenhoover, L.S.

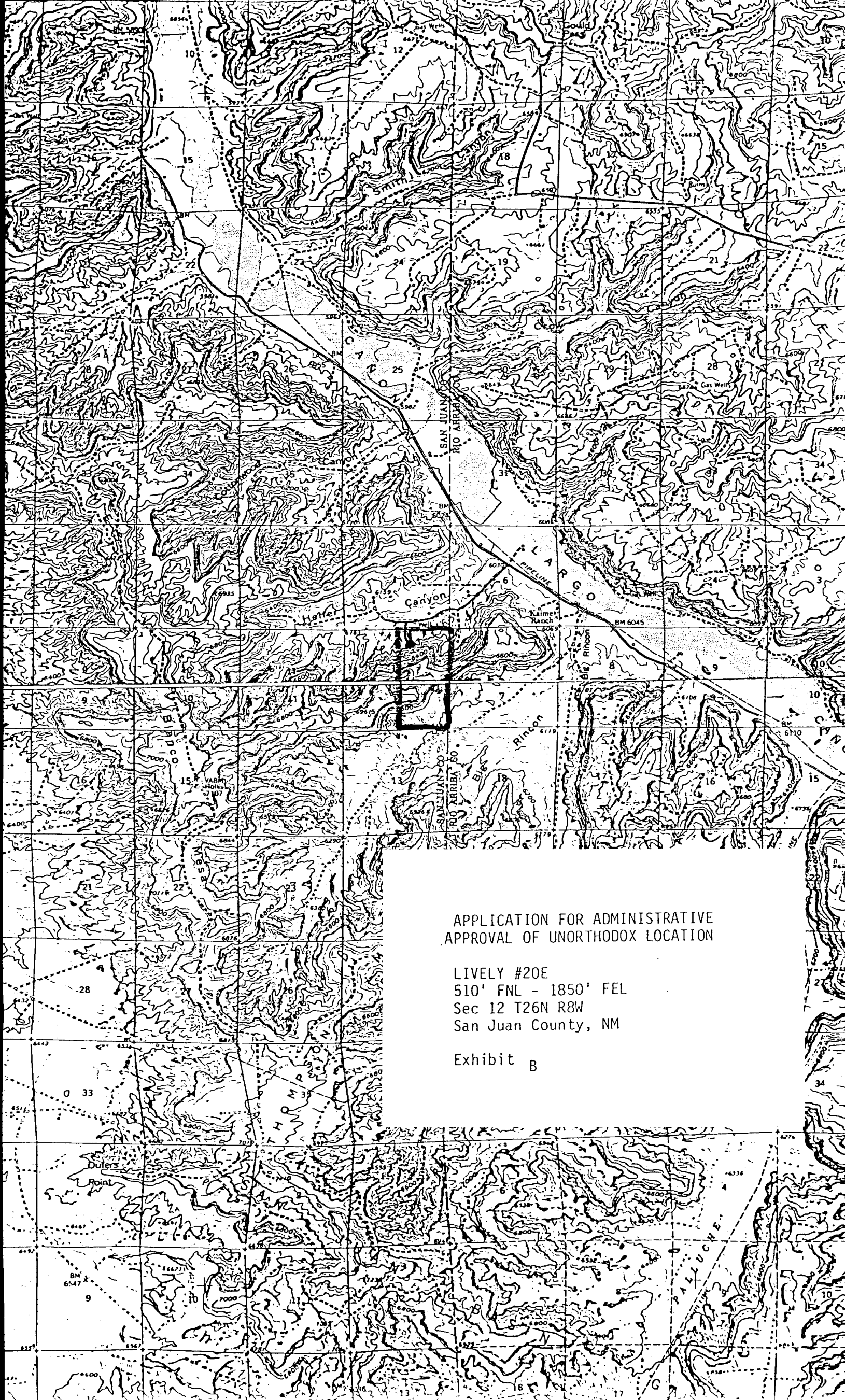

APPLICATION FOR ADMINISTRATIVE
APPROVAL OF UNORTHODOX LOCATION

LIVELY #20E
510' FNL - 1850' FEL
Sec 12 T26N R8W
San Juan County, NM

Exhibit B

OIL CONSERVATION COMMISSION
Alto DISTRICT

OIL CONSERVATION COMMISSION
BOX 2088
SANTA FE, NEW MEXICO

DATE

June 6, 1980

RE:

Proposed MC

Proposed DHC

Proposed NSL

Proposed SWD

Proposed WFX

Proposed PMX

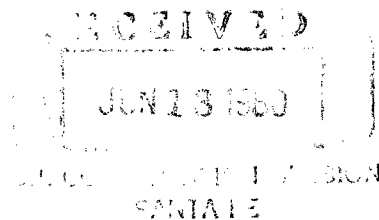

Gentlemen:

I have examined the application dated June 4, 1980
for the Lively Exploration Co. Lively #20E B-12-26 N-8W
Operator Lease and Well No. Unit, S-T-R

and my recommendations are as follows:

Approve

Yours very truly,

Frank S. Chavez

APPLICATION FOR ADMINISTRATIVE APPROVAL
OF UNORTHODOX LOCATION

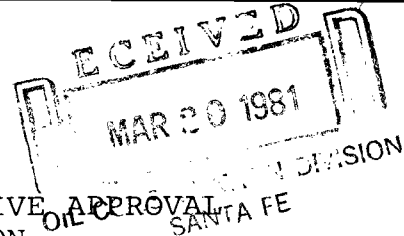

Applicant: Lively Exploration Company
1010 First City National Bank Building
Houston, Texas 77002

Name of Well: Lively No. 20-E

Land Dedicated to Well: Township 26 North Range 8 West NMPM
Section 12: E/2

Proposed Unorthodox Location: Township 26 North Range 8 West, NMPM
Sec. 12: 480'FNL, 1980'FEL
Unit Letter B
San Juan County, N.M.

Reason for Unorthodox Location: Topographical conditions identified
by the Bureau of Land Management.
Standard location would place well
on a steep slope.

Offsetting Leases & Operators: See Exhibit "A" hereto and incorporated
herein by reference in request dated
June 3, 1980.

Existent Topographical Conditions: See Exhibit "B" hereto and incorporated
herein by reference in request dated
June 3, 1980.

New Mexico Oil Conservation Div.
Rule Authorizing Application: Rule 104-F

FOR: LIVELY EXPLORATION COMPANY

BY: Ewell N. Walsh
Ewell N. Walsh, P.E. President
Walsh Engineering & Prod. Corp.

WAIVER:

SUPRON ENERGY CORPORATION hereby acknowledges receipt of the Application for Administrative Approval of Unorthodox location filed by Lively Exploration Corporation herein and hereby waives objection to Lively Exploration Company's Application for Administrative Approval of Unorthodox Location for their Lively No. 20-E well as proposed herein.

BY: Guy L. Lee
DATE: 3/12/81

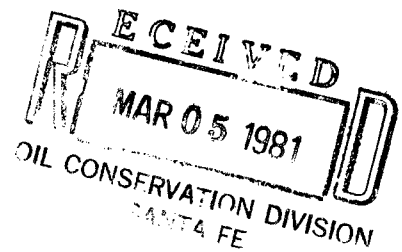

Waiver of Objection

Phillips Petroleum Company
Conversion to Water Injection Service
East Vacuum Grayburg/San Andres Unit
Tract 2963, Well No. 005
Lea County, New Mexico

Texaco Inc., as an offset operator, hereby waives any and all objections to the proposal of Phillips Petroleum Company for one cooperative line injection well to be equipped for injection service on their East Vacuum Grayburg/San Andres Unit, Tract 2963, Well No. 005, located (Unit M) 90' FSL and 50' FWL, Section 29, T-17-S, R-35-E, Lea County, New Mexico.

Company: TEXACO INC

By: 

Title: Asst. Petr. Engineering Mgr.

Date: March 2, 1981

SKN:lw

APPLICATION FOR ADMINISTRATIVE APPROVAL
OF UNORTHODOX LOCATION

Applicant: Lively Exploration Co.
1010 First City National Bank Bldg.
Houston, TX 77002

Name of Well: Lively #20E

Land Dedicated to Well: Township 26 North, Range 8 West, NMPM
Section 12: E/2

Containing 320 acres more or less

Proposed Unorthodox Location: Township 26 North, Range 8 West, NMPM
Section 12: 510' FNL - 1850' FEL
Unit Letter B
San Juan County, New Mexico

Reason for Unorthodox Location: Topographical conditions identified
by the Bureau of Land Management.
Standard location would place well
on tip of ridge.

Offsetting Leases and Operators: See Exhibit "A" hereto and incorporated
herein by reference.

Existent Topographical Conditions: See Exhibit "B" hereto and incorporated
herein by reference.

New Mexico Oil Conservation Division
Rule Authorizing Application: Rule 104-F

By: 
Sherman E. Dugan
Agent for Applicant

Waiver:

Tenneco Oil Co. hereby acknowledges receipt of the Application
for Administrative Approval of Unorthodox Location filed by Lively Exploration
Company herein and hereby waives objection to Lively Exploration Company's
Application for Administrative Approval of Unorthodox Location for their
Lively #20E Well as proposed herein.

Original Stamp by
J. M. LICKY

By: _____

Date: 6/13/16

APPLICATION FOR ADMINISTRATIVE APPROVAL
OF UNORTHODOX LOCATION

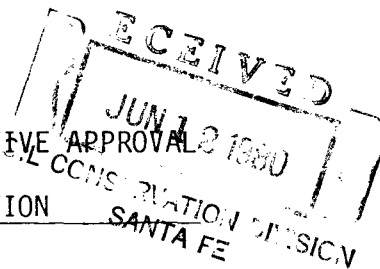

Applicant: Lively Exploration Co.
1010 First City National Bank Bldg.
Houston, TX 77002

Name of Well: Lively #20E

Land Dedicated to Well: Township 26 North, Range 8 West, NMPM
Section 12: E/2
Containing 320 acres more or less

Proposed Unorthodox Location: Township 26 North, Range 8 West, NMPM
Section 12: 510' FNL - 1850' FEL
Unit Letter B
San Juan County, New Mexico

Reason for Unorthodox Location: Topographical conditions identified
by the Bureau of Land Management.
Standard location would place well
on tip of ridge.

Offsetting Leases and Operators: See Exhibit "A" hereto and incorporated
herein by reference.

Existent Topographical Conditions: See Exhibit "B" hereto and incorporated
herein by reference.

New Mexico Oil Conservation Division
Rule Authorizing Application: Rule 104-F

By:

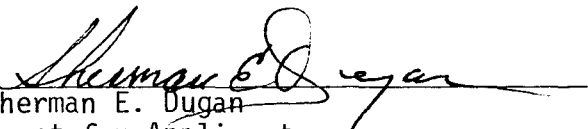

Sherman E. Dugan
Agent for Applicant

Waiver:

El Paso Natural Gas Co. hereby acknowledges receipt of the Application
for Administrative Approval of Unorthodox Location filed by Lively Exploration
Company herein and hereby waives objection to Lively Exploration Company's
Application for Administrative Approval of Unorthodox Location for their
Lively #20E Well as proposed herein.

By:

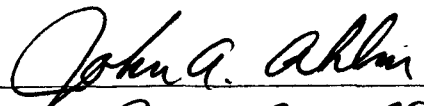
Date:

June 9, 1980

APPLICATION FOR ADMINISTRATIVE APPROVAL
OF UNORTHODOX LOCATION

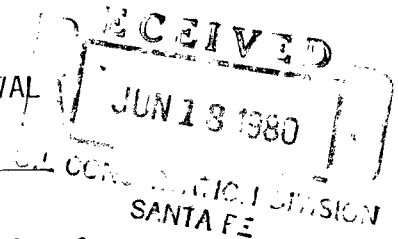

Applicant: Lively Exploration Co.
1010 First City National Bank Bldg.
Houston, TX 77002

Name of Well: Lively #20E

Land Dedicated to Well: Township 26 North, Range 8 West, NMPM
Section 12: E/2

Containing 320 acres more or less

Proposed Unorthodox Location: Township 26 North, Range 8 West, NMPM
Section 12: 510' FNL - 1850' FEL
Unit Letter B
San Juan County, New Mexico

Reason for Unorthodox Location: Topographical conditions identified
by the Bureau of Land Management.
Standard location would place well
on tip of ridge.

Offsetting Leases and Operators: See Exhibit "A" hereto and incorporated
herein by reference.

Existent Topographical Conditions: See Exhibit "B" hereto and incorporated
herein by reference.

New Mexico Oil Conservation Division
Rule Authorizing Application: Rule 104-F

By: Sherman E. Dugan
Sherman E. Dugan
Agent for Applicant

Waiver:

Supron Energy Corp. hereby acknowledges receipt of the Application
for Administrative Approval of Unorthodox Location filed by Lively Exploration
Company herein and hereby waives objection to Lively Exploration Company's
Application for Administrative Approval of Unorthodox Location for their
Lively #20E Well as proposed herein.

By: Haskell Fleetwood
Haskell Fleetwood, Vice President

Date: June 5, 1980

dugan production corp

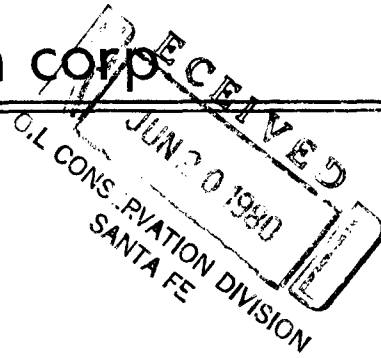

June 17, 1980

R. L. Stamets
Technical Support Chief
New Mexico Oil Conservation Division
Box 2088
Santa Fe, NM 87501

Re: Application for Administrative Approval of Unorthodox
Location for the Lively #19E and the Lively #20E Wells
for Lively Exploration Company.

Dear Mr. Stamets:

We received two duplicate executed copies of waivers from Southwest Production Co. on the two captioned applications.

We are retaining one signed copy for our files and forwarding the extra signed copy to your office. We thought Southwest Production Co. may have inadvertently mailed your copy to us.

Thank you for your assistance.

Sincerely,

A handwritten signature in cursive script that reads "Patty Sink".

Patty Sink
Drilling Secretary

Enclosures

APPLICATION FOR ADMINISTRATIVE APPROVAL
OF UNORTHODOX LOCATION

Applicant: Lively Exploration Co.
1010 First City National Bank Bldg.
Houston, TX 77002

Name of Well: Lively #20E

Land Dedicated to Well: Township 26 North, Range 8 West, NMPM
Section 12: E/2
Containing 320 acres more or less

Proposed Unorthodox Location: Township 26 North, Range 8 West, NMPM
Section 12: 510' FNL - 1850' FEL
Unit Letter B
San Juan County, New Mexico

Reason for Unorthodox Location: Topographical conditions identified
by the Bureau of Land Management.
Standard location would place well
on tip of ridge.

Offsetting Leases and Operators: See Exhibit "A" hereto and incorporated
herein by reference.

Existent Topographical Conditions: See Exhibit "B" hereto and incorporated
herein by reference.

New Mexico Oil Conservation Division
Rule Authorizing Application: Rule 104-F

By: Sherman E. Dugan
Sherman E. Dugan
Agent for Applicant

Waiver:

Southwest Production Co. hereby acknowledges receipt of the Application
for Administrative Approval of Unorthodox Location filed by Lively Exploration
Company herein and hereby waives objection to Lively Exploration Company's
Application for Administrative Approval of Unorthodox Location for their
Lively #20E Well as proposed herein.

By: F. P. Crumpler
Date: 6/6/80

Walsh

ENGINEERING & PRODUCTION CORP.

March 3, 1981

EWELL N. WALSH, P.E.
President

PETROLEUM ENGINEERING
RESERVOIR STUDIES
EVALUATIONS
GEOLOGICAL STUDIES
LEASE MANAGEMENT
CONTRACT PUMPING
DRILLING SUPERVISION
WORKOVER SUPERVISION

CERTIFIED MAIL

Mr. F. P. Crum, Jr.
SOUTHWEST PRODUCTION COMPANY
P. O. Box 400
Aztec, New Mexico 87410

REF: Unorthodox Location
Lively Exploration Company
Lively No. 20-E
Unit B, SEC. 12-T25N-R8W
San Juan County, New Mexico

Dear Mr. Crum:

Please find enclosed a request to the Oil Conservation Commission to change the location of the above-referred-to well as follows:

FROM: 510'FNL, 1850'FEL
TO: 480'FNL, 1980'FEL

The location has been moved from the present area to an area which would lessen the environmental impact.

Although the change is not a considerable distance, it is necessary to request your approval of the new location.

Enclosed you will find three copies of the Application with a Waiver of Objection. Upon your approval of the waiver, please send one copy on to:

Mr. Joe D. Ramey, Director
Energy & Minerals Department
Oil Conservation Commission
P. O. Box 2088
Santa Fe, New Mexico 87501

Please return one copy to the undersigned and retain one copy for your files.

Page 2
F. P. Crum, Jr.

Thank you for your consideration and cooperation in this matter.

Very truly yours,

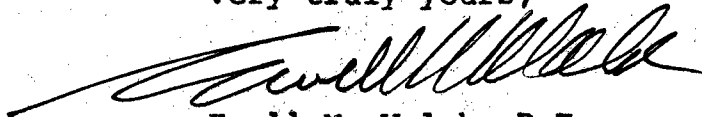
A handwritten signature in dark ink, appearing to read 'Ewell N. Walsh', written in a cursive style.

Ewell N. Walsh, P.E.
President

ENW:rr
cc: Lively Exploration Company
Oil Conservation Commission, Joe Ramey, Santa Fe, N.M.

Enclosures

Walsh

ENGINEERING & PRODUCTION CORP.

March 3, 1981

PETROLEUM ENGINEERING
RESERVOIR STUDIES
EVALUATIONS
GEOLOGICAL STUDIES
LEASE MANAGEMENT
CONTRACT PUMPING
DRILLING SUPERVISION
WORKOVER SUPERVISION

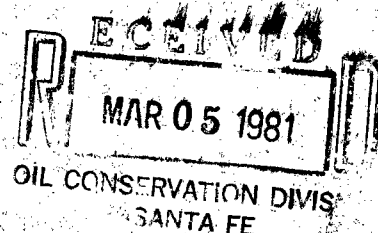

EWELL N. WALSH, P.E.
President

CERTIFIED MAIL

Mr. J. M. Lacey
TENNECO OIL COMPANY
720 S. Colorado Blvd.
Denver, Colorado 80222

REF: Unorthodox Location
Lively Exploration Company
Lively No. 20-E
Unit B, SEC. 12-T26N-R8W
San Juan County, New Mexico

Dear Mr. Lacey:

Please find enclosed a request to the Oil Conservation Commission to change the location of the above-referred-to well as follows:

FROM: 510'FNL, 1850'FEL
TO: 480'FNL, 1980'FEL

The location has been moved from the present area to an area which would lessen the environmental impact.

Although the change is not a considerable distance, it is necessary to request your approval of the new location.

Enclosed you will find three copies of the Application with a Waiver of Objection. Upon your approval of the waiver, please send one copy to:

Mr. Joe D. Ramey, Director
Energy & Minerals Department
Oil Conservation Commission
P. O. Box 2088
Santa Fe, New Mexico 87501

Please return one copy to the undersigned and retain one copy for your files.

Page 2

Mr. J. M. Lacey

Thank you for your consideration and cooperation in this matter.

Very truly yours,

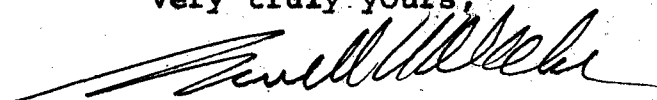

Ewell N. Walsh, P.E.
President

ENW:rr

cc: Lively Exploration Company

Oil Conservation Division, Joe Ramey, Santa Fe, N.M.

Enclosure

Walsh

ENGINEERING & PRODUCTION CORP.

March 3, 1981

PETROLEUM ENGINEERING
RESERVOIR STUDIES
EVALUATIONS
GEOLOGICAL STUDIES
LEASE MANAGEMENT
CONTRACT PUMPING
DRILLING SUPERVISION
WORKOVER SUPERVISION

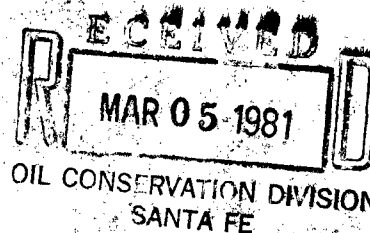

EWELL N. WALSH, P.E.
President

CERTIFIED MAIL

Mr. Havell Fleetwood
Vice President
SUPRON ENERGY CORPORATION
10300 N. Central Expressway
Building 5, Fifth Floor
Dallas, Texas 75231

REF: Unorthodox Location
Lively Exploration Company
Lively No. 20-E
Unit B, SEC. 12-T26N-R8W
San Juan County, New Mexico

Dear Mr. Fleetwood:

Please find enclosed a request to the Oil Conservation Commission to change the location of the above-referred-to well as follows:

FROM: 510'FNL, 1850'FEL
TO: 480'FNL, 1980'FEL

The location has been moved from the present area to an area which would lessen the environmental impact.

Although the change is not a considerable distance, it is necessary to request your approval of the new location.

Enclosed you will find three copies of the Application with a Waiver of Objection. Upon your approval of the waiver, please send one copy to:

Mr. Joe D. Ramey, Director
Energy & Minerals Department
Oil Conservation Commission
P. O. Box 2088
Santa Fe, New Mexico 87501

Please return one copy of the waiver to the undersigned and retain one copy for your files.

Page 2
Mr. Havell Fleetwood

Thank you for your consideration and cooperation in this matter.

Very truly yours,

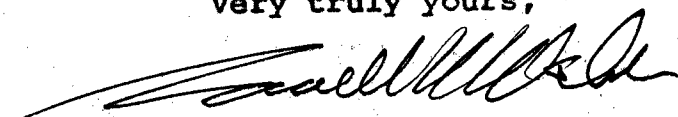
A handwritten signature in dark ink, appearing to read 'Ewell N. Walsh', with a stylized, flowing script.

Ewell N. Walsh, P.E.
President

ENW:rr

cc: Lively Exploration Company
Oil Conservation Commission, Joe Ramey, Santa Fe, N.M.

Enclosures

Walsh

ENGINEERING & PRODUCTION CORP.
March 3, 1981

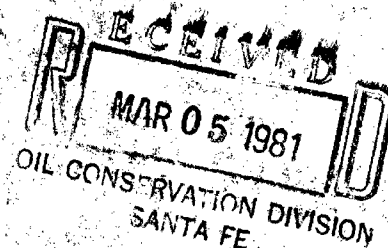

EWELL N. WALSH, P.E.
President

PETROLEUM ENGINEERING
RESERVOIR STUDIES
EVALUATIONS
GEOLOGICAL STUDIES
LEASE MANAGEMENT
CONTRACT PUMPING
DRILLING SUPERVISION
WORKOVER SUPERVISION

CERTIFIED MAIL

Mr. K. G. Ranum
Vice President
DEPCO, Inc.
1000 Petroleum Building
110 - 16th Street
Denver, Colorado 80202

REF: Unorthodox Location
Lively Exploration Company
Lively No. 20-E
Unit B, Sec. 12-T26N-R8W
San Juan County, New Mexico

Dear Mr. Ranum:

Please find enclosed a request to the Oil Conservation Commission to change the location of the above-referred-to well as follows:

From: 510'FNL, 1850'FEL
TO: 480'FNL, 1980'FEL

The location has been moved from the present area to an area which would lessen the environmental impact.

Although the change is not a considerable distance, it is necessary to request your approval of the new location.

Enclosed you will find three copies of the Application with a Waiver of Objection. Upon your approval of the waiver, please send one copy to:

Mr. Joe D. Ramey, Director
Energy & Minerals Department
Oil Conservation Commission
P. O. Box 2088
Santa Fe, New Mexico 87501

Please return one copy to the undersigned and retain one copy for your files.

Page 2
Mr. K. G. Ranum

Thank you for your consideration and cooperation in this matter.

Very truly yours,

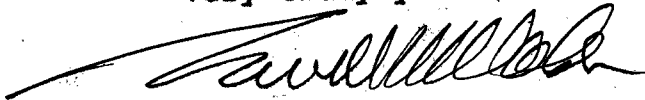
A handwritten signature in dark ink, appearing to read 'Ewell N. Walsh', with a long horizontal flourish extending to the left.

Ewell N. Walsh, P.E.
President

ENW:rr

cc: Lively Exploration Company
Oil Conservation Division, Joe Ramey, Santa Fe, N.M.

Enclosures