



PHILLIPS PETROLEUM COMPANY

ODESSA, TEXAS 79762
4001 PENBROOK

EXPLORATION AND PRODUCTION GROUP

March 12, 1981

Unorthodox Locations

East Vacuum Grayburg San Andres Unit
Vacuum Grayburg San Andres Pool
Lea County, New Mexico

New Mexico Department of Energy and Minerals (3)
Oil Conservation Division
P.O. Box 2088
Santa Fe, New Mexico 87501

Attention: Mr. Joe D. Ramey
Division Director

Gentlemen:

We respectfully request administrative approval of the unorthodox locations for the below listed wells. Administrative action is provided by Special Order No. R-5897, Section 4, Rule 8, provided the proposed locations exceed 330 feet from the nearest unit boundary. The locations for these wells meet that condition. A location plat for each well and a plat of the entire unit is enclosed.

- Tract 2944--Well No. 002 (a proposed water injection well)
2500 feet from east and 50 feet from north lines (Unit B)
Section 29, Township 17 South, Range 35 East, NMPM, Lea
County
- Tract 2980--Well No. 003 (a proposed water injection well)
1350 feet from north and 2600 feet from west lines (Unit F)
Section 29, Township 17 South, Range 35 East, NMPM, Lea
County
- Tract 2947--Well No. 001 (a proposed water injection well)
1500 feet from north and 50 feet from east lines (Unit H)
Section 29, Township 17 South, Range 35 East, NMPM, Lea
County
- Tract 2865--Well No. 001 (a proposed water injection well)
1475 feet from north and 2600 feet from west lines (Unit F)
Section 28, Township 17 South, Range 35 East, NMPM, Lea
County

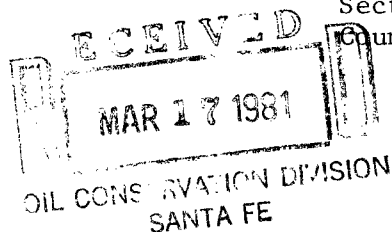

*NS L-1340
Rule 8 R 5897
Immediate*

*Date
Mar 26, 1981*

Unorthodox Locations
East Vacuum Grayburg San Andres Unit
Vacuum Grayburg San Andres Pool
Lea County, New Mexico
Page: 2

Tract 2851--Well No. 002 (a proposed water injection well)
50 feet from north and 50 feet from east lines (Unit A)
Section 28, Township 17 South, Range 35 East, NMPM, Lea
County
Tract 2155--Well No. 001 (a proposed water injection well)
1175 feet from south and 2500 feet from east lines (Unit O)
Section 21, Township 17 South, Range 35 East, NMPM, Lea
County
Tract 2150--Well No. 002 (a proposed water injection well)
1200 feet from south and 1300 feet from east lines (Unit P)
Section 21, Township 17 South, Range 35 East, NMPM, Lea
County

Your early consideration and advice will be appreciated.

Very truly yours,



T. Harold McLemore
Regulation and Proration Supervisor

THM:lw
Attachments

cc: Oil Conservation Division, Hobbs
w/attachments

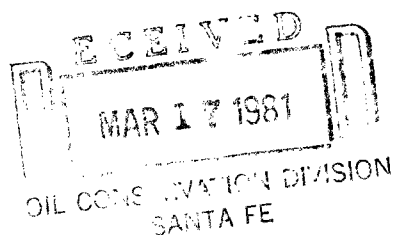

**NEW MEXICO OIL CONSERVATION COMMISSION
WELL LOCATION AND ACREAGE DEDICATION PLAT**

Form C-102
Supersedes C-128
Effective 1-1-65

All distances must be from the outer boundaries of the Section

Operator Phillips Petroleum Co.			Lease EVGSAU Tract 2944		Well No. 002
Unit Letter B	Section 29	Township 17 South	Range 35 East	County Lea	
Actual Footage Location of Well: 2500 feet from the east line and 50 feet from the north line					
Ground Level Elev. 3959.9 (Unprepared)	Producing Formation Grayburg/San Andres	Pool Vacuum Gb/San Andres		Dedicated Acreage: NA Water injection Acres	

1. Outline the acreage dedicated to the subject well by colored pencil or hachure marks on the plat below.
2. If more than one lease is dedicated to the well, outline each and identify the ownership thereof (both as to working interest and royalty).
3. If more than one lease of different ownership is dedicated to the well, have the interests of all owners been consolidated by communitization, unitization, force-pooling, etc?

☐ Yes ☐ No If answer is "yes," type of consolidation _____

If answer is "no," list the owners and tract descriptions which have actually been consolidated. (Use reverse side of this form if necessary.) _____

No allowable will be assigned to the well until all interests have been consolidated (by communitization, unitization, forced-pooling, or otherwise) or until a non-standard unit, eliminating such interests, has been approved by the Commission.

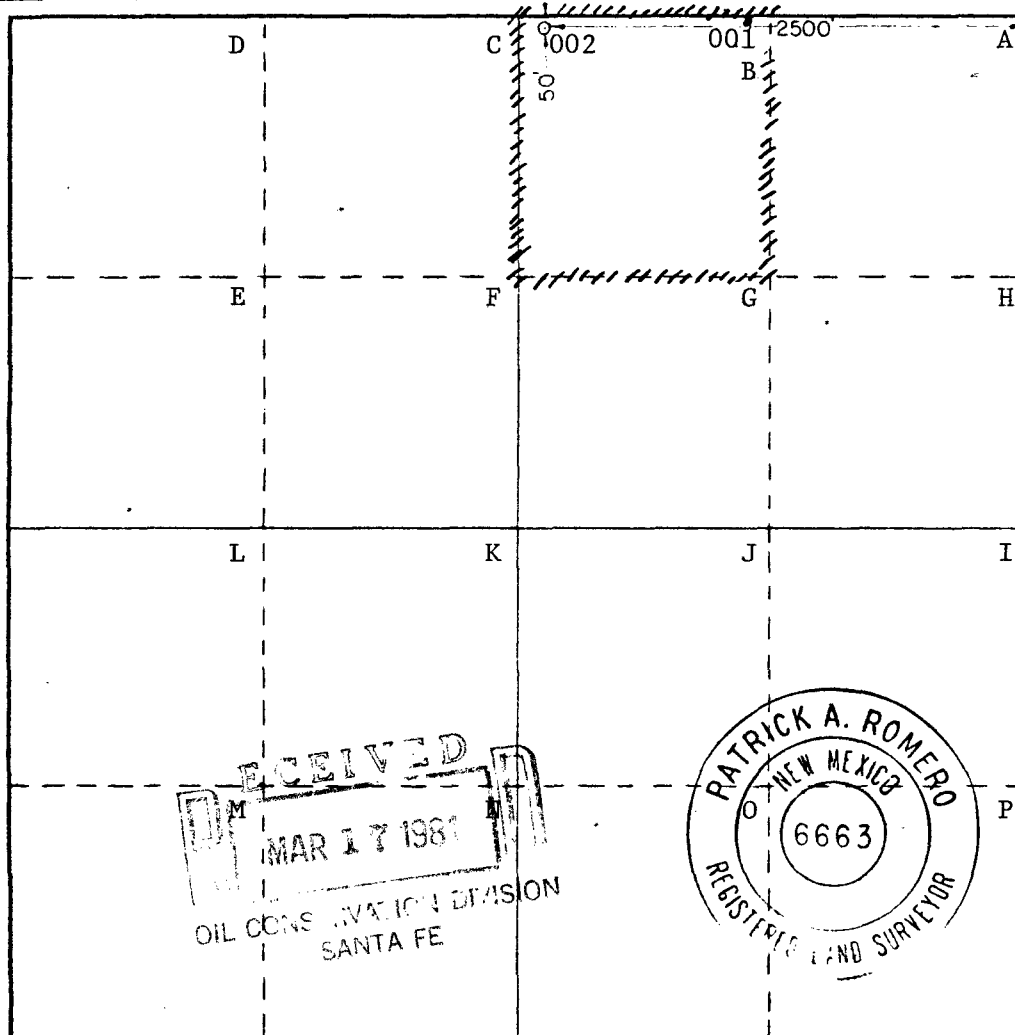

RECEIVED
MAR 17 1981
OIL CONSERVATION DIVISION
SANTA FE



CERTIFICATION

I hereby certify that the information contained herein is true and complete to the best of my knowledge and belief.

[Signature]
Name

W. J. Mueller
Position

Senior Engineering Specialist
Company

Phillips Petroleum Company

Date
March 12, 1981

I hereby certify that the well location shown on this plat was plotted from field notes of actual surveys made by me or under my supervision, and that the same is true and correct to the best of my knowledge and belief.

Date Surveyed
3-2-81

Registered Professional Engineer and/or Land Surveyor

[Signature]
Certificate No. **JOHN W. WEST 676**
PATRICK A. ROMERO 6663
Ronald J. Eidson 3239

**NEW MEXICO OIL CONSERVATION COMMISSION
WELL LOCATION AND ACREAGE DEDICATION PLAT**

Form C-102
Supersedes C-128
Effective 1-1-65

All distances must be from the outer boundaries of the Section

Operator Phillips Petroleum Co.			Lease EVGSAU Tract 2980		Well No. 003
Unit Letter F	Section 29	Township 17 South	Range 35 East	County Lea	
Actual Footage Location of Well: 1350 feet from the North line and 2600 feet from the West line					
Ground Level Elev. 3962.0	Producing Formation Grayburg/San Andres	Pool Vacuum Gb/San Andres		Dedicated Acreage: NA Water injection Acres	

(Unprepared)

1. Outline the acreage dedicated to the subject well by colored pencil or hachure marks on the plat below.
2. If more than one lease is dedicated to the well, outline each and identify the ownership thereof (both as to working interest and royalty).
3. If more than one lease of different ownership is dedicated to the well, have the interests of all owners been consolidated by communitization, unitization, force-pooling, etc?

☐ Yes ☐ No If answer is "yes," type of consolidation _____

If answer is "no," list the owners and tract descriptions which have actually been consolidated. (Use reverse side of this form if necessary.) _____

No allowable will be assigned to the well until all interests have been consolidated (by communitization, unitization, forced-pooling, or otherwise) or until a non-standard unit, eliminating such interests, has been approved by the Commission.

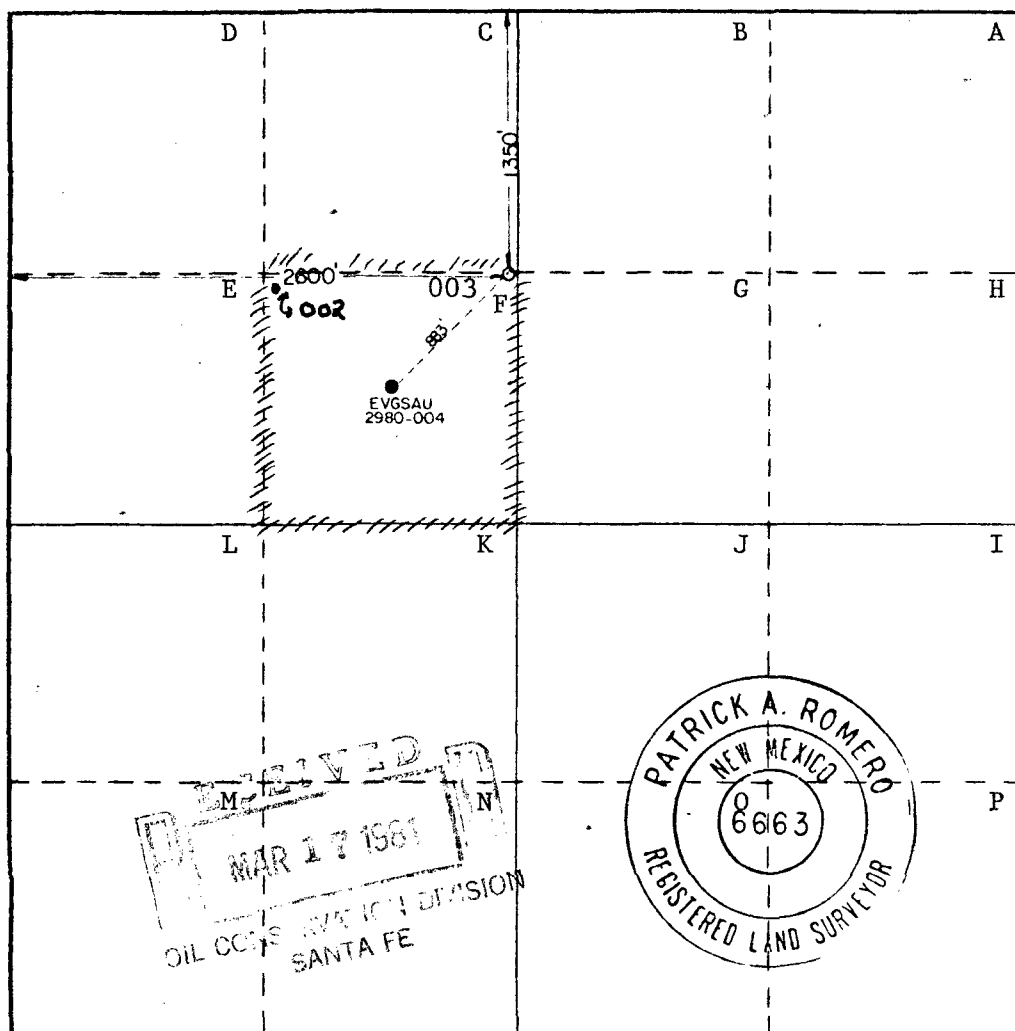

CERTIFICATION

I hereby certify that the information contained herein is true and complete to the best of my knowledge and belief.

Name
W. J. Mueller
W. J. Mueller

Position
Senior Engineering Specialist

Company
Phillips Petroleum Company

Date
March 12, 1981

I hereby certify that the well location shown on this plat was plotted from field notes of actual surveys made by me or under my supervision, and that the same is true and correct to the best of my knowledge and belief.

Date Surveyed
3-2-81

Registered Professional Engineer and/or Land Surveyor

Patrick A. Romero

Certificate No **JOHN W. WEST 676**
PATRICK A. ROMERO 6663
Ronald J. Eidson 3239

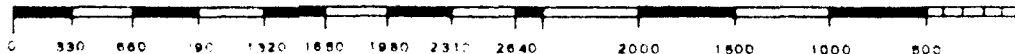

**NEW MEXICO OIL CONSERVATION COMMISSION
WELL LOCATION AND ACREAGE DEDICATION PLAT**

Form C-102
Supersedes C-128
Effective 1-1-65

All distances must be from the outer boundaries of the Section

Operator Phillips Petroleum Co.			Lease EVGSAU Tract 2947		Well No. 001
Unit Letter H	Section 29	Township 17 South	Range 35 East	County Lea	

Actual Footage Location of Well:

1500 feet from the **North** line and **50** feet from the **East** line

Ground Level Elev. 3966.8	Producing Formation Grayburg/San Andres	Pool Vacuum Gb/San Andres	Dedicated Acreage: Water injection NA <small>Acres</small>
-------------------------------------	---	-------------------------------------	---

(Unprepared)

- Outline the acreage dedicated to the subject well by colored pencil or hachure marks on the plat below.
- If more than one lease is dedicated to the well, outline each and identify the ownership thereof (both as to working interest and royalty).
- If more than one lease of different ownership is dedicated to the well, have the interests of all owners been consolidated by communitization, unitization, force-pooling, etc?

☐ Yes ☐ No If answer is "yes," type of consolidation _____

If answer is "no," list the owners and tract descriptions which have actually been consolidated. (Use reverse side of this form if necessary.) _____

No allowable will be assigned to the well until all interests have been consolidated (by communitization, unitization, forced-pooling, or otherwise) or until a non-standard unit, eliminating such interests, has been approved by the Commission.

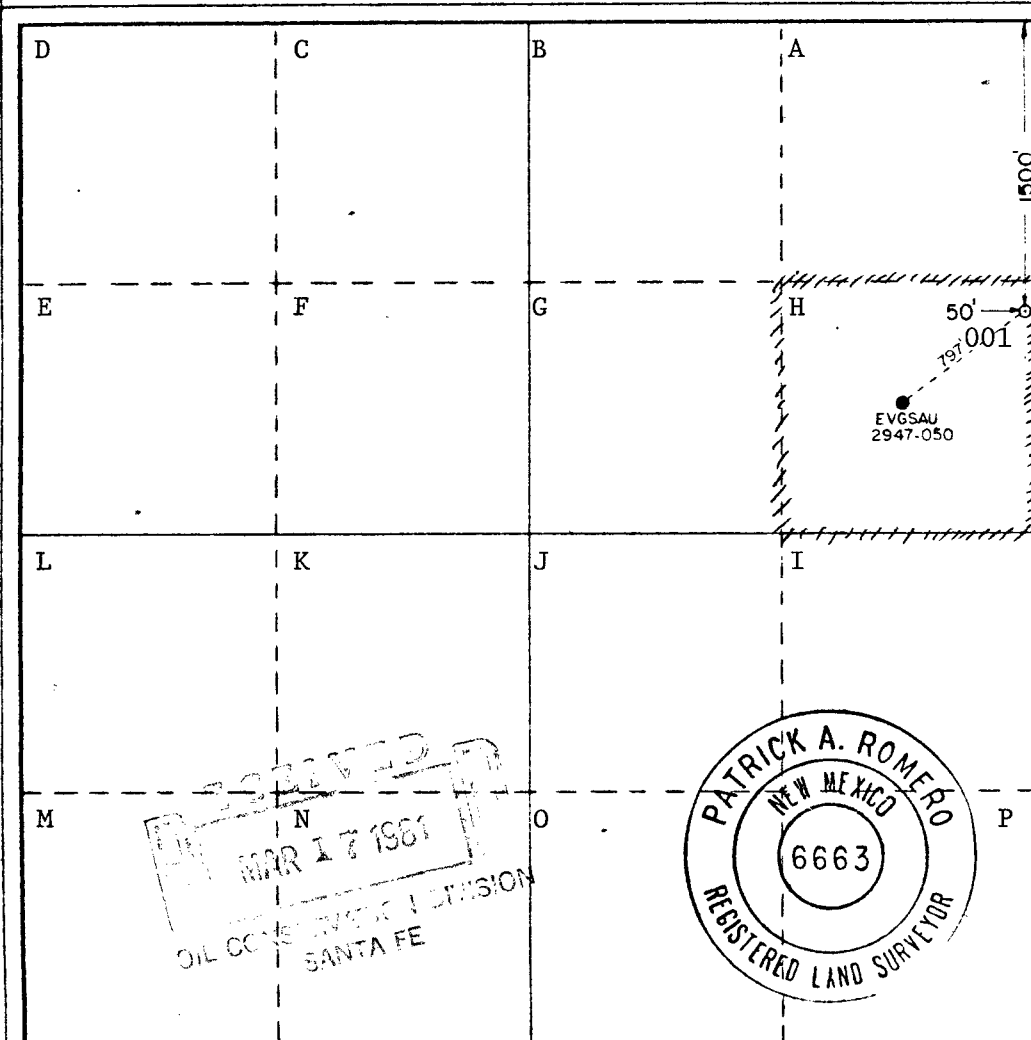

CERTIFICATION

I hereby certify that the information contained herein is true and complete to the best of my knowledge and belief.

[Signature]

Name
W. J. Mueller
Position
Senior Engineering Advisor
Company
Phillips Petroleum Company
Date
March 12, 1981

I hereby certify that the well location shown on this plat was plotted from field notes of actual surveys made by me or under my supervision, and that the same is true and correct to the best of my knowledge and belief.

Date Surveyed
3-2-81

Registered Professional Engineer and/or Land Surveyor

[Signature]

Certificate No. **JOHN W. WEST 676**
PATRICK A. ROMERO 6663
Ronald J. Eidson 3239

**NEW MEXICO OIL CONSERVATION COMMISSION
WELL LOCATION AND ACREAGE DEDICATION PLAT**

Form C-102
Supersedes C-128
Effective 1-1-65

All distances must be from the outer boundaries of the Section

Operator Phillips Petroleum Co.			Lease EVGSAU Tract 2865		Well No. 001
Unit Letter F	Section 28	Township 17 South	Range 35 East	County Lea	
Actual Footage Location of Well: 1475 feet from the North line and 2600 feet from the West line					
Ground Level Elev. 3956.4	Producing Formation Grayburg/San Andres		Pool Vacuum Gb/San Andres		Dedicated Acreage: NA
(Unprepared)			Water injection Acres		

1. Outline the acreage dedicated to the subject well by colored pencil or hachure marks on the plat below.
2. If more than one lease is dedicated to the well, outline each and identify the ownership thereof (both as to working interest and royalty).
3. If more than one lease of different ownership is dedicated to the well, have the interests of all owners been consolidated by communitization, unitization, force-pooling, etc?

☐ Yes ☐ No If answer is "yes," type of consolidation _____

If answer is "no," list the owners and tract descriptions which have actually been consolidated. (Use reverse side of this form if necessary.) _____

No allowable will be assigned to the well until all interests have been consolidated (by communitization, unitization, forced-pooling, or otherwise) or until a non-standard unit, eliminating such interests, has been approved by the Commission.

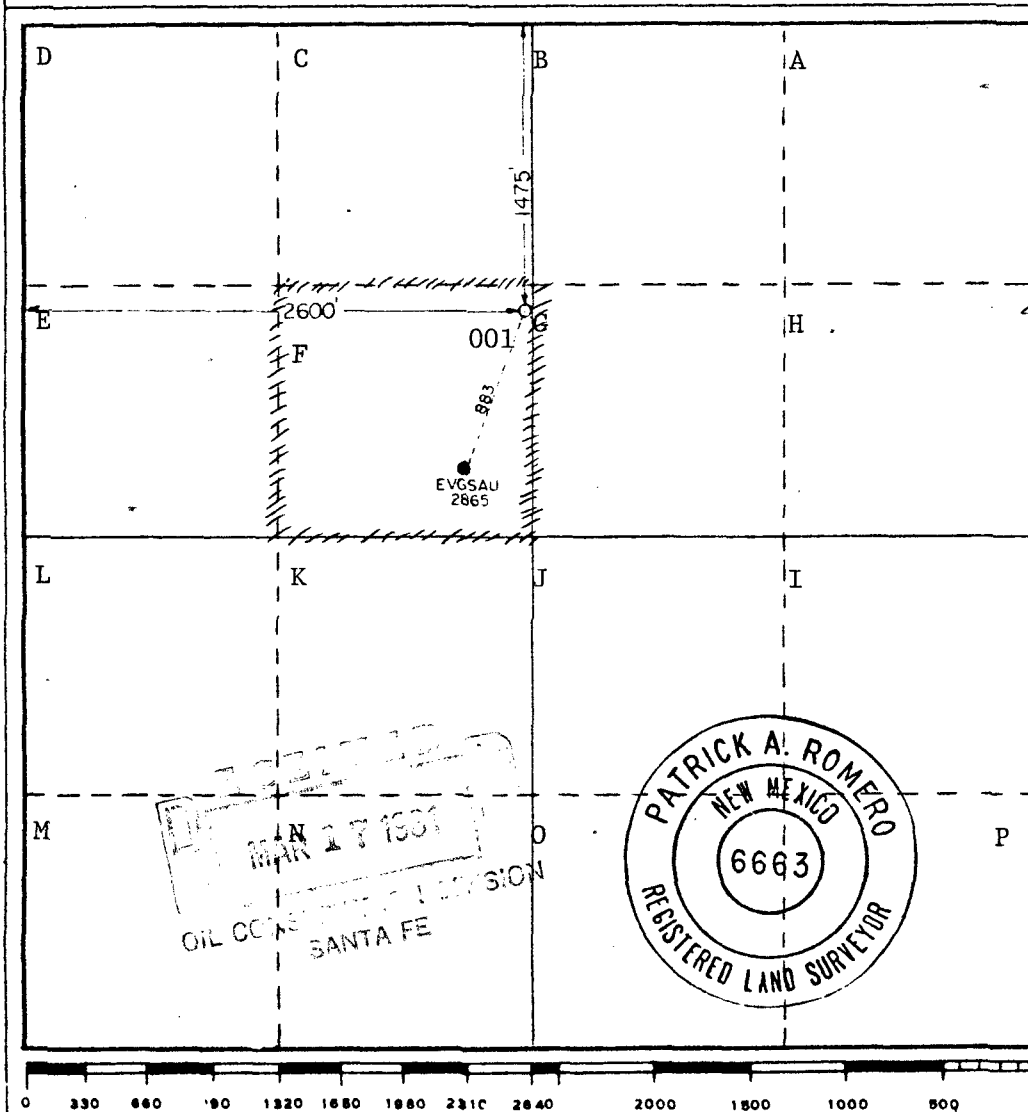

CERTIFICATION

I hereby certify that the information contained herein is true and complete to the best of my knowledge and belief.

W. J. Mueller

Position
Senior Engineering Advisor
Company
Phillips Petroleum Company

Date
March 11, 1981

I hereby certify that the well location shown on this plat was plotted from field notes of actual surveys made by me or under my supervision, and that the same is true and correct to the best of my knowledge and belief.

Date Surveyed
3-2-81

Registered Professional Engineer and/or Land Surveyor

Patrick A. Romero
Certificate No. **JOHN W. WEST 678**
PATRICK A. ROMERO 6663
Ronald J. Eidson 3239

**NEW MEXICO OIL CONSERVATION COMMISSION
WELL LOCATION AND ACREAGE DEDICATION PLAT**

Form C-102
Supersedes C-128
Effective 1-1-65

All distances must be from the outer boundaries of the Section

Operator Phillips Petroleum Co.			Lease EVGSAU Tract 2851		Well No. 002
Unit Letter A	Section 28	Township 17 South	Range 35 East	County Lea	
Actual Footage Location of Well: 50 feet from the North line and 50 feet from the East line					
Ground Level Elev. 3946.1	Producing Formation Grayburg/San Andres		Pool Vacuum Gb/San Andres		Dedicated Acreage: NA Water injection Acres

(unprepared)

1. Outline the acreage dedicated to the subject well by colored pencil or hachure marks on the plat below.
2. If more than one lease is dedicated to the well, outline each and identify the ownership thereof (both as to working interest and royalty).
3. If more than one lease of different ownership is dedicated to the well, have the interests of all owners been consolidated by communitization, unitization, force-pooling, etc?

☐ Yes ☐ No If answer is "yes," type of consolidation _____

If answer is "no," list the owners and tract descriptions which have actually been consolidated. (Use reverse side of this form if necessary.) _____

No allowable will be assigned to the well until all interests have been consolidated (by communitization, unitization, forced-pooling, or otherwise) or until a non-standard unit, eliminating such interests, has been approved by the Commission.

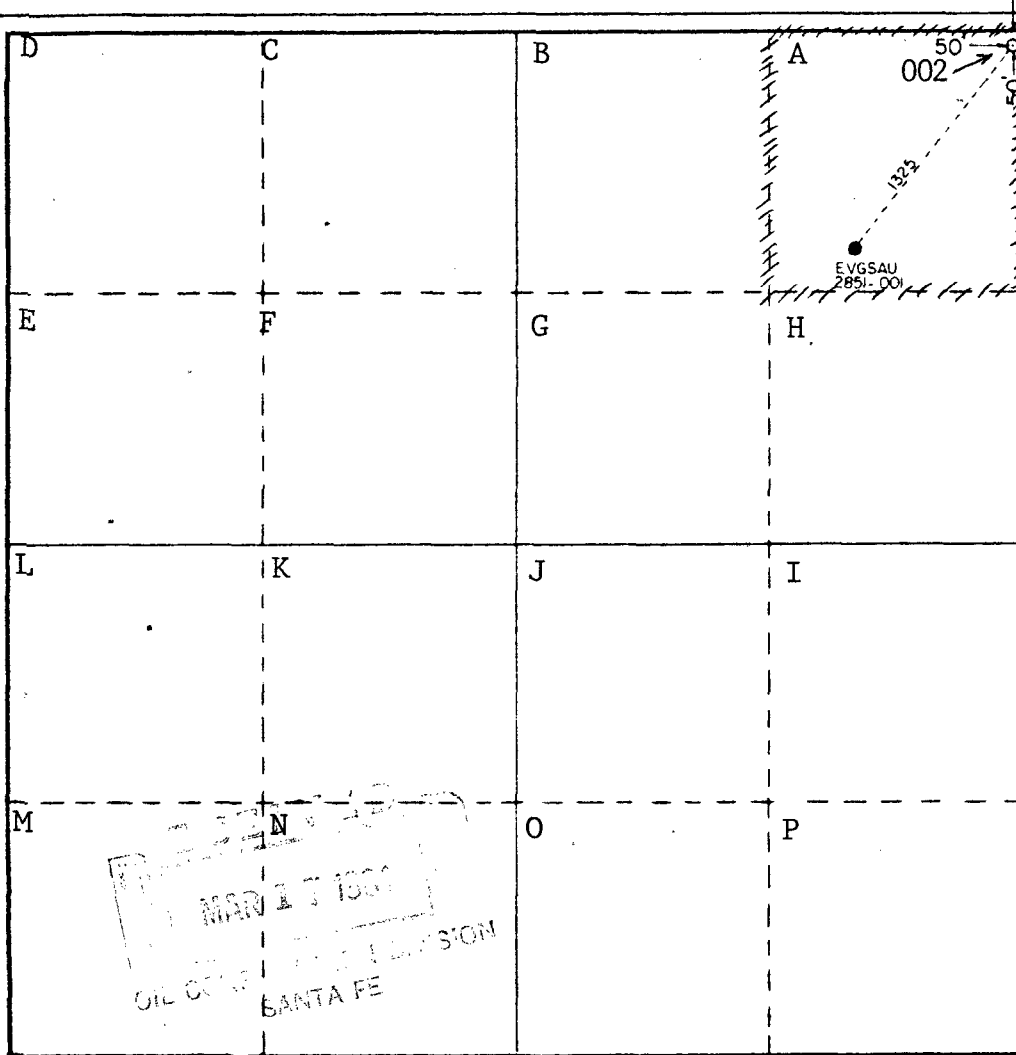

CERTIFICATION

I hereby certify that the information contained herein is true and complete to the best of my knowledge and belief.

Name: W. J. Mueller
Position: Senior Engineering Specialist
Company: Phillips Petroleum Company
Date: March 11, 1981

I hereby certify that the well location shown on this plat was plotted from field notes of actual surveys made by me or under my supervision, and that the same is true and correct to the best of my knowledge and belief.

Date Surveyed: 3-2-81
Registered Professional Engineer and/or Land Surveyor: Patrick A. Romero
Certificate No: JOHN W. WEST 676
PATRICK A. ROMERO 6663
Ronald J. Eidson 3239

MAR 11 1981
OIL CONSERVATION COMMISSION
SANTA FE

**NEW MEXICO OIL CONSERVATION COMMISSION
WELL LOCATION AND ACREAGE DEDICATION PLAT**

Form C-102
Supersedes C-128
Effective 1-1-65

All distances must be from the outer boundaries of the Section.

Operator Phillips Petroleum Co.			Lease EVGSAU Tract 2155		Well No. 001
Unit Letter 0	Section 21	Township 17 South	Range 35 East	County Lea	
Actual Footage Location of Well: 1175 feet from the south line and 2500 feet from the east line					
Ground Level Elev. 3956.6 (unprepared)	Producing Formation Grayburg/San Andres		Pool Vacuum Gb/San Andres	Dedicated Acreage: NA Water injection Acres	

1. Outline the acreage dedicated to the subject well by colored pencil or hachure marks on the plat below.
2. If more than one lease is dedicated to the well, outline each and identify the ownership thereof (both as to working interest and royalty).
3. If more than one lease of different ownership is dedicated to the well, have the interests of all owners been consolidated by communitization, unitization, force-pooling, etc.?

☐ Yes ☐ No If answer is "yes," type of consolidation _____

If answer is "no," list the owners and tract descriptions which have actually been consolidated. (Use reverse side of this form if necessary.) _____

No allowable will be assigned to the well until all interests have been consolidated (by communitization, unitization, forced-pooling, or otherwise) or until a non-standard unit, eliminating such interests, has been approved by the Commission.

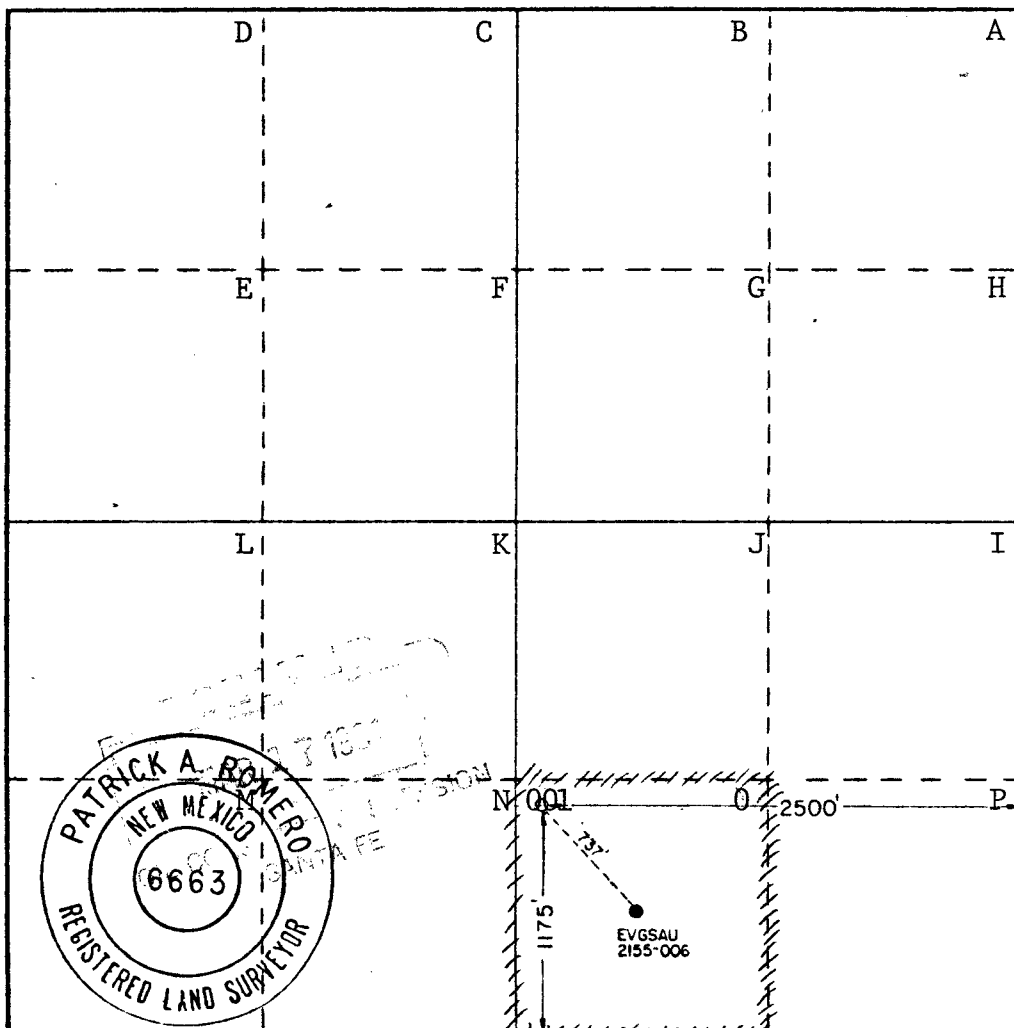

CERTIFICATION

I hereby certify that the information contained herein is true and complete to the best of my knowledge and belief.

Name W. J. Mueller
Position Senior Engineering Specialist
Company Phillips Petroleum Company
Date March 11, 1981

I hereby certify that the well location shown on this plat was plotted from field notes of actual surveys made by me or under my supervision, and that the same is true and correct to the best of my knowledge and belief.

Date Surveyed 3-2-81

Registered Professional Engineer and/or Land Surveyor

Patrick A. Romero
Certificate No. JOHN W. WEST 676
PATRICK A. ROMERO 6663
Ronald J. Eidson 3239

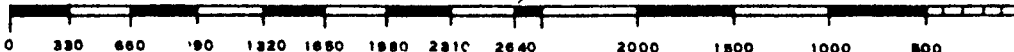

**NEW MEXICO OIL CONSERVATION COMMISSION
WELL LOCATION AND ACREAGE DEDICATION PLAT**

Form C-102
Supersedes C-128
Effective 1-1-65

All distances must be from the outer boundaries of the Section

Operator Phillips Petroleum Co.			Lease EVGSAU Tract 2150		Well No. -002
Unit Letter P	Section 21	Township 17 South	Range 35 East	County Lea	
Actual Footage Location of Well: 1200 feet from the south line and 1300 feet from the east line					
Ground Level Elev. 3949.9	Producing Formation Grayburg/San Andres		Pool Vacuum Gb/San Andres		Dedicated Acreage: NA-Water injections

(unprepared)

1. Outline the acreage dedicated to the subject well by colored pencil or hachure marks on the plat below.
2. If more than one lease is dedicated to the well, outline each and identify the ownership thereof (both as to working interest and royalty).
3. If more than one lease of different ownership is dedicated to the well, have the interests of all owners been consolidated by communitization, unitization, force-pooling, etc?

☐ Yes ☐ No If answer is "yes," type of consolidation _____

If answer is "no," list the owners and tract descriptions which have actually been consolidated. (Use reverse side of this form if necessary.) _____

No allowable will be assigned to the well until all interests have been consolidated (by communitization, unitization, forced-pooling, or otherwise) or until a non-standard unit, eliminating such interests, has been approved by the Commission.

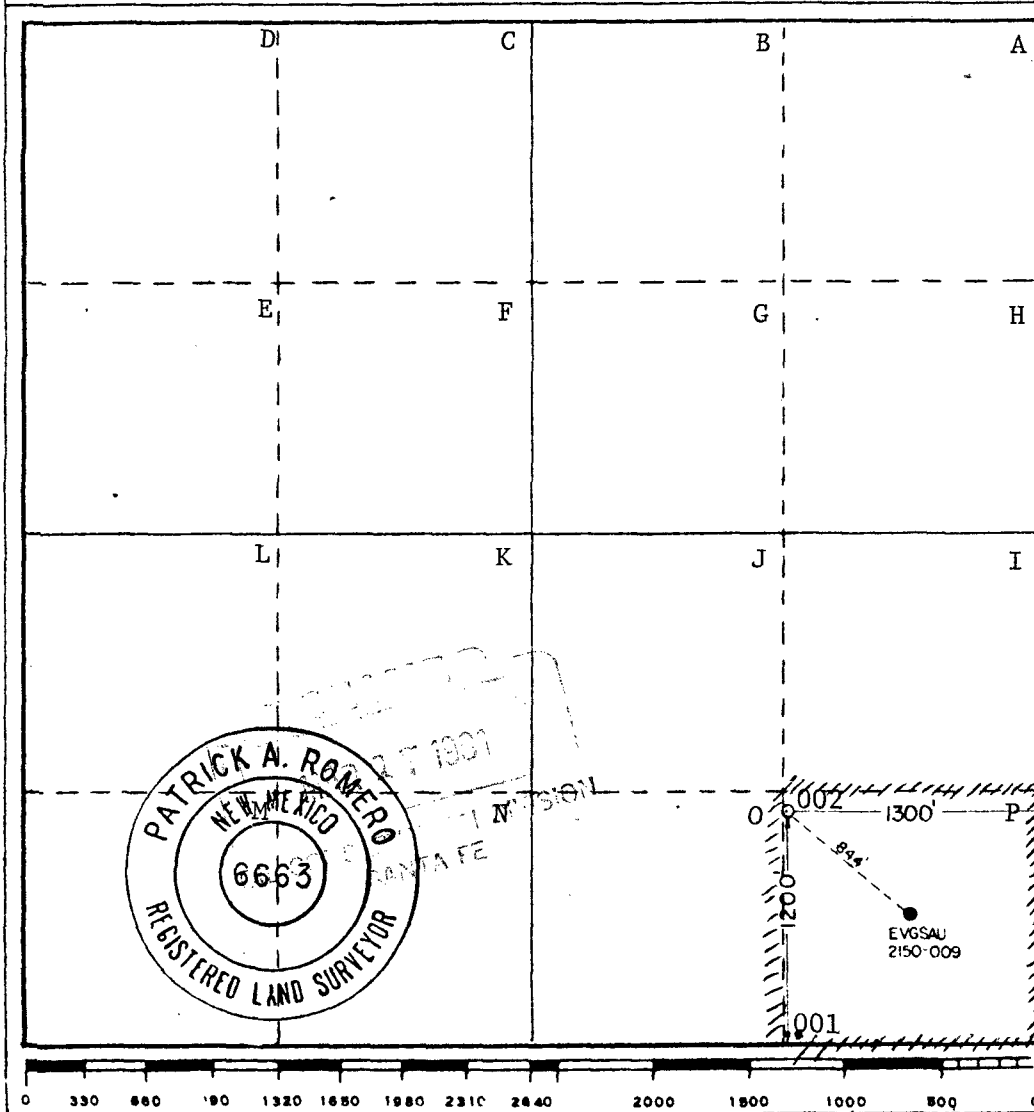

CERTIFICATION

I hereby certify that the information contained herein is true and complete to the best of my knowledge and belief.

[Signature]
Name

W. J. Mueller
Position

Senior Engineering Specialist
Company

Phillips Petroleum Company

Date
March 11, 1981

I hereby certify that the well location shown on this plat was plotted from field notes of actual surveys made by me or under my supervision, and that the same is true and correct to the best of my knowledge and belief.

Date Surveyed
3-2-81

Registered Professional Engineer and/or Land Surveyor

[Signature]
Patrick A. Romero

Certificate No. **JOHN W. WEST 676**
PATRICK A. ROMERO 8863
Ronald J. Eidson 3239

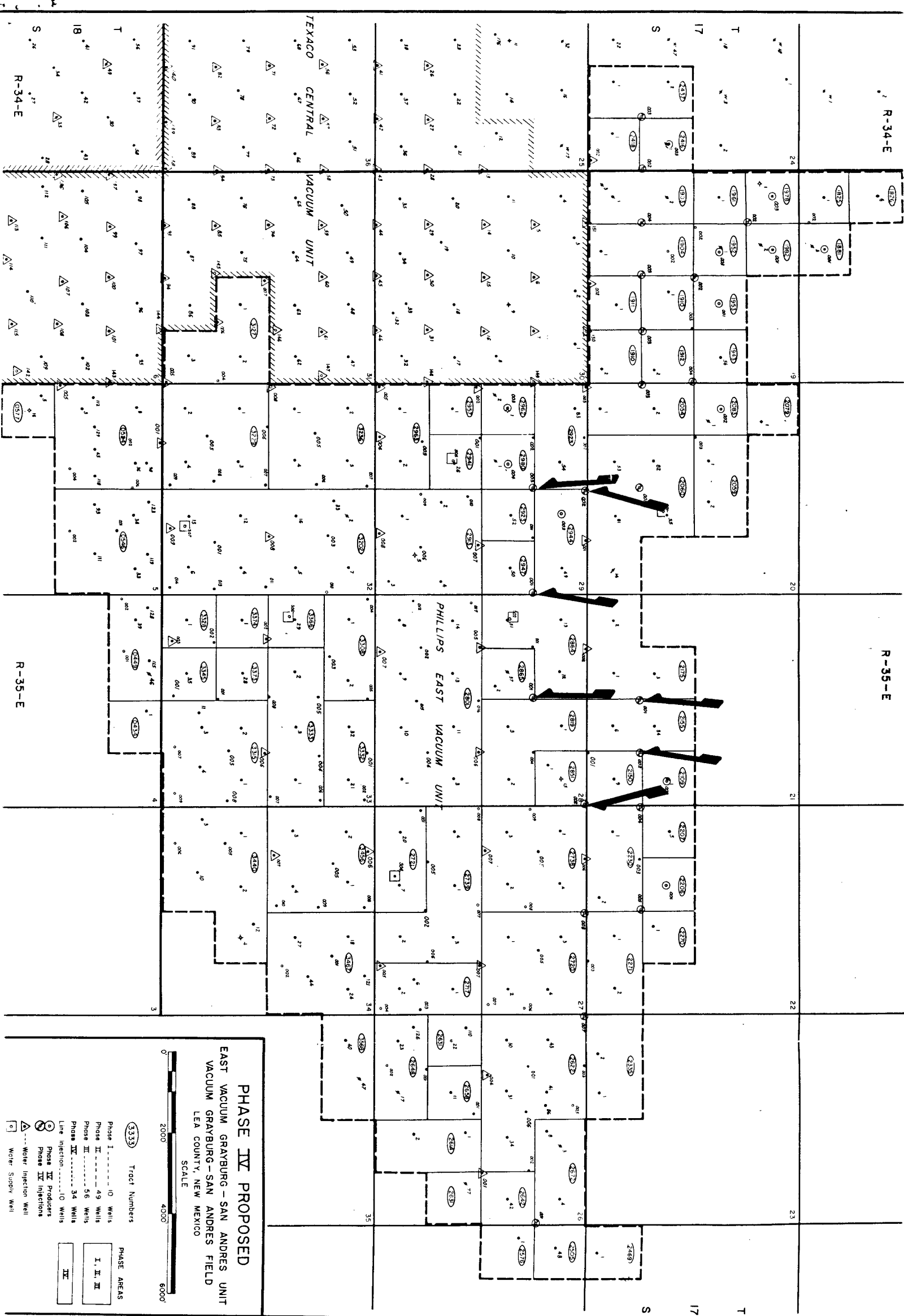

PHASE IV PROPOSED

EAST VACUUM GRAYBURG - SAN ANDRES UNIT

VACUUM GRAYBURG - SAN ANDRES FIELD

LEA COUNTY, NEW MEXICO

SCALE

0 2000 4000 6000'

3333 Tract Numbers

Phase I - 10 Wells

Phase II - 49 Wells

Phase III - 56 Wells

Phase IV - 34 Wells

Line Injection - 10 Wells

Phase IV Producers

Phase IV Injectors

Water Injection Well

Water Supply Well

PHASE AREAS

I, II, III

IV



PETROLEUM PRODUCTS

PRODUCING DEPARTMENT

March 18, 1981

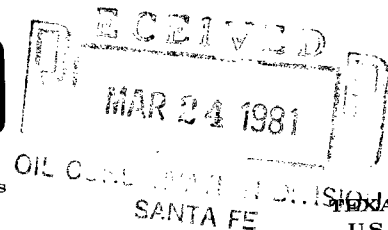

TEXACO
U.S.A.
A DIVISION OF TEXACO INC.
P. O. BOX 3109
MIDLAND, TEXAS 79702

FLUID INJECTION APPLICATION
PHILLIPS PETROLEUM COMPANY
EAST VACUUM GRAYBURG/SAN ANDRES
UNIT WELL NO. 002 (TRACT 1825)
VACUUM GRAYBURG SAN ANDRES FIELD
LEA COUNTY, NEW MEXICO

The State of New Mexico
Oil Conservation Commission
P. O. Box 2088
Santa Fe, NM 87501

Attention: Mr. Joe D. Ramey

Gentlemen:

Texaco Inc. has been advised by Phillips Petroleum Company of their application to inject fluid into the subject well. We understand that injection will be 4660'-4760'.

Texaco Inc., as an offset operator, waives objection to the application.

Yours very truly,

Alan R. McDaniel
Division Manager

By R. D. Tomberlin
R. D. Tomberlin
Petroleum Engineering Manager

CRW/lt

cc: Phillips Petroleum Company
4001 Penbrook
Odessa, TX 79762