

OIL CONSERVATION DIVISION
SANTA FE



May 18, 1981

*NSL-1372
Order 6 R4493
Immediate*

Case 4912

State of New Mexico
Energy and Minerals Department
Oil Conservation Division
P. O. Box 2088
Santa Fe, New Mexico 87501

Attention: Division Director

Dear Sir:

Anadarko Production Company respectfully requests administrative approval to drill the Ballard Grayburg San Andres Unit Well #11-6 at an unorthodox location 330 feet from the north line and 200 feet from the east line of Section 6, Township 18 South, Range 29 East, Eddy County, New Mexico.

The Ballard Grayburg San Andres Unit waterflood was authorized March 16, 1973 by Order Number R-4493. Paragraph 6 of this order provides for administrative approval of such unorthodox locations.

The proposed well will be completed as a producer in the Grayburg zone. The location will be closer than 330 feet to an inner subdivision boundary, therefore making it unorthodox. It will, however be located 330 feet from the Unit boundary. A producing well is required in this area to produce waterflood oil not recoverable from existing wells. A pipeline in the vicinity prevented the well from being staked at a favorable orthodox location.

Attached is a copy of form C-102 showing the proposed unorthodox location. Thank you for your consideration of this matter.

Yours very truly,

Cris G. Rhodes
Staff Production Engineer

CGR/gks

Attachment

NEW MEXICO OIL CONSERVATION COMMISSION
WELL LOCATION AND ACREAGE DEDICATION PLAT

RECEIVED
Form C-102
Supersedes C-128
Effective 1-1-65
MAY 22 1981

All distances must be from the outer boundaries of the Section

Operator ANADARKO PRODUCTION COMPANY		Lease Ballard Grayburg San Andres (tract 11)		Well No. 6
Unit Letter A	Section 6	Township 18 South	Range 29 East	County Edley SANTA FE

Actual Footage Location of Well: 330 feet from the North line and 200 feet from the East line				
Ground Level Elev. 3611.5	Producing Formation Grayburg	Pool Loco Hills - Queen Grayburg - San Andres	Dedicated Acreages 40 Acres	

1. Outline the acreage dedicated to the subject well by colored pencil or hatchure marks on the plat below.
2. If more than one lease is dedicated to the well, outline each and identify the ownership thereof (both as to working interest and royalty).
3. If more than one lease of different ownership is dedicated to the well, have the interests of all owners been consolidated by communitization, unitization, force-pooling, etc?

☒ Yes ☐ No If answer is "yes," type of consolidation unitization

If answer is "no," list the owners and tract descriptions which have actually been consolidated. (Use reverse side of this form if necessary.) _____

No allowable will be assigned to the well until all interests have been consolidated (by communitization, unitization, forced-pooling, or otherwise) or until a non-standard unit, eliminating such interests, has been approved by the Commission.

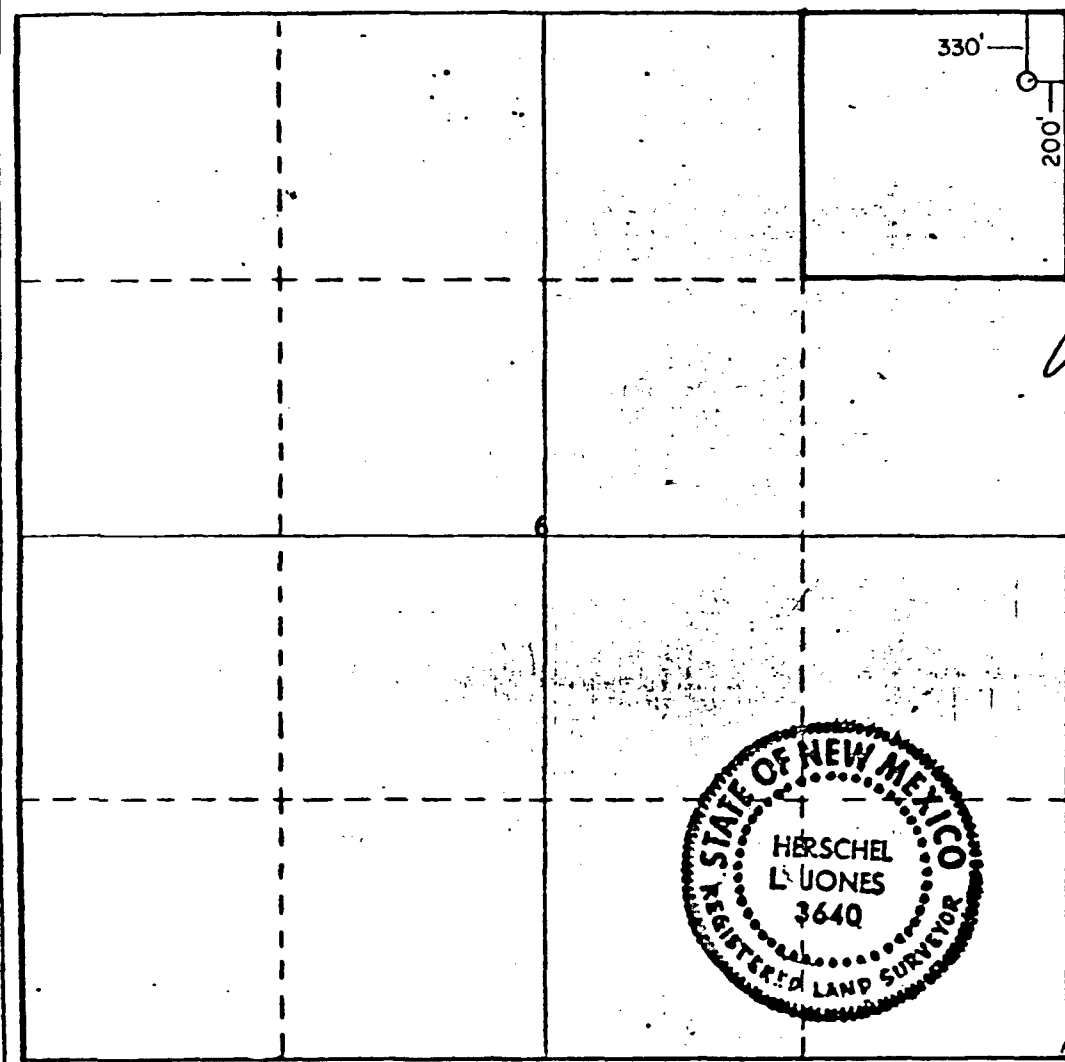

CERTIFICATION	
I hereby certify that the information contained herein is true and complete to the best of my knowledge and belief.	
Name	<i>Jerry E. Buckles</i>
Position	Area Supervisor
Company	Anadarko Production Co.
Date	May 14, 1981
I hereby certify that the well location shown on this plat was plotted from field notes of actual surveys made by me or under my supervision, and that the same is true and correct to the best of my knowledge and belief.	
Date Surveyed	May 11, 1981
Registered Professional Engineer and/or Land Surveyor	
Certificate No.	<i>Herschel Jones</i> 3640

