

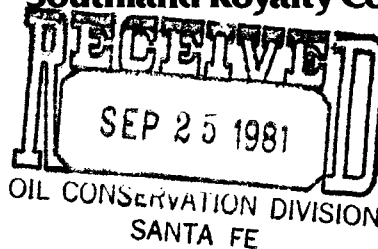

Southland Royalty Company



NSL-1121  
Rule 104 F  
10-15-81

September 23, 1981

Mr. Joe D. Ramey  
New Mexico Department of Energy and Minerals  
Oil & Gas Division  
P. O. Box 2088  
Santa Fe, New Mexico 87501

Dear Mr. Ramey:

Southland Royalty Company hereby requests approval of an unorthodox well location for the Elliott Federal #1. The proposed location is 717' FNL & 623' FEL of Section 30, T29N, R13W, San Juan County, New Mexico.

The unorthodox site is due to topography.

*West Hutz - Pictured Cliffs*

A copy of this application is being submitted to all offset operators by certified mail with a request that they furnish your Santa Fe Office with a waiver of objection.

Pursuant to authority of Rule 104-F, we respectfully request your approval of an exemption to the standard well location requirement.

Sincerely,

SOUTHLAND ROYALTY COMPANY

*R. E. Fielder*

R. E. Fielder  
District Engineer

REF/eg

Enclosures

CC: Mr. Frank Chavez-OCC-Astec, NM

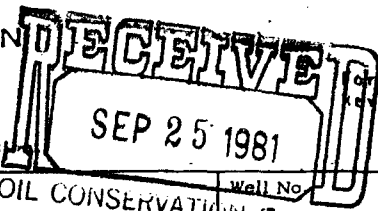

Operator <b>SOUTHLAND ROYALTY COMPANY</b>			Lease <b>ELLIOTT-FEDERAL</b>		Well No.
Unit Letter <b>A</b>	Section <b>30</b>	Township <b>29N</b>	Range <b>13W</b>	County <b>SanJuan</b>	
Actual Footage Location of Well: <b>717</b> feet from the <b>North</b> line and <b>623</b> feet from the <b>East</b> line					
Ground Level Elev. <b>5400</b>	Producing Formation <i>Pictured Cliffs</i>		Pool <i>West Kutz</i>	Dedicated Acreage: <b>160</b> Acres	

1. Outline the acreage dedicated to the subject well by colored pencil or hachure marks on the plat below.
2. If more than one lease is dedicated to the well, outline each and identify the ownership thereof (both as to working interest and royalty).
3. If more than one lease of different ownership is dedicated to the well, have the interests of all owners been consolidated by communitization, unitization, force-pooling, etc?

Yes  No If answer is "yes," type of consolidation \_\_\_\_\_

If answer is "no," list the owners and tract descriptions which have actually been consolidated. (Use reverse side of this form if necessary.) \_\_\_\_\_

No allowable will be assigned to the well until all interests have been consolidated (by communitization, unitization, forced-pooling, or otherwise) or until a non-standard unit, eliminating such interests, has been approved by the Commission.

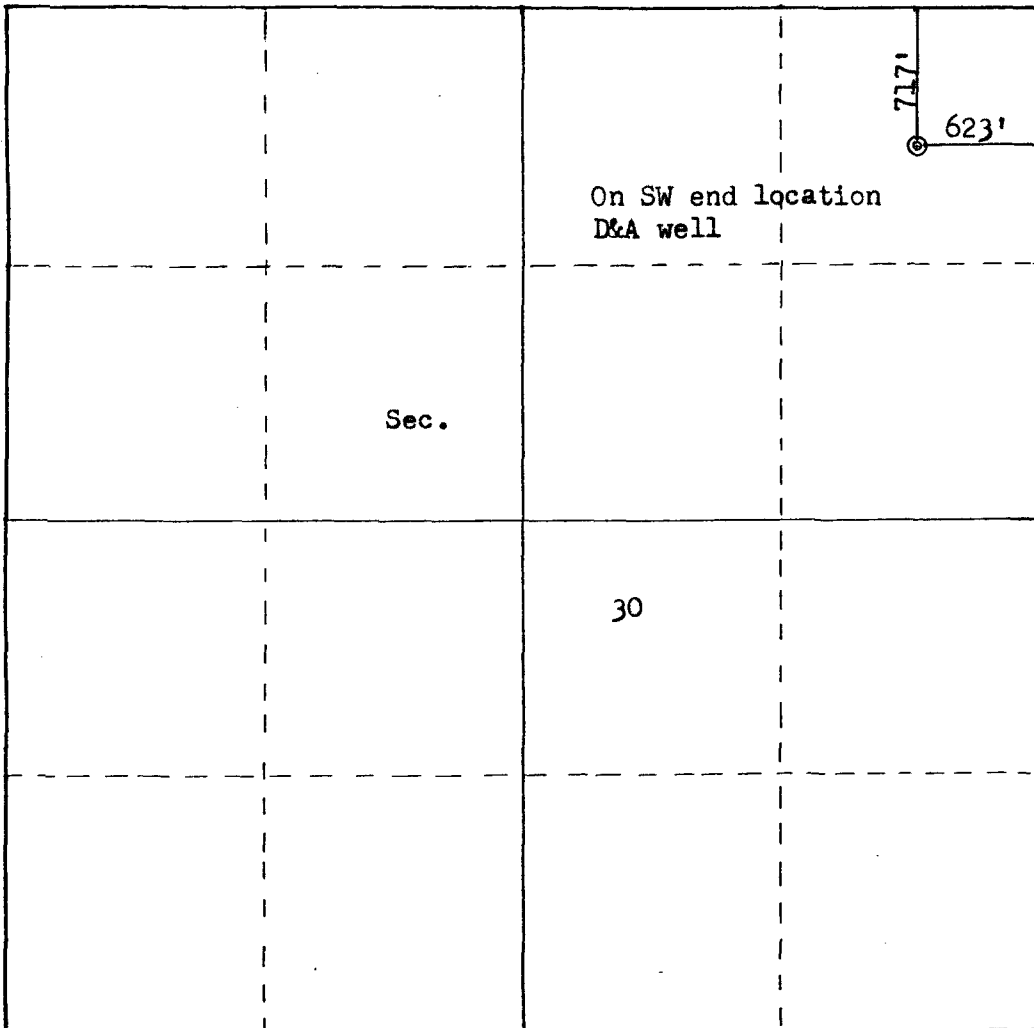

Scale: 1"=1000'

CERTIFICATION

I hereby certify that the information contained herein is true and complete to the best of my knowledge and belief.

*R. E. Fielder*

Name <i>Robert E. Fielder</i>
Position <i>District Engineer</i>
Company <i>Southland Royalty Company</i>
Date <i>September 23, 1981</i>

I hereby certify that the well location shown on this plat was plotted from field notes of actual surveys made by me or under my supervision, and that the same is true and correct to the best of my knowledge and belief.

Date Surveyed <i>September 23, 1981</i>
Registered Professional Engineer and Land Surveyor <i>Fred B. Kerr Jr.</i>
Certificate No. <b>3950</b>

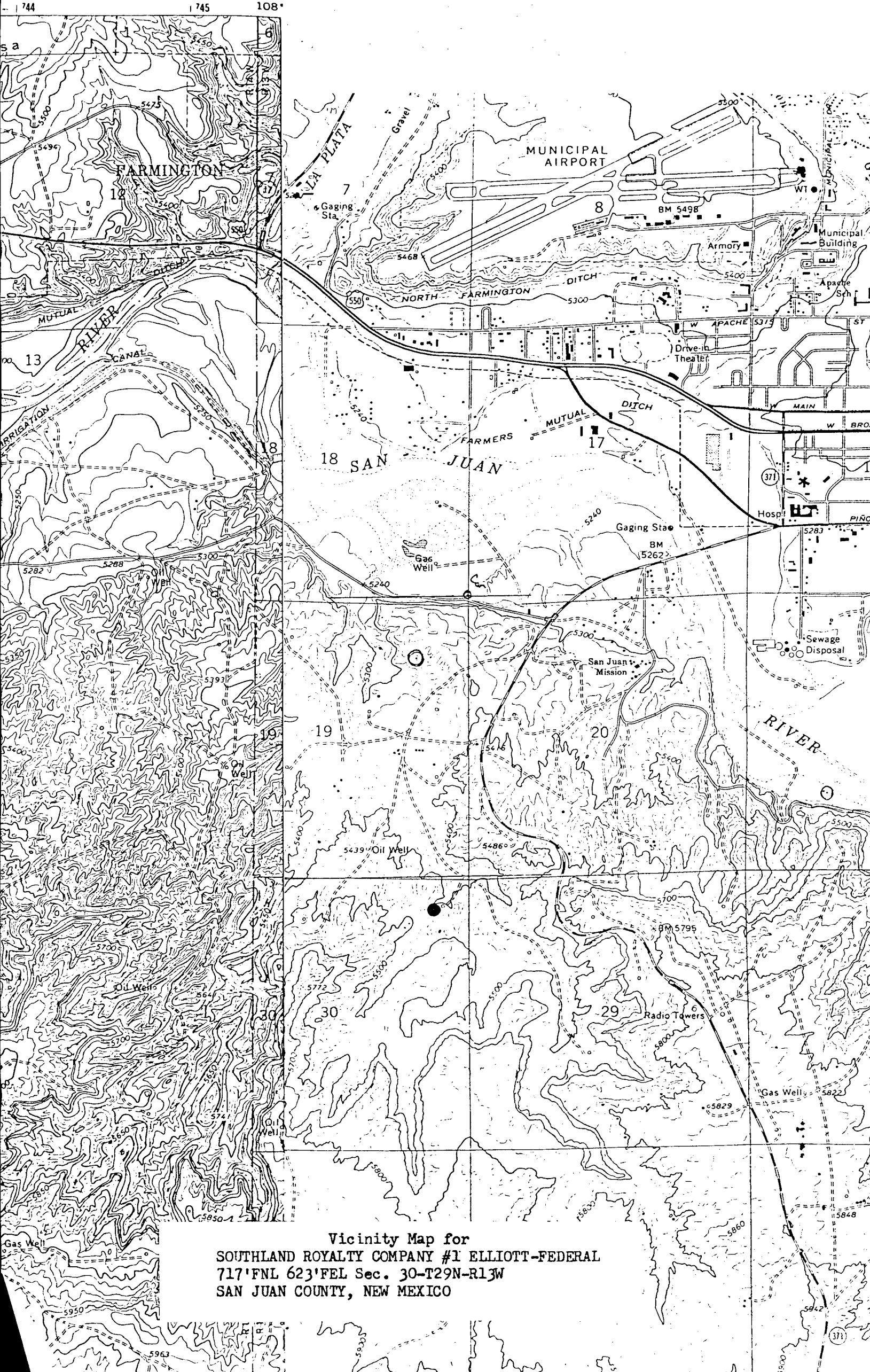

Vicinity Map for  
SOUTHLAND ROYALTY COMPANY #1 ELLIOTT-FEDERAL  
717'FNL 623'FEL Sec. 30-T29N-R13W  
SAN JUAN COUNTY, NEW MEXICO

R 14 W

R 13 W

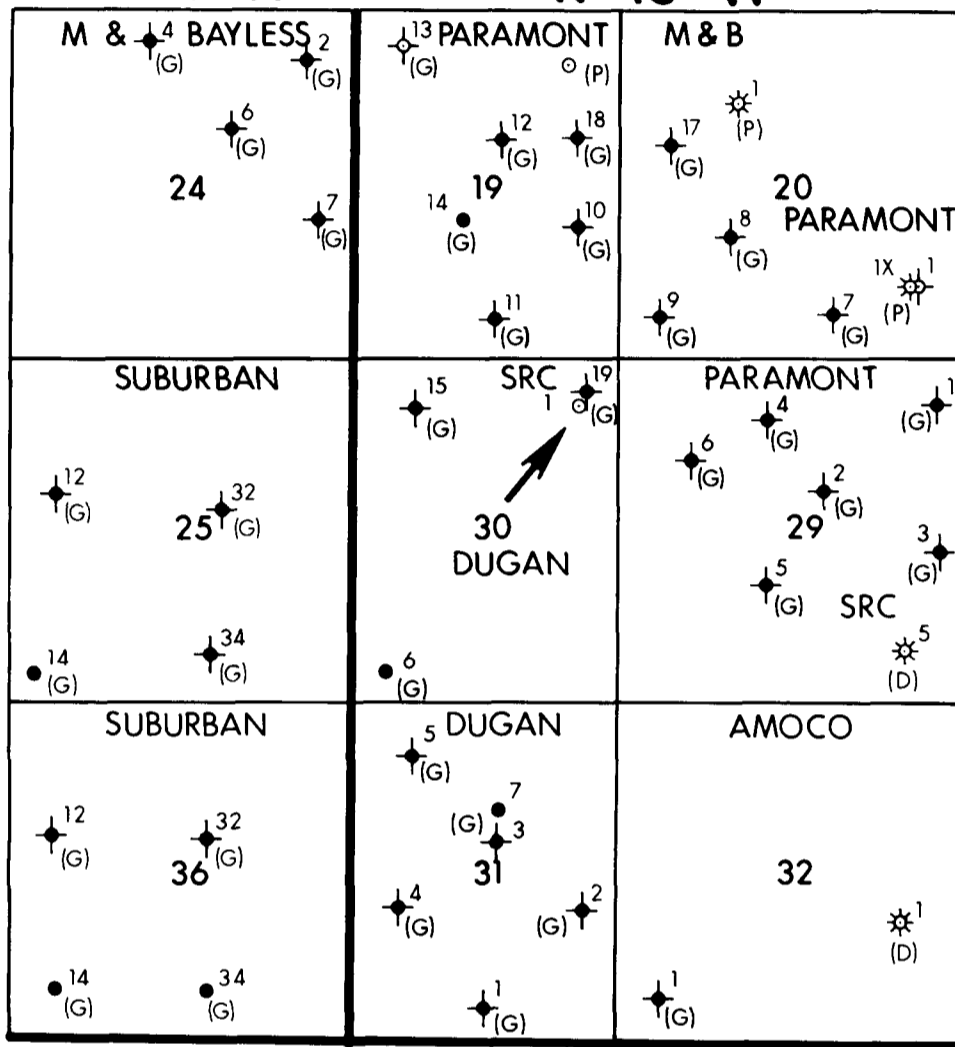

T  
29  
N



**Southland Royalty Company**

*FARMINGTON DISTRICT*

FARMINGTON, NEW MEXICO

9-17-1981
DATE
B. Fielder
PREPARED BY
San Juan Basin
PROJECT AREA
C.I. HORIZON
1" = 3,000'
SCALE
REVISED DATE
NM-FF-0088
FILE NUMBER

SAN JUAN CO. NEW MEXICO

UNORTHODOX LOCATION MAP

SRC

*Elliott Federal #1*

717' FNL - 623' FEL

Sec. 30 - T29N - R13W N.M.P.M.



Southland Royalty Company

September 23, 1981

RECEIVED  
OCT 09 1981  
OIL CONSERVATION D.  
SANTA FE

1427

Mr. Joe D. Ramey  
New Mexico Department of Energy and Minerals  
Oil & Gas Division  
P. O. Box 2088  
Santa Fe, New Mexico 87501

Dear Mr. Ramey:

Southland Royalty Company hereby requests approval of an unorthodox well location for the Elliott Federal #1. The proposed location is 717' FNL & 623' FEL of Section 30, T29N, R13W, San Juan County, New Mexico.

The unorthodox site is due to topography.

A copy of this application is being submitted to all offset operators by certified mail with a request that they furnish your Santa Fe Office with a waiver of objection.

Pursuant to authority of Rule 104-F, we respectfully request your approval of an exemption to the standard well location requirement.

Sincerely,

SOUTHLAND ROYALTY COMPANY

*R. E. Fielder*

R. E. Fielder  
District Engineer

REF/eg

Enclosures

CC: Mr. Frank Chavez-OCC-Aztec, N.M.

-----  
WAIVER

PARAMOUNT PETROLEUM hereby waives objection to Southland Royalty Company's application for unorthodox location for their Elliott Federal #1 as proposed above.

10/7/81  
Date

*R. E. Fielder*  
By

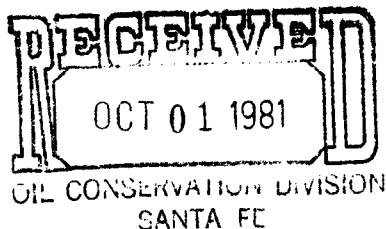

1427



**Southland Royalty Company**

September 23, 1981

Mr. Joe D. Ramey  
New Mexico Department of Energy and Minerals  
Oil & Gas Division  
P. O. Box 2088  
Santa Fe, New Mexico 87501

Dear Mr. Ramey:

Southland Royalty Company hereby requests approval of an unorthodox well location for the Elliott Federal #1. The proposed location is 717' FNL & 623' FEL of Section 30, T29N, R13W, San Juan County, New Mexico.

The unorthodox site is due to topography.

A copy of this application is being submitted to all offset operators by certified mail with a request that they furnish your Santa Fe Office with a waiver of objection.

Pursuant to authority of Rule 104-F, we respectfully request your approval of an exemption to the standard well location requirement.

Sincerely,

SOUTHLAND ROYALTY COMPANY

R. E. Fielder  
District Engineer

REF/eg

Enclosures

CC: Mr. Frank Chavez-OCC-Aztec, N.M.

WAIVER

MERRION & BAYLESS hereby waives objection to Southland Royalty Company's application for unorthodox location for their Elliott Federal #1 ds proposed above.

Sept 29, 1981  
Date

1427

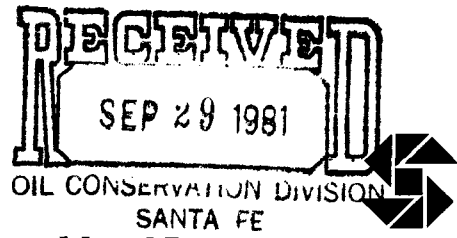

**Southland Royalty Company**

September 23, 1981

Mr. Joe D. Ramey  
New Mexico Department of Energy and Minerals  
Oil & Gas Division  
P. O. Box 2088  
Santa Fe, New Mexico 87501

Dear Mr. Ramey:

Southland Royalty Company hereby requests approval of an unorthodox well location for the Elliott Federal #1. The proposed location is 717' FNL & 623' FEL of Section 30, T29N, R13W, San Juan County, New Mexico.

The unorthodox site is due to topography.

A copy of this application is being submitted to all offset operators by certified mail with a request that they furnish your Santa Fe Office with a waiver of objection.

Pursuant to authority of Rule 104-F, we respectfully request your approval of an exemption to the standard well location requirement.

Sincerely,

SOUTHLAND ROYALTY COMPANY

R. E. Fielder  
District Engineer

REF/eg

Enclosures

CC: Mr. Frank Chavez-OCC-Aztec, N.M.

WAIVER

DUGAN PRODUCTION CORPORATION hereby waives objection to Southland Royalty Company's application for unorthodox location for their Elliott Federal #1 as proposed above.

9-28-81  
Date

Thomas A. Dugan  
By



ENERGY AND MINERALS DEPARTMENT

OIL CONSERVATION DIVISION  
ACTED DISTRICT OFFICE

1000 RIO GRANDES ROAD  
ACTED, NEW MEXICO 87410  
(505) 354-6179

OIL CONSERVATION DIVISION  
BOX 2088  
SANTA FE, NEW MEXICO 87501

DATE Oct 2 1981

- RE: Proposed MC \_\_\_\_\_
- Proposed DHC \_\_\_\_\_
- Proposed NSL \_\_\_\_\_ ✓
- Proposed SWD \_\_\_\_\_
- Proposed WFX \_\_\_\_\_
- Proposed PHX \_\_\_\_\_

1427

Gentlemen:

I have examined the application dated Sept. 25, 1981  
 for the Santolano Realty Co. Elmer Field #1 A-30-29W-132  
 Operator Lease and Well No. Unit, S-T-R

and my recommendations are as follows:

Approve  
 \_\_\_\_\_  
 \_\_\_\_\_  
 \_\_\_\_\_  
 \_\_\_\_\_

RECEIVED  
 OCT 05 1981  
 OIL CONSERVATION DIVISION  
 SANTA FE

Yours truly,

Jell A. Edmister  
 JAE



All distances must be from the outer boundaries of the Section.

Lessor <b>SOUTHLAND ROYALTY COMPANY</b>			Lease <b>ELLIOTT-FEDERAL</b>		Well No. <b>1</b>
Unit Letter <b>A</b>	Section <b>30</b>	Township <b>29N</b>	Range <b>13W</b>	County <b>SanJuan</b>	
Actual Footage Location of Well:					
<b>717</b> feet from the <b>North</b> line and		<b>623</b> feet from the <b>East</b> line			
Ground Level Elev. <b>5400</b>	Producing Formation <i>Pictured Cliffs</i>	Pool <i>West Kutz</i>		Dedicated Acreage: <b>160</b> Acres	

1. Outline the acreage dedicated to the subject well by colored pencil or hachure marks on the plat below.
2. If more than one lease is dedicated to the well, outline each and identify the ownership thereof (both as to working interest and royalty).
3. If more than one lease of different ownership is dedicated to the well, have the interests of all owners been consolidated by communitization, unitization, force-pooling, etc?

Yes  No If answer is "yes," type of consolidation \_\_\_\_\_

If answer is "no," list the owners and tract descriptions which have actually been consolidated. (Use reverse side of this form if necessary.) \_\_\_\_\_

No allowable will be assigned to the well until all interests have been consolidated (by communitization, unitization, forced-pooling, or otherwise) or until a non-standard unit, eliminating such interests, has been approved by the Commission.

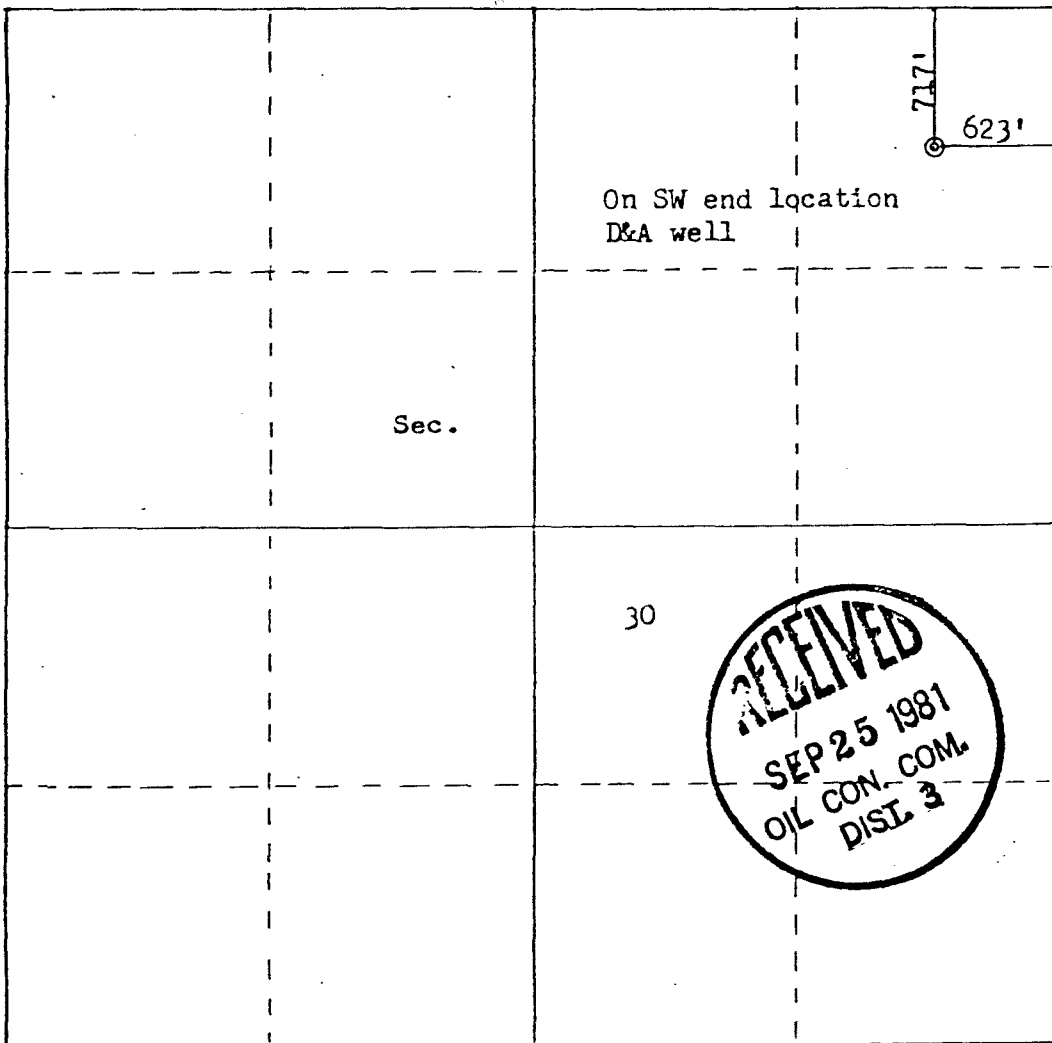

Scale: 1"=1000'

CERTIFICATION

I hereby certify that the information contained herein is true and complete to the best of my knowledge and belief.

*R. E. Fielder*

Name  
**Robert E. Fielder**

Position  
**District Engineer**

Company  
**Southland Royalty Company**

Date  
**September 23, 1981**

I hereby certify that the well location shown on this plat was plotted from field notes of actual surveys made by me or under my supervision, and that the same is true and correct to the best of my knowledge and belief.

Date Surveyed  
**September 6, 1981**

Registered Professional Engineer and Land Surveyor

*Fred B. Kerr Jr.*  
**Fred B. Kerr Jr.**

Certificate No.  
**3950**

