

**Husky**

**Husky Oil Company**

600 South Cherry Street  
Denver, Colorado 80222  
(303) 370-1300

September 30, 1981

*NSL - 14 37  
see next page for  
location  
Rule 104 F  
10-25-81*

Mr. Joe D. Ramey  
Division Director  
New Mexico Oil Conservation Division  
P.O. Box 2088  
Santa Fe, New Mexico 87501

Re: Application for Administrative  
Approval of Unorthodox Location  
of the Bitter Lake Federal No. 1 Well  
Chaves County, New Mexico

Dear Mr. Ramey:

Enclosed please find the following items regarding the Application for Administrative Approval of the Unorthodox Location of the Bitter Lake Federal No. 1 Well which will be located in the NE $\frac{1}{4}$  of Section 34, Township 8 South, Range 24 East, Chaves County, New Mexico:

- 1) Three copies of the Application for Administrative Approval of Unorthodox Location for the captioned well.
- 2) Three copies of a plat showing the ownership of all leases offsetting the NE $\frac{1}{4}$  of Section 34, Township 8 South, Range 24 East, N.M.P.M.
- 3) Three copies of a Certificate of Mailing stating that all operators of leases offsetting the dedicated acreage for this well, the Supervisor of the District II Office of the New Mexico Oil Conservation Division and the U.S.G.S. have been notified of the Application by certified mail.

If no objections to the granting of this Application are timely filed, applicant respectfully requests this Application be approved administratively.

Please advise the undersigned if further information is needed.

Yours very truly,

*Wm. H. Galac*

William H. Galac  
Chief Landman

WHG:mqg  
Enclosures

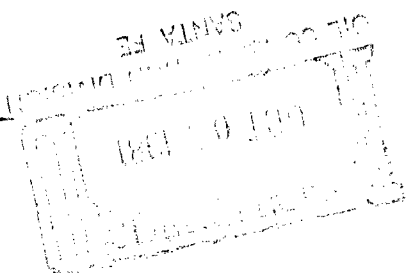

APPLICATION FOR ADMINISTRATIVE  
APPROVAL OF UNORTHODOX LOCATION

Applicant: Husky Oil Company (Operator)  
600 South Cherry Street  
Denver, Colorado 80222

Lease: USA-16316

Lease Date: July 1, 1972

Lease Term: 10 years

Lands described in  
Lease dedicated to well: Township 8 South, Range 24 East, N.M.P.M.  
Section 34: NE $\frac{1}{4}$   
Containing 160 acres more or less  
Chaves County, New Mexico

Name of Well: Bitter Lake Federal No. 1 Well

Proposed Unorthodox  
Location: Township 8 South, Range 24 East, N.M.P.M.  
Section 34: NE $\frac{1}{4}$   
2050 feet FNL and 2100 feet FEL  
Chaves County, New Mexico

Reason for  
Unorthodox Location: Topographical conditions

New Mexico Oil Conservation Division Rule  
Authorizing Application: Rule 104 (D) (II) (F)

Offsetting Leases  
and Operators: A. St. L.G.4359  
Township 8 South, Range 24 East, N.M.P.M.  
Section 27: S $\frac{1}{2}$

Yates Petroleum Corporation  
Attn: R. Patterson  
Yates Building  
207 South 4th  
Artesia, NM 88210

B. C. E. Hinkle  
Township 8 South, Range 24 East, N.M.P.M.  
Section 35: S $\frac{1}{2}$ SW $\frac{1}{4}$ , SE $\frac{1}{4}$ , S $\frac{1}{2}$ NE $\frac{1}{4}$

Corona Oil Co. (formerly Public Lands  
Exploration)  
P.O. Box 29119  
Dallas, Texas 75229

C. C. E. Hinkle  
Township 8 South, Range 24 East, N.M.P.M.  
Section 35:  $S\frac{1}{2}SW\frac{1}{4}$ ,  $SE\frac{1}{4}$ ,  $S\frac{1}{2}NE\frac{1}{4}$

Mesa Petroleum Co.  
P.O. Box 2009  
One Mesa Square  
Amarillo, Texas 79189

D. S.W. Lodewick et al.  
Township 8 South, Range 24 East, N.M.P.M.  
Section 35:  $S\frac{1}{2}SW\frac{1}{4}$ ,  $SE\frac{1}{4}$ ,  $S\frac{1}{2}NE\frac{1}{4}$

✓ Rio Petroleum  
1008 Inland Oil Bldg.  
Amarillo, Texas 79101

E. S. W. Lodewick  
Township 8 South, Range 24 East, N.M.P.M.  
Section 35:  $S\frac{1}{2}SW\frac{1}{4}$ ,  $SE\frac{1}{4}$ ,  $S\frac{1}{2}NE\frac{1}{4}$

Stevens Oil Company  
Box 2023  
Roswell, NM 88202

F. U.S.A. 16316  
Township 8 South, Range 24 East, N.M.P.M.  
Section 34:  $SE\frac{1}{4}$ ,  $W\frac{1}{2}$

Husky Oil Company  
600 S. Cherry St.  
Denver, CO 80222

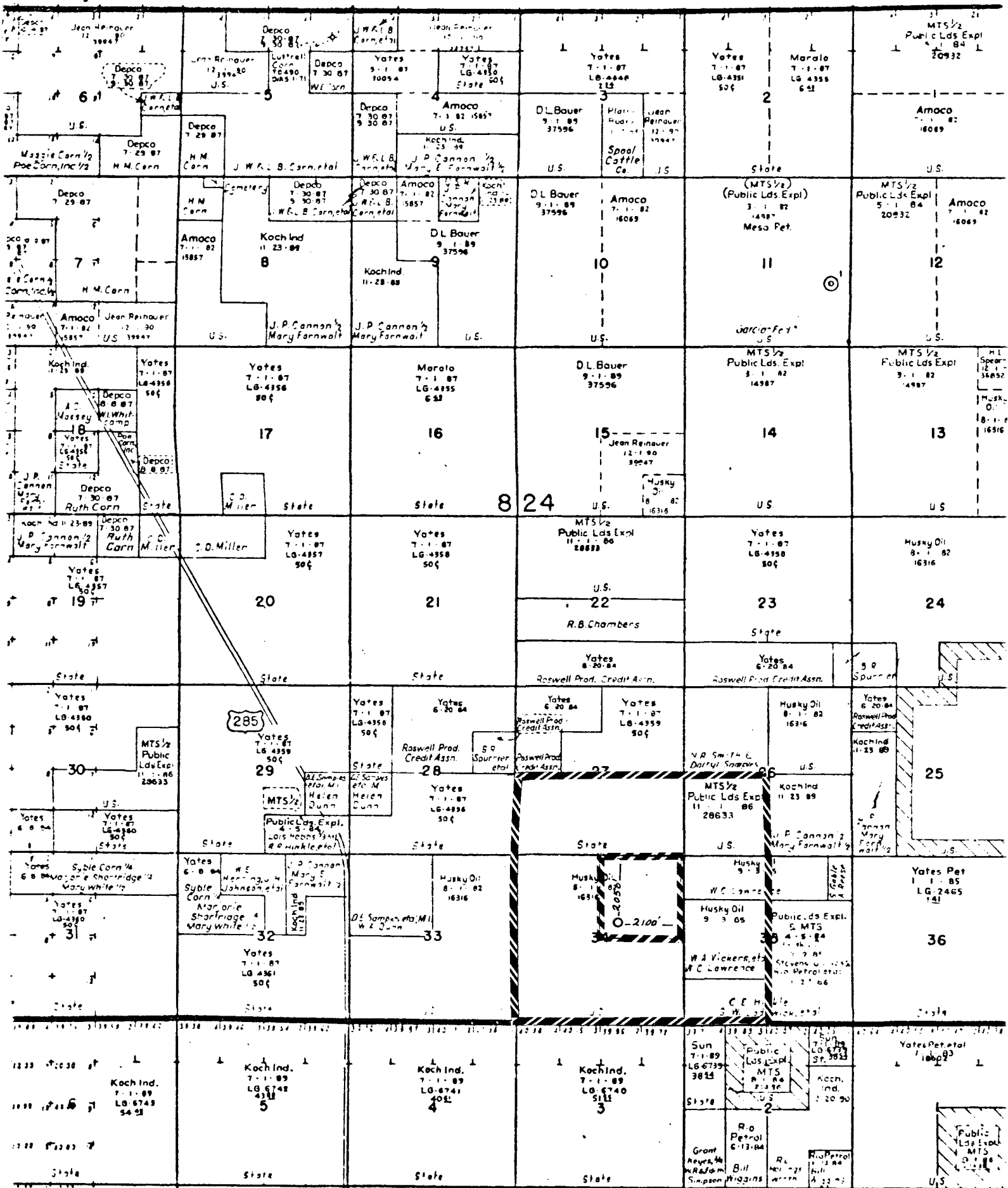

**NEW MEXICO OIL CONSERVATION COMMISSION  
WELL LOCATION AND ACREAGE DEDICATION PLAT**

Form C-102  
Supersedes C-128  
Effective 1-1-65

All distances must be from the outer boundaries of the Section.

Operator <b>HUSKY OIL COMPANY</b>			Lease <b>Federal Bitter Lake</b>		Well No. <b>7 - 34</b>
Unit Letter <b>G</b>	Section <b>34</b>	Township <b>8 South</b>	Range <b>24 East</b>	County <b>Chaves</b>	
Actual Footage Location of Well: <b>2050</b> feet from the <b>North</b> line and <b>2100</b> feet from the <b>East</b> line					
Ground Level Elev. <b>3683.9</b>	Producing Formation <b>Abo</b>		Pool <b>Bitter Lake</b>		Dedicated Acreage: <b>160</b> Acres

1. Outline the acreage dedicated to the subject well by colored pencil or hatchure marks on the plat below.
2. If more than one lease is dedicated to the well, outline each and identify the ownership thereof (both as to working interest and royalty). **N/A**
3. If more than one lease of different ownership is dedicated to the well, have the interests of all owners been consolidated by communitization, unitization, force-pooling, etc? **N/A**

☐ Yes ☐ No If answer is "yes," type of consolidation \_\_\_\_\_

If answer is "no," list the owners and tract descriptions which have actually been consolidated. (Use reverse side of this form if necessary.) \_\_\_\_\_

No allowable will be assigned to the well until all interests have been consolidated (by communitization, unitization, forced-pooling, or otherwise) or until a non-standard unit, eliminating such interests, has been approved by the Commission.

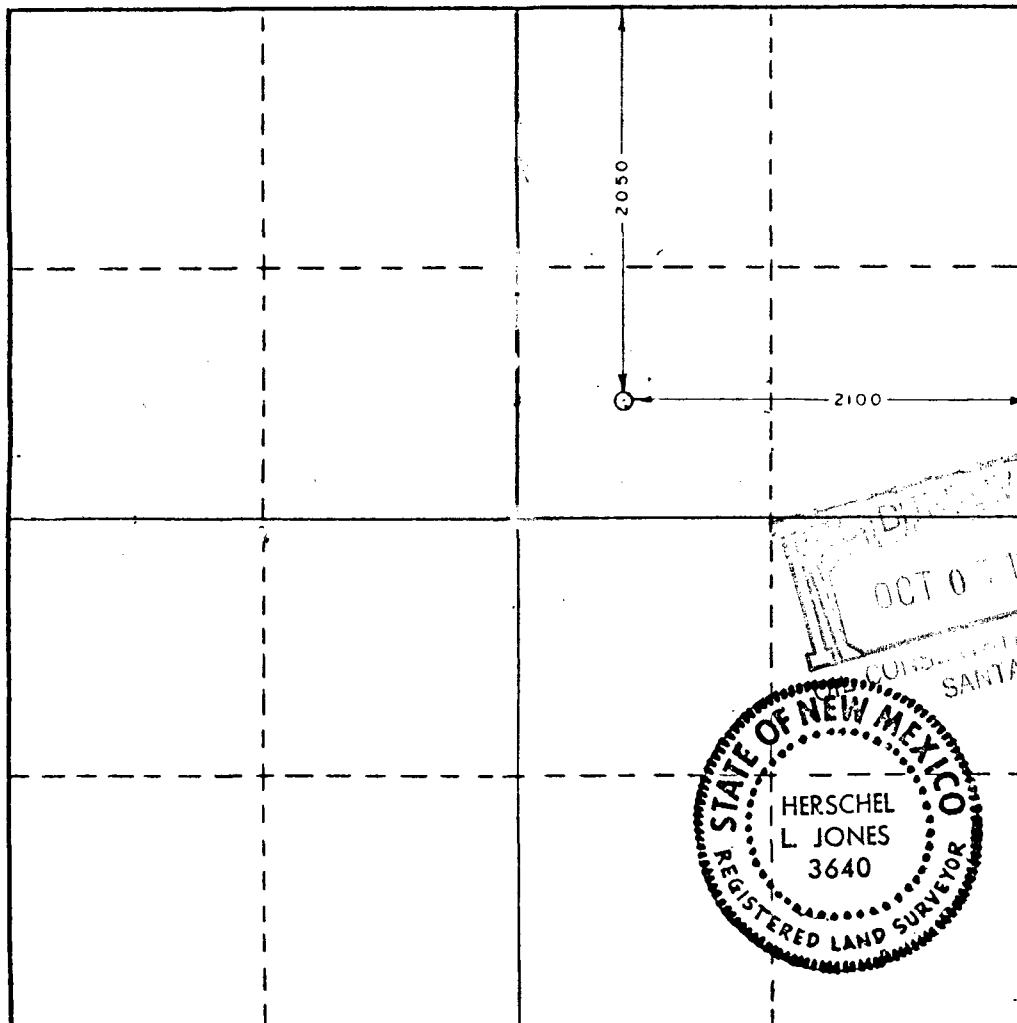

**CERTIFICATION**

*I hereby certify that the information contained herein is true and complete to the best of my knowledge and belief.*

Name  
**/s/ James Yates**

Position  
**Drilling Engineer**

Company  
**HUSKY OIL COMPANY**

Date  
**September 25, 1981**

*I hereby certify that the well location shown on this plat was plotted from field notes of actual surveys made by me or under my supervision, and that the same is true and correct to the best of my knowledge and belief.*

Date Surveyed  
**September 3, 1981**

Registered Professional Engineer and/or Land Surveyor

Certificate No **3640**

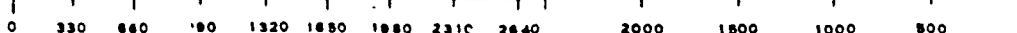

AFFIDAVIT OF MAILING

In the matter of the Application  
for Administrative Approval of  
Unorthodox Location for the  
Bitter Lake Federal No. 1 Well  
NE¼ of Section 34, Township 8 South,  
Range 24 East, N.M.P.M.

STATE OF COLORADO )  
                              )ss  
COUNTY OF ARAPAHOE )

William H. Galac, of lawful age, being first duly sworn upon oath  
deposes and says:

I certify that I mailed a copy of the Application for Unorthodox  
Location of the Bitter Lake Federal No. 1 Well by certified mail to all  
operators of leases offsetting the dedicated acreage for this well, the  
Supervisor of the District II office of the New Mexico Oil Conservation  
Division, the U.S. Geological Survey on this 1<sup>st</sup> day of October,  
1981.

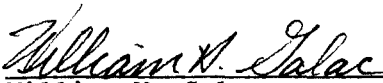
  
\_\_\_\_\_  
William H. Galac

Subscribed and sworn to before me this 1<sup>st</sup> day of October, 1981

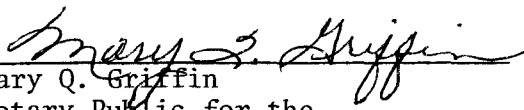
  
\_\_\_\_\_  
Mary Q. Griffin  
Notary Public for the  
State of Colorado  
600 S. Cherry St.  
Denver, Colorado 80222

My commission expires 7/20/85.



**Husky Oil Company**

600 South Cherry Street  
Denver, Colorado 80222  
(303) 370-1300

---

September 30, 1981

TO: ALL OFFSET OPERATORS

Re: Application for Administrative  
Approval of Unorthodox Location  
for the Bitter Lake Federal No. 1 Well  
Chaves County, New Mexico

Gentlemen:

Enclosed are the following items regarding the above subject Application  
filed this date with the State of New Mexico Oil Conservation Division:

- 1) Copy of cover letter to the Oil Conservation  
Division Office in Santa Fe, New Mexico.
- 2) Copy of the Application for Administrative Approval of  
Unorthodox Location.
- 3) Copy of Affidavit of Mailing to offset operators, the  
U.S.G.S., the New Mexico Oil Conservation District II  
office in Artesia, New Mexico.
- 4) Three copies of a Waiver of Objection and Consent by  
offsetting operators.

According to our records you are an offset operator to subject well.  
If you do not have any objection to this unorthodox location, we would  
appreciate your signing all three copies of the enclosed Waiver of Objection.  
Please return one copy to the undersigned at the letterhead address and  
send one copy to:

Mr. Joe D. Ramey  
Division Director  
New Mexico Oil Conservation Division  
P.O. Box 2088  
Santa Fe, New Mexico 87501

The remaining copy is for your files. Pre-stamped, addressed envelopes  
are enclosed for your convenience.

Offset Operators  
September 30, 1981  
Page Two

Please contact the undersigned if you need further information.  
Thanking you in advance for your assistance and cooperation in this matter.

Yours very truly,

A handwritten signature in cursive script, appearing to read "W. H. Galac".

W. H. Galac  
Chief Landman

WHG:mqg

Enclosures



WAIVER OF OBJECTION AND CONSENT  
TO THE UNORTHODOX LOCATION OF  
THE BITTER LAKE FEDERAL NO. 1 WELL

New Mexico Oil Conservation Commission  
P.O. Box 2088  
Santa Fe, New Mexico 87501

The undersigned as an operator of a lease offsetting the NE $\frac{1}{4}$  of Section 34, Township 8 South, Range 24 East, N.M.P.M., Chaves County, New Mexico, does hereby acknowledge receipt of the Application for Administrative Approval of Unorthodox Location for the Bitter Lake Federal No. 1 Well.

The undersigned states that it waives any objection that it may have to this unorthodox location and voluntarily consents to the location of the Bitter Lake Federal No. 1 Well.

It is understood that the surface location for the subject well will be 2050 feet from the north line and 2100 feet from the east line of Section 34, Township 8 South, Range 24 East, N.M.P.M.

Dated this \_\_\_\_\_ day of \_\_\_\_\_, 1981.

By: \_\_\_\_\_

Title: \_\_\_\_\_

Address: \_\_\_\_\_

\_\_\_\_\_

\_\_\_\_\_

WAIVER OF OBJECTION AND CONSENT  
TO THE UNORTHODOX LOCATION OF  
THE BITTER LAKE FEDERAL NO. 1 WELL

New Mexico Oil Conservation Commission  
P.O. Box 2088  
Santa Fe, New Mexico 87501

The undersigned as an operator of a lease offsetting the NE $\frac{1}{4}$  of Section 34, Township 8 South, Range 24 East, N.M.P.M., Chaves County, New Mexico, does hereby acknowledge receipt of the Application for Administrative Approval of Unorthodox Location for the Bitter Lake Federal No. 1 Well.

The undersigned states that it waives any objection that it may have to this unorthodox location and voluntarily consents to the location of the Bitter Lake Federal No. 1 Well.

It is understood that the surface location for the subject well will be 2050 feet from the north line and 2100 feet from the east line of Section 34, Township 8 South, Range 24 East, N.M.P.M.

Dated this 6th day of October, 1981.

STEVENS OIL CO.

By: \_\_\_\_\_

Title: \_\_\_\_\_

Address: \_\_\_\_\_

STEVENS OIL CO.  
P.O. BOX 2203  
ROSWELL, N.M. 88201

WAIVER OF OBJECTION AND CONSENT  
TO THE UNORTHODOX LOCATION OF  
THE BITTER LAKE FEDERAL NO. 1 WELL

New Mexico Oil Conservation Commission  
P.O. Box 2088  
Santa Fe, New Mexico 87501

The undersigned as an operator of a lease offsetting the NE $\frac{1}{4}$  of Section 34, Township 8 South, Range 24 East, N.M.P.M., Chaves County, New Mexico, does hereby acknowledge receipt of the Application for Administrative Approval of Unorthodox Location for the Bitter Lake Federal No. 1 Well.

The undersigned states that it waives any objection that it may have to this unorthodox location and voluntarily consents to the location of the Bitter Lake Federal No. 1 Well.

It is understood that the surface location for the subject well will be 2050 feet from the north line and 2100 feet from the east line of Section 34, Township 8 South, Range 24 East, N.M.P.M.

Dated this 5<sup>th</sup> day of October, 1981.

RIO PETROLEUM, *Inc.*

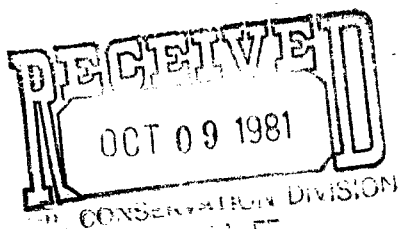

By: Barnett W. Price  
Title: President  
Address: Drawer 12013  
Amarillo, Texas 79101

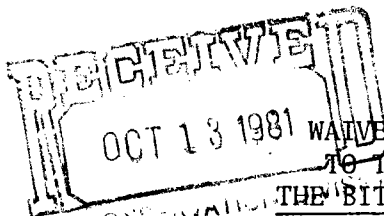

WAIVER OF OBJECTION AND CONSENT  
TO THE UNORTHODOX LOCATION OF  
THE BITTER LAKE FEDERAL NO. 1 WELL  
OIL CONSERVATION COMMISSION  
SANTA FE

#

New Mexico Oil Conservation Commission  
P.O. Box 2088  
Santa Fe, New Mexico 87501

The undersigned as an operator of a lease offsetting the NE $\frac{1}{4}$  of Section 34, Township 8 South, Range 24 East, N.M.P.M., Chaves County, New Mexico, does hereby acknowledge receipt of the Application for Administrative Approval of Unorthodox Location for the Bitter Lake Federal No. 1 Well.

The undersigned states that it waives any objection that it may have to this unorthodox location and voluntarily consents to the location of the Bitter Lake Federal No. 1 Well.

It is understood that the surface location for the subject well will be 2050 feet from the north line and 2100 feet from the east line of Section 34, Township 8 South, Range 24 East, N.M.P.M.

Dated this 9th day of October, 1981.

MESA PETROLEUM CO.

By:   
Title: Vice President  
Address: 1000 Vaughn Building  
Midland, Texas 79701

WAIVER OF OBJECTION AND CONSENT  
TO THE UNORTHODOX LOCATION OF  
THE BITTER LAKE FEDERAL NO. 1 WELL



New Mexico Oil Conservation Commission  
P.O. Box 2088  
Santa Fe, New Mexico 87501

1437

The undersigned as an operator of a lease offsetting the NE $\frac{1}{4}$  of Section 34, Township 8 South, Range 24 East, N.M.P.M., Chaves County, New Mexico, does hereby acknowledge receipt of the Application for Administrative Approval of Unorthodox Location for the Bitter Lake Federal No. 1 Well.

The undersigned states that it waives any objection that it may have to this unorthodox location and voluntarily consents to the location of the Bitter Lake Federal No. 1 Well.

It is understood that the surface location for the subject well will be 2050 feet from the north line and 2100 feet from the east line of Section 34, Township 8 South, Range 24 East, N.M.P.M.

Dated this 12 day of Oct, 1981.

Yates Petroleum Corporation

By: 

Title: Vice President

Address: 207 S. Fourth, Artesia, New Mexico

\_\_\_\_\_  
\_\_\_\_\_

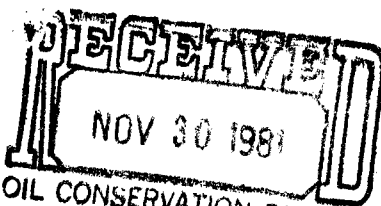

OIL CONSERVATION DIVISION  
WAIVER OF ~~SANCTUARY~~ AND CONSENT  
TO THE UNORTHODOX LOCATION OF  
THE BITTER LAKE FEDERAL NO. 1 WELL

1437

New Mexico Oil Conservation Commission  
P. O. Box 2088  
Santa Fe, New Mexico 87501

The undersigned as an operator of a lease offsetting the NE $\frac{1}{4}$  of Section 34, Township 8 South, Range 24 East, N.M.P.M., Chaves County, New Mexico, does hereby acknowledge receipt of the Application for Administrative Approval of Unorthodox Location for the Bitter Lake Federal No. 1 Well.

The undersigned states that it waives any objection that it may have to this unorthodox location and voluntarily consents to the location of the Bitter Lake Federal No. 1 Well.

It is understood that the surface location for the subject well will be 2050 feet from the north line and 2100 feet from the east line of Section 34, Township 8 South, Range 24 East, N.M.P.M.

Dated this 20th day of November, 1981.

MTS LIMITED PARTNERSHIP

By:

Marion E. Causey  
Marion E. Causey

Title: Vice President

Address: Vaughn Building/ Suite 1000

Midland, Texas 79701



WAIVER OF OBJECTION AND CONSENT  
TO THE UNORTHODOX LOCATION OF  
THE BITTER LAKE FEDERAL NO. 1 WELL

New Mexico Oil Conservation Commission  
P.O. Box 2088  
Santa Fe, New Mexico 87501

The undersigned as an operator of a lease offsetting the NE $\frac{1}{4}$  of Section 34, Township 8 South, Range 24 East, N.M.P.M., Chaves County, New Mexico, does hereby acknowledge receipt of the Application for Administrative Approval of Unorthodox Location for the Bitter Lake Federal No. 1 Well.

The undersigned states that it waives any objection that it may have to this unorthodox location and voluntarily consents to the location of the Bitter Lake Federal No. 1 Well.

It is understood that the surface location for the subject well will be 2050 feet from the north line and 2100 feet from the east line of Section 34, Township 8 South, Range 24 East, N.M.P.M.

Dated this 13th day of October, 1981.

CORONA OIL CO.

By: 

Title: Vice President

Address: 4835 LBJ Freeway

Suite 635

Dallas, Texas 75234