



State of New Mexico
Energy and Minerals Department
Oil Conservation Division
P.O. Box 2088
Santa Fe, New Mexico 87501

Attn: R.L. Stamets
Technical Support Chief

*Amend NSL-1442
1442 to well
No 1-Y and New
location due to
loss of original hole
and "skidding" well over
same Authority
January 26, 1982 2-18-82*

Grace Petroleum Corporation
Subsidiary of W. R. Grace & Co.

Midland District Office
925 Western United Life Building
Midland, Texas 79701

Phone (915) 683-4793

Mailing Address:
P. O. Drawer 2358
Midland, Texas 79702

Re: Amend Administrative Order NSL-1442
Non-Standard Location
West Tonto "A" Federal Com. No. 1-Y
Sec. 25, T-19-S, R-32-E
Lea County, New Mexico

Dear Sir:

Grace Petroleum Corporation requests that Administrative Order NSL-1442 approving the drilling of West Tonto "A" Federal Com. No. 1 be amended for approval of a skid well, West Tonto "A" Federal Com. No. 1-Y.

It was necessary to P & A the No. 1 well because of mechanical problems encountered after the 8-5/8" casing was cemented. The approval is requested for a non-standard location 2450' FSL and 660' FWL of Sec. 25, T-19-S, R-32-E, Lea County, New Mexico (30' South of No. 1 and on the same drilling pad).

Attached is a listing of offset owners that are receiving a copy of this letter by Certified mail.

The proposed non-standard location has the verbal approval of the USGS and was spudded 1-25-82 from the same drilling pad from which Archeological Clearance has already been obtained.

Also attached is a copy of Form C-102 showing the dedicated acreage. GPC proposes the unorthodox location to cover the Bone Springs, Wolfcamp, Strawn, Atoka, and Morrow formations.

Application For Permit to Drill, Deepen, or Plug Back, Form 9-331C and Well Location And Acreage Dedication Plat, Form C-102 for this skid location are being submitted to the U.S.G.S. District Office in Hobbs, New Mexico.

Yours very truly,

GRACE PETROLEUM CORPORATION

Buddy J. Knight
Buddy J. Knight
District Production Manager

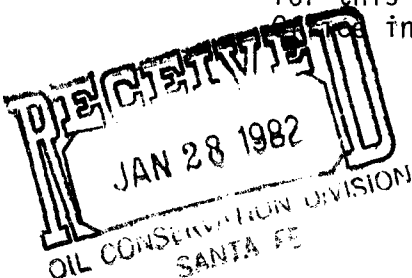

DWR/sgp
XC: West Tonto "A" Federal Com. No. 1-Y w/attachments

GRACE PETROLEUM CORPORATION

Application for Non-Standard
Location: W. Tonto "A" Fed.
Com Well No. 1-Y, Sec. 25,
T-19-S, R-32-E
Lea County, New Mexico

OFFSETTING LEASE OWNERSHIP

Federal Leases
NM 12412

Sun Oil Co.
Box 2880
Dallas, Texas 75221

NM 43731

Anadarko Production Co.
Box 2497
Midland, Texas 79702

State Leases
B-1482-3

Cities Services Co.
Box 300
Tulsa, Oklahoma 74102

B-1565-2

Getty Oil Co.
Box 1404
Houston, Texas 77001

L-6691

Union Oil Co. of CA
Box 3100
Midland, Texas 79702

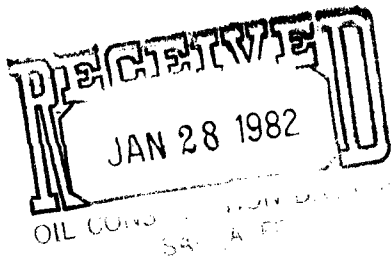

**NEW MEXICO OIL CONSERVATION COMMISSION
WELL LOCATION AND ACREAGE DEDICATION PLAT**

Form C-102
Supersedes C-128
Effective 1-1-65

All distances must be from the outer boundaries of the Section.

Operator Grace Petroleum Corporation			Lease West Tonto "A" Federal Com.		Well No. 1-Y
Unit Letter L	Section 25	Township 19 South	Range 32 East	County Lea	
Actual Footage Location of Well: 2450 feet from the South line and 660 feet from the West line					
Ground Level Elev. 3587.6	Producing Formation Morrow Sand		Pool Undesignated		Dedicated Acreage: 320 Acres

1. Outline the acreage dedicated to the subject well by colored pencil or hachure marks on the plat below.
2. If more than one lease is dedicated to the well, outline each and identify the ownership thereof (both as to working interest and royalty).
3. If more than one lease of different ownership is dedicated to the well, have the interests of all owners been consolidated by communitization, unitization, force-pooling, etc?

☒ Yes ☐ No If answer is "yes," type of consolidation Communitized effective 9-16-81
USGS Approval 11-2-81, SCR194

If answer is "no," list the owners and tract descriptions which have actually been consolidated. (Use reverse side of this form if necessary.) _____

No allowable will be assigned to the well until all interests have been consolidated (by communitization, unitization, forced-pooling, or otherwise) or until a non-standard unit, eliminating such interests, has been approved by the Commission.

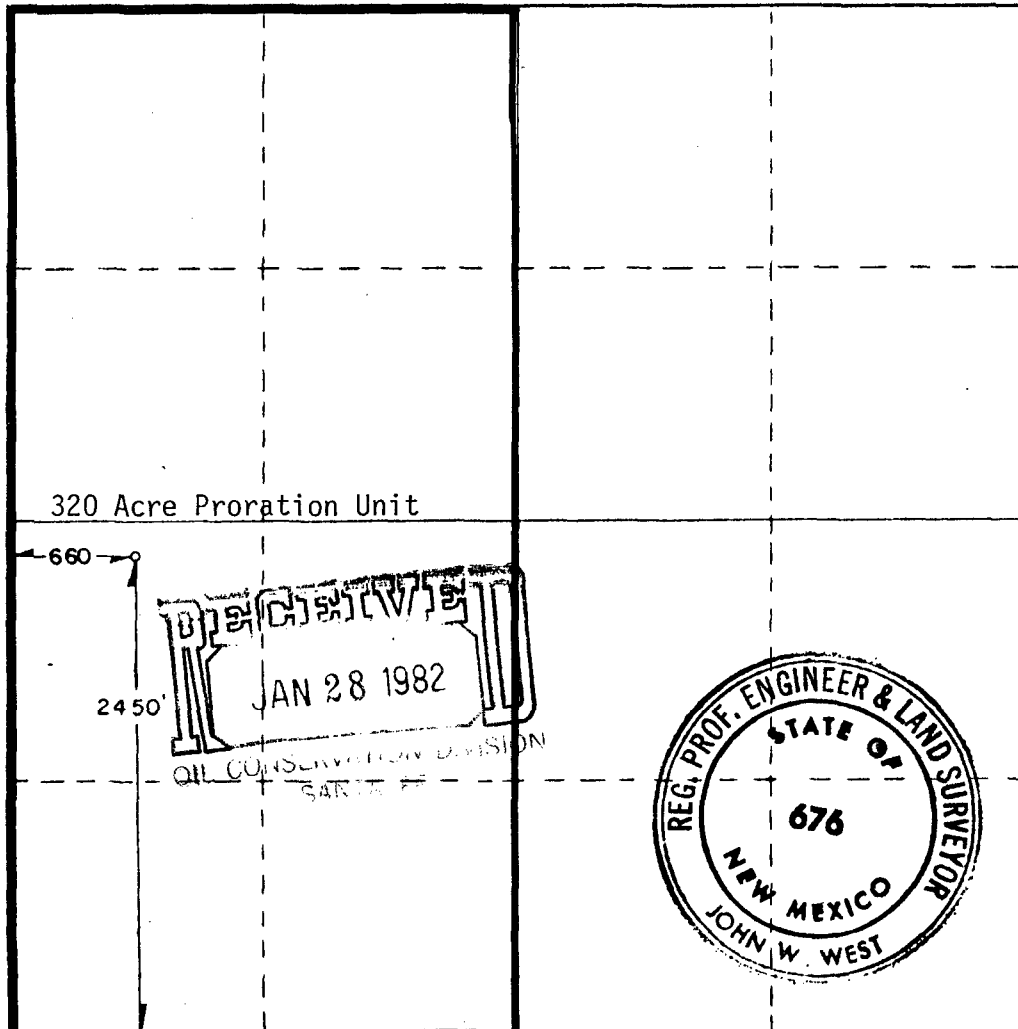

CERTIFICATION

I hereby certify that the information contained herein is true and complete to the best of my knowledge and belief.

[Signature]
Name
District Production Manager
Position
Grace Petroleum Corporation
Company
January 25, 1982
Date

I hereby certify that the well location shown on this plat was plotted from field notes of actual surveys made by me or under my supervision, and that the same is true and correct to the best of my knowledge and belief.

Date Surveyed
1/22/1982

Registered Professional Engineer and/or Land Surveyor

[Signature]
Certificate No. **JOHN W. WEST 676**
PATRICK A. ROMERO 6663
Ronald J. Eidson 3239

0 330 660 990 1320 1650 1980 2310 2640 2970 3300 3630 3960 4290 4620 4950 5280 5610 5940 6270 6600