

District I
1625 N. French Dr., Hobbs, NM 88240
District II
1301 W. Grand Avenue, Artesia, NM 88210
District III
1000 Rio Brazos Road, Aztec, NM 87410
District IV
1220 S. St. Francis Dr., Santa Fe, NM 87505

State of New Mexico
Energy Minerals and Natural Resources

Oil Conservation Division
1220 South St. Francis Dr.
Santa Fe, NM 87505

Form C-141
Revised October 10, 2003

Submit 2 Copies to appropriate
District Office in accordance
with Rule 116 on back
side of form

Release Notification and Corrective Action

OPERATOR

☒ Initial Report ☐ Final Report

Name of Company: DCP Midstream, LP	Contact: Polo Rendon, Lynn Ward
Address: 10 Desta Dr., Suite 400-W, Midland, TX 79705	Telephone No. 432/620-4207
Facility Name: RR Ext Line	Facility Type: Low Pressure Gathering Line

Surface Owner: Jimmy Cooper - Leasee Ownership: State of New Mexico	Mineral Owner	Lease No.
--	---------------	-----------

LOCATION OF RELEASE

Unit Letter N	Section 19	Township 20S	Range 37E	Feet from the 975.5 ft	North/South Line South Line	Feet from the 2,206 ft	East/West Line West	County Lea County
------------------	---------------	-----------------	--------------	---------------------------	--------------------------------	---------------------------	------------------------	----------------------

Latitude 32.55390 Longitude -103.29173

NATURE OF RELEASE

Type of Release: NGLs/Slop Oil	Volume of Release: 4 bbls	Volume Recovered: none
Source of Release: Leak in the 12" low pressure steel gathering line	Date and Hour of Occurrence: unknown	Date and Hour of Discovery 3/15/07 @ 10:30 am MST
Was Immediate Notice Given? <input checked="" type="checkbox"/> Yes <input type="checkbox"/> No <input type="checkbox"/> Not Required	If YES, To Whom? Larry Johnson, OCD Hobbs District Office, NM - email correspondence	
By Whom? Lynn Ward	Date and Hour 3/15/07 @ 3:38 pm	
Was a Watercourse Reached? <input type="checkbox"/> Yes <input checked="" type="checkbox"/> No	If YES, Volume Impacting the Watercourse Not applicable	

If a Watercourse was Impacted, Describe Fully.*
Not applicable

Describe Cause of Problem and Remedial Action Taken.* DCP Midstream, LP was notified by a pumper that a leak had developed on the RR Extension line in Section 19, T20S, R37E, east of CR41. DCP personnel investigated the location and discovered a 20' x 30' area of hydrocarbon impacted soils. In order to terminate the release, a OneCall was made which would enable excavation of the line. When the line was depressurized and excavated, operations placed a clamp at the point of release in order to terminate the release until the pipe can be replaced. Highlander Environmental out of Midland, Texas was contacted to conduct the investigation and prepare a remediation proposal which is to include the delineation of the release site. The estimated volume of the release is 4 bbls and does not exceed the reportable quantity under 19NMAC15.3.116.B of 5 bbls. Hydrocarbon impacted soils were excavated and placed on plastic pending the investigation by the remediation company. The impacted soils will be disposed of as exempt soils at CRI.

Describe Area Affected and Cleanup Action Taken.* When the DCP personnel visited the location, the impacted area was estimated as 20' x 30'. A OneCall was made and the supervisor waited until the appropriate personnel/companies had located their lines prior to excavating and terminating the release. Highlander Environmental was contacted to investigate and prepare a remediation plan to delineate and remediate the location.

From the Office of the State Engineer database, the depth to water at this location is estimated as less than 50 feet below surface indicating the RRALs for the location to be 100 ppm TPH, 50 ppm Total BTEX, and 10 ppm Benzene.

I hereby certify that the information given above is true and complete to the best of my knowledge and that all operators are required to report and/or file certain release notification information to protect public health or the environment. The acceptance of a C-141 report by the operator should their operations have failed to adequately investigate and report the release to the public or the environment. In addition, NMOCD acceptance of the release information is required by federal, state, or local laws and/or regulations.

PIPELINE LEAK INFO (C-141)
Line size, Normal operating PSI, Daily throughput,
H2S ppm, Line depth, Gravity (if oil),
field gathering line or transmission, areal
dimensions of liquid spill, year of installation

it pursuant to NMOCD rules and
or releases which may endanger
relieve the operator of liability
water, surface water, human health
compliance with any other

Signature: *Lynn Ward*

Printed Name: Lynn Ward

Title: Environmental Specialist

E-mail Address: lcward@dcpmidstream.com

Date: 3/23/07

Phone: 432/620-4207

Approved by District Supervisor: *Larry Johnson*

Approval Date: 4.4.07

Expiration Date: 6.4.07

Conditions of Approval:

Attached ☐

RP# 1273

Ward, Lynn C

From: Ward, Lynn C
Sent: Thursday, March 15, 2007 3:38 PM
To: 'Johnson, Larry, EMNRD'
Subject: DeLorme Map Image

Importance: High

Attachments: Map2D_1.jpg



Map2D_1.jpg (687 KB)

Dear Mr. Johnson,

On 3/15/07 at 11:15 am MST, I was notified by a field operator that a leak was found on the DCP Midstream, LP operated RR Extension Line in UL N, Sec. 19, T20S, R37E. The estimated size of impact was 20' x 30' and the field operator estimated 3 bbls of heavy hydrocarbons had been released. The leak was found at 10:30 am on 3/15/07, the line was a 12" steel, low pressure pipeline, the line was depressurized and clamped in order to terminate the release. The pipe will be released as quickly as possible. If you have any questions, please let me know.

It is DCP policy to remediate to the recommended remedial action levels all releases to soils and a 3rd party contractor will be contacted to perform the delineation/remediation. At this time, the field personnel were directed to place the hydrocarbon impacted soils on plastic and backfill until arrangements could be made.

The attached image is a map with the lat and long of the release location.

Sincerely,
DCP Midstream

Lynn Ward
Sr. Env. Specialist

(o) 432/620-4207
(c) 432/413-3601

See attached DeLorme Map Image (Map2D_1.jpg)

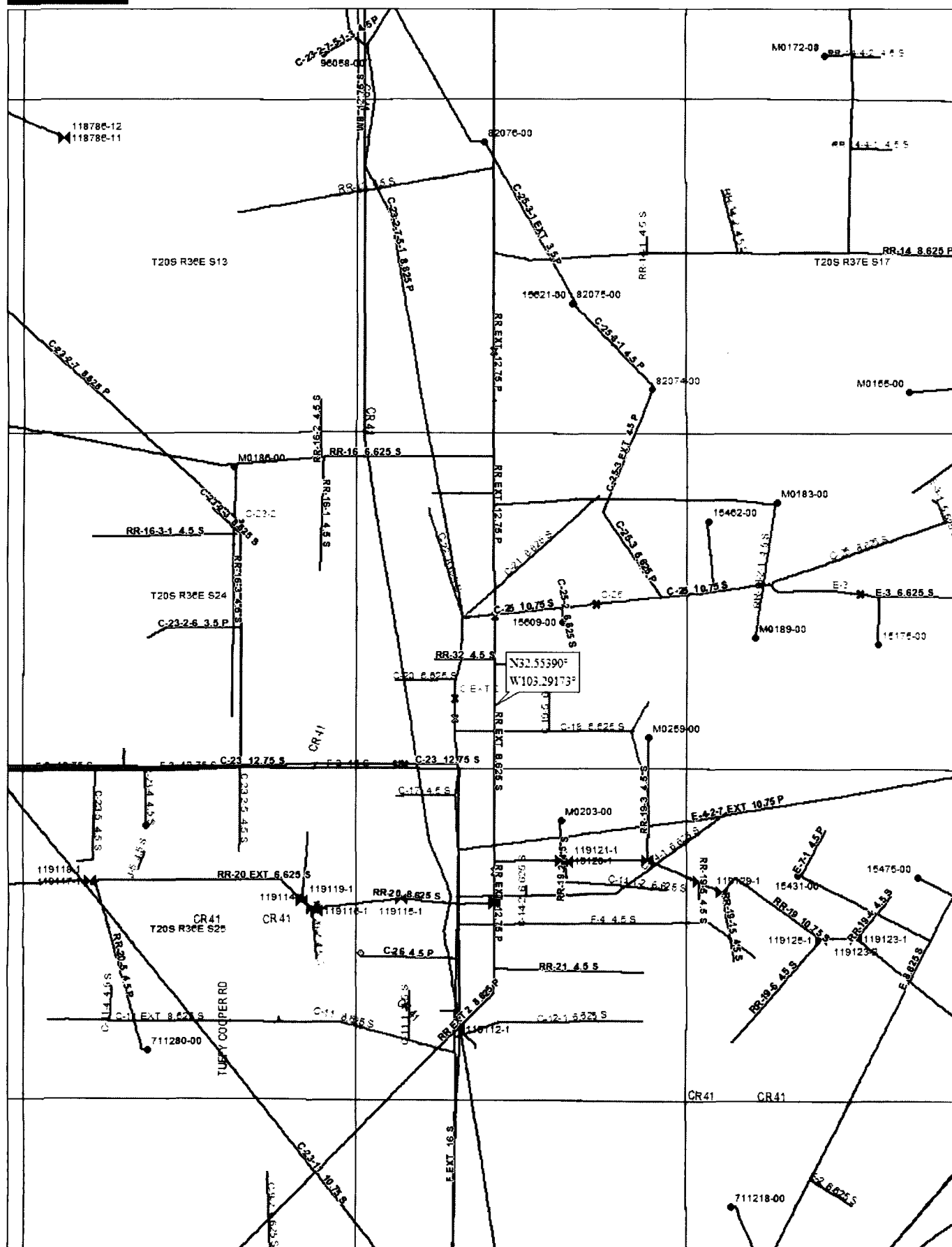

Data use subject to license.

© 2004 DeLorme. XMap® 4.5.

www.delorme.com

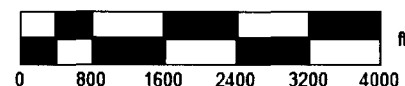

Data Zoom 13-0