

ABOVE THIS LINE FOR DIVISION USE ONLY

NEW MEXICO OIL CONSERVATION DIVISION
 - Engineering Bureau -
 1220 South St. Francis Drive, Santa Fe, NM 87505



ADMINISTRATIVE APPLICATION CHECKLIST

THIS CHECKLIST IS MANDATORY FOR ALL ADMINISTRATIVE APPLICATIONS FOR EXCEPTIONS TO DIVISION RULES AND REGULATIONS WHICH REQUIRE PROCESSING AT THE DIVISION LEVEL IN SANTA FE

Application Acronyms:

☒ **NSL-Non-Standard Location**
 ☐ **NSP-Non-Standard Proration Unit**
 ☐ **SD-Simultaneous Dedication**
☐ **DHC-Downhole Commingling**
 ☐ **CTB-Lease Commingling**
 ☐ **PLC-Pool/Lease Commingling**
☐ **PC-Pool Commingling**
 ☐ **OLS - Off-Lease Storage**
 ☐ **OLM-Off-Lease Measurement**
☐ **WFX-Waterflood Expansion**
 ☐ **PMX-Pressure Maintenance Expansion**
☐ **SWD-Salt Water Disposal**
 ☐ **IPI-Injection Pressure Increase**
☐ **EOR-Qualified Enhanced Oil Recovery Certification**
 ☐ **PPR-Positive Production Response**

- [1] **TYPE OF APPLICATION** - Check Those Which Apply for [A]
- [A] Location - Spacing Unit - Simultaneous Dedication
☐ NSL ☐ NSP ☐ SD
- Check One Only for [B] or [C]
- [B] Commingling - Storage - Measurement
☐ DHC ☐ CTB ☐ PLC ☐ PC ☐ OLS ☐ OLM
- [C] Injection - Disposal - Pressure Increase - Enhanced Oil Recovery
☐ WFX ☐ PMX ☒ SWD ☐ IPI ☐ EOR ☐ PPR
- [D] Other: Specify _____
- [2] **NOTIFICATION REQUIRED TO:** - Check Those Which Apply, or Does Not Apply
- [A] ☐ Working, Royalty or Overriding Royalty Interest Owners
- [B] ☐ Offset Operators, Leaseholders or Surface Owner
- [C] ☐ Application is One Which Requires Published Legal Notice
- [D] ☐ Notification and/or Concurrent Approval by BLM or SLO
U.S. Bureau of Land Management - Commissioner of Public Lands, State Land Office
- [E] ☐ For all of the above, Proof of Notification or Publication is Attached, and/or,
- [F] ☐ Waivers are Attached

[3] **SUBMIT ACCURATE AND COMPLETE INFORMATION REQUIRED TO PROCESS THE TYPE OF APPLICATION INDICATED ABOVE.**

[4] **CERTIFICATION:** I hereby certify that the information submitted with this application for administrative approval is **accurate** and **complete** to the best of my knowledge. I also understand that **no action** will be taken on this application until the required information and notifications are submitted to the Division.

Note: Statement must be completed by an individual with managerial and/or supervisory capacity.

Print or Type Name	Signature	Title	Date
e-mail Address			



MAR OIL & GAS

exploration and production P.O. Box 5155 • Santa Fe, NM 87502

RECEIVED
RECEIVED

JUN 20

JUN 20 2007

Oil Conservation Division

1220 S. St. Francis Drive

Oil Conservation Division

1220 S. St. Francis Drive

Santa Fe, NM 87505

New Mexico Oil Conservation Division
Engineering Bureau
1220 South St. Francis
Santa Fe, New Mexico 87505

RE: C108(Application for Authorization to Inject)

Mr. William V. Jones,

Enclosed is NMOCD form C108 for the conversion of the Mar Oil and Gas Corp.
Sawyer 4 State # 2 API # 30-025-26893 from Sawyer West San Andres Oil well to a
lease salt water disposal well.

Should you have questions or need further information, please do not hesitate to call
or email.

Sincerely,



Billy (Bill) E. Prichard

505-390-9100 cellular

Email: shabillron01@warpdriveonline.com

APPLICATION FOR AUTHORIZATION TO INJECT

- I. PURPOSE: _____ Secondary Recovery _____ Pressure Maintenance _____ ☒ Disposal _____ Storage
Application qualifies for administrative approval? _____ ☒ Yes _____ No
- II. OPERATOR: **Mar Oil and Gas Corporation** Ogrid # **151228**
ADDRESS: **PO Box 5155 Santa Fe, New Mexico 87502**
CONTACT PARTY: **Billy E. Prichard** PHONE: **505-390-9100**
- III. WELL DATA: Complete the data required on the reverse side of this form for each well proposed for injection.
Additional sheets may be attached if necessary.
- IV. Is this an expansion of an existing project? _____ Yes _____ ☒ No
If yes, give the Division order number authorizing the project: _____
- V. Attach a map that identifies all wells and leases within two miles of any proposed injection well with a one-half mile radius circle drawn around each proposed injection well. This circle identifies the well's area of review.
- VI. Attach a tabulation of data on all wells of public record within the area of review which penetrate the proposed injection zone. Such data shall include a description of each well's type, construction, date drilled, location, depth, record of completion, and a schematic of any plugged well illustrating all plugging detail.
- VII. Attach data on the proposed operation, including:
1. Proposed average and maximum daily rate and volume of fluids to be injected;
 2. Whether the system is open or closed;
 3. Proposed average and maximum injection pressure;
 4. Sources and an appropriate analysis of injection fluid and compatibility with the receiving formation if other than reinjected produced water; and,
 5. If injection is for disposal purposes into a zone not productive of oil or gas at or within one mile of the proposed well, attach a chemical analysis of the disposal zone formation water (may be measured or inferred from existing literature, studies, nearby wells, etc.).
- *VIII. Attach appropriate geologic data on the injection zone including appropriate lithologic detail, geologic name, thickness, and depth. Give the geologic name, and depth to bottom of all underground sources of drinking water (aquifers containing waters with total dissolved solids concentrations of 10,000 mg/l or less) overlying the proposed injection zone as well as any such sources known to be immediately underlying the injection interval.
- IX. Describe the proposed stimulation program, if any.
- *X. Attach appropriate logging and test data on the well. (If well logs have been filed with the Division, they need not be resubmitted).
- *XI. Attach a chemical analysis of fresh water from two or more fresh water wells (if available and producing) within one mile of any injection or disposal well showing location of wells and dates samples were taken.
- XII. Applicants for disposal wells must make an affirmative statement that they have examined available geologic and engineering data and find no evidence of open faults or any other hydrologic connection between the disposal zone and any underground sources of drinking water.
- XIII. Applicants must complete the "Proof of Notice" section on the reverse side of this form.
- XIV. Certification: I hereby certify that the information submitted with this application is true and correct to the best of my knowledge and belief.
- NAME: Billy E. Prichard TITLE: Foreman
SIGNATURE: _____ DATE: _____
E-MAIL ADDRESS: shabillron01@warpdriveonline.com
- * If the information required under Sections VI, VIII, X, and XI above has been previously submitted, it need not be resubmitted. Please show the date and circumstances of the earlier submittal: _____

Mar Oil and Gas Corporation
C-108(Application for Authorization to Inject)
Sawyer 4 State # 2
API # 30-025-26893
660 FNL X 660 FEL
Unit Letter "A", Section 4, T10S, R37E
Lea County, New Mexico

Well Data

Spud 6/12/1981 as Sawyer San Andres oil well.

8 5/8" 24# casing set at 456ft in 12 1/4" hole. Cemented with 325 sacks Class "C" cement. Cement circulated to surface

7 7/8" hole drilled to TD 5142ft

5 1/2" 15.50# casing set at 5116ft. Cemented in 2 stages with 2050 sacks Class "C" cement. DV tool at 2319ft. Cement top on 1st stage at 3200ft by CBL. 2nd stage circulated to surface.

Anhy – 2271ft

Top Yates – 2950ft

Queen – 3681ft

San Andres – 4240ft

Pi – 4816ft

Slaughter – 4976ft

Perforations 4974 – 5038ft

Production Summary of api:3002526893 pool:SAWYER;SAN ANDRES, WEST

producing year	Oil	Gas	Water	Co2
1992	35098	0	274126	0
1993	1613	0	39888	0
1994	1566	0	38106	0
1995	1765	0	43442	0
1996	1723	0	49255	0
1997	1745	0	48198	0
1998	596	0	40896	0
1999	485	0	32254	0
2000	478	0	30773	0
2001	177	0	26644	0
2002	0	0	22409	0
2003	499	0	10020	0
2004	1605	0	27070	0
2005	1165	0	17870	0
2006	327	0	4347	0
2007	0	0	0	0
summary	13744	0	431172	0

Attachment "A"

Mar Oil and Gas Corporation
Sawyer 4 State # 2
API # 30-025-26893
660 FNL X 660 FEL
Unit Letter "A", Section 4, T10S, R37E
Lea County, New Mexico
Prior to conversion to SWD

Spud 6/12/1981

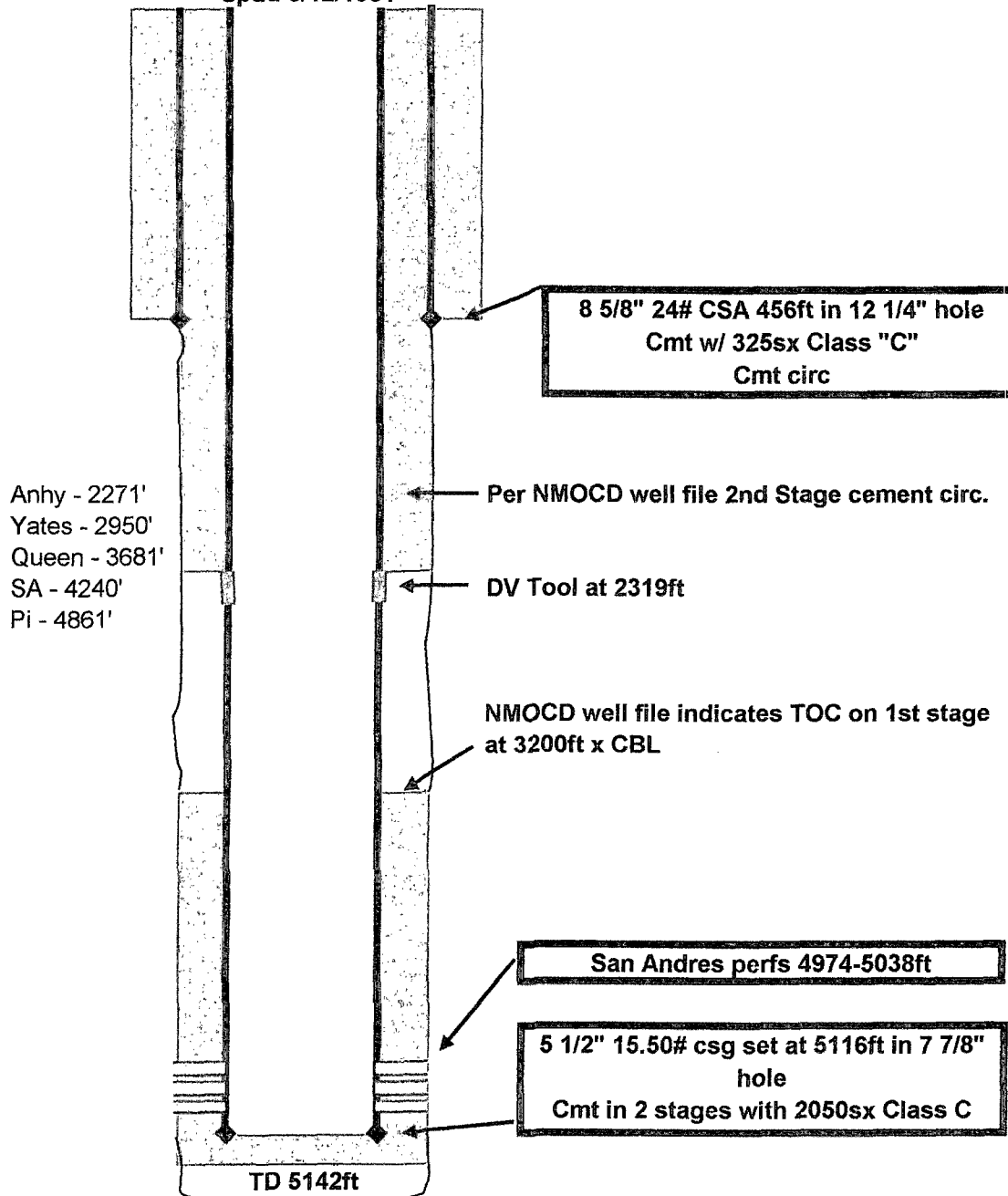

Mar Oil and Gas Corporation
 Sawyer 4 State # 2
 API # 30-025-26893
 660 FNL X 660 FEL
 Unit Letter "A", Section 4, T10S, R37E
 Lea County, New Mexico
 After conversion to SWD

Spud 6/12/1981

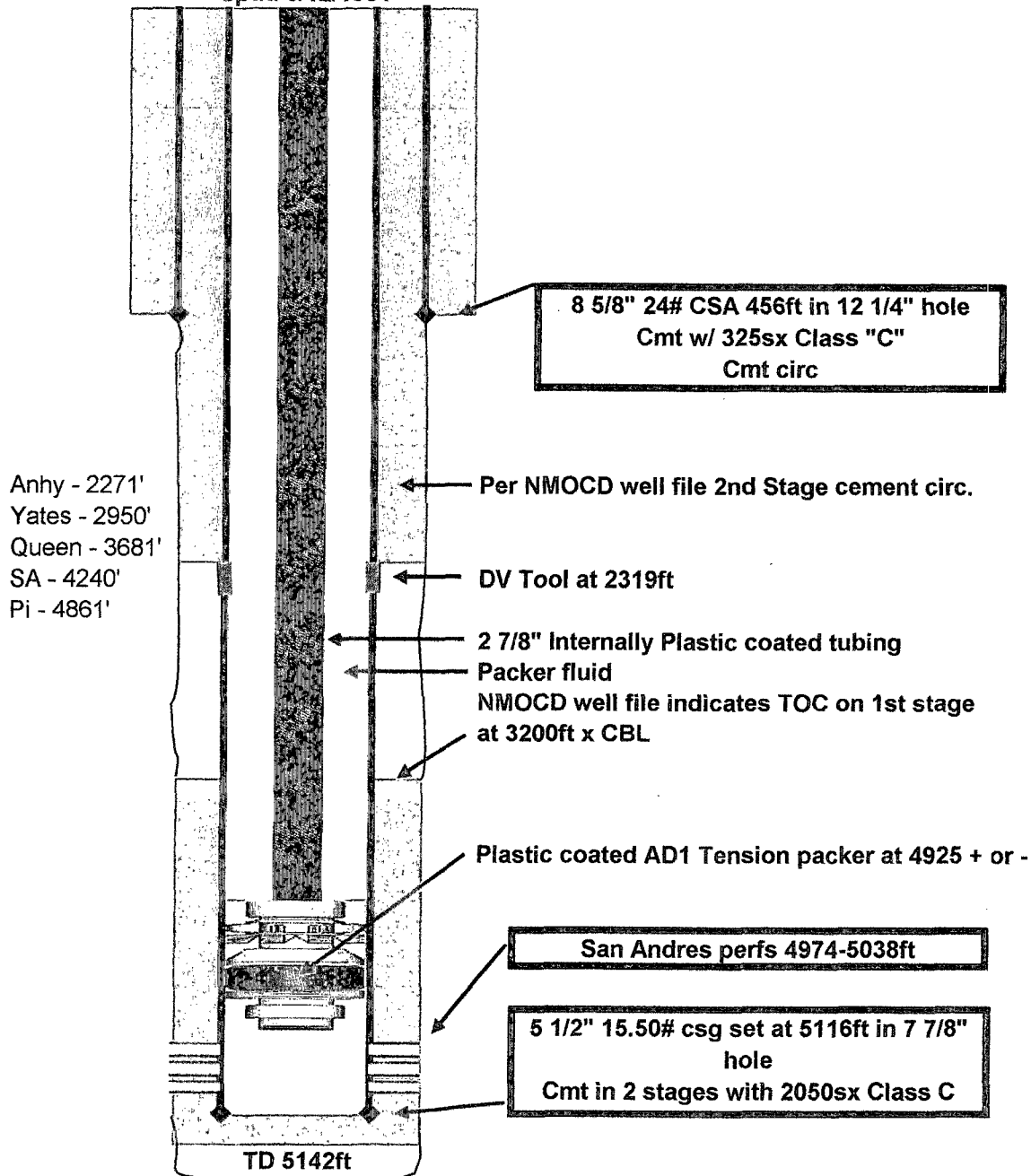

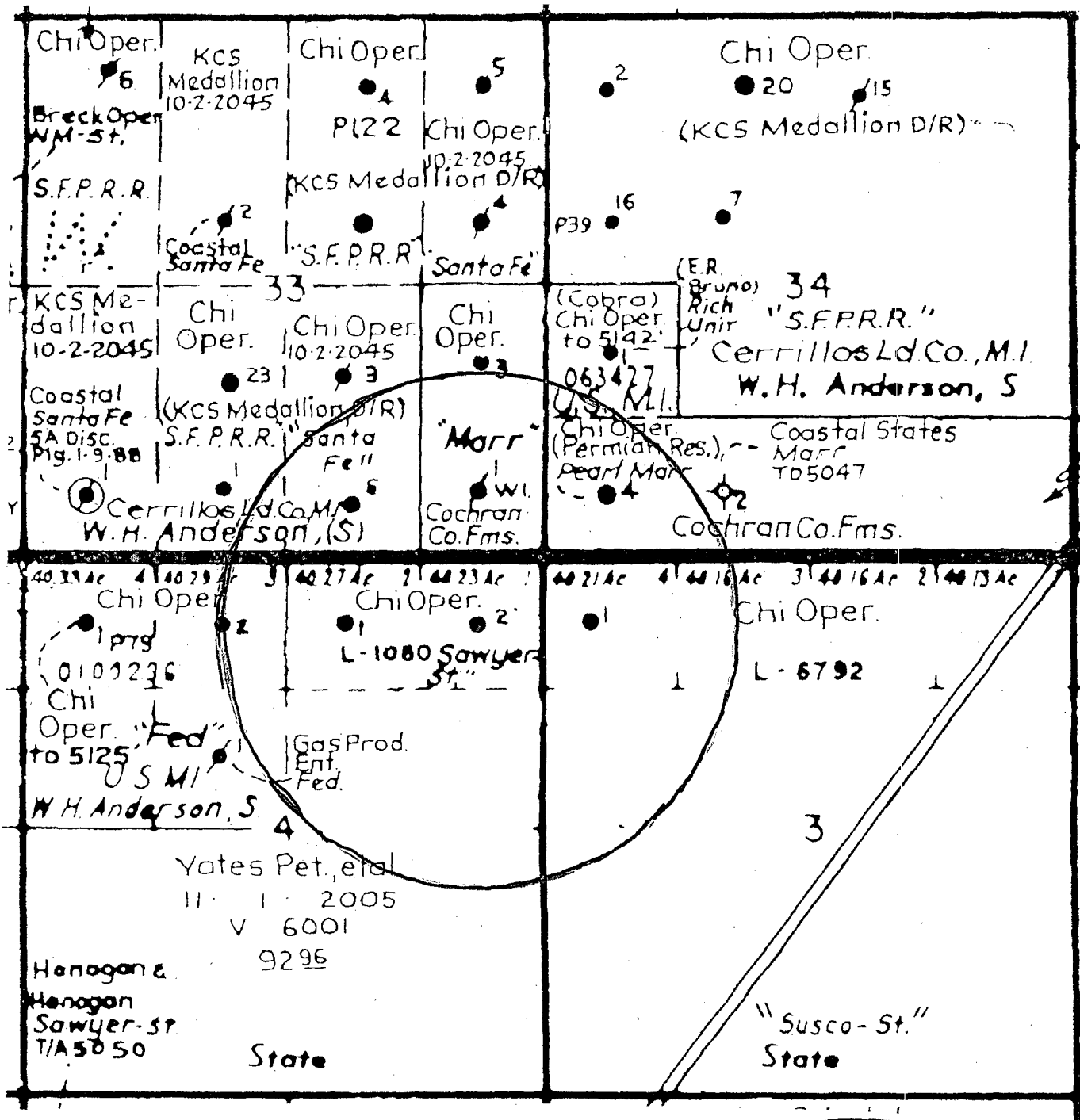

OCD
GENERATED
FROM OLDER
MIDLAND MAP
CO. DATA

RADIUS API	OPERATOR	LEASE	# TYPE	TWN	RNG	SEC	UNIT
3002526893	MAR OIL & GAS CORP.	SAWYER 4 STATE	2 OIL	10S	37E	4	1
1120	3002527615 MAR OIL & GAS CORP.	SUSCO 3 STATE	1 OIL	10S	37E	3	4 ✓
1320	3002523247 MAR OIL & GAS CORP.	PEARL MARR	1 SWD	09S	37E	33	P ✓
1320	3002523169 MAR OIL & GAS CORP.	SAWYER 4 STATE	1 OIL	10S	37E	4	2 ✓
1800	3002526972 MAR OIL & GAS CORP.	COASTAL SANTA FE	6 OIL	09S	37E	33	O ✓
1865	3002527145 MAR OIL & GAS CORP.	PEARL MARR	4 OIL	09S	37E	34	M ✓
2640	3002525881 MAR OIL & GAS CORP.	PEARL MARR	3 OIL	09S	37E	33	1 ✓
2642	3002525914 MAR OIL & GAS CORP.	FEDERAL 4	2 OIL	10S	37E	4	3 ✓

out
of AsR

Wells in 0.5 mile area of review

Attachment C

BEP

Attachment B

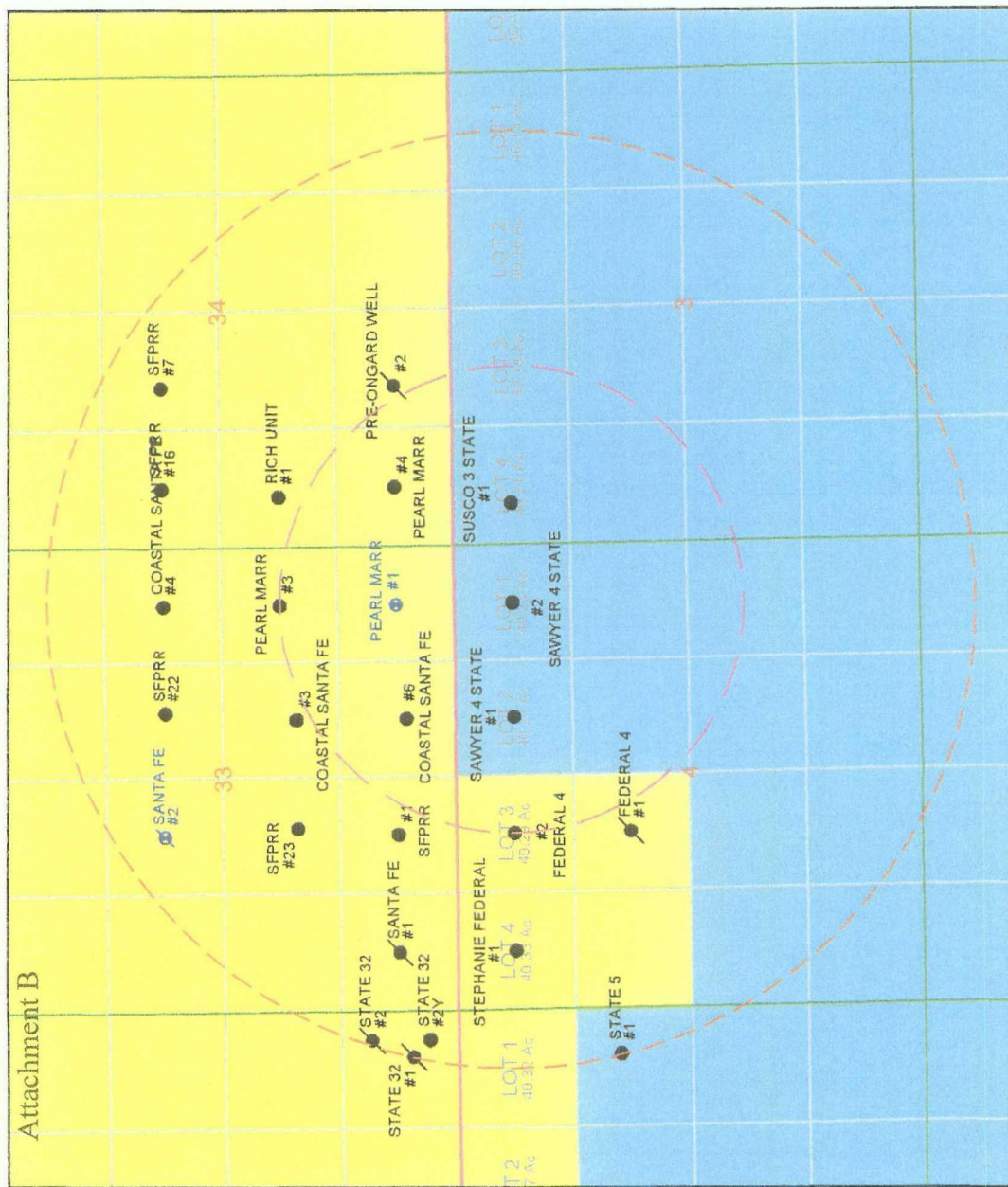

SURFACE OWNERSHIP

- BLM
- STATE
- PRIVATE
- BUREAU OF RECLAM.
- NATIONAL PARK SERV.
- FOREST SERVICE
- PARK
- WILDLIFE REFUGE
- TRIBAL LANDS

- ACTIVE OIL
- INACTIVE OIL
- ACTIVE GAS
- INACTIVE GAS
- ACTIVE INJECTION
- INACTIVE INJECTION
- ACTIVE WATER
- INACTIVE WATER
- ACTIVE SWD
- INACTIVE SWD
- WATER WELL

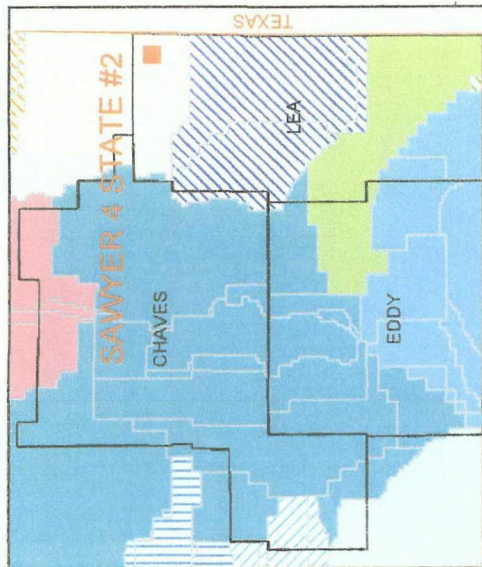

- DECLARED GROUND WATER BASINS**
- CAPITAN
 - CARLSBAD
 - FORT SUMNER
 - LEA COUNTY
 - JAL
 - HONDO
 - SALT BASIN
 - PENASCO
 - PORTALES
 - ROSWELL
 - ARTESIAN

- 1 MILE RADIUS
- 1/2 MILE RADIUS
- TOWNSHIP LINE
- SECTION LINE

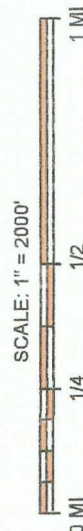

MAR OIL & GAS CORP.
SAWYER 4 STATE #2

API: 3002526893
SEC: 4
UNIT: 1

TWP: 10S
RNG: 37E
660 FEL

COUNTY: LEA
N 31 E - 18.2 MILES FROM Tatum, NM

LAT: 33°28.895' N. LON: 103°08.090' W.

NO WARRANTY IS EXPRESSED OR IMPLIED FOR THE RESULTS AND/OR COMPLETION OF THIS MAP

DATE: 05/23/07
www.WELLFROMAPPING.COM
COPYRIGHT 2003-2006

Mar Oil and Gas Corporation
Susco 3 State # 1
API # 30-025-27615
660 FNL X 460 FWL
Unit Letter "D", Section 3, T10S, R37E
Lea County, New Mexico
Drilled as San Andres Oil Well

Spud 11/24/1981

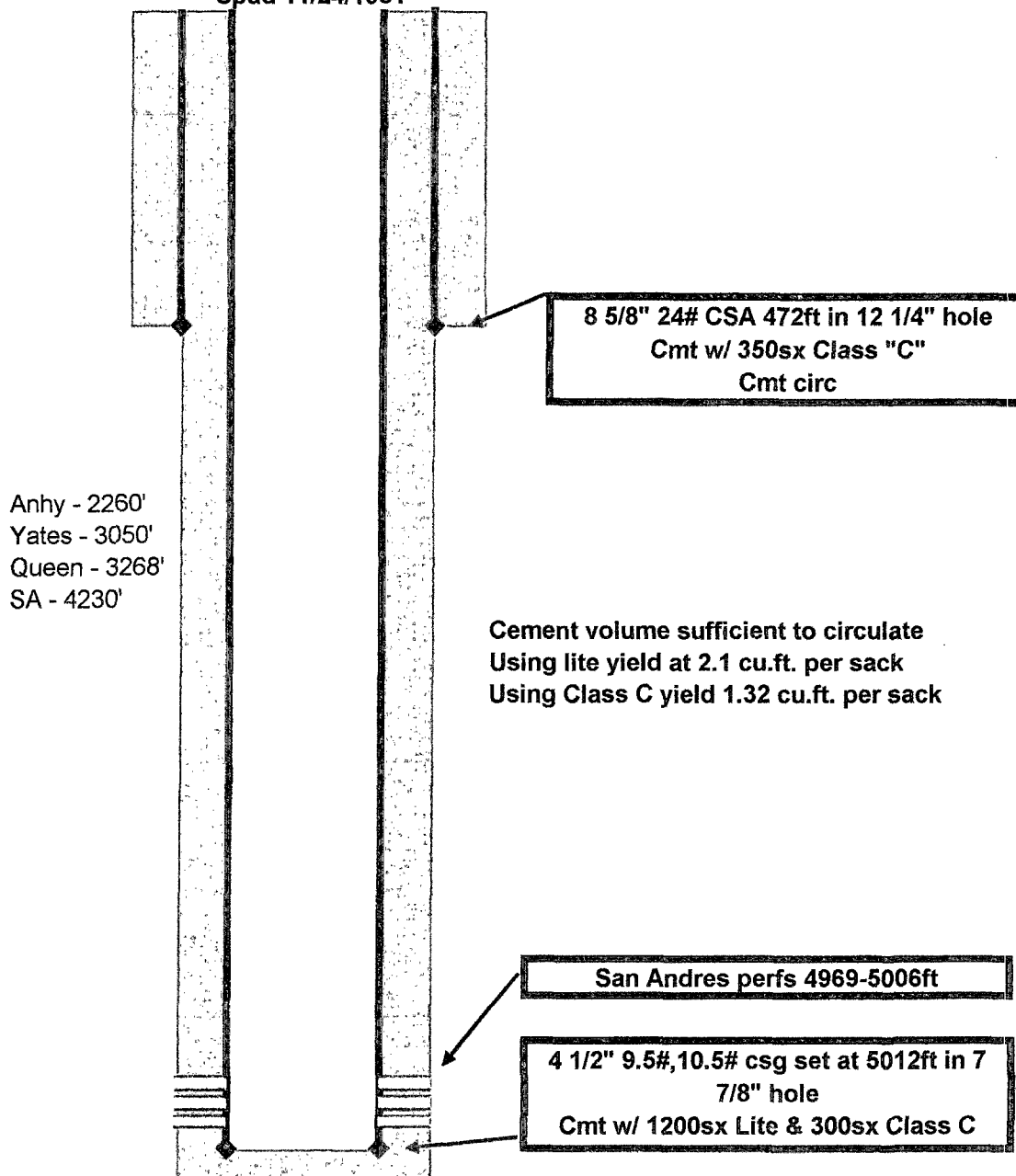

Attachment C

Mar Oil and Gas Corporation
Pearl Marr SWD # 1
API # 30-025-23247
660 FEL X 660 FSL
Unit Letter "P", Section 33, T9S, R37E
Lea County, New Mexico
Drilled as San Andres Oil Well

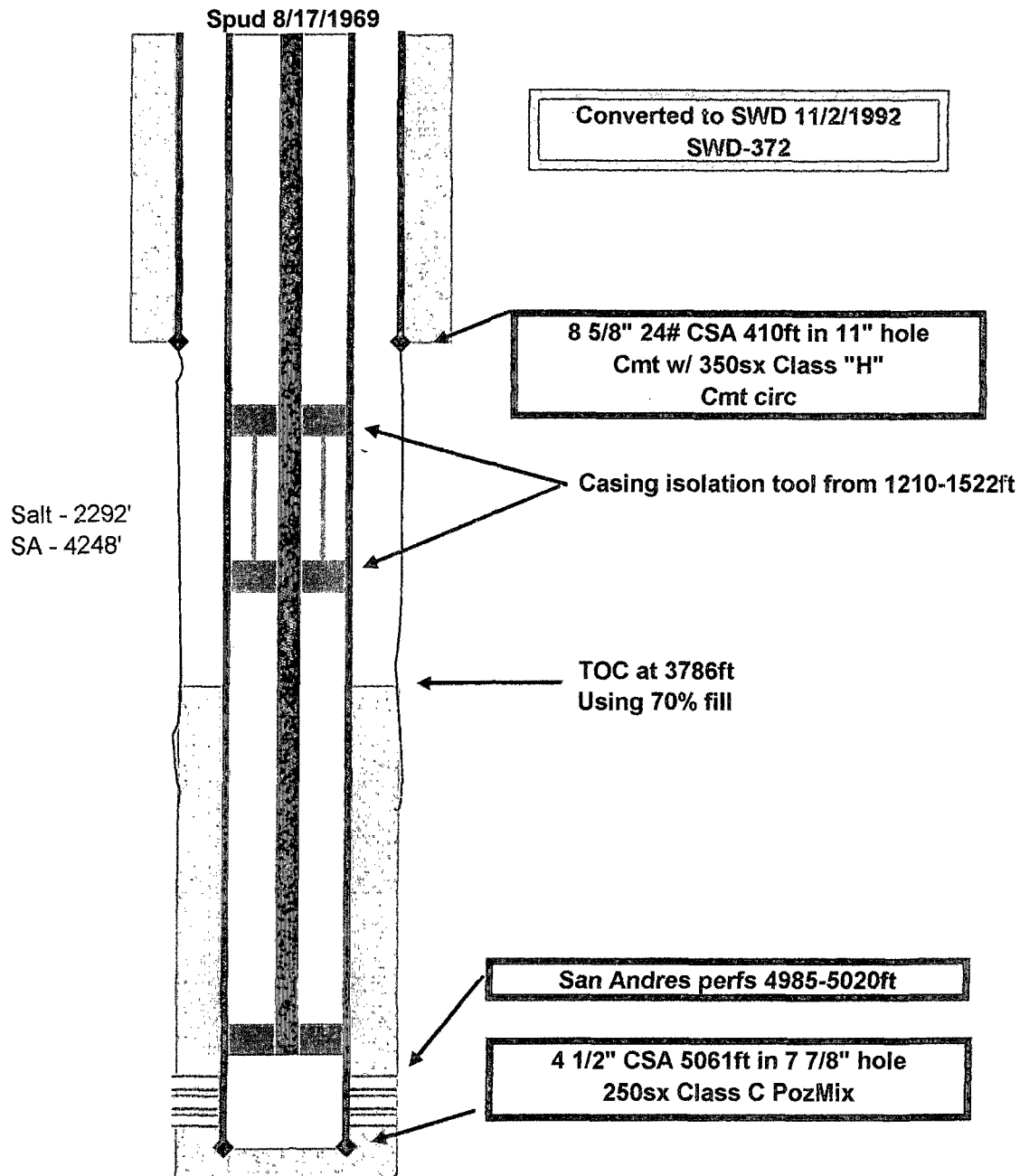

Mar Oil and Gas Corporation
Sawyer 4 State # 1
API # 30-025-23169
660 FNL X 1980 FEL
Unit Letter "B", Section 4, T10S, R37E
Lea County, New Mexico
Drilled as San Andres Oil Well

Spud 6/2/1969

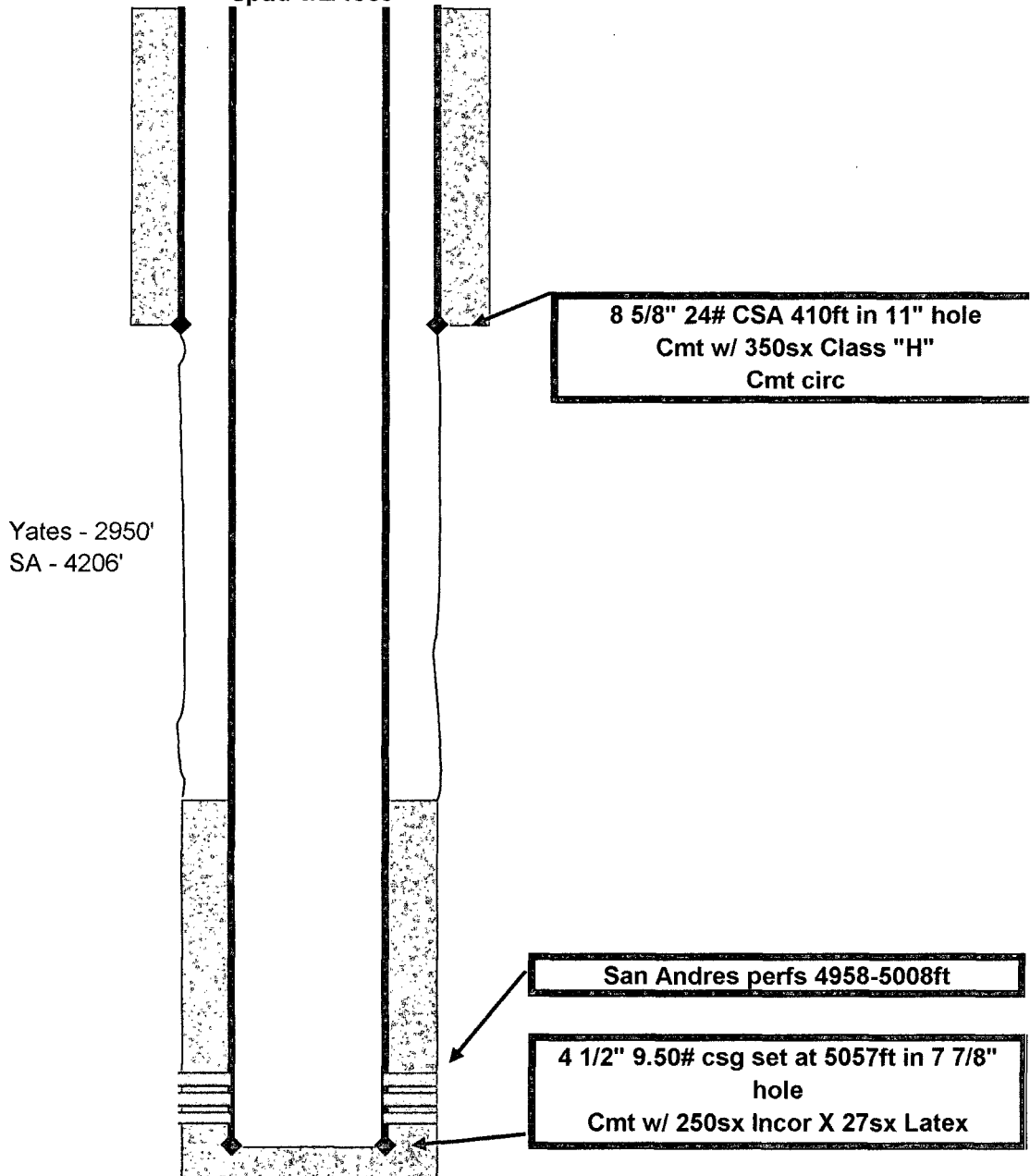

Attachment C

Mar Oil and Gas Corporation
Coastal Santa Fe # 6
API # 30-025-26972
560 FSL X 1980 FEL
Unit Letter "O", Section 33, T9S, R37E
Lea County, New Mexico
Drilled as San Andres Oil Well

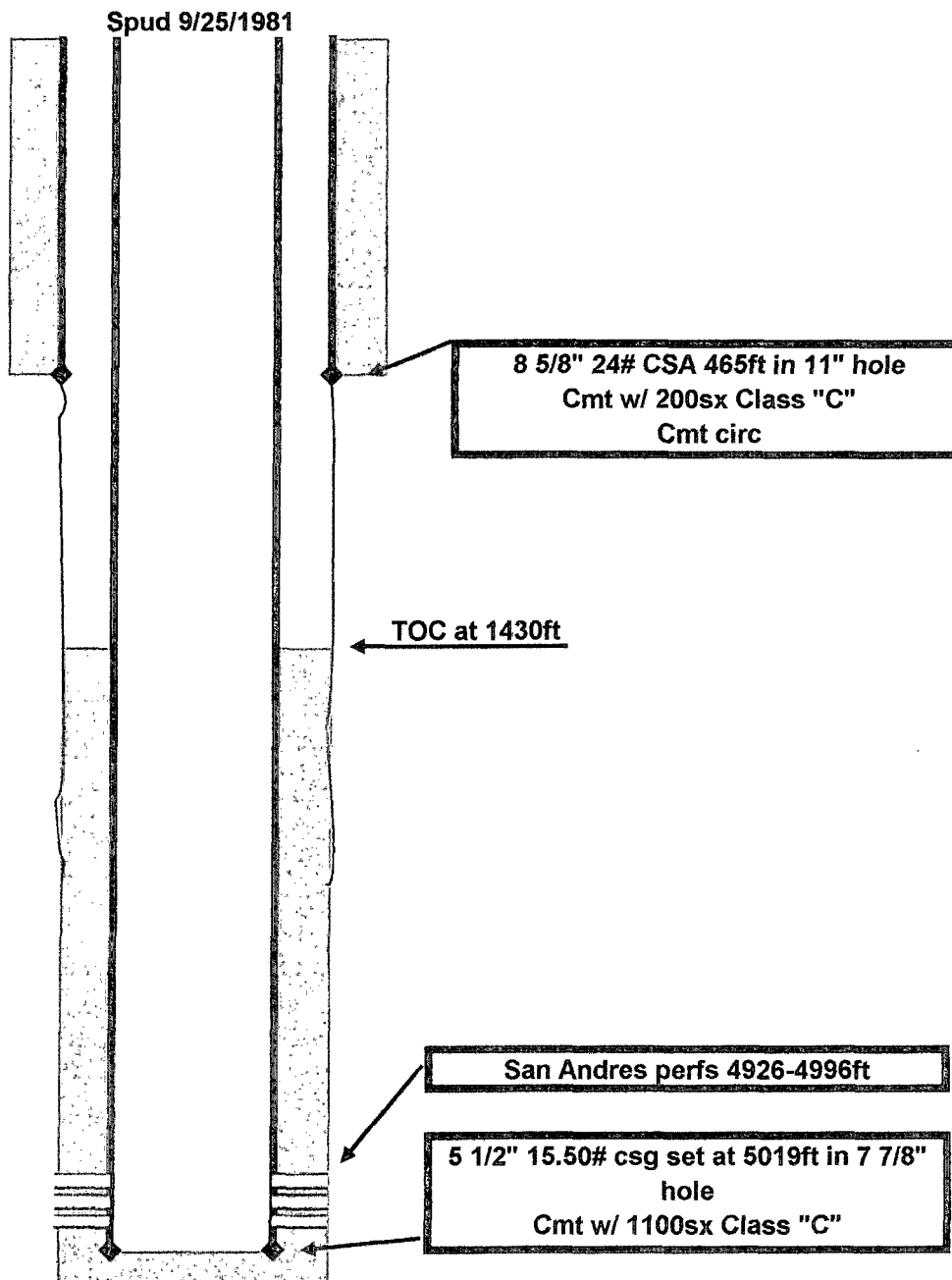

Attachment C

Mar Oil and Gas Corporation
Pearl Marr # 4
API # 30-025-27145
660 FSL X 660 FWL
Unit Letter "M", Section 34, T9S, R37E
Lea County, New Mexico
Drilled as San Andres Oil Well

Spud 5/18/1981

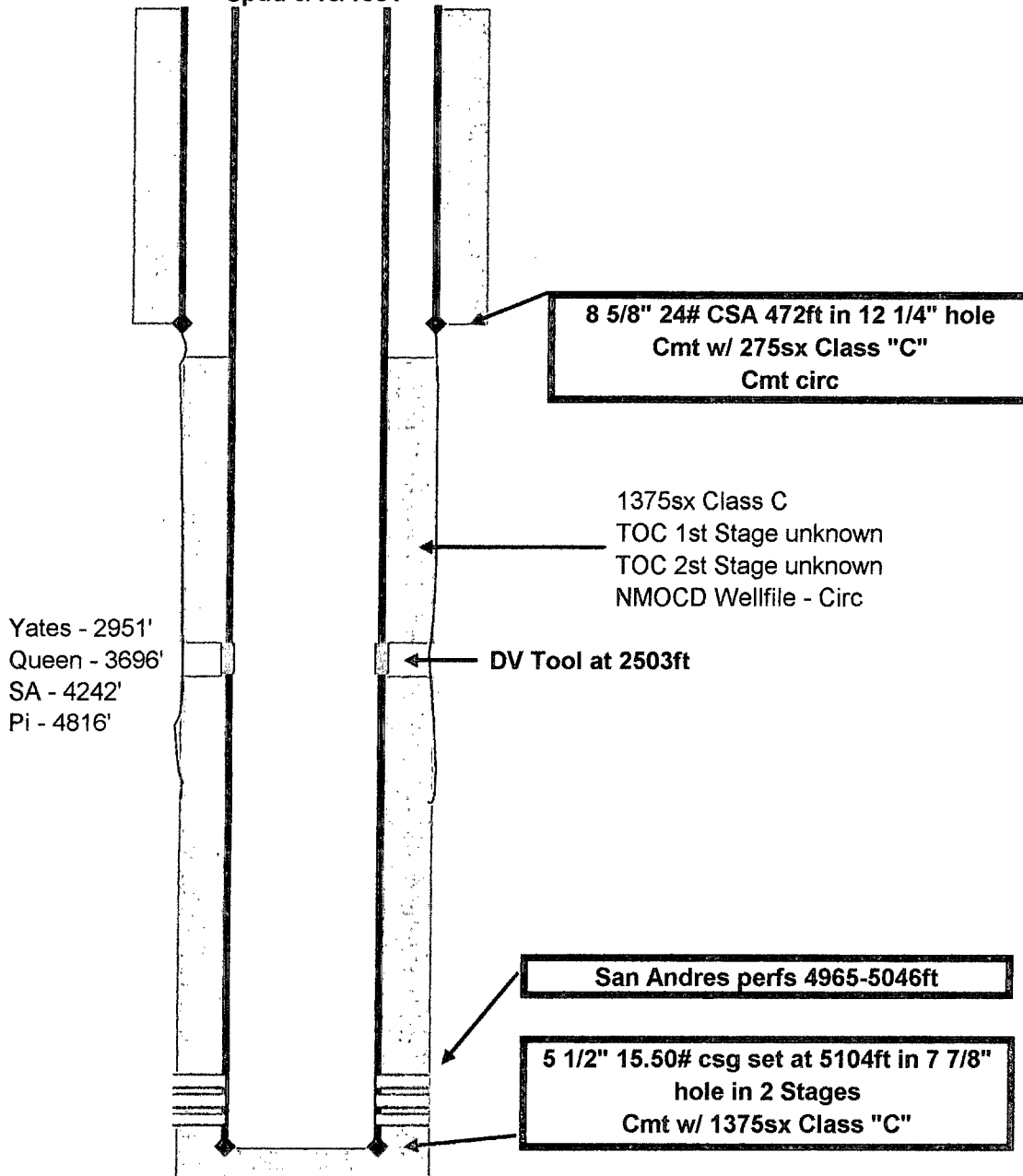

Mar Oil and Gas Corporation
Pearl Marr # 3
API # 30-025-25881
1980 FSL X 660 FEL
Unit Letter "I", Section 33, T9S, R37E
Lea County, New Mexico
Drilled as San Andres Oil Well

Spud 5/17/1978

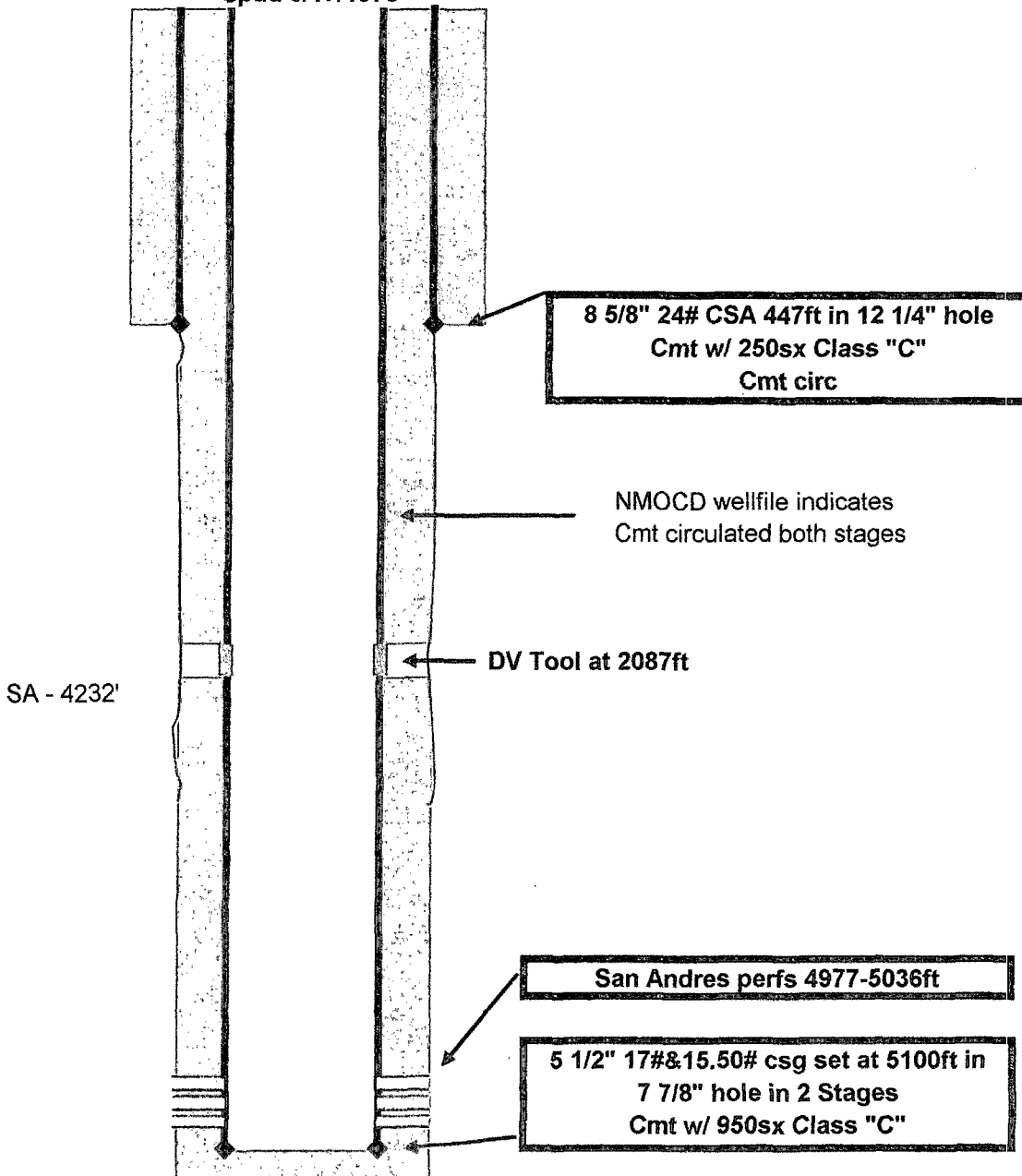

Mar Oil and Gas Corporation
Federal 4 # 2
API # 30-025-25914
660 FNL X 1980 FWL
Unit Letter "C", Section 4, T10S, R37E
Lea County, New Mexico
Drilled as San Andres Oil Well

Spud 5/31/1978

Distance from proposed
SWD
2642 feet

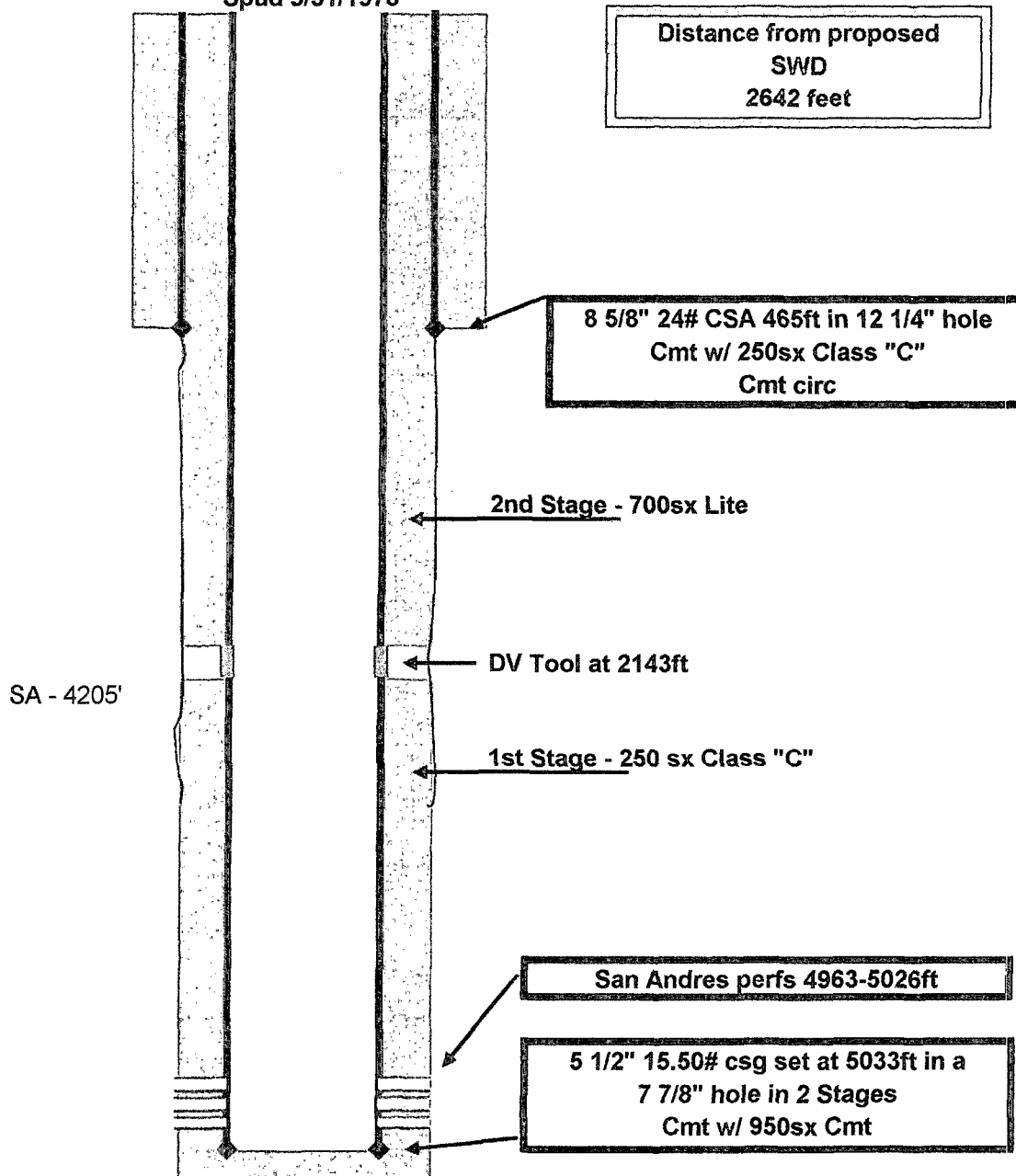

Attachment C

**Mar Oil and Gas Corporation
C-108(Application for Authorization to Inject)
Sawyer 4 State # 2
API # 30-025-26893
660 FNL X 660 FEL
Unit Letter "A", Section 4, T10S, R37E
Lea County, New Mexico**

VIII

The proposed disposal interval is the Sawyer San Andres, West formation. The San Andres is a carbonate reservoir of Permian Age. Above the San Andres is the Queen formation, estimated top of the Queen is 3645 feet. Below the San Andres is the Glorieta formation, estimated top of the Glorieta is 5100ft.

There is no known fresh water strata underlying the San Andres formation

No fresh water wells were identified within the 1 mile Area of Review. Fresh water is in the alluvial fill from the surface to the top of the Red Bed. Surface casing on oil and gas wells in the area have average setting depth of 450 feet.

New Mexico Office of the State Engineer
POD Reports and Downloads

Township: Range: Sections:

NAD27 X: Y: Zone: Search Radius:

County: Basin: Number: Suffix:

Owner Name: (First) (Last) ☐ Non-Domestic ☐ Domestic ☒ All

AVERAGE DEPTH OF WATER REPORT 05/24/2007

Bsn	Tws	Rng	Sec	Zone	X	Y	Wells	(Depth Water in Feet)		
								Min	Max	Avg

No Records found, try again

New Mexico Office of the State Engineer
POD Reports and Downloads

Township: Range: Sections:

NAD27 X: Y: Zone: Search Radius:

County: Basin: Number: Suffix:

Owner Name: (First) (Last) ☐ Non-Domestic ☐ Domestic ☒ All

AVERAGE DEPTH OF WATER REPORT 05/24/2007

Bsn	Tws	Rng	Sec	Zone	X	Y	Wells	(Depth Water in Feet)		
								Min	Max	Avg

No Records found, try again

Attachment E

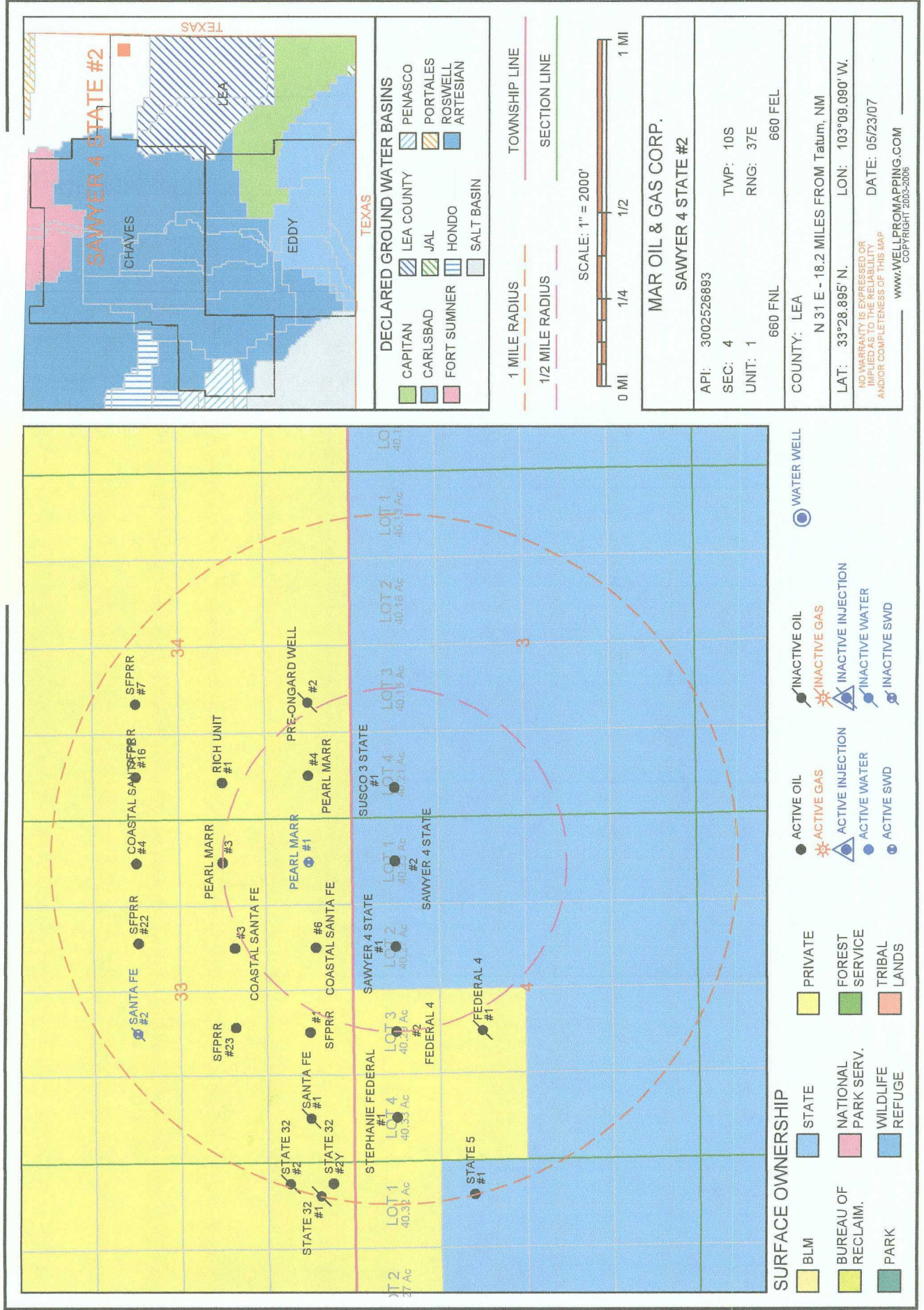

**Mar Oil and Gas Corporation
C-108(Application for Authorization to Inject)
Sawyer 4 State # 2
API # 30-025-26893
660 FNL X 660 FEL
Unit Letter "A", Section 4, T10S, R37E
Lea County, New Mexico**

XII

Affirmative Water Statement

As required by Item XII of form C-108, Mar Oil and Gas Corporation, has examined available geologic and engineering data and found no evidence of open faults or other hydrologic connection between the disposal zone and any other underground source of drinking water.

Affidavit of Publication

STATE OF NEW MEXICO)

) ss.

COUNTY OF LEA)

Joyce Clemens being first duly sworn on oath deposes and says that she is Advertising Director of **THE LOVINGTON LEADER**, a daily newspaper of general paid circulation published in the English language at Lovington, Lea County, New Mexico; that said newspaper has been so published in such county continuously and uninterruptedly for a period in excess of Twenty-six (26) consecutive weeks next prior to the first publication of the notice hereto attached as hereinafter shown; and that said newspaper is in all things duly qualified to publish legal notices within the meaning of Chapter 167 of the 1937 Session Laws of the State of New Mexico.

That the notice which is hereto attached, entitled

Legal Notice

was published in a regular and entire issue of **THE LOVINGTON LEADER** and not in any supplement thereof, for

one (1) day, beginning with the issue of May 26, 2007 and ending with the issue of May 26, 2007.

And that the cost of publishing said notice is the sum of \$ 29.26 which sum has been (Paid) as Court Costs.

Joyce Clemens

Subscribed and sworn to before me this 7th day of June 2007

Debbie Schilling

Debbie Schilling

Notary Public, Lea County, New Mexico

My Commission Expires June 22, 2010

LEGAL NOTICE
Mar. Oil and Gas Corporation, PO Box 5155, Santa Fe, New Mexico 87502 has filed form C-108 (Application for Authorization to Inject) with the New Mexico Oil Conservation Division seeking administrative approval for the conversion of the Sawyer 4 State #2, API #30-025-26893, 660 FNL X 660 FEL Unit Letter "A" Section 4, T10S, R37E Lea County, New Mexico from a Sawyer San Andres West oil well to a lease salt water disposal well. The disposal interval would be the San Andres formation through perforations 4974-5038ft. Disposal fluid would produced water from surrounding San Andres oil wells. Anticipated disposal rate of 250 BWPD with a maximum disposal rate of 700 BWPD. Anticipated disposal pressure 250 psi with a maximum disposal pressure of 990 psi.

All interested parties opposing the aforementioned must file objections with the New Mexico Oil Conservation Division, 1220 South St. Francis Drive, Santa Fe, New Mexico 87505 within 15 days. Additional information can be obtained by

contacting Billy Prichard 505-390-9100.

Published in the Lovington Leader May 26, 2007.

Mar Oil and Gas Corporation
C-108(Application for Authorization to Inject)
Sawyer 4 State # 2
API # 30-025-26893
660 FNL X 660 FEL
Unit Letter "A", Section 4, T10S, R37E
Lea County, New Mexico

Proof of Notify
Surface Owner

State of New Mexico
State Land Office
PO Box 1148
Santa Fe, NM
87504-1148

Mineral Owner

State of New Mexico
State Land Office
PO Box 1148
Santa Fe, NM
87504-1148

Surface Lessee

MICHAEL HARTON
PO BOX 415
TATUM, NM U.S.A.
88267

Legal Notice

Mar Oil and Gas Corporation, PO Box 5155, Santa Fe, New Mexico 87502 has filed form C-108 (Application for Authorization to Inject) with the New Mexico Oil Conservation Division seeking administrative approval for the conversion of the Sawyer 4 State # 2, API #30-025-26893, 660 FNL X 660 FEL, Unit Letter "A", Section 4, T10S, R37E Lea County, New Mexico from a Sawyer San Andres, West oil well to a lease salt water disposal well. The disposal interval would be the San Andres formation through perforations 4974-5038ft. Disposal fluid would produced water from surrounding San Andres oil wells. Anticipated disposal rate of 250 BWPD with a maximum disposal rate of 700 BWPD. Anticipated disposal pressure 250 psi with a maximum disposal pressure of 990 psi.

All interested parties opposing the aforementioned must file objections with the New Mexico Oil Conservation Division, 1220 South St. Francis Drive, Santa Fe, New Mexico 87505 within 15 days. Additional information can be obtained by contacting Billy Prichard 505-390-9100

Mar Oil and Gas Corporation
C-108(Application for Authorization to Inject)
Sawyer 4 State # 2
API # 30-025-26893
660 FNL X 660 FEL
Unit Letter "A", Section 4, T10S, R37E
Lea County, New Mexico

Proof of Notify
Surface Owner

State of New Mexico
State Land Office
PO Box 1148
Santa Fe, NM
87504-1148

Mineral Owner

State of New Mexico
State Land Office
PO Box 1148
Santa Fe, NM
87504-1148

Surface Lessee

MICHAEL HARTON
PO BOX 415
TATUM, NM U.S.A.
88267

U.S. Postal Service[™]
CERTIFIED MAIL[™] RECEIPT
(Domestic Mail Only; No Insurance Coverage Provided)

For delivery information visit our website at www.usps.com

SANTA FE NM 87504-1148

OFFICIAL USE	
Postage	\$ 1.48
Certified Fee	\$2.65
Return Receipt Fee (Endorsement Required)	\$2.15
Restricted Delivery Fee (Endorsement Required)	\$0.00
Total Postage & Fees	\$ 6.28

0488
01
Postmark Here
06/18/2007

Sent To:
Street, Apt. or PO Box
City, State

New Mexico State Land Office
PO Box 1148
Santa Fe, NM 87504-1148

PS Form 3800, August 2006 See Reverse for Instructions

U.S. Postal Service[™]
CERTIFIED MAIL[™] RECEIPT
(Domestic Mail Only; No Insurance Coverage Provided)

For delivery information visit our website at www.usps.com

TATUM NM 88267

OFFICIAL USE	
Postage	\$ 1.48
Certified Fee	\$2.65
Return Receipt Fee (Endorsement Required)	\$2.15
Restricted Delivery Fee (Endorsement Required)	\$0.00
Total Postage & Fees	\$ 6.28

0488
01
Postmark Here
06/18/2007

Sent To:
Street, Apt. or PO Box
City, State

Michael Harton
PO Box 415
Tatum, New Mexico
88267

PS Form 3800, August 2006 See Reverse for Instructions

OIL CONSERVATION DIVISION
P. O. BOX 2088
SANTA FE, NEW MEXICO 87501

WELL COMPLETION OR RECOMPLETION REPORT AND LOG

NO. OF COPIES RECEIVED	
DISTRIBUTION	
SANTA FE	
FILE	
U.S.G.S.	
LAND OFFICE	
OPERATOR	

5a. Indicate Type of Lease
State ☒ Free ☐

5. State Oil & Gas Lease No.

L-1080

7. Lease Agreement Name

8. Form or Lease Name

Sawyer State 44

9. Well No.

2

10. Field and Pool, or Wildcat

West Sawyer/San Andres

12. County

Lea

TYPE OF WELL

OIL WELL ☒

GAS WELL ☐

DRY ☐

OTHER

TYPE OF COMPLETION

NEW WELL ☒

WORK OVER ☐

REPERM ☐

PLUG BACK ☐

DIFF. RESER. ☐

OTHER

Name of Operator:

Coastal Oil & Gas Corp.

Address of Operator:

P.O. Box 235 Midland, Texas 79702-7473

Location of Well:

LETTER A LOCATED 660 FEET FROM THE North LINE AND 660 FEET FROM

East LIKE OF SEC. 4 TWP. 10-S RCL. 37-E

16. Date Spudded 6-12-81 16. Date T.D. Reached 8-9-81 17. Date Compl. (Ready to Prod.) 9-9-81 18. Elevations (DF, RKB, RT, GR, etc.) 3983' GR 3996' KB 19. Elev. Casinghead 3983'

20. Total Depth 5142' 21. Plug Back T.D. 5058' 22. If Multiple Compl., How Many 23. Interval Drilled By Rotary Tools Cable Tools X

Producing Interval(s), of this completion - Top, Bottom, Name

4974' - 5010' Slaughter San Andres

Type Electric and Other Logs Run

CBL - GR - NL

25. Was Directional Survey Made

No

27. Was Well Cored

No

CASING RECORD (Report all strings set in well)

CASING SIZE	WEIGHT LB./FT.	DEPTH SET	HOLE SIZE	CEMENTING RECORD	AMOUNT PULLED
8-5/8"	24#	456'	12 1/4"	325 sx CLs. "C"	--
5-1/2"	15.5#	5116'	7 7/8"	2050 sx CLs C	--

LINER RECORD

SIZE	TOP	BOTTOM	SACKS CEMENT	SCREEN	SIZE	DEPTH SET	PACKER SET
------	-----	--------	--------------	--------	------	-----------	------------

Perforation Record (Interval, size and number)

4974' - 5010' 15 PF X (.50" diameter)

32. ACID, SHOT, FRACTURE, CEMENT SQUEEZE, ETC.

DEPTH INTERVAL	AMOUNT AND KIND MATERIAL USED
4974' - 5010'	3780 gal 28% HCL
	3080 gal 15% HCL
	6000 gal 3% HCL

PRODUCTION

First Production 9-10-81		Production Method (Flowing, gas lift, pumping - Size and type pump) Pumping - 1½" rod pump				Well Status (Prod. or Shut-in) Prod.	
Date of Test 9-22-81	Hours Tested 24	Choke Size	Prod'n. Per Test Period →	Oil - Bbl. 18	Gas - MCF 32	Water - Bbl. 147	Gas - Oil Ratio 1778:1
Flow Tubing Press. 30#	Casing Pressure 85#	Calculated 24- Hour Rate	Oil - Bbl. 18	Gas - MCF 32	Water - Bbl. 147	Oil Gravity - API (Conn.) 20.3	
Disposition of Gas (Sale, used for fuel, vented, etc.)						Test Witnessed by	

Disposition of Gas (Sale, used for fuel, vented, etc.)

Sold

Test Witnessed By

C. D. Tate

List of Attachments

Logs/deviation Survey - C-104 - C-103

I hereby certify that the information shown on both sides of this form is true and complete to the best of my knowledge and belief.

SIGNED David J. Campbell

TITLE Sr. Prod. Engr.

DATE 9-24-81

STATE OF NEW MEXICO
ENERGY AND MINERALS DEPARTMENT

NO. OF COPIES RECEIVED	
DISTRIBUTION	
SANTA FE	
FILE	
U.S.G.S.	
LAND OFFICE	
OPERATOR	

OIL CONSERVATION DIVISION
P. O. BOX 2088
SANTA FE, NEW MEXICO 87501

Form C-103
Revised 10-1-78

5a. Indicate Type of Lease State <input checked="" type="checkbox"/> Fee <input type="checkbox"/>
5. State Oil & Gas Lease No. L-1080
7. Unit Agreement Name
8. Farm or Lease Name Sawyer State "4"
9. Well No. 2
10. Field and Pool, or Wildcat West Sawyer/San Andres
12. County Lea

SUNDRY NOTICES AND REPORTS ON WELLS
(DO NOT USE THIS FORM FOR PROPOSALS TO DRILL OR TO DEEPEN OR PLUG BACK TO A DIFFERENT RESERVOIR. USE "APPLICATION FOR PERMIT -" (FORM C-101) FOR SUCH PROPOSALS.)

1. OIL WELL <input checked="" type="checkbox"/> GAS WELL <input type="checkbox"/> OTHER-
2. Name of Operator Coastal Oil & Gas Corp.
3. Address of Operator P.O. Box 235 Midland, Texas 79702
4. Location of Well UNIT LETTER A, 660 FEET FROM THE North LINE AND 660 FEET FROM THE East LINE, SECTION 4 TOWNSHIP 10-S RANGE 37-E NMPM.
15. Elevation (Show whether DF, RT, GR, etc.) 3983' GL 3996' KB

16. Check Appropriate Box To Indicate Nature of Notice, Report or Other Data

NOTICE OF INTENTION TO:		SUBSEQUENT REPORT OF:	
PERFORM REMEDIAL WORK <input type="checkbox"/>	PLUG AND ABANDON <input type="checkbox"/>	REMEDIAL WORK <input type="checkbox"/>	ALTERING CASING <input type="checkbox"/>
TEMPORARILY ABANDON <input type="checkbox"/>	CHANGE PLANS <input type="checkbox"/>	COMMENCE DRILLING OPNS. <input type="checkbox"/>	PLUG AND ABANDONMENT <input type="checkbox"/>
PULL OR ALTER CASING <input type="checkbox"/>	OTHER <input type="checkbox"/>	CASING TEST AND CEMENT JOBS <input type="checkbox"/>	OTHER Perforating & Acidizing <input checked="" type="checkbox"/>

17. Describe Proposed or Completed Operations (Clearly state all pertinent details, and give pertinent dates, including estimated date of starting any proposed work) SEE RULE 1103.

8-25-81 RU completion Unit GIH to - DV Tool @ 2319' - drill out and test to 1500# - ok

8-26-81 Run CBL -GR-NL 5080' to 3000' top of cement @ 3200'.
Perf 4974' to 5010' w 4" csg. gun.
Run pkr on tbgs. to 4930'

8-27-81 Acidized w 12,800 gal acid & salt. Inj rate average 5 BPM @ 3100 PSI - swabbed well

8-28-81 Swabbed 158 BF

8-29-81 WO Pumping Unit

18. I hereby certify that the information above is true and complete to the best of my knowledge and belief.

SIGNED David M Campbell TITLE Sr. Prod. Engineer DATE 9-29-81

APPROVED BY Jerry Sexton TITLE Dist. 1, Supv. DATE OCT 2 1981

CONDITIONS OF APPROVAL, IF ANY:

STATE OF NEW MEXICO
ENERGY AND MINERALS DEPARTMENT

NO. OF COPIES RECEIVED	
DISTRIBUTION	
SANTA FE	
FILE	
U.S.G.S.	
LAND OFFICE	
OPERATOR	

OIL CONSERVATION DIVISION
P. O. BOX 2088
SANTA FE, NEW MEXICO 87501

Form C-103
Revised 10-1-7

5a. Indicate Type of Lease
State ☒ Fee ☐
5. State Oil & Gas Lease No.
L-1080

SUNDRY NOTICES AND REPORTS ON WELLS
(DO NOT USE THIS FORM FOR PROPOSALS TO DRILL OR TO DEEPEN OR PLUG BACK TO A DIFFERENT RESERVOIR.
USE "APPLICATION FOR PERMIT -" (FORM C-101) FOR SUCH PROPOSALS.)

1. OIL WELL <input checked="" type="checkbox"/> GAS WELL <input type="checkbox"/> OTHER <input type="checkbox"/>	7. Unit Agreement Name
2. Name of Operator Coastal Oil & Gas Corp.	8. Farm or Lease Name Sawyer State "4"
3. Address of Operator P.O. Box 235 Midland, Texas 79702-7473	9. Well No. 2
4. Location of Well UNIT LETTER A, 660 FEET FROM THE North LINE AND 660 FEET FROM THE East LINE, SECTION 4 TOWNSHIP 10-S RANGE 37-E NMPM.	10. Field and Pool, or Wildcat West Sawyer - San And
15. Elevation (Show whether DF, RT, GR, etc.) 3983' GL 3996' KB	12. County Lea

16. Check Appropriate Box To Indicate Nature of Notice, Report or Other Data

NOTICE OF INTENTION TO:		SUBSEQUENT REPORT OF:	
PERFORM REMEDIAL WORK <input type="checkbox"/>	PLUG AND ABANDON <input type="checkbox"/>	REMEDIAL WORK <input type="checkbox"/>	ALTERING CASING <input type="checkbox"/>
TEMPORARILY ABANDON <input type="checkbox"/>	CHANGE PLANS <input type="checkbox"/>	COMMENCE DRILLING OPNS. <input type="checkbox"/>	PLUG AND ABANDONMENT <input type="checkbox"/>
PULL OR ALTER CASING <input type="checkbox"/>	OTHER <input type="checkbox"/>	CASING TEST AND CEMENT JOBS <input type="checkbox"/>	OTHER Set 5 1/2" casing <input checked="" type="checkbox"/>

17. Describe Proposed or Completed Operations (Clearly state all pertinent details, and give pertinent dates, including estimated date of starting any proposed work) SEE RULE 1103.

8-11-81 TD 5142' - layed down drill pipe and prepared to run 5 1/2" prod. casing.
P.U. & Run 127 jnts to 5116'. Set w 2050 sx. Class "C" in 2 stages, circ. 25 sx.

8-12-81 P.D. @ 1:00 A.M. 8-12-81
Tested to 1500 psi; held ok
WOC 288 hrs.

18. I hereby certify that the information above is true and complete to the best of my knowledge and belief.

SIGNED David H Campbell TITLE Sr. Prod. Engineer DATE 9-24-81

APPROVED BY Jerry Sexton TITLE Dist 1, Supv. DATE 9-24-81

CONDITIONS OF APPROVAL, IF ANY

COUNTY LEA FIELD Sawyer, W. STATE NM
 OPR COASTAL OIL & GAS CORP. API 30-025-26893
 NO 2 LEASE Sawyer State MAP
Sec 4, T10S, R37E CO-ORD
660 FNL, 660 FEL of Sec 10-4-31 NM
11 mi SE/Cross Roads SPD 6-12-81 CMP 2-22-81

CSC	WELL CLASS: INITD FIN DO LSE CODE			
	FORMATION	DATUM	FORMATION	DATUM
	TD 5142		PBD 5058	

IP (San Andres) Perfs 4974-5010 P 18 BOPD + 147 BW. Pot based on 24 hr test. GOR 1777; gty (NR)

CONTR BBL #2 OPRSELEV 3982 GL sub-s

F.R. 7-6-81
 PD 5100 RT (San Andres)
 7-7-81 TD 4977; SDR
 Pulled Derrick
 7-21-81 TD 4977; fsg
 7-28-81 TD 4977; fsg
 8-11-81 TD 5142; Prep Log
 Recd Fish
 8-18-81 TD 5142; WOCU
 9-1-81 TD 5142; PBD 5058; Swbg Ld
 Perf (San Andres) 4974-5010 (overall)
 Acid (4974-5010) 12,000 gals
 9-7-81 TD 5142; PBD 5058; WOPU
 9-14-81 TD 5142; PBD 5058; TOP
 9-24-81 ID 5192; PBD 5058; WOSP
 Spd 18 BO + 147 BW in 24 hrs (4974-5010)
 10-19-81 TD 5142; PBD 5058; Complete
 LOGS RUN: NEUT, FRXL, DEML, DILL
 Rig Released 8-13-81
 10-24-81 COMPLETION ISSUED 10-4-31 NM
 IC 30-025-70335-81

District I
1625 N. French Dr., Hobbs, NM 88240
District II
1301 W. Grand Avenue, Artesia, NM 88210
District III
1000 Rio Brazos Road, Aztec, NM 87410
District IV
1220 S. St. Francis Dr., Santa Fe, NM 87505

State of New Mexico
Energy Minerals and Natural Resources

Form C-104A
March 19, 2001

Oil Conservation Division
1220 South St. Francis Dr.
Santa Fe, NM 87505

Submit 1 copy of the final affected wells
list along with 1 copy of this form per
number of wells on that list to appropriate
District Office

Change of Operator

Previous Operator Information:

OGRID: 4378
Name: Chi Operating
Address: P.O. Box 51202
Address: _____
City, State, Zip: Midland, TX 79710

New Operator Information:

Effective Date: January 31, 2003
New Ogrid: 151228
New Name: MAR Oil & Gas Corp.
Address: P.O. Box 5155
Address: _____
City, State, Zip: Santa Fe, NM 87502

I hereby certify that the rules of the Oil Conservation Division have been complied with and that the information on this form and the attached list of wells is true and complete to the best of my knowledge and belief.

New Operator

Signature: _____

Printed name: Leon Romero

Title: PRESIDENT

Date: 1/31/03 Phone: 505-989-5155

Previous operator complete below:

Previous
Operator: Chi Operating
Previous
OGRID: 4378
Signature: Dennis Kruse
Printed Name: Dennis Kruse

NMOCD Approval

Signature: _____

Printed

Name: PAUL F. KAUTE

District: _____

PETROLEUM ENGINEER

Date: _____

JUN 16 2003

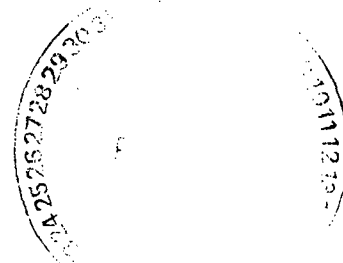
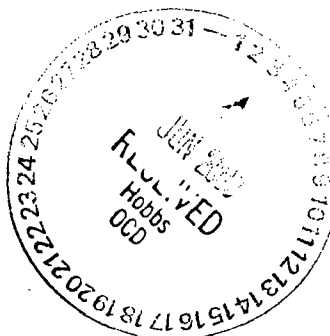

Jones, William V., EMNRD

From: Jones, William V., EMNRD
Sent: Friday, June 29, 2007 12:50 PM
To: 'Billy Prichard'
Cc: Ezeanyim, Richard, EMNRD; Brooks, David K., EMNRD
Subject: SWD Application: Sawyer 4 State #2 API No. 30-025-26893

Hello Billy:

After reviewing this application, the following questions arose:

1) The proposed injection is into the San Andres oil production area which is most likely spaced on 40 acres per proration unit. For the undrilled proration units in the 1/2 mile AoR of the proposed well, who has the rights to the San Andres? Specifically who is the lessee of Section 3, Units C, and E and Section 4, Units G, H, and I? Have these lessees been notified of this application?

2) This would be the second disposal well in this area into the San Andres (Slaughter member). Please talk about the first disposal well (Pearl Marr #1, directly north in Section 33). Is it at capacity? what pressure and rate does it operate at? What effect on surrounding producing wells has this well caused? did it stimulate production or did it harm production? Why is another injection well needed? and why was this one picked for conversion? Is there any plans for secondary recovery of the San Andres in this area?

Please let me know about these items

and thanks for the nice application,

William V. Jones PE
New Mexico Oil Conservation Division
1220 South St. Francis
Santa Fe, NM 87505
505-476-3448

6/29/2007

Jones, William V., EMNRD

From: Billy Prichard [shabillron01@warpdriveonline.com]
Sent: Friday, June 29, 2007 3:25 PM
To: Jones, William V., EMNRD
Subject: Re: SWD Application: Sawyer 4 State #2 API No. 30-025-26893

Will, Rights to the SA in UL C and E (3,10S,37E) currently belong to Mar Oil and Gas Corp. UL G,H and I (4,10S,37E) are currently owned by the state of NM and according to the SLO web page are currently unleased..A copy of this permit application went to the SLO. BEP

Jones, William V., EMNRD wrote:

> Hello Billy:
> After reviewing this application, the following questions arose:
>
> 1) The proposed injection is into the San Andres oil production
> area which is most likely spaced on 40 acres per proration unit. For
> the undrilled proration units in the 1/2 mile AoR of the proposed
> well, who has the rights to the San Andres?
> Specifically who is the lessee of Section 3, Units C, and E and
> Section 4, Units G, H, and I ?
> Have these lessees been notified of this application?
>
> 2) This would be the second disposal well in this area into the San
> Andres (Slaughter member). Please talk about the first disposal well
> (Pearl Marr #1, directly north in Section 33). Is it at capacity?
> what pressure and rate does it operate at? What effect on
> surrounding producing wells has this well caused? did it stimulate
> production or did it harm production? Why is another injection well
> needed? and why was this one picked for conversion? Is there any
> plans for secondary recovery of the San Andres in this area?
>
> Please let me know about these items
>
> and thanks for the nice application,
>
>
> William V. Jones PE
> New Mexico Oil Conservation Division
> 1220 South St. Francis
> Santa Fe, NM 87505
> 505-476-3448
>
>
>
> Confidentiality Notice: This e-mail, including all attachments is for
> the sole use of the intended recipient(s) and may contain confidential
> and privileged information. Any unauthorized review, use, disclosure
> or distribution is prohibited unless specifically provided under the
> New Mexico Inspection of Public Records Act. If you are not the
> intended recipient, please contact the sender and destroy all copies
> of this message. -- This email has been scanned by the Sybari -
> Antigen Email System.
>
>

This inbound email has been scanned by the MessageLabs Email Security System.

Jones, William V., EMNRD

From: Billy Prichard [shabillron01@warpdriveonline.com]
Sent: Friday, June 29, 2007 2:58 PM
To: Jones, William V., EMNRD
Subject: Re: SWD Application: Sawyer 4 State #2 API No. 30-025-26893

Will, Do you need this on paper? The Pearl Marr Disposal has failed an MIT. It is currently SI..As soon as we finish plugging wells, plans are to repair the Pearl Marr #1. The Pearl Marr #1 has had casing problems in the past and may need major repairs or plugged, gut feel is that the well will need plugged. The Pearl Marr takes the water on a vacuum around 300 barrels per day, if we can keep our producers up and running.. We wanted a disposal well for a back up..We are currently hauling water...The Sawyer 4 State #2 was chosen due to extremely low reserves and the well construction. There are all ways plans for secondary recovery at some point in the future, long ways off..Majority of wells in the Sawyer field have 4 1/2 casing with minimal cement jobs. There a lot of casing problems..Spent right at \$1000000 last year squeezing and drilling with marginal success. The area would need unitized for secondary recovery, with a high percentage of different private ownership, unitization would be a pain in the #%\$@^&. We have discussed this with petroleum land man..I will put all this on paper and send a copy for the application as well as answer your other questions.

BEP

> After reviewing this application, the following questions arose:

>

> 1) The proposed injection is into the San Andres oil production
> area which is most likely spaced on 40 acres per proration unit. For
> the undrilled proration units in the 1/2 mile AoR of the proposed
> well, who has the rights to the San Andres?
> Specifically who is the lessee of Section 3, Units C, and E and
> Section 4, Units G, H, and I ?
> Have these lessees been notified of this application?

>

> 2) This would be the second disposal well in this area into the San
> Andres (Slaughter member). Please talk about the first disposal well
> (Pearl Marr #1, directly north in Section 33). Is it at capacity?
> what pressure and rate does it operate at? What effect on
> surrounding producing wells has this well caused? did it stimulate
> production or did it harm production? Why is another injection well
> needed? and why was this one picked for conversion? Is there any
> plans for secondary recovery of the San Andres in this area?

>

> Please let me know about these items

>

> and thanks for the nice application,

>

>

> William V. Jones PE
> New Mexico Oil Conservation Division
> 1220 South St. Francis
> Santa Fe, NM 87505
> 505-476-3448

>

>

>

> Confidentiality Notice: This e-mail, including all attachments is for
> the sole use of the intended recipient(s) and may contain confidential
> and privileged information. Any unauthorized review, use, disclosure
> or distribution is prohibited unless specifically provided under the
> New Mexico Inspection of Public Records Act. If you are not the
> intended recipient, please contact the sender and destroy all copies
> of this message. -- This email has been scanned by the Sybari -
> Antigen Email System.

>

Injection Permit Checklist 2/8/07

SWD Order Number 1086 Dates: Division Approved _____ District Approved _____

Well Name/Num: SAWYER 4 STATE #2 Date Spudded: 6/12/81

API Num: (30-) 025-28843 County: LEA

Footages 660 FNL 660 FEL Sec 4 Tsp 10S Rge 37E

Operator Name: MAR OIL and Gas CORP. Contact BILL Y E. PRICHARD

Operator Address: P.O. BOX 5155, SANTA FE NM 87502

Current Status of Well: Depleted SA Planned Work: Convert EQPT Inj. Tubing Size: 2 7/8

	Hole/Pipe Sizes	Depths	Cement	Top/Method
Surface	12 1/4 8 5/8	456	325 "C"	CIRC
Intermediate				
Production	7 7/8 5 1/2	5116	2000 SX	TOPS @ 3200' and CIRC
Last DV Tool		DV @ 2319'		
Open Hole/Liner				
Plug Back Depth				

Diagrams Included (Y/N): Before Conversion ☒ After Conversion ☒

Checks (Y/N): Well File Reviewed ☒ ELogs in Imaging ☒

Intervals:	Depths	Formation	Producing (Yes/No)
Salt/Potash	2271 - 2950		
Capitan Reef			
Cliff House, Etc.			
Formation Above	3645	Queen	
Top Inj Interval	4974	SA (Slaughter)	
Bottom Inj Interval	5038	SA	
Formation Below	5100'	GLORIETA	

995 PSI Max. WHIP

NO Open Hole (Y/N)

NO Deviated Hole (Y/N)

Fresh Water: Depths: 0 - Top of Res Wells (Y/N) NO Analysis Included (Y/N): _____ Affirmative Statement ☒

Salt Water Analysis: Injection Zone (Y/N/NA) SA Disp Waters (Y/N/NA) _____ Types: SA

Notice: Newspaper (Y/N) ☒ Surface Owner SLO Mineral Owner(s) SLO

Other Affected Parties: MIKE Horton Surface Lessee

AOR/Repairs: NumActiveWells 0 Repairs? NO Producing in Injection Interval in AOR Yes

AOR Num of P&A Wells 0 Repairs? _____ Diagrams Included? _____ RBDMS Updated (Y/N) ☒

Well Table Adequate (Y/N) Yes AOR STRs: Sec _____ Tsp _____ Rge _____ UIC Form Completed (Y/N) ☒

New AOR Table Filename _____ Sec _____ Tsp _____ Rge _____ This Form completed 6/29/07

Conditions of Approval: Sec _____ Tsp _____ Rge _____ Data Request Sent 6/29/07

What has other wells done w/ Pearlman SWP#1 inj?
SLO AOR check!

AOR Required Work: _____

Required Work to this Well: _____