

Tenneco Oil Exploration and Production

A Tenneco Company

Western Rocky Mountain Division

P.O. Box 3249
Englewood, Colorado 80155
(303) 740-4800

Certified Mail
Return Receipt Requested

New Mexico Oil Conservation Division
P.O. Box 2088
Santa Fe, NM 87501
Attn: Joe D. Ramey

New Mexico Oil Conservation Division
1000 Rio Brazos Road
Aztec, NM 87401
Attn: Frank Chavez

Delivery Address:
6061 South Willow Drive
Englewood, Colorado

February 23, 1982

*NSL-1496
Basin Dakota
Rule 3 R1670
3-17-82*

Re: Application for Unorthodox Location
Tenneco Hughes 2E, 1735' FSL
2000' FEL, Sec. 21, T29N, R8W
San Juan County, NM

Gentlemen:

Attached in duplicate (to each office) are a well location plat (C-102) with a sketch of the surrounding conditions and an ownership plat for the above referenced well.

Due to topographic conditions and the proximity of other wells, this location was placed where it does not conform to State spacing requirements.

A copy of this application is being submitted to all offset operators by certified mail with a request that they furnish your Santa Fe office with a waiver of objection.

Pursuant to the authority of Rule 104-F we respectfully request your approval of an exemption to the standard well location requirements.

Yours very truly,

TENNECO OIL COMPANY

Ken Russell
Ken Russell
Sr. Production Analyst

RECEIVED
FEB 25 1982
NEW MEXICO OIL CONSERVATION DIVISION
SANTA FE
KR/jt
Enclosures

W A I V E R

_____ hereby waives objection to Tenneco Oil Company's application for unorthodox location for their Hughes 2E proposed above.

BY: _____

DATE: _____

*Rec'd
3-17-82
3-25-82*

Application for Unorthodox Location
Tenneco Hughes 2E
Offset Operators

Southern Union Exploration Company
P.O. Box 750
208 E. Apache
Farmington, NM 87401

Amoco Production Company
1670 Broadway
Denver, CO 80202

Attn: R. C. Brooke, Jr.

El Paso Natural Gas
P. O. Box 990
Reilly Heights
Farmington, NM 87401

Attn: Carl E. Matthews

D. J. Simmons
c/o A. B. Geren Jr.
100 West 38th Street
P. O. Box 1469
Farmington, NM 87401

OIL CONSERVATION DIVISION

STATE OF NEW MEXICO
ENERGY AND MINERALS DEPARTMENTP. O. BOX 2088
SANTA FE, NEW MEXICO 87501Form C-102
Revised 10-1-78

All distances must be from the outer boundaries of the Section.

Operator TENNECO OIL COMPANY			Lease HUGHES		Well No. 2E
Unit Letter J	Section 21	Township 29N	Range 8W	County San Juan	
Actual Footage Location of Well: 1735 feet from the South line and 2000 feet from the East line					
Ground Level Elev. 6378	Producing Formation Dakota		Pool Basin Dakota		Dedicated Acreage: 320 Acres

1. Outline the acreage dedicated to the subject well by colored pencil or hatchure marks on the plat below.
2. If more than one lease is dedicated to the well, outline each and identify the ownership thereof (both as to working interest and royalty).
3. If more than one lease of different ownership is dedicated to the well, have the interests of all owners been consolidated by communitization, unitization, force-pooling, etc?

☐ Yes ☐ No If answer is "yes," type of consolidation _____

If answer is "no," list the owners and tract descriptions which have actually been consolidated. (Use reverse side of this form if necessary.) _____

No allowable will be assigned to the well until all interests have been consolidated (by communitization, unitization, forced-pooling, or otherwise) or until a non-standard unit, eliminating such interests, has been approved by the Commission.

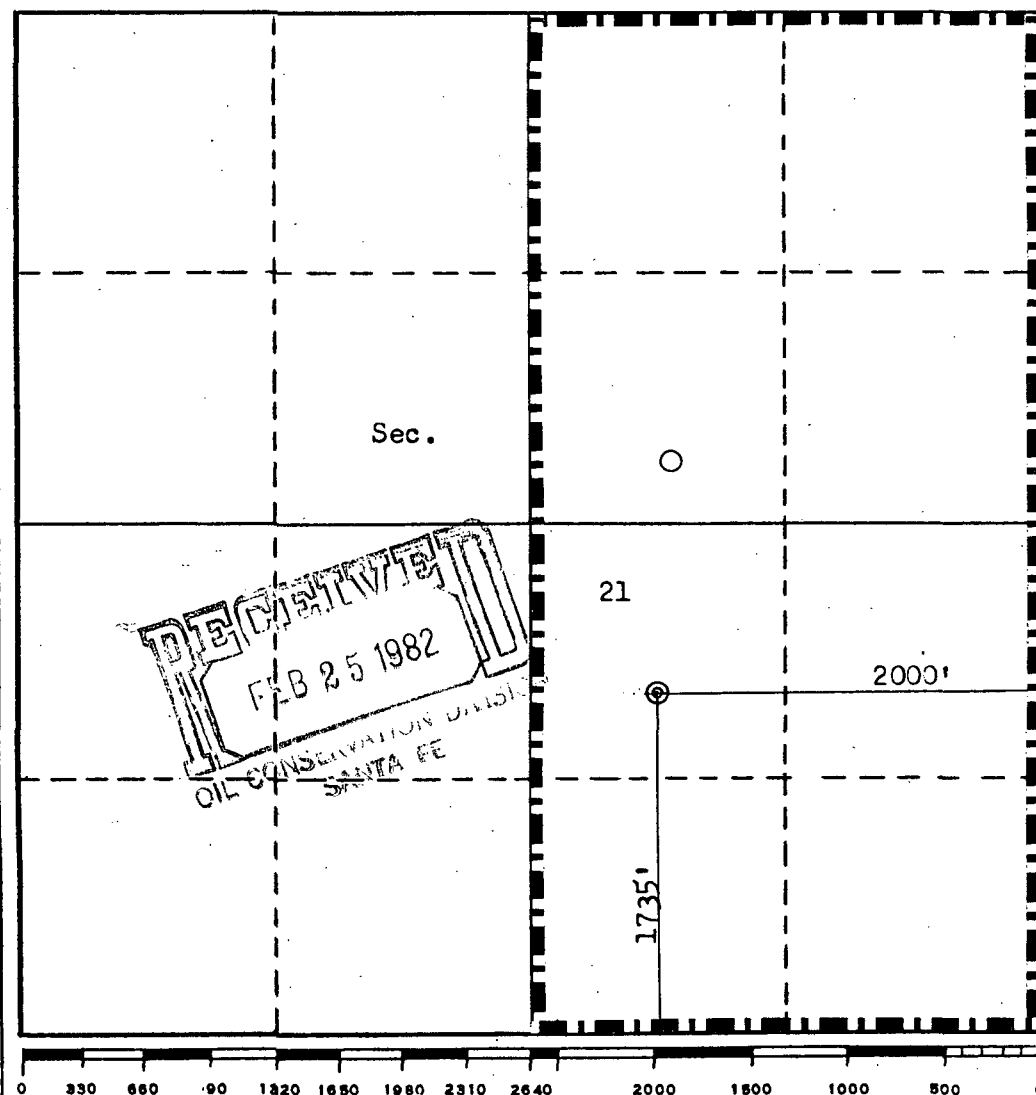

CERTIFICATION

I hereby certify that the information contained herein is true and complete to the best of my knowledge and belief.

Name
Ken Russell
Position
Senior Production Analyst
Company
Tenneco Oil Company
Date
February 22, 1982

I hereby certify that the well location shown on this plat was plotted from field notes of actual surveys made by me or under my supervision, and that the same is true and correct to the best of my knowledge and belief.

Date Surveyed
Feb. 16, 1982
Registered Professional Engineer and/or Land Surveyor
Fred B. Kerr Jr.
Certificate No.
3950

T
29
N

AZTEC

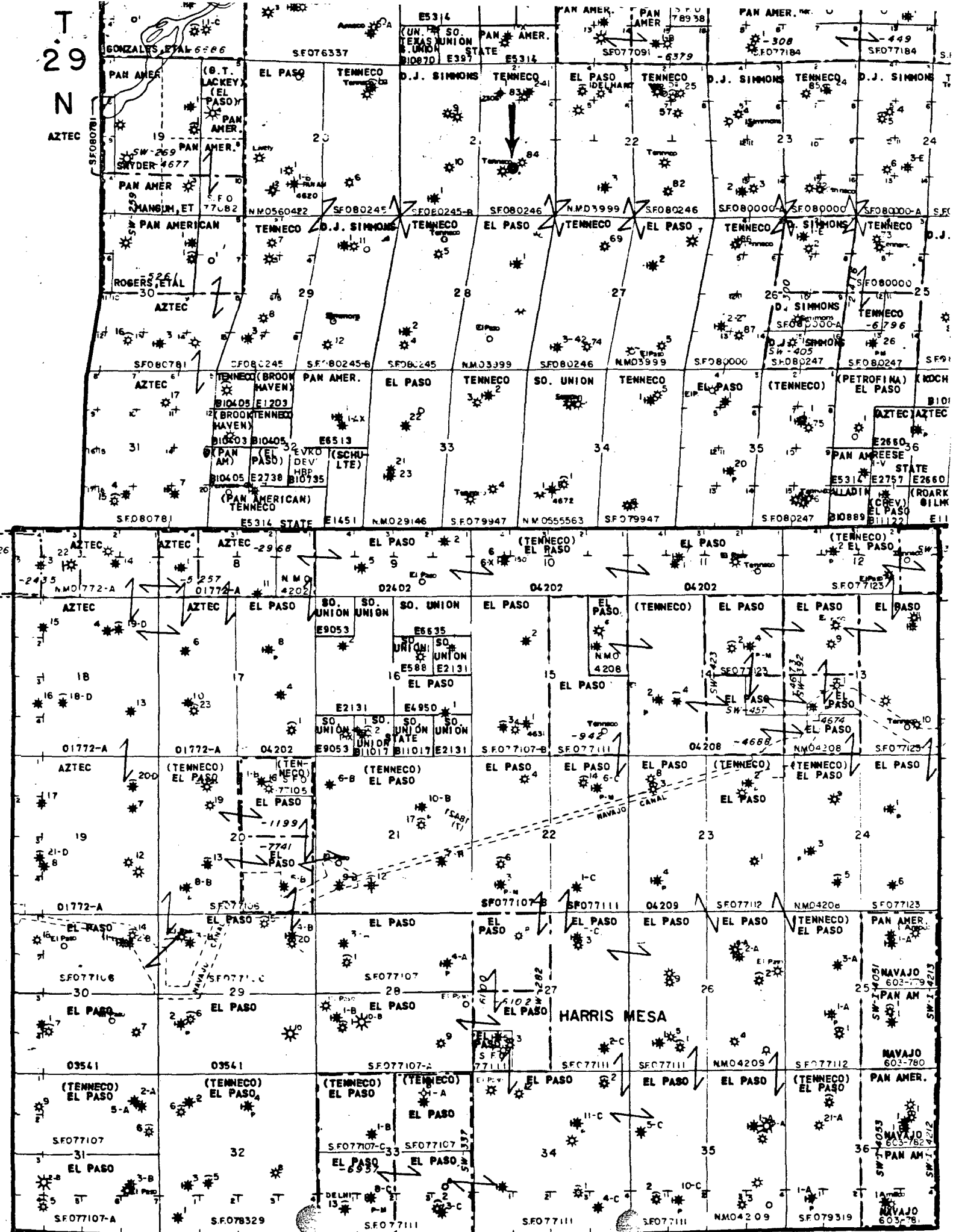



1496

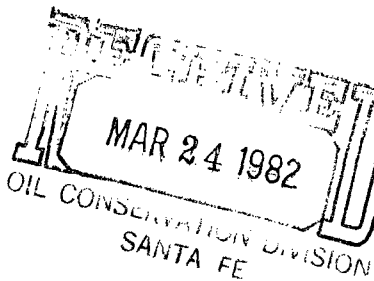

Amoco Production Company

Denver Region
Amoco Building
17th & Broadway
Denver, Colorado 80202
303-830-4040

March 19, 1982

Tenneco Oil and Exploration Company
Western Rocky Mountain Division
P. O. Box 3249
Englewood, CO 80155

File: MRG-27-980.2

Gentlemen:

Application for Unorthodox
Tenneco Hughes #2E
SE/4 Section 21-T29N-R8W
San Juan County, NM

In reference to your request for an unorthodox location on the above-mentioned well, Amoco Production Company does not show any working interest offsetting the well in question and, therefore, feels it is unnecessary to sign the enclosed waiver.

MDK/h1

cc: ~~New Mexico Oil Conservation Division~~
P. O. Box 2088
Sante Fe, NM 87501
Attn: Joe D. Ramey

New Mexico Oil Conservation Division
1000 Rio Brayos Road
Aztec, NM 87401
Attn: Frank Chavey



STATE OF NEW MEXICO
ENERGY AND MINERALS DEPARTMENT
OIL CONSERVATION DIVISION

BRUCE KING
GOVERNOR

LARRY KEHOE
SECRETARY

March 22, 1982

POST OFFICE BOX 2088
STATE LAND OFFICE BUILDING
SANTA FE, NEW MEXICO 87501
(505) 827-2434

Tenneco Oil Exploration and Production
P. O. Box 3249
Englewood, Colorado 80155

Attention: Ken Russell

Re: Non-Standard Location
Hughes Well No. 2E-J
Section 21, T29N, R8W
San Juan County

Dear Mr. Russell:

Our Aztec district office has made an objection to the above described application for unorthodox location submitted by you on February 23, 1982. Therefore, the application cannot be approved administratively.

If you wish this set for hearing, please let me know. Our next two examiner hearings are scheduled for April 14th and 28th.

Sincerely,

Florene Davidson
Staff Specialist



STATE OF NEW MEXICO
ENERGY AND MINERALS DEPARTMENT
OIL CONSERVATION DIVISION
AZTEC DISTRICT OFFICE

1000 RIO BRAZOS ROAD
AZTEC, NEW MEXICO 87410
(505) 334-6178

OIL CONSERVATION DIVISION
BOX 2088
SANTA FE, NEW MEXICO 87501

DATE March 12, 1982

RE: Proposed MC _____
Proposed DHC _____
Proposed NSL ✓ _____
Proposed SWD _____
Proposed WFX _____
Proposed PMX _____

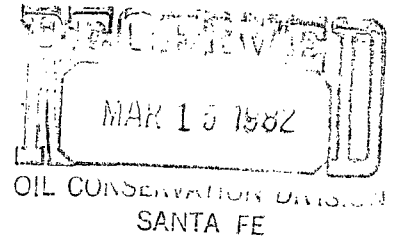

Gentlemen:

I have examined the application dated Feb 25, 1982
for the Tenneco Oil Co. Hughes 2E J-21-29N-8W
Operator Lease and Well No. Unit, S-T-R

and my recommendations are as follows:

Disapprove there is a standard location available, but it is
close to the EPNG #6A. If EPNG would object
to it being that close to their well, then I would
approve it at this NSL applied for.

Yours truly,

Jeff A. Edmister

*Objected
w/ phone
drawn by
RLL
3-24-82*

N
7

1950 —

Regions
NISC

1850 —

EPNG
GA

1750 —

Present NISC

1650 —

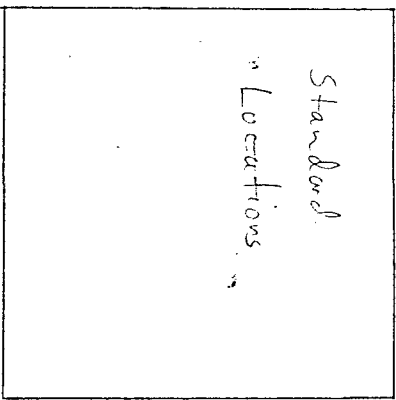

2050

1950

1850

1750

1650

1550

1450

1350

1250

1150

EPNG
21



STATE OF NEW MEXICO
ENERGY AND MINERALS DEPARTMENT
OIL CONSERVATION DIVISION

BRUCE KING
GOVERNOR

LARRY KEHOE
SECRETARY

March 17, 1982

POST OFFICE BOX 2088
STATE LAND OFFICE BUILDING
SANTA FE, NEW MEXICO 87501
(505) 827-2434

Tenneco Oil Exploration and Production
P. O. Box 3249
Englewood, Colorado 80155

Attention: Ken Russell

Administrative Order NSL-1496

Gentlemen:

Reference is made to your application for a non-standard location for your Hughes Well No. 2E to be located 1735 feet from the South line and 2000 feet from the East line of Section 21, Township 29 North, Range 8 West, NMPM, Basin-Dakota Pool, San Juan County, New Mexico.

By authority granted me under the provisions of Rule 3 of Order No. R-1670, the above-described unorthodox location is hereby approved.

Sincerely,

JOE D. RAMEY,
Director

JDR/RLS/dr

cc: Oil Conservation Division - Aztec
Oil & Gas Engineering Committee - Hobbs
Minerals Management Service - Farmington

Tenneco Oil Exploration and Production

A Tenneco Company

Western Rocky Mountain Division

P.O. Box 3249
Englewood, Colorado 80155
(303) 740-4800

Certified Mail
Return Receipt Requested

New Mexico Oil Conservation Division
P.O. Box 2088
Santa Fe, NM 87501
Attn: Joe D. Ramey

New Mexico Oil Conservation Division
1000 Rio Brazos Road
Aztec, NM 87401
Attn: Frank Chavez

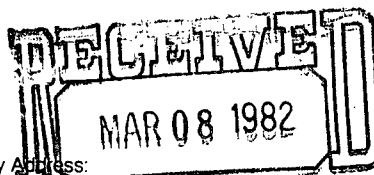

Delivery Address:
6061 South Willow Drive
Englewood, Colorado 80155

NEW MEXICO OIL CONSERVATION DIVISION
SANTA FE
February 23, 1982

1496

Re: Application for Unorthodox Location
Tenneco Hughes 2E, 1735' FSL
2000' FEL, Sec. 21, T29N, R8W
San Juan County, NM

Gentlemen:

Attached in duplicate (to each office) are a well location plat (C-102) with a sketch of the surrounding conditions and an ownership plat for the above referenced well.

Due to topographic conditions and the proximity of other wells, this location was placed where it does not conform to State spacing requirements.

A copy of this application is being submitted to all offset operators by certified mail with a request that they furnish your Santa Fe office with a waiver of objection.

Pursuant to the authority of Rule 104-F we respectfully request your approval of an exemption to the standard well location requirements.

Yours very truly,

TENNECO OIL COMPANY

Ken Russell
Ken Russell
Sr. Production Analyst

KR/jt
Enclosures

El Paso Natural Gas Co.

W A I V E R

hereby waives objection to Tenneco Oil Company's application for unorthodox location for their Hughes 2E proposed above.

BY:

Caul E. Matthews

DATE:

3/3/82