



**Southern Union Exploration Company**  
First International Building  
Dallas, Texas 75270  
(214) 748-8511

325 327  
2881 4481

NSL-1529  
Rule 104 F  
6-5-82

April 20, 1982

New Mexico Oil Conservation Division  
P.O. Box 2088  
Santa Fe, New Mexico 87501  
Attn: Joe D. Ramey

New Mexico Oil Conservation Division  
1000 Rio Brazos Road  
Aztec, New Mexico 87410  
Attn: Frank Chaves

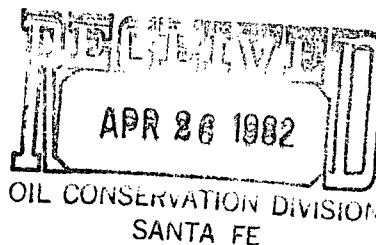

Phone from Burton  
5-17-82  
Mobil letter  
mailed Sat + Monday  
May 10 Bld

Re: Application for Unorthodox  
Location Southern Union Exploration,  
Jicarilla B-#14. 1875' FNL-725' FEL.  
Sec. 25, T26N-R4W, Rio Arriba County,  
New Mexico.

Pictured Giff's & Dakota  
formations

Gentlemen:

Attached in duplicate (to each office) is a well location plot (C 102) with a sketch of the surrounding conditions and an ownership plat for the above referenced well.

Due to topographic conditions and the proximity of other wells, this location was placed where it does not conform to state spacing requirements.

A copy of this application is being submitted to all offset operators with a request that they furnish your Santa Fe office with a waiver of objection.

Pursuant to the authority of Rule 104-F we respectfully request your approval of an exemption to the standard well location requirements.

Yours very truly,

*Lee Burton*

LEE BURTON, Dirg. Supervisor  
Southern Union Exploration  
314 N. Auburn, Drawer "F"  
Farmington, New Mexico 87401

*Consolidated Oil E&S*

WAIVER

hereby waves objection to Southern Union Exploration Company's application for unorthodox location for their Jicarilla B-14 proposed above.

BY *[Signature]*

DATE *4/23/82*

LB/ja

attachment

APPLICATION FOR UNORTHODOX LOCATION  
SOUTHERN UNION, JICARILLA B-14  
OFFSET OPERATORS

Consolidated Oil and Gas  
P.O. Box 2038  
Farmington, New Mexico 87401

Attn: Dale Richardson

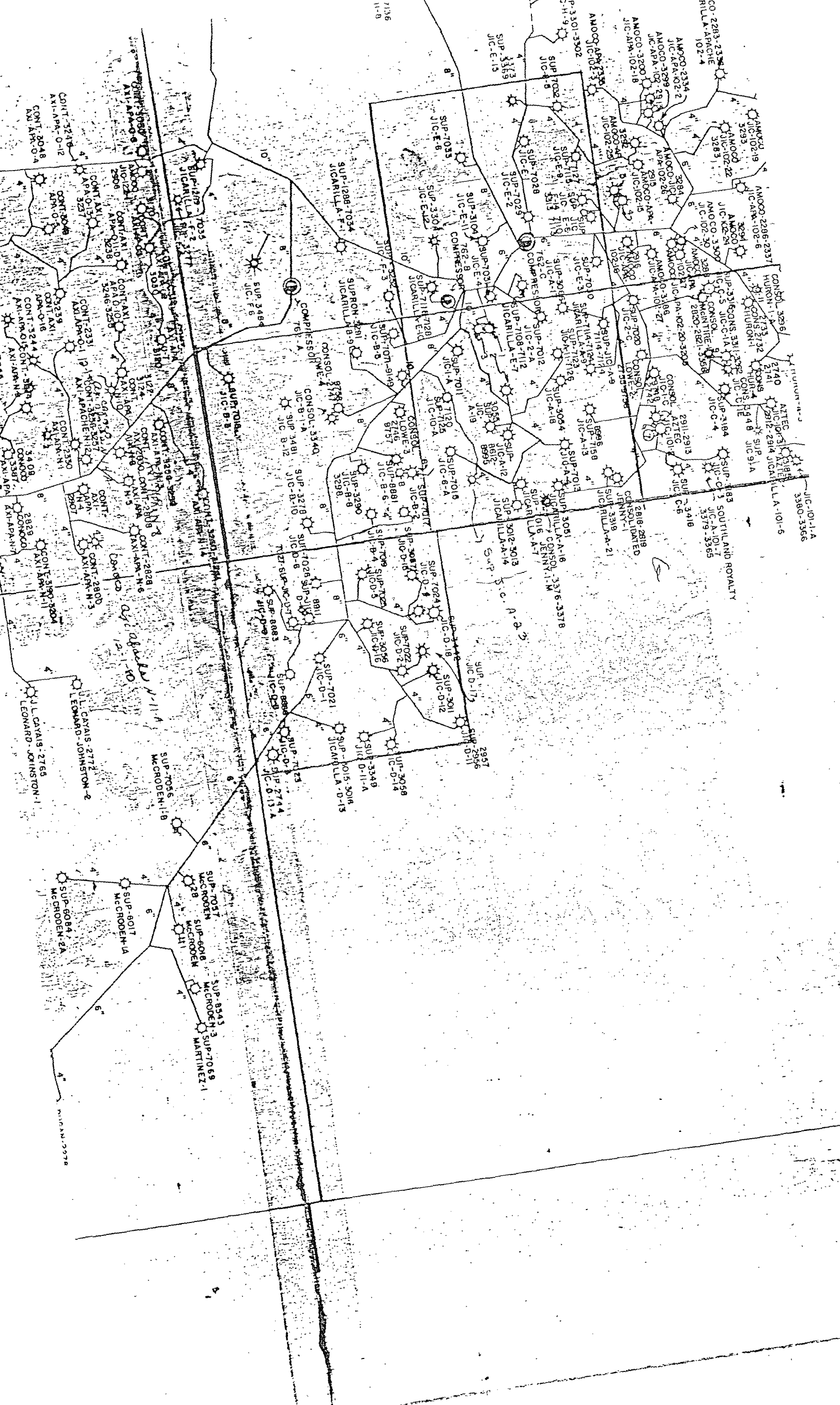

## F. UNORTHODOX LOCATIONS

I. The Division Director shall have authority to grant an exception to the well location requirements of Sections B and C above without notice and hearing when the necessity for such unorthodox location is based upon topographical conditions, the recompletion of a well previously drilled to another horizon, provided said well was drilled at an orthodox location for such original horizon, or to permit the completion of an efficient production and injection pattern within a secondary recovery or pressure maintenance project, provided that any such unorthodox location within such project is no closer than 330 feet to the outer boundary of the lease or the unitized area, nor closer than 10 feet to any quarter-quarter section line or subdivision inner boundary.

II. The Division Director shall have authority to grant an exception to the well location requirements of Rule 104 B.I. (a) and Rule 104 C.II. (a) without notice and hearing when the necessity for such unorthodox location is based upon geologic conditions provided that any such unorthodox location shall be no closer than 660 feet to the nearest side boundary nor closer than 990 feet to the nearest end boundary of the proration unit.

III. Applications for administrative approval of unorthodox locations shall be filed in triplicate and shall be accompanied by plats, showing the ownership of all leases offsetting the proration or spacing unit for which the unorthodox location is sought, and also all wells completed thereon. If the proposed unorthodox location is based upon topography, the plat shall also show and describe the existent topographical conditions. If the proposed unorthodox location is based upon completion of an efficient production and injection pattern, the plat shall also show the project outline identifying all producing and injection wells therein, and the applicant shall further include a statement setting forth the necessity for such location. If the proposed unorthodox location is based upon geology as provided in Paragraph II above, the application shall include appropriate geologic maps, cross-sections, and/or logs, and a discussion of the geologic conditions which result in the necessity for the unorthodox location.

IV. All operators of proration or spacing units offsetting the unit for which the unorthodox location is sought shall be notified of the application by certified or registered mail, and the application shall state that such notification has been given. The Division Director may approve the unorthodox location upon receipt of waivers from all offset operators or if no offset operator has entered an objection to the unorthodox location within 20 days after the Director has received the application.

V. The Division Director may, at his discretion, set any application for administrative approval of an unorthodox location for public hearing.

G. Whenever an exception is granted, the Division may take such action as will offset any advantage which the person securing the exception may obtain over other producers by reason of the unorthodox location.

H. If the drilling tract is within an allocated oil pool or is placed within such allocated pool at any time after completion of the well and the drilling tract consists of less than  $39\frac{1}{2}$  acres or more than  $40\frac{1}{2}$  acres, the top unit allowable for such well shall be increased or decreased in the proportion that the number of acres in the drilling tract bears to 40.

I. If the drilling tract is within an allocated gas pool or is subsequently placed within an allocated gas pool, and the drilling tract consists of less than 158 acres or more than 162 acres in 160-acre pools, or less than 316 acres or more than 324 acres in 320-acre pools, the top allowable for such well shall be decreased or increased in the proportion that the number of acres in the drilling tract bears to a standard unit for the pool.

J. In computing acreage under H and I above, minor fractions of an acre shall not be counted but  $\frac{1}{2}$  acres or more shall count as 1 acre.

K. The provisions of H and I above shall apply only to wells completed after January 1, 1950. Nothing herein contained shall affect in any manner any well completed prior to the effective date of this rule and no adjustments shall be made in the allowable production for any such wells by reason of these rules.

L. In order to prevent waste the Division may, after notice and hearing, fix different spacing requirements and require greater acreage for drilling tracts in any defined oil pool or in any defined gas pool notwithstanding the provisions of B and C above.

M. The Division may approve the pooling or communitization of fractional lots of 20.49 acres or less with another oil proration unit when:

1. The units involved are contiguous;
2. They are part of the same basic lease, carrying the same royalty interest; and
3. The ownership of the units involved is common.

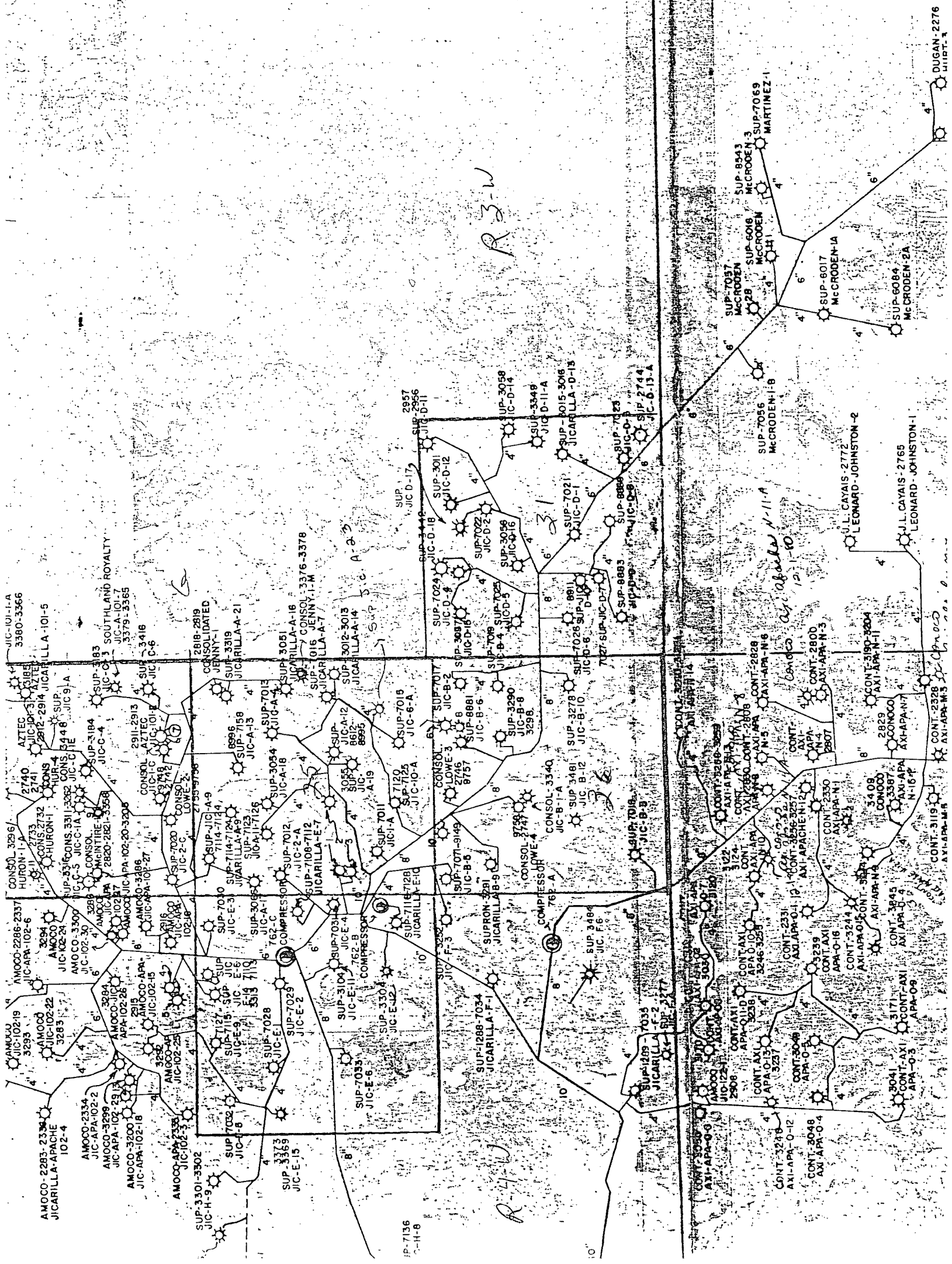

15 29  
SOUTHERN UNION EXPLORATION  
314 N. Auburn, Drawer "F"  
Farmington, New Mexico 87401

May 10, 1982

New Mexico Oil Conservation Division  
P.O. Box 2088  
Santa Fe, New Mexico 87501  
Attn: Joe D. Ramey

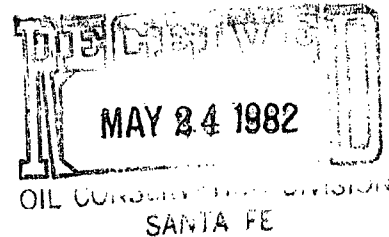

New Mexico Oil Conservation Division  
1000 Rio Brazos Road  
Aztec, New Mexico 87410  
Attn: Frank Chaves

RE: Application for Unorthodox  
location Southern Union Exploration,  
Jicarilla B #14. 1875'FNL & 725"FEL.  
Sec. 25, T26N-R4W, Rio Arriba County,  
New Mexico.

Gentlemen:

Attached in duplicate (to each office) is a well location plot (C 102) with a sketch of the surrounding conditions and an ownership plat for the above referenced well.

Due to topographic conditions and the proximity of other wells, this location was placed where it does not conform to state spacing requirements.

A copy of this application is being submitted to all offset operators with a request that they furnish your Santa Fe office with a waiver of objection.

Pursuant to the authority of Rule 104-F we respectfully request your approval of an exemption to the standard well location requirements.

Yours very truly,

A handwritten signature in cursive script, appearing to read "Lee Burton".

LEE BURTON, Drlg. Supervisor

WAIVER

MOBIL PRODUCING TX & NM INC. hereby waives objection to Southern Union Exploration Company's application for unorthodox location for their Jicarilla B-14 proposed above.

BY

A handwritten signature in cursive script, appearing to read "J. A. Morris".

DATE

5/20/82

LB/ja

attachment

SOUTHERN UNION EXPLORATION  
314 N. Auburn, Drawer "F"  
Farmington, New Mexico 87401

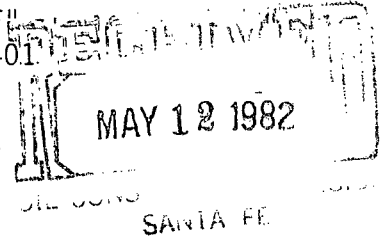

May 10, 1982

State of New Mexico  
Energy and Minerals Department  
Oil Conservation Division

Attn: R.L. Stomets

RE: Application for non standard location.  
Jicarilla B #14, 1875'FNL & 725'FEL  
Sec. 25, T26N-R4W, Rio Arriba County  
New Mexico.

Gentlemen:

Pursuant to your request via letter of 04/29/82 for a plat of offselling operators to the above referenced well.

Please find additional attached area map.

Thanks,

LEE BURTON, Drlg. Supervisor

LB/ja

attachment

All distances must be from the outer boundaries of the Section

MAY 12 1982

Operator: SOUTHERN UNION EXPLORATION COMPANY		Lease: JICARILLA "B"		Well No. 14	
Unit Letter H	Section 25	Township 26N	Range 4W	County Rio Arriba	
Actual Footage Location of Well: 1875 feet from the North line and 725 feet from the East line					
Ground Level Elev. 7119	Producing Formation Pictured Cliffs-Dakota		Pool Tapicito PC Basin Dakota	Dedicated Acreage: 320 Acres	

1. Outline the acreage dedicated to the subject well by colored pencil or hachure marks on the plat below.
2. If more than one lease is dedicated to the well, outline each and identify the ownership thereof (both as to working interest and royalty).
3. If more than one lease of different ownership is dedicated to the well, have the interests of all owners been consolidated by communitization, unitization, force-pooling, etc?

☐ Yes ☐ No If answer is "yes," type of consolidation \_\_\_\_\_

If answer is "no," list the owners and tract descriptions which have actually been consolidated. (Use reverse side of this form if necessary.) \_\_\_\_\_

No allowable will be assigned to the well until all interests have been consolidated (by communitization, unitization, forced-pooling, or otherwise) or until a non-standard unit, eliminating such interests, has been approved by the Commission.

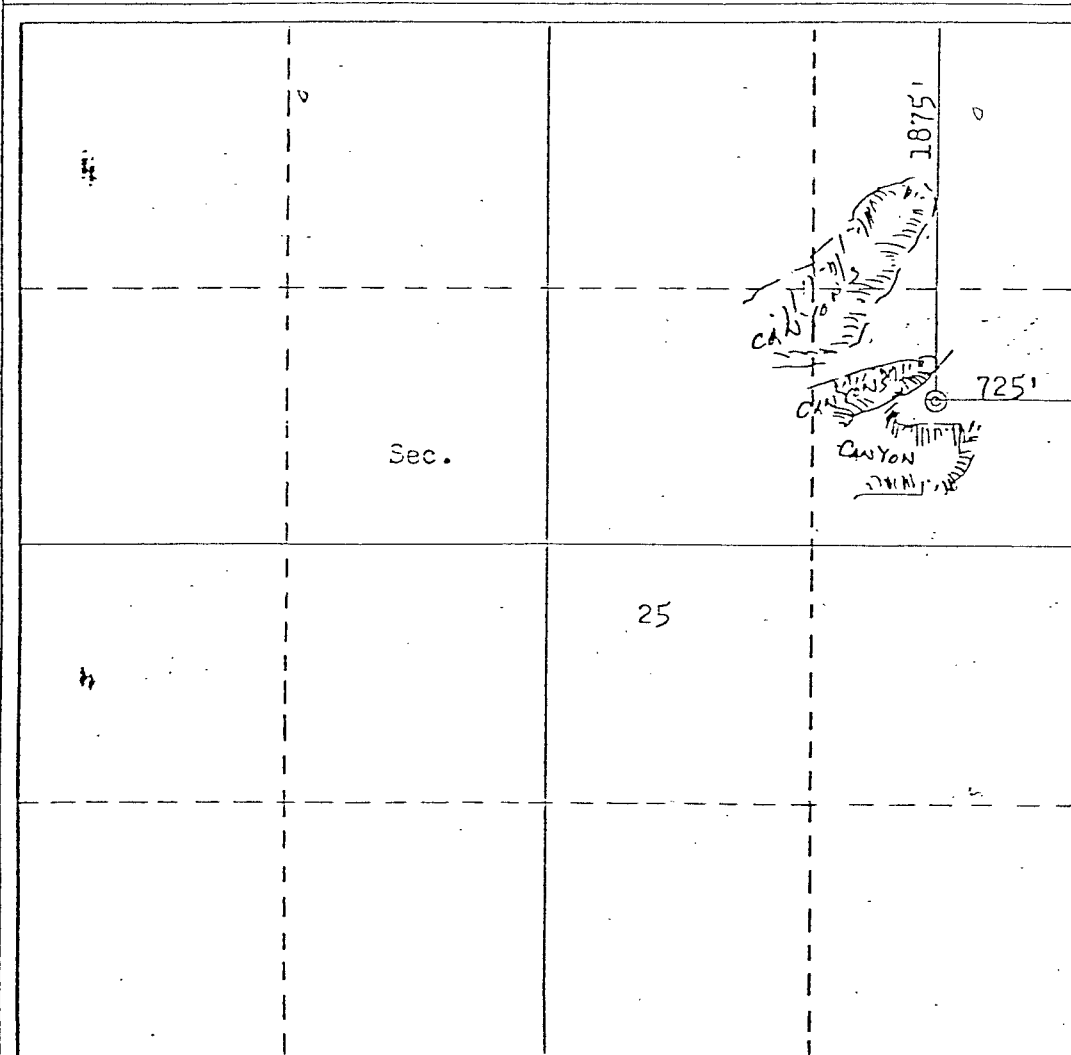

## CERTIFICATION

I hereby certify that the information contained herein is true and complete to the best of my knowledge and belief.

Name: Michael L. Davis  
Position: Division Manager  
Company: Southern Union Expl.  
Date: April 14, 1982

I hereby certify that the well location shown on this plat was plotted from field notes of actual surveys made by me or under my supervision, and that the same is true and correct to the best of my knowledge and belief.

Date Surveyed: April 14, 1982  
Registered Professional Engineer and/or Land Surveyor:  
Fred B. Kerr Jr.  
Certificate No.: 3950

0 250 500 750 1000 1250 1500 1750 2000 2250 2500 2750 3000



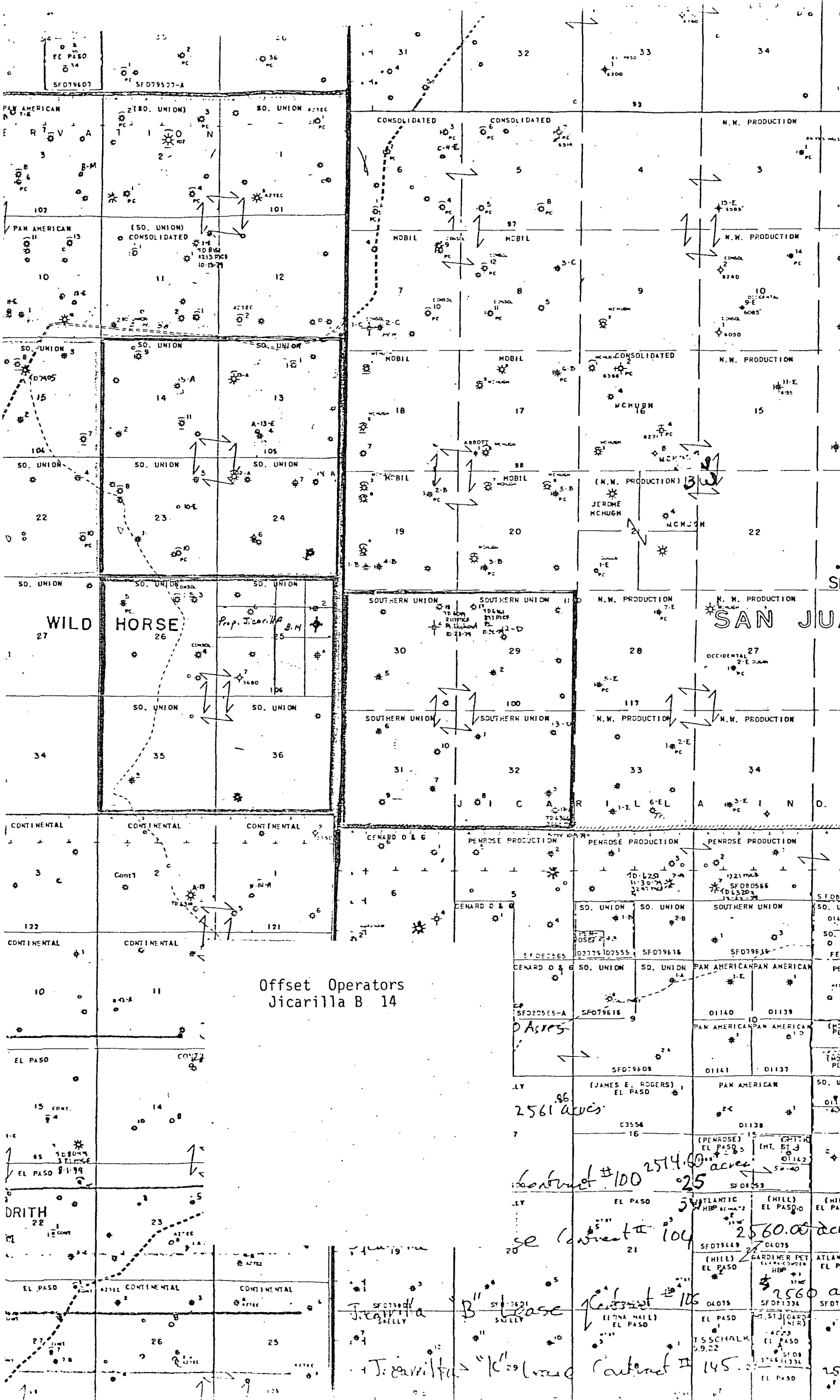

Offset Operators  
Jicarilla B 14

2561 acres

Contract #100 2514.00 acres

Contract #104 2560.00 acres

Contract #106 2560 a

Contract #145 2561 acres

Jicarrilla

B Lease

Jicarrilla

K

Continent

145

## Profile for

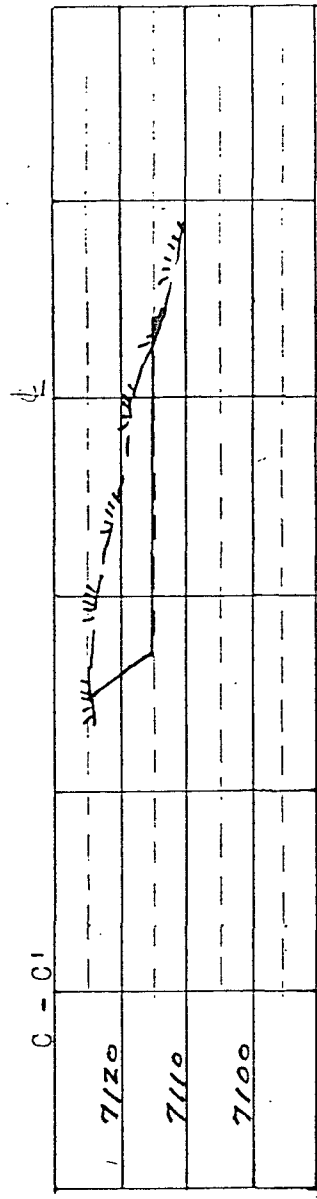
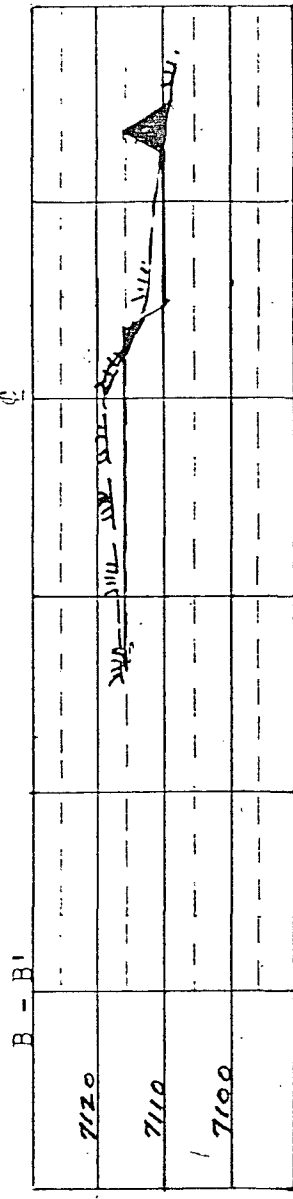
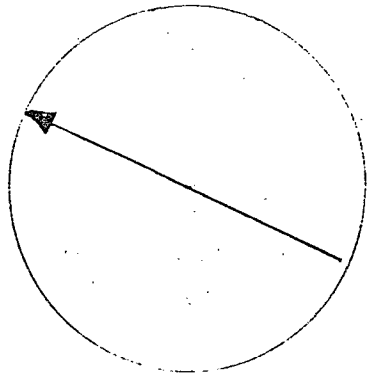

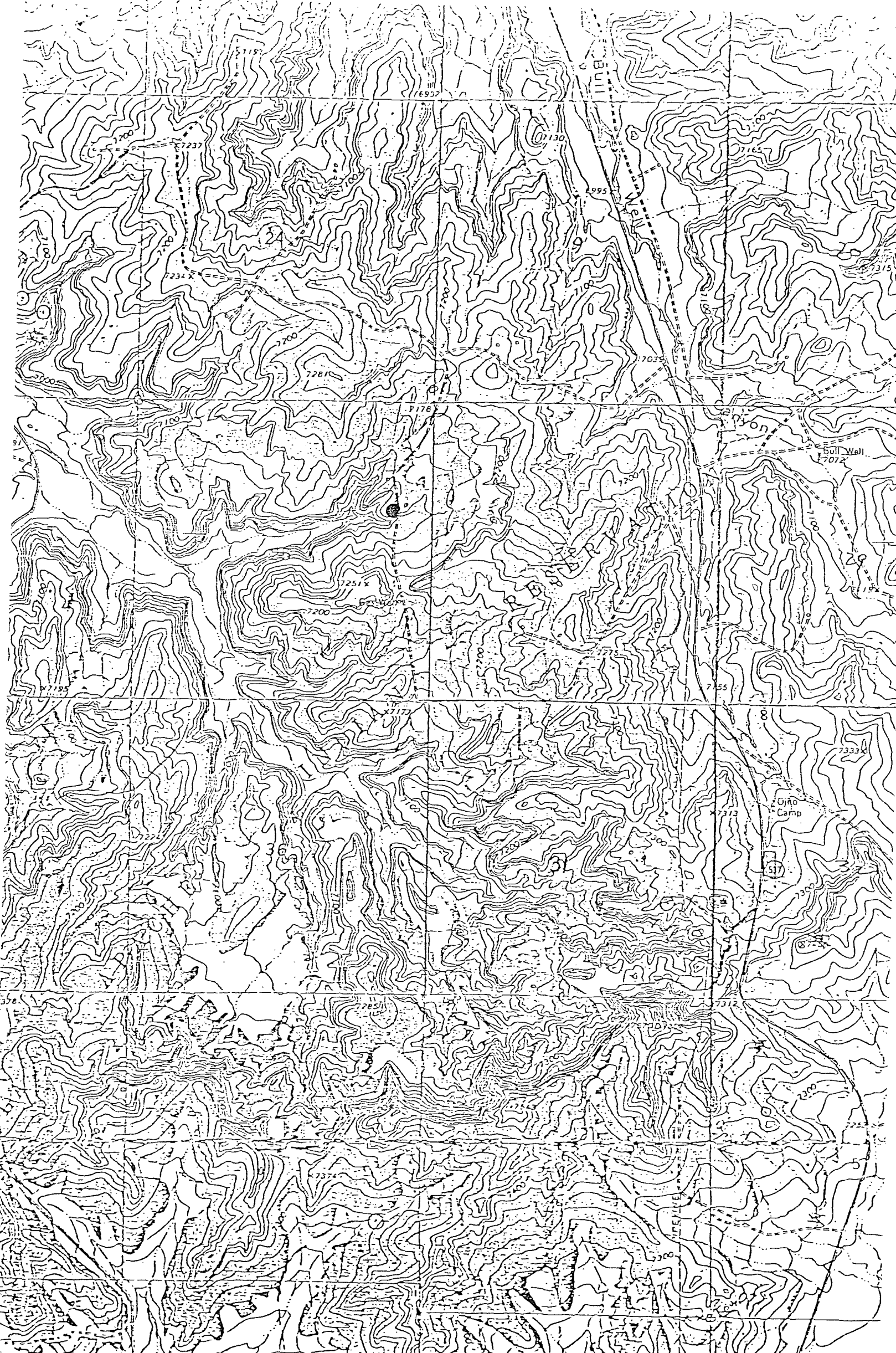

Vicinity Map for  
SOUTHERN UNION EXPLORATION CO. #14 JICARILLA B  
1375'FNL 725'FEL Sec. 25-T26N-RLW  
RIO ARRIBA COUNTY, NEW MEXICO



STATE OF NEW MEXICO  
ENERGY AND MINERALS DEPARTMENT  
OIL CONSERVATION DIVISION  
AZTEC DISTRICT OFFICE

1000 RIO BRAZOS ROAD  
AZTEC, NEW MEXICO 87410  
(505) 334-6178

OIL CONSERVATION DIVISION  
BOX 2088  
SANTA FE, NEW MEXICO 87501

DATE 5-5-82

RE: Proposed MC \_\_\_\_\_  
Proposed DHC \_\_\_\_\_  
Proposed NSL ✓ \_\_\_\_\_  
Proposed SWD \_\_\_\_\_  
Proposed WFX \_\_\_\_\_  
Proposed PMX \_\_\_\_\_

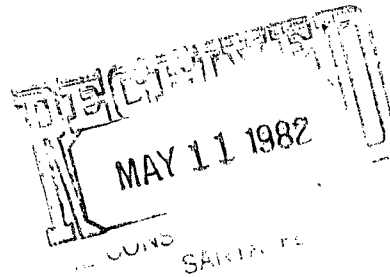

Gentlemen:

I have examined the application dated 4-23-82  
for the Southern Union Expl. Co. Jicarilla B 14 H-25-26W-4W  
Operator Lease and Well No. Unit, S-T-R

and my recommendations are as follows:

Approve  
\_\_\_\_\_  
\_\_\_\_\_  
\_\_\_\_\_  
\_\_\_\_\_

Yours truly,

Jeff A. Elmster



STATE OF NEW MEXICO  
ENERGY AND MINERALS DEPARTMENT  
OIL CONSERVATION DIVISION

April 29, 1982

BRUCE KING  
GOVERNOR

LARRY KEHOE  
SECRETARY

POST OFFICE BOX 2088  
STATE LAND OFFICE BUILDING  
SANTA FE, NEW MEXICO 87501  
(505) 827-2434

Southern Union Exploration Co.  
First International Building  
Dallas, Texas 75270

Attn: Lee Burton

Re: Application for Non-Standard  
Location: Jicarilla B No. 14  
Sec. 25, T-26-N, R-4-W  
Rio Arriba County, N. M.

We may not process the subject application for non-standard location until the required information or plats checked below (is) (are) submitted.

- ☒ A plat must be submitted clearly showing the ownership of the offsetting leases. Section numbers could not be read on the plat submitted and so much other information was shown that ownership was not clear.
- ☐ A statement must be submitted that offset owners have been notified of the application by certified mail.
- ☐ A plat must be submitted fully identifying the topography necessitating the non-standard location.
- ☐ Other:

Very truly yours

R. L. STAMETS  
Technical Support Chief

RLS/dr