

This is a duplicate  
filing - original  
file misplaced -

**Union Texas  
Petroleum**

1300 Wilco Building  
Midland, Texas 79701  
(915) 684-0600

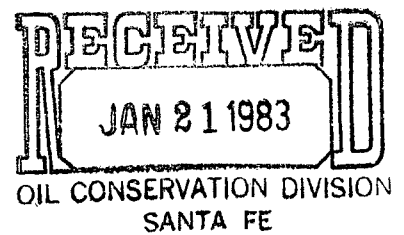

January 19, 1983

State of New Mexico  
Energy and Minerals Department  
P. O. Box 2088  
Santa Fe, New Mexico 87501

Attn: R. L. Stamets

RE: Administrative Order NSL-1545

*(Just do this one well)  
Amend NSL 1545  
Immediate, no offsets  
Rule 104 F*

Gentlemen:

Union Texas Petroleum respectfully requests that the location approved July 21, 1982, for an unorthodox location for the Langlie-Jal Unit Well No. 99, be changed from 1424' FSL & 2650' FWL to 1424' FSL & 2450' FSL. *WL*  
The approved location was the alternate location for this well. Corrected Form C-101 has been mailed to Hobbs.

Your consideration in this matter will be appreciated.

*See 32 T245 R37E*

Very truly yours,

UNION TEXAS PETROLEUM CORPORATION

  
Richard Atchley  
Production Services Supervisor

NO. OF COPIES RECEIVED		
DISTRIBUTION		
SANTA FE		
FILE		
U.S.G.S.		
LAND OFFICE		
OPERATOR		

NEW MEXICO OIL CONSERVATION COMMISSION

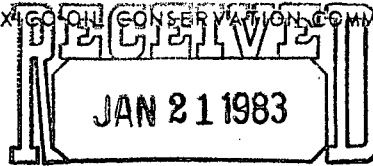

OIL CONSERVATION DIVISION

SANTA FE

Form C-101  
Revised 1-1-65

5A. Indicate Type of Lease

STATE	<input checked="" type="checkbox"/>	FEE	<input type="checkbox"/>
-------	-------------------------------------	-----	--------------------------

5. State Oil & Gas Lease No.

5. State Oil &amp; Gas Lease No.

## APPLICATION FOR PERMIT TO DRILL, DEEPEN, OR PLUG BACK

1a. Type of Work b. Type of Well OIL WELL <input checked="" type="checkbox"/> GAS WELL <input type="checkbox"/> OTHER <input type="checkbox"/> DRILL <input checked="" type="checkbox"/> DEEPEN <input type="checkbox"/> PLUG BACK <input type="checkbox"/> SINGLE ZONE <input checked="" type="checkbox"/> MULTIPLE ZONE <input type="checkbox"/>			7. Unit Agreement Name Langlie-Jal Unit	
2. Name of Operator Union Texas Petroleum Corporation			8. Farm or Lease Name	
3. Address of Operator 1300 Wilco Bldg., Midland, Texas 79701			9. Well No. 99	
4. Location of Well UNIT LETTER <u>K</u> LOCATED <u>1424</u> FEET FROM THE <u>South</u> LINE <u>2450</u> West <u>32</u> 24-S <u>37-E</u> AND FEET FROM THE LINE OF SEC. TWP. RGE. NMPM			10. Field and Pool, or Wildcat Langlie Mattix (Queen)	
11. Elevation (Show whether DP, RT, etc.) 3238.3 GR			12. County Lea	
13. Proposed Depth 3700			14. Formation Seven Rivers Queen	
15. Final & Status Plug, Bond Blanket			16. Rotary or C.T. Rotary	
17. Drilling Contractor			18. Approx. Date Work will start -	

## PROPOSED CASING AND CEMENT PROGRAM

SIZE OF HOLE	SIZE OF CASING	WEIGHT PER FOOT	SETTING DEPTH	SACKS OF CEMENT	EST. TOP
12-1/4"	8-5/8"	24#	800	600	Surface
7-7/8"	5-1/2"	14#	3700	700	Circulate

Propose to drill to depth of 3700' to the Seven Rivers-Queen Formation  
Blow-out preventors - 2000 psi.

This C-101 submitted to correct location from 2650 FWL to 2450 FWL.

IN ABOVE SPACE DESCRIBE PROPOSED PROGRAM; IF PROPOSAL IS TO DEEPEN ON PLUS BACK, GIVE DATA ON PRESENT PRODUCTIVE ZONE AND PROPOSED NEW PRODUCTIVE ZONE. GIVE BLOWOUT PREVENTER PROGRAM, IF ANY.

I hereby certify ~~that~~ the information above is true and complete to the best of my knowledge and belief.

Signed Richard A. Hickey Title Production Services Supr. Date 1-19-83

(This space for State Use)

APPROVED BY \_\_\_\_\_ TITLE \_\_\_\_\_ DATE \_\_\_\_\_

CONDITIONS OF APPROVAL, IF ANY:

**Union Texas  
Petroleum**

Southwestern Division  
1300 Wilco Building  
Midland, Texas 79701  
(915) 684-0600

JUN 07 1982

June 1, 1982

State of New Mexico  
Energy and Mineral Department  
Oil Conservation Commission  
P. O. Box 2088  
Santa Fe, New Mexico 87501

Attn: R. L. Stamets

Gentlemen:

Union Texas Petroleum Corporation respectfully requests administrative approval for three (3) unorthodox locations on our Langlie-Jal Unit, located in Lea County, New Mexico. The locations are as follows:

Well No. 95-M Located 90' FSL & 1250' FWL, Sec. 32, T-24-S, R-37-E

Well No. 96-N Located 90' FSL & 2600' FWL, Sec. 32, T-24-S, R-37-E

Well No. 97-P Located 90' FSL & 1200' FEL, Sec. 32, T-24-S, R-37-E.

Three (3) regular locations are also being applied for at this time and have been submitted to the District Office. These are Well Nos. 98-I, 99-K and 100-L, Sec. 32, T-24-S, R-37-E.

As all of the above unorthodox locations are surrounded by Langlie-Jal Unit Wells and no offset operators are involved, your early approval of the application will be greatly appreciated.

Very truly yours,

UNION TEXAS PETROLEUM CORPORATION

*Richard Atchley*

Richard Atchley  
Production Services Supervisor

Attachments

cc: Hobbs

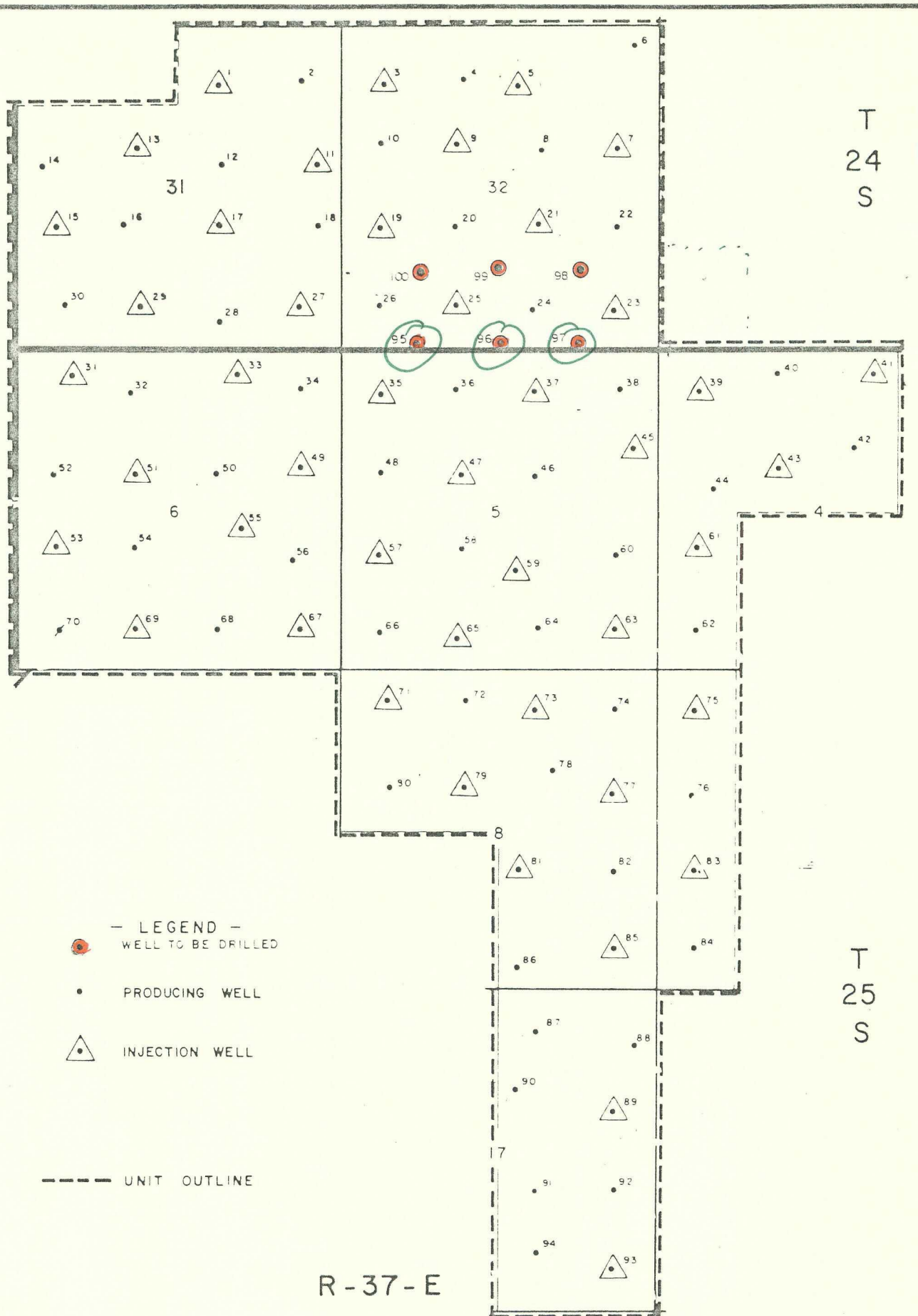

UNION TEXAS PETROLEUM	
A DIVISION OF ALLIED CHEMICAL CORPORATION	
LANGLIE-JAL UNIT	
LEA COUNTY, NEW MEXICO	
INFIELD WELL LOCATIONS	
SCALE IN FEET	
2000	0 2000 4000
S.M.F.	SOUTHWEST DIVISION
	2/24/82

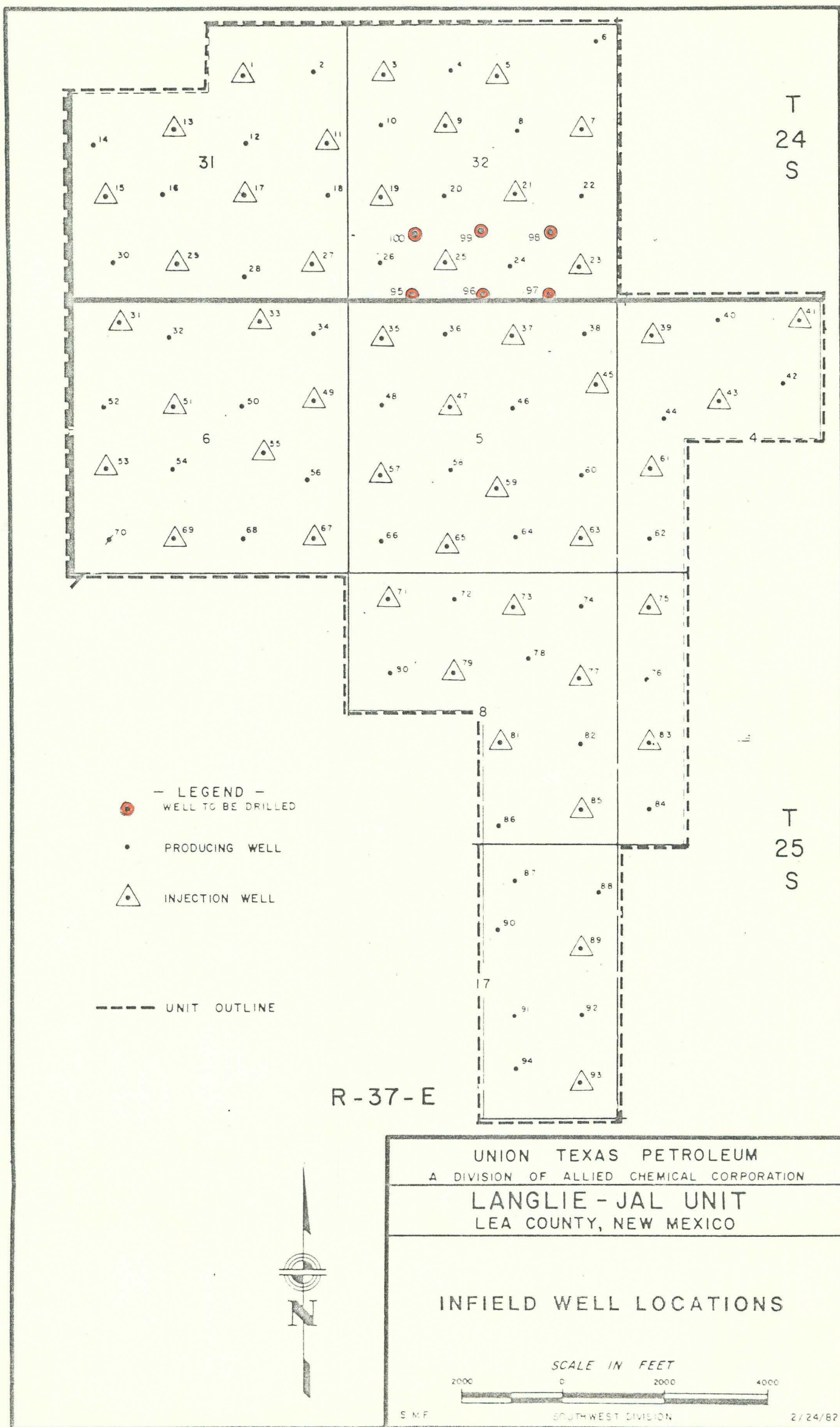



STATE OF NEW MEXICO  
**ENERGY AND MINERALS DEPARTMENT**  
OIL CONSERVATION DIVISION

TONY ANAYA  
GOVERNOR

March 24, 1983

POST OFFICE BOX 2088  
STATE LAND OFFICE BUILDING  
SANTA FE, NEW MEXICO 87501  
(505) 827-5800

Union Texas Petroleum  
1300 Wilco Building  
Midland, Texas 79701

Attention: Richard Atchley

Amendment  
Administrative Order NSL-1545

Gentlemen:

Reference is made to your application for a non-standard location for your Langlie-Jal Unit Well No. 99 to be located 1424 feet from the South line and 2450 feet from the West line of Section of Section 32, Township 24 South, Range 37 East, Langlie Mattix Queen, Lea County, New Mexico.

By authority granted me under the provisions of Rule 104 F of the Division Rules and Regulations, the above-described unorthodox location is hereby approved.

Sincerely,

A handwritten signature in dark ink, appearing to read "Joe D. Ramey", written over a horizontal line.

JOE D. RAMEY  
Director

JDR/RLS/dr

cc: Oil Conservation Division - Hobbs  
Oil & Gas Engineering Committee - Hobbs  
Oil & Gas Division - State Land Office - Santa Fe



BRUCE KING  
GOVERNOR

STATE OF NEW MEXICO  
ENERGY AND MINERALS DEPARTMENT  
OIL CONSERVATION DIVISION

July 21, 1982

POST OFFICE BOX 2088  
STATE LAND OFFICE BUILDING  
SANTA FE, NEW MEXICO 87501  
(505) 827-2434

Union Texas Petroleum  
1300 Wilco Building  
Midland, Texas 79701

*See Amendment*

Attention: Richard Atchley

Correction  
Administrative Order NSL-1545

Gentlemen:

Reference is made to your application for the amendment of three non-standard locations and the addition of three non-standard locations in Lea County, New Mexico, as follows:

Well No. 95-M located 140' FSL & 1250' FWL; ✓  
Well No. 96-N located 140' FSL & 2600' FWL; ✓  
Well No. 97-P located 140' FSL & 1200' FEL; ✓  
Well No. 98-I located 1422' FSL & 1200' FEL;  
Well No. 99-K located 1424' FSL & 2650' FWL; and  
Well No. 100-L located 1426' FSL & 1300' FWL,

all in Section 32, Township 24 South, Range 37 East,  
Langlie-Jal Unit.

By authority granted me under the provisions of Rule 104 F of the Division Rules and Regulations, the above-described unorthodox location is hereby approved.

Sincerely,

*Joe D. Ramey*  
JOE D. RAMEY,  
Director

JDR/RLS/dr

cc: Oil Conservation Division - Hobbs  
Oil & Gas Engineering Committee - Hobbs





STATE OF NEW MEXICO  
ENERGY AND MINERALS DEPARTMENT  
OIL CONSERVATION DIVISION

BRUCE KING  
GOVERNOR  
LARRY KEHOE  
SECRETARY

July 13, 1982

POST OFFICE BOX 2088  
STATE LAND OFFICE BUILDING  
SANTA FE, NEW MEXICO 87501  
(505) 827-2434

RECEIVED

JUL 19 1982

O. C. D.  
ARTESIA, OFFICE

Union Texas Petroleum  
1300 Wilco Building  
Midland, Texas 79701

Attention: Richard Atchley

Amendment  
Administrative Order NSL-1545

Gentlemen:

Reference is made to your application for the amendment of three non-standard locations and the addition of three non-standard locations in Lea County, New Mexico as follows:

- ✓ Well No. 95-M located 90' FSL & 1250' FWL;
- ✓ Well No. 96-N located 90' FSL & 2600' FWL;
- ✓ Well No. 97-P located 90' FSL & 1200' FEL;
- ✓ Well No. 98-I located 1422' FSL & 1200' FEL;
- ✓ Well No. 99-K located 1424' FSL & 2650' FWL; and
- ✓ Well No. 100L located 1426' FSL & 1300' FWL,

all in Section 32, Township 24 South, Range 37 East,  
Langlie-Jal Unit.

By authority granted me under the provisions of Rule 104 F of the Division Rules and Regulations, the above-described unorthodox location is hereby approved.

Sincerely,

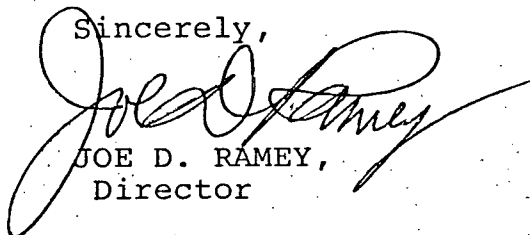
  
JOE D. RAMEY,  
Director

JDR/RLS/dr

cc: Oil Conservation Division - Hobbs  
Oil & Gas Engineering Committee - Hobbs

Union Texas  
Petroleum

Southwestern Division  
1300 Wilco Building  
Midland, Texas 79701  
(915) 684-0600

*Amend NSL 1545  
3 changes 3 additions  
Rule 104 F  
Immediate*

July 6, 1982

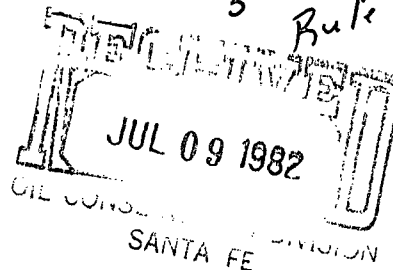

State of New Mexico  
Energy and Mineral Department  
Oil Conservation Commission  
P. O. Box 2088  
Santa Fe, New Mexico 87501

Attn: R. L. Stamets

Gentlemen:

Union Texas Petroleum Corporation respectfully requests administrative approval to amend three (3) unorthodox locations on our Langlie-Jal Unit, located in Lea County, New Mexico, and to add three (3) additional wells to your Administrative Order No. NSL-1545. The locations are as follows:

Well No. 95-M	Located	140' <sup>90</sup>	FSL &	1250' <sup>1250</sup>	FWL, Sec. 32, T-24-S, R-37-E	} <i>Amended</i>
Well No. 96-N	located	140' <sup>90</sup>	FSL &	2600' <sup>2600</sup>	FWL, Sec. 32, T-24-S, R-37-E	
Well No. 97-P	located	140' <sup>90</sup>	FSL &	1200' <sup>1200</sup>	FEL, Sec. 32, T-24-S, R-37-E	
Well No. 98-I	located	1422'	FSL &	1200'	FEL, Sec. 32, T-24-S, R-37-E	} <i>added</i>
Well No. 99-K	located	1424'	FSL &	2650'	FWL, Sec. 32, T-24-S, R-37-E	
Well No. 100-L	located	1426'	FSL &	1300'	FWL, Sec. 32, T-24-S, R-37-E	

As all of the above onorthodox locations are surrounded by Langlie-Jal Unit wells and no offset operators are involved, your early approval of the application will be greatly appreciated.

Very truly yours,

UNION TEXAS PETROLEUM CORPORATION

Richard Atchley  
Production Services Supervisor

Attachments

cc: Hobbs