

A. R. "Al" Kendrick

P. O. Box 516 • AZTEC, NEW MEXICO 87410 • (505) 334-2555

February 9, 1983

NSL 1659  
Rule 10# F  
3-3-83

Mr. Joe D. Ramey  
Oil Conservation Division  
P.O. Box 2088  
Santa Fe, New Mexico 87501

Re: Application for nonstandard location

Dear Mr. Ramey:

Approval is hereby requested for the location of the Helen Loraine Hedrick #2 Gale well at a point 2030' FNL and 1730' FWL of Section 24, T29N, R11W as an Aztec-Pictured Cliffs Pool extension in San Juan County as provided in Rule 3 of Order R-1670 due to topographic conditions.

A well at a standard location would be in an arable, gravity irrigated field where the well pad and roadway would disrupt the irrigation of a portion of the field.

Enclosed are: 1. A copy of the surveyor's plat showing the location of the well and the field, 2. An ownership plat showing the developed offset drill tracts, and 3. A list of offset owners and their addresses.

All offset operators have been supplied a copy of this application by certified mail with this mailing.

If further information is desired, please contact me.

Yours very truly,

*AR Kendrick*  
A. R. Kendrick

cc w/Encls: Helen Loraine Hedrick  
B. H. Keyes  
El Pamco, Inc.  
Oil Conservation Division, Aztec, NM

## OIL CONSERVATION DIVISION

P. O. BOX 2088

SANTA FE, NEW MEXICO 87501

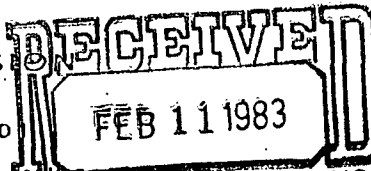
Form C-107  
Revised 10-1-77STATE OF NEW MEXICO  
ENERGY AND MINERALS DEPARTMENT

All distances must be from the outer boundaries of the well.

Operator <b>HELEN LORAIN HEDRICK</b>			Lease <b>GALE</b>			OIL CONSERVATION DIVISION SANTA FE			Well No. <b>2</b>		
Unit Letter <b>F</b>	Section <b>24</b>	Township <b>29N</b>	Range <b>11W</b>	County <b>San Juan</b>							
Actual Footage Location of Well: <b>2030</b> feet from the <b>North</b> line and <b>1730</b> feet from the <b>West</b> line.											
Ground Level Elev: <b>5482</b>	Producing Formation <b>Pictured Cliffs</b>		Pool <b>Aztec-Pictured Cliffs ext</b>					Dedicated Acreage: <b>160</b> Acres			

1. Outline the acreage dedicated to the subject well by colored pencil or hachure marks on the plat below.
2. If more than one lease is dedicated to the well, outline each and identify the ownership thereof (both as to working interest and royalty).
3. If more than one lease of different ownership is dedicated to the well, have the interests of all owners been consolidated by communitization, unitization, force-pooling, etc?

☐ Yes ☐ No If answer is "yes," type of consolidation \_\_\_\_\_

If answer is "no," list the owners and tract descriptions which have actually been consolidated. (Use reverse side of this form if necessary.) \_\_\_\_\_

No allowable will be assigned to the well until all interests have been consolidated (by communitization, unitization, forced-pooling, or otherwise) or until a non-standard unit, eliminating such interests, has been approved by the Commission.

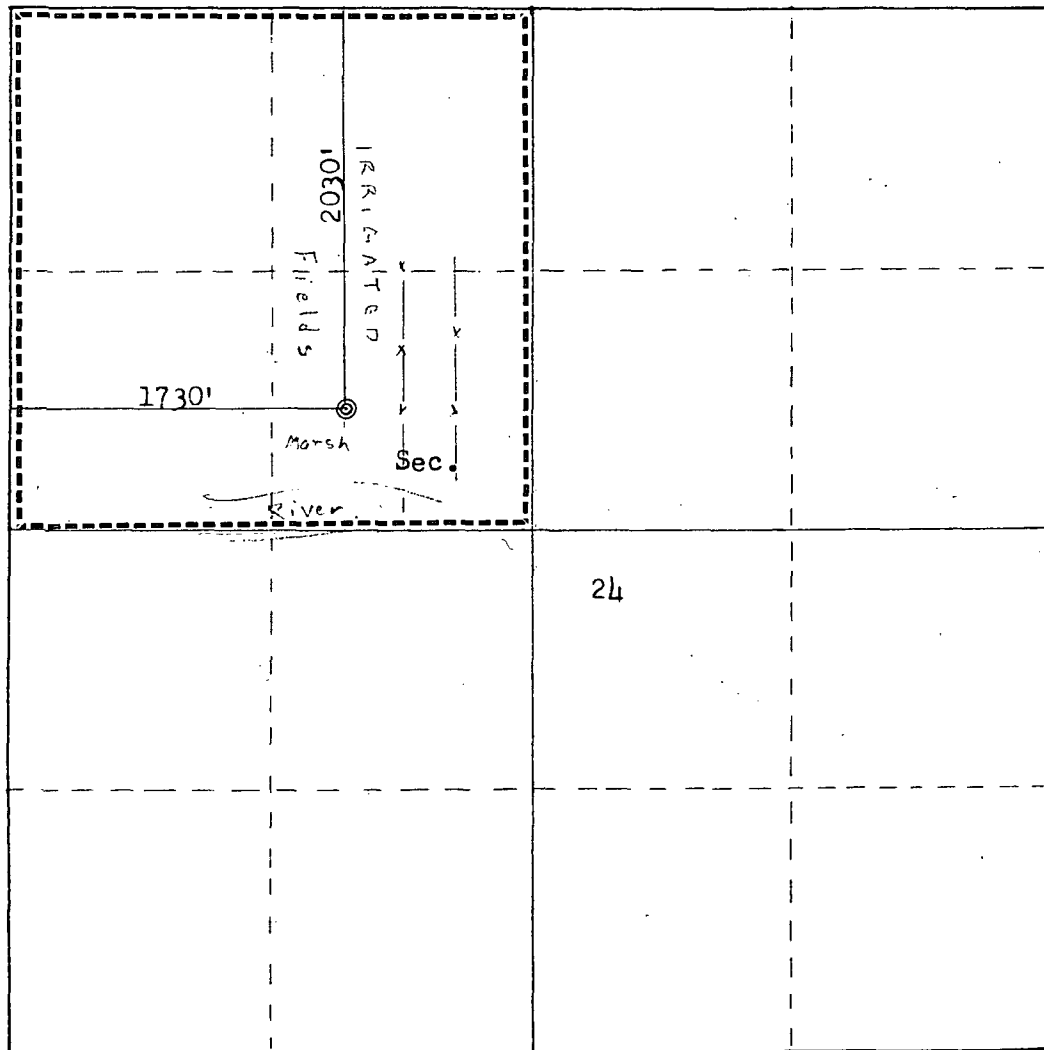

## CERTIFICATION

I hereby certify that the information contained herein is true and complete to the best of my knowledge and belief.

Name  
*Helen Lorraine Hedrick*  
Position  
Agent

Company  
Helen Lorraine Hedrick

Date  
February 8, 1983.

I hereby certify that the well location shown on this plat was plotted from field notes of actual surveys made by me or under my supervision, and that the same is true and correct to the best of my knowledge and belief.

Date Surveyed  
December 23, 1982  
Registered Professional Engineer  
and Land Surveyor.

*Fred B. Kerr Jr.*  
Fred B. Kerr Jr.

Certificate No. *3950*

Scale: 1"=1000'

TOWNSHIP 29 NORTH, RANGE 11 WEST

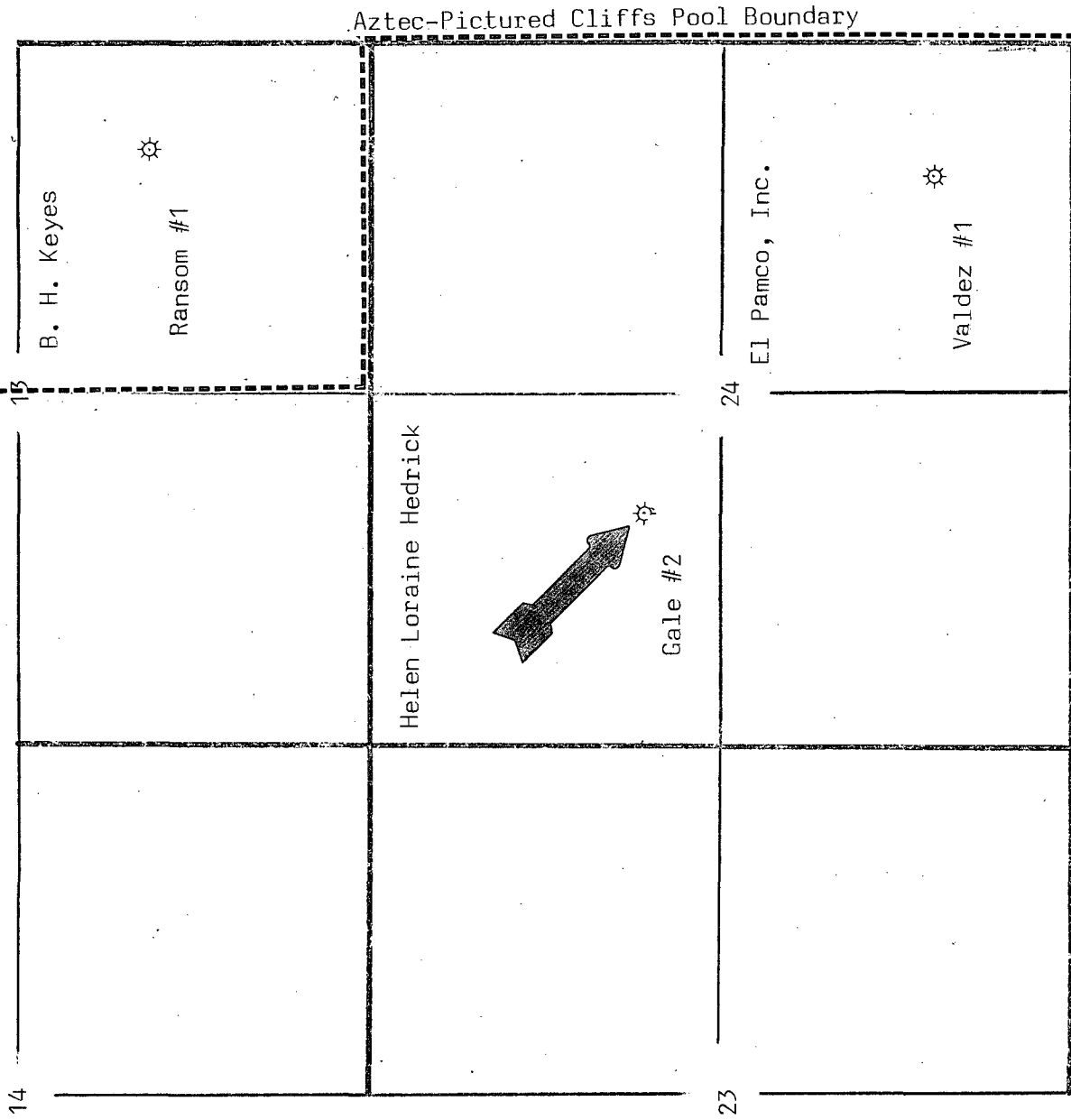

Helen Loraine Hedrick  
Gale #2  
F-24-T29N-R11W

Offset Operators:

B. H. Keyes  
P.O. Box 842  
Aztec, New Mexico 87410

El Pamco, Inc.  
P.O. Box 14738  
Albuquerque, New Mexico 87191

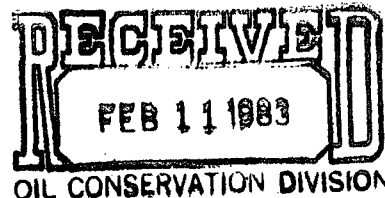

A. R. "Al" Kendrick

P. O. Box 516 • AZTEC, NEW MEXICO 87410 • (505) 334-2555

February 9, 1983

To offset operators of the:

Helen Loraine Hedrick  
Gale #2  
2030' FNL 1730' FWL  
Section 24, T29N, R11W  
Aztec-Pictured Cliffs Pool extension

Dear Operator:

If you do not object to the approval of the enclosed Application for Nonstandard Location, please sign and forward one copy of this letter to the Oil Conservation Division, P.O. Box 2088, Santa Fe, New Mexico.

Yours very truly,

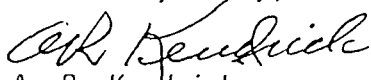
  
A. R. Kendrick

Mr. Joe D. Ramey  
Oil Conservation Division  
P.O. Box 2088  
Santa Fe, New Mexico 87501

Dear Mr. Ramey:

We, as offset operator, hereby waive objection to the Application for Nonstandard Location for the above captioned well.

Yours very truly,

B. H. Keyes

Date

2-10-83

By



1659

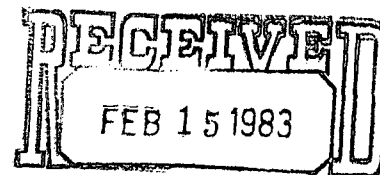

OIL CONSERVATION DIVISION  
SANTA FE

A. R. "Al" Kendrick

P. O. Box 516 • AZTEC, NEW MEXICO 87410 • (505) 334-2555

February 9, 1983

To offset operators of the:

Helen Loraine Hedrick  
Gale #2  
2030' FNL 1730' FWL  
Section 24, T29N, R11W  
Aztec-Pictured Cliffs Pool extension

Dear Operator:

If you do not object to the approval of the enclosed Application for Nonstandard Location, please sign and forward one copy of this letter to the Oil Conservation Division, P.O. Box 2088, Santa Fe, New Mexico.

Yours very truly,

*A. R. Kendrick*  
A. R. Kendrick

Mr. Joe D. Ramey  
Oil Conservation Division  
P.O. Box 2088  
Santa Fe, New Mexico 87501

*Waiver*

Dear Mr. Ramey:

We, as offset operator, hereby waive objection to the Application for Nonstandard Location for the above captioned well.

Yours very truly,

El Pamco, Inc.

Date 14 Feb 83

By *Will J. Mayhew U.P.*



STATE OF NEW MEXICO  
ENERGY AND MINERALS DEPARTMENT

OIL CONSERVATION DIVISION  
AZTEC DISTRICT OFFICE

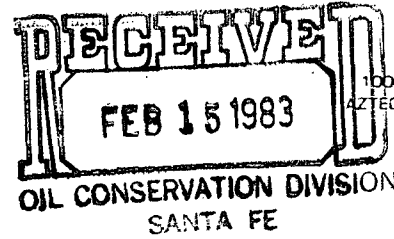

1000 RIO BRAZOS ROAD  
AZTEC, NEW MEXICO 87410  
(505) 334-6178

OIL CONSERVATION DIVISION  
BOX 2088  
SANTA FE, NEW MEXICO 87501

DATE 2-14-83

RE: Proposed MC \_\_\_\_\_  
Proposed DHC \_\_\_\_\_  
Proposed NSL ✓ \_\_\_\_\_  
Proposed SWD \_\_\_\_\_  
Proposed WFX \_\_\_\_\_  
Proposed PMX \_\_\_\_\_

Gentlemen:

I have examined the application dated 2-10-83  
for the Helen Loraine Hedrick Gale #2 F-24-29N-11W  
Operator Lease and Well No. Unit, S-T-R

and my recommendations are as follows:

Approve  
\_\_\_\_\_  
\_\_\_\_\_  
\_\_\_\_\_  
\_\_\_\_\_  
\_\_\_\_\_

Yours truly,

Jeff A. Edmister