

Getty Oil Company | P.O. Box 3360 Casper, Wyoming 82602-3360

Central Exploration and Production Division

March 9, 1983

*NS 41674
Rule 104 F &
Rule 3 B-1620
4-3-83*

New Mexico Oil Conservation Commission
P.O. Box 2088
Santa Fe, NM 87501

ATTENTION: Mr. Joe D. Ramey, Director

RE: Application for an Unorthodox Well
Location for Getty's Jicarilla "B"
#26E 1600' FSL and 1850' FEL of
J, Section 31-T25N-R5W, Rio Arriba
County, New Mexico

*Otero - Gallup
Basin - Dakota*

Dear Mr. Ramey:

Getty Oil Company requests approval of an Unorthodox Well Location for the above-referenced well. This well was staked at this location because of the location of a buried pipeline nearby as shown on our Well Location Plat (C-102). Please find attached a list of the names and addresses of the lessees of all offsetting properties and a plat showing these offset leaseholders and properties.

By copy of the attached letter and attachments, offset leaseholders were notified of this request for a well location exception by certified mail.

Very truly yours,

Getty Oil Company

David W. Bowers
Area Superintendent

SP/nmt

Attachments

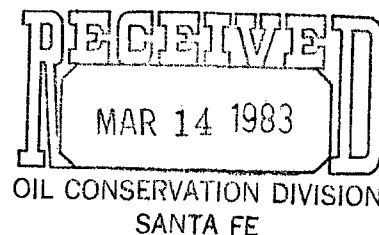

March 9, 1983

RE: Application for an Unorthodox Well
Location for Getty's Jicarilla "B"
#26E 1600' FSL & 1850' FEL of J,
Section 31-T25N-R5W, Rio Arriba
County, New Mexico

Gentlemen:

Please find attached a copy of our Application for an unorthodox well location for the above-referenced well which we are submitting to the New Mexico Oil Conservation Commission.

If you, as an offset leaseholder, have no objections to this unorthodox location, please sign the waiver at the bottom of the page and send to:

New Mexico Oil Conservation Commission
P.O. Box 2088
Santa Fe, New Mexico 87501
Attention: Mr. Joe D. Ramey, Director

We would appreciate your returning one executed copy to the undersigned.

Very truly yours,

Getty Oil Company

David W. Bowers
Area Superintendent

SP/nmt

Attachments

W A I V E R

We hereby waive any objections to Getty Oil Company's Application for an Unorthodox Well Location as set forth above:

Name of Person (for Company)

Date

RECEIVED
MAR 14 1983

All distances must be from the outer boundaries of the section.

OIL CONSERVATION DIVISION
SANTA FE

Operator: GETTY OIL COMPANY			Lease JICARILLA "B"		Well No. 26E
Unit Letter J	Section 31	Township 25N	Range 5W	County Rio Arriba	
Actual Footage Location of Well: 1600 feet from the South line and 1850 feet from the East line					
Ground Level Elev: 6759	Producing Formation Gallup Dakota		Pool Otero Gallup/Basin Dakota		Dedicated Acreage: Gallup - 40 Dakota - 320 Acres

1. Outline the acreage dedicated to the subject well by colored pencil or hachure marks on the plat below.
2. If more than one lease is dedicated to the well, outline each and identify the ownership thereof (both as to working interest and royalty).
3. If more than one lease of different ownership is dedicated to the well, have the interests of all owners been consolidated by communitization, unitization, force-pooling, etc?

☐ Yes ☐ No If answer is "yes," type of consolidation _____

If answer is "no," list the owners and tract descriptions which have actually been consolidated. (Use reverse side of this form if necessary.) _____

No allowable will be assigned to the well until all interests have been consolidated (by communitization, unitization, forced-pooling, or otherwise) or until a non-standard unit, eliminating such interests, has been approved by the Commission.

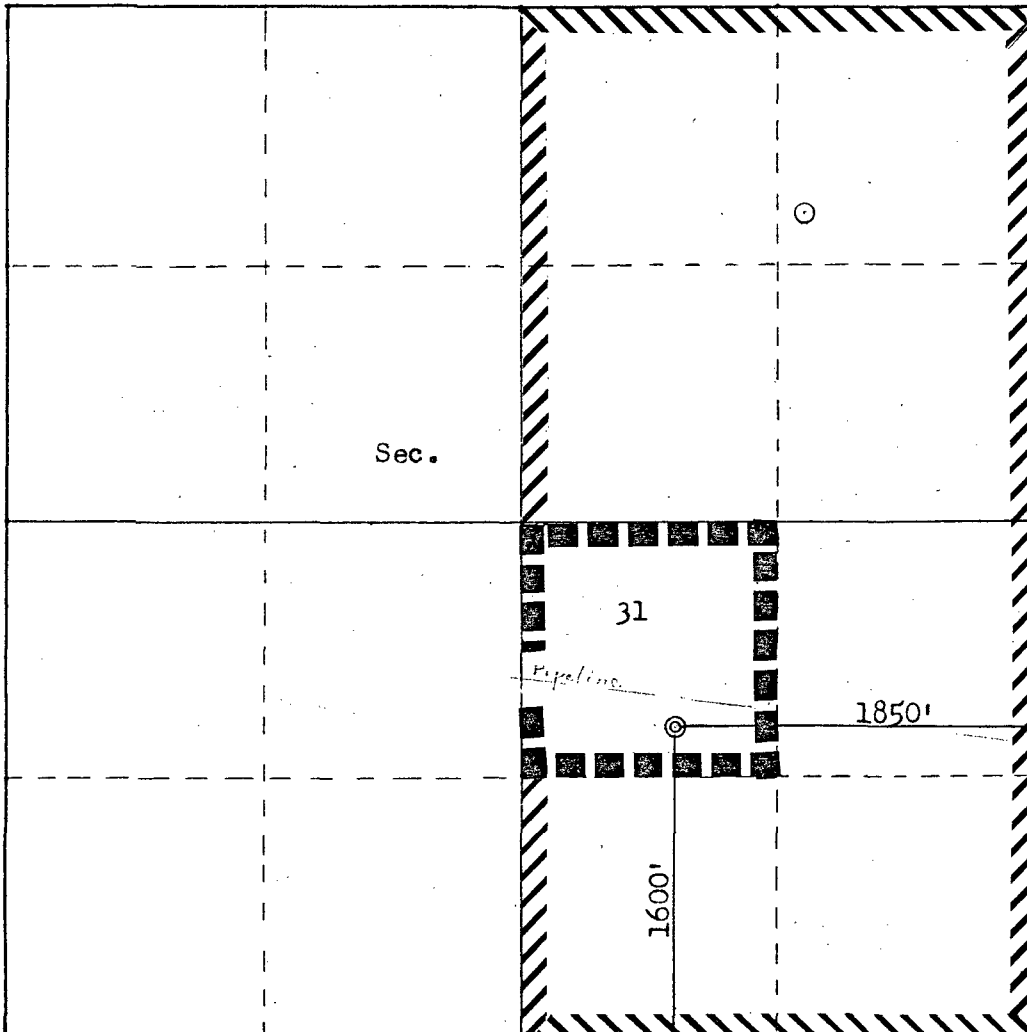

Scale: 1"=1000'

CERTIFICATION

I hereby certify that the information contained herein is true and complete to the best of my knowledge and belief.

Name *OW B...*
Position
Area Superintendent
Company
Getty Oil Company
Date
1-3-83

I hereby certify that the well location shown on this plat was plotted from field notes of actual surveys made by me or under my supervision, and that the same is true and correct to the best of my knowledge and belief.

Date Surveyed
January 19, 1983
Registered Professional Engineer and Land Surveyor
Fred B. Kerr Jr.
Certificate No. 3950

ATTACHMENT - ADJOINING LESSEES
Getty Oil Company's Jicarilla "B" #26E
Rio Arriba County, New Mexico

Amerada Hess Corporation
218 West 6th Street
P.O. Box 2040
Tulsa, OK 74102

El Paso Exploration Company
P.O. Box 1492
El Paso, TX 79978

Gulf Oil Exploration and Production Company
851 Werner Court
P.O. Box 2619
Casper, WY 82602

R 6 W

Ximbell

R 5 W

25

30

29

T
25
W

AMERADA
Kq1 8/60
TA 2/81
28,939
Kd 12/59
43
846
52,472
526

AMERADA
Kq1 2/59
53
536
61,572
302

EPNG
Kd 4/60
69
4/80
761
TA 2/52
5319
Commaled

EPNG
Kd 1/59
32
1673
16,564

AMERADA
Kq1 9/59
2
40,530
Kd 3/61
21
1227
107,685
4457

EPNG
Kq1 11/50
2
34,391

AMERADA
Kq1 7/53
2
15,155
Kd 12/59
44
2152
7973

GETTY
Jicarilla "B" #26E
Kq1 11/59
2
19,562
Kd 12/57
132
18,351

GETTY
Jicarilla "B" #26E
Kq1 9/58
2
19,562
Kd 12/57
132
18,351

EPNG
Kd 9/51
63
2705
33,794
EPNG
Kd 9/61
TA 11/79
599
5177

GETTY
Jicarilla "B" #26E
Kq1 12/58
2
18,160
Kd 12/57
132
18,351

GETTY
Jicarilla "B" #26E
Kq1 10/57
2
15,301
Kd 12/57
132
18,351

T
24
W

EPNG
Kd 9/73
34
31
1235

GULF
Kd 7/51
TA 12/77
279
4001
Recomp 7/81 (Koc)

GULF
Kd 10/50
TA 8/32
1429
20,732

EPNG
Kd 12/53
36
677
13,178

GULF
Kd 4/81
S.I. 8/82
31
296

GULF
Kd 9/51
S.I. 8/82
31
296

GULF

ATTACHMENT
Getty Oil Company's
Jicarilla "B" #26E
J, Section 31-T25N-R5W
Rio Arriba County, New Mexico

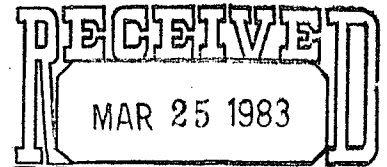

Getty Oil Company

Central Exploration and Production Division

March 9, 1983

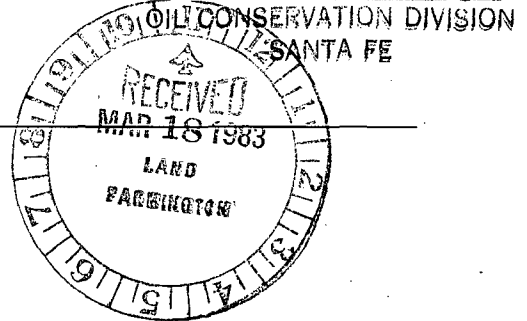

El Paso Natural Gas Company
P.O. Box 1492
El Paso, TX 79978

167d

RE: Application for an Unorthodox Well
Location for Getty's Jicarilla "B"
#26E 1600' FSL & 1850' FEL of J,
Section 31-T25N-R5W, Rio Arriba
County, New Mexico

Gentlemen:

Please find attached a copy of our Application for an unorthodox well location
for the above-referenced well which we are submitting to the New Mexico Oil
Conservation Commission.

If you, as an offset leaseholder, have no objections to this unorthodox loca-
tion, please sign the waiver at the bottom of the page and send to:

New Mexico Oil Conservation Commission
P.O. Box 2088
Santa Fe, New Mexico 87501
Attention: Mr. Joe D. Ramey, Director

We would appreciate your returning one executed copy to the undersigned.

Very truly yours,

Getty Oil Company

David W. Bowers
Area Superintendent

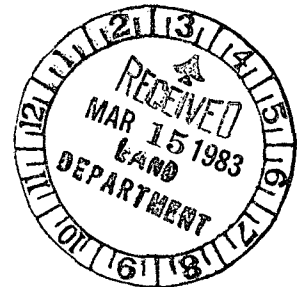

SP/nmt

Attachments

W A I V E R

We hereby waive any objections to Getty Oil Company's Application for an
Unorthodox Well Location as set forth above:

Name of Person (for Company)
EL PASO NATURAL GAS COMPANY

March 23, 1983

Date

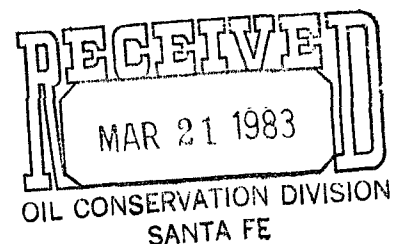

Getty Oil Company |

Central Exploration and Production Division

March 9, 1983

Gulf Oil Corporation
851 Werner Court
P.O. Box 2619
Casper, WY 82602

RE: Application for an Unorthodox Well
Location for Getty's Jicarilla "B"
#26E 1600' FSL & 1850' FEL of J,
Section 31-T25N-R5W, Rio Arriba
County, New Mexico

Gentlemen:

Please find attached a copy of our Application for an unorthodox well location for the above-referenced well which we are submitting to the New Mexico Oil Conservation Commission.

If you, as an offset leaseholder, have no objections to this unorthodox location, please sign the waiver at the bottom of the page and send to:

New Mexico Oil Conservation Commission
P.O. Box 2088
Santa Fe, New Mexico 87501
Attention: Mr. Joe D. Ramey, Director

We would appreciate your returning one executed copy to the undersigned.

Very truly yours,

Getty Oil Company

David W. Bowers
Area Superintendent

SP/nmt

Attachments

W A I V E R

We hereby waive any objections to Getty Oil Company's Application for an Unorthodox Well Location as set forth above:

J. R. Frank - Chief Proration Engineer
Name of Person (for Company)
March 16, 1983

Date