

Mobil Producing Texas & New Mexico Inc.

September 9, 1983

NINE GREENWAY PLAZA—SUITE 2700
HOUSTON, TEXAS 77046

State of New Mexico
Energy and Minerals Department (3)
Oil Conservation Division
State Land Office Building
P.O. Box 2088
Santa Fe, New Mexico 87501

Attention Mr. R. L. Stamets

*Amend
NSL 1701
Rule 104
No off 5x 1/2
Immediate*

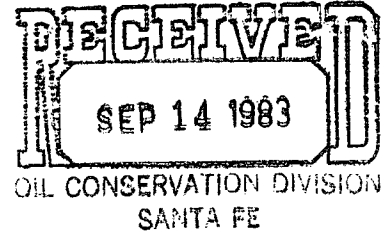

NSL-1701
UNORTHODOX LOCATION
MOBIL PRODUCING TX. & N.M. INC.
W.O. HUGHES, WELL #6
WILDCAT
RIO ARriba COUNTY, NEW MEXICO

Gentlemen:

Mobil Producing TX. & N.M. Inc. (MPTM) respectfully requests that the approval to drill the subject well at an unorthodox location be amended to permit drilling 1000 feet deeper to a total depth of 8700 feet to test the Entrada Sandstone. This well is only 21' from the quarter-quarter line which is less than the 330' requirement of Rule 2(b), Order No. R-5353.

In support of this request, the following items are submitted:

1. Form C-103 - Sundry Notice - Application for amended permit to drill deeper
2. Form C-102 - Well Location and Acreage Dedication Plat for wildcat

MPTM is the operator of all land surrounding the 40-acre proration unit.

Yours truly,

A handwritten signature in cursive script, appearing to read "J.A. Morris".

J.A. Morris
Regulatory Engineering Supervisor

LSHall/ec
Attachments
cc: NM Energy & Minerals Dept., Aztec District Office

NO. OF COPIES RECEIVED		
DISTRIBUTION		
SANTA FE		
FILE		
U.S.G.S.		
LAND OFFICE		
OPERATOR		

NEW MEXICO OIL CONSERVATION COMMISSION

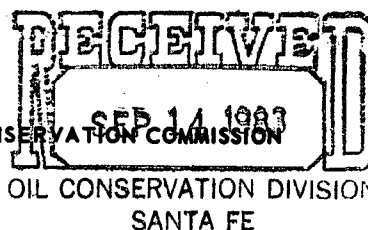

Form C-103
Supersedes Old
C-102 and C-103
Effective 1-1-85

5a. Indicate Type of Lease	
State <input type="checkbox"/>	Fee <input checked="" type="checkbox"/>
5. State Oil & Gas Lease No.	
7. Unit Agreement Name	
8. Farm or Lease Name W.O. Hughes	
9. Well No. 6	
10. Field and Pool, or Wildcat	
12. County Rio Arriba	

SUNDRY NOTICES AND REPORTS ON WELLS
(DO NOT USE THIS FORM FOR PROPOSALS TO DRILL OR TO DEEPEN OR PLUG BACK TO A DIFFERENT RESERVOIR. USE "APPLICATION FOR PERMIT -" (FORM C-101) FOR SUCH PROPOSALS.)

1. OIL WELL <input checked="" type="checkbox"/> GAS WELL <input type="checkbox"/> OTHER <input type="checkbox"/>	2. Name of Operator Mobil Producing TX. & N.M. Inc.
3. Address of Operator Nine Greenway Plaza, Suite 2700, Houston, TX 77046	4. Location of Well UNIT LETTER J 1743 FEET FROM THE South LINE AND 1341 FEET FROM THE East LINE, SECTION 8 TOWNSHIP 24N RANGE 3W NMPM.
15. Elevation (Show whether DF, RT, GR, etc.) 6871' GR	

Check Appropriate Box To Indicate Nature of Notice, Report or Other Data
NOTICE OF INTENTION TO: SUBSEQUENT REPORT OF:

PERFORM REMEDIAL WORK <input type="checkbox"/>	PLUG AND ABANDON <input type="checkbox"/>	REMEDIAL WORK <input type="checkbox"/>	ALTERING CASING <input type="checkbox"/>
TEMPORARILY ABANDON <input type="checkbox"/>	CHANGE PLANS <input type="checkbox"/>	COMMENCE DRILLING OPNS. <input type="checkbox"/>	PLUG AND ABANDONMENT <input type="checkbox"/>
PULL OR ALTER CASING <input type="checkbox"/>	OTHER <input checked="" type="checkbox"/> Drill Deeper	CASING TEST AND CEMENT JOBS <input type="checkbox"/>	OTHER <input type="checkbox"/>

17. Describe Proposed or Completed Operations (Clearly state all pertinent details, and give pertinent dates, including estimated date of starting any proposed work) SEE RULE-1703.

Well #6 has been permitted to drill to a TD of 7700'.

Permission requested to drill to 8700' for borehole seismic program to test the Entrada Sandstone. If pay is encountered in the Entrada Sandstone. If pay is encountered in the Entrada, the 4½" casing will be set at 8700'. Cement will be circulated with the top at ±2600'.

18. I hereby certify that the information above is true and complete to the best of my knowledge and belief.

SIGNED A.D. Bond A.D. Bond TITLE Regulatory Technician Supervisor DATE September 9, 1983

APPROVED BY _____ TITLE _____ DATE _____

CONDITIONS OF APPROVAL, IF ANY:

**NEW MEXICO OIL CONSERVATION COMMISSION
WELL LOCATION AND ACREAGE DEDICATION PLAT**

Form C-102
Supersedes C-128
Effective 1-1-65

All distances must be from the outer boundaries of the Section.

Operator Mobil Producing TX. & N.M. Inc.			Lease W.O. Hughes		Well No. 6
Unit Letter J	Section 8	Township 24N	Range 3W	County Rio Arriba	
Actual Footage Location of Well: 1743 feet from the South line and 1341 feet from the East line					
Ground Level Elev. 6871'	Producing Formation Entrada		Pool Wildcat		Dedicated Acreage: 40 Acres

1. Outline the acreage dedicated to the subject well by colored pencil or hachure marks on the plat below.
2. If more than one lease is dedicated to the well, outline each and identify the ownership thereof (both as to working interest and royalty).
3. If more than one lease of different ownership is dedicated to the well, have the interests of all owners been consolidated by communitization, unitization, force-pooling, etc?

☐ Yes ☐ No If answer is "yes," type of consolidation _____

If answer is "no," list the owners and tract descriptions which have actually been consolidated. (Use reverse side of this form if necessary.) _____

No allowable will be assigned to the well until all interests have been consolidated (by communitization, unitization, forced-pooling, or otherwise) or until a non-standard unit, eliminating such interests, has been approved by the Commission.

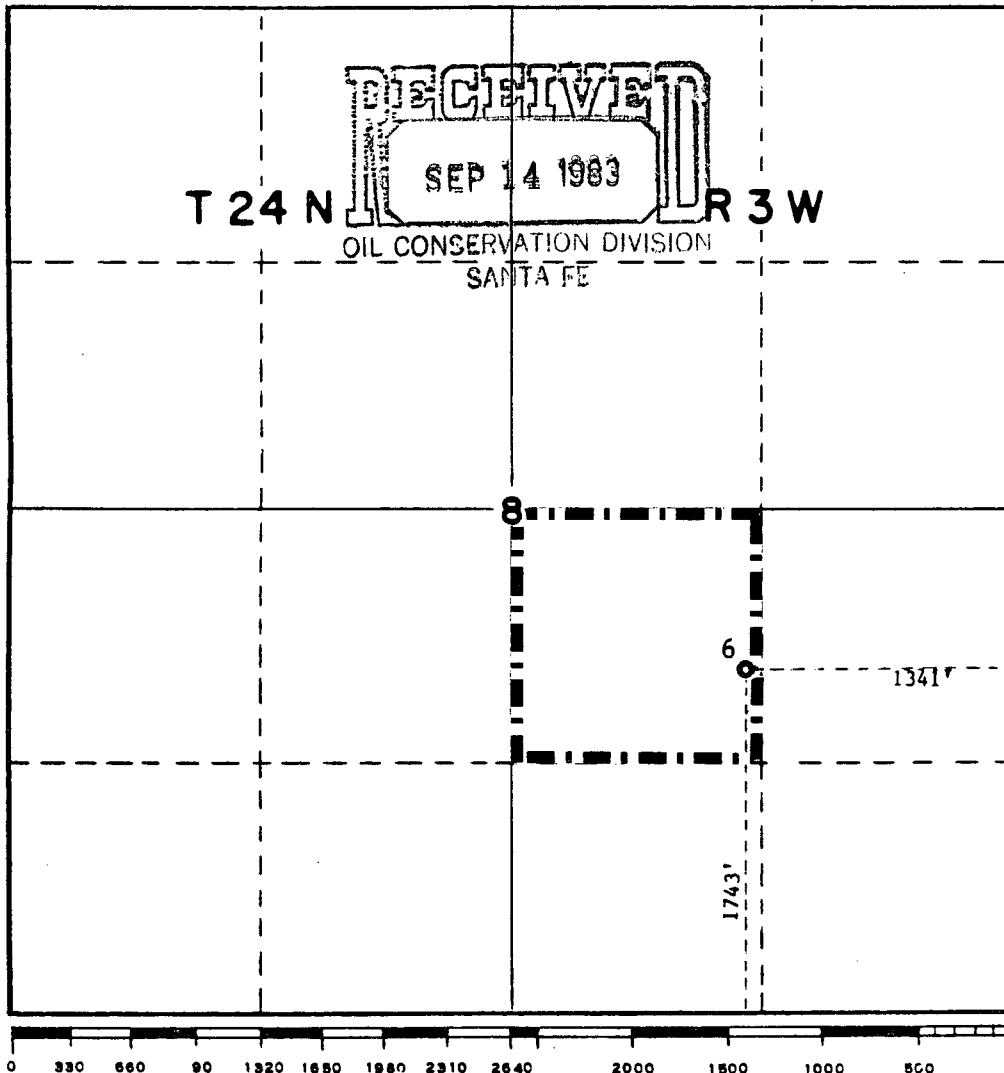

CERTIFICATION

I hereby certify that the information contained herein is true and complete to the best of my knowledge and belief.

Name
A.D. Bond

Position **Regulatory Technician Supervisor**

Company **Mobil Producing TX. & N.M. Inc.**

Date
September 9, 1983

I hereby certify that the well location shown on this plat was plotted from field notes of actual surveys made by me or under my supervision, and that the same is true and correct to the best of my knowledge and belief.

Date Surveyed _____

Registered Professional Engineer and/or Land Surveyor
H.A. Carson, Jr.

Certificate No.
5063



STATE OF NEW MEXICO
ENERGY AND MINERALS DEPARTMENT
OIL CONSERVATION DIVISION

June 13, 1983

TONEY ANAYA
GOVERNOR

POST OFFICE BOX 2088
STATE LAND OFFICE BUILDING
SANTA FE, NEW MEXICO 87501
(505) 827-5800

Mobil Producing Texas and
New Mexico, Inc.
Nine Greenway Plaza
Suite 2700
Houston, Texas 77046

Attention: J. A. Morris

Administrative Order NSL-1701

Gentlemen:

Reference is made to your application for a non-standard location for your W. O. Hughes Well No. 6 to be located 1743 feet from the South line and 1341 feet from the East line of Section 8, Township 24 North, Range 3 West, NMPM, West Lindrith Gallup-Dakota Pool, Rio Arriba County, New Mexico.

By authority granted me under the provisions of Rule 5 of Order No. R-4314, the above-described unorthodox location is hereby approved.

Sincerely,

A handwritten signature in dark ink, appearing to read "Joe D. Ramey", written over the typed name and title.

JOE D. RAMEY,
Director

JDR/RLS/dr

cc: Oil Conservation Division - Aztec
Oil & Gas Engineering Committee - Hobbs

Mobil Producing Texas & New Mexico Inc.

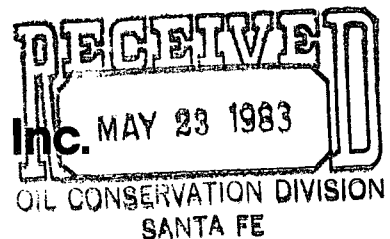

May 18, 1983

NINE GREENWAY PLAZA—SUITE 2700
HOUSTON, TEXAS 77046

State of New Mexico
Energy and Minerals Department (3)
Oil Conservation Division
State Land Office Building
P.O. Box 2088
Santa Fe, New Mexico 87501

*NSL 1701
Rule 5 R - 4314
6-12-83*

7.01
UNORTHODOX LOCATION
MOBIL PRODUCING TX. & N.M. INC.
W.O. HUGHES
WELL #6
WEST LINDRITH GALLUP-DAKOTA POOL
RIO ARriba COUNTY, NEW MEXICO

Gentlemen:

Mobil Producing TX. & N.M. Inc. respectfully requests permission to drill the subject well at an unorthodox location at the landowner's request to avoid locating the well in the landowner's pasture. This location was moved approximately 1000' Northeast of the original proposed location. This well is only 21' from the quarter-quarter line which is less than the 330' requirement of Rule 2(b), Order No. R5353.

Proposed well #6 will be located as follows:

1743' from the South line and
1341' from the West line of
Sec. 8, T24N - R3W
Rio Arriba County, New Mexico

In support of this request, the following items are submitted:

1. Form C-101 - Application for Permit to Drill
2. Form C-102 - Well Location and Acreage
Dedication Plat
3. Plat showing offset lease owners and topography

Mobil

Energy and Minerals Dept.

Page 2

May 18, 1983

Mobil Producing TX. & N.M. Inc. respectfully requests that this un-orthodox well location be approved administratively as provided for in Rule 2(c) of Order No. R-5353.

A copy of this letter and attachments are being sent to the offset operators by certified mail as their notice of this application and request for their waiver of objection. These offset operators are:

Arco Oil & Gas Company
P.O. Box 5540
Denver, CO 80217

Reading & Bates Petroleum Co.
2300 Denver National Bank Bldg.
1125 Seventeenth Street
Denver, CO 80202

Yours truly,

A handwritten signature in cursive script, appearing to read "J. A. Morris".

J.A. Morris
Regulatory Engineering Supervisor

LSHall/ec
Attachments

cc: Offset Operators
NM Energy & Minerals Dept., Aztec District Office

NEW MEXICO OIL CONSERVATION COMMISSION
WELL LOCATION AND ACREAGE DEDICATION PLAT

RECEIVED
MAY 23 1983

Form C-102
Supersedes C-128
Effective 1-1-85

All distances must be from the outer boundaries of the Section.

Operator Mobil Producing TX. & N.M. Inc.			Lease W.O. Hughes		OIL CONSERVATION DIVISION 6	
Unit Letter J	Section 8	Township 24N	Range 3W	County SANTA FE Rio Arriba		
Actual Footage Location of Well: 1743 feet from the South line and 1341 feet from the East line						
Ground Level Elev. 6871'	Producing Formation Gallup - Dakota		Pool West Lindrith Gallup - Dakota		Dedicated Acreage: 160 Acres	

1. Outline the acreage dedicated to the subject well by colored pencil or hachure marks on the plat below.
2. If more than one lease is dedicated to the well, outline each and identify the ownership thereof (both as to working interest and royalty).
3. If more than one lease of different ownership is dedicated to the well, have the interests of all owners been consolidated by communitization, unitization, force-pooling, etc?

☐ Yes ☐ No If answer is "yes," type of consolidation _____

If answer is "no," list the owners and tract descriptions which have actually been consolidated. (Use reverse side of this form if necessary.) _____

No allowable will be assigned to the well until all interests have been consolidated (by communitization, unitization, forced-pooling, or otherwise) or until a non-standard unit, eliminating such interests, has been approved by the Commission.

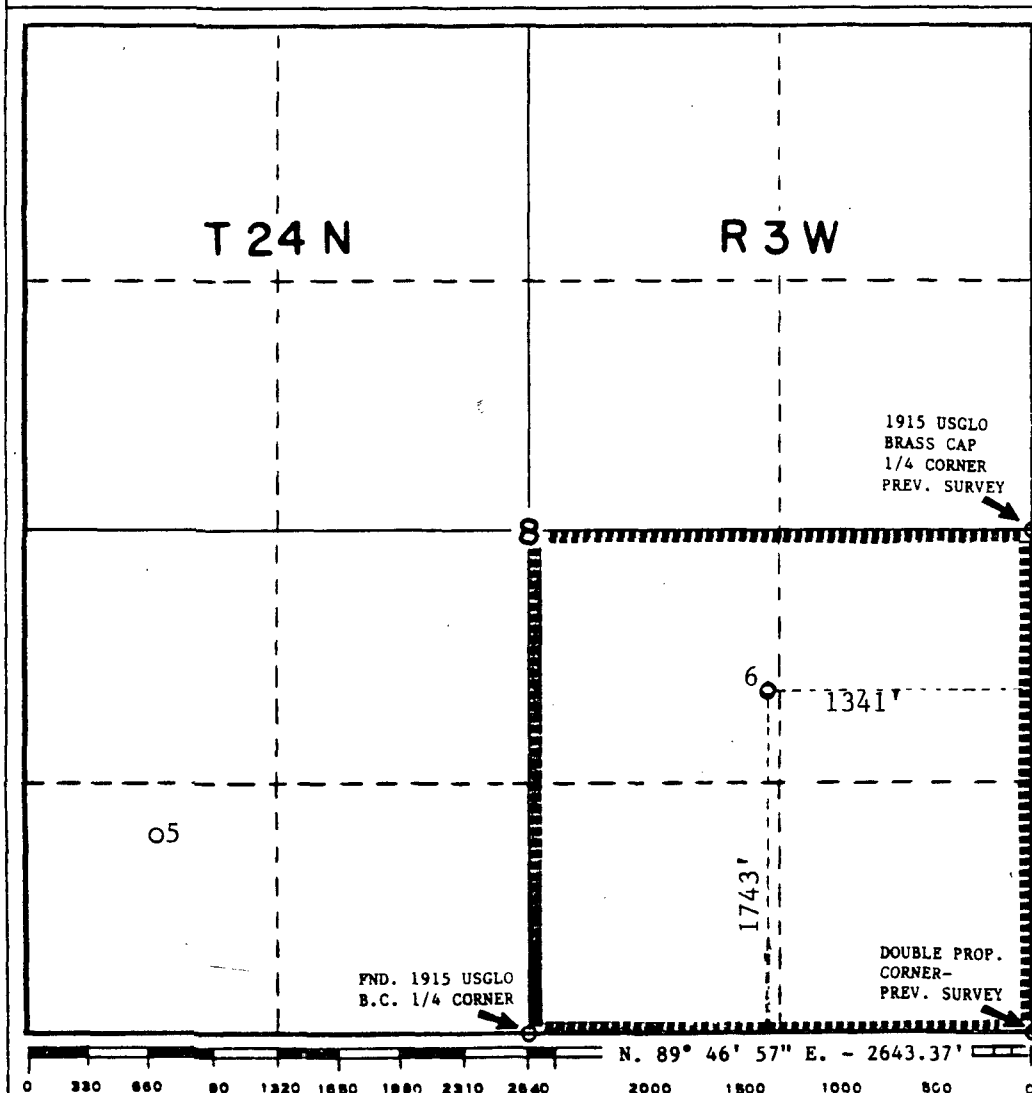

CERTIFICATION

I hereby certify that the information contained herein is true and complete to the best of my knowledge and belief.

Name
A.D. Bond
Position
Regulatory
Engineering Coordinator II
Company
Mobil Producing
TX. & N.M. Inc.

Date

I hereby certify that the location shown on this plat was plotted from field notes and actual measurements made by me or under my supervision, and that the same is true and correct to the best of my knowledge and belief.

Date Surveyed

April 12, 1983

Registered Professional Engineer
and/or Land Surveyor

H.A. Carson, Jr.

Certificate No.

5063

NO. OF COPIES RECEIVED	
DISTRIBUTION	
SANTA FE	
FILE	
U.S.G.S.	
LAND OFFICE	
OPERATOR	

NEW MEXICO OIL CONSERVATION COMMISSION

Form C-101
Revised 1-1-65

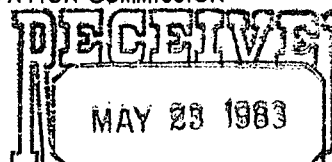

3A. Indicate Type of Lease
STATE ☐ FEE ☒
5. State Oil & Gas Lease No.

APPLICATION FOR PERMIT TO DRILL, DEEPEN, OR PLUG BACK

1a. Type of Work DRILL <input checked="" type="checkbox"/> DEEPEN <input type="checkbox"/> PLUG BACK <input type="checkbox"/>		7. Unit Agreement Name
b. Type of Well OIL WELL <input checked="" type="checkbox"/> GAS WELL <input type="checkbox"/> OTHER <input type="checkbox"/> SINGLE ZONE <input checked="" type="checkbox"/> MULTIPLE ZONE <input type="checkbox"/>		8. Farm or Lease Name W.O. Hughes
2. Name of Operator Mobil Producing TX. & N.M. Inc.		9. Well No. 6
3. Address of Operator Nine Greenway Plaza, Suite 2700, Houston, TX 77046		10. Field and Pool, or Wildcat West Lindrieth Gallup - Dakota
4. Location of Well UNIT LETTER <u>I</u> LOCATED <u>1743</u> FEET FROM THE <u>South</u> LINE AND <u>1341</u> FEET FROM THE <u>East</u> LINE OF SEC. <u>8</u> TWP. <u>24N</u> RGE. <u>3W</u> NMPM		12. County Rio Arriba
19. Proposed Depth 7700'		19A. Formation Gallup - Dakota
20. Rotary or C.T. Rotary		
21. Elevations (Show whether DF, RT, etc.) 6871' GR	21A. Kind & Status Plug. Bond On File	21B. Drilling Contractor Unknown
22. Approx. Date Work will start		

PROPOSED CASING AND CEMENT PROGRAM

SIZE OF HOLE	SIZE OF CASING	WEIGHT PER FOOT	SETTING DEPTH	SACKS OF CEMENT	EST. TOP
17-1/2"	13-3/8"	48# H-40	0 - 400'	Circulate	Surface
11"	8-5/8"	24# K-55	0 - 2300'	Circulate	Surface
		32# K-55	2300 - 3300'		
7-7/8"	4 1/2"	10.5# K-55	0 - 1600'		
		9.5# K-55	1600 - 5500'	Circulate	±2600'
		10.5# K-55	5500 - 7000'		
		11.6# K-55	7000 - 7750'		

BLOWOUT PREVENTER PROGRAM:

Casing String	Equipment Size & API Series	No & Type	Test Pressure (psi)
Surface	13-5/8" x 2000#	1 Master Gate & 1 Pipe Ram	2000
Intermediate	9" x 3000#	1 Master Gate & 1 Pipe Ram	3000

IN ABOVE SPACE DESCRIBE PROPOSED PROGRAM: IF PROPOSAL IS TO DEEPEN OR PLUG BACK, GIVE DATA ON PRESENT PRODUCTIVE ZONE AND PROPOSED NEW PRODUCTIVE ZONE. GIVE BLOWOUT PREVENTER PROGRAM, IF ANY.

I hereby certify that the information above is true and complete to the best of my knowledge and belief.

Signed J. A. Morris J. A. Morris Title Regulatory Engineering Supervisor Date May 18, 1983

(This space for State Use)

APPROVED BY _____ TITLE _____ DATE _____

CONDITIONS OF APPROVAL, IF ANY:

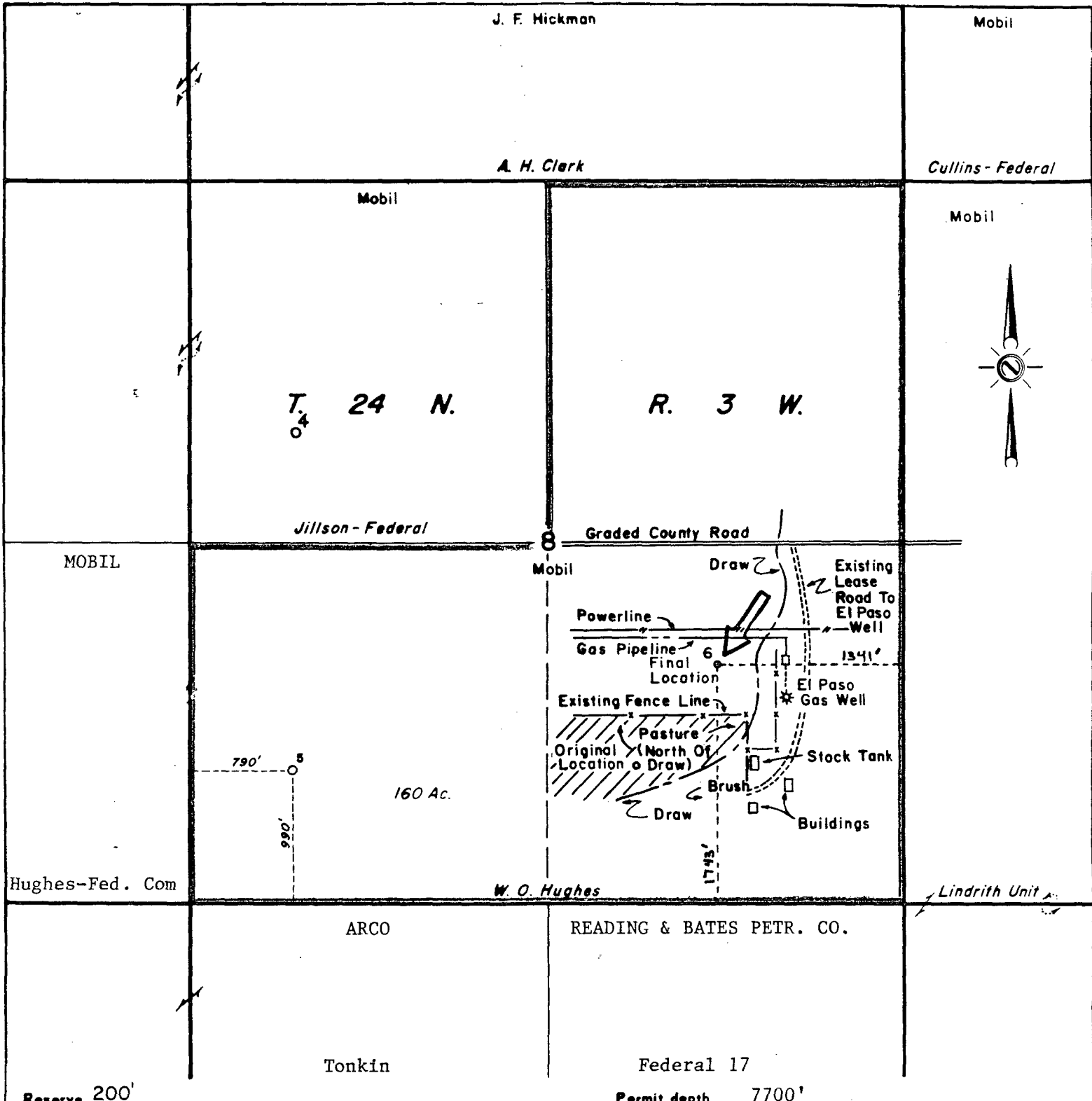

Reserve 200' Permit depth 7700'

Special instructions _____

Date work is commenced _____, 19____ Supt. _____

Location approved by _____ Location made by _____

THE STATE OF TEXAS
COUNTY OF HARRIS

I hereby certify that this plat truly represents conditions as they actually exist on this lease; that said plat which is drawn to the scale indicated hereon, is to the best of my knowledge true and correct; that it accurately shows said lease with all wells on same; that number and locations of said wells are as indicated hereon; and that this plat correctly reflects all pertinent and required data.

Mobil Producing Texas & New Mexico Inc.
Houston, Texas

LEASE W. O. Hughes

LEASE NO. NM-36

LOCATION MADE May 18, 1983 WELL NO. 6

TOTAL ACRES IN LEASE 480 ACRES COVERED BY PLAT 480

DESCRIPTION E 1/2 & SW 1/4 Sec. 8,

T. 24 N. - R. 3 W.

Rio Arriba COUNTY New Mexico

DRAWN Wm. H. Winckler DATE 7-12-57 FIELD West Lindrith
SCALE 1" = 1000' FILE NO. 104 Gallup-Dakota Oil Pool

Mobil Producing Texas & New Mexico Inc.

June 14, 1983

NINE GREENWAY PLAZA—SUITE 2700
HOUSTON, TEXAS 77046

State of New Mexico
Energy and Minerals Department
Oil Conservation Division
State Land Office Building
P.O. Box 2088
Santa Fe, New Mexico 87501

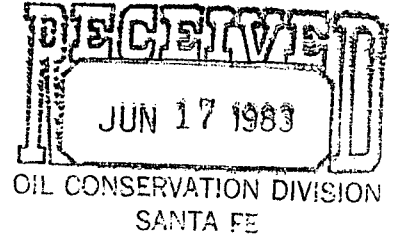

7.01
UNORTHODOX LOCATION
MOBIL PRODUCING TX. & N.M. INC.
W. O. HUGHES, WELL #6
WEST LINDRITH GALLUP-DAKOTA POOL
RIO ARriba COUNTY, NEW MEXICO

Gentlemen:

Attached are waivers (two copies each) from the offset operators to the subject well, waiving objection to the well being drilled at an unorthodox location. Accordingly, it is requested that the permit be granted administratively to drill this well at the proposed unorthodox location.

Yours very truly,

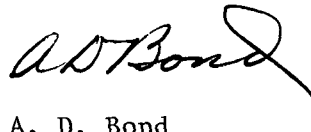

A handwritten signature in cursive script, appearing to read "A. D. Bond".

A. D. Bond
Regulatory Technician Supervisor

LSHall/ec
Attachments

cc: NM Energy & Minerals Dept., Aztec District Office (w/attach.)

W A I V E R

State of New Mexico
Energy & Minerals Department
Oil Conservation Division
State Land Office Building
P.O. Box 2088
Santa Fe, New Mexico 87501

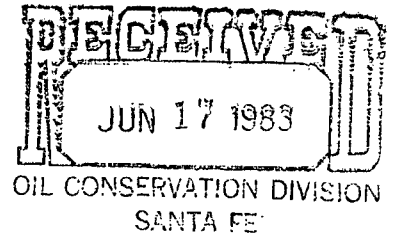

7.01
UNORTHODOX LOCATION
MOBIL PRODUCING TX. & N.M. INC.
W. O. HUGHES, WELL #6
WEST LINDRITH GALLUP-DAKOTA POOL
RIO ARriba COUNTY, NEW MEXICO

Gentlemen:

We have received a copy of Mobil Producing TX. & N.M. Inc.'s (MPTM) application to drill the subject well at an unorthodox location. Please be informed that we, as an offset operator to MPTM's proposed well, waive objection to their application as set forth in their letter dated May 18, 1983.

Yours very truly,

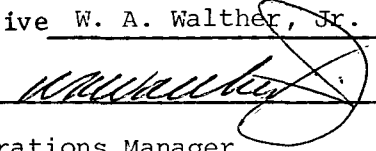
Company ARCO Oil and Gas Company
Representative W. A. Walther, Jr.
Signature 
Title Operations Manager
Date May 25, 1983

W A I V E R

State of New Mexico
Energy & Minerals Department
Oil Conservation Division
State Land Office Building
P.O. Box 2088
Santa Fe, New Mexico 87501

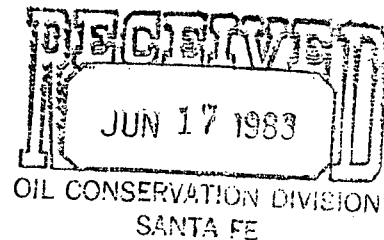

7.01
UNORTHODOX LOCATION
MOBIL PRODUCING TX. & N.M. INC.
W. O. HUGHES, WELL #6
WEST LINDRITH GALLUP-DAKOTA POOL
RIO ARriba COUNTY, NEW MEXICO

Gentlemen:

We have received a copy of Mobil Producing TX. & N.M. Inc.'s (MPTM) application to drill the subject well at an unorthodox location. Please be informed that we, as an offset operator to MPTM's proposed well, waive objection to their application as set forth in their letter dated May 18, 1983.

Yours very truly,

Company Reading & Bates Petroleum Co.

Representative R. B. Shindhelm

Signature *R. B. Shindhelm*

Title Division Manager

Date May 25, 1983