

OIL CONSERVATION DIVISION  
SANTA FE

Amoco Production Company  
Petroleum Center Building  
501 Airport Drive  
Farmington, New Mexico 87401  
505-325-8841

S. D. Blossom  
District Superintendent

March 29, 1983

Mr. Joe D. Ramey  
New Mexico Oil Conservation Division  
P. O. Box 2088  
Santa Fe, NM 87501

File: DDL-210-400.1

Application for Unorthodox Location  
Jicarilla Apache 102 Well No. 30A  
Blanco Mesaverde Field Pool  
Rio Arriba County, New Mexico

Amoco Production Company hereby requests approval of an unorthodox well location for the Jicarilla Apache 102 No. 30A. The proposed location is 970' FNL and 550' FWL of Section 10, T26N, R4W, Rio Arriba County, New Mexico. The attached Form C-102 illustrates the topographical problems encountered in selecting a suitable well site.

A copy of this application is being sent by certified mail to the offset lease holders, Consolidated Oil & Gas Inc., Union Texas Petroleum Corp., and Southland Royalty Co., with the request that they furnish you a waiver of objection and return one copy of the same to me.

Very truly yours,

RPM/eb  
Attachments

*NSL-1704  
Rule 104 F  
Times up  
Immediate*

R4W

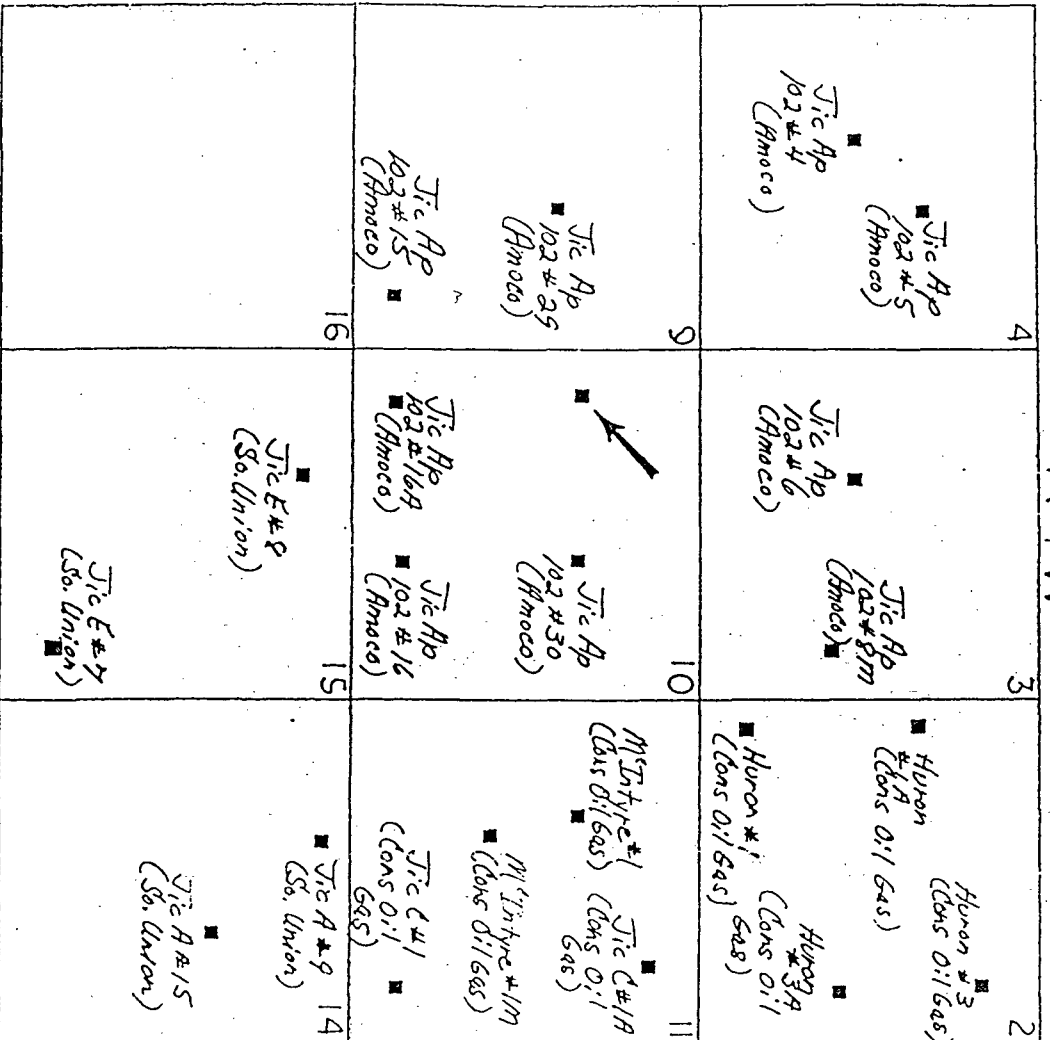

T  
26  
N

EXISTING BLANCO MESAVERDE WELLS

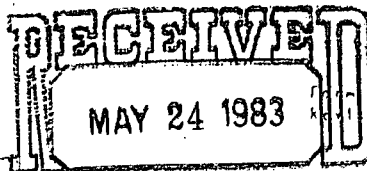

Operator <b>AMOCO PRODUCTION COMPANY</b>		Lease <b>JICARILLA APACHE 102</b>		OIL CONSERVATION DIVISION <b>SANTA FE 30A</b>	
Unit Letter <b>D</b>	Section <b>10</b>	Township <b>26</b>	Range <b>4W</b>	County <b>Rio Arriba</b>	
Actual Footage Location of Well: <b>970</b> feet from the <b>North</b> line and <b>550</b> feet from the <b>West</b> line					
Ground Level Elev: <b>6907</b>	Producing Formation <b>Mesa Verde</b>		Pool <b>Blanco Mesa Verde</b>		Dedicated Acreage: <b>320</b> Acres

1. Outline the acreage dedicated to the subject well by colored pencil or hachure marks on the plat below.
2. If more than one lease is dedicated to the well, outline each and identify the ownership thereof (both as to working interest and royalty).
3. If more than one lease of different ownership is dedicated to the well, have the interests of all owners been consolidated by communitization, unitization, force-pooling, etc?

☐ Yes ☐ No If answer is "yes," type of consolidation \_\_\_\_\_

If answer is "no," list the owners and tract descriptions which have actually been consolidated. (Use reverse side of this form if necessary.) \_\_\_\_\_

No allowable will be assigned to the well until all interests have been consolidated (by communitization, unitization, forced-pooling, or otherwise) or until a non-standard unit, eliminating such interests, has been approved by the Commission.

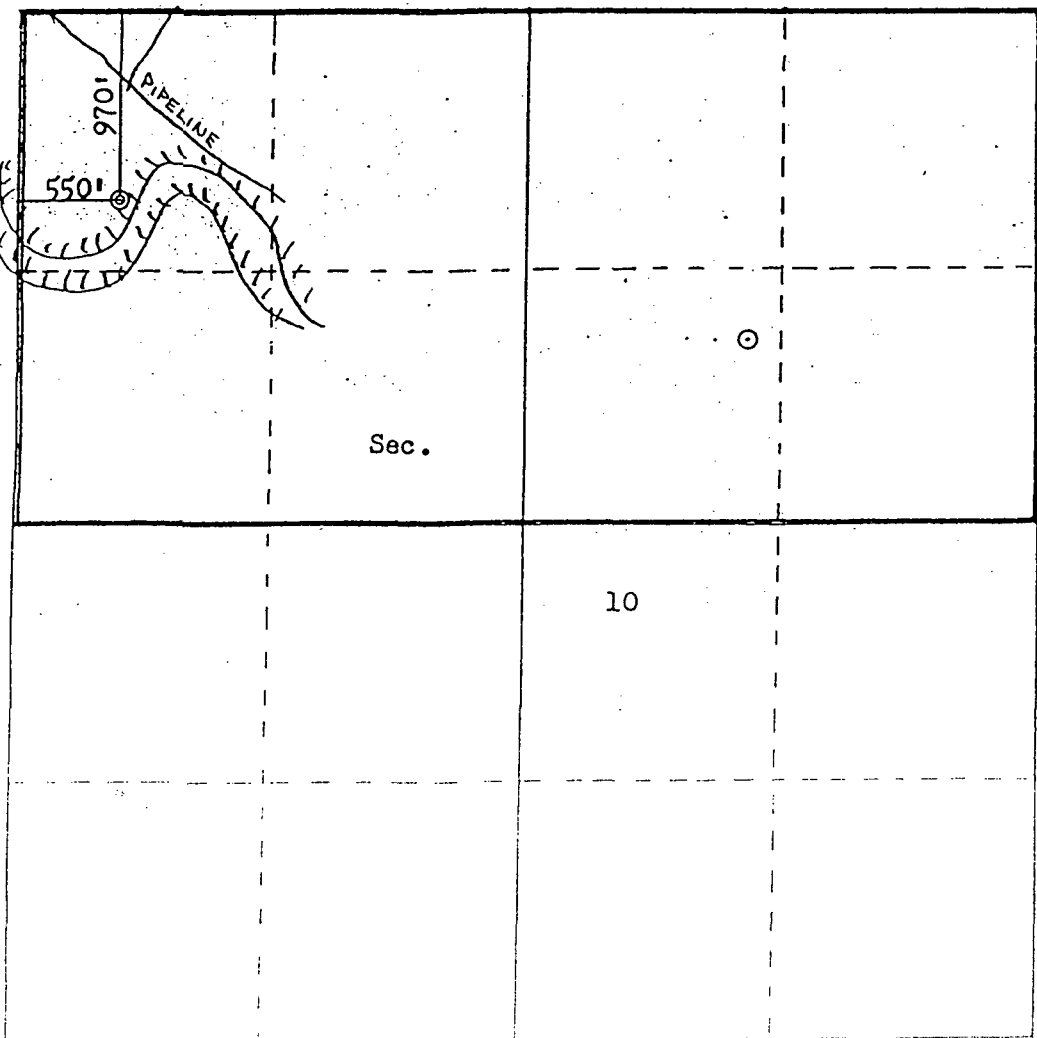

CERTIFICATION

I hereby certify that the information contained herein is true and complete to the best of my knowledge and belief.

*Dale H. Shoemaker*

Name  
**DALE H. SHOEMAKER**  
Position  
**DISTRICT ENGINEER**  
Company  
**AMOCO PRODUCTION COMPANY**

Date  
**MARCH 18, 1983**

I hereby certify that the well location shown on this plat was plotted from field notes of actual surveys made by me or under my supervision, and that the same is true and correct to the best of my knowledge and belief.

Date Surveyed  
**March 9, 1983**  
Registered Professional Engineer and Land Surveyor  
*Fred B. Kern Jr.*  
**Fred B. Kern Jr.**