

22 June 07 DATE IN	SUSPENSE	J. C. Caranach ENGINEER	22 June 07 LOGGED IN	NSL TYPE	PCLP0717343219 APP NO.
-----------------------	----------	----------------------------	-------------------------	-------------	---------------------------

ABOVE THIS LINE FOR DIVISION USE ONLY

NEW MEXICO OIL CONSERVATION DIVISION
- Engineering Bureau -
1220 South St. Francis Drive, Santa Fe, NM 87505



ADMINISTRATIVE APPLICATION CHECKLIST

THIS CHECKLIST IS MANDATORY FOR ALL ADMINISTRATIVE APPLICATIONS FOR EXCEPTIONS TO DIVISION RULES AND REGULATIONS WHICH REQUIRE PROCESSING AT THE DIVISION LEVEL IN SANTA FE

Application Acronyms:

[NSL-Non-Standard Location] [NSP-Non-Standard Proration Unit] [SD-Simultaneous Dedication]
[DHC-Downhole Commingling] [CTB-Lease Commingling] [PLC-Pool/Lease Commingling]
[PC-Pool Commingling] [OLS - Off-Lease Storage] [OLM-Off-Lease Measurement]
[WFX-Waterflood Expansion] [PMX-Pressure Maintenance Expansion]
[SWD-Salt Water Disposal] [IPI-Injection Pressure Increase]
[EOR-Qualified Enhanced Oil Recovery Certification] [PPR-Positive Production Response]

- [1] **TYPE OF APPLICATION** - Check Those Which Apply for [A]
 [A] Location - Spacing Unit - Simultaneous Dedication
☒ NSL ☐ NSP ☐ SD
 Check One Only for [B] or [C]
 [B] Commingling - Storage - Measurement
☐ DHC ☐ CTB ☐ PLC ☐ PC ☐ OLS ☐ OLM
 [C] Injection - Disposal - Pressure Increase - Enhanced Oil Recovery
☐ WFX ☐ PMX ☐ SWD ☐ IPI ☐ EOR ☐ PPR
 [D] Other: Specify _____

RECEIVED

JUN 22 2007

- [2] **NOTIFICATION REQUIRED TO:** - Check Those Which Apply, or Does Not Apply
 [A] ☐ Working, Royalty or Overriding Royalty Interest Owners
 [B] ☐ Offset Operators, Leaseholders or Surface Owner
 [C] ☐ Application is One Which Requires Published Legal Notice
 [D] ☐ Notification and/or Concurrent Approval by BLM or SLO
U.S. Bureau of Land Management - Commissioner of Public Lands, State Land Office
 [E] ☐ For all of the above, Proof of Notification or Publication is Attached, and/or,
 [F] ☐ Waivers are Attached

Oil Conservation Division
1220 S. St. Francis Drive
Santa Fe, NM 87505

- [3] **SUBMIT ACCURATE AND COMPLETE INFORMATION REQUIRED TO PROCESS THE TYPE OF APPLICATION INDICATED ABOVE.**

- [4] **CERTIFICATION:** I hereby certify that the information submitted with this application for administrative approval is **accurate** and **complete** to the best of my knowledge. I also understand that **no action** will be taken on this application until the required information and notifications are submitted to the Division.

Note: Statement must be completed by an individual with managerial and/or supervisory capacity.

Heather Riley	Heather Riley	Regulatory Specialist	6/18/07
Print or Type Name	Signature	Title	Date
		heather.riley@williams.com	
		e-mail Address	



P. O. Box 640
Aztec, NM 87410
(505) 634-4222
(505) 634-4205 (fax)
Heather.riley@williams.com

June 20, 2007

Mark E. Fesmire
NEW MEXICO OIL CONSERVATION DIVISION
1220 South Saint Francis Drive
Santa Fe, NM 87505

*Re: Request for Administrative approval for non-standard Dakota Location
Rosa Unit #188C
API # 3003929909
SW4 Sec. 34, T31N, R5W
880' FSL & 2450' FWL*

Dear Mr. Fesmire:

Williams Production Co., LLC, is requesting administrative approval to construct the Rosa Unit #188C as a dual Mesaverde/Dakota with the Dakota being non-standard. Pursuant to Order No. R-10987-B(2), spacing requirements allow for up to 4 Dakota wells in a standard GPU and they shall be located not closer than 660 feet to the outer boundary of the GPU and not closer than 10 feet to any interior quarter or quarter-quarter section line or subdivision inner boundary. Given these requirements, this location is non-standard to the east by 470 feet.

Williams has already been issued an APD for drilling a standard infill Mesaverde well by the BLM. A copy of the front page of the APD is enclosed for your review.

Williams intends to make the well a dual well thereby capturing the reserves from the Dakota with a single well bore. By itself the Dakota in this area is at best very marginal economically and a dual completion helps capture additional reserves from the Dakota that otherwise would not be able to be economically developed. Utilizing a single well bore for a dual completion would also negate the need for additional disturbance of another wellpad, road, and pipeline.

The surface location was picked by considering drainage patterns from the offset Mesaverde wells. In particular, the drainage patterns we are trying to avoid are from the Rosa Unit #184A in the northeast of 34, the Rosa Unit #188A in the northwest of 34, the Rosa Unit #184 in the southeast of 34, the Rosa Unit #188C in the southwest of 34, the

Mark E. Fesmire

June 20, 2007

Page 2 of 2

Rosa Unit #188B in the southwest of 34, and the Rosa Unit #2A in the northwest of 3 (T30N, R5W). See drainage map.

As the Unit Operator of the Rosa Unit, Williams Production is the only offset operator, thereby this proposed non-standard location would not affect any other operators.

The offset unit's working interest and mineral owners to the east are common with the subject unit therefore there are no "affected persons."

Enclosed for your reference are copies of the Participating Area maps for the Mesaverde and Dakota Formations. As you can see, the east half of section 34 is not in a PA, nor is the west half. Both areas are in a PA in the Mesaverde Formation.

The spacing unit for the Mesaverde is the west half and the other Mesaverde wells in the spacing unit are the Rosa Unit #188, #188A and #188B.

The spacing unit for the Dakota is the west half and there are no other Dakota wells in the spacing unit.

Should you have any questions or concerns, please don't hesitate to contact me at the phone numbers listed above. You can also contact Vern Hansen at our Tulsa office at (918) 573-6169.

Sincerely,

A handwritten signature in black ink, appearing to read "Heather Riley". The signature is fluid and cursive, with the first name being more prominent.

Heather Riley

Regulatory Specialist

Enc.: 1st page of the APD
Plat
Topographic map
Drainage Map
PA Maps (MV & DK)

Copy: Unit C

UNITED STATES
DEPARTMENT OF THE INTERIOR
BUREAU OF LAND MANAGEMENT

APPLICATION FOR PERMIT TO DRILL OR REENTER

FORM APPROVED
OMB No. 1004-0136
Expires January 31, 2004

5. Lease Serial No.
NMSF-078773
6. If Indian, Allottee or Tribe Name

1a. Type of Work: ☒ DRILL ☐ REENTER

1b. Type of Well: ☐ Oil Well ☒ Gas Well ☐ Other ☒ Single Zone ☐ Multiple Zone

2. Name of Operator

Williams Production Company, LLC

3a. Address

P.O. Box 640 Aztec, NM 87410

3b. Phone No. (include area code)

(505) 634-4208

4. Location of Well (Report location clearly and in accordance with any State requirements. *)

At surface 880' FSL & 2450' FWL

At proposed prod. zone same

14. Distance in miles and direction from nearest town or post office*

approximately 31 miles northeast of Blanco, New Mexico

15. Distance from proposed*

location to nearest
property or lease line, ft.
(Also to nearest drig. unit line, if any)

880'

16. No. of Acres in lease

1,920.00

17. Spacing Unit dedicated to this well

320.0 (W/2)

18. Distance from proposed location*
to nearest well, drilling, completed,
applied for, on this lease, ft.

1500'

19. Proposed Depth

6,491

20. BLM/BIA Bond No. on file

WT0047 UTB000178

21. Elevations (Show whether DF, KDB, RT, GL, etc.)

6,712' GR

22. Approximate date work will start*

June 1, 2006

23. Estimated duration

1 month

24. Attachments

The following, completed in accordance with the requirements of Onshore Oil and Gas Order No.1, shall be attached to this form:

1. Well plat certified by a registered surveyor.
2. A Drilling Plan.
3. A Surface Use Plan (if the location is on National Forest System Lands, the SUPO shall be filed with the appropriate Forest Service Office).

4. Bond to cover the operations unless covered by an existing bond on file (see Item 20 above).
5. Operator certification.
6. Such other site specific information and/or plans as may be required by the authorized officer.

25. Signature

Title

Drilling COM

Approved by (Signature)

Title

Name (Printed/Typed)

Larry Higgins

Date

5-11-06

Name (Printed/Typed)

Office

Date

4/13/07

Application approval does not warrant or certify that the applicant holds legal or equitable title to those rights in the subject lease which would entitle the applicant to conduct operations thereon.

Conditions of approval, if any, are attached.

Title 18 U.S.C. Section 1001 and Title 43 U.S.C. Section 1212, make it a crime for any person knowingly and willfully to make to any department or agency of the United States any false, fictitious or fraudulent statements or representations as to any matter within its jurisdiction.

*(Instructions on reverse)

Williams Exploration and Production Company, LLC, proposes to drill a well to develop the Blanco Mesaverde formation at the above described location in accordance with the attached drilling and surface use plans.

The surface is under jurisdiction of the Carson National Forest, Jicarilla Ranger District.

This location has been archaeologically surveyed La Plata Archaeological Consultants. Copies of their report have been submitted directly to the CNF/JRD.

A 1150-foot on-lease access road and a 1352.30-foot pipeline tie would be required for this location. Williams Field Services has filed a pipeline route plan for the associated pipeline. The pipeline would be owned and operated by Williams Field Services.

District I
1625 N. French Dr., Hobbs, NM 88240

District II
1301 W. Grand Avenue, Artesia, NM 88210

District III
1000 Rio Brazos Rd., Aztec, NM 87410

District IV
1220 S. St Francis Dr., Santa Fe, NM 87505

State of New Mexico
Energy, Minerals & Natural Resources Department

OIL CONSERVATION DIVISION
1220 South St. Francis Dr.
Santa Fe, NM 87505

Form C-102
Revised October 12, 2005

Instructions on back
Submit to Appropriate District Office
State Lease - 4 Copies
Fee Lease - 3 Copies

☐ AMENDED REPORT

WELL LOCATION AND ACREAGE DEDICATION PLAT

1 API Number		2 Pool Code 72319 / 71599		3 Pool Name BLANCO MESAVERDE / BASIN DAKOTA	
4 Property Code 17033		5 Property Name ROSA UNIT			6 Well Number 188C
7 OGRID No. 120782		8 Operator Name WILLIAMS PRODUCTION COMPANY			9 Elevation 6712'

10 Surface Location

UL or lot no.	Section	Township	Range	Lot Idn	Feet from the	North/South line	Feet from the	East/West line	County
N	34	31N	5W		880	SOUTH	2450	WEST	RIO ARriba

11 Bottom Hole Location If Different From Surface

UL or lot no.	Section	Township	Range	Lot Idn	Feet from the	North/South line	Feet from the	East/West line	County
12 Dedicated Acres 320.0 Acres - W/2 (MV) 320.0 Acres - W/2 (DK)					13 Joint or Infill	14 Consolidation Code	15 Order No.		

NO ALLOWABLE WILL BE ASSIGNED TO THIS COMPLETION UNTIL ALL INTERESTS HAVE BEEN CONSOLIDATED
OR A NON-STANDARD UNIT HAS BEEN APPROVED BY THE DIVISION

16		5277.36'		17 OPERATOR CERTIFICATION I hereby certify that the information contained herein is true and complete to the best of my knowledge and belief, and that this organization either owns a working interest or unleased mineral interest in the land including the proposed bottom-hole location or has a right to drill this well at this location pursuant to a contract with an owner of such a mineral or working interest, or to a voluntary pooling agreement or a compulsory pooling order heretofore entered by the division. Signature _____ Date _____ Printed Name _____	
LEASE SF-078773		34		18 SURVEYOR CERTIFICATION I hereby certify that the well location shown on this plat was plotted from field notes of actual surveys made by me or under my supervision, and that the same is true and correct to the best of my belief Survey Date: OCTOBER 5, 2005 Signature and Seal of Professional Surveyor	
5280.00'		2450'		JASON C. EDWARDS NEW MEXICO REGISTERED PROFESSIONAL SURVEYOR 15269 JASON C. EDWARDS Certificate Number 15269	
2640.00'		880'			
DATUM: NAD83 LAT: 36.85131°N LONG: 107.35027°W					

This is a detailed topographic map of the Laguna Seca area in California. The map features contour lines indicating elevation, with labels such as 6400, 6500, 6600, 6700, and 6800. A prominent thick black line runs vertically through the center of the map, and another thick black line runs horizontally across the bottom, likely representing major roads or boundaries. The map includes several numbered points (e.g., 309A, 309B, 309C, 309D) and specific locations like 'Cabestro' and 'Laguna Seca'. The map is overlaid with a grid of latitude and longitude lines. The map also shows various geographical features such as 'LAGUNA SECA', 'MESA 34', 'CANYON', and 'FOREST'. The map is oriented with North at the top.

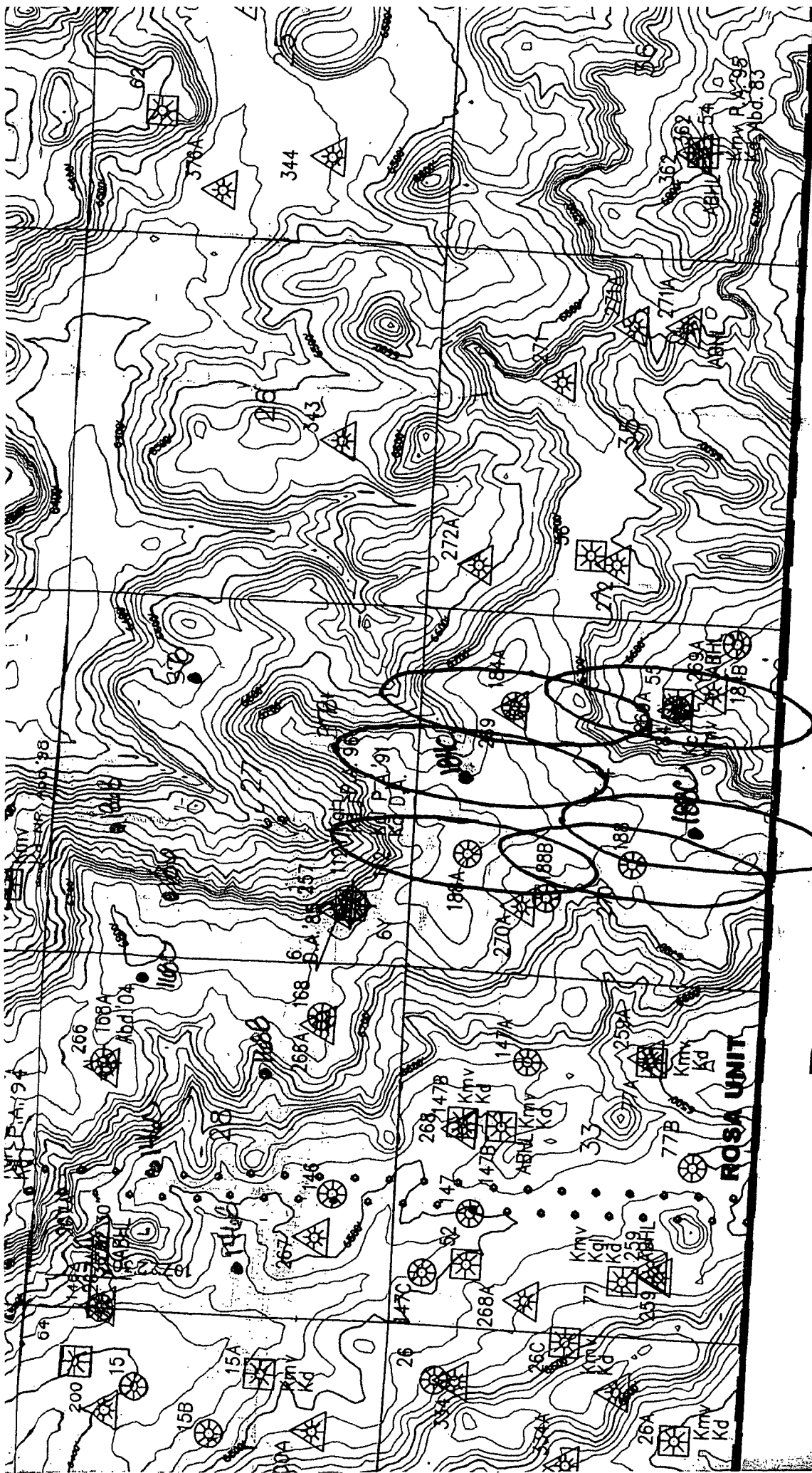

R-5-W

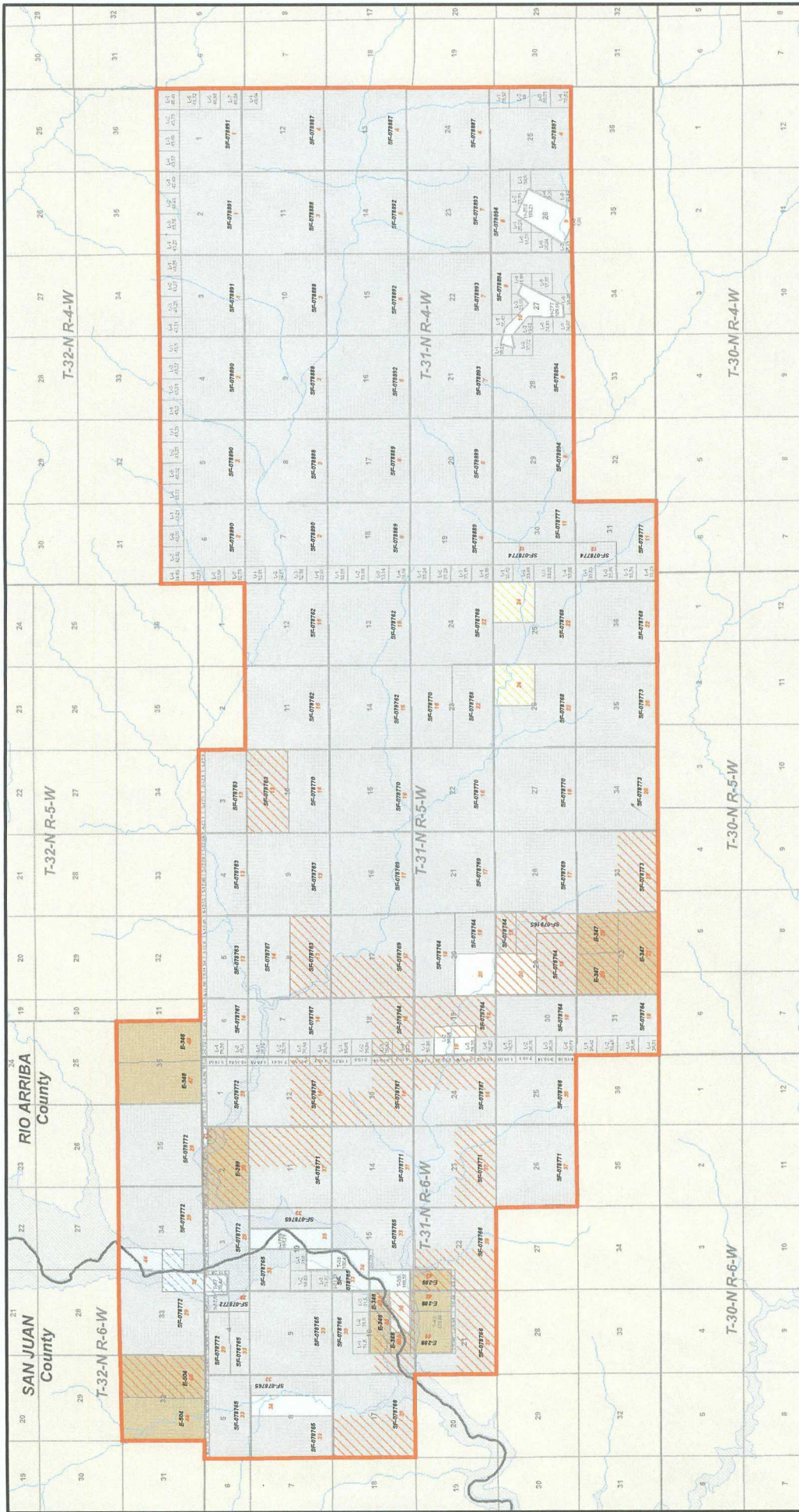

Legend

- Dakota Participating Area-18th Expansion
- Mineral Ownership
- Federal
- Fee
- Partially Committed
- State
- Not Committed

Rosa Unit Tract No: XX

Map Document: G:\Project\San_Juan\Rosa_Unit\Participating_Areas\rosa-unit_00a.mxd
3/7/2007 - 11:02:28 AM

Scale: 1:172,000

Date: 3/7/2007

Author: SA

Williams Exploration & Production

Rosa Unit
Dakota Formation
San Juan and Rio Arriba Counties, New Mexico

