

Energy Reserves Group, Inc.
P.O. Box 3280
Casper, Wyoming 82602-3280
307 265 7331

September 26, 1983

State of New Mexico
Oil Conservation Division
P.O. Box 2088
Santa Fe, New Mexico 87501

NSL-1760 Φ Energy Reserves Group
Rule 104FI
November 13, 1983

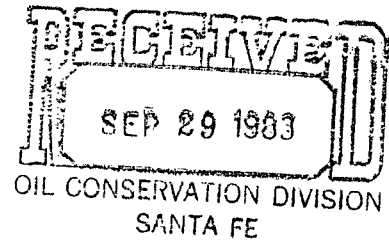

RE: Request for Unorthodox Well Location
E.H. Pipkin Lease
San Juan County, New Mexico

Gentlemen:

Energy Reserves Group, Inc., respectfully requests approval of the below unorthodox well location.

E. H. Pipkin No. G-1
350' FNL & 1120' FWL
Section 36 T28N-R11W
Federal Lease SF-078019

Undesignated Gallup Oil Pool

This well is a proposed Gallup well at a depth of 5850'. Energy Reserves Group, Inc. has 100% working interest in all formations on this lease. The lease boundry is shown on the attached vicinity map.

As shown by the vicinity map, the Kutz Wash runs through this lease. Topography all along this wash is eroded sandstone with numerous smaller washes and steep narrow gullies. Due to a hill on the west, this location was moved in order to minimize surface distrubance. We would appreciate your review of our request based on topographic conflicts.

Sincerely yours,
ENERGY RESERVES GROUP, INC.

Paul Bertoglio

Paul Bertoglio
Production Engineer
Rocky Mountain District.

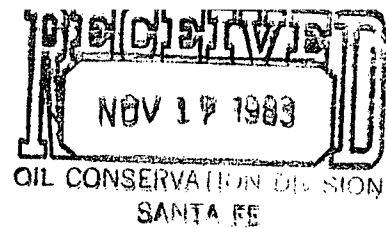

Energy Reserves Group, Inc.
P.O. Box 3280
Casper, Wyoming 82602-3280
307 265 7331



As proposed by Energy Reserves Group, Inc., we have no objection to the unorthodox well location known as the:

E. H. Pipkin No. G-1
Section 36-T28N-R11W
San Juan County, New Mexico

Doyle L. Jones
Name

Marathon Oil Company
Company

District Operations Manager
Title

November 8, 1983
Date

Energy Reserves Group, Inc.
P.O. Box 3280
Casper, Wyoming 82602-3280
307 265 7331



October 21, 1983

State of New Mexico
Energy and Mineral Department
Oil Conservation Division
P. O. Box 2088
Santa Fe, New Mexico 87501

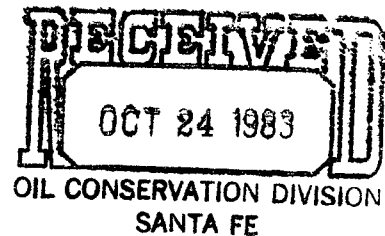

Attn: Mr. R. L. Stamets
Technical Support Chief

RE: APD for Non-Standard Location
E. H. Pipkin No. G-1
Section 36 T28N-R11W
San Juan County, New Mexico

Dera Mr. Stamets:

In reference to your letter of 10-11-83, please find attached a plat showing the ownership of the offsetting leases to the subject well. These offset owners were notified by certified letter sent 10-21-83.

Sincerely yours,
ENERGY RESERVES GROUP, INC.

Paul Bertoglio
Production Engineer
Rocky Mountain District

cc: Well File

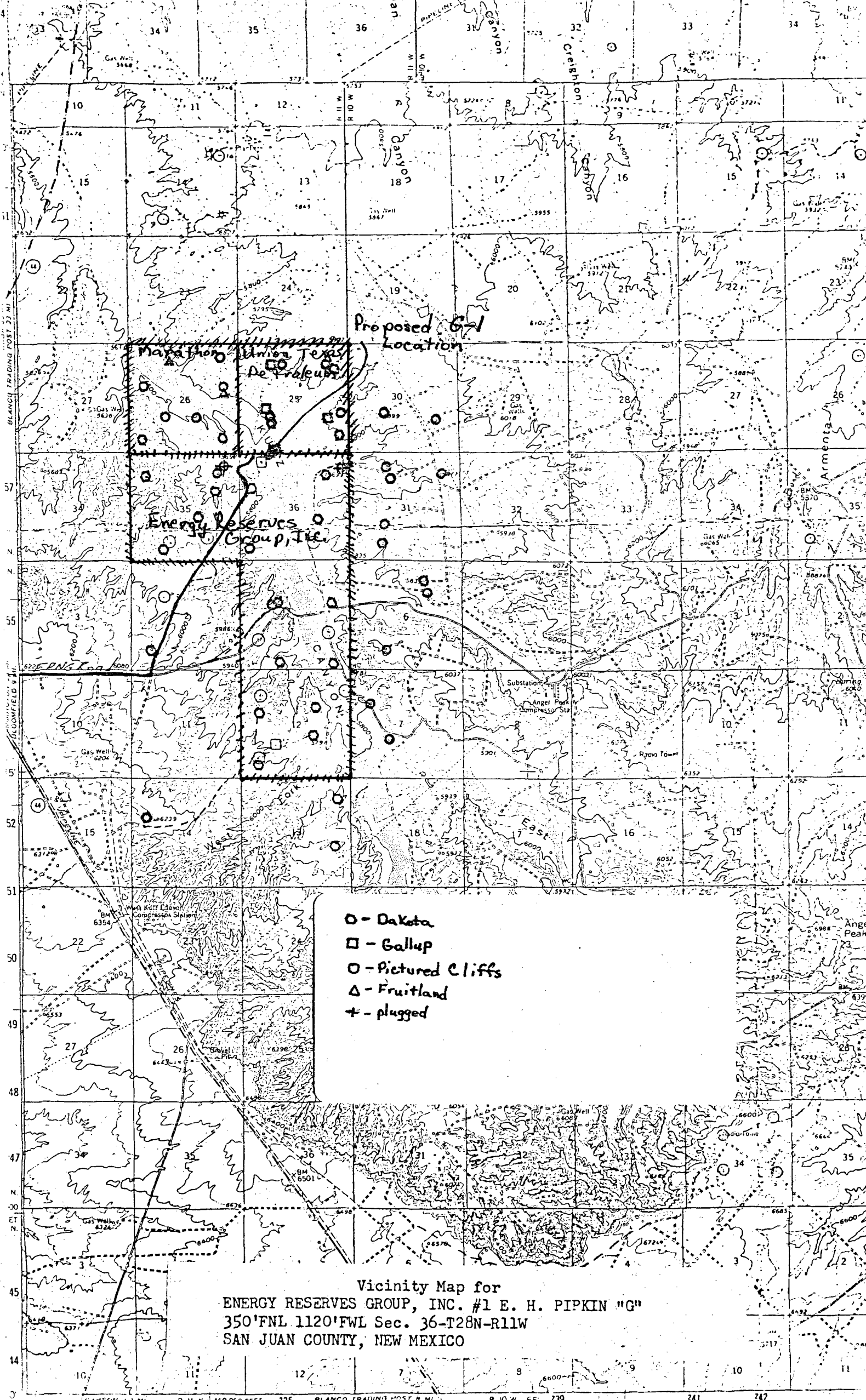

Proposed G-1 Location

Maya, Union Texas De France

Energy Reserves Group, Inc.

- O - Dakota
- - Gallup
- - Pictured Cliffs
- △ - Fruitland
- + - plugged

Vicinity Map for
ENERGY RESERVES GROUP, INC. #1 E. H. PIPKIN "G"
350'FNL 1120'FWL Sec. 36-T28N-R11W
SAN JUAN COUNTY, NEW MEXICO

UNITED STATES
DEPARTMENT OF THE INTERIOR
GEOLOGICAL SURVEY

APPLICATION FOR PERMIT TO DRILL, DEEPEN, OR PLUG BACK

1a. TYPE OF WORK

DRILL ☒DEEPEN ☐PLUG BACK ☐

b. TYPE OF WELL

OIL
WELL ☒GAS
WELL ☐

OTHER

SINGLE
ZONE ☒MULTIPLE
ZONE ☐

2. NAME OF OPERATOR

Energy Reserves Group, Inc.

3. ADDRESS OF OPERATOR

P.O. Box 3280 Capser, Wyoming 82602

4. LOCATION OF WELL (Report location clearly and in accordance with any State requirements.)*

At surface 350' FNL & 1120' FWL

At proposed prod. zone

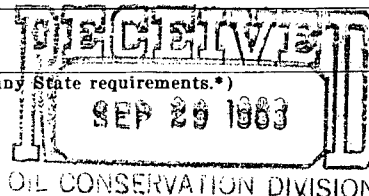

14. DISTANCE IN MILES AND DIRECTION FROM NEAREST TOWN OR POST OFFICE*

SANTA FE

6 miles South of Bloomfield, New Mexico

15. DISTANCE FROM PROPOSED*

LOCATION TO NEAREST
PROPERTY OR LEASE LINE, FT. 350'
(Also to nearest drlg. unit line, if any)

16. NO. OF ACRES IN LEASE

2560.96

17. NO. OF ACRES ASSIGNED
TO THIS WELL

40

18. DISTANCE FROM PROPOSED LOCATION*

TO NEAREST WELL, DRILLING, COMPLETED,
OR APPLIED FOR, ON THIS LEASE, FT. 714'

19. PROPOSED DEPTH

5850

20. ROTARY OR CABLE TOOLS

Rotary

21. ELEVATIONS (Show whether DF, RT, GR, etc.)

G.L.-5648' (Ungraded)

22. APPROX. DATE WORK WILL START*

Winter, 1983-84

23.

PROPOSED CASING AND CEMENTING PROGRAM

SIZE OF HOLE	SIZE OF CASING	WEIGHT PER FOOT	SETTING DEPTH	QUANTITY OF CEMENT
12 1/4"	9 5/8"	36#	300'	Cement to Surface
8 5/8"	7"	29#	5140'	Cement to Surface
6"	4 1/2" (lnr.)	10.5#	4990'-5850'	Cement to liner top

It is proposed to drill the referenced well with rotary tools from the surface to T.D. The anticipated zone of completion is the Gallup Formation. Attached is the 10 point Drilling Plan and the 13 Point Surface Use Plan.

Gas is dedicated to Southern Union.

IN ABOVE SPACE DESCRIBE PROPOSED PROGRAM: If proposal is to deepen or plug back, give data on present productive zone and proposed new productive zone. If proposal is to drill or deepen directionally, give pertinent data on subsurface locations and measured and true vertical depths. Give blowout preventer program, if any.

24.

SIGNED

Paul C. Bertoglio

TITLE Production Engineer RMD

DATE September 21, 1983

(This space for Federal or State office use)

PERMIT NO.

APPROVAL DATE

APPROVED BY

TITLE

DATE

CONDITIONS OF APPROVAL, IF ANY:

All distances must be from the outer boundaries of the Section.

Operator ENERGY RESERVES GROUP, INC.		Lease E. H. PIPKIN "G"		Well No. 1
Unit Letter D	Section 36	Township 28N	Range 11W	County San Juan
Actual Footage Location of Well: 350 feet from the North line and 1120 feet from the West line				
Ground Level Elev. 5648	Producing Formation Gallup	Pool Unnamed Gallup	Dedicated Acreage: 40 Acres	

1. Outline the acreage dedicated to the subject well by colored pencil or hatchure marks on the plat below.
2. If more than one lease is dedicated to the well, outline each and identify the ownership thereof (both as to working interest and royalty).
3. If more than one lease of different ownership is dedicated to the well, have the interests of all owners been consolidated by communitization, unitization, force-pooling, etc?

☐ Yes ☐ No If answer is "yes," type of consolidation _____

If answer is "no," list the owners and tract descriptions which have actually been consolidated. (Use reverse side of this form if necessary.) _____

No allowable will be assigned to the well until all interests have been consolidated (by communitization, unitization, forced-pooling, or otherwise) or until a non-standard unit, eliminating such interests, has been approved by the Commission.

1120'	350'
Sec.	
RECEIVED SEP 29 1983 OIL CONSERVATION DIVISION SANTA FE	

Scale: 1"=1000'

CERTIFICATION	
I hereby certify that the information contained herein is true and complete to the best of my knowledge and belief.	
Name	Paul C. Bertoglio
Position	Production Engineer
Company	Energy Reserves Group, Inc.
Date	September 21, 1983
I hereby certify that the well location shown on this plat was plotted from field notes of actual surveys made by me or under my supervision, and that the same is true and correct to the best of my knowledge and belief.	
Date Surveyed	September 7, 1983
Registered Professional Engineer and Land Surveyor	Fred B. Kerr Jr.
Certificate No.	3950



STATE OF NEW MEXICO
ENERGY AND MINERALS DEPARTMENT
OIL CONSERVATION DIVISION

October 11, 1983

TONY ANAYA
GOVERNOR

POST OFFICE BOX 2088
STATE LAND OFFICE BUILDING
SANTA FE, NEW MEXICO 87501
(505) 827-5800

Energy Reserves Group Inc.
P. O. Box 3280
Casper, Wyoming 82602-3280

Re: Application for Non-Standard
Location: E. H. Pipkin No. G-1

Sec. 36, T-28-N, R-11-W, Gallup

Oil Well, San Juan County, NM

We may not process the subject application for non-standard location until the required information or plats checked below (is) (are) submitted.

☒ A plat must be submitted clearly showing the ownership of the offsetting leases, including sections 25 and 26 to the North.

☒ A statement must be submitted that offset owners have been notified of the application by certified mail. (if any)

☐ A plat must be submitted fully identifying the topography necessitating the non-standard location.

☐ Other:

Very truly yours,

R. L. STAMETS
Technical Support Chief

RLS/dr