

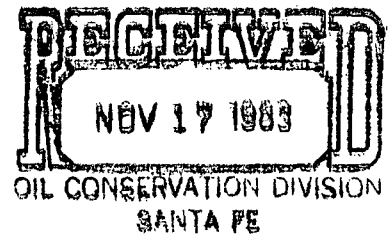

McClellan Oil Corporation



November 15, 1983

Mr. Joe Ramey, Secretary - Director
New Mexico Oil Conservation Division
P.O. Box 2088
Santa Fe, NM 87503

NSL-1973
Rule 104 F I
Dec. 7, 1983

Re: MM Fed. No. 3
Lease #NM-0559993
Sec. 31-T9S-R26E
2080' FNL & 660' FWL
Chaves County, NM

South Pecos Slope Abo Pool

Dear Mr. Ramey:

McClellan Oil Corporation would appreciate an administrative approval for a non-standard Abo gas well location as provided for under NMOCD Rule 104-F.

We were unable to stake the well in our preferred location of 1980' FNL & 660' FWL due to an order by the BLM to move the location 100' south due to a topography problem. We are requesting administrative approval for this location for topographical reasons.

The enclosed lease map shows the offset operator who has been notified by certified mail of our request.

We will appreciate your expeditious approval and issuance of the administrative order.

Sincerely yours,

Mark McClellan

Mark McClellan
Geologist

Enclosure

cc: Yates Petroleum



McClellan Oil Corporation

FILE HSL - 1773

November 29, 1983

Oil Conservation Division
P.O. Box 2088
Santa Fe, New Mexico 87501

Attention: Gilbert Quintana

Dear Mr. Quintana:

Enclosed please find a plat on our MM Federal #3 you requested per our telephone conversation this date. This information is for our non-standard location application.

Sincerely,

Kay Smith

All distances must be from the outer boundaries of the Section.

McClellan Oil Corp.			Lease		M M Federal	Well No.	#3
Section	31	Township	9 South	Range	26 East	County	Chaves
Section	31	Township	9 South	Range	26 East	County	Chaves
Well Postage Location of Well:							
2080	feet from the	North	line and	660	feet from the	West	line
und Level Elev.	3655	Producing Formation	Abo	Pool	South Pecos Slope Abo	Dedicated Acreage:	160 Acres

1. Outline the acreage dedicated to the subject well by colored pencil or hatchure marks on the plat below.
2. If more than one lease is dedicated to the well, outline each and identify the ownership thereof (both as to working interest and royalty).
3. If more than one lease of different ownership is dedicated to the well, have the interests of all owners been consolidated by communitization, unitization, force-pooling, etc?

☐ Yes ☐ No If answer is "yes," type of consolidation _____

If answer is "no," list the owners and tract descriptions which have actually been consolidated. (Use reverse side of this form if necessary.) _____

No allowable will be assigned to the well until all interests have been consolidated (by communitization, unitization, forced-pooling, or otherwise) or until a non-standard unit, eliminating such interests, has been approved by the Division.

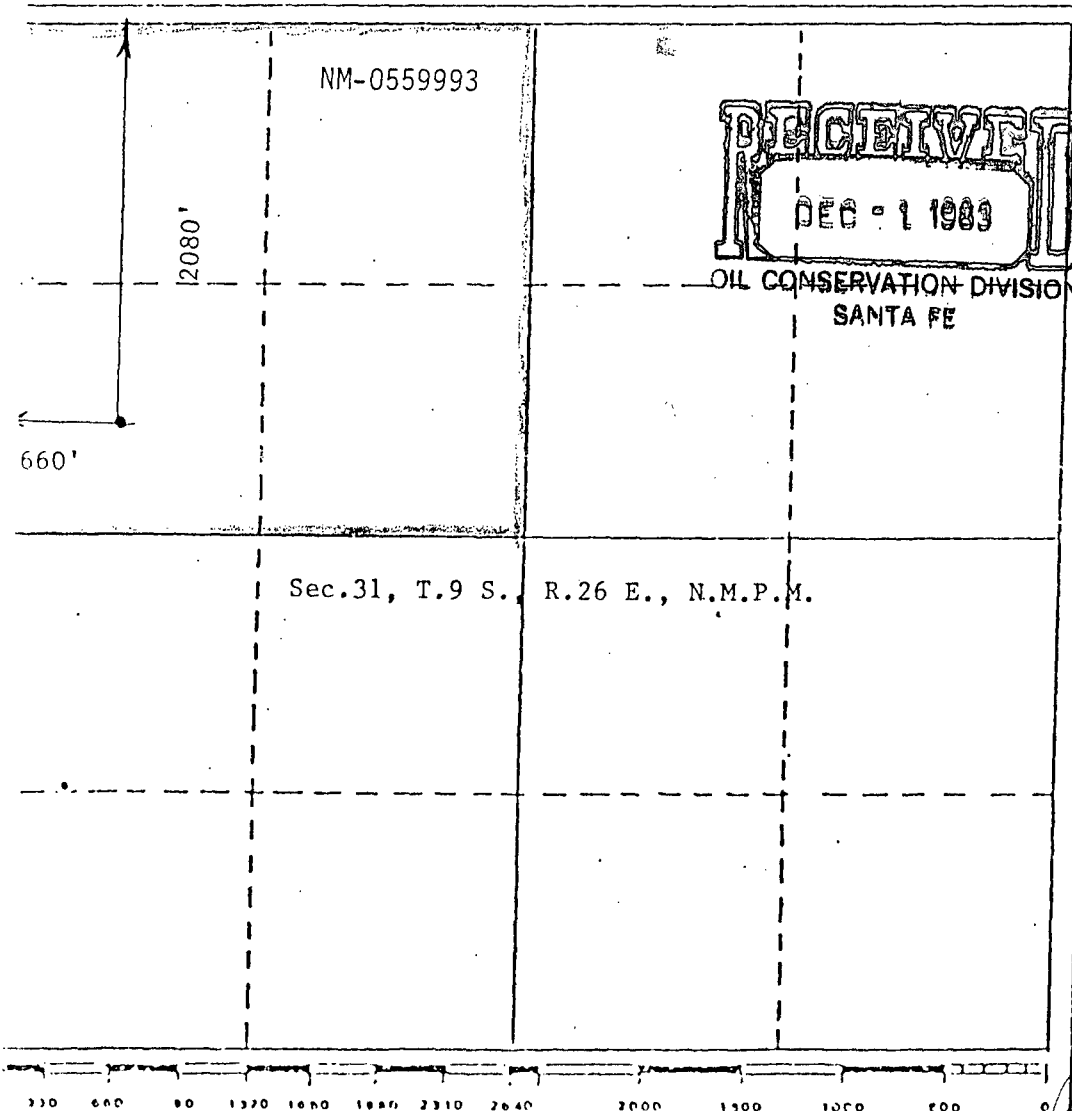

CERTIFICATION

I hereby certify that the information contained herein is true and complete to the best of my knowledge and belief.

Name Paul Ragsdale
Position Operations Manager
Company McClellan Oil Corporation
Date Nov. 15, 1983

I hereby certify that the well location shown on this plat was plotted from field notes of actual surveys made by me or under my supervision, and that the same is true and correct to the best of my knowledge and belief.

JOHN D. JAQUES
NEW MEXICO
REGISTERED PROFESSIONAL ENGINEER
and/or LAND SURVEYOR
Date Surveyed November 11, 1983
6290
John D. Jaques, P.E. & L.S.
Certificate No. 6290

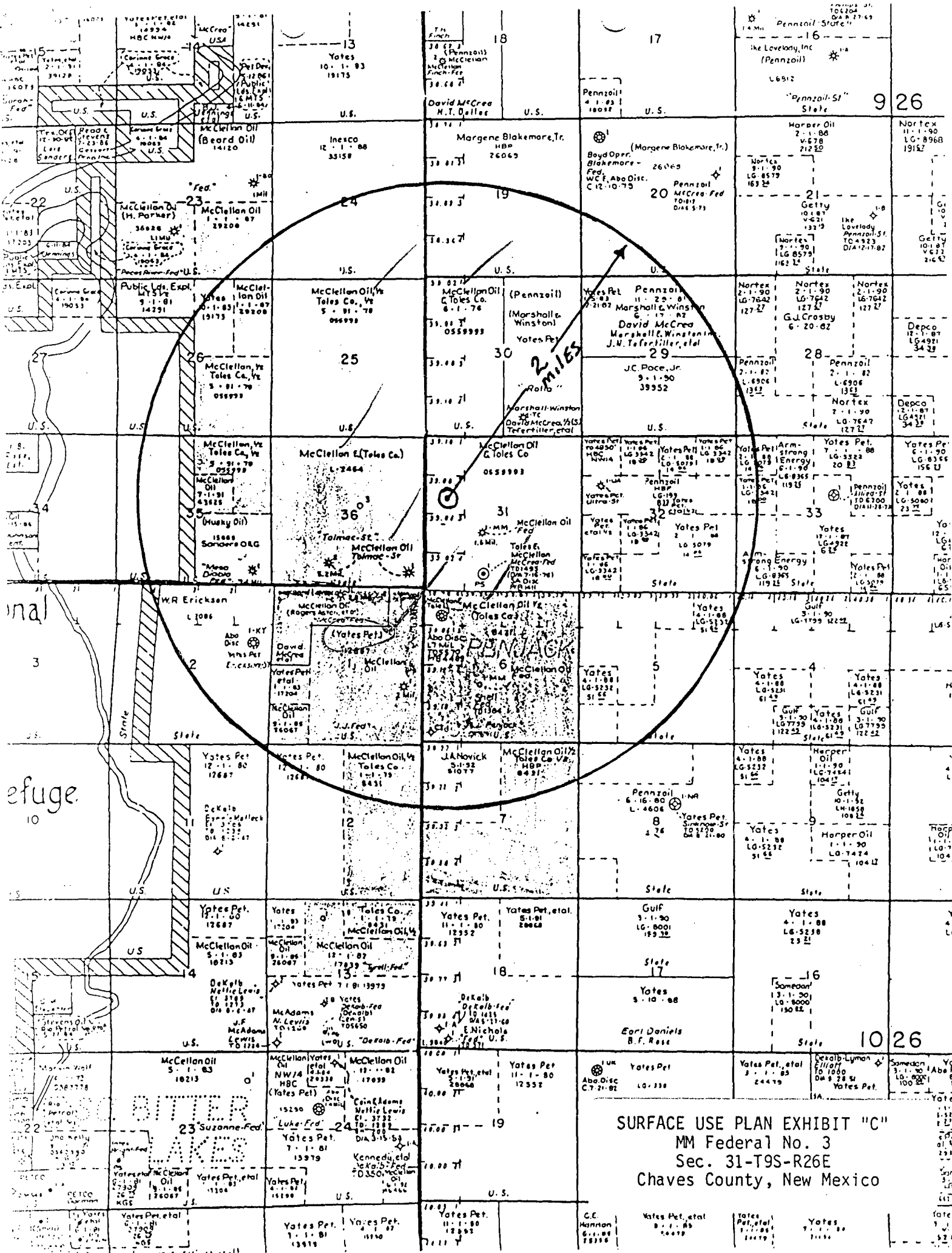

SURFACE USE PLAN EXHIBIT "C"
MM Federal No. 3
Sec. 31-T9S-R26E
Chaves County, New Mexico

