

District I
1625 N. French Dr., Hobbs, NM 88240
District II
1301 W. Grand Avenue, Artesia, NM 88210
District III
1000 Rio Brazos Road, Aztec, NM 87410
District IV
1220 S. St Francis Dr., Santa Fe, NM 87505

State of New Mexico
Energy Minerals and Natural Resources

Oil Conservation Division
1220 South St. Francis Dr.
Santa Fe, NM 87505

Form C-141
Revised October 10, 2003

Submit 2 Copies to appropriate
District Office in accordance
with Rule 116 on back
side of form

Trunk "0" #3

Release Notification and Corrective Action

OPERATOR

☒ Initial Report ☐ Final Report

Name of Company	Southern Union Gas Services, Ltd.	Contact	Tony Savoie
Address	P.O. Box 1226 Jal, N.M. 88252	Telephone No.	505-395-2116
Facility Name	Lea County Field Dept.	Facility Type	Natural Gas Gathering

Surface Owner: Mathew Casey	Mineral Owner: Fee	Lease No.
-----------------------------	--------------------	-----------

LOCATION OF RELEASE

Unit Letter N	Section 27	Township 22S	Range 36E	Feet from the	North/South Line	Feet from the	East/West Line	County Lea
------------------	---------------	-----------------	--------------	---------------	------------------	---------------	----------------	---------------

Latitude N32 21.511 Longitude W103 15.408

NATURE OF RELEASE

Type of Release : Crude Oil, Produced water, and Natural Gas	Volume of Release: 50 Bbbls Fluid and 360 MCF Nat. Gas	Volume Recovered 0 Bbbls crude Oil and produced water
Source of Release : 30" Natural Gas Pipeline	Date and Hour of Occurrence not known	Date and Hour of Discovery 7/21/07 Time: 7:00 p.m.
Was Immediate Notice Given? <input checked="" type="checkbox"/> Yes <input type="checkbox"/> No <input type="checkbox"/> Not Required	If YES, To Whom? NMOCD on call representative	
By Whom? Tony Savoie	Date and Hour: 7/21/07 7:15 p.m.	
Was a Watercourse Reached? <input type="checkbox"/> Yes <input checked="" type="checkbox"/> No	If YES, Volume Impacting the Watercourse.	

If a Watercourse was Impacted, Describe Fully.*

Describe Cause of Problem and Remedial Action Taken.*

A 30" Natural Gas gathering line developed a leak due to excess fluid delivered by a producer caused the line to pressure up and leak fluid and natural gas. Crews began shutting the line in at 7:45 pm. All of the fluid lost had soaked into the ground before the vacuum trucks arrived on site.

Describe Area Affected and Cleanup Action Taken. Approximately 5100 Square feet of pasture land and approximately 3672 square feet of caliche lease road was impacted by the release. No cleanup actions were taken at the time of the release.
The final remediation will follow the NMOCD guidelines for the remediation of leaks and spills.

I hereby certify that the information given above is true and complete to the best of my knowledge and understand that pursuant to NMOCD rules and regulations all operators are required to report and/or file certain release notifications and perform corrective actions for releases which may endanger public health or the environment. The acceptance of a C-141 report by the NMOCD marked as "Final Report" does not relieve the operator of liability should their operations have failed to adequately investigate and remediate contamination that pose a threat to ground water, surface water, human health or the environment. In addition, NMOCD acceptance of a C-141 report does not relieve the operator of responsibility for compliance with any other federal, state, or local laws and/or regulations.

Signature: Tony Savoie		OIL CONSERVATION DIVISION	
Printed Name: John A. Savoie		Approved by District Supervisor: [Signature]	
Title: Remediation Supervisor		Approval Date: 8-2-07	Expiration Date: 10-20-07
E-mail Address: tony.savoie@sug.com		Conditions of Approval:	
Date: 7/31/07 Phone: 505-395-2116		SUBMIT FINAL C-141 w/ SUPPORTING DOCUMENTATION BY [Signature]	

* Attach Additional Sheets If Necessary

RP #1509

2007-027

Trunk "O" #3

36 E

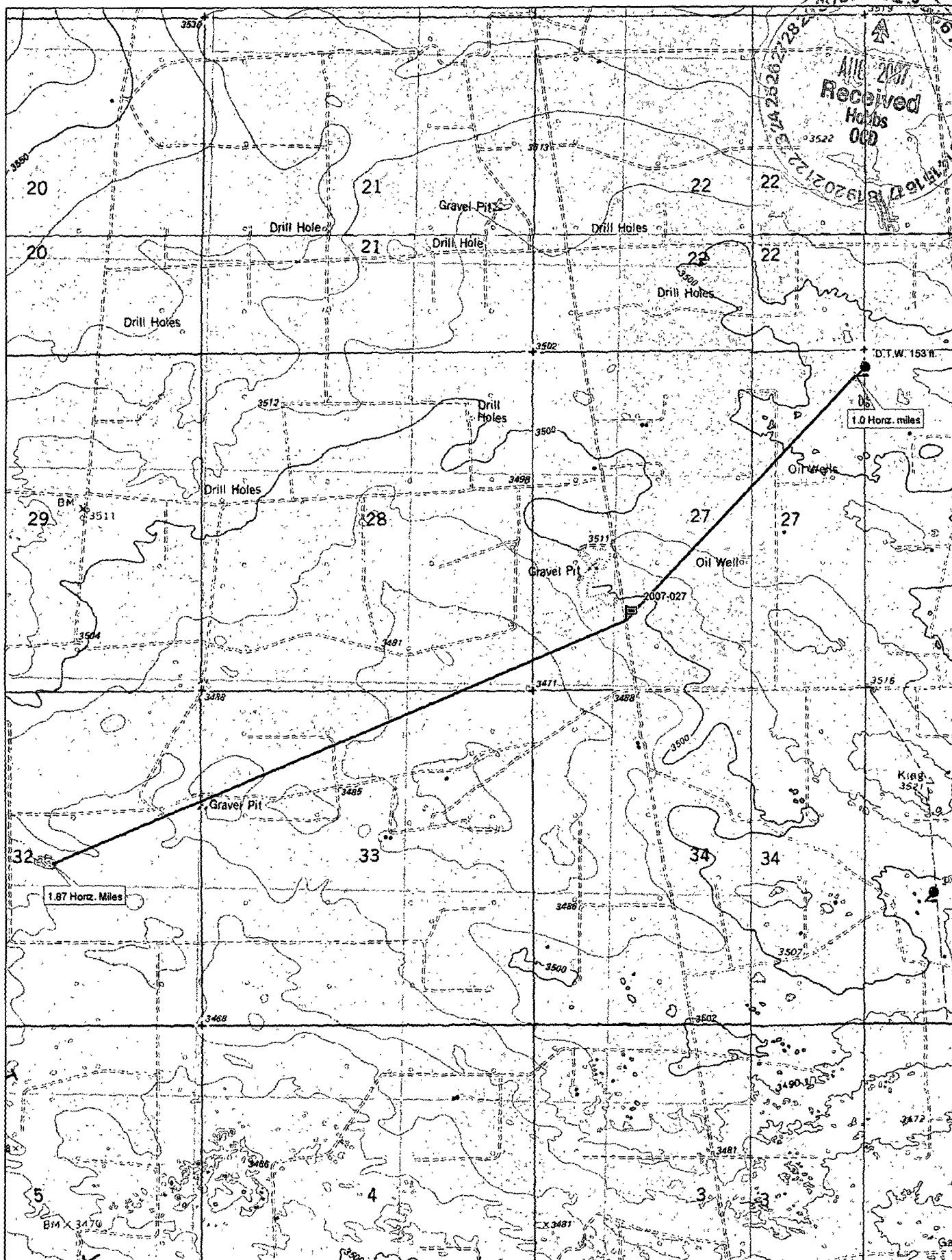

22
5



© 2002 DeLorme, 3-D TopoQuads®, Data copyright of content owner.
www.delorme.com

Scale 1 : 25,000
1" = 2080 ft

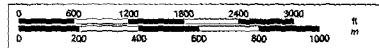

Trunk "O" #3

Job # 2007-027

Ranking Analysis

NMOCD Standards			Points
Depth to Ground Water	Greater than 100 ft.		0
Depth to Ground Water	Less than 100 ft. but greater than 50 ft.		10
Depth to Ground Water	Less than 50 ft.		20
Well Head Protection	Less than 1000 ft. from a water source, or;	Yes	20
	Less than 200 ft. from private domestic water source	No	0
Distance to Surface water body	Less than 200 Horizontal ft.		20
Distance to Surface water body	200 to 1000 Horizontal ft.		10
Distance to Surface water body	Greater than 1000 Horizontal ft.		0
Action levels	>19	10-19	0-9
Benzene (mg/kg)	10	10	10
BTEX (mg/kg)	50	50	50
TPH (mg/kg)	100	1000	5000

Site Ranking			Points
Depth to Ground Water "Avg."	153 ft.		0
Well Head Protection	1.0 Horiz. Miles		0
Surface Water Body	1.87 Horiz. Miles		0
Total Ranking Score			0

Site Closure Objective	
Benzene (mg/kg)	10
BTEX (mg/kg)	50
TPH (mg/kg) "Surface"	5000
Chlorides (mg/kg)	1000

Remediation Plan:
All affected soil will be excavated and sampled for the presence of Hydrocarbons EPA method (8015M)
Soil with TPH values greater than 5000 mg/kg or chloride values greater than 1000 mg/kg will be transported to the Southern Union Landfarm or remediated on site.
Soil samples will be collected from the excavation and analyzed for Hydrocarbons EPA method (8015M)
All samples will be field screened with a "PID" The soil sample with the highest PID reading will be analyzed separately and tested for BTEX.

